

THE YORK

PARKING, STOPPING AND WAITING (AMENDMENT) (No 11/8)

TRAFFIC ORDER 2012

THE YORK PARKING, STOPPING AND WAITING (AMENDMENT) (NO 11/8)
TRAFFIC ORDER 2012

The Council for the City of York, in exercise of powers under Sections 1, 2, 4, 32, 35, 45, 46, 53 and Schedule 9 of the Road Traffic Regulation Act 1984 (the Act) and of all other enabling powers and after consultation with the Chief Officer of Police in accordance with Schedule 9 of the Act hereby makes the following Order:

1. This Order may be cited as the York (Amendment)(No 11/8) Traffic Order 2012 and shall come into effect on the 28th day of August 2012.
2. The York Parking, Stopping and Waiting Traffic Order 2011 is amended by:
 - (a) the deletion of the entries in Columns 1 to 3 of Part II of the First Schedule against the roads WIGGINTON – “WESTFIELD LANE”, YORK - “BLUE BRIDGE LANE”, “BURTON GREEN – NORTH WESTERN CARRIAGEWAY”, “BURTON STONE LANE”, “FABER STREET”, “FULFORD CROSS”, “FULFORD CROSS – LENGTH ADJACENT TO SOUTH EASTERN BOUNDARY OF FULFORD CROSS SCHOOL”, “FULFORD CROSS – LENGTH ADJACENT TO NO’S 8 TO 13 FULFORD CROSS”, “HALLFIELD ROAD”, “HAZEL COURT”, “MAPLE GROVE”, “RICHMOND STREET”, “RICHMOND STREET – CUL-DE-SAC FRONTING NO’S 23–35 and 12-18”, “ROWNTREE AVENUE” and “THE GROVE” and the substitution to the respective Columns of the entries set out in Part I of the Schedule to this Order;
 - (b) the addition to the respective Columns of Part II of the First Schedule of the entries set out in Part II of the Schedule to this Order;
 - (c) the deletion from Column 2 of Part I of the Fifth Schedule of the Zone “RICHMOND STREET” against the Reference and Plan Number “R31” in Column 1 and the substitution of the Zone “FABER STREET”;
 - (d) the deletion from Part II of the Fifth Schedule of the plan entitled “R31 RICHMOND STREET” and the substitution of the plan entitled “R31 FABER STREET” contained in the Second Schedule to this Order.

FIRST SCHEDULE
(PARKING PLACES, STOPPING AND WAITING RESTRICTIONS)
PART I

<u>Column 1</u> Road and Side	<u>Column 2</u> Length	<u>Column 3</u> (Designation)
<u>WIGGINTON</u>		
<u>WESTFIELD LANE</u>		
East side	From the projected southern property boundary line of No 7 Westfield Lane south for 51m.	NW 24
	Between points 51m and 134m south from the said line.	NS (Sch) 8.30/9.30 and 3/4 XSS
	Between a point 134m south from the said line and a point 46m north from the projected southern property boundary line of Wigginton Primary School.	NW 24
West side	From the projected southern property boundary line of No. 7 Westfield Lane south for 31m.	NW 24
	Between points 44m and 51m south from the said line.	NW 24
	From the projected southern property boundary line of No 10 Westfield Lane south for 75m.	NW 24
	Between points 46m and 72m north from the projected southern property boundary line of Wigginton Primary School.	NW 24

Column 1
Road and Side

Column 2
Length

Column 3
(Designation)

YORK

BLUE BRIDGE LANE

South side and west end

The whole except the lengths set out in the following parking provision.

NW 24

North side

Between points 15m and 49m east from the projected western highway boundary line of William Court.

Park (8/6 XS) 60

Between points 2m and 53m west from the said line.

Park (8/6XS) 60

BURTON GREEN
– NORTH WESTERN
CARRIAGEWAY

North west sides

From a point 33m north east from the projected north eastern property boundary line of No 93 Burton Green north east for the remainder of its length.

NW 24

South east side

From a point 31m north east from the said line north east for the remainder of its length.

NW 24

BURTON STONE LANE

Both sides

From the north eastern property boundary line of No 136 Burton Stone Lane south west for 31m.

NW 24

From the projected southern property boundary line of No 248 Burton Stone Lane south to the projected northern highway boundary line of Crichton Avenue.

NW 24

North west side

From the projected centreline of Surtees Street south west for 12.5m and north east for 12.5m.

NW 24

Between points:

37.5m and 62.5m, and
93m and 118m

NW 24

north east from the said line.

Between the highway boundary line on the north east side of Clifton and a point 2m north east from the projected north eastern property boundary line of No 81 Burton Stone Lane.

NW 24

South east side

From the highway boundary line on the north east side of Clifton to the projected south western boundary line of the grounds of St Luke's Church. Between its junctions with Field View and Glencoe Street.

NW 24

NW 8/6 XS

East side

From the projected centreline of Rowntree Avenue south for 8m and north for 70m.

NW 24

Between points 97m and 130m north from the said line.

NW 24

From a point 148m north from the said line north for the remainder of its length.

NW 24

West side

From the said line south for 8m and north east for 101m.

NW 24

Between points 101m and 132m north from the said line.

NS (Sch) 8.30/9.30
and 3/4 XSS

Between points 132m and 158m north from the said line.

NW 24

North east side
(end of cul-de-sac)

The whole length.

NW 24

<u>Column 1</u> <u>Road and Side</u>	<u>Column 2</u> <u>Length</u>	<u>Column 3</u> <u>(Designation)</u>
FABER STREET		
West side	From a point 15m south from the projected southern property boundary line of No 9 Faber Street south for the remainder of its length.	NW 24
	Between a point 15m south from the said line and a point 3m south from the projected northern property boundary line of No 39 Faber Street.	Res. P (24)10
	Within the main carriageway, from the said line north for 12m and south for 3m.	NW 24
East side	Within the main carriageway, from the said line north for 12m and south for the remainder of its length.	NW 24
North side	Within the main carriageway, from the projected eastern kerbline of Faber Street east for 11m.	NW 24
South side	Within the main carriageway, from the said line east for 16m.	NW 24
FULFORD CROSS		
South side	From the kerbline on the west side of Fulford Road for 36m.	NW 24
	Between points 4m and 25m west from the projected western property boundary line of No 7 Fulford Cross.	NW 24
	From the projected eastern property boundary line of York Steiner School west for 7.5m and east for 36m.	NS (Sch) 8/5 XSS
	Between points 36m and 49m east from the said line.	NW 24
North side	From the said line west for 3m and east for 23m.	NS (Sch) 8/5 XSS
	Between a point 23m east from the said line and a point 4m west from the projected western property boundary line of No 7 Fulford Cross.	NW 24
	From the kerbline on the west side of Fulford Road for 39m.	NW 24
FULFORD CROSS - LENGTH ADJACENT TO SOUTH EASTERN BOUNDARY OF FULFORD CROSS SCHOOL		
Both sides	The whole except that length on its north west side between points 2m and 30m south west from the projected south western highway boundary line of that length of Fulford Cross extending along the frontages of No's 8 – 13 Fulford Cross.	NW 24
FULFORD CROSS – LENGTH ADJACENT TO NO'S 8 TO 13 FULFORD CROSS		
Both sides	The whole extending north west to the entrance to Fulford School, except that length on its north east side between points 27m north and west and 13m south east from the projected north western property boundary line of No 9 Fulford Cross.	NW 24

<u>Column 1</u> <u>Road and Side</u>	<u>Column 2</u> <u>Length</u>	<u>Column 3</u> <u>(Designation)</u>
FULFORD CROSS - LENGTH ADJACENT TO NORTH WESTERN BOUNDARY OF NO 13 FULFORD CROSS Both sides	From a point 3m south west from the projected south western building line of property No's 8-13 Fulford Cross south west for the remainder of its length.	NW 24
HALLFIELD ROAD Both sides	Between its junctions with Layerthorpe and James Street.	NW 24 LBXS
	Between a point 20m north west from the projected centreline of Richmond Street and its junction with James Street excluding that area of road, not being main carriageway, fronting No's 49 and 51 Hallfield Road.	NW 24 LBXS
North side	That area of road not being a main carriageway, fronting property No's 49 and 51 Hallfield Road.	Res. P(24) 10
North east side	From the projected centreline of Richmond Street north west for 20m and south east to a point 14m south east from the projected southern kerbline of Little Hallfield Road.	NW 24
	Between points 14m and 30m south east from the said line.	Park (24) 60
	From a point 30m south east from the said line south east for the remainder of its length including the whole of that 18m length of spine road forming part of a turning head opposite Hallfield Road Industrial Estate property unit C1.	NW 24
South west side	From the projected centreline of Richmond Street north west for 20m and south east to a point 48m south east from the projected southern kerbline of Little Hallfield Road.	NW 24
	From the projected north western building line of Hallfield Road Industrial Estate Unit at No. 64 Hallfield Road north west for 25m.	NW 24
	From a point 32m south east from the said building line south east for the remainder of its length.	NW 24
HAZEL COURT Both sides and turning head at its eastern end	The whole except that length on its south side between points 48m west and 39m east from the projected eastern property boundary line of the Household Waste Recycling Centre.	NW 24
South side	Between points 28 and 39m east from the said line.	Car Club Park (24)
MAPLE GROVE Both sides	From the projected western highway boundary line of Fulford Road for 20m.	NW 24
	From the respective western property boundary lines of No's 87 and 88 Maple Grove west for the remainder of the respective lengths of Maple Grove and in the whole of the turning head at its western end.	NW 24

<u>Column 1</u> <u>Road and Side</u>	<u>Column 2</u> <u>Length</u>	<u>Column 3</u> <u>(Designation)</u>
RICHMOND STREET Both sides	From the projected north eastern kerbline of Hallfield Road for 23m.	NW 24
ROWNTREE AVENUE Both sides	From the projected northern kerbline of Intake Avenue for 10m. From the projected eastern kerbline of Burton Stone Lane for 10m.	NW 24 NW 24
THE GROVE Both sides	From the south eastern kerbline of Tadcaster Road south east for the remainder of its length and in the whole of the turning head at its south eastern extremity except that this restriction does not apply in the lay-by on its north east side.	NW 24

PART II

<u>Column 1</u> <u>Road and Side</u>	<u>Column 2</u> <u>Length</u>	<u>Column 3</u> <u>(Designation)</u>
FULFORD CROSSFIELD CRESCENT Both sides	Between the projected north eastern property boundary line of No 51 Crossfield Crescent and the projected south eastern property boundary line of No 35 Crossfield Crescent. Between the projected south western property boundary line of No 7 Crossfield Crescent and the projected south eastern property boundary line of No 19 Crossfield Crescent.	NW 24 NW 24
ST OSWALD'S ROAD North side South side	From the projected western highway boundary line of Fulford Road for 8m. From the said line for 50m.	NW 24 NW 24
YORK BROADWAY South side North side	From the projected eastern property boundary line of No 60 Broadway east for 3m and west for 58m. From a point 32m west from the said line west and continuing north and north east to a point 4m west from the projected western property boundary line of No 71 Broadway.	NW 24 NW 24

<u>Column 1</u> <u>Road and Side</u>	<u>Column 2</u> <u>Length</u>	<u>Column 3</u> <u>(Designation)</u>
BROADWAY – SERVICE ROAD EXTENDING ON SOUTH SIDE ALONG THE FRONTAGES OF NO'S 30 TO 54 BROADWAY – EASTERN ENTRANCE Both sides	Between the projected southern kerblines of Broadway (through road) and the projected southern highway boundary line of Broadway (through road).	NW 24
DERWENT ROAD Both sides	From the projected eastern kerblines of Fulford Road for 10m.	NW 24
FARNDALE STREET North side	From the projected western kerblines of Rosedale Street for 7m.	NW 24
FOREST WAY Both sides	From the projected south eastern kerblines of Stockton Lane for 10m.	NW 24
MOORLAND ROAD Both sides	From the projected eastern kerblines of Fulford Road for 10m.	NW 24
ROSE STREET North side	Between points 4m and 9m east from the projected eastern property boundary line of No 2 Rose Street.	Dis. Park (24)
ROSEDALE STREET West side	From the projected northern kerblines of Farndale Street for 7m.	NW 24
SHIPTON STREET North east side	From the projected centreline of the road giving access to Albert Court north west for 9m and south east for 9m.	NW 24
STOCKTON LANE South east side	From the projected centreline of Forest Way north east for 23m and south west for 13m.	NW 24

SECOND SCHEDULE

PLANS OF RESIDENTS' PRIORITY PARKING ZONES

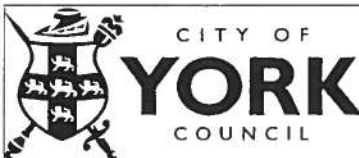
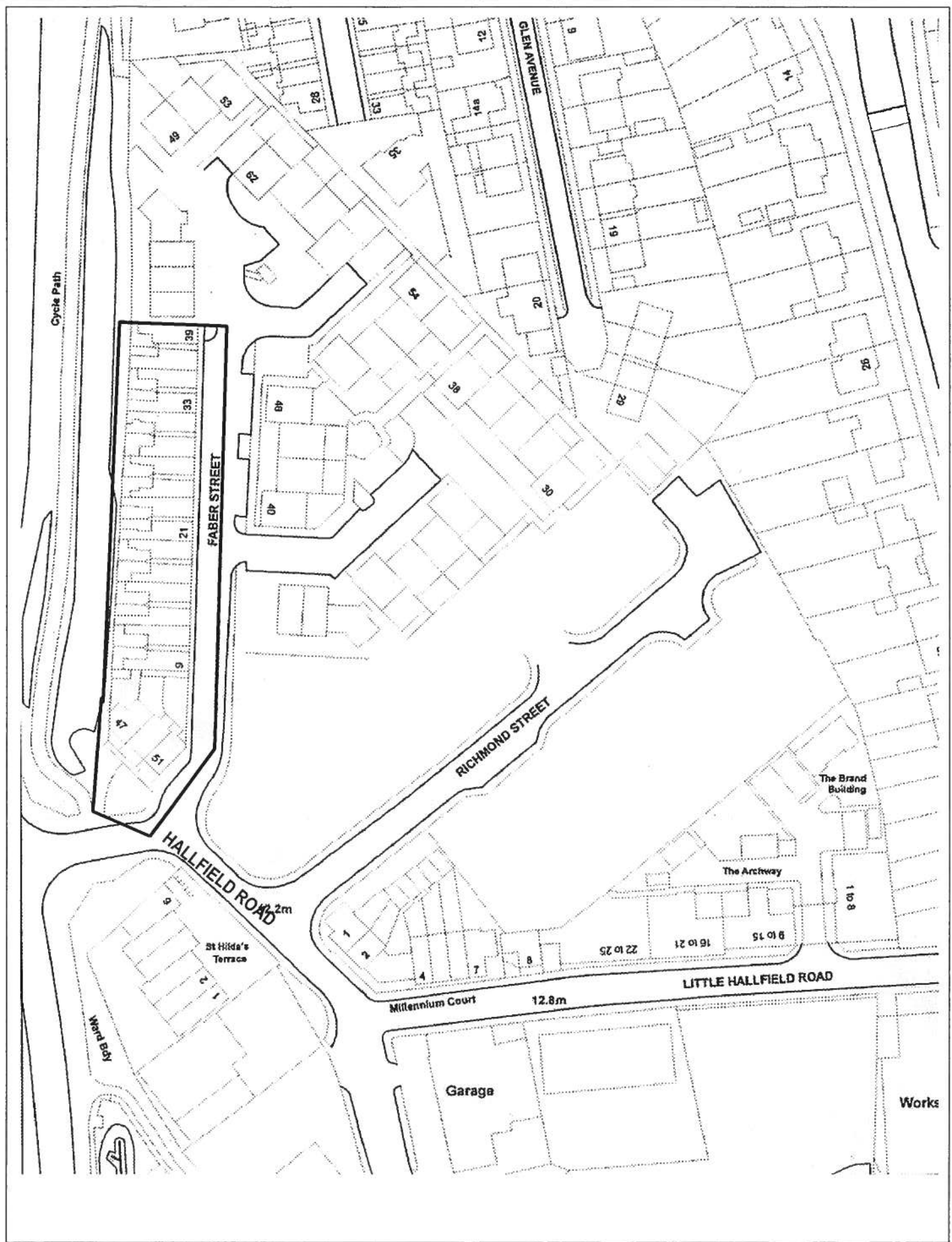

9, St. Leonards Place, York, YO1 2ET
 Telephone: 01904 551550

R31 FABER STREET

 Boundary of Area



SCALE 1:1000

DRAWN BY PSL
 Project

DATE 26/10/2011
 Drawing No

R31FAB

Dated the 21st day of August 2012

THE COMMON SEAL OF THE
COUNCIL FOR THE CITY OF
YORK WAS HERETO AFFIXED
IN THE PRESENCE OF

ASSISTANT DIRECTOR
OF GOVERNANCE AND ICT

