

01 DEC 2008

WYCHAVON DISTRICT COUNCIL

**THE WYCHAVON DISTRICT COUNCIL (OFF-STREET PARKING PLACES)
(CONSOLIDATION) (VARIATION) (NO. 1) ORDER 2008**

THE WYCHAVON DISTRICT COUNCIL in exercise of its powers under Section 35(1) and (3) of the Road Traffic Regulation Act 1984 (hereinafter referred to as "The Act") and Part IV of Schedule 9 to the Act, and of all other enabling powers, with the consent of Worcestershire County Council in accordance with Section 39(3) of the Act and after consulting the Chief Officer of Police in accordance with Part III of Schedule 9 of the Act, hereby makes the following Order:-

1. This Order shall come into operation on the 1st day of DECEMBER 2008 and may be cited as the Wychavon District Council (Off-Street Parking Places) (Consolidation) (Variation) (No. 1) Order 2008.
2. The Wychavon District Council (Off-Street Parking Places) (Consolidation) (Order) 2004 is hereby varied by:-

The incorporation in Schedule 1 to the Order of the additional short stay car park at Evesham Chapel Street by the insertion in Schedule 1 to the Order after "Evesham Oat Street Car Park (Short Stay)" of the wording set out in Schedule A to this Variation Order.

Schedule A

Name of parking place	Position in which vehicles may wait	Classes of vehicles	Days of operation of parking places	Hours of operation of parking places	Maximum period for which vehicles may wait	Scale of Charges
(1)	(2)	(3)	(4)	(5)	(6)	(7)
Evesham Chapel Street Car Park (short stay)	Wholly within a parking bay i.e. between such lines (if any) as are marked on the surface of the parking place to indicate each parking bay	i) Motor cars within the provisions of Section 136(2)(a) of the 1984 Act, ii) Light commercial motor vehicles constructed for use for the conveyance of goods or burden the unladen weight of which does not exceed 1525 kg iii) Motor cycles as defined in section 136(4) of the 1984 Act iv) Invalid carriages or Disabled persons vehicles	Monday to Saturday inclusive including Bank Holidays	0800 hours to 1800 hours (8.00am – 6.00pm)	3 Hours	Up to 1 hour £0.70 Up to 2 hours £1.40 Up to 3 hours £2.10

The Common Seal of Wychavon ~~DC~~

District Council was

hereunto affixed the 7th day

of NOVEMBER 2008 in the

presence of

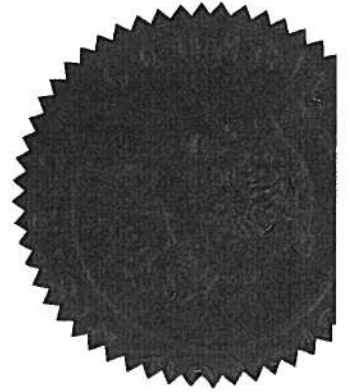

11,234

JACK HEGARTY
Managing Director

IAN MARSHALL
Head of Legal & Support Services

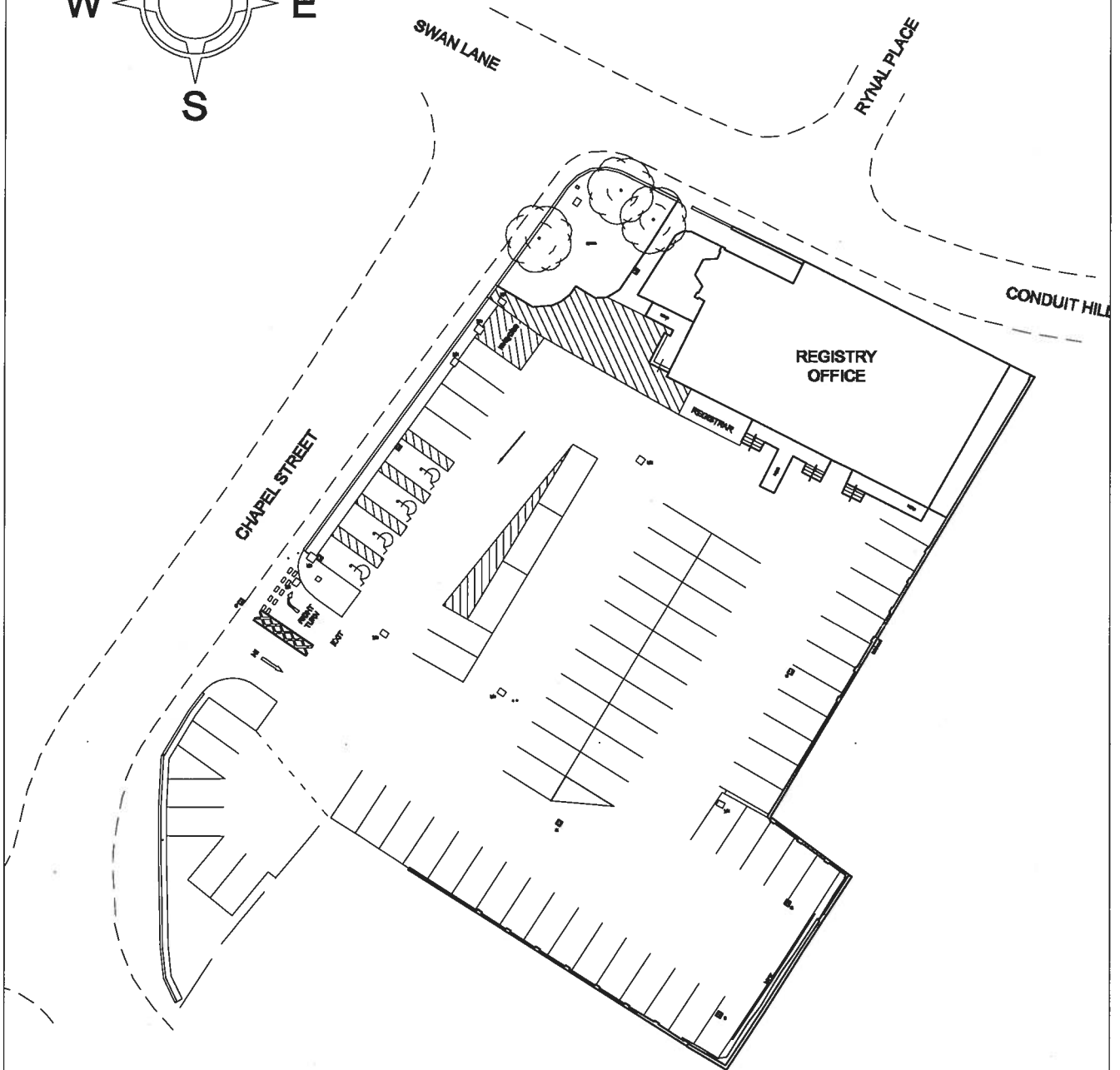
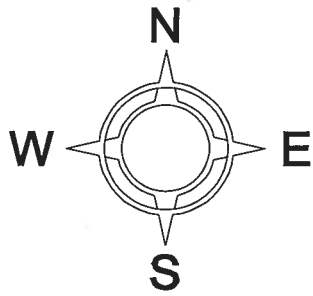

TITLE Chapel Street, Evesham - Plan for Parking Order



Eur. Ing. A.H.JONES (ENGINEERING
CONSULTANCY MANAGER) B.Sc., C.Eng.,
M.I.C.E., F.C.I.W.E.M.
CIVIC CENTRE
QUEEN ELIZABETH DRIVE
PERSHORE
WORCS TEL (01388 565000)
WR10 1PT FAX (01388 565560)

SCALE

1/500

DRAWING No.

W837/6

DATE

Sept 2008

DRAWN BY

MAC