

WOLVERHAMPTON CITY COUNCIL

THE WOLVERHAMPTON CITY COUNCIL (PENN)
(PROHIBITION AND RESTRICTION OF WAITING)
(AMENDMENT NO 1) ORDER 2010

Wolverhampton City Council in exercise of its powers under Sections 1, 2 and 124 (1) (d) of the Road Traffic Regulation Act 1984 and of all other enabling powers, after consultation with the chief officer of police in accordance with Part III of Schedule 9 to the Act hereby make the following Order:-

In this Order -

"disabled persons badge" has the same meaning as in The Disabled Persons (Badges for Motor Vehicles) Regulations 2000

"parking disc" means a disc, issued by a Local Authority in accordance with Article 8(5) of the Local Authorities Traffic Orders (Exemptions for Disabled Persons) (England) Regulations 2000

For the purposes of this Order a vehicle shall be regarded as displaying a disabled persons badge in the relevant position if the badge is displayed in accordance with Part III of the Disabled Persons (Badges for Motor Vehicles) (England) Regulations 2000

1. This Order shall come into operation on the 13th day of September 2010 and may be cited as The Wolverhampton City Council (Penn) (Prohibition and Restriction of Waiting) (Amendment No 1) Order 2010.
2. The Wolverhampton City Council (Penn) (Prohibition and Restriction of Waiting) (Amendment No.1) Order 2010 includes Plans (the "Plans") incorporated in the The Wolverhampton City Council (Penn) (Prohibition and Restriction of Waiting) (Amendment No.1) Order 2010 Plan Supplement ("the Plan Supplement")
3. Save as provided in Article 4, no person shall, except upon the direction or with the permission of a police officer in uniform or of a civil enforcement officer in uniform, cause or permit any vehicle to wait at any time on any day in parts of Thomas Street, Pountney Street, Stewart Street and Finchfield Road West as specified on the Plans.
4. (1) Nothing in Article 3 hereto shall render it unlawful to cause or permit any vehicle to wait on the lengths of roads referred to therein for so long as may be necessary to enable:-
 - (a) a person to board or alight from the vehicle;
 - (b) the vehicle, if it cannot conveniently be used for such purposes in any other road, to be used in connection with any of the following operations, namely -
 - (i) building, industrial or demolition operations;
 - (ii) the removal of any obstruction to traffic;
 - (iii) the maintenance, improvement or reconstruction of the said lengths of roads;
 - (iv) the laying, erection, alteration or repair in, or on land adjacent to the said lengths of roads of any sewer or of any main, pipe or apparatus for the supply of gas, water or electricity or of any telecommunications apparatus as defined in the Telecommunications Act 1984;

- (c) the vehicle, if it cannot conveniently be used for such purpose in any other road, to be used in the service of a local authority or a water authority in pursuance of statutory powers or duties;
 - (d) the vehicle of the Royal Mail or other universal provider (as defined in section 4(3) and (4) of the Postal Services Act 2000) to be used for the purpose of delivering and/or collecting mail;
 - (e) the vehicle to wait at or near to any premises situated on or adjacent to the said lengths of roads for so long as such waiting by that vehicle is reasonably necessary in connection with any wedding or funeral;
 - (f) the vehicle to be used for fire brigade, ambulance or police purposes; or
 - (g) goods to be loaded on or unloaded from the vehicle
- (2) Nothing in Article 3 shall render it unlawful to cause or permit a disabled person's vehicle which displays in the relevant position a disabled person's badge, and a parking disc (on which the driver, or other person in charge of the vehicle, has marked the time at which the period of waiting began) to wait on the length of road referred to in that Article for a period not exceeding three hours (not being a period separated by an interval of less than one hour from a previous period of waiting by the same vehicle in the same length of road on the same day):

Provided that the vehicle immediately before or after the act of parking has been or is about to be driven or used by the person to whom the badge has been issued or as the cause may be, used for the carrying of disabled person(s) as passenger(s).

THE COMMON SEAL of Wolverhampton
City Council was hereunto affixed in the
presence of:-



Authorised Officer

Dated: 7 September 2010



310/10

Pl Refers to: Stewart Street (Part); Thomas Street; Pountney Street (Part).

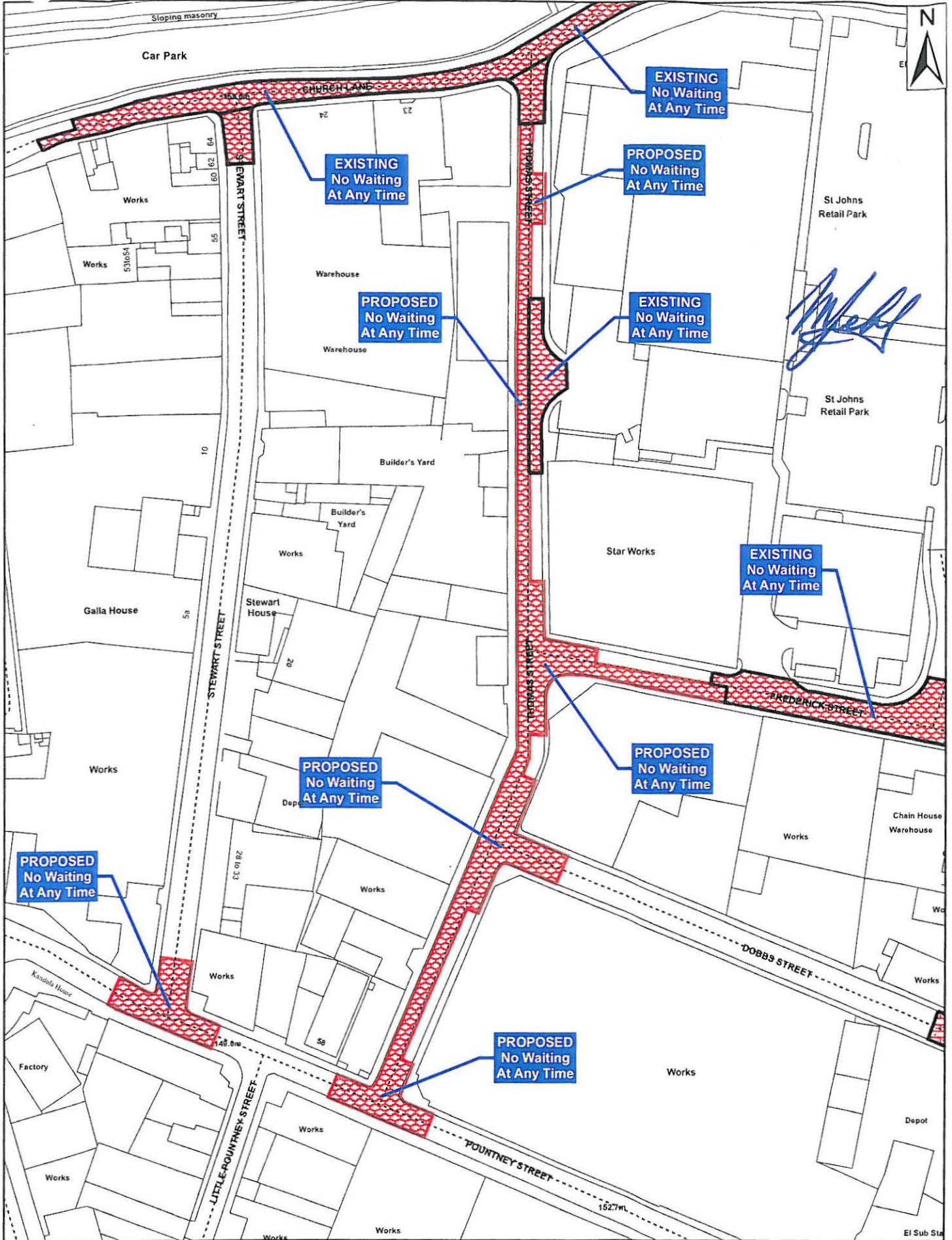

© OS Licence No. 100019537. Unauthorised reproduction infringes Crown Copyright 2010

SCALE - 1:1,250



The Wolverhampton City Council (Penn)
(Prohibition and Restriction of Waiting)
(Amendment No.1) Order 2010

Transportation Network Management
Heantun House
Salop Street
Wolverhampton
WV3 0SQ

Plan Refers to: Finchfield Road West (Part)

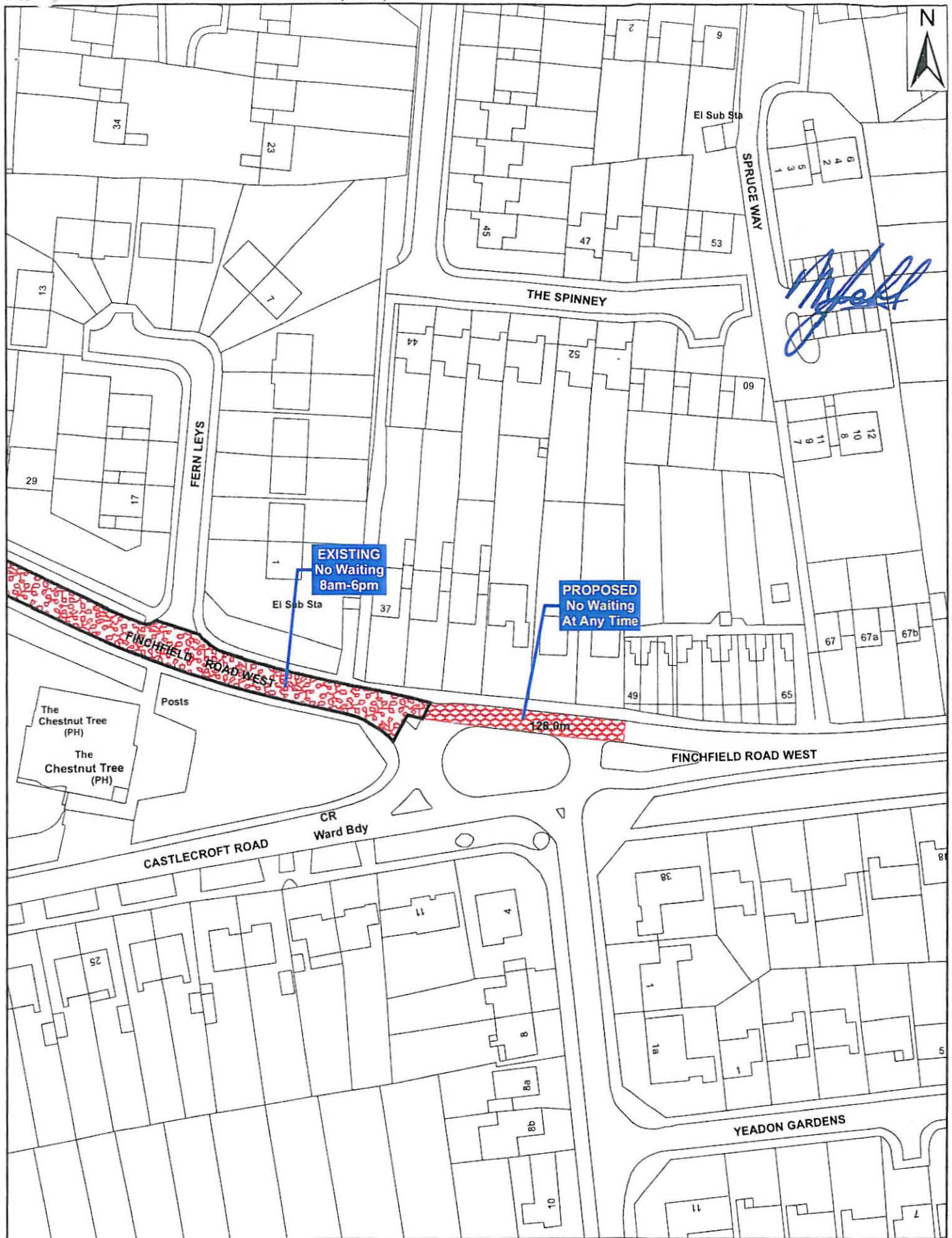

© OS Licence No. 100019537. Unauthorised reproduction infringes Crown Copyright 2010

SCALE - 1:1,000