

**Map Based Traffic Regulation Order
(MBTRO)**

**The County of Wiltshire
(The City of Salisbury)
(Prohibition and Restriction of Waiting, Taxi Rank Clearways and On Street Parking)
Consolidation Order
2013**

Zone H

MBTRO filename: SALSZONH2013

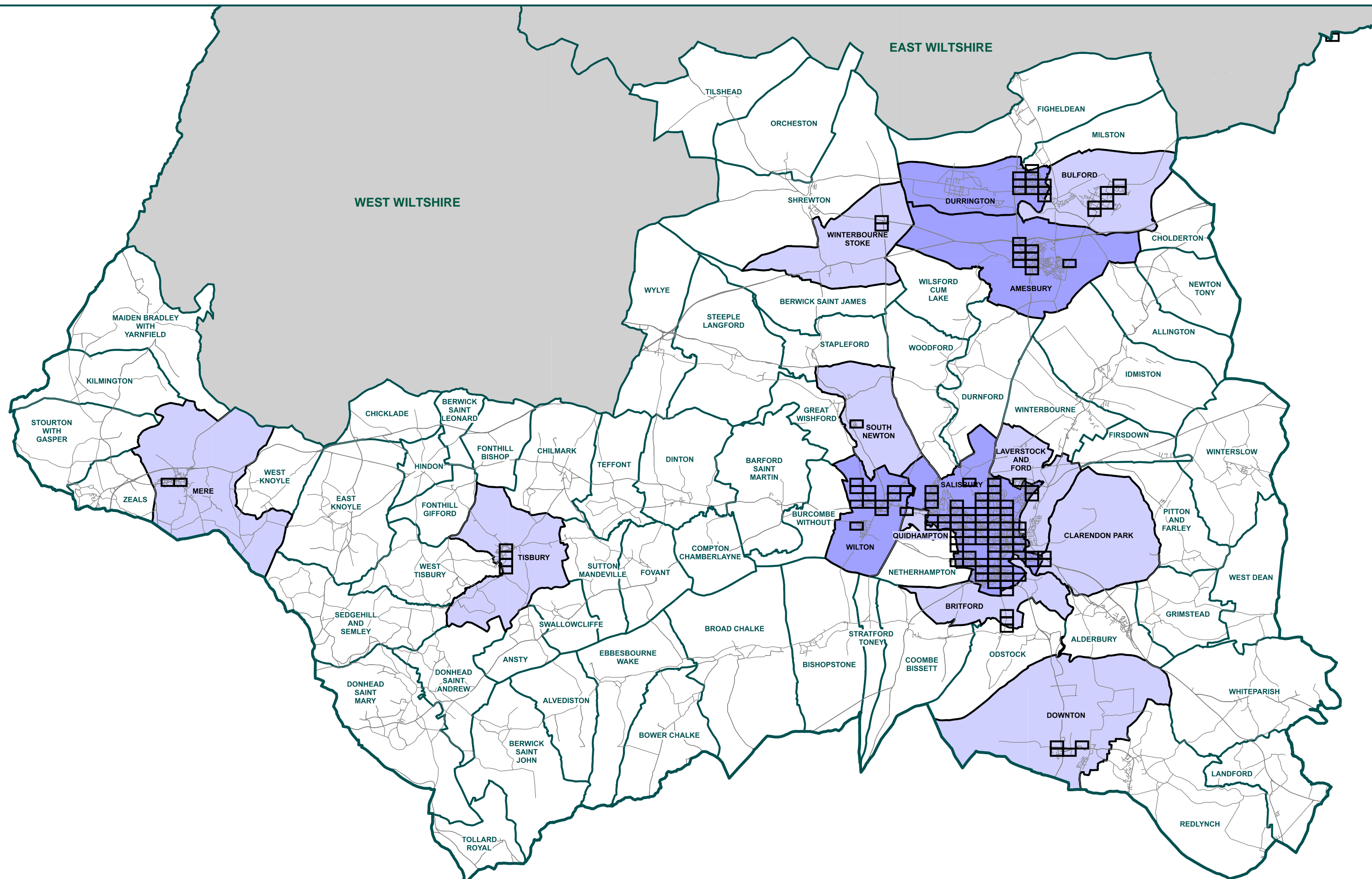

WILTSHIRE COUNCIL

ROAD TRAFFIC REGULATION ACT 1984
TRAFFIC MANAGEMENT ACT 2004

THE COUNTY OF WILTSHIRE (SALISBURY)
(PROHIBITION AND RESTRICTION OF WAITING, TAXI RANK CLEARWAYS AND
ON STREET PARKING) CONSOLIDATION ORDER 2013

The Council of the County of Wiltshire in exercise of its powers under Sections 1, 2, 4, 32, 35, 45, 46, 49, 51, 53 and Part IV of Schedule 9 of the Road Traffic Regulation Act 1984 (hereinafter referred to as "the Act of 1984") as amended and the Traffic Management Act 2004 (hereinafter referred to as "the Act of 2004") as amended and of all other enabling powers and after consultation with the Chief Officer of Police in accordance with Part III of Schedule 9 to the Act of 1984 hereby makes the following Order.

PART I – GENERAL

Commencement and Citation

1. This Order shall come into operation on 11th February 2013 and may be cited as The County of Wiltshire (Salisbury) (Prohibition and Restriction of Waiting, Taxi Rank Clearways and On Street Parking) Consolidation Order 2013.

Revocations

2. The following Orders are hereby revoked:

The City of New Sarum (Various Streets) Traffic Regulation Order No. 1, 1965
The City of New Sarum (Various Street) Traffic Regulation (Amendment)
Order No. 1 1966

The City of New Sarum (Various Street) Traffic Regulation (Amendment)
Order No. 2 1973

The County of Wiltshire (Salisbury) (Revocation of Various Orders) Traffic
Regulation Order 1979

The County of Wiltshire (Exeter Street Parking Place, Salisbury) Revocation
Order 1984

Wiltshire County Council (Salisbury) (St. Edmund's Area) (Residents' Parking
Places) Order 1989

Wiltshire County Council (Salisbury) (St. Edmund's Area) (Residents' Parking
Places) Order 1989 (Amendment No. 1) Order 1991

Wiltshire County Council (Salisbury) (St. Edmund's Area) (Resident's Parking
Places) Order 1989 (Amendment No. 2) Order 1992

Wiltshire County Council (Salisbury) (St. Edmund's Area) (Resident's Parking
Places) Order 1989 (Amendment No. 3) Order 1998

Wiltshire County Council (Salisbury) (St. Edmund's Area) (Resident's Parking
Places) Order 1989 (Amendment No. 4) Order 1998

Wiltshire County Council (Salisbury) (St. Edmund's Area) (Resident's Parking
Places) Order 1989 (Amendment No. 5) Order 2001

Wiltshire County Council (Salisbury) (St. Edmund's Area) (Resident's Parking
Places) Order 1989 (Amendment No. 6) Order 2001

Wiltshire County Council (Salisbury) (St. Edmund's Area) (Resident's Parking
Places) Order 1989 (Amendment No. 7) Order 2002

Wiltshire County Council (Residents' Parking Places, Salisbury) (Visitors' Parking Permits) Order 1996
The County of Wiltshire (Various Roads, Salisbury) Revocation Order 1999
The County of Wiltshire (Various Roads, Salisbury) (Prohibition and Restriction of Waiting, Loading and Unloading) Order 2000
The County of Wiltshire (Various Roads, Salisbury) (Prohibition and Restriction of Waiting, Loading and Unloading) Order 2000 (Amendment No.1) Order 2001
The County of Wiltshire (Various Roads, Salisbury) (Prohibition and Restriction of Waiting, Loading and Unloading) Order 2000 (Amendment No.2) Order 2000
The County of Wiltshire (Various Roads, Salisbury) (Prohibition and Restriction of Waiting, Loading and Unloading) Order 2000 (Amendment No.3) Order 2001
The County of Wiltshire (Various Roads, Salisbury) (Prohibition and Restriction of Waiting, Loading and Unloading) Order 2000 (Amendment No.4) Order 2001
The County of Wiltshire (Various Roads, Salisbury) (Prohibition and Restriction of Waiting, Loading and Unloading) Order 2000 (Amendment No.5) Order 2001
The County of Wiltshire (Various Roads, Salisbury) (Prohibition and Restriction of Waiting, Loading and Unloading) Order 2000 (Amendment No.6) Order 2002
The County of Wiltshire (Various Roads, Salisbury) (Prohibition and Restriction of Waiting, Loading and Unloading) Order 2000 (Amendment No.7) Order 2002
The County of Wiltshire (Various Roads, Salisbury) (Prohibition and Restriction of Waiting, Loading and Unloading) Order 2000 (Amendment No.8) Order 2003
The County of Wiltshire (Various Roads, Salisbury) (Prohibition and Restriction of Waiting, Loading and Unloading) Order 2000 (Amendment No.9) Order 2004
The County of Wiltshire (Various Roads, Salisbury) (Prohibition and Restriction of Waiting, Loading and Unloading) Order 2000 (Amendment No.10) Order 2004
The County of Wiltshire (Various Roads, Salisbury) (Prohibition and Restriction of Waiting, Loading and Unloading) Order 2000 (Amendment No.11) Order 2005
The County of Wiltshire (Various Roads, Salisbury) (Prohibition and Restriction of Waiting, Loading and Unloading) Order 2000 (Amendment No.12) Order 2006
The County of Wiltshire (Various Roads, Salisbury) (Prohibition and Restriction of Waiting, Loading and Unloading) Order 2000 (Amendment No.13) Order 2007
The County of Wiltshire (Various Roads, Salisbury) (Prohibition and Restriction of Waiting, Loading and Unloading) Order 2000 (Amendment No.14) Order 2006
The County of Wiltshire (Various Roads, Salisbury) (Prohibition and Restriction of Waiting, Loading and Unloading) Order 2000 (Amendment No.15) Order 2008
The County of Wiltshire (Various Roads, Salisbury) (Prohibition and Restriction of Waiting, Loading and Unloading) Order 2000 (Amendment No.16) Order 2009
The County of Wiltshire (Various Roads, Salisbury) (Prohibition and Restriction of Waiting, Loading and Unloading) Order 2000 (Amendment No.17) Order 2008

The County of Wiltshire (Various Roads, Salisbury) (Prohibition and Restriction of Waiting, Loading and Unloading) Order 2000 (Amendment No.18) Order 2009

The County of Wiltshire (Various Roads, Salisbury) (Prohibition and Restriction of Waiting, Loading and Unloading) Order 2000 (Amendment No.19) Order 2010

The County of Wiltshire (Various Roads, Salisbury) (Prohibition and Restriction of Waiting, Loading and Unloading) Order 2000 (Amendment No.20) Order 2012

The County of Wiltshire (Various Roads, Bemerton Heath, Salisbury) (Prohibition of Waiting) Order 2001

The County of Wiltshire (Various Orders) (In the District of Salisbury) (Decriminalised Parking) (Amendment) Order 2001

The County of Wiltshire (A36 Trunk Road in the District of Salisbury) (Decriminalised Parking) (Amendment) Order 2001

The County of Wiltshire (Central Salisbury) (Pay and Display Street Parking Places) Order 2004

The County of Wiltshire (Central Salisbury) (Pay and Display Street Parking Places) Order 2004 (Amendment No. 1) Order 2007

The County of Wiltshire (Central Salisbury) (Pay and Display Street Parking Places) Order 2004 (Amendment No. 2) Order 2010

The County of Wiltshire (Central Salisbury) (Pay and Display Street Parking Places) Order 2004 (Amendment No. 3) Order 2010

The County of Wiltshire (Central Salisbury) (Street Parking Places) Order 2004

The County of Wiltshire (Central Salisbury) (Street Parking Places) Order 2004 (Amendment No. 1) Order 2010

The County of Wiltshire (Central Salisbury) (Street Parking Places) Order 2004 (Amendment No. 2) Order 2010

The County of Wiltshire (Central Salisbury) (Loading Bay Areas) Order 2004

The County of Wiltshire (Central Salisbury) (Loading Bay Areas) Order 2004 (Amendment No. 1) Order 2007

The County of Wiltshire (Central Salisbury) (Loading Bay Areas) Order 2004 (Amendment No. 2) Order 2010

The County of Wiltshire (Central Salisbury) (Loading Bay Areas) Order 2004 (Amendment No. 3) Order 2010

The County of Wiltshire (Central Salisbury) (Prohibition and Restriction of Waiting, Loading and Unloading) Order 2004

The County of Wiltshire (Central Salisbury) (Prohibition and Restriction of Waiting, Loading and Unloading) Order 2004 (Amendment No. 1) Order 2010

The County of Wiltshire (Central Salisbury) (Prohibition and Restriction of Waiting, Loading and Unloading) Order 2004 (Amendment No. 2) Order 2010

The County of Wiltshire (Central Salisbury) (Taxi Rank Clearways) Order 2004

The County of Wiltshire (Central Salisbury) (Taxi Rank Clearways) Order 2004 (Amendment No. 1) Order 2010

The County of Wiltshire (Central Salisbury) (Pedestrianised Areas) (Prohibition of Waiting, Loading and Unloading) Order 2004

The County of Wiltshire (Brick Lane, Salisbury) (Prohibition of Waiting) Order 2005

The County of Wiltshire (Salisbury) (Residents Parking) (Amendment) Order 2006

The County of Wiltshire (District of Salisbury) (Civil Parking Enforcement) Amendment Order 2008

The County of Wiltshire (Norfolk Road, Salisbury) (Street Parking Places) Order 2008

Wiltshire County Council (Salisbury – Zone B) (Waiting Restriction and Residents' Parking Bay) Order 1997
Wiltshire County Council (Salisbury – Zone B) (Waiting Restrictions and Residents' Parking Bay) Order 1997 (Amendment No. 1) Order 2000
Wiltshire County Council (Salisbury – Zone B) (Waiting Restrictions and Residents' Parking Bay) Order 1997 (Amendment No. 2) Order 2001
Wiltshire County Council (Salisbury – Zone B) (Waiting Restrictions and Residents' Parking Bay) Order 1997 (Amendment No. 3) Order 2002
Wiltshire County Council (Salisbury – Zone B) (Waiting Restrictions and Residents' Parking Bay) Order 1997 (Amendment No. 4) Order 2004
The County of Wiltshire (Salisbury – Zone C – Milford) (Residents Parking Places) Order 2009
The County of Wiltshire (Salisbury – Zone C – Milford) (Street Parking Places) Order 2009
The County of Wiltshire (Salisbury – Zone C – Milford) (Prohibition and Restriction of Waiting) Order 2009
The County of Wiltshire (Salisbury – Zone D) (Prohibition and Restriction of Waiting, Loading and Unloading) Order 2006
The County of Wiltshire (Salisbury – Zone D) (Prohibition and Restriction of Waiting, Loading and Unloading) Order 2006 (Amendment No. 1) Order 2006
The County of Wiltshire (Salisbury – Zone D) (Street Parking Places) Order 2006
The County of Wiltshire (Salisbury – Zone D) (Street Parking Places) Order 2006 (Amendment No. 1) Order 2006
The County of Wiltshire (Salisbury – Zone D) (Loading Bay Areas) Order 2006
The County of Wiltshire (Salisbury – Zone D) (Loading Bay Areas) Order 2006 (Amendment No. 1) Order 2006
The County of Wiltshire (Salisbury – Zone D) (Residents' Parking Places) Order 2006
The County of Wiltshire (Salisbury – Zone D) (Residents' Parking Places) Order 2006 (Amendment No. 1) Order 2006
The County of Wiltshire (Salisbury – Zone E) (Residents' Parking Places) Order 2004
The County of Wiltshire (Salisbury – Zone E) (Residents' Parking Places) Order 2004 (Amendment No. 1) Order 2011
The County of Wiltshire (Salisbury – Zone E) (Prohibition and Restriction of Waiting, Loading and Unloading) Order 2004
The County of Wiltshire (Salisbury – Zone E) (Prohibition and Restriction of Waiting, Loading and Unloading) Order 2004 (Amendment No. 1) Order 2011
The County of Wiltshire (Salisbury – Zone E) (Disabled Persons' Street Parking Places) Order 2004
The County of Wiltshire (Salisbury – Zone E) (Loading Bay Areas) Order 2004
The County of Wiltshire (Salisbury – Zone E) (Loading Bay Areas) Order 2004 (Amendment No. 1) Order 2011
The County of Wiltshire (Salisbury – Zone F – The Friary) (Waiting Restrictions, Street Parking Places and Residents' Parking Places) Order 2004
The County of Wiltshire (Salisbury – Zone G – Harnham) (Prohibition and Restriction of Waiting) Order 2008
The County of Wiltshire (Salisbury – Zone G – Harnham) (Prohibition and Restriction of Waiting) Order 2008 (Amendment No. 1) Order 2011
The County of Wiltshire (Salisbury – Zone G – Harnham) (Prohibition and Restriction of Waiting) Order 2008 (Amendment No. 2) Order 2012
The County of Wiltshire (Salisbury – Zone G – Harnham) (Street Parking Places) Order 2008
The County of Wiltshire (Salisbury – Zone G – Harnham) (Street Parking Places) Order 2008 (Amendment No. 1) Order 2012

The County of Wiltshire (Salisbury – Zone G – Harnham) (Residents Parking Places) Order 2008
The County of Wiltshire (Salisbury – Zone G – Harnham) (Residents Parking Places) Order 2008 (Amendment No. 1) Order 2011
The County of Wiltshire (Salisbury – Zone H) (Residents' Parking Places) Order 2009
The County of Wiltshire (Salisbury – Zone H) (Prohibition and Restriction of Waiting) Order 2009
The County of Wiltshire (Salisbury – Zone I – De Vaux Place) (Residents' Parking Places) (Controlled Parking Zone) Order 2003(a)
The County of Wiltshire (Various Roads, Bemerton Heath, Salisbury) (Bus Stop Clearways) Order 2001
The County of Wiltshire (Castle Road and Stratford Road, Salisbury) (Bus Stop Clearways) Order 2000

Interpretation

3(1) In this Order, except where the context otherwise requires, the following expressions have the meanings hereby respectively assigned to them:-

“bus” has the meaning defined in Regulation 22 of the Traffic Signs Regulations and General Directions 2002;

“Civil Enforcement Officer” has the meaning defined in Article 76(1) of the Act of 2004

“delivering” and “collecting” in relation to any goods includes checking the goods for the purpose of their delivery or collection

"disabled persons vehicle" means a vehicle lawfully displaying a disabled persons badge

“disabled persons badge” means a badge issued by a local authority in the form prescribed by Regulations 7 and 11 of the Disabled Persons (Badges for Motor Vehicles) (England) Regulations 2000

“disabled persons bay” means a road or length of road designated for the leaving of vehicles as indicated by appropriate road markings designating that bay as reserved for disabled blue badge holders

"driver" in relation to a vehicle waiting in a parking place or on a road or length of road, means the person driving the vehicle at the time it was left in that parking place or road or length of road

“dual purpose vehicle” has the meaning defined in Regulation 3 of the Road Vehicles (Construction and Use) Regulations 1986

“goods” includes postal packets of any description

“goods vehicle” has the meaning defined in the Traffic Signs Regulations and General Directions 2002

“hackney carriage” means a vehicle licensed under Section 37 of the Town Police Clauses Act 1847, or Section 6 of the Metropolitan Public Carriage Act 1869(b) or under any similar enactment

“invalid carriage” and “passenger vehicles” have the same meaning as defined in Section 136 of the Act

“lay-by” in relation to a main carriageway, means any area intended for the use of waiting of vehicles at the side of the main carriageway

“light goods vehicle” means a motor vehicle which is constructed or adapted for use for the carriage of goods or burden of any description and which has a gross vehicle weight not exceeding 2 tonnes and is not more than 6 metres in length and is not drawing a trailer

“loading bay area” means the part of a road authorised by this Order to be used as a loading and unloading only area and indicated by sign diagram number 660.4 as defined in Schedule 2 of the Traffic Signs Regulations and General Directions 2002

“main carriageway” means any carriageway of a road used primarily by through traffic and excludes any lay-by

“medical practitioner” means a fully registered medical practitioner within the meaning of the Medical Act 1983

“Medical Practitioner’s Parking Permit” means a permit bearing the words “Medical Practitioner” (and includes the name and address of the surgery) issued by Wiltshire Council or its agent to a Medical Practitioner for use in a designated Doctor parking bay identified on the plans attached to this Order

“motor cycle” and “invalid carriage” and “passenger vehicle” have the same meaning as defined in Section 136 of the Act of 1984

“owner” in relation to a vehicle means the person by whom such vehicles is kept and used

“parking place” means a road or length of road designated for the leaving of vehicles as indicated by appropriate road markings

“parking bay” means an area contained within a parking place as indicated by the appropriate road markings

“parking disc” has the same meaning as provided in the Local Authorities’ Traffic Orders (Exemptions for Disabled Persons) (England) Regulations 2000

“permit” means a formal document issued by Wiltshire Council to either a resident, business or visitor of the relevant Zone to exempt a vehicle from waiting where a restriction applies or from a time limit under the Terms and Conditions applicable at the time of issue

“permitted hours” means the hours identified for permitted parking (including parking in a resident permit holders bay, disabled parking bay or in a loading bay area) on the plans attached to this Order but excluding any such day that is Christmas Day, Good Friday or a Bank Holiday not being a Public Holiday

“public service vehicle” has the meaning defined in Section 1 of the Public Passenger Vehicles Act 1981

“registered local service” has the meaning defined in Sections 2 and 6 of the Transport Act 1985;

"relevant position" means:-

- (a) A vehicle displays a disabled persons badge, permit, or ticket issued in accordance with this Order in the relevant position if:
 - (i) it is exhibited in or on the front windscreen, on the dashboard or fascia of the vehicle; or
 - (ii) where the vehicle is not fitted with a dashboard or fascia, the badge, permit or ticket is exhibited in a conspicuous position at the front of the vehicle

so that the front of the badge, permit or ticket (showing any Serial numbers, time, date and expiry or purchase details) is clearly legible from the front of the outside of the vehicle

- (b) A vehicle displays a parking disc in the relevant position if:
 - (i) the disc is exhibited on the dashboard or fascia of the vehicle; or
 - (ii) where the vehicle does not have a dashboard or fascia, the disc is exhibited in a conspicuous position on the vehicle

so that, when marked to show the quarter-hour period during which a period of waiting began, that period is clearly legible from the outside of the vehicle.

"resident" means a person whose residence is at premises the postal address of which is in any street or part of a street described in Part X of this Order

"taxi" has the same meaning given by Regulation 4 of the Traffic Signs Regulations and General Directions 2002 and "taxi rank" means an area of carriageway reserved for use by taxis waiting to pick up passengers

"telecommunications apparatus" has the same meaning as in Schedule 2 of the Telecommunications Act 1984

"the Council" shall mean the authority known as Wiltshire Council

"ticket machine" means apparatus of a type and design approved in accordance with Section 35(3) of the Act of 1984, being apparatus designed to issue parking tickets indicating the payment of a charge, the date and either the time at which the charge was paid or the time at which the initial period expires

"tourist bus area" means any area of carriageway of a specified road, intended for the waiting of a bus not operating a registered local service which is comprised within and indicated by a road marking complying with diagram 1028.3 in Schedule 6 to the Traffic Signs and General Directions 2002

"traffic sign" means a sign of any size, colour and type prescribed or authorised under, or having effect as though prescribed or authorised under Section 64 of the Act of 1984

"waiver" means a short term formal document issued by Wiltshire Council to exempt a vehicle from a restriction under the terms and charges applicable at the time of issue

- (2) Where reference is made to The County of Wiltshire (Salisbury) (Prohibition and Restriction of Waiting, Taxi Rank Clearways and On Street Parking) Consolidation Order” in the map schedules to this Order, this shall mean The County of Wiltshire (Salisbury) (Prohibition and Restriction of Waiting, Taxi Rank Clearways and On Street Parking) Consolidation Order 2011.
- (3) For the purpose of this Order the prohibitions and restrictions contained in the Articles to this Order and shown on the attached plans shall apply to the full extent of the public highway, with the exception of Clearways which apply to the extent of the carriageway.
- (4) For the purpose of this Order a vehicle shall be taken as waiting on a length of road if any point on that length of road is below the vehicle or its load (if any).
- (5) The prohibitions imposed by this Order shall be in addition to and not in derogation of any restriction, prohibition or requirement imposed by any Regulations or Orders made or having effect as if made under the Act of 1984, or by or under any other enactment.
- (6) Insofar as any provision of this Order conflicts with the effect of markings placed on the carriageway, as specified under Regulation 29(1) of The Traffic Signs Regulations and General Directions 2002 (“TSRGD”) conveying the existence of a ‘bus stop/clearway’ as defined by Part 1 of Schedule 19 of TSRGD then the effect of those markings and the existence of that bus stop/clearway shall prevail.
- (7) For the purposes of this Order, Wiltshire Council accepts no responsibility for any inaccuracies contained in the Ordnance Survey data relied upon in the preparation of the plans attached to this Order. Where a restriction applies to the edge of a length of carriageway or highway (adjacent to the kerb) that restriction will continue to apply to the actual edge of carriageway or highway irrespective of changes to either the carriageway width or to the underlying Ordnance Survey data.

PART II

GENERAL PROVISIONS RELATING TO WAITING, LOADING AND TAXI RANK CLEARWAY RESTRICTIONS

4. Save as provided in Articles 8, 9, 10, 11, 12 and 13 of this Order no person shall, except upon the direction or with the permission of a Police Constable in uniform or of a Civil Enforcement Officer cause or permit any vehicle (and/or drawn trailer) to wait on the roads or sides of the roads subject to restrictions identified as No Waiting during a specified time limit, for the periods identified on the plans attached to this Order.
5. Save as provided in Articles 8 and 9 of this Order no person shall, except upon the direction or with the permission of a Police Constable in uniform or of a Civil Enforcement Officer cause or permit any vehicle to load or unload in the roads or sides of the roads identified as No Loading, and for the periods identified on the plans attached to this Order.
6. Save as provided in Articles 8(c), 8(d), 8(f) and 8(g) of this Order, no person shall, except upon the direction or with the permission of a Police Constable in uniform or of a Civil Enforcement Officer cause or permit a vehicle, other than

a taxi to stop or wait in a taxi rank area in the roads or sides of the roads identified as No Stopping Except Taxis for the periods identified on the plans attached to this Order.

7. Save as provided in Articles 8(c), 8(d), 8(f) and 8(g) to this Order, no person shall, except upon the direction or with the permission of a Police Constable in uniform or of a Civil Enforcement Officer cause or permit any vehicle, other than a bus not operating as a registered local service to stop or wait in a tourist bus area in the roads or sides of the roads identified as a Bus Parking for the periods identified on the plans attached to this Order.
8. Nothing in Articles 4, 5, 6 and 7 of this Order shall render it unlawful to cause or permit any vehicle to wait in any of the roads, lengths of road or on the sides of road identified in the plans attached to this Order for so long as may be necessary to enable:
 - (a) a person to board or alight from the vehicle;
 - (b) goods to be loaded onto or unloaded from the vehicle provided that loading is carried out in one continuous operation and that no vehicle shall so wait on any of the lengths of road identified on the plans attached to this Order where loading and unloading is prohibited on such days and times so identified on the aforementioned plans;
 - (c) the vehicle, if it cannot conveniently be used for such purpose in any other road, to be used for the purpose of any building operation, demolition or excavation, or the maintenance or improvement or reconstruction of the said lengths or sides of road or any works connected with any sewer, main, pipe or apparatus for the supply of gas, water or electricity or of any telecommunications apparatus;
 - (d) the vehicle, if it cannot conveniently be used for such purpose in any other road, to be used in the service of the local authority in pursuance of statutory powers or duties;
 - (e) the vehicle of a universal service provider (as defined in Section 4(3) and (4) of the Postal Services Act 2000) to be used for the purpose of delivering and/or collecting mail;
 - (f) the vehicle to be used in the service of the Police, Fire & Rescue Service or Ambulance Service;
 - (g) the vehicle to be used in any case where the person in control of the vehicle:
 - (i) is required by law to stop or wait or is permitted to stop or wait by a Police Officer in uniform;
 - (ii) is obliged to stop so as to prevent an accident; or
 - (iii) is prevented from proceeding by circumstances outside his control;
 - (h) the vehicle to be loaded or unloaded whilst it is in actual use in connection with the removal of furniture and effects from one office or dwelling house to another or to such premises from a depository or from such premises to a depository notwithstanding anything contained in paragraph (b) above as to waiting in the roads or sides of

the roads identified and for the periods identified on the plans attached to this Order;

- (i) a security vehicle to be used in the course of delivering or collecting cash to/from properties in any of the lengths of road identified on the plans attached to this Order and being a vehicle specifically designed for that purpose.
9. Nothing in Articles 4 and 5 of this Order shall apply to any vehicle:
- (a) being used as part of a wedding or funeral cortege or otherwise in connection with a wedding or funeral; or
 - (b) being licensed as a hackney carriage whilst waiting at a duly authorised taxi rank as marked on the carriageway.
10. Nothing in Article 4 of this Order shall render it unlawful to cause or permit a disabled persons vehicle which displays in the relevant position a disabled persons badge and a parking disc (on which the driver, or other person in charge of the vehicle, has marked the time at which the period of waiting began) to wait in any of the lengths of road referred to in those Articles for a period not exceeding three hours (not being a period separated by an interval of less than one hour from a previous period of waiting by the same vehicle in the same length of road).
11. Nothing in Article 4 of this Order shall prevent any person from causing or permitting any vehicle to wait in any of the lengths of road referred to in that Article provided permission has been obtained from Wiltshire Council by means of a waiver to be displayed in the front or nearside of the vehicle and which includes information to enable the driver to be contacted in an emergency and providing that an obstruction is not caused by so doing and that the vehicle is moved if the driver is requested to do so by a Police Officer in uniform or Civil Enforcement Officer.
12. Nothing in Article 4 of this Order shall render it unlawful for a taxi to stop or wait in any of the lengths of road identified as No Waiting Except Taxis on the plans attached to this Order.
13. Nothing in Article 4 of this Order shall render it unlawful for a bus to stop or wait in any of the lengths of road identified as Bus Parking on the plans attached to this Orders.

PART III

GENERAL PROVISIONS RELATING TO THE USE OF ON-STREET PARKING PLACES (INCLUDING PAY AND DISPLAY BAYS), PARKING PLACES FOR RESIDENT PERMIT HOLDERS, LOADING BAY AREAS AND DOCTORS BAYS

14. The parts of the roads identified as Parking places on the plans attached to this Order are authorised to be used, subject to the following provisions of this Order by the class of vehicle specified, if none specified then all classes of vehicle, on such days and during such permitted hours as identified on the plans attached to this Order and in such positions as indicated by the appropriate road markings. The parts of the roads identified as Parking places for resident permit holders on the plans attached to this order shall be used in accordance with Articles 28, 29, 30, 31 and 32 of this Order. Parking

places shall operate at all times unless otherwise specified in the Articles to this Order

15.
 - (1) Nothing in Article 14 of this Order shall restrict the power of the Council, for preventing obstruction of the streets, by order on the occasion of any public markets or fairs or of any public procession, rejoicing or illumination, or where the streets are thronged or liable to be obstructed, to close any parking places or part thereof;
 - (2) Nothing in Article 14 of this Order shall prevent the Council, by notice displayed at any parking place:
 - (a) from closing that parking place or any part thereof for any period while any works are being executed therein or adjacent thereto or whilst that parking place or any part thereof is required for use for some special purpose;
 - (b) from setting aside for use only by specially authorised vehicles of any part(s) of that parking place on all days or on certain days or during certain parts of certain days.
16. Nothing in Article 14 of this Order shall apply so as to prevent any person from causing any vehicle to wait in the parking place specified in that Article if the vehicle is being used in connection with the provisions contained within Article 8(c), (d) and (f) of this Order.
17. Where in the roads or sides of the roads identified on the plans attached to this Order a parking place is described as available for vehicles of a specified class, a specified position, or a specified day, the driver of a vehicle shall not permit it to wait in that parking place:
 - (a) unless it is of the specified class appropriate to that parking place and that specified day; and
 - (b) otherwise than wholly within the limits of a parking bay marked out in that parking place as indicated by white line carriageway markings, provided that no vehicle may wait in any part of a parking place which is an access way.
18.
 - (1) Except as provided in Article 21 and 43 the driver of a vehicle shall not permit it to wait in a parking place for longer than the maximum period permitted for waiting specified in relation to that parking place and as identified on the plans attached to this Order; and
 - (2) When a vehicle has left a parking place after waiting thereon, the driver thereof shall not within the period specified in relation to that parking place and as identified on the plans attached to this Order after its leaving permit it to wait again upon that parking place.
19. The driver of a vehicle drawing a trailer shall not permit the vehicle or the trailer to wait in a parking place unless they have been disconnected and for the purpose of this Order the vehicle and the trailer shall be deemed to be separate vehicles and the driver shall be deemed to be the driver of each of the said vehicles.

20. The driver of a vehicle shall not permit the vehicle to wait in a parking place so as unreasonably to prevent access to any premises adjoining the road, or the use of the road by other persons, or so as to be a nuisance.
21. The driver of a vehicle being an invalid carriage, or a disabled persons vehicle which displays in the relevant position a disabled persons badge, shall be exempt from any limitation on time when left in a parking place (not being a designated disabled parking bay, Doctors bay or loading bay area) identified on the plans attached to this Order.
22. The driver of a vehicle displaying at its front or nearside a valid waiver issued by Wiltshire Council shall be exempt from any limitation of time in the lengths of road or on any of the sides of road identified as Parking places identified on the plans attached to this Order when left in a parking place.
23. Notwithstanding the foregoing provisions of this part of the Order, any vehicle may wait during the permitted hours in a parking place (other than a parking place or part thereof the use of which has been suspended under Article 21 of this Order) for so long as may be necessary if:-
 - (a) the vehicle is a vehicle used for Police, Fire & Rescue Service or Ambulance purposes, or a vehicle (other than a passenger vehicle) in the service of a local authority or its agent which is being used in pursuance of statutory powers or duties to maintain the highway;
 - (b) the vehicle (not being a passenger vehicle) is waiting to enable it to be used for the purpose of any building operation, demolition or excavation in or adjacent to the parking place or the maintenance or improvement of the parking place or any works connected with any sewer, main, pipe or apparatus for the supply of gas, water or electricity or of any telecommunications apparatus;
 - (c) the vehicle (not being a passenger vehicle) is in actual use in connection with the removal of furniture from one business or dwelling house to another or the removal of furniture from such premises to a depository or to such premises from a depository.

Power to Suspend Use of Parking Places

24. (1) Any person authorised by the Council may suspend the use of a parking place or any part thereof whenever the Council considers such suspension reasonably necessary:-
 - (a) for the purpose of facilitating the movement of traffic or promoting its safety;
 - (b) for any purposes specified in Articles 15 and 23(b) of this Order; or
 - (c) for the convenience of occupiers of premises adjacent to the parking place at times of weddings or funerals, or on other special occasions.

- (2) A Police Officer in uniform may suspend for not longer than twenty-four hours the use of a parking place or any part thereof whenever he considers such suspension reasonably necessary for the purpose of facilitating the movement of traffic or promoting its safety.
 - (3) Any person suspending the use of a parking place or any part thereof in accordance with the provisions of paragraph (1) or paragraph (2) of this Article shall thereupon:-
 - (a) place or cause to be placed in or adjacent to that parking place or the part thereof the use of which is suspended, a traffic sign indicating that waiting by vehicles is prohibited;
 - (b) for the purpose of delivering or collecting postal packets as defined in Section 87 of the Post Office Act 1953; or
 - (c) in the case of Pay & Display parking places within which the use of all the parking bays relating to one ticket machine have been suspended, place over the ticket machine(s) a hood or other cover indicating that use of the parking bay(s) is suspended and waiting by vehicles is prohibited.
 - (4) No person shall cause or permit a vehicle to be left in any part of a parking place during such period as either there is in or adjacent to that part of a parking place a traffic sign placed in pursuance of paragraph (3)(a) of this Article, or there is a hood or cover indicating that the use of the parking place is suspended in pursuance of paragraph (3)(c) of this Article.
25. Provided that nothing in Article 24(1) of this Order shall render it unlawful to cause or permit a vehicle to be left in a parking place if it is being used:
- (a) for the Fire & Rescue Service, ambulance or Police purposes or in the service of a local authority or its agents in pursuance of its statutory powers and duties to maintain the highway;
 - (b) or if the vehicle is left with the permission of the person suspending the use of the parking place or part thereof in pursuance of Article 21(1) of this Order, a Police Constable in uniform or of a person authorised in that behalf by the Council.
26. Subject to the proviso hereto, when a vehicle is left in a parking place in contravention of any of the provisions contained in Articles 17, 18, 24(4) and 34 of this Order, a person authorised in that behalf by the Council may remove the vehicle or arrange for it to be removed from that parking place provided that when a vehicle is waiting in the parking place in contravention of the provisions of Article 17(b) of this Order, a person authorised in that behalf by the Council may alter or cause to be altered the position of the vehicle in order that its position shall comply with that provision.
27. Any person removing a vehicle or altering its position by virtue of the last preceding Article of this Order may do so by towing or driving the vehicle or in such other manner as he may think necessary to enable him to remove it as aforesaid and may take such measures in relation to the vehicle as necessary to enable the vehicle to be removed or to alter the position of the vehicle as the case may be and shall make such arrangements as may be reasonably necessary for the safe custody of the vehicle.

PART IV

PROVISIONS RELATING TO PARKING PLACES FOR RESIDENT PERMIT HOLDERS

28. The parts of the roads identified on the plans attached to this Order as Parking places for resident permit holders, are authorised to be used, subject to the provisions of this Order, as parking places for use by holders of resident parking permits in accordance with the Wiltshire Council Residents' Parking Schemes Terms and Conditions for Salisbury on such days and during such permitted hours as specified in relation to those parking places and in such positions as indicated by the appropriate road signs.
29. Any resident whose postal address is in a street or part of a street described in Part X of this Order eligible to apply for a permit within the Wiltshire Council Residents' Parking Schemes Terms and Conditions for Salisbury or any visitor eligible to apply for a waiver to exempt a vehicle from waiting where a restriction applies or from a time limit may do so by Application to Wiltshire Council under the aforementioned terms and conditions applicable at the time of application.
30. At all times during which a vehicle is left in a parking place identified for use by resident permit holders during the permitted hours there shall be displayed in the relevant position a valid permit or waiver issued in respect of that vehicle by Wiltshire Council so that all the particulars specified by Wiltshire Council are clearly visible from the front or near-side of the vehicle.
31. The driver of a vehicle displaying at its front or nearside a valid permit issued by Wiltshire Council shall be exempt from any limitation on time in the lengths of road or on any of the sides of road identified as Parking places for Resident Permit holders on the plans attached to this Order.
32. Where a permit or waiver has been displayed in a vehicle, in accordance with the provisions of Articles 22 and 30, no person not being the driver of the vehicle shall remove the permit or waiver from the vehicle unless authorised to do so by the driver of the vehicle.

PART V

LOADING BAY AREAS **PROVISIONS RELATING TO LOADING BAY AREAS**

33. (1) The parts of the roads identified on the plans attached to this Order as Loading are authorised to be used, subject to the following provisions of this Order, as loading bay areas for vehicles, in such positions and on such days and during such permitted hours as identified on the plans attached to this Order for the purpose of loading and unloading only.
- (2) Nothing in paragraph (1) of this Article shall apply so as to prevent any person from causing any vehicle to wait in the loading bay area specified in that paragraph if the vehicle is being used in connection with the provisions contained within Article 8(c), (d) and (f) of this Order.

34. The driver of a vehicle shall not permit it to wait in a loading bay area for longer than is necessary to enable goods to be loaded or unloaded from a vehicle.
35. Subject to the proviso hereto, when a vehicle is left in the loading bay area in contravention of the provision contained in Article 34 of this Order, a person authorised in that behalf by the Council may remove the vehicle or arrange for it to be removed from that loading bay area.

PART VI

PROVISIONS RELATING TO PAY & DISPLAY (P&D) PARKING PLACES

36. The parts of the road identified on the plans attached to this Order as P&D parking places are authorised to be used, subject to the provisions of this part of the Order, as Pay & Display parking places.
37.
 - (a) The P&D parking places identified on the plans attached to this Order are authorised to be used on such days and during such hours as identified on the plans attached to this Order and shall be subject to a charge of 20 pence for fifteen minutes stay, 60 pence for up to thirty minutes stay, 1 pound 10 pence for up to forty five minutes stay and 1 pound 70 pence for up to a one hour stay for a maximum stay of one hour.
 - (b) Payment of the charge shall be made:
 - a. by purchase of a parking ticket from a ticket machine at a parking place and such ticket shall be purchasable by the insertion into a ticket machine of the appropriate coins; or
 - b. by any other method of payment and indication of payment offered from time to time by the Council;
 - (c) The charge shall be payable on the leaving of the vehicle in a parking place identified as a P&D parking place on the plans attached to this Order.

Requirement to Exhibit Ticket

38. The driver of the vehicle shall exhibit the ticket issued by the P&D machine relating to the parking bay in which the vehicle is left. Such ticket to be displayed in the relevant position at all times.

Validity of Parking Ticket

39. The parking ticket shall be valid for a P&D parking place if and so long as the following conditions are satisfied:-
 - (a) The parking ticket is purchased immediately on the leaving of the vehicle at a P&D parking place;
 - (b) Where two or more tickets are purchased they are purchased by the insertion into the ticket machine of the appropriate number of coins immediately one after the other and the parking tickets thereby obtained are consecutively numbered;

- (c) The parking ticket is exhibited on the vehicle at all times in the relevant position on the vehicle as specified in Article 38 of this Order and in the case of a motorcycle having a sidecar attached in a conspicuous position on the vehicle in front of the driving seat and in all cases the ticket shall be exhibited on the vehicle so that the date and time shown on the front of the said ticket is clearly visible from the front of the vehicle;
- (d) The indication on the parking ticket are not that the period specified on the ticket has expired;
- (e) The indications are stipulated by any other payment method are not that the period specified has expired.

Indications by Ticket Machines and Parking Tickets as Evidence

- 40. (1) If at any time while a vehicle is left in a P&D parking place identified on the plans attached to this Order and no parking ticket is exhibited on that vehicle in accordance with the provisions of this Order it shall be presumed, unless the contrary is proved, that a charge has been incurred.
- (2) If at any time while a vehicle is left in a P&D parking place identified on the plans attached to this Order, the ticket machine clock and the parking ticket exhibited on the vehicle indicate that the period of exemption has expired it shall be presumed, unless the contrary is proved, the period of exemption has expired and that the charge has been incurred.

No Additional Coins or Other Means of Payment To Be Inserted After Payment of the Charge

- 41. No person shall insert in a ticket machine relating to any P&D parking place in which a vehicle is left, any additional payment by whatever means to the charge in respect of that vehicle to extend the stay.

Out of Order P&D Ticket Machines

- 42. If at any time during the charging hours a P&D ticket machine is out of order, a ticket shall be obtained from the nearest working P&D ticket machine.

Exemptions for Disabled Drivers

- 43. Nothing in Articles 37, 38, 39, 40, 41 and 42 of this Order shall apply to any vehicle left in a P&D parking place and identified on the plans attached to this Order if there is displayed on the vehicle in the relevant position a disabled persons badge.

Provided that

- (a) the vehicle is one in respect of which the badge has been issued; and
- (b) at the time the vehicle was left in the parking place it was being driven or used by the person or institution to whom the badge was issued; and

- (b) any period shown on the badge as being the period in respect of which it was issued shall not have expired at the time at which the vehicle is left in the parking place

PART VII

DESIGNATED PARKING PLACES FOR DISABLED PERSONS

- 44. (1) The parts of the roads identified as Disabled parking on the plans attached to this Order and therein designated 'Disabled badge holders only' may be used, subject to the provisions of this part of the Order, as parking places for disabled persons vehicles, in such positions and on such days and during such permitted hours as identified.
- (2) Where within a parking place, there is a sign or surface marking which indicates that a parking bay is available only for a disabled persons vehicle, the driver of a vehicle shall not permit it to wait in the parking bay unless the vehicle is a disabled persons vehicle.
- 45. The driver of a vehicle shall exhibit a parking disc on the vehicle in the relevant position and set the disc to indicate a quarter-hour period during which the vehicle arrived at the disabled persons bay.
- 46. (a) The driver of a vehicle shall not permit it to wait continuously in a disabled persons bay for longer than the maximum period permitted for waiting specified in relation to that parking place and as identified on the plans attached to this Order, such period being calculated as commencing from the later time indicated on the parking disc set in accordance with the provisions of Article 45 of this Order and when the vehicle has left that parking place after waiting therein shall not within the period specified in relation to that parking place and identified on the plans attached to this Order after its waiting return to that parking place.
- (b) Where a parking disc exhibited in pursuance of this Order on a vehicle waiting in a disabled persons bay is showing a quarter-hour period, the later time indicated by the disc showing the end of that period shall be treated as evidence that the vehicle has been waiting in that parking place since that later time.

No person shall:-

- 47. (a) After the parking disc exhibited on a vehicle has been set in accordance with Article 45 of this Order, alter the indications given by that parking disc whilst the said vehicle remains in the disabled persons bay; or
- (b) knowingly exhibit on any vehicle any parking disc which has been altered, defaced, mutilated or added to or upon which the figures or particulars have become illegible.
- (c) It shall be assumed, unless the contrary is shown, that the parking disc mentioned in Article 45 is an approved device.

PART VIII

PROVISIONS RELATING TO VIRTUAL PARKING PERMITS

48. Where in this Order there is a requirement or option to obtain a Parking Ticket, this requirement or option may be discharged by the obtaining of a Virtual Parking Permit, as an alternative to any method set out in this Order.
49. A Virtual Parking Permit may be obtained by any of the methods provided from time to time by the Council and to be valid must be registered on an account in an electronic database approved by the Council and an indication that payment has been made and the parking period for which payment has been made shall either;
- (a) appear on a hand-held device; or
 - (b) be obtained by a Civil Enforcement Officer contacting the service provider.
50. Without prejudice to the provisions of this Order, if at any time while a vehicle is left in a parking place there is no indication as set out in Article 38 to this Order that payment of the charge for a Parking Ticket has been made using the Virtual Parking Permit system, or there is an indication that the parking period for which payment was made has expired, it shall be presumed, unless the contrary is proved, that either;
- (a) the charge for the Parking Ticket has not been duly paid in respect of that vehicle; or
 - (b) the parking period for which payment was made had already expired.
51. Where a Virtual Parking Permit has been obtained as an alternative to a Parking Ticket and remains valid, any requirement in this Order for the Parking Ticket to be display on the vehicles to which it relates shall not apply.
52. Any other provisions in this Order relating to the validity of a Parking Ticket shall expect where the context otherwise provides apply to a Virtual Parking Ticket.

PART IX

CONTRAVENTION OF RESTRICTIONS

53. Where a vehicle has been left in contravention of the restrictions imposed by this Order, a Penalty Charge shall be incurred, the amount of which will be set by Wiltshire Council under the provisions of the Act of 2004 relating to the Civil Enforcement Areas and Special Enforcement Areas.
54. Where a Penalty Charge is payable, a Penalty Charge Notice shall be issued by a Civil Enforcement Officer in accordance with the Act of 2004.

Manner of Payment of Penalty Charge Notice

55. The Penalty Charge shall be paid within 28 days payable to Wiltshire Council under the terms referred to in the said Notice.

Restriction on Removal of Penalty Charge Notice

56. Where a notice has been attached to a vehicle in accordance with the provisions of the Act of 2004, no person not being the driver of the vehicle or duly authorised representative of the Council shall remove the notice from the vehicle unless authorised to do so by the driver.

PART X

Streets or Parts of Streets in Salisbury
For the Purpose of the Issue of Permits (Subject to Eligibility)

Zone A

Albany Road, Belle Vue Road, Castle Street, College Street, Endless Street (Nos. 39-76 inclusive), Estcourt Road, Hamilton Road, Helena Terrace, King's Road, Marlborough Road, Nelson Road, Park Street, Queens Road, School Lane, St. Mark's Road, Swaynes Close, Woodstock Road, Wyndham Road and Wyndham Terrace

Zone B

Bridge Street, Churchfields Road (inc. Nadder Terrace), Crane Bridge Road (South Western Side Only), Crane Street, Dews Road (inc. Clifton Row), East Street, Fisherton Street (Nos. 1-113) (Nos. 16-144), Harcourt Terrace, High Street (Nos. 37-51) (Nos. 52-64), Jubilee Court, Mill Road, North Street, Rectory Road, Sandown Place, South Street, South Western Road, Sovereign Court, St. Clements Mews, St. Thomas's Square, Water Lane and West Street.

Zone C

Bellamy Lane, Bourne Avenue, Byways Close, Clarendon Road, Courtwood Close, Elm Grove Avenue, Elm Grove Place, Elm Grove Road, Fairview Road, Farley Road, Fowlers Hill, Fowlers Road, Glenside Gardens, Kelsey Road, Laverstock Road, London Road (Nos.68-78), Manor Road, Marina Road, Methuen Drive, Milford Hill, Milford Hollow, Millbrook, Polden Road, Rougemont Close, Shady Bower, St. Margaret's Close, St. Martin's Terrace, The Avenue, The Beeches, The Sidings, The Sleepers, Tollgate Road, Wain-a-Long Road, Waterloo Road and Wessex Road.

Zone D

Ashley Road, Avon Terrace, Blackwell Mews, Charles Street, Clifton Road, Coldharbour Lane (Nos. 1-67 and 2-36), Devizes Road (Nos. 1-79 and 2-94), Fisherton Street (Nos. 139-169 and 146-148), Gas Lane, George Street, George Street (South), Hartington Road, Hawthorn Close, James Street, Lees Court, Marsh Lane, Meadow Road, Meadow Road (South), Merom Row, Middleton Road, Orchard Place, Prospect Place, Shakespeare Place, Sidney Street, Spire View, St Paul's Road, Station Terrace, The Hardings, Wilton Road (Nos. 1-47 and 10-28), Windsor Road, Windsor Street and York Road.

Zone E

Barnard Street, Bedwin Street, Bourne Hill, Brewery Lane, Brown Street, Catherine Court (off Catherine Street), Catherine Street, Chipper Lane, Culver Street, Dolphin Street, Endless Street (Nos. 1-37 and 2-22), Gigant Street, Greencroft Street, Green's Court, Guilder Lane, Hill View Road, Ivy Street, Love Lane, Milford Street, New Street, Payne's Hill, Pennyfarthing Street, Queens Street, Rampart Road,

Rollestone Street, Salt Lane, St. Ann Place, St. Ann Street, St. Edmund's Church Street, St. John's Street, St. Martin's Church Street, The Greencroft, Three Cuppes Lane, Trinity Street, Waverley Place and Winchester Street.

Zone F

Blackfriars Way (inc. Tintern Court), Carmelite Way, Exeter Street, Eyres Way, Friary Lane, Friar's Orchard, Greyfriars Close, The Friary and Whitefriars Road.

Zone G

Ayleswade Road, Britford Lane, Britford Lane West (unadopted), Burford Avenue, Burford Road, Butler Close, Chichester Close, Downton Road, Dryden Close, Harnham Road, Milton Pines (Nos. 1-11 and 10-18), Milton Road, New Bridge Road, Old Street (unadopted), Poole Close, St. Nicholas' Road (Nos. 1-11 and 10-18) and Swan Close.

Zone H

Bower Hill Road, Butts Road, Campbell Road, Castle Road (Nos. 18-72 and 25-61), Donaldson Road, Douglas Haig Road, Grange Gardens, Hulse Road, Moberly Road, Netheravon Road, Ridgeway Road, Somerset Road, St. Mark's Avenue, St. Mark's House, Tower Mews, The Ventry and Victoria Road.

Zone I

De Vaux Place (including De Vaux House) and St. Nicholas' Road (Nos. 2 – 8)

THE COMMON SEAL of
WILTSHIRE COUNCIL was
hereunto affixed this
29th day of January 2013
in the presence of:-

Wiltshire Council seal: 76835

WILTSHIRE COUNCIL**THE COUNTY OF WILTSHIRE (SALISBURY) (PROHIBITION AND RESTRICTION
OF WAITING, TAXI RANK CLEARWAYS AND ON STREET PARKING)
CONSOLIDATION ORDER 2013 (AMENDMENT NO.1) ORDER 2014**

The Council of the County of Wiltshire in exercise of its powers under Sections 1, 2, 4, 32, 35, 45, 46, 49, 51, 53 and Part IV of Schedule 9 of the Road Traffic Regulation Act 1984 (hereinafter referred to as "the Act of 1984") as amended and the Traffic Management Act 2004 (hereinafter referred to as "the Act of 2004") as amended and of all other enabling powers and after consultation with the Chief Officer of Police in accordance with Part III of Schedule 9 to the Act of 1984 hereby makes the following Order.

1. The County of Wiltshire (Salisbury) (Prohibition and Restriction of Waiting, Taxi Rank Clearways and On Street Parking) Consolidation Order 2013 shall be amended by the revocation of the Map Schedule specified in the First Schedule to this Order and the insertion of the Map Schedule specified in the Second Schedule to this Order.
2. The effect of the Order will be remove existing Parking Monday - Saturday 8am-6pm 2 hours No return within 4 hours Except Permit Holders Zone C and to introduce **No Waiting Monday - Saturday 8am-6pm** on the following length of road:

. **St Margarets Close** – at a point on the south western turning head
3. This Order shall come into operation on 3rd February 2014 and may be cited as The County of Wiltshire (Salisbury) (Prohibition and Restriction of Waiting, Taxi Rank Clearways and On Street Parking) Consolidation Order 2013 (Amendment No.1) Order 2014.

FIRST SCHEDULEMap Schedule to be revoked

Map Schedule	Date
IK84 (Zone C)	11/02/2013

SECOND SCHEDULEMap Schedule to be inserted

Map Schedule	Date
IK84 (Zone C)	03/02/2014

THE COMMON SEAL of
WILTSHIRE COUNCIL
was hereunto affixed this
21st day of January 2014
in the presence of: -

WILTSHIRE COUNCIL**THE COUNTY OF WILTSHIRE (SALISBURY) (PROHIBITION AND RESTRICTION
OF WAITING, TAXI RANK CLEARWAYS AND ON STREET PARKING)
CONSOLIDATION ORDER 2013 (AMENDMENT NO.2) ORDER 2014**

The Council of the County of Wiltshire in exercise of its powers under Sections 1, 2, 4, 32, 35, 45, 46, 49, 51, 53 and Part IV of Schedule 9 of the Road Traffic Regulation Act 1984 (hereinafter referred to as “the Act of 1984”) as amended and the Traffic Management Act 2004 (hereinafter referred to as “the Act of 2004”) as amended and of all other enabling powers and after consultation with the Chief Officer of Police in accordance with Part III of Schedule 9 to the Act of 1984 hereby makes the following Order.

1. The County of Wiltshire (Salisbury) (Prohibition and Restriction of Waiting, Taxi Rank Clearways and On Street Parking) Consolidation Order 2013 shall be amended by the revocation of the Map Schedules specified in the First Schedule to this Order and the insertion of the Map Schedules specified in the Second Schedule to this Order.
2. The effect of the Order will be :-
 - (a) to introduce a new zone to the consolidation order which will be known as Zone J
 - (b) to remove No waiting at any time on the following lengths of road;

Coldharbour Lane – both sides – from a point 10 metres north of its junction with Ashley Road to a point 21 metres north of the centre line of that junction

Kingsland Road – both sides – from a point 10 metres north east of its junction with Devizes Road to a point 22 metres north east of that junction
 - (c) to introduce **No waiting at any time** on the following lengths of road;

Ashfield Road – east side – from a point 14 metres south of its junction with Wilton Road to a point in line with the boundary between Nos. 28 and 29 Ashfield Road

Coldharbour Lane – west side – from its junction with Kingsland Road to appoint 10 metres south of that junction

Kensington Road – both sides – from its junction with Kingsland Road to a point 5 metres north-west of that junction

Kingsland Road – north west side – from a point 10 metres south west of its junction with Kensington Road to a point 10 metres north east of that junction; from a point 10 metres south west of its junction with Richmond Road to a point 10 metres north east of that junction; from a point 10 metres south west of its junction with Westminster Road to a point 10 metres north east of that junction.

Kingsland Road – south east – from its junction with Coldharbour Lane to a point in line with the boundary between Nos. 19 and 20 Kingsland Road

Richmond Road – both sides – from its junction with Kingsland Road to a point 5 metres north west of that junction

Richmond Road – Cul-de-sac – from a point in line with the north western boundary wall of No. 1 Richmond Road to a point 5 metres north

west of the boundary between the properties known as Amberley and Richmond Villa

Westminster Road – both sides – from its junction with Kingsland Road to a point 5 metres north west of that junction

Westminster Road – Cu-de-sac – from a point in line with the boundary between Nos. 10 and 12 Westminster Road to a point 1 metre south east of a point in line with the north western boundary wall of No. 15

Westminster Road – south west side – from a point in line with the boundary between the property known as Woodlynch and No. 4 Westminster Road to a point 7 metres north west of that boundary

- (d) to introduce **Resident Parking Mon-Sat 8am-6pm Zone J permit holders only** on the west side of **Ashfield Road** from a point 10 metres south of its junction with Wilton Road to a point 30 metres south of that junction; from a point 2 metres north of a point in line with the boundary between Nos. 4E and 5 Ashfield Road to a point in line with the boundary between Nos. 5 and 6 Ashfield Road; from a point 7 metres south of a point in line with the boundary between Nos. 5 and 6 Ashfield Road to a point in line with the northern side of Ashfield Road Railway Bridge

- (e) to introduce **No waiting Mon-Fri 8am – 6pm** on the following lengths of road;

Kingsland Road – north west side – from a point 10 metres north east of its junction with Westminster Road to its junction with Coldharbour Lane

Westminster Road – north east side – from a point 1 metre south east of a point in line with the north western boundary wall of No. 5 Westminster Road to point 1 metre south east of a point in line with the north western boundary wall of No. 15 Westminster Road

Westminster Road – south west side – from a point 5 metres north west of its junction with Kingsland Road to a point in line with the boundary between the property known as Woodlynch and No. 4 Westminster Road

These restrictions will replace any existing restrictions currently in force in the city of Salisbury.

3. The Consolidation Order shall be amended by: -
- (a) Removal from Article 37(a) of reference to 1 pound and 70 pence for up to a one hour stay for a maximum stay of one hour and replacement with 1 pound and 60 pence for up to a one hour stay for a maximum stay of one hour.
- (b) The inclusion of the following under 'PART X Streets or Parts of Streets in Salisbury For the Purpose of the Issue of Permits (Subject to Eligibility)';

'Zone J

Ashfield Road'

4. This Order shall come into operation on 2nd June 2014 and may be cited as The County of Wiltshire (Salisbury) (Prohibition and Restriction of Waiting, Taxi Rank Clearways and On Street Parking) Consolidation Order 2013 (Amendment No.2) Order 2014.

FIRST SCHEDULE**Map Schedule to be revoked**

Map Schedule	Date
IH81 (Outer Zone)	11/02/2013
IH82 (Outer Zone)	11/02/2013
IH82 (Zone D)	11/02/2013
II81 (Outer Zone)	11/02/2013
IJ81 (Outer Zone)	11/02/2013

SECOND SCHEDULE**Map Schedule to be inserted**

Map Schedule	Date
IH81 (Outer Zone)	02/06/2014
IH82 (Outer Zone)	02/06/2014
IH82 (Zone D)	02/06/2014
II81 (Zone J)	02/06/2014
II81 (Outer Zone)	02/06/2014
IJ81 (Zone J)	02/06/2014
IJ81 (Outer Zone)	02/06/2014

THE COMMON SEAL of
WILTSHIRE COUNCIL
was hereunto affixed this
20th day of May 2014
in the presence of: -

Wiltshire Council seal: 79573

WILTSHIRE COUNCIL**THE COUNTY OF WILTSHIRE (SALISBURY) (PROHIBITION AND RESTRICTION OF WAITING, TAXI RANK CLEARWAYS AND ON STREET PARKING) CONSOLIDATION ORDER 2013 (AMENDMENT NO.3) ORDER 2013**

The Council of the County of Wiltshire in exercise of its powers under Sections 1, 2, 4, 32, 35, 45, 46, 49, 51, 53 and Part IV of Schedule 9 of the Road Traffic Regulation Act 1984 (hereinafter referred to as “the Act of 1984”) as amended and the Traffic Management Act 2004 (hereinafter referred to as “the Act of 2004”) as amended and of all other enabling powers and after consultation with the Chief Officer of Police in accordance with Part III of Schedule 9 to the Act of 1984 hereby makes the following Order.

1. The County of Wiltshire (Salisbury) (Prohibition and Restriction of Waiting, Taxi Rank Clearways and On Street Parking) Consolidation Order 2013 shall be amended by the revocation of the Map Schedules specified in the First Schedule to this Order and the insertion of the Map Schedules specified in the Second Schedule to this Order.
2. The effect of the Order will be :-
 - (a) To remove the provisions for Pay and Display parking bays in Blue Boar Row.
 - (b) To reduce the length of No waiting at any time and the length of No loading at any time on the south side of Blue Boar Row between points 4 and 6 metres west of the eastern access to Market Place car park.
 - (c) To introduce **Disabled badge holders only at all times Mon, Wed-Fri 8am-6pm Tuesday and Saturday Midnight - 6am, 8am-3pm and 5pm - Midnight 3 hours No return within 3 hours** on the following lengths of road:-

Blue Boar Row – south side – from a point 2 metres west of the centre line of the western access to Market Place Car Park to a point 31 metres east of that centre line; and from a point 17 metres west of the centre line of the eastern access to Market Place car park to a point 24 metres west of that centre line.
 - (d) To introduce **Loading only 8am-6pm on Blue Boar Row** – south side – from a point 4 metres west of the eastern access to Mark Place car park to a point 17 metres west of that access
 - (e) To introduce **Loading only Tuesday and Saturday 6am-8am and 3pm-5pm on Blue Boar Row** – south side – from a point 2 metres west of the centre line of the western access to Market Place car park to a point 31 metres east of that centre line; and from a point 17 metres west of the centre line of the eastern access to Market Place car park to a point 24 metres west of that centre line
3. This Order shall come into operation on 30th September 2013 and may be cited as The County of Wiltshire (Salisbury) (Prohibition and Restriction of Waiting, Taxi Rank Clearways and On Street Parking) Consolidation Order 2013 (Amendment No.3) Order 2013.

FIRST SCHEDULE

Map Schedule to be revoked

Map Schedule	Date
IK83 (Central Zone)	08/04/2013

SECOND SCHEDULE

Map Schedule to be inserted

Map Schedule	Date
IK83 (Central Zone)	30/09/2013

THE COMMON SEAL of
WILTSHIRE COUNCIL
was hereunto affixed this
17th day of September 2013
in the presence of: -

Wiltshire Council seal: 78219

WILTSHIRE COUNCIL

**THE COUNTY OF WILTSHIRE (SALISBURY) (PROHIBITION AND RESTRICTION
OF WAITING, TAXI RANK CLEARWAYS AND ON STREET PARKING)
CONSOLIDATION ORDER 2013 (AMENDMENT NO.3) ORDER 2014**

The Council of the County of Wiltshire in exercise of its powers under Sections 1, 2, 4, 32, 35, 45, 46, 49, 51, 53 and Part IV of Schedule 9 of the Road Traffic Regulation Act 1984 (hereinafter referred to as “the Act of 1984”) as amended and the Traffic Management Act 2004 (hereinafter referred to as “the Act of 2004”) as amended and of all other enabling powers and after consultation with the Chief Officer of Police in accordance with Part III of Schedule 9 to the Act of 1984 hereby makes the following Order.

1. The County of Wiltshire (Salisbury) (Prohibition and Restriction of Waiting, Taxi Rank Clearways and On Street Parking) Consolidation Order 2013 shall be amended by the revocation of the Map Schedules specified in the First Schedule to this Order and the insertion of the Map Schedules specified in the Second Schedule to this Order.

2. The effect of the Order will be as follows: -

To introduce **Parking Mon-Sat 8am – 6pm 2 hours No return within 2 hours (except permit holders)** on various lengths of the following roads:
North side: Butts Road, Cornwall Road, Cornwall Road (Eastern Spur), Moberly Road and Ridgeway Road
North-east side: Donaldson Road, Hulse Road (north western), Moberly Road, Stratford Road, Victoria Road and Warwick Close
North-west side: Douglas Haig Road, Hulse Road (north western), Warwick Close, Wordsworth Road
East side: Cornwall Road, Hulse Road (south eastern), Moberly Road and Wordsworth Road
South side: Cambridge Road, Cornwall Road, Cornwall Road (Eastern Spur), Cornwall Road (Western Spur), Moberly Road and Ridgeway Road
South-eastern side: Donaldson Road, Douglas Haig Road, Warwick Close and Wordsworth Road
South-east side: Donaldson Road, Hulse Road (north western), Stratford Road and Victoria Road
South-west side and south-east side: Donaldson Road
West side: Cornwall Road, Hulse Road (south eastern), Moberly Road and Wordsworth Road

To introduce **Parking Mon-Sat 8am – 4pm 2 hours No return within 4 hours (except permit holders)** on the north, east, south and west sides of Devonshire Road

To introduce **No waiting at any time** on various lengths of the following roads:
Both sides: Cornwall Road (Eastern Spur), Hudson Road, Hulse Road (north western), Ridgeway Road, St. Mark’s Avenue, Stratford Road and Warwick Close
North side: Butts Road, Cambridge Road, Cornwall Road (Eastern Spur), Cornwall Road (Western Spur), Moberly Road and Somerset Road (Northern Spur)

North-east side: Donaldson Road, Hulse Road (north western), Stratford Road and Victoria Road
North and west sides: Devonshire Road
North-east and North-east sides: Donaldson Road and Warwick Close
North-east and South-east sides: Hulse Road (north western)
East side: Cornwall Road, Devonshire Road, Hulse Road (south eastern), St. Mark's Avenue and Somerset Road
East and North Side: Devonshire Road
East and South side: Cornwall Road
South side: Cambridge Road, Cornwall Road (Eastern Spur), Cornwall Road (Western Spur), Moberly Road and Somerset Road (Northern Spur)
South and West side: Cornwall Road and Moberly Road
South-east side: Donaldson Road
South-west side: Donaldson Road, Hulse Road (north western) and Stratford Road
South-east and South-west side: Warwick Close
West side: Devonshire Road, Hulse Road (south eastern), Moberly Road, St. Mark's Avenue and Somerset Road
West and South side: Devonshire Road
Cul-de-sacs: Hulse Road (south eastern), Victoria Road and Wordsworth Road

To introduce **No waiting Mon-Sat 8am – 6pm** on the north-east side and south-west side of Stratford Road

To introduce **No waiting Mon-Fri 10am – 11am** on various lengths of the following roads:

North side: Cambridge Road, Cornwall Road (Eastern Spur) and Cornwall Road (Western Spur)
North-west and north-east side: Warwick Close
East side: St. Mark's Avenue
South side: Cornwall Road
South and east side: Devonshire Road
Cul-de-sac: Warwick Close

To introduce **No waiting Mon-Fri 8am – 6pm** on lengths on the north side of Somerset Road (Northern Spur) and on the south side of Moberly Road and Somerset Road (Northern Spur)

These restrictions will replace any existing restrictions currently in force in the City of Salisbury.

3. The Consolidation Order shall be amended by the removal under 'PART X Streets or Parts of Streets in Salisbury for the Purpose of the Issue of Permits (Subject to Eligibility)' of the streets listed under 'Zone H' and replacement with the following;

'Zone H'

Bower Hill Road, Butts Road, Campbell Road, Castle Road (Nos. 25-91) (Nos. 18-72), Cornwall Road, Devonshire Road, Donaldson Road, Douglas Haig Road, Grange Gardens, Hulse Road, Moberly Road, Netheravon Road, Park Lane, Ridgeway Road, Somerset Road, St. Mark's Avenue, St. Mark's House, Stratford Road, The Ventry, Tower Mews, Victoria Road, Warwick Close and Wordsworth Road'

4. This Order shall come into operation on 3rd February 2014 and may be cited as The County of Wiltshire (Salisbury) (Prohibition and Restriction of Waiting, Taxi Rank Clearways and On Street Parking) Consolidation Order 2013 (Amendment No.3) Order 2014.

FIRST SCHEDULE

Map Schedule to be revoked

Map Schedule	Date
IF84 (Zone H)	11/02/2013
IG82 (Zone H)	11/02/2013
IG83 (Zone H)	11/02/2013
IG84 (Zone H)	11/02/2013
IH83 (Zone H)	11/02/2013
IH84 (Zone H)	11/02/2013
II84 (Zone H)	11/02/2013
IF82 (Outer Zone)	11/02/2013
IF83 (Outer Zone)	11/02/2013
IG83 (Outer Zone)	11/02/2013

SECOND SCHEDULE

Map Schedule to be inserted

Map Schedule	Date
IF82 (Zone H)	03/02/2014
IF83 (Zone H)	03/02/2014
IF84 (Zone H)	03/02/2014
IG82 (Zone H)	03/02/2014
IG83 (Zone H)	03/02/2014
IG84 (Zone H)	03/02/2014
IH83 (Zone H)	03/02/2014
IH84 (Zone H)	03/02/2014
II84 (Zone H)	03/02/2014
IF82 (Outer Zone)	03/02/2014
IF83 (Outer Zone)	03/02/2014
IG83 (Outer Zone)	03/02/2014

THE COMMON SEAL of
WILTSHIRE COUNCIL
was hereunto affixed this
23rd day of January 2014
in the presence of: -

Wiltshire Council seal: 78849

WILTSHIRE COUNCIL**THE COUNTY OF WILTSHIRE (SALISBURY) (PROHIBITION AND RESTRICTION OF WAITING, TAXI RANK CLEARWAYS AND ON STREET PARKING) CONSOLIDATION ORDER 2013 (AMENDMENT NO.4) ORDER 2013**

The Council of the County of Wiltshire in exercise of its powers under Sections 1, 2, 4, 32, 35, 45, 46, 49, 51, 53 and Part IV of Schedule 9 of the Road Traffic Regulation Act 1984 (hereinafter referred to as “the Act of 1984”) as amended and the Traffic Management Act 2004 (hereinafter referred to as “the Act of 2004”) as amended and of all other enabling powers and after consultation with the Chief Officer of Police in accordance with Part III of Schedule 9 to the Act of 1984 hereby makes the following Order.

1. The County of Wiltshire (Salisbury) (Prohibition and Restriction of Waiting, Taxi Rank Clearways and On Street Parking) Consolidation Order 2013 Experimental Order 2013 is hereby revoked.
2. The County of Wiltshire (Salisbury) (Prohibition and Restriction of Waiting, Taxi Rank Clearways and On Street Parking) Consolidation Order 2013 shall be amended by the revocation of the Map Schedules specified in the First Schedule to this Order and the insertion of the Map Schedules specified in the Second Schedule to this Order.
3. The effect of the Order will be: -
 - (a) To Introduce **Disabled parking Mon-Sat 8am-6pm 3 hours No return within 3 hours** as follows;
 - Milford Street** – south side – outside of Specsavers
 - Minster Street** – west side – for a length of 7 metres outside of Nos. 3-13 Minster Street
 - New Canal** – south side – for a length of 20 metres outside of Nos. 47-53 New Canal
 - Silver Street** – south side – for a length of 14 metres outside of the Boots premises
 - (b) To introduce **No waiting Sat 6pm – Midnight and Sun Midnight – 6am** to the existing Pay and Display parking bays on;
 - Milford Street** – north side – outside of Nos. 13-19 Milford Street
 - Milford Street** – south side – outside of Nos. 2-10 and 22-23 Milford Street
 - (c) To introduce **No waiting Sat 10pm – Midnight and Sun Midnight – 6am** to the existing Pay and Display parking bays on the north side of **Milford Street** outside of Nos. 25-35 Milford Street
 - (d) To introduce **No waiting Sat 6pm – Midnight and Sun Midnight – 6am** to the existing loading bays as follows;
 - Milford Street** – north side – outside of The Cathedral Hotel
 - Milford Street** – south side – outside of The Red Lion Hotel
 - (e) To introduce **No waiting at any time** and **No loading at any time** on the north side of **New Canal** outside of the Boots premises and the Burger King premises

- (f) To introduce **Loading only 8am – 6pm** on the south side of **New Canal** for a length of 15 metres outside of Nos. 53-57 New Canal
- (g) To extend the **No stopping at any time except taxis** on **Castle Street** for 16 metres in a southerly direction
- (h) To extend the existing **Disabled parking Mon-Sat 8am-6pm 3 hours No return within 3 hours** on the north side of **Winchester Street** by 7 metres at its eastern end

These restrictions will replace any existing restrictions currently in force in the city of Salisbury.

4. This Order shall come into operation on 18th November 2013 and may be cited as The County of Wiltshire (Salisbury) (Prohibition and Restriction of Waiting, Taxi Rank Clearways and On Street Parking) Consolidation Order 2013 (Amendment No.4) Order 2013.

FIRST SCHEDULE

Map Schedule to be revoked

Map Schedule	Date
IJ83 (Central Zone)	11/02/2013
IK83 (Central Zone)	11/02/2013
IK83 (Zone E)	11/02/2013
IK84 (Zone E)	11/02/2013

SECOND SCHEDULE

Map Schedule to be inserted

Map Schedule	Date
IJ83 (Central Zone)	18/11/2013
IK83 (Central Zone)	18/11/2013
IK83 (Zone E)	18/11/2013
IK84 (Zone E)	18/11/2013

THE COMMON SEAL of
WILTSHIRE COUNCIL
was hereunto affixed this
5th day of November 2013
in the presence of: -

Wiltshire Council seal: 78439

WILTSHIRE COUNCIL**THE COUNTY OF WILTSHIRE (SALISBURY) (PROHIBITION AND RESTRICTION OF WAITING, TAXI RANK CLEARWAYS AND ON STREET PARKING) CONSOLIDATION ORDER 2013 (AMENDMENT NO.5) ORDER 2015**

The Council of the County of Wiltshire in exercise of its powers under Sections 1, 2, 4, 32, 35, 53 and Part IV of Schedule 9 of the Road Traffic Regulation Act 1984 (hereinafter referred to as “the Act of 1984”) as amended and the Traffic Management Act 2004 (hereinafter referred to as “the Act of 2004”) as amended and of all other enabling powers and after consultation with the Chief Officer of Police in accordance with Part III of Schedule 9 to the Act of 1984 hereby makes the following Order.

1. The County of Wiltshire (Salisbury) (Prohibition and Restriction of Waiting, Taxi Rank Clearways and On Street Parking) Consolidation Order 2013 shall be amended by the revocation of the Map Schedules specified in the First Schedule to this Order and the insertion of the Map Schedules specified in the Second Schedule to this Order.

2. The effect of the Order will be:

(a) To introduce **No Waiting at any time** on the following lengths of roads:

Netherhampton Road – south side – from a point 6 metres east of a point in line with the boundary between property Nos. 73 & 75 Netherhampton Road to a point 7 metres west of a point in line with the boundary between property Nos. 75 & 77 Netherhampton Road

Parsonage Green – north side – from a point 27 metres west of its junction with Saxon Road to a point 10 metres west of its junction with the access to Wesley Court Car Park

Parsonage Green – south side – from its junction with Parsonage Green (Southern Spur) to a point 20 metres east of that junction

Parsonage Green (Southern Spur) – both sides – from its junction with Parsonage Green to a point 8 metres south of that junction

Wiltshire Road (Eastern Spur) – north side – from its junction with Wiltshire Road to a point 15 metres east of that junction

Wiltshire Road (Eastern Spur) – south side – from its junction with Wiltshire Road to its junction with Wiltshire Road (Slip Road)

Wiltshire Road – east side – from its junction with Wiltshire Road (Eastern Spur) to its junction with Wiltshire Road (Slip Road)

(b) To introduce **No Waiting Monday – Friday 8.15am-9.15am and 2.30pm-3.30pm** on the following lengths of roads:

Parsonage Green – north side – from a point 10 metres west of its junction with the access to Wesley Court Car Park to a point 40 metres west of that junction

Parsonage Green – north side – from a point in line with the boundary between property Nos. 10 & 11 Parsonage Green to its junction with Wiltshire Road

Parsonage Green – south side – from a point 21 metres west of its junction with Parsonage Green (Southern Spur) to a point in line with the boundary between property Nos. 9 & 10 Parsonage Green

3. This Order shall come into operation on 22nd June 2015 and may be cited as The County of Wiltshire (Salisbury) (Prohibition and Restriction of Waiting, Taxi Rank Clearways and On Street Parking) Consolidation Order 2013 (Amendment No.5) Order 2015.

FIRST SCHEDULE

Map Schedules to be revoked

Map Schedule	Date
IN81 (Outer Zone)	11/02/2013
IN82 (Outer Zone)	11/02/2013

SECOND SCHEDULE

Map Schedules to be inserted

Map Schedule	Date
IN81 (Outer Zone)	22/06/2015
IN82 (Outer Zone)	22/06/2015

THE COMMON SEAL of
WILTSHIRE COUNCIL
was hereunto affixed this
9th day of June 2015
in the presence of: -

Wiltshire Council seal: 81521

WILTSHIRE COUNCIL**THE COUNTY OF WILTSHIRE (SALISBURY) (PROHIBITION AND RESTRICTION
OF WAITING, TAXI RANK CLEARWAYS AND ON STREET PARKING)
CONSOLIDATION ORDER 2013 (AMENDMENT NO.6) ORDER 2014**

The Council of the County of Wiltshire in exercise of its powers under Sections 1, 2, 4, 32, 35, 45, 46, 49, 51, 53 and Part IV of Schedule 9 of the Road Traffic Regulation Act 1984 (hereinafter referred to as "the Act of 1984") as amended and the Traffic Management Act 2004 (hereinafter referred to as "the Act of 2004") as amended and of all other enabling powers and after consultation with the Chief Officer of Police in accordance with Part III of Schedule 9 to the Act of 1984 hereby makes the following Order.

1. The County of Wiltshire (Salisbury) (Prohibition and Restriction of Waiting, Taxi Rank Clearways and On Street Parking) Consolidation Order 2013 shall be amended by the revocation of the Map Schedules specified in the First Schedule to this Order and the insertion of the Map Schedules specified in the Second Schedule to this Order.
2. The effect of the Order will be to amend for administrative purposes only (no changes to take place on the ground) the various parking and waiting restrictions to reflect what is currently in place in Blue Boar Row, Bridge Street, Brown Street, Butcher Row, Castle Street, Catherine Street, Cheese Market, Chipper Lane, Fish Row, Gigant Street, High Street, Milford Street, Minster Street, New Canal, Pennyfarthing Street, Queen Street, Rolleston Street and Winchester Street
3. This Order shall come into operation on 29th December 2014 and may be cited as The County of Wiltshire (Salisbury) (Prohibition and Restriction of Waiting, Taxi Rank Clearways and On Street Parking) Consolidation Order 2013 (Amendment No.6) Order 2014.

FIRST SCHEDULE**Map Schedule to be revoked**

Map Schedule	Date
IJ83 (Central Zone)	08/04/2013
IK83 (Central Zone)	05/01/2014
IL83 (Central Zone)	11/02/2013
IJ83 (Zone E)	28/07/2014
IK83 (Zone E)	28/07/2014
IK84 (Zone E)	18/11/2013

SECOND SCHEDULE

Map Schedule to be inserted

Map Schedule	Date
IJ83 (Central Zone)	29/12/2014
IK83 (Central Zone)	29/12/2014
IL83 (Central Zone)	29/12/2014
IJ83 (Zone E)	29/12/2014
IK83 (Zone E)	29/12/2014
IK84 (Zone E)	29/12/2014

THE COMMON SEAL of
WILTSHIRE COUNCIL
was hereunto affixed this
16th day of December 2014
in the presence of: -

WILTSHIRE COUNCIL**THE COUNTY OF WILTSHIRE (SALISBURY) (PROHIBITION AND RESTRICTION
OF WAITING, TAXI RANK CLEARWAYS AND ON STREET PARKING)
CONSOLIDATION ORDER 2013 (AMENDMENT NO.7) ORDER 2015**

The Council of the County of Wiltshire in exercise of its powers under Sections 1, 2, 4, 32, 35, 45, 46, 49, 51, 53 and Part IV of Schedule 9 of the Road Traffic Regulation Act 1984 (hereinafter referred to as “the Act of 1984”) as amended and the Traffic Management Act 2004 (hereinafter referred to as “the Act of 2004”) as amended and of all other enabling powers and after consultation with the Chief Officer of Police in accordance with Part III of Schedule 9 to the Act of 1984 hereby makes the following Order.

1. The County of Wiltshire (Salisbury) (Prohibition and Restriction of Waiting, Taxi Rank Clearways and On Street Parking) Consolidation Order 2013 shall be amended by the revocation of the Map Schedules specified in the First Schedule to this Order and the insertion of the Map Schedules specified in the Second Schedule to this Order.
2. The effect of the Order will be to introduce:
 - (a) No Stopping at any time on both sides of Lower Road, Lower Bemerton – from the boundary of No. 136 Lower Road and Bemerton St John Primary School for a distance of 44 metres in a westerly direction
 - (b) No waiting Mon – Sat 8am – 6pm on the following lengths of road:

Lower Road– both sides – from the boundary of the property known as Waterside and St Johns Church for a distance of 44 metres in an easterly direction

Lower Road– both side – from the boundary of No. 136 Lower Road and Bemerton St John Primary School for a distance of 197 metres in a westerly direction

Church Lane – west side – from its junction with Lower Road for a distance of 20 metres in a northerly direction

These restrictions will replace any existing restrictions currently in force in the City of Salisbury.

3. This Order shall come into operation on 23rd February 2015 and may be cited as The County of Wiltshire (Salisbury) (Prohibition and Restriction of Waiting, Taxi Rank Clearways and On Street Parking) Consolidation Order 2013 (Amendment No.7) Order 2015.

FIRST SCHEDULE**Map Schedule to be revoked**

Map Schedule	Date
II78 (Outer Zone)	11/02/2013
II79 (Outer Zone)	11/02/2013

SECOND SCHEDULE

Map Schedule to be inserted

Map Schedule	Date
II78 (Outer Zone)	23/02/2015
II79 (Outer Zone)	23/02/2015

THE COMMON SEAL of
WILTSHIRE COUNCIL
was hereunto affixed this
10th day of February 2015
in the presence of: -

WILTSHIRE COUNCIL

**THE COUNTY OF WILTSHIRE (SALISBURY) (PROHIBITION AND RESTRICTION
OF WAITING, TAXI RANK CLEARWAYS AND ON STREET PARKING)
CONSOLIDATION ORDER 2013 (AMENDMENT NO.8) ORDER 2014**

The Council of the County of Wiltshire in exercise of its powers under Sections 1, 2, 4, 32, 35, 45, 46, 49, 51, 53 and Part IV of Schedule 9 of the Road Traffic Regulation Act 1984 (hereinafter referred to as “the Act of 1984”) as amended and the Traffic Management Act 2004 (hereinafter referred to as “the Act of 2004”) as amended and of all other enabling powers and after consultation with the Chief Officer of Police in accordance with Part III of Schedule 9 to the Act of 1984 hereby makes the following Order.

1. The County of Wiltshire (Salisbury) (Prohibition and Restriction of Waiting, Taxi Rank Clearways and On Street Parking) Consolidation Order 2013 Experimental Order No.2 2013 is hereby revoked.
2. The County of Wiltshire (Salisbury) (Prohibition and Restriction of Waiting, Taxi Rank Clearways and On Street Parking) Consolidation Order 2013 shall be amended by the revocation of the Map Schedules specified in the First Schedule to this Order and the insertion of the Map Schedules specified in the Second Schedule to this Order.
3. The effect of the Order will be: -
 - (a) To introduce **No waiting at any time** and **No loading at any time** on the following lengths of road: -
 - Endless Street** – west side – from a point 10 metres north of its junction with Blue Boar Row to a point 11 metres north of that junction
 - Milford Street** – north side – from a point 41 metres east of a point in line with the western boundary wall of the Cathedral Hotel to a point in line with the boundaries between Nos. 10 and 12 Milford Street
 - (b) To introduce **Loading only 8am – 6pm** and **No waiting Saturday 6pm – Midnight and Sunday Midnight – 6am** on the north side of **Milford Street** from a point in line with the western boundary wall of the Cathedral Hotel to a point 12 metres east of that boundary
 - (c) To introduce **Loading only 8am – 6pm** on the north side of **New Canal** from a point 30 metres west of its junction with Queen Street to a point 44 metres west of that junction
 - (d) To introduce **No waiting except taxis** on the north side of **New Canal** from a point 9 metres west of its junction with Queen Street to a point 30 metres west of that junction
 - (e) Administrative change in New Canal to update restrictions previously mapped.

These restrictions will replace any existing restrictions currently in force in the city of Salisbury.

4. This Order shall come into operation on 28th July 2014 and may be cited as The County of Wiltshire (Salisbury) (Prohibition and Restriction of Waiting, Taxi Rank Clearways and On Street Parking) Consolidation Order 2013 (Amendment No.8) Order 2014.

FIRST SCHEDULE

Map Schedules to be revoked

Map Schedule	Date
IJ83 (Central Zone)	18/11/2013
IK83 (Central Zone)	18/11/2013
IJ83 (Zone E)	11/02/2013
IK83 (Zone E)	18/11/2013
IJ83 (Central Zone)	05/01/2014
IK83 (Central Zone)	05/01/2014
IJ83 (Zone E)	05/01/2014
IK83 (Zone E)	05/01/2014

SECOND SCHEDULE

Map Schedules to be inserted

Map Schedule	Date
IJ83 (Central Zone)	28/07/2014
IK83 (Central Zone)	28/07/2014
IJ83 (Zone E)	28/07/2014
IK83 (Zone E)	28/07/2014

THE COMMON SEAL of
WILTSHIRE COUNCIL
was hereunto affixed this
17th day of July 2014
in the presence of: -

Wiltshire Council seal: 79940

WILTSHIRE COUNCIL**THE COUNTY OF WILTSHIRE (SALISBURY) (PROHIBITION AND RESTRICTION
OF WAITING, TAXI RANK CLEARWAYS AND ON STREET PARKING)
CONSOLIDATION ORDER 2013 (AMENDMENT NO.9) ORDER 2015**

The Council of the County of Wiltshire in exercise of its powers under Sections 1, 2, 4, 32, 35, 45, 46, 49, 51, 53 and Part IV of Schedule 9 of the Road Traffic Regulation Act 1984 (hereinafter referred to as "the Act of 1984") as amended and the Traffic Management Act 2004 (hereinafter referred to as "the Act of 2004") as amended and of all other enabling powers and after consultation with the Chief Officer of Police in accordance with Part III of Schedule 9 to the Act of 1984 hereby makes the following Order.

1. The County of Wiltshire (Salisbury) (Prohibition and Restriction of Waiting, Taxi Rank Clearways and On Street Parking) Consolidation Order 2013 shall be amended by the revocation of the Map Schedule specified in the First Schedule to this Order and the insertion of the Map Schedule specified in the Second Schedule to this Order.
2. The effect of the Order will be to introduce:
 - (a) **No stopping at any time except taxis** on the south side of New Canal (Pig Market Area) from a point 24 metres east of a point in line with the centreline of Salisbury Footpath 69 to a point 64 metres east of that centreline.
 - (b) **Disabled badge holders only at all times Mon-Sat 8am – 6pm 3 hours No return within 3 hours** on the north side of New Canal (Pig Market Area) from a point 24 metres east of a point in line with the centreline of Salisbury Footpath 69 to a point 69 metres east of that centreline.
 - (c) **Loading only 6am – 10am and Bus parking 10am – 6pm** on the north west side of New Canal (Pig Market Area) from a point in line with the centreline of Salisbury Footpath 69 to a point 24 metres east of that centreline.

These restrictions will replace any existing restrictions currently in force in the City of Salisbury.

3. This Order shall come into operation on 5th May 2015 and may be cited as The County of Wiltshire (Salisbury) (Prohibition and Restriction of Waiting, Taxi Rank Clearways and On Street Parking) Consolidation Order 2013 (Amendment No.9) Order 2015.

FIRST SCHEDULE**Map Schedule to be revoked**

Map Schedule	Date
IK83 (Central Zone)	29/12/2014

SECOND SCHEDULE

Map Schedule to be inserted

Map Schedule	Date
IK83 (Central Zone)	05/05/2015

THE COMMON SEAL of
WILTSHIRE COUNCIL
was hereunto affixed this
21st day of April 2015
in the presence of: -

WILTSHIRE COUNCIL**THE COUNTY OF WILTSHIRE (SALISBURY) (PROHIBITION AND RESTRICTION OF WAITING, TAXI RANK CLEARWAYS AND ON STREET PARKING) CONSOLIDATION ORDER 2013 (AMENDMENT NO.10) ORDER 2016**

The Council of the County of Wiltshire in exercise of its powers under Sections 1, 2, 4, 32, 35, 53 and Part IV of Schedule 9 of the Road Traffic Regulation Act 1984 (hereinafter referred to as “the Act of 1984”) as amended and the Traffic Management Act 2004 (hereinafter referred to as “the Act of 2004”) as amended and of all other enabling powers and after consultation with the Chief Officer of Police in accordance with Part III of Schedule 9 to the Act of 1984 hereby makes the following Order.

1. The County of Wiltshire (Salisbury) (Prohibition and Restriction of Waiting, Taxi Rank Clearways and On Street Parking) Consolidation Order 2013 shall be amended by the revocation of the Map Schedules specified in the First Schedule to this Order and the insertion of the Map Schedules specified in the Second Schedule to this Order.

2. The effect of the Order will be to introduce **No Waiting at any time** on the following lengths of roads:

Church Lane – both sides – from a point 12 metres north of its junction with St Andrews Road to a point 12 metres south of that junction

Hadrians Close – both sides – from its junction with Lower Road to a point 10 metres south of that junction

Lower Road – north side – from its junction with Skew Bridge Road to a point in line with the boundary between property Nos. 119 and 121 Lower Road

Lower Road – north east side – from a point 4 metres north west of a point in line with the boundary between property Nos. 85 and 87 Lower Road to a point 10 metres south east of a point in line with the boundary between property Nos. 85 and 87 Lower Road

Lower Road – north east side – from its junction with Salisbury Footpath 48 to a point 4 metres north west of that junction

Lower Road – east side – from its junction with Salisbury Footpath 48 to a point 6 metres south of that junction

Lower Road – east and north side – from a point 18 metres south of its junction with Salisbury Footpath 48 to a point 10 metres west of a point in line with the boundary between property Nos. 65 and 71 Lower Road

Lower Road – south side – from a point 17 metres west of its junction with Hadrians Close to a point in line with the western property wall of No.88 Lower Road;

Lower Road – south side – from a point in line with the boundary between property Nos. 139 and 141 Lower Road to a point in line with the boundary between properties known as ‘Nadder House’ and No.76 Lower Road

Skew Bridge Road – both sides – from its junction with Lower Road to a point 7 metres north of that junction

Skew Bridge Road – both sides – from its junction with St Andrews Road to a point in line with the boundary between property Nos. 16 and 18 Skew Bridge Road;

St Andrews Road – both sides – from its junction with Church Lane to a point 6 metres east of that junction;

St Andrews Road – south side – from its junction with Skew Bridge Road to a point in line with the boundary between property No.11 Skew Bridge Road and No.48 St Andrews Road

3. This Order shall come into operation on 15th August 2016 and may be cited as The County of Wiltshire (Salisbury) (Prohibition and Restriction of Waiting, Taxi Rank Clearways and On Street Parking) Consolidation Order 2013 (Amendment No.10) Order 2016.

FIRST SCHEDULE

Map Schedules to be revoked

Map Schedule	Date
II79 (Outer Zone)	23/02/2015
II80 (Outer Zone)	11/02/2013
IJ80 (Outer Zone)	11/02/2013

SECOND SCHEDULE

Map Schedules to be inserted

Map Schedule	Date
II79 (Outer Zone)	15/08/2016
II80 (Outer Zone)	15/08/2016
IJ80 (Outer Zone)	15/08/2016

THE COMMON SEAL of
WILTSHIRE COUNCIL
was hereunto affixed this
2nd day of August 2016
in the presence of: -

Wiltshire Council seal: 84078

WILTSHIRE COUNCIL**THE COUNTY OF WILTSHIRE (SALISBURY) (PROHIBITION AND RESTRICTION
OF WAITING, TAXI RANK CLEARWAYS AND ON STREET PARKING)
CONSOLIDATION ORDER 2013 (AMENDMENT NO.11) ORDER 2017**

The Council of the County of Wiltshire in exercise of its powers under Sections 1, 2, 4, 32, 35, 45, 46, 49, 51, 53 and Part IV of Schedule 9 of the Road Traffic Regulation Act 1984 (hereinafter referred to as “the Act of 1984”) as amended and the Traffic Management Act 2004 (hereinafter referred to as “the Act of 2004”) as amended and of all other enabling powers and after consultation with the Chief Officer of Police in accordance with Part III of Schedule 9 to the Act of 1984 hereby makes the following Order.

1. The County of Wiltshire (Salisbury) (Prohibition and Restriction of Waiting, Taxi Rank Clearways and on Street Parking) Consolidation Order 2013 shall be amended by the revocation of the Map Schedules specified in the First Schedule to this Order and the insertion of the Map Schedules specified in the Second Schedule to this Order.

2. The effect of the Order will be:-

- (a) To introduce **No Waiting at any time** on the following lengths of roads:

Albany Road – south west side – from a point 12 metres north west of a point in line with the boundary between property Nos. 37 and 39 Albany Road to a point 3 metres south west of a point in line with the boundary between property Nos. 45 and 47 Albany Road

Belle Vue Road – north east side – from a point in line with the boundary between property Nos. 38 and 40 Belle Vue Road to its junction with the College Street Car Park Access Road

Castle Street – west side – from a point 8 metres north of the centreline of the access for Archers Court to a point 63 metres north of that line

College Street – north east side – from a point 5 metres north west of a point in line with the boundary between property Nos. 66 and 68 College Street to a point 1 metre south east of that boundary

Endless Street – west side – from a point 35 metres north of its junction with Scots Lane to a point 52 metres north of that junction

Kings Road – south east side – from a point 57 metres south west of its junction with Marlborough Road to a point 58 metres south west of that junction

Nelson Road – north east side – the northern end between the time limited parking bay and proposed new section of single yellow line

Scamells Road – north west side – from a point 19 metres south west of a point in line with boundary between property Nos. 10 and 11 Nelson Road to a point 24 metres south west of that boundary

Scamells Road – south east side – from a point 17 metres south west of a point in line with the boundary between property Nos. 12 and 13 Nelson Road to its south western end (including the cul-de-sac turning head)

Woodstock Road – south east side – from a point 48 metres north east of its junction with Marlborough Road to a point 58 metres north east of that junction

Wyndham Road – north west side – from a point in line with the boundary between property Nos. 60 and 62 Wyndham Road to a point 2 metres south west of a point in line with the boundary between property Nos. 68 and 70 Wyndham Road

Wyndham Road – north west side – from a point 2 metres south west of its junction with Queens Road to a point 10 metres south west of that junction

Wyndham Road – north west side – from a point 6 metres south west of a point in line with the boundary between property known as 'Wyndham Park' and property Nos. 101 to 123 Wyndham Road to a point 1 metre south west of a point in line with the boundary between property Nos. 98 and 100 Wyndham Road

- (b) To introduce **Parking Monday to Saturday 8am – 6pm Permit Holders Only Zone A** on the following lengths of roads:

Albany Road – north east side – from a point in line with the boundary between property Nos. 4 and 6 Albany Road to a point 5 metres north west of a point in line with property Nos. 46 to 48 Albany Road

Albany Road – south east side – from a point 4 metres north east of a point in line with the boundary between property Nos. 47 and 49 Albany Road to a point in line with the boundary between property Nos. 55 and 57 Albany Road

Albany Road – south west side – from a point 16 metres south east of a point in line with the boundary between property Nos. 1 and 3 Albany Road to a point 5 metres south east of that boundary

Albany Road – south west side – from a point 5 metres north west of a point in line with the boundary between property Nos. 1 and 3 Albany Road to a point 12 metres north west of a point in line with the boundary to property Nos. 37 and 39 Albany Road

Albany Road – north west side – from a point 3 metres south west of a point in line with the boundary between property Nos. 45 and 47 Albany Road to a point 25 metres north east of that boundary

Albany Road (north western spur) – south west side – from a point 6 metres north west of its junction with Albany Road to a point 28 metres north west of that junction

Albany Road (north western spur) – south west side – from a point 37 metres north west of its junction with Albany Road to a point 12 metres south east of its junction with Wyndham Road

Albany Road (north western spur) – north east side – from a point 12 metres south east of its junction with Wyndham Road to a point 32 metres south east of that junction

Albany Road (north western spur) – north east side – from a point 42 metres south east of its junction with Wyndham Road to a point 63 metres south east of that junction

Belle Vue Road – north east side – from a point 10 metres south east of a point in line with the boundary between property Nos. 46 and 48 Belle Vue Road to a point in line with the boundary between property Nos. 38 and 40 Belle Vue Road

Belle Vue Road – north west side – from a point 7 metres south west of a point in line with the boundary between property known as 'Melissa', Belle Vue Road and No. 1 Albany Road to a point 7 metres north east of that boundary

Belle Vue Road – north west side – from a point in line with the boundary between property Nos. 22 and 24 Belle Vue Road to a point 11 metres north east of that boundary

Belle Vue Road – north west side – from a point 23 metres north east of a point in line with the boundary between property Nos. 22 and 24 Belle Vue Road to a point 36 metres north east of that boundary

Belle Vue Road – south west side – from a point 5 metres south east of a point in line with the boundary between property Nos. 7 and 9 Belle Vue Road to a point 16 metres south east of a point in line with the boundary between property Nos. 37 and 39 Belle Vue Road

Belle Vue Road – south west side – from a point 5 metres south east of a point in line with the boundary between property Nos. 37 and 39 Belle Vue Road to a point 4 metres south east of a point in line with the boundary between property Nos. 47 and 49 Belle Vue Road

Belle Vue Road (northern spur) – south east side – from a point 29 metres north east of a point in line with the boundary between property Nos. 55 and 57 Albany Road to a point 18 metres north east of that boundary

Belle Vue Road (northern spur) – north west side – from a point 4 metres south west of a point in line with the boundary between property Nos. 61 and 63 Belle Vue Road to a point 13 metres north east of a point in line with the boundary between property Nos. 67 and 69 Belle Vue Road

Belle Vue Road (northern spur) – south east side – from a point 3 metres south west of a point in line with the boundary between property Nos. 73 and 75 Belle Vue Road to a point 16 metres south west of that boundary

Belle Vue Road – north east side – from a point 3 metres south east of a point in line with the boundary between property Nos. 86 and 88 Belle Vue Road to a point in line with the boundary between property Nos. 38 and 40 Belle Vue Road

Belle Vue Road – south east side – from a point 5 metres south west of a point in line with the boundary between property Nos. 34 and 36 Belle Vue Road to a point 3 metres south west of a point in line with the boundary between property Nos. 18 and 20 Belle Vue Road

Belle Vue Road – south east side – from a point 9 metres south west of a point in line with the boundary between property Nos. 18 and 20 Belle Vue Road to a point in line with the boundary between property Nos. 2 and 4 Belle Vue Road

Belle Vue Road – south east side – from a point 16 metres south west of a point in line with the boundary between property Nos. 2 and 4 Belle Vue Road to a point 32 metres south west of that boundary

College Street – north east side – from a point 12 metres south east of its junction with Park Street to a point 19 metres south east of that junction

College Street – north east side – from a point 25 metres south east of its junction with Park Street to a point 5 metres north west of a point in line with the boundary between property Nos. 66 and 68 College Street

College Street – north east side – from a point 1 metre south east of a point in line with the boundary between property Nos. 66 and 68 College Street to a point 8 metres south east of a point in line with the boundary between property Nos. 22 and 24 College Street

College Street – north east side – from a point 14 metres south east of a point in line with the boundary between property Nos. 22 and 24 College Street to a point 4 metres south east of a point in line with the boundary between property Nos. 2 and 4 College Street

College Street – south west side – from a point 5 metres north west of its junction with Estcourt Road to a point 34 metres north west of that junction

College Street – south west side – from a point 45 metres north west of its junction with Estcourt Road to a point 5 metres south east of its junction with Helena Terrace

College Street – south west side – from a point 5 metres north west of its junction with Helena Terrace to a point 15 metres north west of a point in line with the boundary between property Nos. 58 and 60 College Street

College Street – south west side – from a point in line with the boundary between property Nos. 72 and 74 College Street to a point 30 metres north west of that boundary

College Street – south west side – from a point 36 metres north west of a point in line with the boundary between property Nos. 72 and 74 College Street to its junction with Queens Road

Endless Street – west side – from a point 17 metres north of its junction with Scots Lane to a point 35 metres north of that junction

Endless Street – west side – from a point 52 metres north of its junction with Scots Lane to a point in line with the boundary between property Nos. 72 and 74 Endless Street

Estcourt Road – north west side – from a point 3 metres south west of a point in line with the boundary between property Nos. 31 and 33 Estcourt Road to a point 19 metres north east of that boundary

Estcourt Road – north west side – from a point 5 metres south west of a point in line with the boundary between property Nos. 59 and 61 Estcourt Road to a point 17 metres north east of a point in line with the boundary between property Nos. 67 and 69 Estcourt Road

Hamilton Road – north west side – from a point 1 metre south west of a point in line with the boundary between property Nos. 3 and 5 Hamilton Road to a point 5 metres north east of a point in line with the boundary between property Nos. 85 and 87 Hamilton Road

Hamilton Road – south east side – from a point in line with the boundary between property Nos. 22 and 24 Hamilton Road to a point 5 metres north east of a point in line with property Nos. 66 and 68 Hamilton Road

Hamilton Road – south east side – from a point 10 metres north east of a point in line with the boundary between property Nos. 66 and 68 Hamilton Road to a point 1 metre south west of a point in line with the boundary between property Nos. 80 and 82 Hamilton Road

Kings Road – south east side – from a point 22 metres south west of its junction with Marlborough Road to a point 31 metres south west of that junction

Kings Road – south east side – from a point 37 metres south west of its junction with Marlborough Road to a point 47 metres south west of that junction

Kings Road – south east side – from a point 53 metres south west of its junction with Marlborough Road to a point 57 metres south west of that junction

Kings Road – north east side – from a point 8 metres north west of its junction with Wyndham Road to a point 29 metres north west of that junction

Marlborough Road – north east side – from a point in line with the boundary between property Nos. 2 and 4 Marlborough Road to a point 4 metres north west of a point in line with the boundary between property Nos. 32 and 34 Marlborough Road

Nelson Road – south east side – from its junction with Scamells Road to a point 5 metres north east of a point in line with the boundary between Nos. 21 and 22 Nelson Road

Nelson Road – north west side – from a point in line with the boundary between property No. 1 and property known as 'Nelson House' to its junction with Scamells Road

Park Street – north east side – from a point 4 metres north west of its junction with Estcourt Road to a point 22 metres north west of that junction

Park Street – north east side – from a point 29 metres north west of its junction with Estcourt Road to a point 35 metres north west of that junction

Park Street – north east side – from a point 40 metres north west of its junction with Estcourt Road to a point 4 metres north west of a point in line with the boundary between property Nos. 4 and 6 Park Street

Park Street – north east side – from a point 10 metres north west of a point in line with the boundary between property Nos. 4 and 6 Park Street to a point 4 metres north west of a point in line with the boundary between property Nos. 16 and 18 Park Street

Park Street – north east side – from a point in line with the boundary between property Nos. 22 and 24 Park Street to a point 4 metres north west of that boundary

Park Street – north east side – from a point 5 metres north west of a point in line with the boundary between property Nos. 60 and 62 Park Street to a point 3 metres north west of a point in line with the boundary of property Nos. 64 and 66 Park Street

Park Street – north east side – from a point 5 metres north west of a point in line with the boundary between property Nos. 68 and 70 Park Street to a point 9 metres north west of a point in line with that boundary

Park Street – north west side – from a point 6 metres north east of a point in line with the boundary of property Nos. 91 and 93 Park Street to a point 5 metres north east of its junction with Queens Road

Park Street – south east and south west side – from a point 12 metres north east of its junction with College Street to a point 4 metres south east of a point in line with the boundary between property Nos. 61 and 63 Park Street

Park Street – south west side – from a point 9 metres south east of a point in line with the boundary between property Nos. 61 and 63 Park Street to a point 11 metres south east of a point in line with the boundary of property Nos. 5 and 7 Park Street

Queens Road – north east side – From a point 12 metres north west of its junction with Park Street to a point 11 metres north west of a point in line with the boundary between property Nos. 8 and 10 Queens Road

Queens Road – north east side – from a point 16 metres north west of a point in line with the boundary between property Nos. 8 and 10 Queens Road to a point in line with the boundary between property Nos. 24 and 26 Queens Road

Queens Road – north east side – from a point 10 metres south east of a point in line with the boundary between property Nos. 28 and 30 Queens Road to a point in line with the boundary between property Nos. 36 and 38 Queens Road

Queens Road – south west side – from a point in line with the boundary between property Nos. 38 and 40 Queens Road to a point 7 metres south east of a point in line with the boundary between property Nos. 5 and 7 Queens Road

Queens Road – south west side – from a point 21 metres south east of a point in line with the boundary of property Nos. 5 and 7 Queens Road to a point 45 metres south east of that boundary

Queens Road – south west side – from a point 11 metres south east of a point in line with the boundary between property Nos. 12 and 14 Queens Road to its junction with College Street

St Marks Road – north west side – from a point 5 metres south west of a point in line with the boundary between property Nos. 104 and 106 St Marks Road to a point 3 metres north east of a point in line with the boundary to property Nos. 72 and 74 St Marks Road

St Mark Road – north east side – from a point 4 metres north east of a point in line with the boundary of property Nos. 68 and 70 St Marks Road to a point 6 metres south east of a point in line with the boundary between property Nos. 32 and 34 St Marks Road

St Marks Road – north east side – from a point 11 metres south east of a point in line with the boundary between property Nos. 32 and 34 St Marks Road to a point 8 metres south east of a point in line with the boundary between property Nos. 4 and 6 St Marks Road

St Marks Road – south west side – from a point 25 metres south east of a point in line with the boundary between property Nos. 7 and 9 St Marks Road to a point 37 metres south east of that boundary

St Marks Road – south west side – from a point 1 metre south east of a point in line with the boundary of property Nos. 7 and 9 St Marks Road to a point 5 metres north west of a point in line with the boundary between property Nos. 29 and 31 St Marks Road

St Marks Road – south west side – from a point 10 metres north west of a point in line with the boundary between property Nos. 29 and 31 St Marks Road to a point 3 metres north west of a point in line with the boundary between property Nos. 57 and 59 St Marks Road

St Marks Road – south west side – from a point 9 metres north west of a point in line with the boundary between property Nos. 57 and 59 St Marks Road to a point 13 metres north west of a point in line with the boundary between property Nos. 61 and 63 St Marks Road

St Marks Road – south east side – from a point 18 metres north west of a point in line with the boundary between property Nos. 61 and 63 St Marks Road to a point 2 metres south west of a point in line with the boundary between property Nos. 73 and 75 St Marks Road

St Marks Road – south east side – from a point 10 metres south west of a point in line with the boundary between property Nos. 73 and 75 St Marks Road to a point 5 metres south west of a point in line with the boundary between property Nos. 79 and 81 St Marks Road

Scamells Road – north west side – from its junction with Nelson Road to a point 19 metres south west of a point in line with the boundary between property Nos. 10 and 11 Nelson Road

Scamells Road – north west side – from a point 24 metres south west of a point in line with the boundary between property Nos. 10 and 11 Nelson Road to its south western end

Scamells Road – south east side – from a point 17 metres south west of a point in line with the boundary between property Nos. 12 and 13 Nelson Road to its junction with Nelson Road

Swaynes Close – north east side – from a point 1 metre north west of a point in line with the boundary between property Nos. 1 and 3 Swaynes Close to a point 5 metres south east of that boundary

Swaynes Close – north east side – from a point 6 metres south east of a point in line with the boundary between property Nos. 3 and 5 Swaynes Close to a point 5 metres south east of a point in line with the boundary between property Nos. 5 and 7 Swaynes Close

Swaynes Close – north east side – from a point 4 metres south east of a point in line with the boundary between property Nos. 7 and 9 Swaynes Close to a point 5 metres south east of a point in line with the boundary between property Nos. 9 and 11 Swaynes Close

Swaynes Close – north east – from a point 11 metres south east of a point in line with the boundary between property Nos. 9 and 11 Swaynes Close to a point 28 metres south east of that boundary

Swaynes Close – north east side – from a point 35 metres south east of a point in line with the boundary between property Nos. 9 and 11 Swaynes Close to a point 45 metres south east of that boundary

Swaynes Close – south west side – from a point 12 metres south east of its junction with Wyndham Road to a point 31 metres south east of that junction

Swaynes Close – south west side – from a point 38 metres south east of its junction with Wyndham Road to a point 68 metres south east of that junction

Woodstock Road – south east side – from a point 13 metres north east of its junction with Marlborough Road to a point 20 metres north east of that junction

Woodstock Road – south east side – from a point 25 metres north east of its junction with Marlborough Road to a point 48 metres north east of that junction

Wyndham Road – north west side – from a point 15 metres north east of a point in line with the boundary between property Nos. 7 and 9 Wyndham Road to a point 7 metres north east of a point in line with the boundary between property Nos. 15 and 17 Wyndham Road

Wyndham Road – north west side – from a point in line with the boundary between property Nos. 21 and 23 Wyndham Road to a point 5 metres north east of a point in line with the boundary between property Nos. 49 and 51 Wyndham Road

Wyndham Road – north west side – north west side – from a point 34 metres south west of a point in line with the boundary between property Nos. 60 and 62 Wyndham Road to a point in line with that boundary

Wyndham Road – north west side – from a point 6 metres south west of a point in line with the boundary between property Nos. 53 and 55 Wyndham Road to a point in line with that boundary

Wyndham Road – north west side – from a point 34 metres south west of a point in line with the boundary between property Nos. 60 and 62 Wyndham Road to a point in line with that boundary

Wyndham Road – north west side – from a point 2 metres south west of its junction with Queens Road to a point 6 metres south west of a point in line with the boundary between property known as 'Wyndham Park' and Nos. 101 and 123 Wyndham Road

Wyndham Road – south east side – from a point in line with the boundary between property Nos. 104 and 106 Wyndham Road to a point 33 metres north east of its junction with Swaynes Close

Wyndham Road – south east side – from a point 28 metres north east its junction with Queens Road to a point 12 metres north east of that junction

Wyndham Road – south east side – from a point in line with the boundary between property Nos. 78 and 80 Wyndham Road to a point 2 metres south west of a point in line with the boundary between property Nos. 54 and 56 Wyndham Road

Wyndham Road – south east side – from a point 11 metres south west of a point in line with the boundary between property Nos. 54 and 56 Wyndham Road to a point 15 metres north east of its junction with Swaynes Close

Wyndham Road – south east side – from a point in line with the boundary between property Nos. 49 and 51 Wyndham Road to a point in line with the boundary between property Nos. 36b and 38 Wyndham Road

Wyndham Road – south east side – from a point 5 metres north east of a point in line with the boundary between property Nos. 32 and 34 Wyndham Road to a point 4 metres south west of a point in line with the boundary between property Nos. 18 and 20 Wyndham Road

Wyndham Road – south east side – from a point 10 metres south west of a point in line with the boundary between property Nos. 18 and 20 Wyndham Road to a point 5 metres south west of a point in line with the boundary between properties known as 'Tennesa' and 'Ingleside', Wyndham Road

- (c) To introduce **Disabled Badge Holders Only At All Times Monday to Saturday 8am – 6pm 3 hours No Return within 3 hours** on the following length of road:

Endless Street – east side – from a point 11 metres south of a point in line with the boundary between property Nos. 72 and 74 Endless Street to a point 3 metres north of that boundary

- (d) To introduce **Loading Only Monday to Saturday 8am – 6pm** on the following length of road:

Estcourt Road – north west side – from a point 19 metres north east of a point in line with the boundary between property Nos. 31 and 33 Estcourt Road to a point in line with the boundary between property Nos. 45 and 47 Estcourt Road

- (e) To introduce **Parking Monday to Saturday 8am – 6pm 1 hour No Return within 2 hours** on the following lengths of roads:

Belle Vue Road – south east side – from a point 9 metres south west of the centreline of the College Street Car Park Access Road to a point 32 metres south west of that point

Estcourt Road – north west side – from a point 23 metres north east of a point in line with the boundary between property Nos. 67 and 69 Estcourt Road to a point 43 metres north east of a point in line with the boundary between property Nos. 67 and 69 Estcourt Road

Hamilton Road – south east side - from a point in line with the boundary between property Nos. 2 and 4 Hamilton Road to a point in line with the boundary between property Nos. 22 and 24 Hamilton Road

Marlborough Road – north east side – from a point 10 metres north west of its junction with Marlborough Road to a point 14 metres south east of its junction with Woodstock Road

Nelson Road – south east side – from its north eastern end to its junction with Nelson Road (south eastern spur)

St Marks Road – south east side – from a point 12 metres south west of a point in line with the boundary between property Nos. 79 and 81 St Marks Road to a point 38 metres south west of that boundary

Wyndham Road – north west side – from a point 13 metres south west of a point in line with the boundary between property Nos. 7 and 9 Wyndham Road to a point 22 metres south west of that boundary

Wyndham Road – north west side – from a point 7 metres south west of a point in line with the boundary between property Nos. 7 and 9 Wyndham Road to a point 6 metres north east of that boundary

Wyndham Road – south east side – from a point 15 metres north east of its junction with Swaynes Close to a point 8 metres north east of that junction

- (f) To introduce **Parking Monday to Saturday 8am – 6pm 30 minutes No Return within 1 hour** on the following lengths of roads:

Estcourt Road – north west side – from a point in line with the boundary between Nos. 45 and 47 Estcourt Road to a point 8 metres north east of a point in line with the boundary between property Nos. 53 and 55 Estcourt Road

Park Street – south east side – from a point 5 metres north east of its junction with College Street to a point 12 metres north east of that junction

- (g) To introduce **Pay and Display Parking Monday to Saturday 8am – 6pm and Sunday 10am - 4pm 1 hour No Return within 2 hours Except Permit Holders Zone A** on the following lengths of road:

Castle Street – west side – from a point 34 metres south of a point in line with the boundary between property Nos. 73 and 75 Castle street to a point 17 metres south of that boundary

Castle Street – west side – from a point 2 metres north of a point in line with the boundary between property Nos. 73 and 75 Castle Street to a point 32 metres north of a point in line with the boundary between property Nos. 91 and 93 Castle Street

- (h) To introduce **No Waiting Monday to Saturday 8am – 6pm** on the following lengths of roads:
Belle Vue Road – south east side – from a point 32 metres south west of the centreline of College Street Car Park Access Road to a point in line with the boundary between property Nos. 34 and 36 Belle Vue Road
Nelson Road – north west side – from a point 5 metres north east of a point in line with the boundary between property No.1 Nelson Road and property known as ‘Nelson House’ to its north eastern end

These restrictions will replace any existing restrictions currently in force in the City of Salisbury.

3. This Order shall come into operation on 31st July 2017 and may be cited as The County of Wiltshire (Salisbury) (Prohibition and Restriction of Waiting, Taxi Rank Clearways and on Street Parking) Consolidation Order 2013 (Amendment No.11) Order 2017.

FIRST SCHEDULE

Map Schedules to be revoked

Map Schedule	Date
IH83 (Zone A)	11/02/2013
IH84 (Zone A)	11/02/2013
II83 (Zone A)	11/02/2013
II84 (Zone A)	11/02/2013
IJ83 (Zone A)	11/02/2013
IJ84 (Zone A)	11/02/2013

SECOND SCHEDULE

Map Schedule to be inserted

Map Schedules	Date
IH83 (Zone A)	31/07/2017
IH84 (Zone A)	31/07/2017
II83 (Zone A)	31/07/2017
II84 (Zone A)	31/07/2017
IJ83 (Zone A)	31/07/2017
IJ84 (Zone A)	31/07/2017

THE COMMON SEAL of
 WILTSHIRE COUNCIL
 was hereunto affixed this
 18th day of July 2017
 in the presence of: -

Wiltshire Council seal: 84573

WILTSHIRE COUNCIL**THE COUNTY OF WILTSHIRE (SALISBURY) (PROHIBITION AND RESTRICTION
OF WAITING, TAXI RANK CLEARWAYS AND ON STREET PARKING)
CONSOLIDATION ORDER 2013 (AMENDMENT NO.13) ORDER 2015**

The Council of the County of Wiltshire in exercise of its powers under Sections 1, 2, 4, 32, 35, 45, 46, 49, 51, 53 and Part IV of Schedule 9 of the Road Traffic Regulation Act 1984 (hereinafter referred to as “the Act of 1984”) as amended and the Traffic Management Act 2004 (hereinafter referred to as “the Act of 2004”) as amended and of all other enabling powers and after consultation with the Chief Officer of Police in accordance with Part III of Schedule 9 to the Act of 1984 hereby makes the following Order.

1. The County of Wiltshire (Salisbury) (Prohibition and Restriction of Waiting, Taxi Rank Clearways and On Street Parking) Consolidation Order 2013 shall be amended by the revocation of the Map Schedules specified in the First Schedule to this Order and the insertion of the Map Schedules specified in the Second Schedule to this Order.
2. The effect of the Order will be:
 - (a) To introduce **No waiting at any time** on the following lengths of road:-
Fisherton Street – north east side – from a point 24 metres north west of a point in line with the centreline of the pedestrian access to St. Paul’s Home to a point 36 metres north west of that point
Fisherton Street – south west side – from the boundary between Nos. 159/161 Fisherton Street and No. 163 Fisherton Street for a distance of 6 metres south east of that point
St Paul’s Road – south east side – from a point 6 metres north east of its south western end to a point 16 metres north east of its south western end; between a point 16 metres and 24 metres north east of its south western end; from a point 24 metres north east of its south western end to a point 2 metres south west of the boundary between Nos. 10 and 12 St Paul’s Road; between a point 7 metres and 18 metres north east of the north eastern wall on No. 82 St Paul’s Road
 - (b) To introduce **Parking Mon – Sat 8am – 6pm 30 minutes No return within 1 hour** on the following lengths of road:
Fisherton Street – north east side – from a point 8 metres north west of the north western boundary wall of No. 148 Fisherton Street to a point 2 metres south east of the south eastern wall of No. 146 Fisherton Street
Fisherton Street (Service Road) – south west side – from the boundary between Nos. 159/161 Fisherton Street and No. 163 Fisherton Street to its north western end; from a point 6 metres south east of the boundary between Nos. 159/161 Fisherton Street and No. 163 Fisherton Street to a point 4 metres south east of the boundary between Nos. 155 and 157 Fisherton Street
 - (c) To introduce **Parking Mon – Sat 8am – 6pm 2 hours No return within 4 hours** on the south east side of York Road from a point 5 metres south west of the boundary between Nos. 42/44 York Road to a point 5 metres north east of that boundary

- (d) To introduce **Parking Mon – Sat 8am – 6pm Resident permit holders only Zone D** on the following lengths of road:-
- Hartington Road** – south east side – between a point 1 metre and 3 metres south west of the north eastern boundary wall of No. 3 Hartington Road; between a point 3 metres and 7 metres north east of a point in line with the north eastern boundary wall of No. 3 Hartington Road
- Sidney Street** – south west side – from a point in line with the south eastern wall of No. 3 Sidney Street to a point 7 metres south east of that point
- St Paul's Road** – south east side – from its south western end in a north easterly direction for 6 metres
- St Paul's Road** – north west side – from its south western end to a point 2 metres south west of the boundary between Nos. 10 and 12 St Paul's Road; from a point 2 metres north east of the boundary between Nos. 18 and 20 St Paul's Road to the boundary between Nos. 22 and 24 St Paul's Road; from the boundary between Nos. 34 and 36 St Paul's Road to the boundary between Nos. 38 and 40 St Paul's Road; from a point 2 metres south west of the north eastern wall of No. 64 St Paul's Road to the south western wall of No. 66 St Paul's Road; from a point 2 metres south west of the north eastern wall of No. 82 St Paul's Road to a point 20 metres north east of the boundary between Nos. 80 and 82 St Paul's Road
- Windsor Road** – north east side – between a point 27 metres and 30 metres south east of the south eastern boundary wall of No. 6 Windsor Road; between a point 12 metres and 15 metres south east of the south eastern boundary wall of No. 6 Windsor Road; from the boundary between Nos. 44 and 46 Windsor Road to the boundary between Nos. 48 and 50 Windsor Road
- Windsor Road** – south west side – between a point 26 metres and 32 metres south east of the south eastern boundary wall of No. 13 Windsor Road
- York Road** – north west side – from a point 18 metres north east of the boundary between Nos. 9 and 11 York Road to a point 5 metres south west of the north eastern boundary wall of No. 1 Sidney Street; from a point 6 metres north east of the south western boundary wall of No. 42 York Road to the boundary between No. 37 York Road and No. 40 George Street; from the boundary between Nos. 39 and 41 York Road to the boundary between Nos. 61 and 63 York Road
- York Road** – south east side – from a point 5 metres south west of the north eastern wall of No. 40 York Road to the south western wall of No. 40 York Road
- (e) To revoke No waiting at any time and replace with advisory driveway protection (white bar) markings on the following lengths of road:-
- Hartington Road** – south east side – from a point 1 metres south west of the north eastern boundary wall of No. 3 Hartington Road to a point 3 metres of that boundary wall
- Meadow Road (South)** – north east side – from the north western wall of No. 59 Meadow Road (South) to a point 6 metres north west of that wall
- Meadow Road (South)** – south west side – between a point 4 metres and 10 metres north west of the boundary between No. 68 and 70 Meadow Road (South)
- Middleton Road (South)** – south west side – between a point 10 metres south east and 15 metres south of the boundary between Nos. 12 and 14 Middleton Road
- Sidney Road** – north east side – from the south eastern wall of No. 24 Sidney Street in a south easterly direction for a distance of 5 metres

Windsor Road – north east side – from a point 12 metres south east of the south eastern boundary wall of No. 6 Windsor Road to a point 6 metres south east of the boundary between Nos. 6 and 8 Windsor Road

York Road – south east side – from a point 1 metre south west of the north eastern wall of the Duke of York Public House to the south western wall of No. 40 York Road

These restrictions will replace any existing restrictions currently in force in the city of Salisbury.

3. This Order shall come into operation on 10th August 2015 and may be cited as The County of Wiltshire (Salisbury) (Prohibition and Restriction of Waiting, Taxi Rank Clearways and On Street Parking) Consolidation Order 2013 (Amendment No.13) Order 2015.

FIRST SCHEDULE

Map Schedule to be revoked

Map Schedule	Date
II82 (Zone D)	11/02/2013
IJ82 (Zone D)	11/02/2013

SECOND SCHEDULE

Map Schedule to be inserted

Map Schedule	Date
II82 (Zone D)	10/08/2015
IJ82 (Zone D)	10/08/2015

THE COMMON SEAL of
WILTSHIRE COUNCIL
was hereunto affixed this
30th day of July 2015
in the presence of: -

WILTSHIRE COUNCIL

**THE COUNTY OF WILTSHIRE (SALISBURY) (PROHIBITION AND RESTRICTION
OF WAITING, TAXI RANK CLEARWAYS AND ON STREET PARKING)
CONSOLIDATION ORDER 2013 (AMENDMENT NO.14) ORDER 2015**

The Council of the County of Wiltshire in exercise of its powers under Sections 1, 2, 4, 32, 35, 45, 46, 49, 51, 53 and Part IV of Schedule 9 of the Road Traffic Regulation Act 1984 (hereinafter referred to as "the Act of 1984") as amended and the Traffic Management Act 2004 (hereinafter referred to as "the Act of 2004") as amended and of all other enabling powers and after consultation with the Chief Officer of Police in accordance with Part III of Schedule 9 to the Act of 1984 hereby makes the following Order.

1. The County of Wiltshire (Salisbury) (Prohibition and Restriction of Waiting, Taxi Rank Clearways and On Street Parking) Consolidation Order 2013 shall be amended by the removal from Article 37(a) of reference to 20 pence for fifteen minutes stay, 60 pence for up to thirty minutes stay, 1 pound 10 pence for up to forty five minutes stay and 1 pound 60 pence for up to one hour stay for a maximum stay of one hour and replacement with 50 pence for up to thirty minutes stay and 1 pound and 50 pence for up to one hour stay for a maximum stay of one hour.
2. This Order shall come into operation on 26th October 2015 and may be cited as The County of Wiltshire (Salisbury) (Prohibition and Restriction of Waiting, Taxi Rank Clearways and On Street Parking) Consolidation Order 2013 (Amendment No.14) Order 2015.

THE COMMON SEAL of
WILTSHIRE COUNCIL
was hereunto affixed this
13th day of October 2015
in the presence of: -

WILTSHIRE COUNCIL**THE COUNTY OF WILTSHIRE (SALISBURY) (PROHIBITION AND RESTRICTION
OF WAITING, TAXI RANK CLEARWAYS AND ON STREET PARKING)
CONSOLIDATION ORDER 2013 (AMENDMENT NO.15) ORDER 2016**

The Council of the County of Wiltshire in exercise of its powers under Sections 1, 2, 4, 32, 35, 45, 46, 49, 51, 53 and Part IV of Schedule 9 of the Road Traffic Regulation Act 1984 (hereinafter referred to as “the Act of 1984”) as amended and the Traffic Management Act 2004 (hereinafter referred to as “the Act of 2004”) as amended and of all other enabling powers and after consultation with the Chief Officer of Police in accordance with Part III of Schedule 9 to the Act of 1984 hereby makes the following Order.

1. The County of Wiltshire (Salisbury) (Prohibition and Restriction of Waiting, Taxi Rank Clearways and On Street Parking) Consolidation Order 2013 shall be amended by the revocation of the Map Schedule specified in the First Schedule to this Order and the insertion of the Map Schedule specified in the Second Schedule to this Order.
2. The effect of the Order will be to revoke the existing Parking Mon-Sat 8am – 6pm 2 hours No return within 4 hours and introduce **No waiting at any time** on the west side of Exeter Street – from a point 72 metres north of its junction with Carmelite Way to a point 79 metres north of that junction.

These restrictions will replace any existing restrictions currently in force in the City of Salisbury.

3. This Order shall come into operation on 15th February 2016 and may be cited as The County of Wiltshire (Salisbury) (Prohibition and Restriction of Waiting, Taxi Rank Clearways and On Street Parking) Consolidation Order 2013 (Amendment No.15) Order 2016.

FIRST SCHEDULE**Map Schedule to be revoked**

Map Schedule	Date
IM83 (Zone F)	11/02/2013

SECOND SCHEDULE

Map Schedule to be inserted

Map Schedule	Date
IM83 (Zone F)	15/02/2016

THE COMMON SEAL of
WILTSHIRE COUNCIL
was hereunto affixed this
2nd day of February 2016
in the presence of: -

WILTSHIRE COUNCIL

**THE COUNTY OF WILTSHIRE (SALISBURY) (PROHIBITION AND RESTRICTION
OF WAITING, TAXI RANK CLEARWAYS AND ON STREET PARKING)
CONSOLIDATION ORDER 2013 (AMENDMENT NO.16) ORDER 2016**

The Council of the County of Wiltshire in exercise of its powers under Sections 1, 2, 4, 32, 35, 45, 46, 49, 51, 53 and Part IV of Schedule 9 of the Road Traffic Regulation Act 1984 (hereinafter referred to as “the Act of 1984”) as amended and the Traffic Management Act 2004 (hereinafter referred to as “the Act of 2004”) as amended and of all other enabling powers and after consultation with the Chief Officer of Police in accordance with Part III of Schedule 9 to the Act of 1984 hereby makes the following Order.

1. The County of Wiltshire (Salisbury) (Prohibition and Restriction of Waiting, Taxi Rank Clearways and On Street Parking) Consolidation Order 2013 Experimental Order No.4 2015 is hereby revoked.
2. The County of Wiltshire (Salisbury) (Prohibition and Restriction of Waiting, Taxi Rank Clearways and On Street Parking) Consolidation Order 2013 shall be amended by the revocation of the Map Schedules specified in the First Schedule to this Order and the insertion of the Map Schedule specified in the Second Schedule to this Order.
3. The effect of the Order will be: -
 - (a) The inclusion of the following interpretations: -

“car club” means an organisation operating a car sharing scheme approved by the Council to operate within its boundaries;
“car club parking place” means an area of highways designated for the leaving of vehicles as indicated by appropriate road markings designating that bay as reserved for by car club vehicles;
“car club permit” means a permit issued to a car club authorised by the Council to park in a car club parking place;
“car club vehicle” means a vehicles which is provided by a car club for the use of its members subject to the rules and conditions of membership of the said car club.
 - (b) To replace Article 14 with the following wording:

**‘PART III
GENERAL PROVISIONS RELATING TO THE USE OF ON-STREET
PARKING PLACES (INCLUDING PAY AND DISPLAY BAYS),
PARKING PLACES FOR RESIDENT PERMIT HOLDERS, CAR CLUB
PERMIT HOLDERS, LOADING BAY AREAS AND DOCTORS BAYS**

14. The parts of roads identified as Parking places on the plans attached to this Order are authorised to be used, subject to the following provisions of this Order by the class of vehicle specified, if none specified then all classes of vehicle, on such days and during such permitted hours as identifies on the plans attached to this Order and in such positions as indicated by the appropriate road markings. The parts of the roads identified as Parking places for resident permit holders on the plans attached to this Order shall be used in accordance with Articles 28, 29, 30, 31 and 32 of this Order. The

parts of roads identified as Parking places for car club permit holders on the plans attached to this Order shall be used in accordance with Articles 32(a), (b), (c) and (d) of this Order. Parking places shall operate at all times unless otherwise specified in the Articles to this Order.'

- (c) The inclusion of the following articles: -

'PART IV(A)
PROVISIONS RELATING TO PARKING PLACES FOR CAR CLUB
PERMIT HOLDERS

- 32(a). The parts of roads identified on the plans attached to this Order as Parking places for car club permit holders, are authorised to be used, subject to the provisions of this Order, as parking places for use by holders of car club parking permits in accordance with Wiltshire Council's Terms and Conditions on such days and during such hours as specified in relation to those parking places and in such a position as indicated by the appropriate road signs.
- 32(b). At all times during which a vehicle is left in a parking place identified for use by car club permit holders during the permitted hours there shall be displayed in the relevant position a valid permit issued in respect of that vehicle by Wiltshire Council so that all the particulars specified by Wiltshire Council are clearly visible from the front or near-side of the vehicle.
- 33(c). The driver of a vehicle displaying at its front or near-side a valid permit issued by Wiltshire Council shall be exempt from any limitation on time in the lengths of road or on any of the sides of road identified as Parking places for car club permit holders on the plans attached to this Order.
- 33(d). Where a permit has been displayed in a vehicle, in accordance with the provisions of Article 32(b), no person being the driver of the vehicle shall remove the permit from the vehicle unless authorised to do so by the driver of the vehicle.'
- (d) to introduce **Parking Car Club Permit Holders Only** on the north west side of **York Road** from a point 18 metres north east of the boundary between No. 9 York Road and No. 1 Belgrave Terrace, York Road to a point 5 metres south west of the north eastern boundary wall of No. 1 Sidney Street.

These restrictions will replace any existing restrictions currently in force in the city of Salisbury.

4. This Order shall come into operation on 9th May 2016 and may be cited as The County of Wiltshire (Salisbury) (Prohibition and Restriction of Waiting, Taxi Rank Clearways and On Street Parking) Consolidation Order 2013 (Amendment No.16) Order 2016.

FIRST SCHEDULE

Map Schedules to be revoked

Map Schedule	Date
II82 (Zone D)	10/08/2015
II82 (Zone D)	28/09/2015

SECOND SCHEDULE

Map Schedule to be inserted

Map Schedule	Date
II82 (Zone D)	09/05/2016

THE COMMON SEAL of
WILTSHIRE COUNCIL
was hereunto affixed this
26th day of April 2016
in the presence of: -

WILTSHIRE COUNCIL**THE COUNTY OF WILTSHIRE (SALISBURY) (PROHIBITION AND RESTRICTION
OF WAITING, TAXI RANK CLEARWAYS AND ON STREET PARKING)
CONSOLIDATION ORDER 2013 (AMENDMENT NO.17) ORDER 2018**

The Council of the County of Wiltshire in exercise of its powers under Sections 1, 2, 4, 32, 35, 45, 46, 49, 51, 53 and Part IV of Schedule 9 of the Road Traffic Regulation Act 1984 (hereinafter referred to as “the Act of 1984”) as amended and the Traffic Management Act 2004 (hereinafter referred to as “the Act of 2004”) as amended and of all other enabling powers and after consultation with the Chief Officer of Police in accordance with Part III of Schedule 9 to the Act of 1984 hereby makes the following Order.

1. The County of Wiltshire (Salisbury) (Prohibition and Restriction of Waiting, Taxi Rank Clearways and On Street Parking) Consolidation Order 2013 shall be amended by the revocation of the Map Schedules specified in the First Schedule to this Order and the insertion of the Map Schedules specified in the Second Schedule to this Order.
2. The effect of the Order will be:
 - (a) To introduce **No Waiting at any time and No Loading Monday to Friday 8am – 6pm** on the following lengths of road:
 - Stratford Road** – north east side – from a point 8 metres north west of the centreline of the vehicular access to Victoria Park to a point 32 metres north west of that centreline
 - Stratford Road** – north east side – from a point 10 metres south east of the centreline of the vehicular access to Victoria Park to a point 33 metres south east of that centreline
 - Stratford Road** – south west side – from a point 4 metres north west of the centreline of the vehicular access to South Wilts Grammar School, Stratford Road to a point 26 metres north west of that centreline
 - (b) To introduce **No Loading Monday to Friday 8am – 6pm** on the following lengths of road:
 - Stratford Road** – north east side – from a point 14 metres north west of a point in line with the boundary between property Nos. 8 and 10 Stratford Road to a point 33 metres south east of the centreline of the vehicular access to Victoria Park
 - Stratford Road** – north east side – from a point 10 metres south east of the centreline of the vehicular access to Victoria Park to a point 8 metres north west of that centreline
 - Stratford Road** – north east side – from a point 32 metres north west of the centreline of the vehicular access to Victoria Park to a point in line with the boundary between property Nos. 16 and 18 Stratford Road
 - Stratford Road** – south west side – from a point 27 metres south east of the centreline of the vehicular access to South Wilts Grammar School, Stratford Road to a point 4 metres north west of that centreline

These restrictions will replace any existing restrictions currently in force in the City of Salisbury.

3. This Order shall come into operation on 11th June 2018 and may be cited as The County of Wiltshire (Salisbury) (Prohibition and Restriction of Waiting, Taxi Rank Clearways and On Street Parking) Consolidation Order 2013 (Amendment No.17) Order 2018.

FIRST SCHEDULE

Map Schedule to be revoked

Map Schedule	Date
IF83 (Zone H)	03/02/2014
IG83 (Zone H)	03/02/2014

SECOND SCHEDULE

Map Schedule to be inserted

Map Schedule	Date
IF83 (Zone H)	11/06/2018
IG83 (Zone H)	11/06/2018

THE COMMON SEAL of
WILTSHIRE COUNCIL
was hereunto affixed this
29th day of May 2018
in the presence of: -

Wiltshire Council seal: 87199

WILTSHIRE COUNTY COUNCIL

NOTICE OF PENALTY CHARGES

**CIVIL ENFORCEMENT AREAS AND SPECIAL ENFORCEMENT AREAS
IN THE DISTRICTS OF KENNET, NORTH WILTSHIRE AND SALISBURY**

NOTICE IS HEREBY GIVEN that Wiltshire County Council in accordance with its powers under the Traffic Management Act 2004 and in consultation with the Secretary of State for Transport has amended the level of Penalty Charges in the designated parking areas in the Districts of Kennet, North Wiltshire and Salisbury. These relate to the Civil Enforcement of on-street parking contraventions for waiting/loading and parking restrictions.

Two levels of Penalty Charge have been set for different contraventions (previously one level which was £60). The Penalty Charges are £70 on the issue of a Penalty Charge Notice ("PCN") for Higher Level contraventions and £50 on the issue of a PCN for Lower Level contraventions in accordance with The Civil Enforcement of Parking Contraventions (Guidelines on Levels of Charges) (England) Order 2007 but discounted by 50% if payment is received within 14 days of the issue of the PCN (as before) or if payment is received within 21 days for contraventions detected with a camera (approved device).

On the issue of a Charge Certificate in accordance with The Civil Enforcement of Parking Contraventions (Guidelines on Levels of Charges) (England) Order 2007 the penalty charge will be increased by 50% (as before).

The above charges will come into effect on 31 March 2008.

GEORGE BATTEN
Director of Environmental Services
County Hall, Trowbridge, BA14 8JD

6 March 2008

WILTSHIRE COUNCIL**ROAD TRAFFIC REGULATION ACT 1984****THE COUNTY OF WILTSHIRE (SALISBURY) (PROHIBITION AND RESTRICTION
OF WAITING, TAXI RANK CLEARWAYS AND ON STREET PARKING)
CONSOLIDATION ORDER 2013 EXPERIMENTAL ORDER NO.3 2015
REVOCATION ORDER 2016**

The Council of the County of Wiltshire in exercise of its powers under Sections 1, 2, 4, 32, 35, 45, 46, 49, 51, 53 and Part IV of Schedule 9 of the Road Traffic Regulation Act 1984 (hereinafter referred to as "the Act") as amended and of all other enabling powers and after consultation with the Chief Officer of Police in accordance with Part III of Schedule 9 to the Act hereby makes the following Order: -

1. The County of Wiltshire (Salisbury) (Prohibition and Restriction of Waiting, Taxi Rank Clearways and On Street Parking) Consolidation Order 2013 Experimental Order No.3 2015 is hereby revoked along with the Map Schedule specified in the First Schedule to this Order and the reinstating of the Map Schedule specified in the Second Schedule to this Order.
2. This Order shall come into operation on 7th March 2016 and may be cited as The County of Wiltshire (Salisbury) (Prohibition and Restriction of Waiting, Taxi Rank Clearways and On Street Parking) Consolidation Order 2013 Experimental Order No.3 2015 Revocation Order 2016.

FIRST SCHEDULE**Map Schedule to be revoked**

Map Schedule	Date
IK84 (Zone E)	06/07/2015

SECOND SCHEDULE**Map schedule to be reinstated**

Map Schedule	Date
IK84 (Zone E)	29/12/2014

THE COMMON SEAL of the
WILTSHIRE COUNCIL
was hereunto affixed this
23rd day of February 2016
in the presence of: -

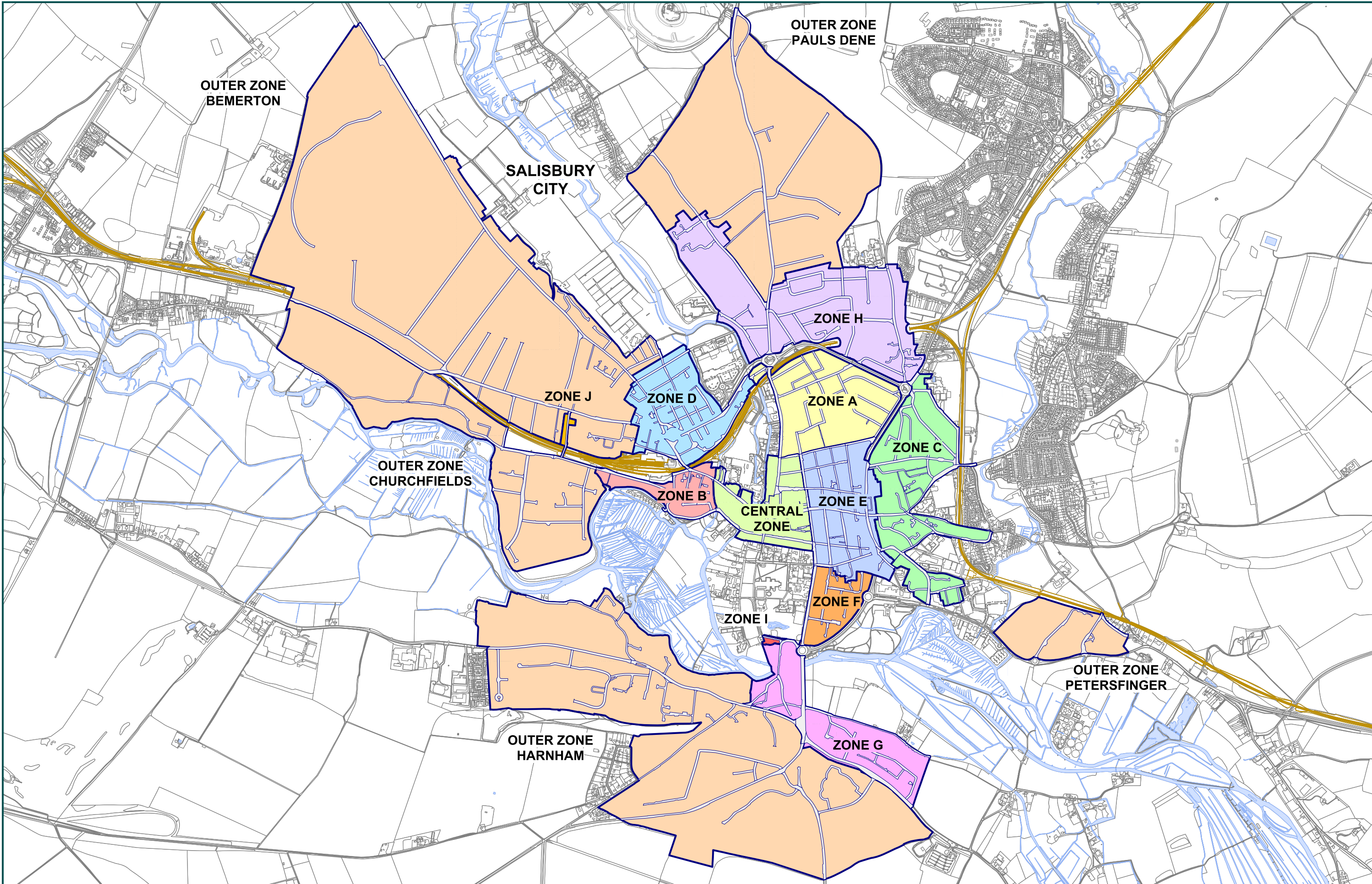

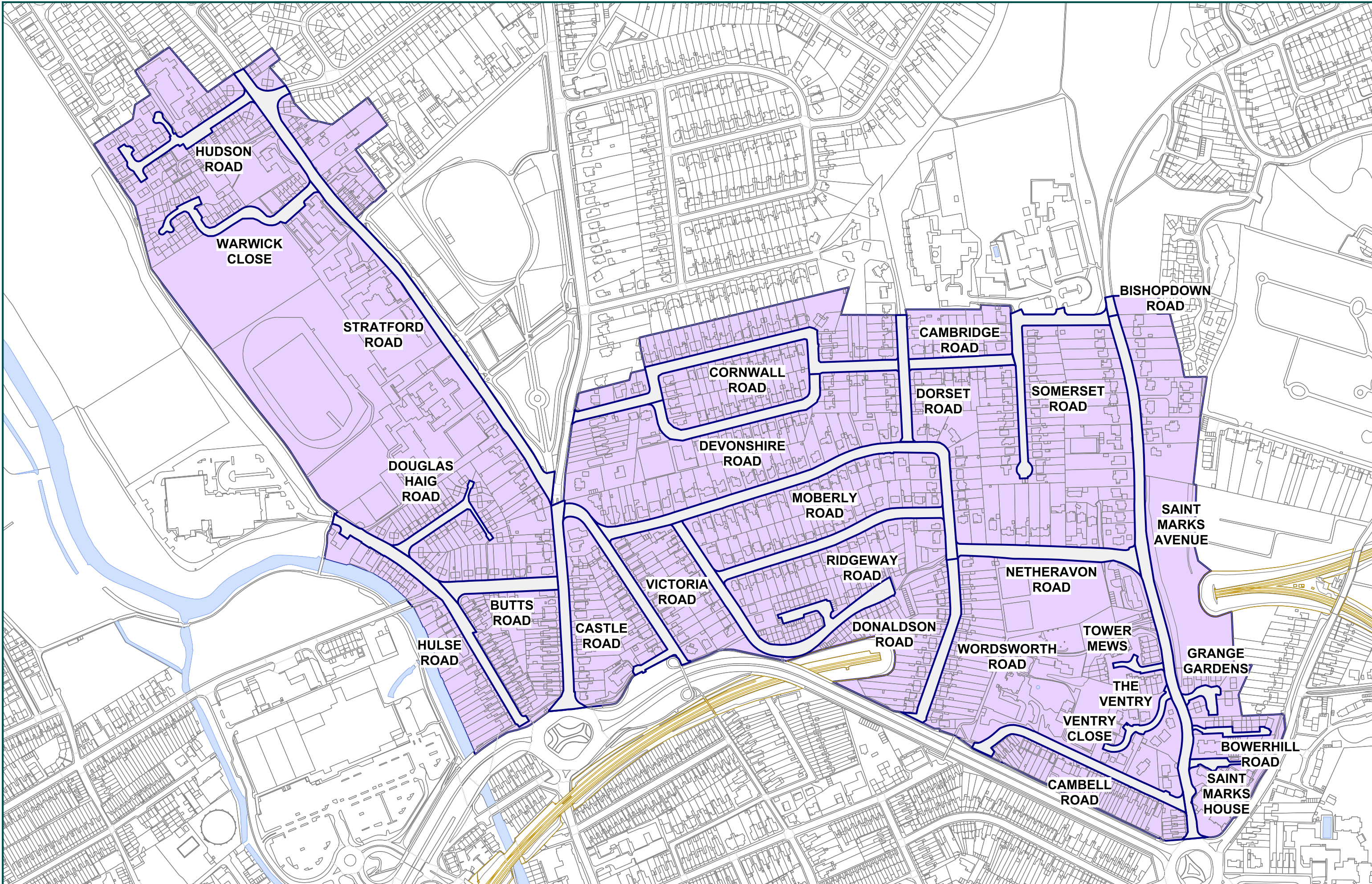

ZONE H				
STREET NAME		MAP SCHEDULE		
BISHOPDOWN ROAD	IF84	IG84		
BOWERHILL ROAD	* IH84	IH85		
BUTTS ROAD	IH83			
CAMBELL ROAD	IH84	* II84		
CAMBRIDGE ROAD	IG84			
CASTLE ROAD 25-61 and 18-72	IG83	IH83		
CORNWALL ROAD	IG83	IG84	IH84	
DEVONSHIRE ROAD	IG83	IG84		
DONALDSON ROAD	IG83	IH83		
DORSET ROAD	IG84			
DOUGLAS HAIG ROAD	IG83			
GRANGE GARDENS	IH84			
HUDSON CLOSE	IF82			
HULSE ROAD	IG82	IG83	IH83	
MOBERLY ROAD	IG83	IG84		
NETHERAVON ROAD	IG84	IH84		
RIDGEWAY ROAD	IG83	IG84	IH83	
SAINT MARKS AVENUE	IG84	IH84	II84	
SAINT MARKS HOUSE	IH84	IH85		
STRATFORD ROAD	IF82	IF83	IG83	
SOMERSET ROAD	IG84			
THE VENTRY	IH84			
TOWER MEWS	IH84			
VENTRY CLOSE	IH84			
VICTORIA ROAD	IG83	IH83		
WARWICK CLOSE	IF82			
WORDSWORTH ROAD	IH84			

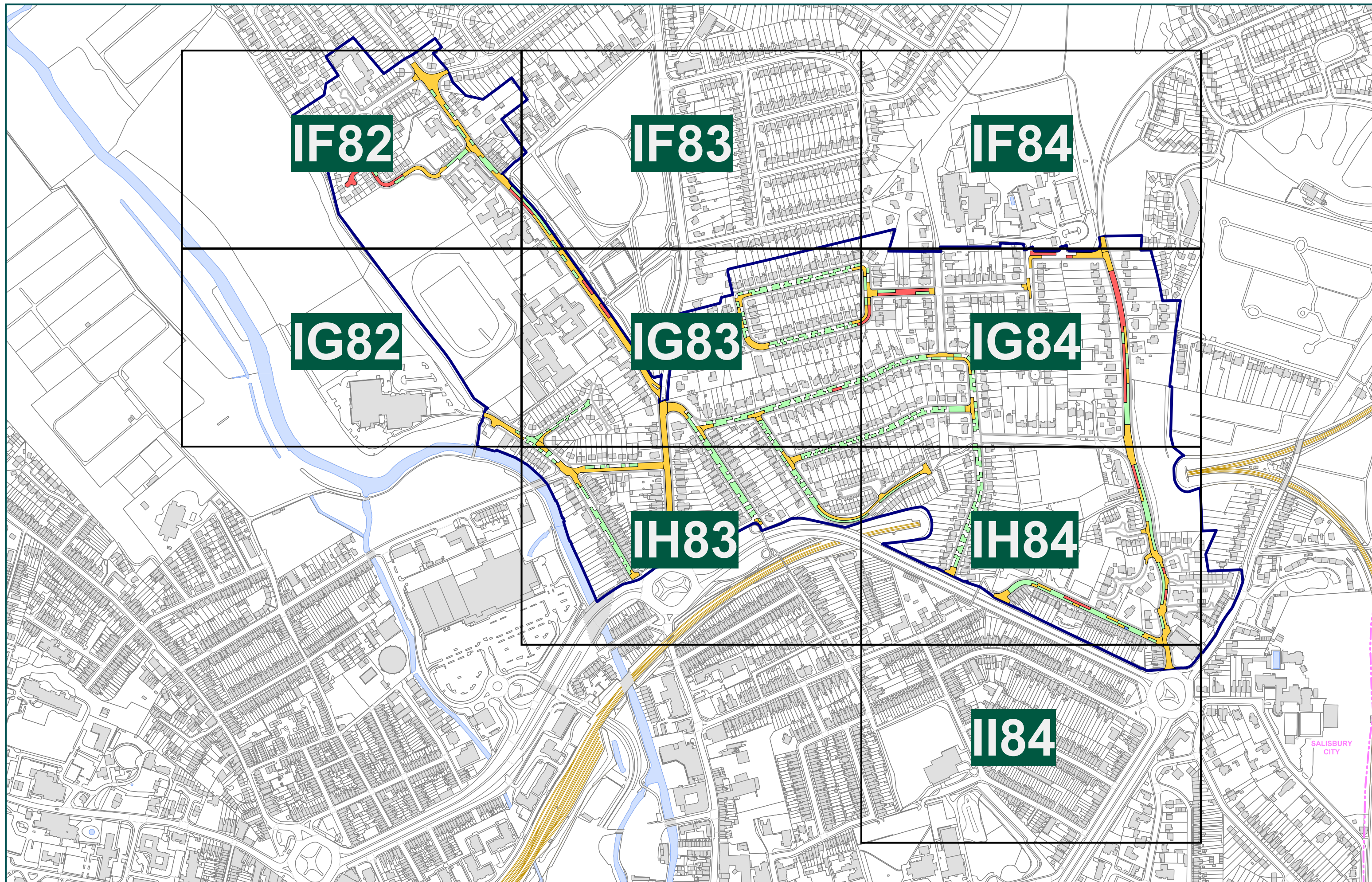

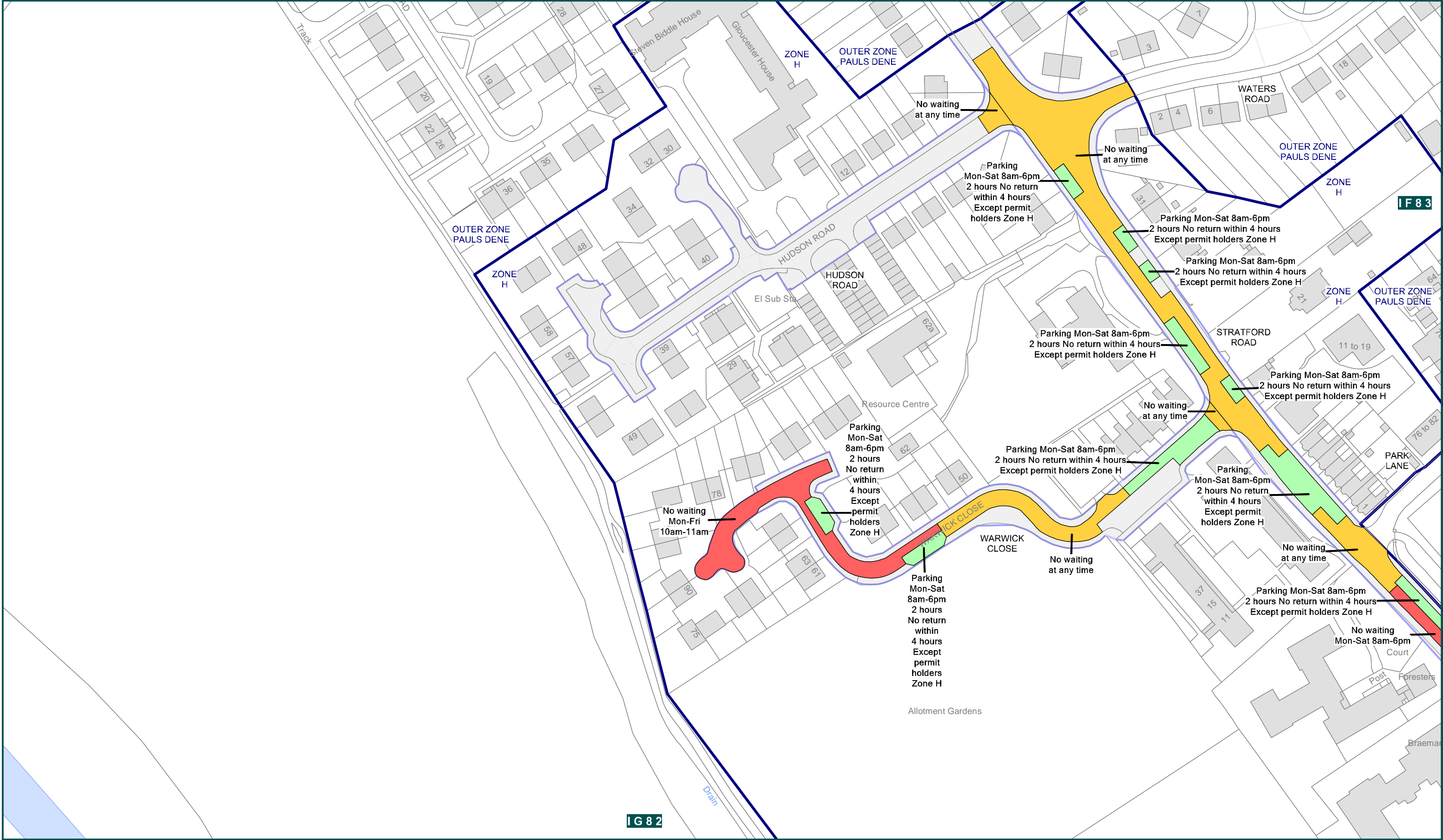

<div>Wiltshire Council</div> <div>Where everybody matters</div>	<div>The County of Wiltshire (Salisbury City)</div> <div>(Prohibition and Restriction of Waiting, Taxi Rank Clearways and On Street Parking) Consolidation Order - Zone H</div> <div>Crown copyright and database rights 2014 Ordnance Survey 100049050</div>						SCALE	1: 1250 @ A3	
							DATE	03/02/2014	
<div>Wiltshire Council</div> <div>County Hall, Bythesea Road,</div> <div>Trowbridge, Wiltshire.</div> <div>BA14 8JN</div>	<div>KEY</div> <div><div><div>PARKING</div><div>RESIDENT PARKING</div><div>PAY AND DISPLAY</div></div><div><div>DISABLED PARKING</div><div>DOCTOR PARKING</div><div>MOTORCYCLE PARKING</div><div>LOADING</div></div><div><div>NO WAITING</div><div>NO WAITING AND NO LOADING</div><div>NO WAITING AND NO LOADING AT ANY TIME</div><div>MULTIPLE RESTRICTIONS</div></div><div><div>NO WAITING AT ANY TIME</div><div>NO WAITING AT ANY TIME AND NO LOADING</div><div>NO WAITING AT ANY TIME AND NO LOADING AT ANY TIME</div><div>PEDESTRIAN ZONE</div></div><div><div>TAXI CLEARWAY</div><div>CLEARWAY</div><div>ZONE</div><div>ZONE ROAD</div></div><div><div>EXPERIMENTAL RESTRICTIONS</div></div></div>						FILE	SALSZONH2013	
							<div><div>N</div><div>W</div><div>O</div><div>E</div><div>S</div></div>	MAP SCHEDULE	IF82



<div><div>Wiltshire Council</div><div>Where everybody matters</div></div> <div>Wiltshire Council County Hall, Bythesea Road, Trowbridge, Wiltshire. BA14 8JN</div>	<div>The County of Wiltshire (Salisbury City) (Prohibition and Restriction of Waiting, Taxi Rank Clearways and On Street Parking) Consolidation Order Zone H</div> <div>Crown copyright and database rights 2018 Ordnance Survey 100049050</div>						SCALE	1: 1250 @ A3	
							DATE	11/06/2018	
	<div><div>KEY</div><div><div><div>PARKING</div><div>RESIDENT PARKING</div><div>PAY AND DISPLAY</div></div><div><div>DISABLED PARKING</div><div>DOCTOR PARKING</div><div>MOTORCYCLE PARKING</div><div>LOADING</div></div><div><div>NO WAITING</div><div>NO WAITING AND NO LOADING</div><div>NO WAITING AND NO LOADING AT ANY TIME</div><div>MULTIPLE RESTRICTIONS</div></div><div><div>NO WAITING AT ANY TIME</div><div>NO WAITING AT ANY TIME AND NO LOADING</div><div>NO WAITING AT ANY TIME AND NO LOADING AT ANY TIME</div><div>PEDESTRIAN ZONE</div></div><div><div>TAXI CLEARWAY</div><div>CLEARWAY</div><div>ZONE</div><div>ZONE ROAD</div></div><div><div>EXPERIMENTAL RESTRICTIONS</div></div></div></div>						FILE	SALSZONH2013	
							<div><div>N</div><div>W</div><div>E</div><div>S</div></div> <div>MAP SCHEDULE</div>	IF83	

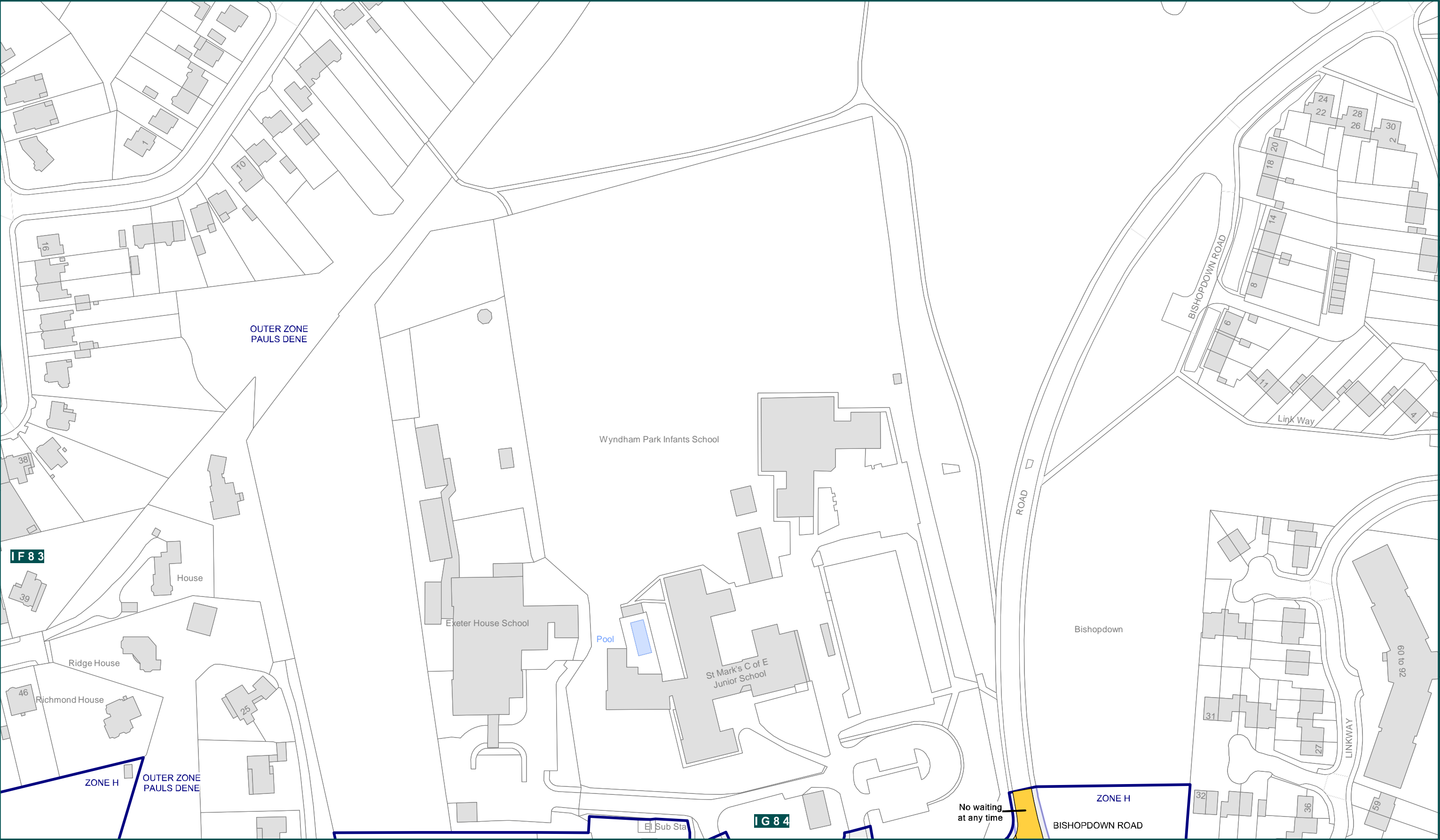

<div><div>Wiltshire Council</div><div>Where everybody matters</div></div> <div>Wiltshire Council County Hall, Bythesea Road, Trowbridge, Wiltshire. BA14 8JN</div>	<div><div>The County of Wiltshire (Salisbury City)</div><div>(Prohibition and Restriction of Waiting, Taxi Rank Clearways and On Street Parking) Consolidation Order - Zone H</div><div>Crown copyright and database rights 2014 Ordnance Survey 100049050</div></div>	SCALE1: 1250 @ A3	
		DATE03/02/2014	
	<div><div>KEY</div><div><div><div>PARKING</div><div>RESIDENT PARKING</div><div>PAY AND DISPLAY</div></div><div><div>DISABLED PARKING</div><div>DOCTOR PARKING</div><div>MOTORCYCLE PARKING</div><div>LOADING</div></div><div><div>NO WAITING</div><div>NO WAITING AND NO LOADING</div><div>NO WAITING AND NO LOADING AT ANY TIME</div><div>MULTIPLE RESTRICTIONS</div></div><div><div>NO WAITING AT ANY TIME</div><div>NO WAITING AT ANY TIME AND NO LOADING</div><div>NO WAITING AT ANY TIME AND NO LOADING AT ANY TIME</div><div>PEDESTRIAN ZONE</div></div><div><div>TAXI CLEARWAY</div><div>CLEARWAY</div><div>ZONE</div><div>ZONE ROAD</div></div><div><div>EXPERIMENTAL RESTRICTIONS</div></div></div></div>	FILESALSZONH2013	
<div><div>N</div><div>W</div><div>E</div><div>S</div></div>	MAP SCHEDULE		IF84

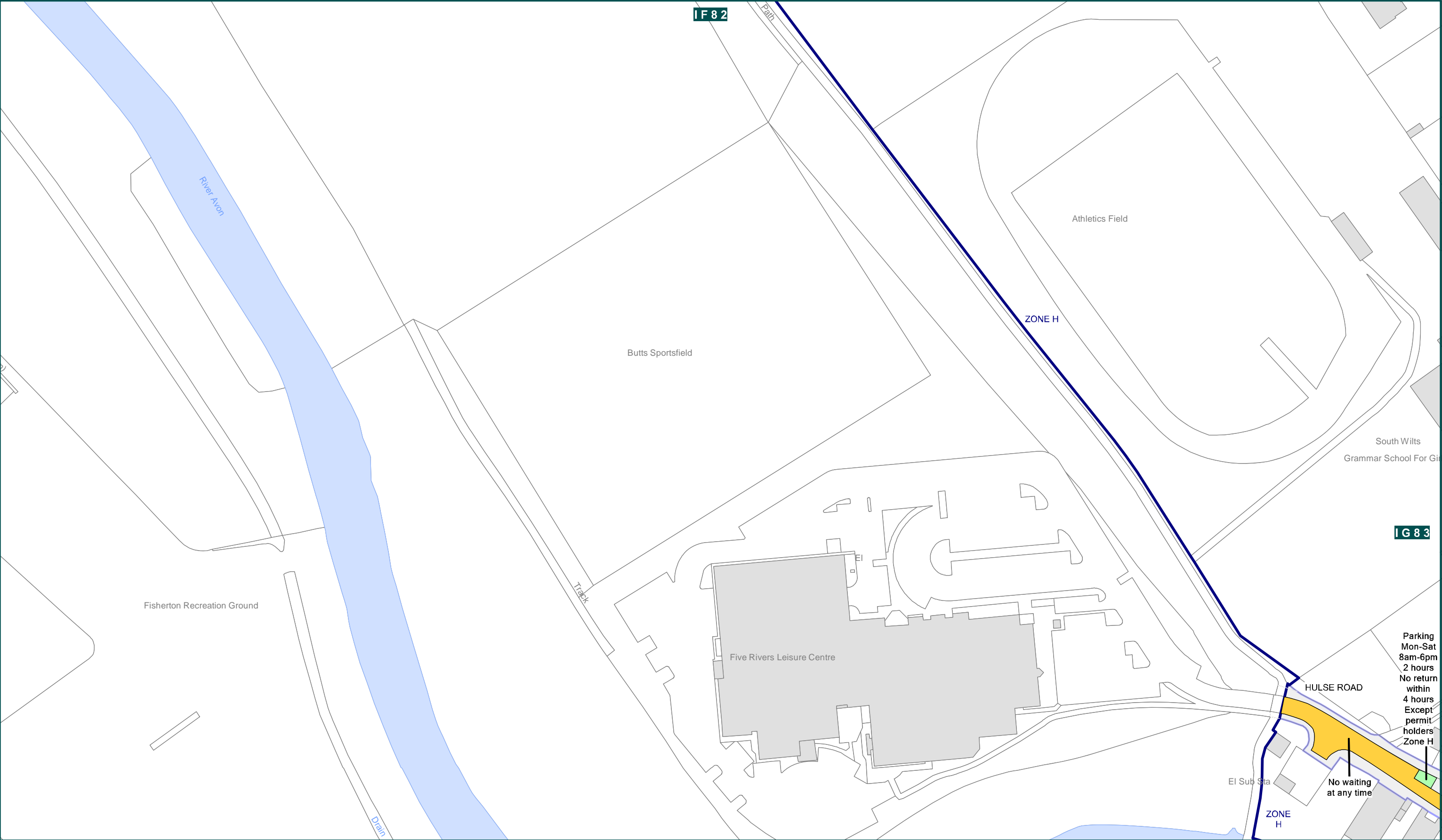

<div><div>Wiltshire Council</div><div>Where everybody matters</div></div>	<div><div>The County of Wiltshire (Salisbury City)</div><div>(Prohibition and Restriction of Waiting, Taxi Rank Clearways and On Street Parking) Consolidation Order - Zone H</div><div>Crown copyright and database rights 2014 Ordnance Survey 100049050</div></div>						SCALE	1: 1250 @ A3	
							DATE	03/02/2014	
<div>Wiltshire Council</div> <div>County Hall, Bythesea Road,</div> <div>Trowbridge, Wiltshire.</div> <div>BA14 8JN</div>	<div><div>KEY</div><div><div><div></div><div>PARKING</div></div><div><div></div><div>RESIDENT PARKING</div></div><div><div></div><div>PAY AND DISPLAY</div></div><div><div></div><div>DISABLED PARKING</div></div><div><div></div><div>DOCTOR PARKING</div></div><div><div></div><div>MOTORCYCLE PARKING</div></div><div><div></div><div>LOADING</div></div><div><div></div><div>NO WAITING</div></div><div><div></div><div>NO WAITING AND NO LOADING</div></div><div><div></div><div>NO WAITING AND NO LOADING AT ANY TIME</div></div><div><div></div><div>MULTIPLE RESTRICTIONS</div></div><div><div></div><div>NO WAITING AT ANY TIME</div></div><div><div></div><div>NO WAITING AT ANY TIME AND NO LOADING</div></div><div><div></div><div>NO WAITING AT ANY TIME AND NO LOADING AT ANY TIME</div></div><div><div></div><div>PEDESTRIAN ZONE</div></div><div><div></div><div>TAXI CLEARWAY</div></div><div><div></div><div>CLEARWAY</div></div><div><div></div><div>ZONE</div></div><div><div></div><div>ZONE ROAD</div></div><div><div></div><div>EXPERIMENTAL RESTRICTIONS</div></div></div></div>						FILE	SALSZONH2013	
							<div><div>N</div><div>W</div><div>S</div><div>E</div></div>	MAP SCHEDULE	IG82

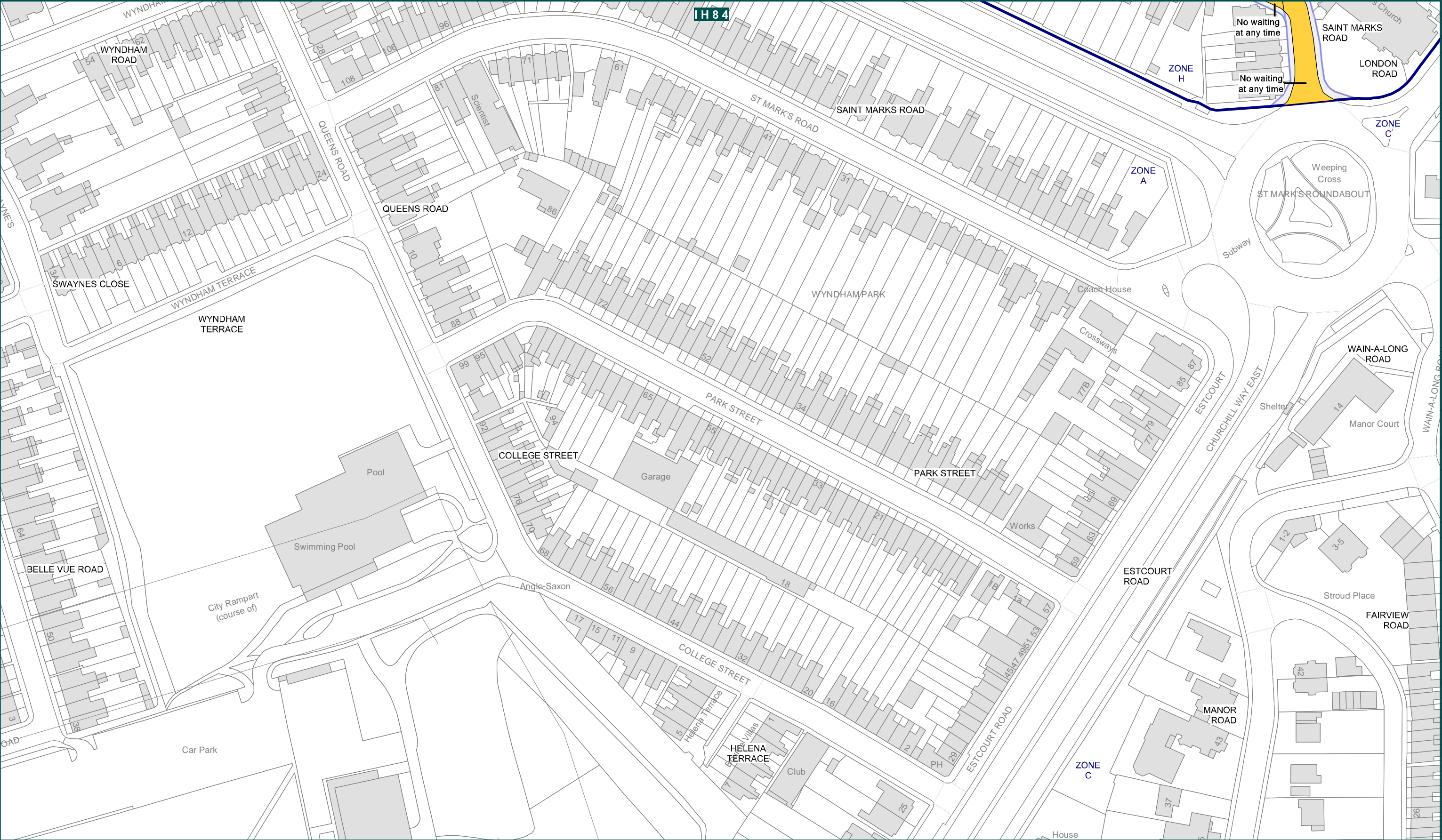

<div><div>Wiltshire Council</div><div>Where everybody matters</div></div>	<div><div>The County of Wiltshire (Salisbury City)</div><div>(Prohibition and Restriction of Waiting, Taxi Rank Clearways and On Street Parking) Consolidation Order - Zone H</div><div>Crown copyright and database rights 2014 Ordnance Survey 100049050</div></div>						SCALE	1: 1250 @ A3	
							DATE	03/02/2014	
<div>Wiltshire Council</div> <div>County Hall, Bythesea Road,</div> <div>Trowbridge, Wiltshire.</div> <div>BA14 8JN</div>	<div><div>KEY</div><div><div><div>PARKING</div><div>RESIDENT PARKING</div><div>PAY AND DISPLAY</div></div><div><div>DISABLED PARKING</div><div>DOCTOR PARKING</div><div>MOTORCYCLE PARKING</div><div>LOADING</div></div><div><div>NO WAITING</div><div>NO WAITING AND NO LOADING</div><div>NO WAITING AND NO LOADING AT ANY TIME</div><div>MULTIPLE RESTRICTIONS</div></div><div><div>NO WAITING AT ANY TIME</div><div>NO WAITING AT ANY TIME AND NO LOADING</div><div>NO WAITING AT ANY TIME AND NO LOADING AT ANY TIME</div><div>PEDESTRIAN ZONE</div></div><div><div>TAXI CLEARWAY</div><div>CLEARWAY</div><div>ZONE</div><div>ZONE ROAD</div></div><div><div>EXPERIMENTAL RESTRICTIONS</div></div></div></div>						FILE	SALSZONH2013	
							<div><div>N</div><div>W</div><div>E</div><div>S</div></div>	MAP SCHEDULE	I184

SALISBURY CITY - ZONE H - REVISION

ITEM	SCHEDULE NUMBER	OPERATIONAL DATE	OPERATIONAL	ORDER NUMBER	REVOKED DATE	REVOKED	REVOKED BY
Front cover		11/06/2018	000-salisbury-zone-h-cover-2018-06-11				
Area map		11/06/2018	00-salisbury-area-2018-06-11				
Articles		11/02/2013	01-salisbury-articles-2013-02-11	Sealed order: 2771			
Amendment 01		03/02/2014	02-salisbury-amendment-01-2014-02-03	Sealed order: 2857			
Amendment 02		02/06/2014	02-salisbury-amendment-02-2014-06-02	Sealed order: 2872			
Amendment 03 [2013]		30/09/2013	02-salisbury-amendment-03-2013-09-30	Sealed order: 2825			
Amendment 03 [2014]		03/02/2014	02-salisbury-amendment-03-2014-02-03	Sealed order: 2856			
Amendment 04		18/11/2013	02-salisbury-amendment-04-2013-11-18	Sealed order: 2836			
Amendment 05		22/06/2015	02-salisbury-amendment-05-2015-06-22	Sealed order: 2923			
Amendment 06		29/12/2014	02-salisbury-amendment-06-2014-12-29	Sealed order: 2887			
Amendment 07		23/02/2015	02-salisbury-amendment-07-2015-02-23	Sealed order: 2896			
Amendment 08		28/07/2014	02-salisbury-amendment-08-2014-07-28	Sealed order: 2882			
Amendment 09		05/05/2015	02-salisbury-amendment-09-2015-05-05	Sealed order: 2915			
Amendment 10		15/08/2016	02-salisbury-amendment-10-2016-08-15	Sealed order: 3031			
Amendment 11		31/07/2017	02-salisbury-amendment-11-2017-07-31	Sealed order: 3090			
Amendment 13		10/08/2015	02-salisbury-amendment-13-2015-08-10	Sealed order: 2932			
Amendment 14		26/10/2015	02-salisbury-amendment-14-2015-02-26	Sealed order: 2956			
Amendment 15		15/02/2016	02-salisbury-amendment-15-2016-02-15	Sealed order: 2983			
Amendment 16		09/05/2016	02-salisbury-amendment-16-2016-05-09	Sealed order: 3003			
Amendment 17		11/06/2018	02-salisbury-amendment-17-2018-06-11	Sealed order: 3142			
Penalty Charge Notice 01		31/03/2008	05-salisbury-penalty-01-2008-03-31	Order: 2468			
Revocation Order 03		07/03/2016	06-salisbury-revocation-03-2016-03-07	Order: 2994			

SALISBURY CITY - ZONE H - REVISION

ITEM	SCHEDULE NUMBER	OPERATIONAL DATE	OPERATIONAL	ORDER NUMBER	REVOKED DATE	REVOKED	REVOKED BY
Zone map		11/06/2018	12-salisbury-city-zones-2018-06-11				
Street map		11/06/2018	13-salisbury-zone-h-street-2018-06-11				
Street gazetteer		11/06/2018	14-salisbury-zone-h-gazetteer-2018-06-11				
Overview (9 map schedules)		11/06/2018	15-salisbury-zone-h-overview-2018-06-11				
Map schedule	IF82	03/02/2014	salisbury-zone-h-map-schedule-if82-2014-02-03				
Map schedule	IF83	11/06/2018	salisbury-zone-h-map-schedule-if83-2018-00-11		03/02/2014	salisbury-zone-h-map-schedule-if83-2014-02-03	Sealed order: 3142
Map schedule	IF84	03/02/2014	salisbury-zone-h-map-schedule-if84-2014-02-03				
Map schedule	IG82	03/02/2014	salisbury-zone-h-map-schedule-ig82-2014-02-03				
Map schedule	IG83	11/06/2018	salisbury-zone-h-map-schedule-ig83-2018-06-11		03/02/2014	salisbury-zone-h-map-schedule-ig83-2014-02-03	Sealed order: 3142
Map schedule	IG84	03/02/2014	salisbury-zone-h-map-schedule-ig84-2014-02-03				
Map schedule	IH83	03/02/2014	salisbury-zone-h-map-schedule-ih83-2014-02-03				
Map schedule	IH84	03/02/2014	salisbury-zone-h-map-schedule-ih84-2014-02-03				
Map schedule	II84	03/02/2014	salisbury-zone-h-map-schedule-ii84-2014-02-03				