

WEST SUSSEX COUNTY COUNCIL
((WORTHING) (PARKING PLACES & TRAFFIC REGULATION)
(CONSOLIDATION) ORDER 2007)
(GORING-BY-SEA: MARINE DRIVE AND MARINE CRESCENT
AMENDMENT) ORDER 2016

WORTHING: LOCATION OF WAITING RESTRICTIONS

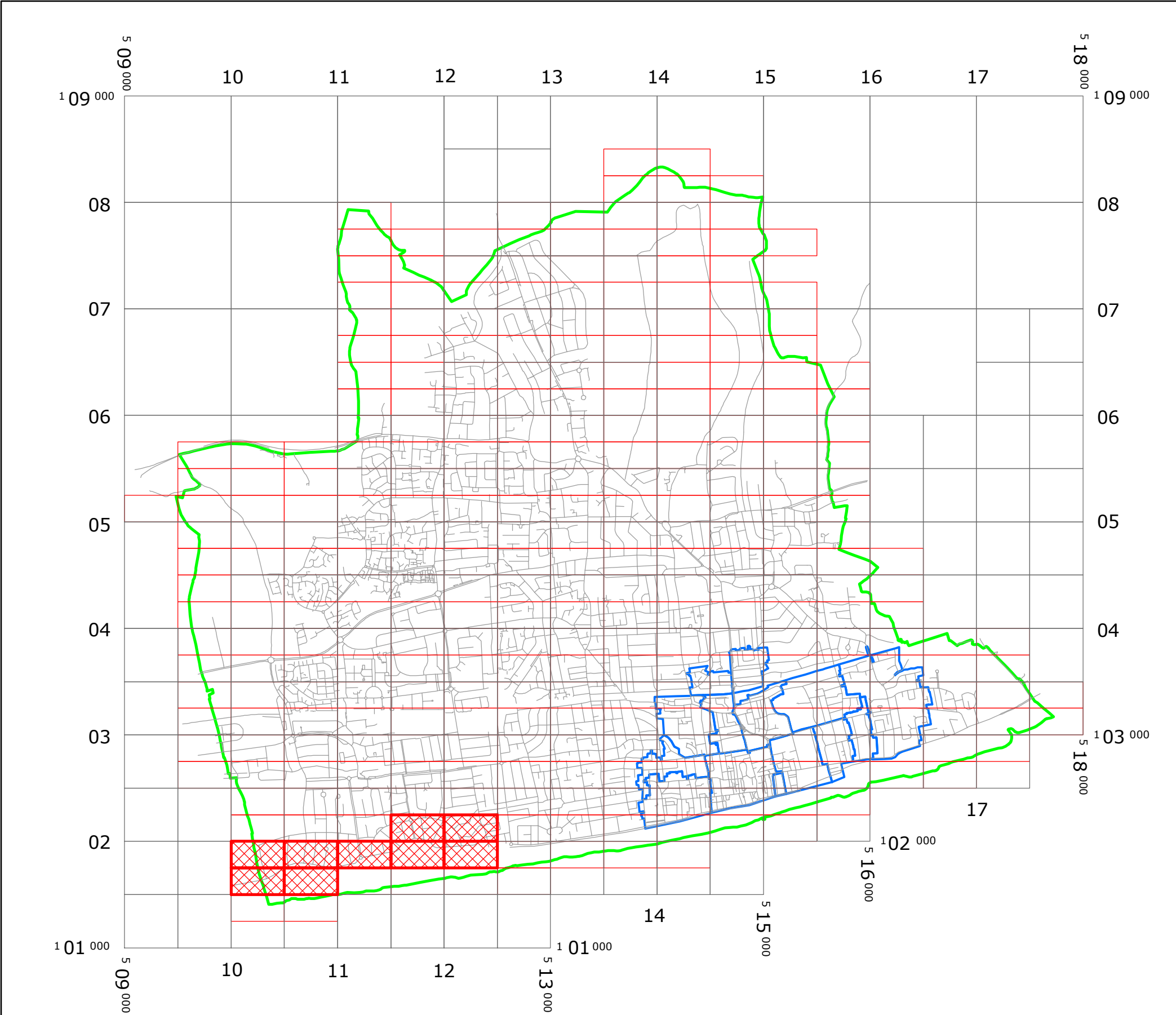

KEY:

OS TILE GRID

PARKING TILE GRID

LOCATION OF WAITING RESTRICTIONS

PARISH BOUNDARY

WORTHING CONTROLLED PARKING ZONE

ROAD NETWORK



West Sussex County Council
 Residents & Environmental Services
 The Grange, Tower Street
 Chichester
 West Sussex
 PO19 1RH

WEST SUSSEX COUNTY COUNCIL
 ((WORTHING) (PARKING PLACES & TRAFFIC REGULATION)
 (CONSOLIDATION) ORDER 2007)
 (GORING-BY-SEA: MARINE DRIVE AND MARINE CRESCENT
 AMENDMENT) ORDER 2016
 LOCATION OF WAITING RESTRICTIONS



Reproduced from or based upon 2013 Ordnance Survey material with permissions of the Controller of HMSO
 (c) Crown Copyright reserved. Unauthorised reproduction infringes Crown copyright and may lead to
 prosecution or civil proceedings West Sussex County Council Licence No. 100023447

SCALE: 1:40,000
 DATE: 05/09/2016

Key for Waiting Restrictions

All areas over which the provision of the orders apply are defined by the shaded areas as shown on the following plans plus a contiguous area not indicated on the plans of verge and/or footway between the carriageway edge and the highway boundary. The plans in this schedule are based upon grid references of the Ordnance Survey National Grid defined by the OSGB 36 triangulation.

Prohibition of waiting at any time

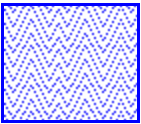
101		check	No waiting at any time
197		herring3	No waiting for motor caravans 10.00pm-9.00am any day

WEST SUSSEX COUNTY COUNCIL
((WORTHING) (PARKING PLACES & TRAFFIC REGULATION)
(CONSOLIDATION) ORDER 2007)

(GORING-BY-SEA: MARINE DRIVE & MARINE CRESCENT AMENDMENT)
ORDER 2016

West Sussex County Council in exercise of their powers under Sections 1 (1) 2 (1) and (2), 4 (2), 45, 46, 49 and 53 and Part IV of Schedule 9 of the Road Traffic Regulation Act 1984 ("the Act") as amended and of all other enabling powers and after consultation with the Chief Officer of Police in accordance with Part III of Schedule 9 to the Act hereby make the following Order:-

1. This Order shall come into operation on the Fifth day of September 2016 and may be cited as "West Sussex County Council ((Worthing) (Parking Places & Traffic Regulation) (Consolidation) Order 2007) (Goring-by-Sea: Marine Drive & Marine Crescent Amendment) Order 2016".
2. The West Sussex County Council (Worthing) (Parking Places & Traffic Regulation) (Consolidation) Order 2007 is hereby amended by the insertion of the following interpretation into Article 3.1:

"motor caravan" means a motor vehicle which is constructed or adapted for the carriage of passengers and their effects and which contains, as permanently installed equipment, the facilities which are reasonably necessary for enabling the vehicle to provide mobile living accommodation for its users.
3. The "West Sussex County Council (Worthing) (Parking Places & Traffic Regulation) (Consolidation) Order 2007" is hereby amended by the replacement of the plans specified in the First Schedule to this Order, with the plans specified in the Second Schedule, attached hereto.
4. The "West Sussex County Council (Worthing) (Parking Places & Traffic Regulation) (Consolidation) Order 2007" is hereby amended by the insertion of the plan specified in the Third Schedule to this Order, attached hereto.

FIRST SCHEDULE
Plans to be Replaced

TQ1001NEN (Issue Number 1)
TQ1001NWN (Issue Number 1)
TQ1001NWS (Issue Number 1)
TQ1101NEN (Issue Number 1)
TQ1101NWN (Issue Number 1)
TQ1102SES (Issue Number 1)
TQ1201NWN (Issue Number 2)
TQ1202SWS (Issue Number 2)

SECOND SCHEDULE
Replacement Plans

TQ1001NEN (Issue Number 2)
TQ1001NWN (Issue Number 2)
TQ1001NWS (Issue Number 2)
TQ1101NEN (Issue Number 2)
TQ1101NWN (Issue Number 2)
TQ1102SES (Issue Number 2)
TQ1201NWN (Issue Number 3)
TQ1202SWS (Issue Number 3)

THIRD SCHEDULE
Plan to be inserted

TQ1001NES (Issue Number 1)

THE Common Seal of THE
WEST SUSSEX COUNTY COUNCIL
was hereto affixed the

day of ^{FIRST} SEPTEMBER 2016

Authorised Signatory
WOR8014-MM



09/08 DELEGATED AUTHORITY



No waiting
at any time

No waiting
for motor caravans
10.00pm-9.00am
any day



West Sussex County Council
Highways & Transport
The Grange
Tower Street
Chichester
West Sussex
PO19 1RH

WORTHING BOROUGH: GORING WARD

WAITING RESTRICTIONS

Reproduced from or based upon 2013 Ordnance Survey material with permission of the Controller of HMSO (c) Crown Copyright reserved.
Unauthorised reproduction infringes Crown copyright and may lead to prosecution or civil proceedings West Sussex County Council Licence No. 100023447

TILE REF NO:
TQ1001NEN

SHEET ISSUE NO 2
SHEET ACTIVE FROM - 05/09/2016



SCALE:
1:1250
at A3 size

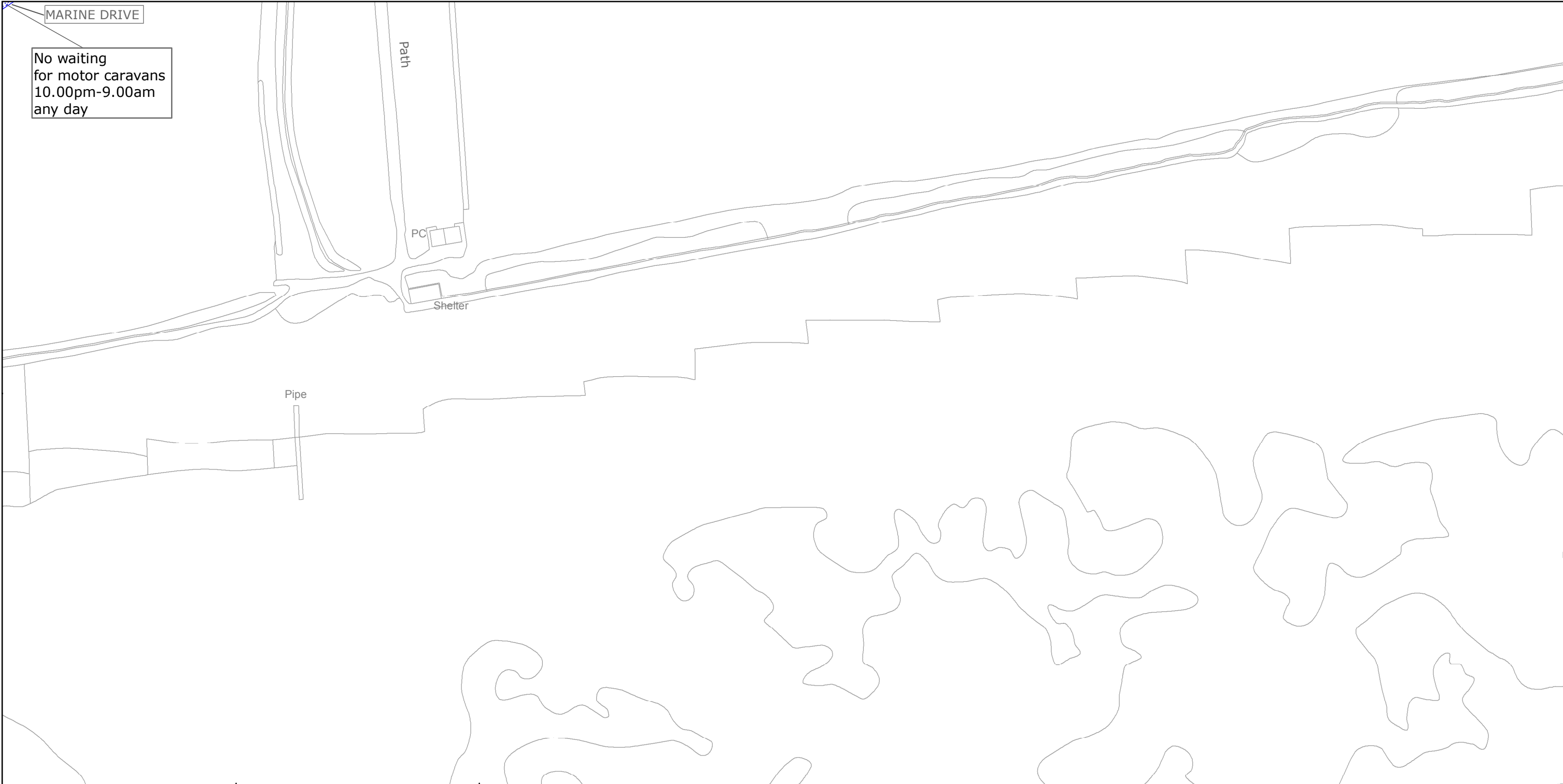

West Sussex County Council
Highways & Transport
The Grange
Tower Street
Chichester
West Sussex
PO19 1RH

WORTHING BOROUGH: GORING WARD

WAITING RESTRICTIONS

Reproduced from or based upon 2013 Ordnance Survey material with permission of the Controller of HMSO (c) Crown Copyright reserved.
Unauthorised reproduction infringes Crown copyright and may lead to prosecution or civil proceedings West Sussex County Council Licence No. 100023447

TILE REF NO:
TQ1001NES

SHEET ISSUE NO 1
SHEET ACTIVE FROM - 05/09/2016

N
SCALE:
1:1250
at A3 size



West Sussex County Council
Highways & Transport
The Grange
Tower Street
Chichester
West Sussex
PO19 1RH

WORTHING BOROUGH: GORING WARD

WAITING RESTRICTIONS

Reproduced from or based upon 2013 Ordnance Survey material with permission of the Controller of HMSO (c) Crown Copyright reserved.
Unauthorised reproduction infringes Crown copyright and may lead to prosecution or civil proceedings West Sussex County Council Licence No. 100023447

TILE REF NO:
TQ1001NWN

SHEET ISSUE NO 2
SHEET ACTIVE FROM - 05/09/2016

N
SCALE:
1:1250
at A3 size

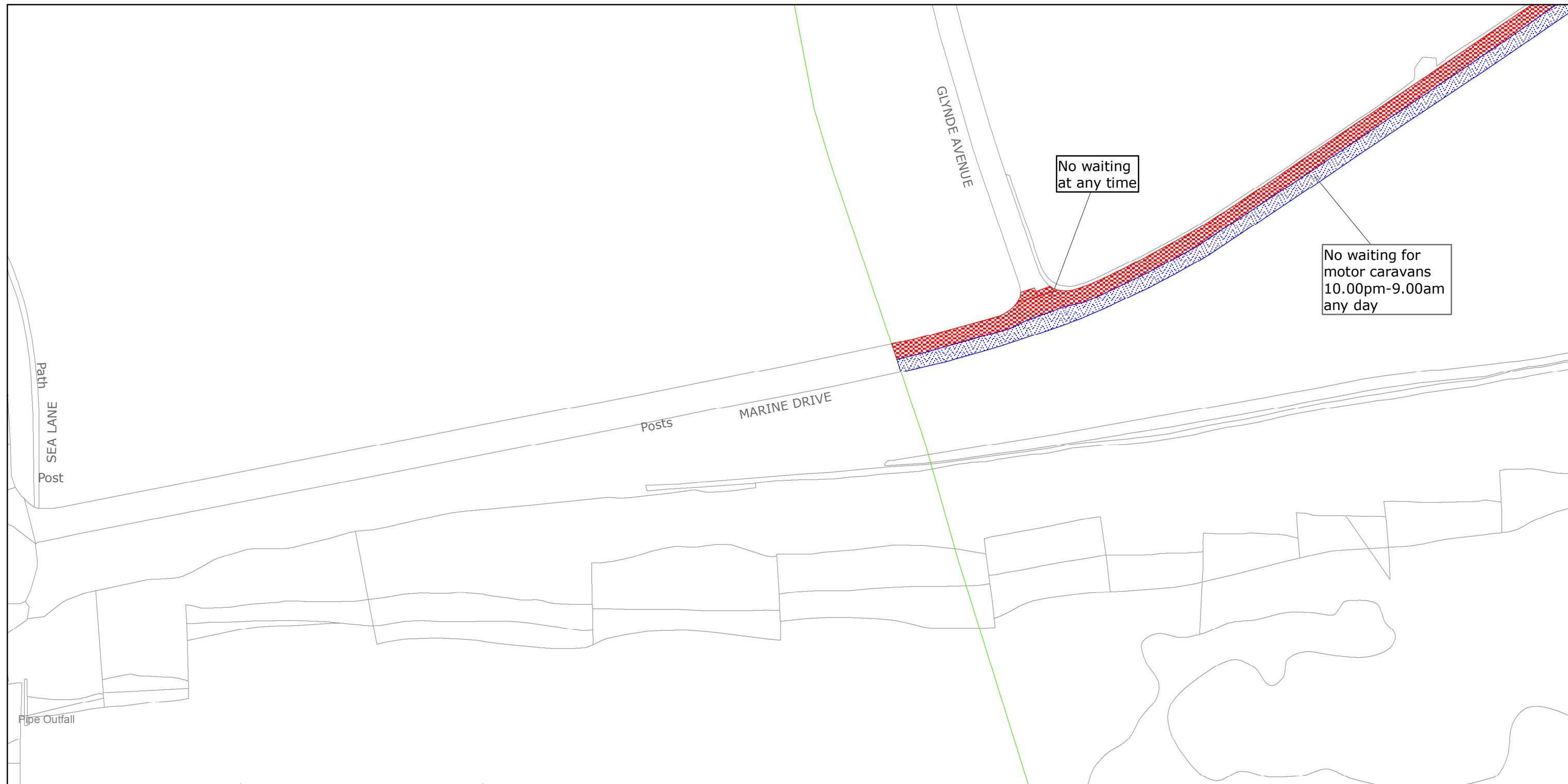

West Sussex County Council
Highways & Transport
The Grange
Tower Street
Chichester
West Sussex
PO19 1RH

WORTHING BOROUGH: GORING WARD

WAITING RESTRICTIONS

TILE REF NO:
TQ1001NWS

SHEET ISSUE NO 2
SHEET ACTIVE FROM - 05/09/2016



SCALE:
1:1250
at A3 size



West Sussex County Council
 Highways & Transport
 The Grange
 Tower Street
 Chichester
 West Sussex
 PO19 1RH

WORTHING BOROUGH: GORING WARD

WAITING RESTRICTIONS

Reproduced from or based upon 2013 Ordnance Survey material with permission of the Controller of HMSO (c) Crown Copyright reserved.
 Unauthorised reproduction infringes Crown copyright and may lead to prosecution or civil proceedings West Sussex County Council Licence No. 100023447

TILE REF NO:
TQ1101NEN

SHEET ISSUE NO 2
 SHEET ACTIVE FROM - 05/09/2016



SCALE:
 1:1250
 at A3 size

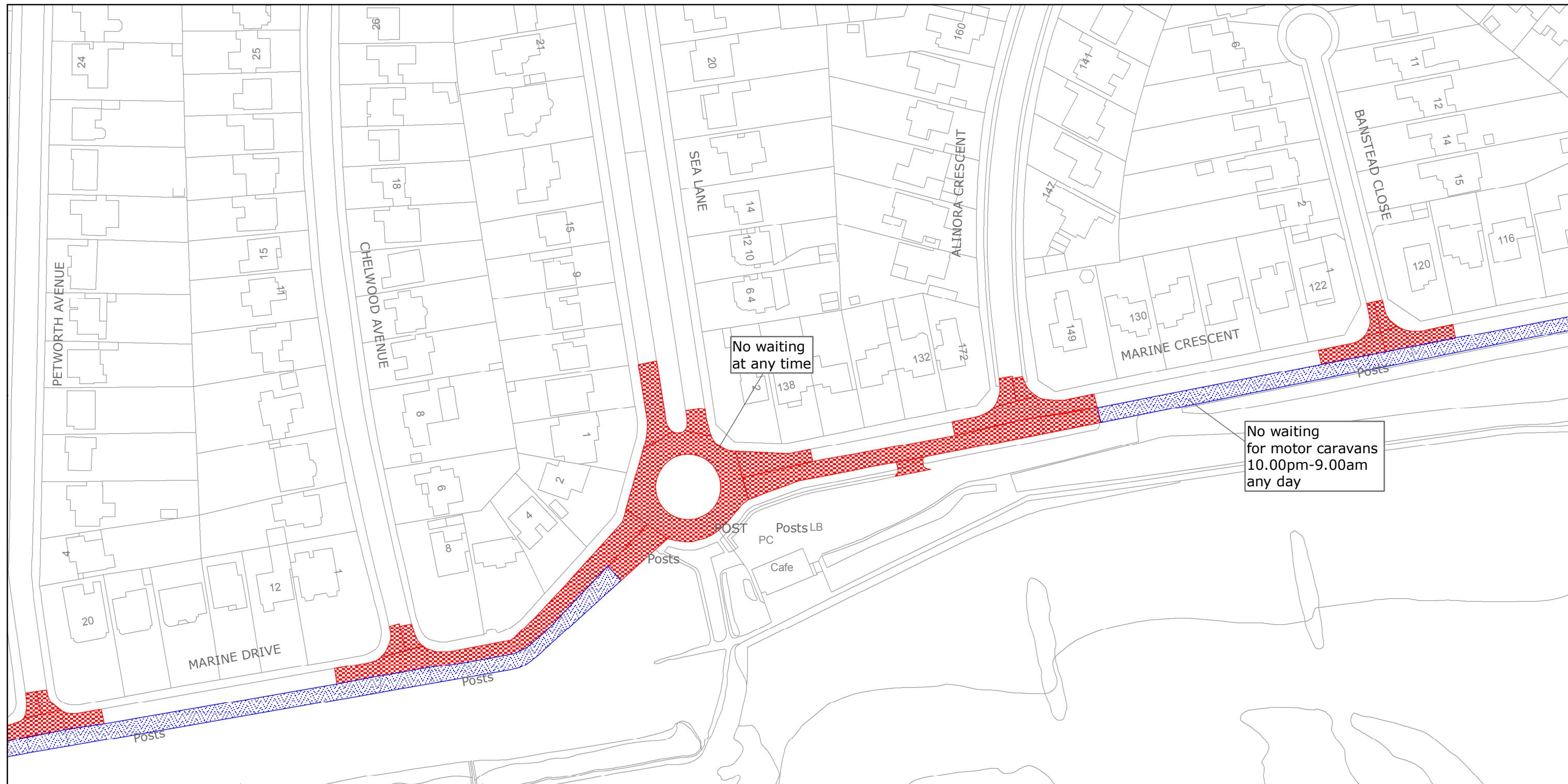

West Sussex County Council
Highways & Transport
The Grange
Tower Street
Chichester
West Sussex
PO19 1RH

WORTHING BOROUGH: GORING WARD
WAITING RESTRICTIONS

Reproduced from or based upon 2013 Ordnance Survey material with permission of the Controller of HMSO (c) Crown Copyright reserved.
Unauthorised reproduction infringes Crown copyright and may lead to prosecution or civil proceedings West Sussex County Council Licence No. 100023447

TILE REF NO:
TQ1101NWN

SHEET ISSUE NO 2
SHEET ACTIVE FROM - 05/09/2016



SCALE:
1:1250
at A3 size

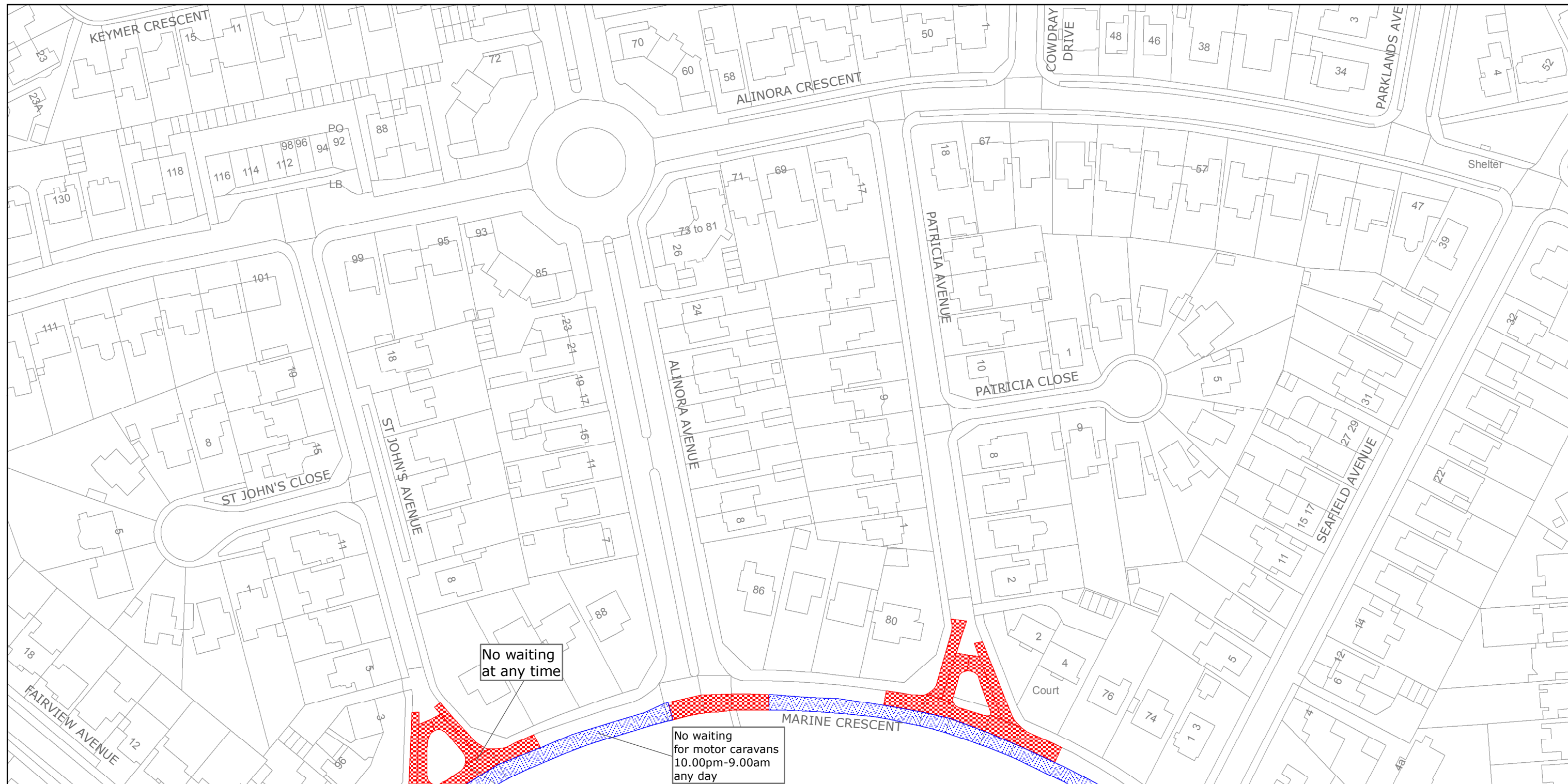

West Sussex County Council
Highways & Transport
The Grange
Tower Street
Chichester
West Sussex
PO19 1RH

WORTHING BOROUGH: GORING WARD

WAITING RESTRICTIONS

Reproduced from or based upon 2013 Ordnance Survey material with permission of the Controller of HMSO (c) Crown Copyright reserved.
Unauthorised reproduction infringes Crown copyright and may lead to prosecution or civil proceedings West Sussex County Council Licence No. 100023447

TILE REF NO:
TQ1102SES

SHEET ISSUE NO 2
SHEET ACTIVE FROM - 05/09/2016



SCALE:
1:1250
at A3 size

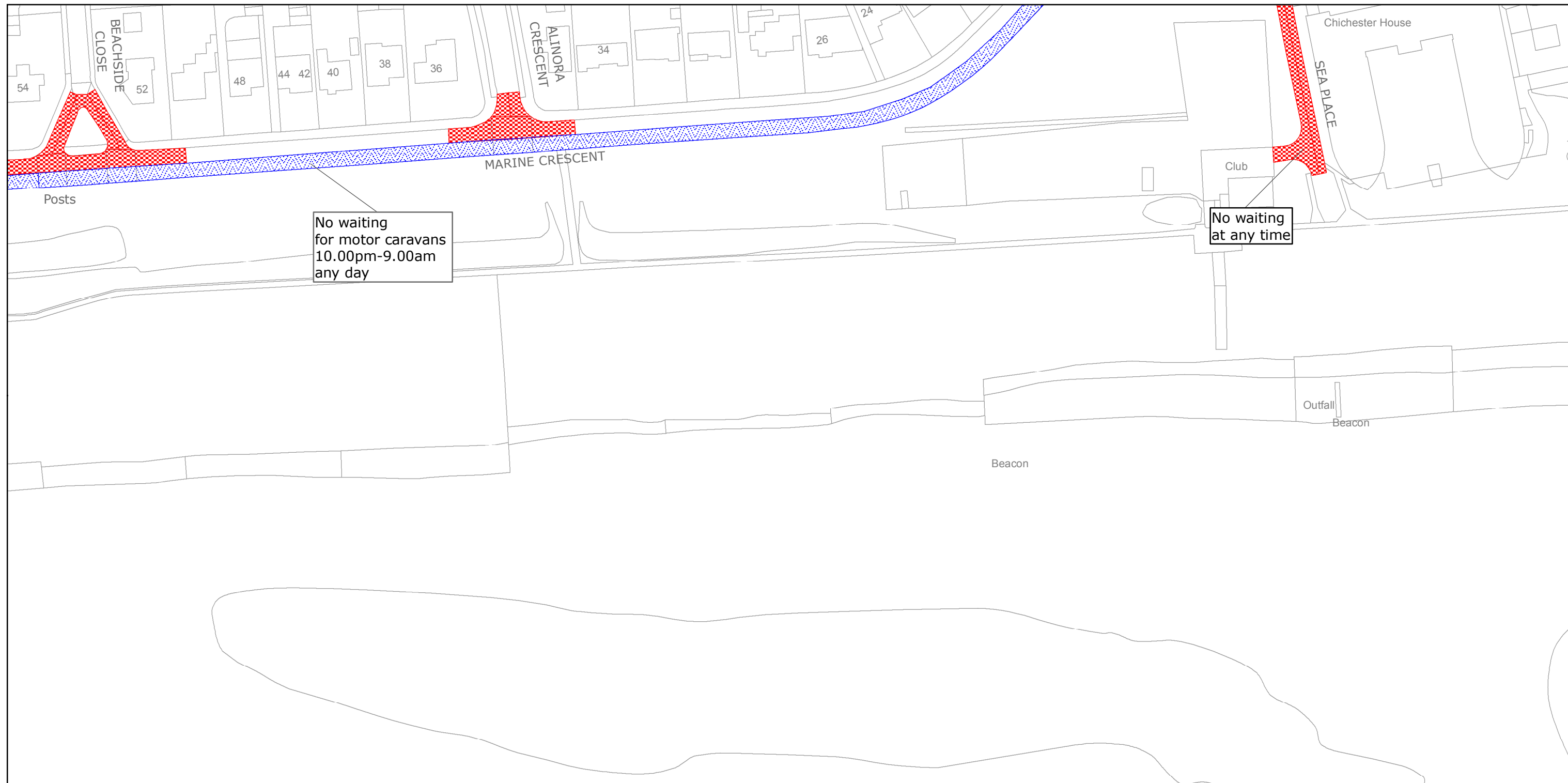

West Sussex County Council
Highways & Transport
The Grange
Tower Street
Chichester
West Sussex
PO19 1RH

WORTHING BOROUGH: GORING AND MARINE WARDS WAITING RESTRICTIONS

Reproduced from or based upon 2013 Ordnance Survey material with permission of the Controller of HMSO (c) Crown Copyright reserved.
Unauthorised reproduction infringes Crown copyright and may lead to prosecution or civil proceedings West Sussex County Council Licence No. 100023447

TILE REF NO:
TQ1201NWN

SHEET ISSUE NO 3
SHEET ACTIVE FROM - 05/09/2016



SCALE:
1:1250
at A3 size

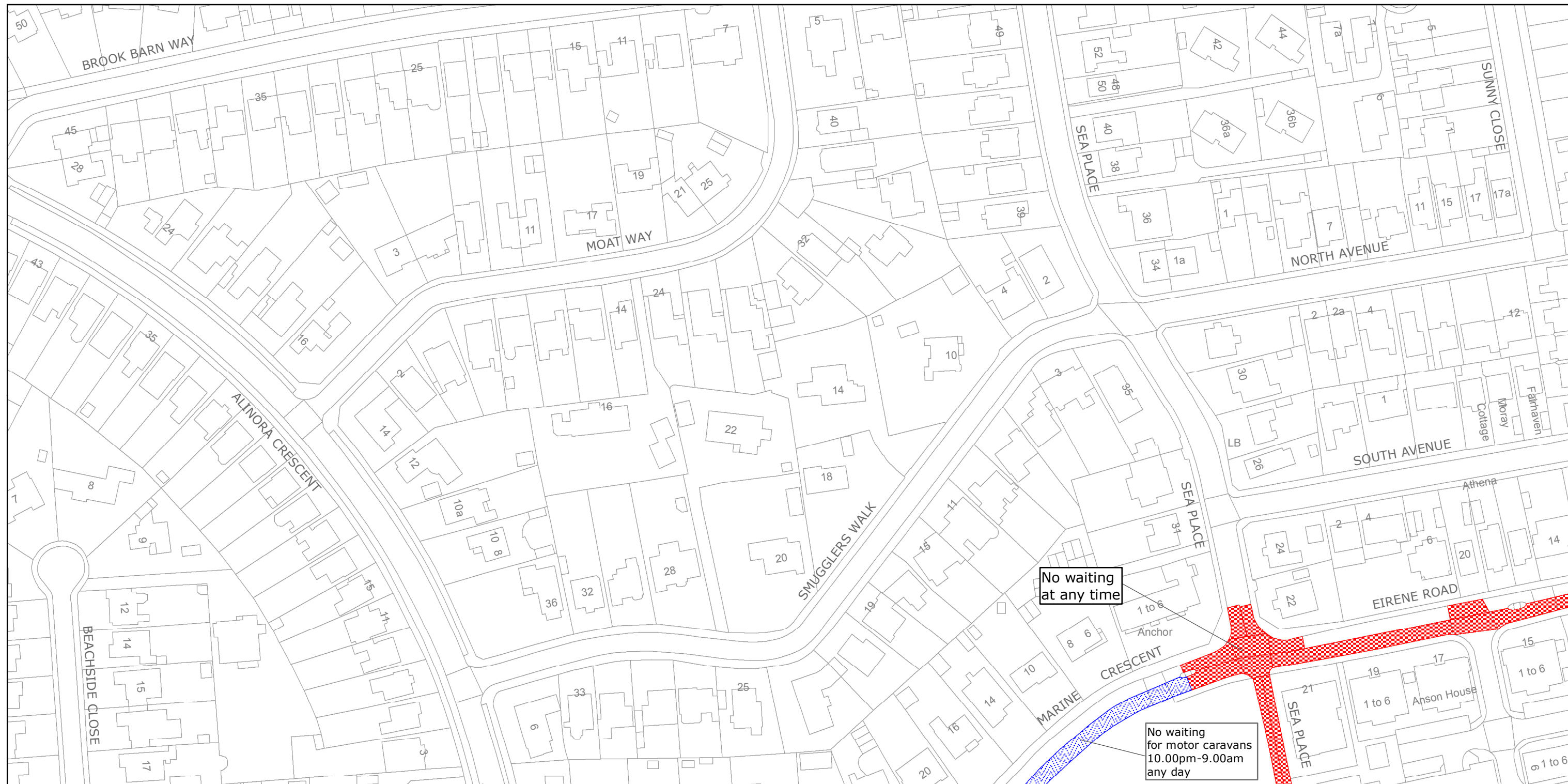

West Sussex County Council
Highways & Transport
The Grange
Tower Street
Chichester
West Sussex
PO19 1RH

WORTHING BOROUGH: GORING AND MARINE WARDS

WAITING RESTRICTIONS

Reproduced from or based upon 2013 Ordnance Survey material with permission of the Controller of HMSO (c) Crown Copyright reserved.
Unauthorised reproduction infringes Crown copyright and may lead to prosecution or civil proceedings West Sussex County Council Licence No. 100023447

TILE REF NO: TQ1202SWS

SHEET ISSUE NO 3
SHEET ACTIVE FROM - 05/09/2016



SCALE:
1:1250
at A3 size