

WEST SUSSEX COUNTY COUNCIL
((WORTHING) (PARKING PLACES AND TRAFFIC REGULATION)
(CONSOLIDATION) ORDER 2007)
(AMENDMENT No.1) ORDER 2010

WORTHING: LOCATION OF WAITING RESTRICTIONS

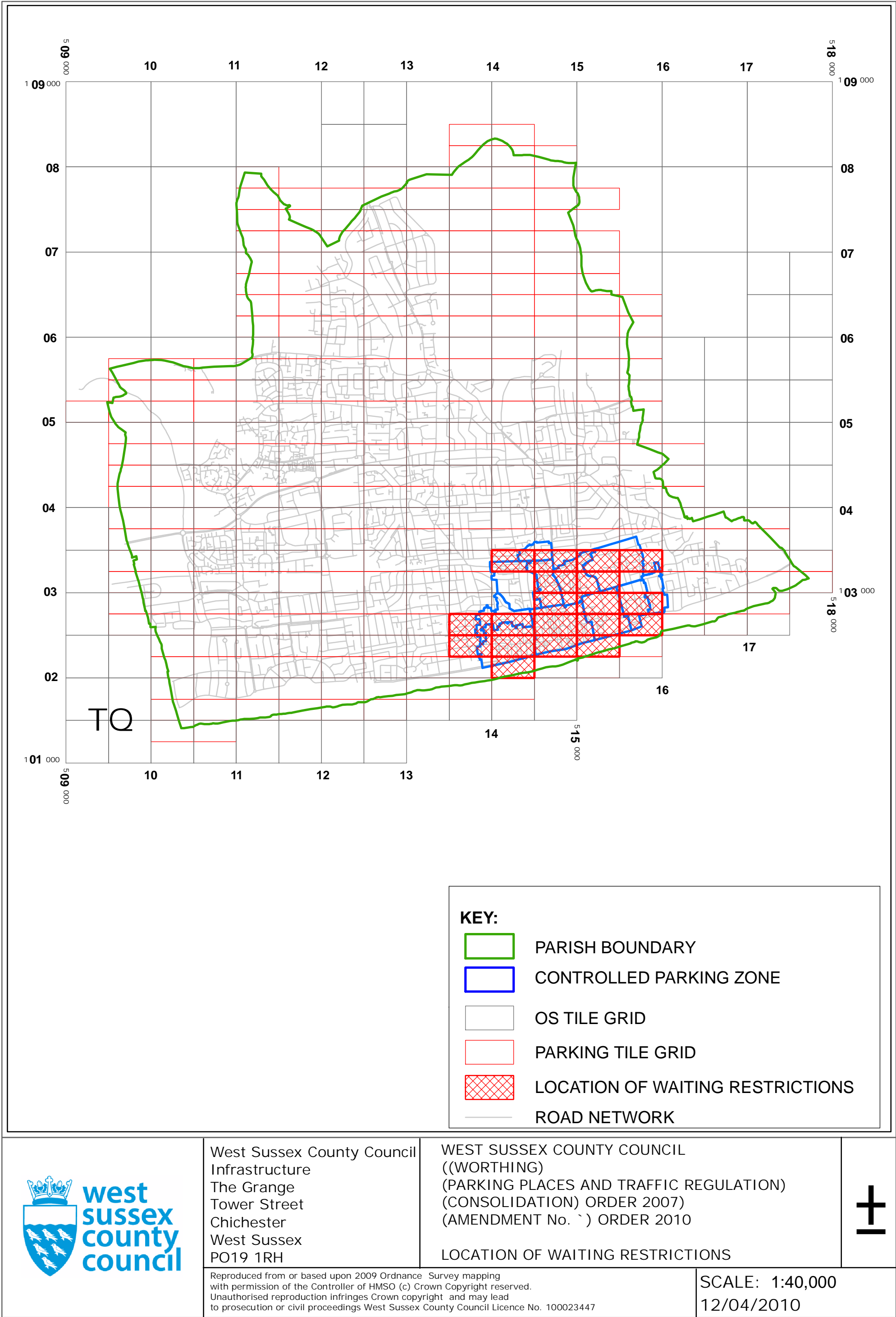

5236

WEST SUSSEX COUNTY COUNCIL
((WORTHING) (PARKING PLACES AND TRAFFIC REGULATION)
(CONSOLIDATION) ORDER 2007)
(AMENDMENT NO. 1) ORDER 2010

West Sussex County Council in exercise of their powers under Sections 1 (1) 2 (1) and (2), 4 (2), 45, 46, 49 and 53 and Part IV of Schedule 9 of the Road Traffic Regulation Act 1984 "the Act" as amended and of all other enabling powers and after consultation with the chief officer of police in accordance with Part III of Schedule 9 to the Act hereby make the following Order:-

1. This Order shall come into operation on the twelfth day of April 2010 and may be cited as "West Sussex County Council ((Worthing) (Parking Places and Traffic Regulation) (Consolidation) Order 2007) (Amendment No. 1) Order 2010."
2. The "West Sussex County Council (Worthing) (Parking Places and Traffic Regulation) (Consolidation) Order 2007" is hereby amended by the deletion from it of the plans specified in the First Schedule to this Order and the substitution of the plans attached in the Second Schedule to this Order.

FIRST SCHEDULE
Plan numbers to be revoked

TQ1302NES (Issue No. 1)
TQ1302SEN (Issue No. 1)
TQ1402NEN (Issue No. 2)
TQ1402NES (Issue No. 3)
TQ1402NWS (Issue No. 1)
TQ1402SEN (Issue No. 2)
TQ1402SWN (Issue No. 1)
TQ1402SWS (Issue No. 1)
TQ1403SEN (Issue No. 1)
TQ1403SES (Issue No. 2)
TQ1403SWN (Issue No. 3)
TQ1502NEN (Issue No. 1)
TQ1502NES (Issue No. 1)
TQ1502NWN (Issue No. 1)
TQ1502NWS (Issue No. 3)
TQ1502SWN (Issue No. 2)
TQ1503SEN (Issue No. 1)
TQ1503SWN (Issue No. 2)
TQ1503SWS (Issue No. 2)

SECOND SCHEDULE
Plans to be substituted
(as attached)

TQ1302NES (Issue No. 2)
TQ1302SEN (Issue No. 2)
TQ1402NEN (Issue No. 3)
TQ1402NES (Issue No. 4)
TQ1402NWS (Issue No. 2)
TQ1402SEN (Issue No. 3)
TQ1402SWN (Issue No. 2)
TQ1402SWS (Issue No. 2)
TQ1403SEN (Issue No. 2)
TQ1403SES (Issue No. 3)
TQ1403SWN (Issue No. 4)
TQ1502NEN (Issue No. 2)
TQ1502NES (Issue No. 2)
TQ1502NWN (Issue No. 2)
TQ1502NWS (Issue No. 4)
TQ1502SWN (Issue No. 3)
TQ1503SEN (Issue No. 2)
TQ1503SWN (Issue No. 3)
TQ1503SWS (Issue No. 3)

The COMMON SEAL of WEST SUSSEX
COUNTY COUNCIL was hereto affixed

the SIXTH day of APRIL 2010
in the presence of

M. Kentell
Authorised Signatory

)
)
)
)
) (L.S.)
)
)
)



7285/6/10

I HEREBY CERTIFY THIS TO
BE A TRUE COPY OF THE
ORIGINAL DOCUMENT

Tony Kenward
.....
Authorised Officer

WEST SUSSEX COUNTY COUNCIL

04/08 DELEGATED AUTHORITY

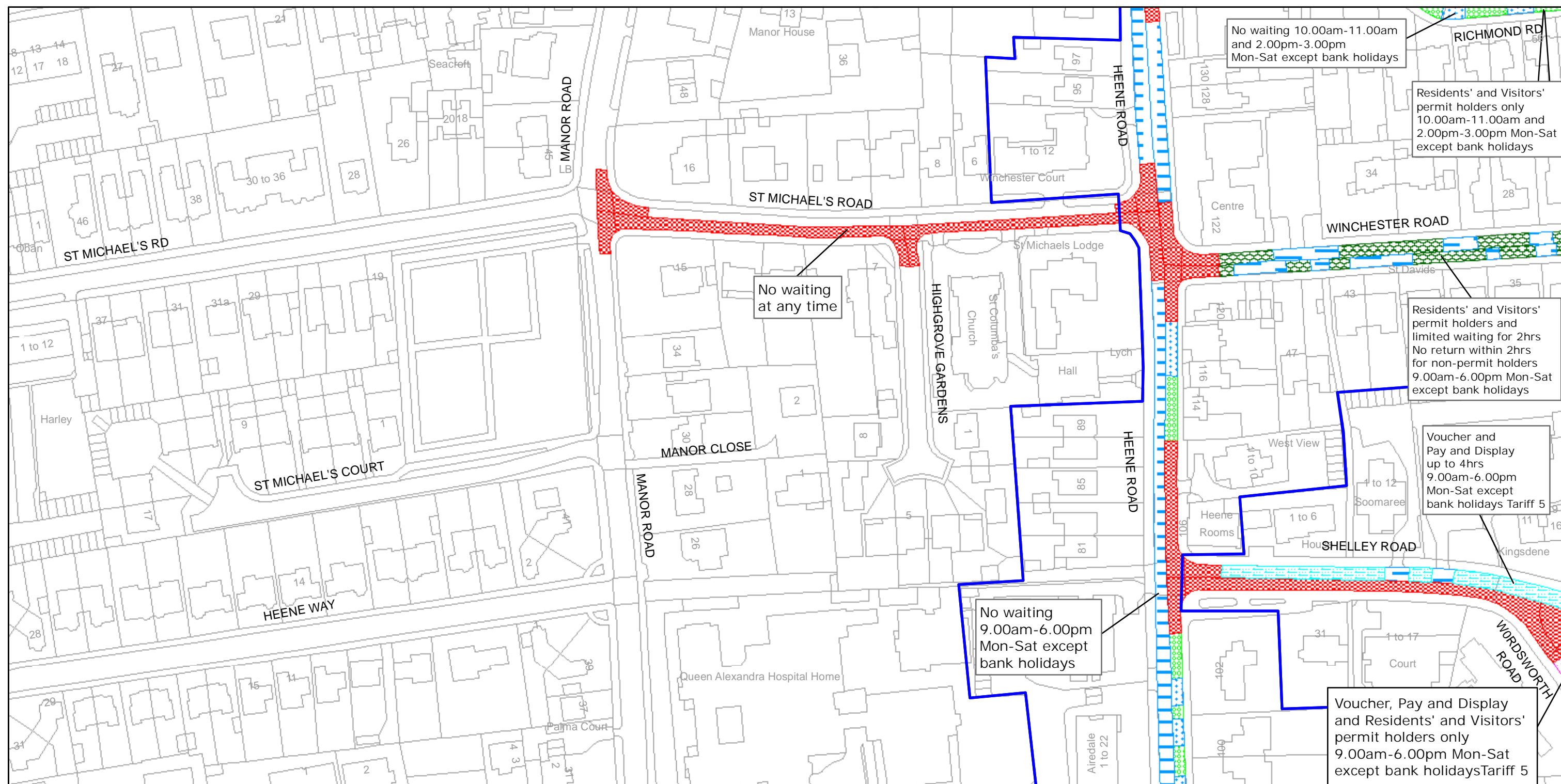

West Sussex County Council
Infrastructure
The Grange
Tower Street
Chichester
West Sussex
PO19 1RH

WORTHING BOROUGH: HEENE WARD WAITING RESTRICTIONS

Reproduced from or based upon 2009 Ordnance Survey mapping with permission of the Controller of HMSO (c) Crown Copyright reserved.
Unauthorised reproduction infringes Crown copyright and may lead to prosecution or civil proceedings West Sussex County Council Licence No. 100023447

TILE REF NO:
TQ1302NES

SHEET ISSUE NO 2

SHEET ACTIVE FROM - 12/04/2010



SCALE:
1:1250
at A3 size

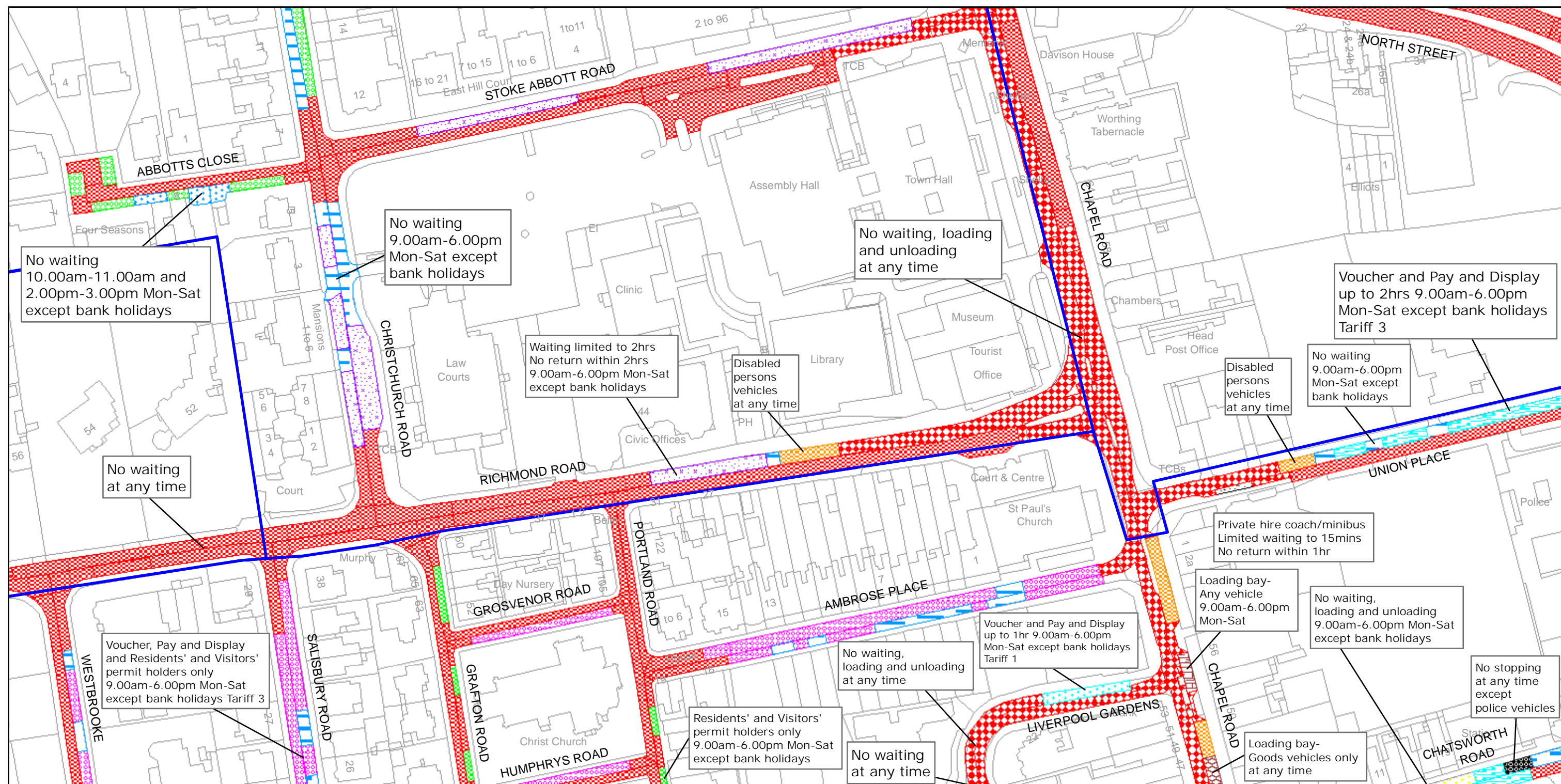

West Sussex County Council
Infrastructure
The Grange
Tower Street
Chichester
West Sussex
PO19 1RH

WORTHING BOROUGH: CENTRAL WARD WAITING RESTRICTIONS

Reproduced from or based upon 2009 Ordnance Survey mapping with permission of the Controller of HMSO (c) Crown Copyright reserved.
Unauthorised reproduction infringes Crown copyright and may lead to prosecution or civil proceedings West Sussex County Council Licence No. 100023447

TILE REF NO:
TQ1402NEN

SHEET ISSUE NO 3

SHEET ACTIVE FROM - 12/04/2010



SCALE:
1:1250
at A3 size

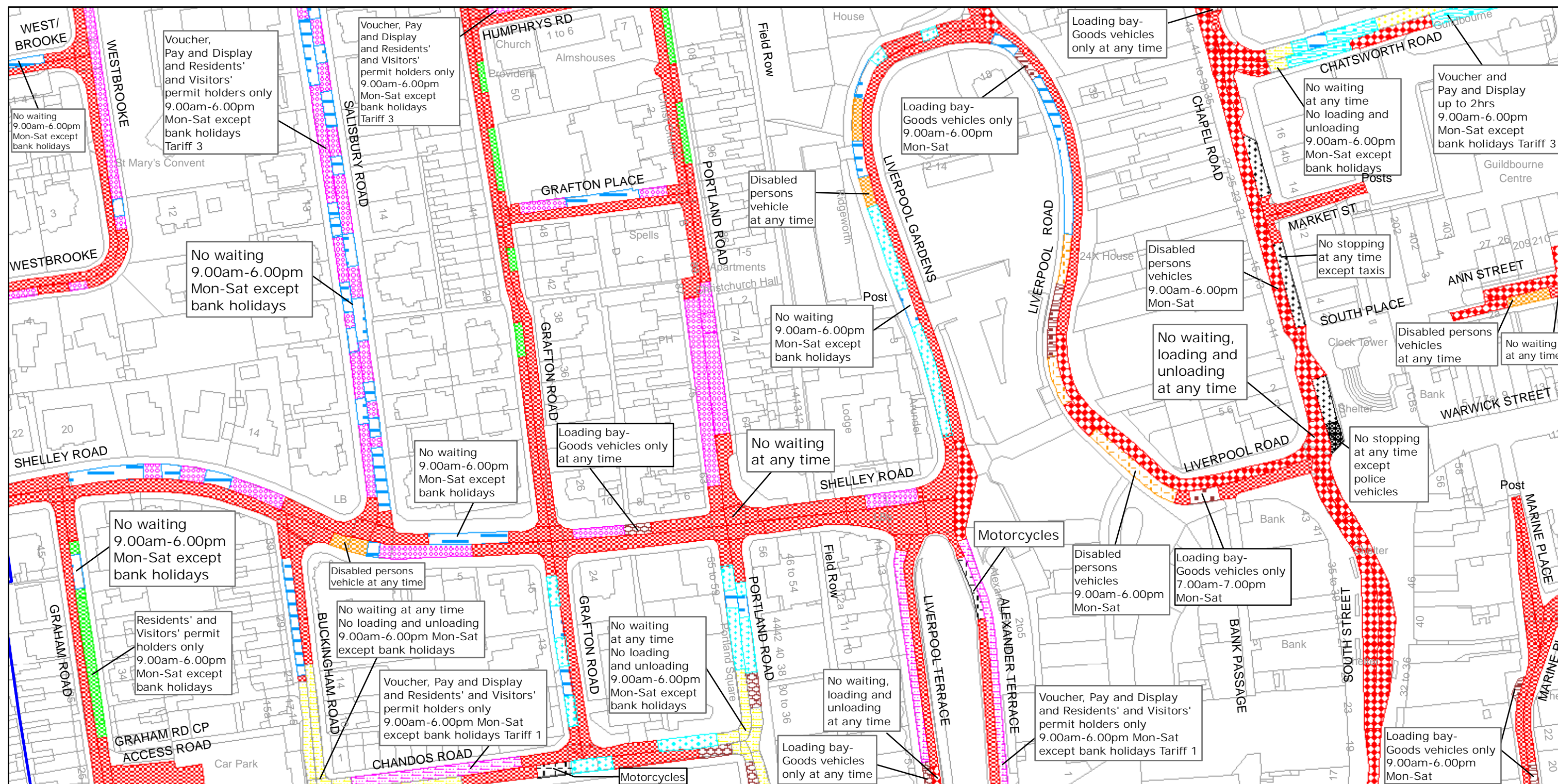

West Sussex County Council
Infrastructure
The Grange
Tower Street
Chichester
West Sussex
PO19 1RH

WORTHING BOROUGH: CENTRAL WARD WAITING RESTRICTIONS

Reproduced from or based upon 2009 Ordnance Survey mapping with permission of the Controller of HMSO (c) Crown Copyright reserved.
Unauthorised reproduction infringes Crown copyright and may lead to prosecution or civil proceedings West Sussex County Council Licence No. 100023447

TILE REF NO:
TQ1402NES

SHEET ISSUE NO 4

SHEET ACTIVE FROM - 12/04/2010



SCALE:
1:1250
at A3 size

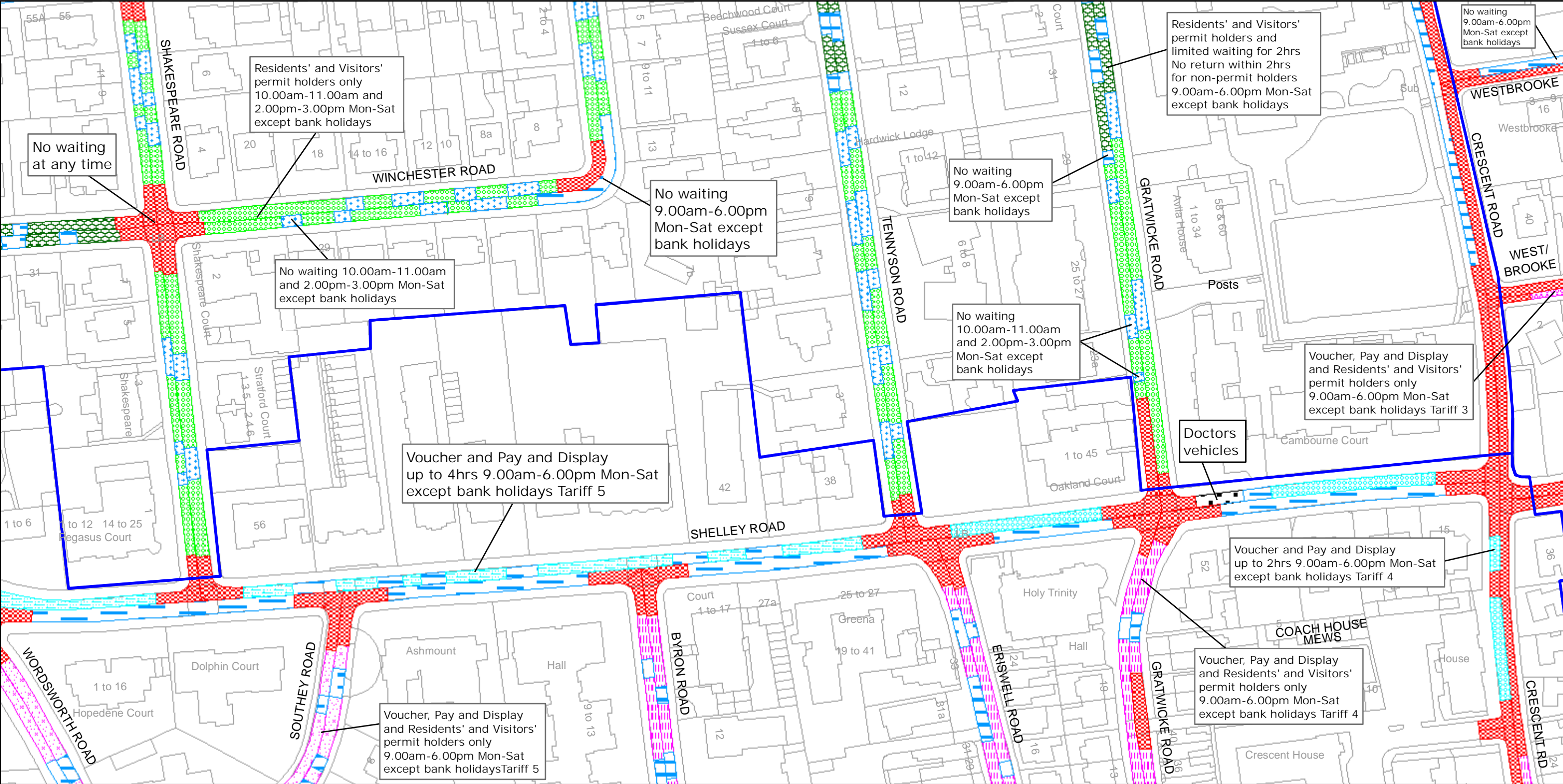

West Sussex County Council
Infrastructure
The Grange
Tower Street
Chichester
West Sussex
PO19 1RH

WORTHING BOROUGH: CENTRAL WARD
WAITING RESTRICTIONS

Reproduced from or based upon 2009 Ordnance Survey mapping with permission of the Controller of HMSO (c) Crown Copyright reserved.
Unauthorised reproduction infringes Crown copyright and may lead to prosecution or civil proceedings West Sussex County Council Licence No. 100023447

TILE REF NO:
TQ1402NWS

SHEET ISSUE NO 2
SHEET ACTIVE FROM - 12/04/2010

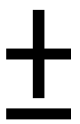

SCALE:
1:1250
at A3 size

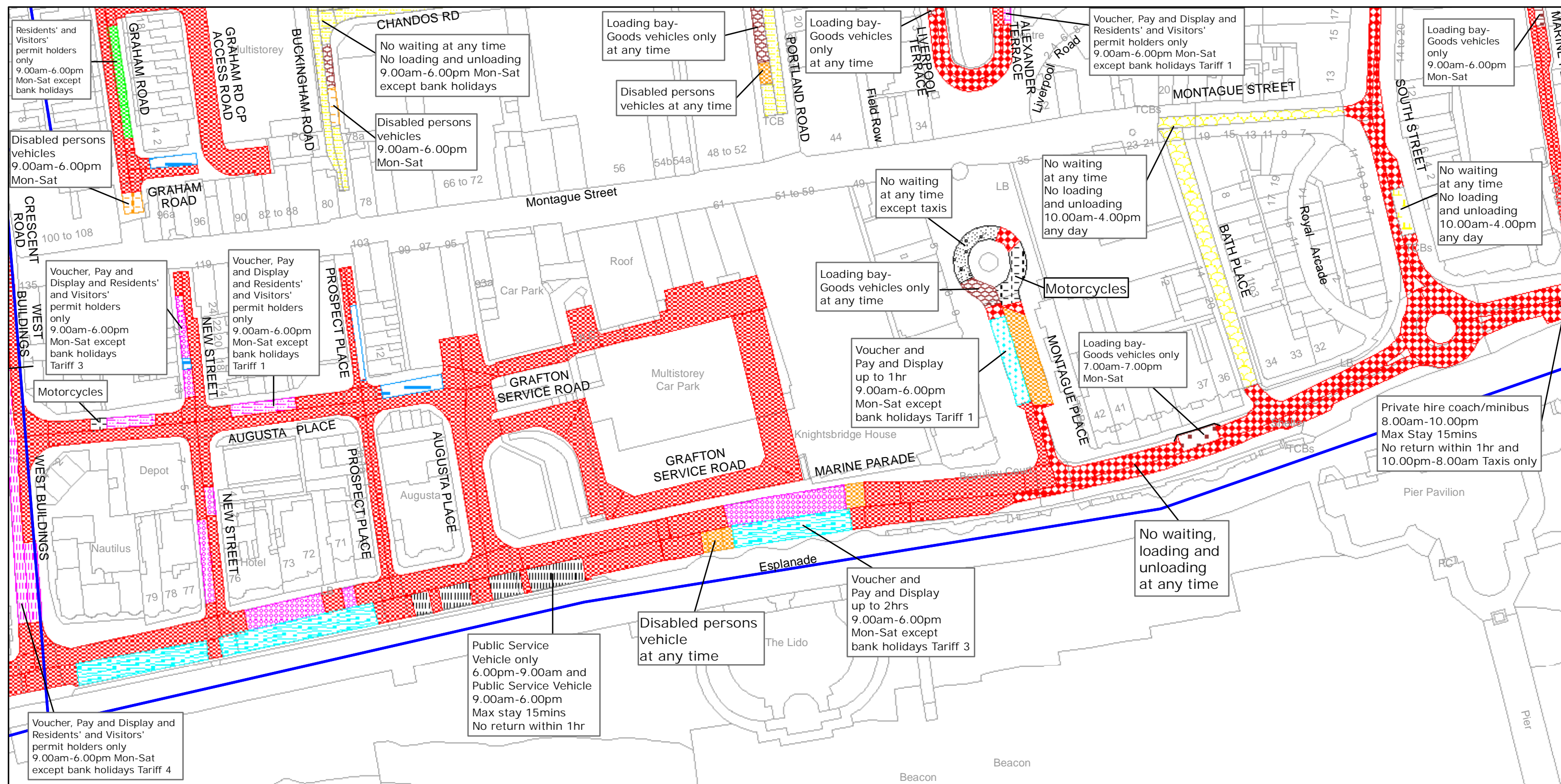

West Sussex County Council
Infrastructure
The Grange
Tower Street
Chichester
West Sussex
PO19 1RH

WORTHING BOROUGH: CENTRAL WARD WAITING RESTRICTIONS

Reproduced from or based upon 2009 Ordnance Survey mapping with permission of the Controller of HMSO (c) Crown Copyright reserved.
Unauthorised reproduction infringes Crown copyright and may lead to prosecution or civil proceedings West Sussex County Council Licence No. 100023447

TILE REF NO:
TQ1402SEN

SHEET ISSUE NO 3

SHEET ACTIVE FROM - 12/04/2010



SCALE:
1:1250
at A3 size

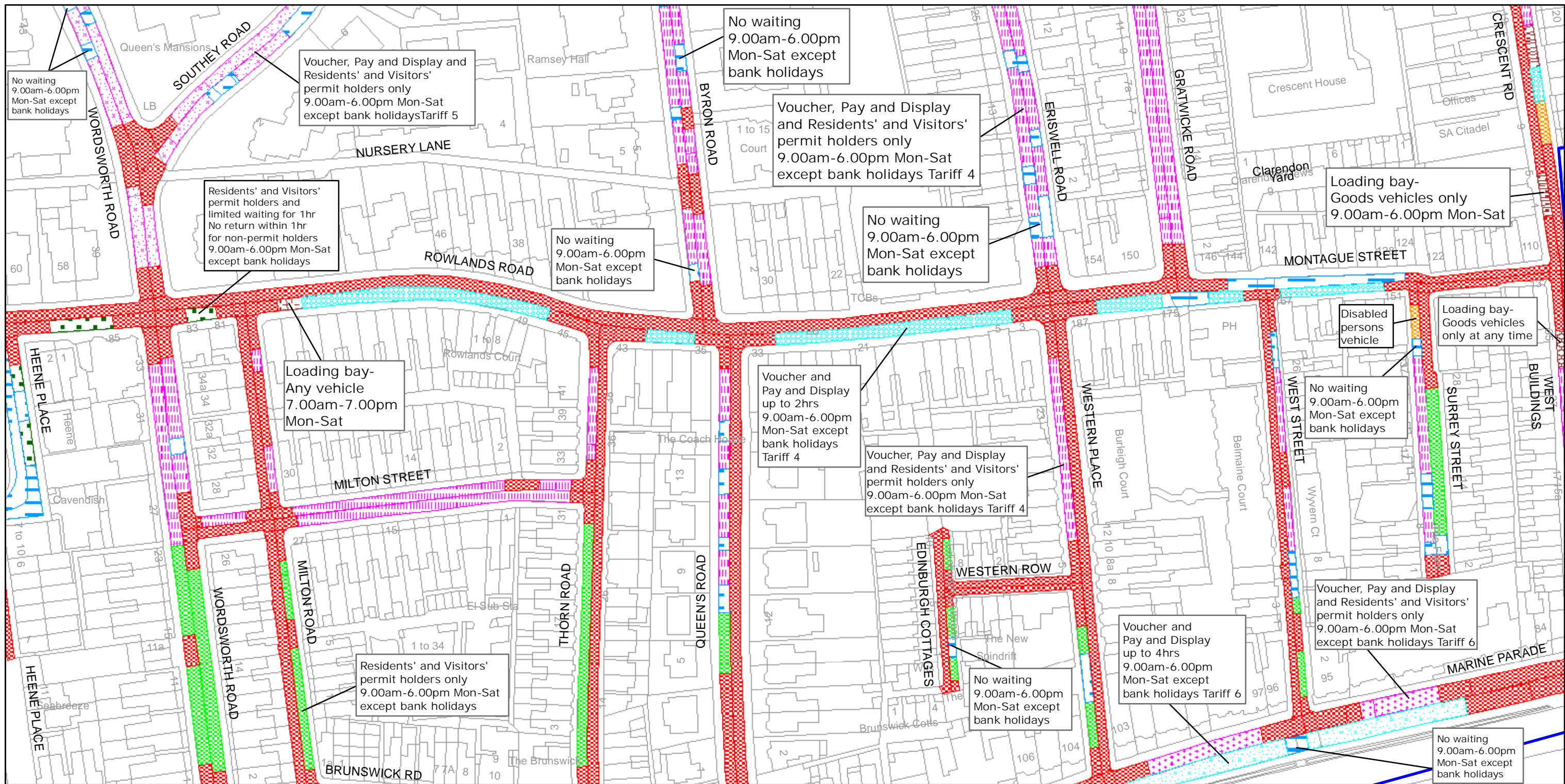

West Sussex County Council
Infrastructure
The Grange
Tower Street
Chichester
West Sussex
PO19 1RH

WORTHING BOROUGH: CENTRAL AND HEENE WARDS

WAITING RESTRICTIONS

Reproduced from or based upon 2009 Ordnance Survey mapping with permission of the Controller of HMSO (c) Crown Copyright reserved.
Unauthorised reproduction infringes Crown copyright and may lead to prosecution or civil proceedings West Sussex County Council Licence No. 100023447

TILE REF NO:
TQ1402SWN

SHEET ISSUE NO 2

SHEET ACTIVE FROM - 12/04/2010



SCALE:
1:1250
at A3 size

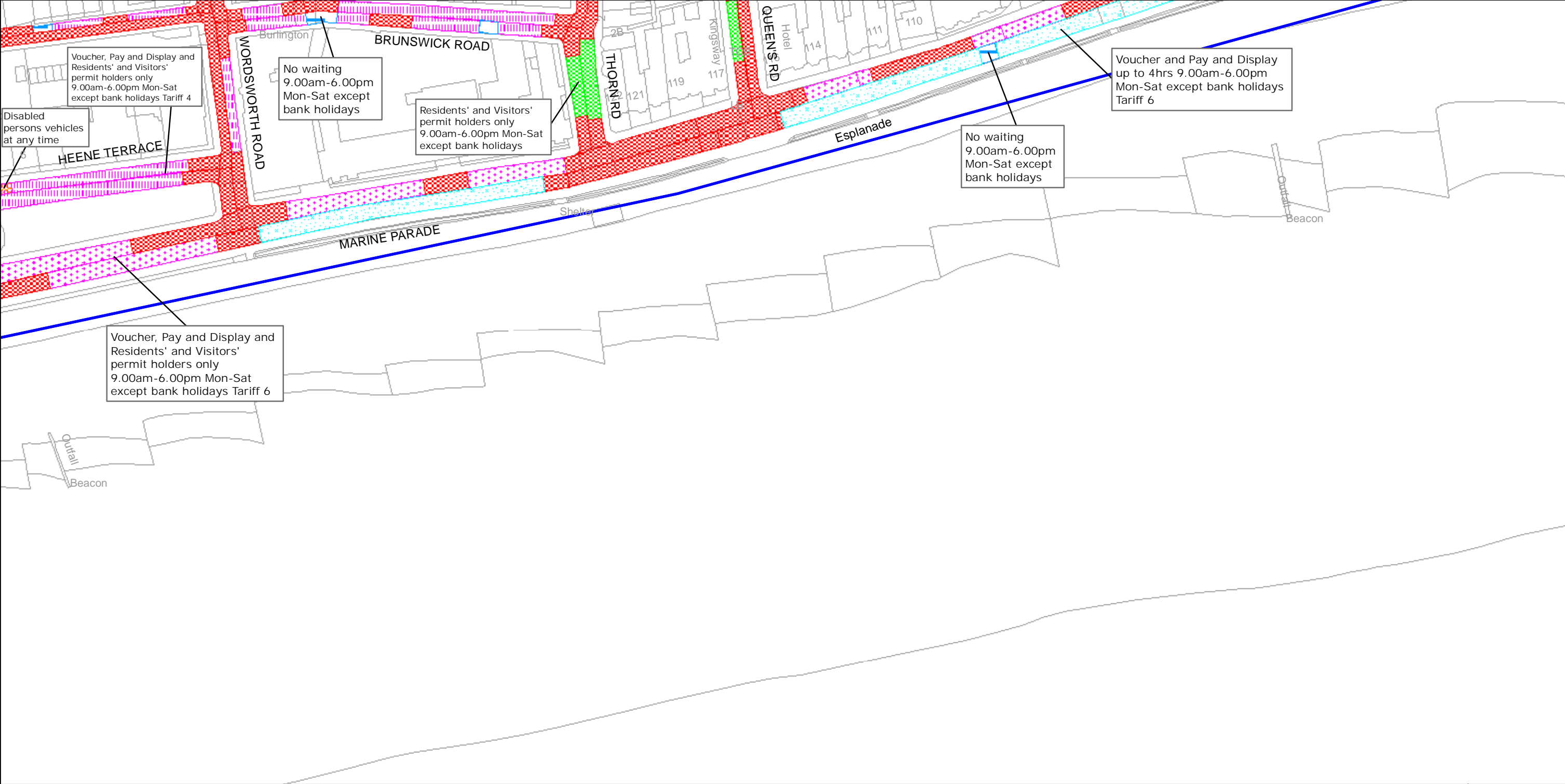

West Sussex County Council
Infrastructure
The Grange
Tower Street
Chichester
West Sussex
PO19 1RH

WORTHING BOROUGH: CENTRAL AND HEENE WARDS
WAITING RESTRICTIONS

Reproduced from or based upon 2009 Ordnance Survey mapping with permission of the Controller of HMSO (c) Crown Copyright reserved.
Unauthorised reproduction infringes Crown copyright and may lead to prosecution or civil proceedings West Sussex County Council Licence No. 100023447

TILE REF NO:
TQ1402SWS

SHEET ISSUE NO 2

SHEET ACTIVE FROM - 12/04/2010

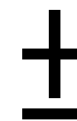

SCALE:
1:1250
at A3 size

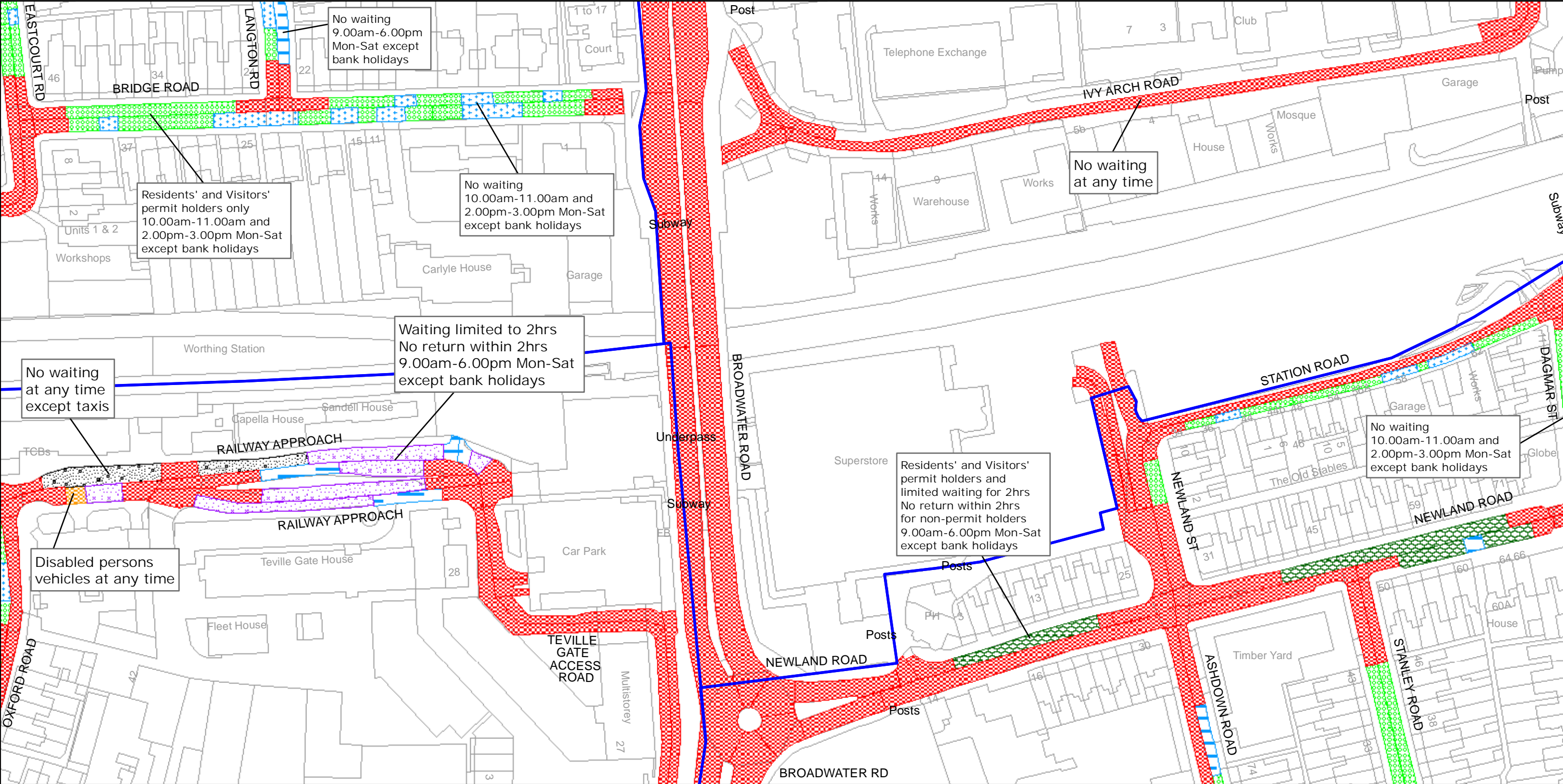

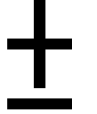
 <p>West Sussex County Council The Grange Tower Street Chichester West Sussex PO19 1RH</p>	<p>WORTHING BOROUGH: BROADWATER, CENTRAL AND GAISFORD WARDS</p> <p>WAITING RESTRICTIONS</p> <p><small>Reproduced from or based upon 2009 Ordnance Survey mapping with permission of the Controller of HMSO (c) Crown Copyright reserved. Unauthorised reproduction infringes Crown copyright and may lead to prosecution or civil proceedings West Sussex County Council Licence No. 100023447</small></p>	<p>TILE REF NO: TQ1403SEN</p> <p>SHEET ISSUE NO 3</p> <p>SHEET ACTIVE FROM - 12/04/2010</p>	 <p>SCALE: 1:1250 at A3 size</p>
---	--	---	---

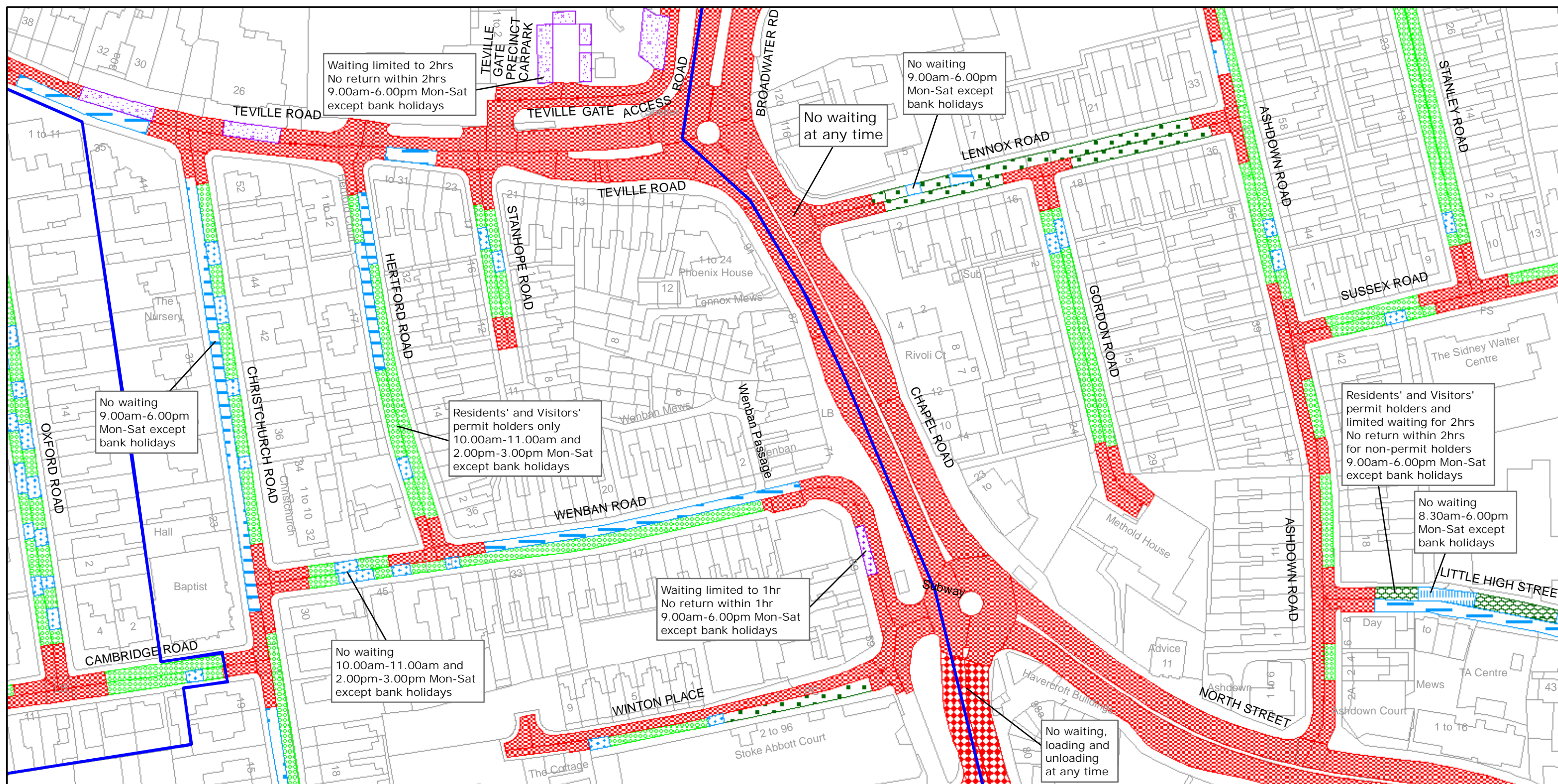

West Sussex County Council
Infrastructure
The Grange
Tower Street
Chichester
West Sussex
PO19 1RH

WORTHING BOROUGH: CENTRAL WARD WAITING RESTRICTIONS

Reproduced from or based upon 2009 Ordnance Survey mapping with permission of the Controller of HMSO (c) Crown Copyright reserved.
Unauthorised reproduction infringes Crown copyright and may lead to prosecution or civil proceedings West Sussex County Council Licence No. 100023447

TILE REF NO:
TQ1403SES

SHEET ISSUE NO 3

SHEET ACTIVE FROM - 12/04/2010



SCALE:
1:1250
at A3 size

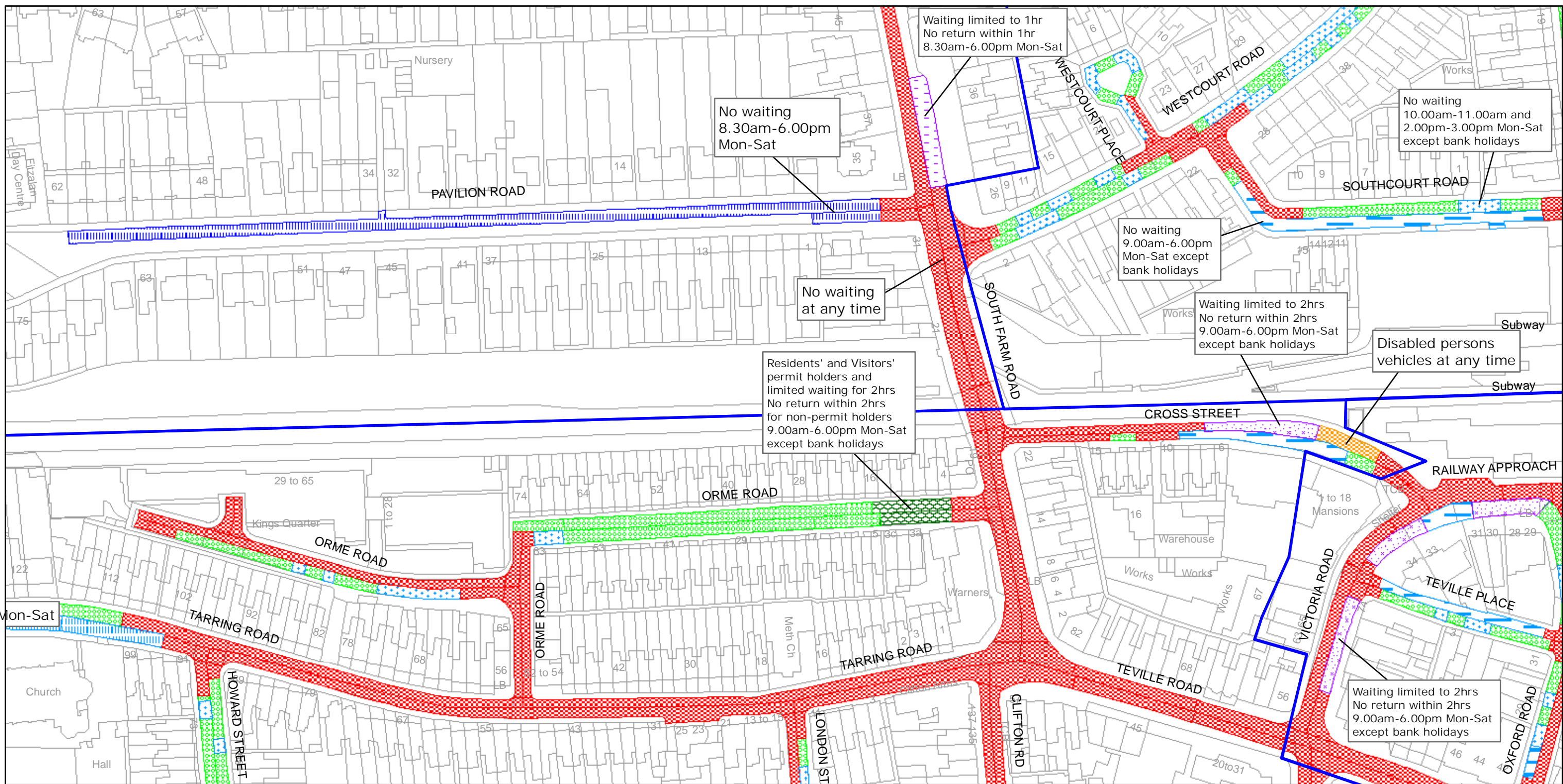

West Sussex County Council
Infrastructure
The Grange
Tower Street
Chichester
West Sussex
PO19 1RH

WORTHING BOROUGH: CENTRAL AND GAISFORD WARDS WAITING RESTRICTIONS

Reproduced from or based upon 2009 Ordnance Survey mapping with permission of the Controller of HMSO (c) Crown Copyright reserved.
Unauthorised reproduction infringes Crown copyright and may lead to prosecution or civil proceedings West Sussex County Council Licence No. 100023447

TILE REF NO:
TQ1403SWN

SHEET ISSUE NO 4

SHEET ACTIVE FROM - 12/04/2010



SCALE:
1:1250
at A3 size

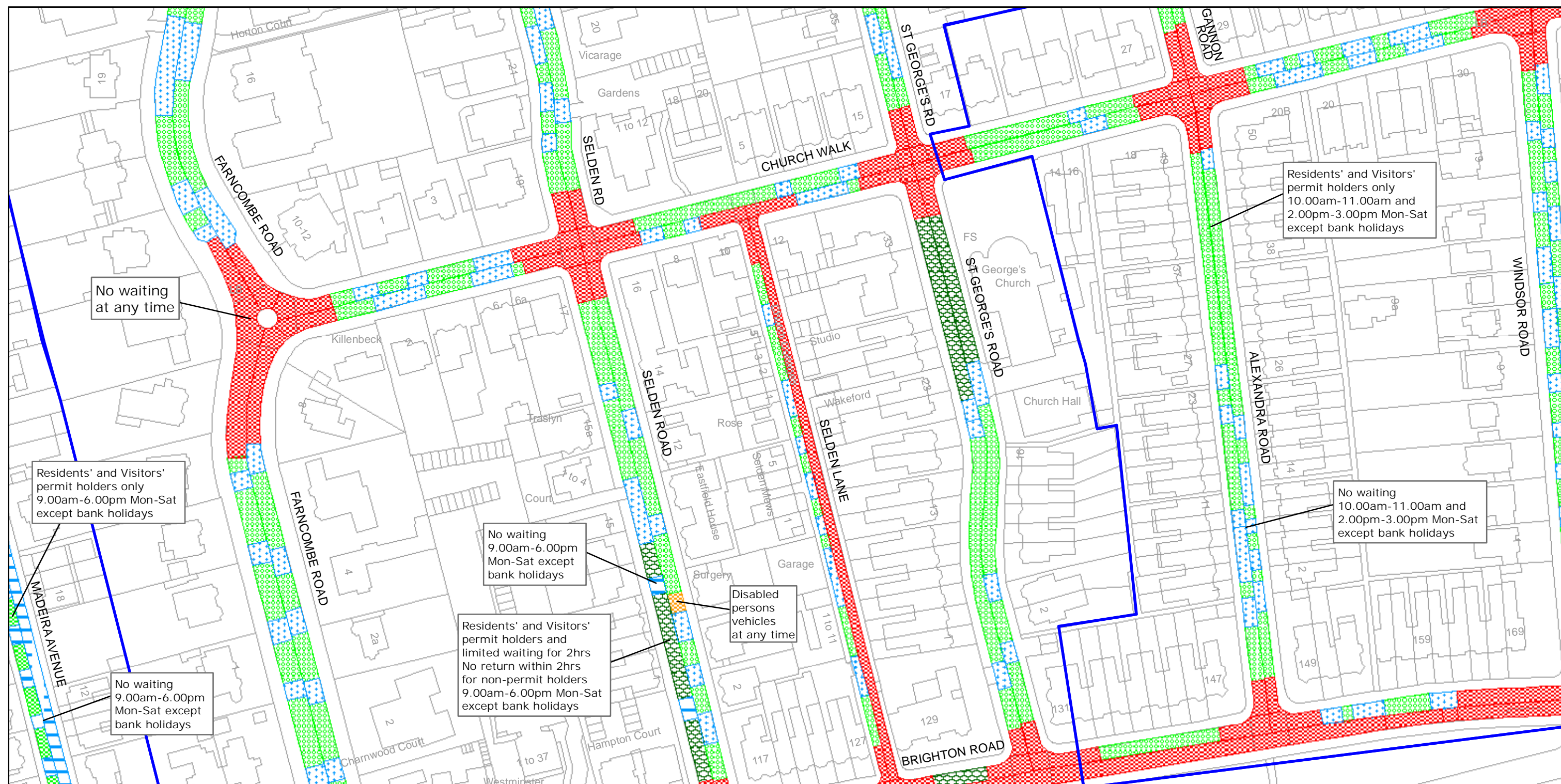

West Sussex County Council
Infrastructure
The Grange
Tower Street
Chichester
West Sussex
PO19 1RH

WORTHING BOROUGH: SELDEN WARD WAITING RESTRICTIONS

Reproduced from or based upon 2009 Ordnance Survey mapping with permission of the Controller of HMSO (c) Crown Copyright reserved.
Unauthorised reproduction infringes Crown copyright and may lead to prosecution or civil proceedings West Sussex County Council Licence No. 100023447

TILE REF NO:
TQ1502NEN

SHEET ISSUE NO 2

SHEET ACTIVE FROM - 12/04/2010



SCALE:
1:1250
at A3 size

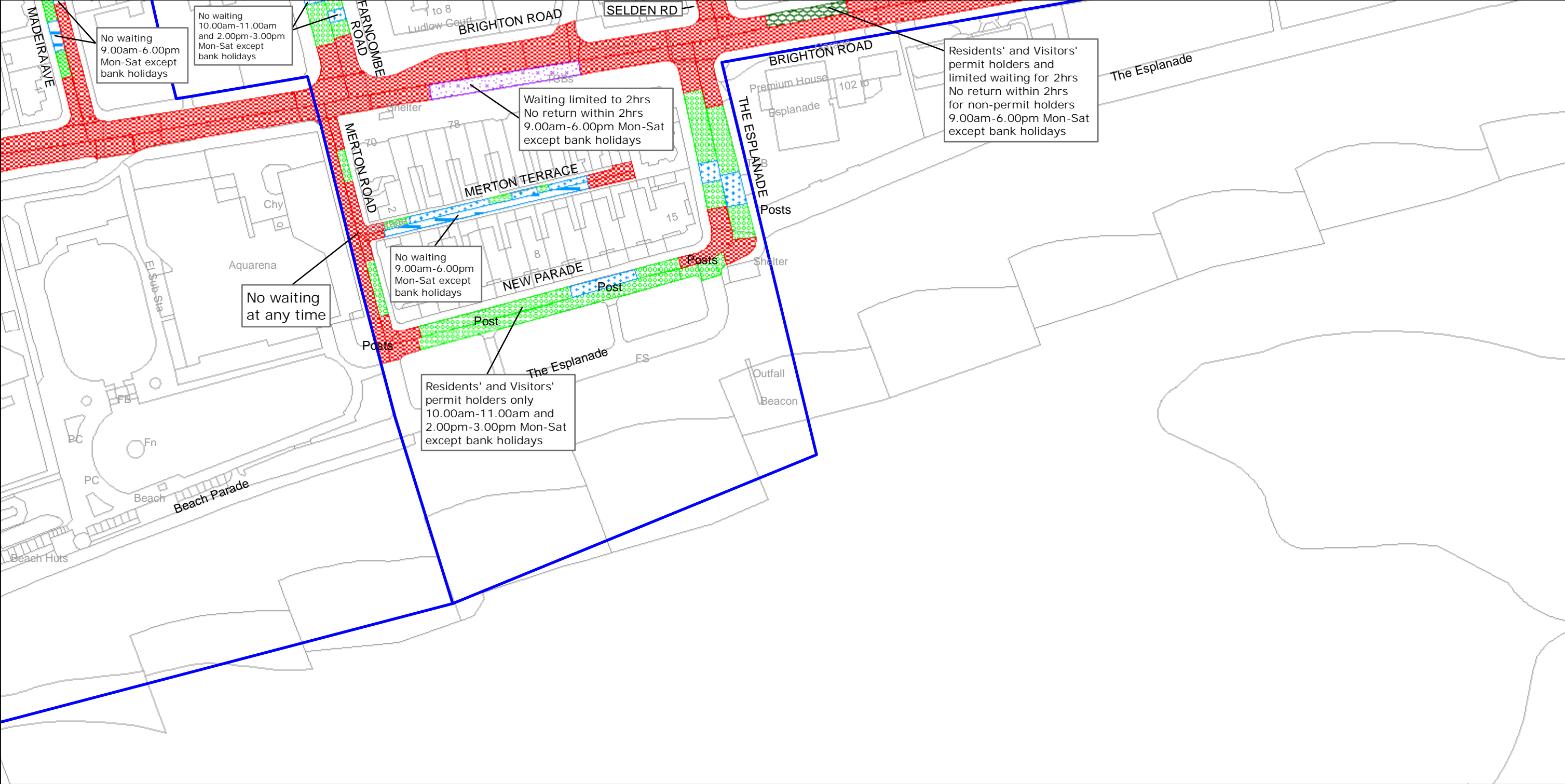

West Sussex County Council
Infrastructure
The Grange
Tower Street
Chichester
West Sussex
PO19 1RH

WORTHING BOROUGH: CENTRAL AND SELDEN WARDS
WAITING RESTRICTIONS

Reproduced from or based upon 2009 Ordnance Survey mapping with permission of the Controller of HMSO (c) Crown Copyright reserved.
Unauthorised reproduction infringes Crown copyright and may lead to prosecution or civil proceedings West Sussex County Council Licence No. 100023447

TILE REF NO:
TQ1502NES

SHEET ISSUE NO 2
SHEET ACTIVE FROM - 12/04/2010

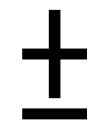

SCALE:
1:1250
at A3 size

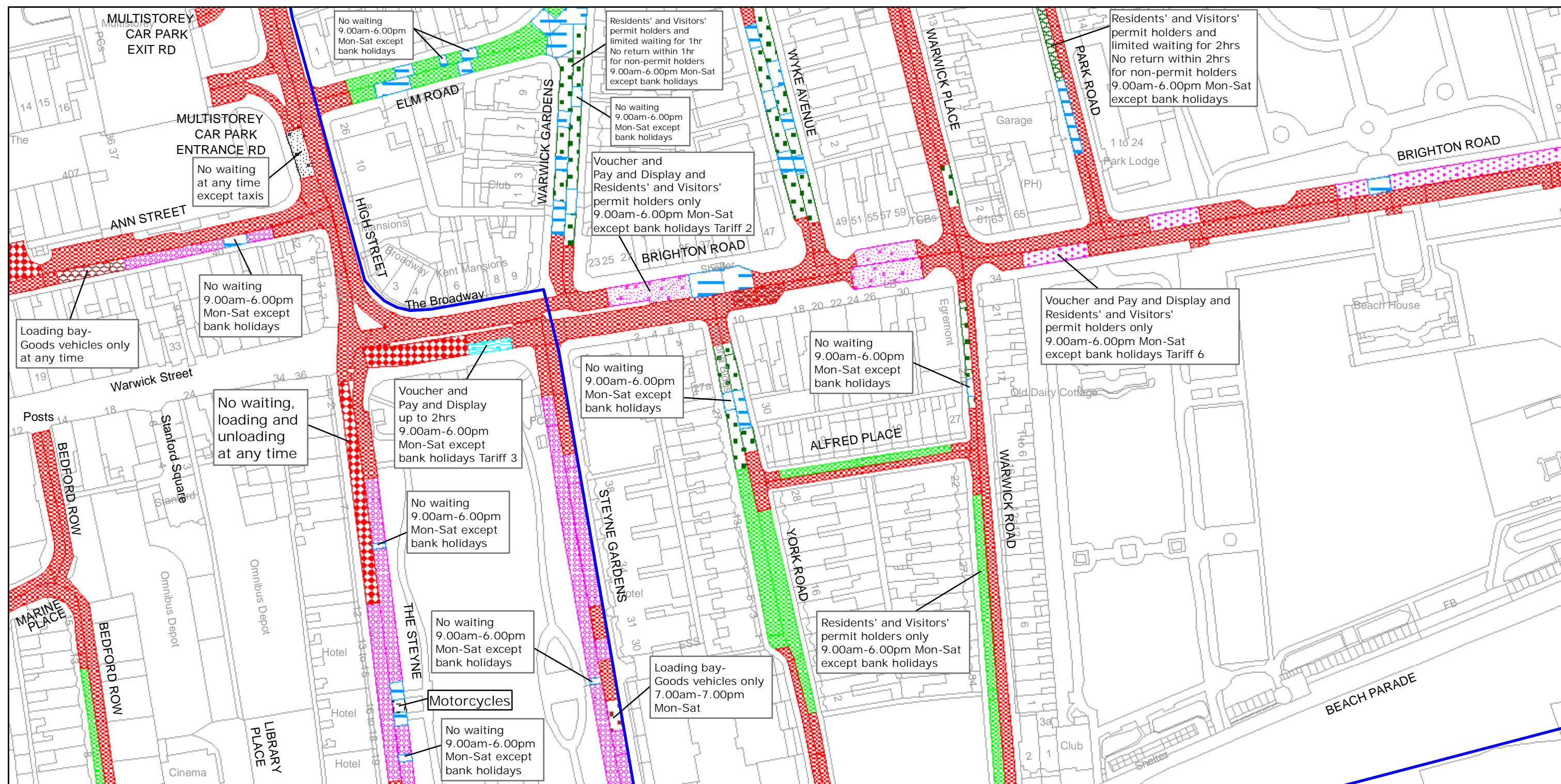

West Sussex County Council
Infrastructure
The Grange
Tower Street
Chichester
West Sussex
PO19 1RH

WORTHING BOROUGH: CENTRAL WARD WAITING RESTRICTIONS

Reproduced from or based upon 2009 Ordnance Survey mapping with permission of the Controller of HMSO (c) Crown Copyright reserved.
Unauthorised reproduction infringes Crown copyright and may lead to prosecution or civil proceedings West Sussex County Council Licence No. 100023447

TILE REF NO:
TQ1502NWS



SHEET ISSUE NO 4

SHEET ACTIVE FROM - 12/04/2010

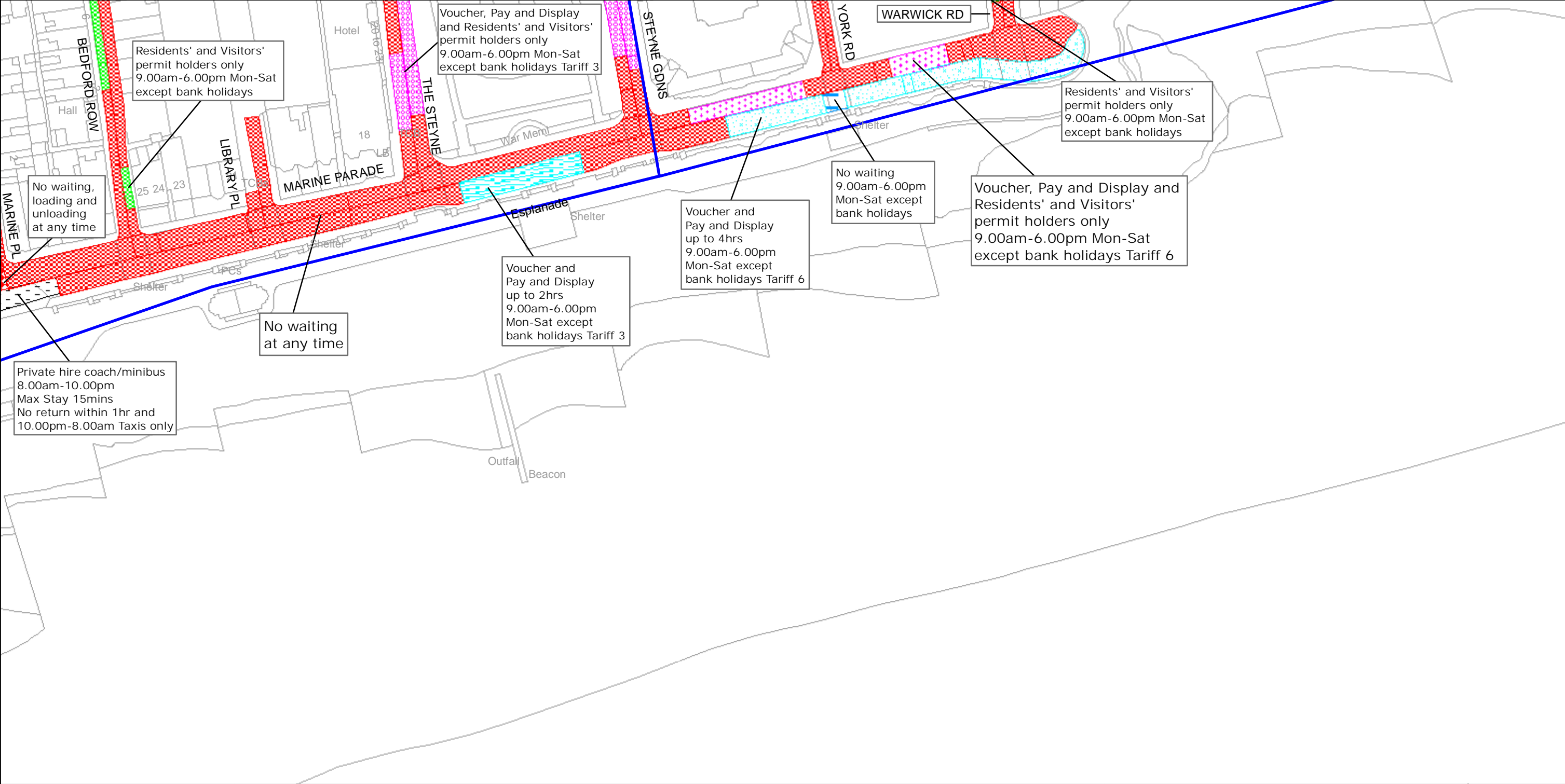

SCALE:
1:1250
at A3 size



 <p>West Sussex County Council Infrastructure The Grange Tower Street Chichester West Sussex PO19 1RH</p>	<p>WORTHING BOROUGH: CENTRAL WARD</p> <p>WAITING RESTRICTIONS</p> <p>Reproduced from or based upon 2009 Ordnance Survey mapping with permission of the Controller of HMSO (c) Crown Copyright reserved. Unauthorised reproduction infringes Crown copyright and may lead to prosecution or civil proceedings West Sussex County Council Licence No. 100023447</p>	<p>TILE REF NO: TQ1502SWN</p> <p>SHEET ISSUE NO 3</p> <p>SHEET ACTIVE FROM - 12/04/2010</p>	 <p>SCALE: 1:1250 at A3 size</p>
--	---	---	---

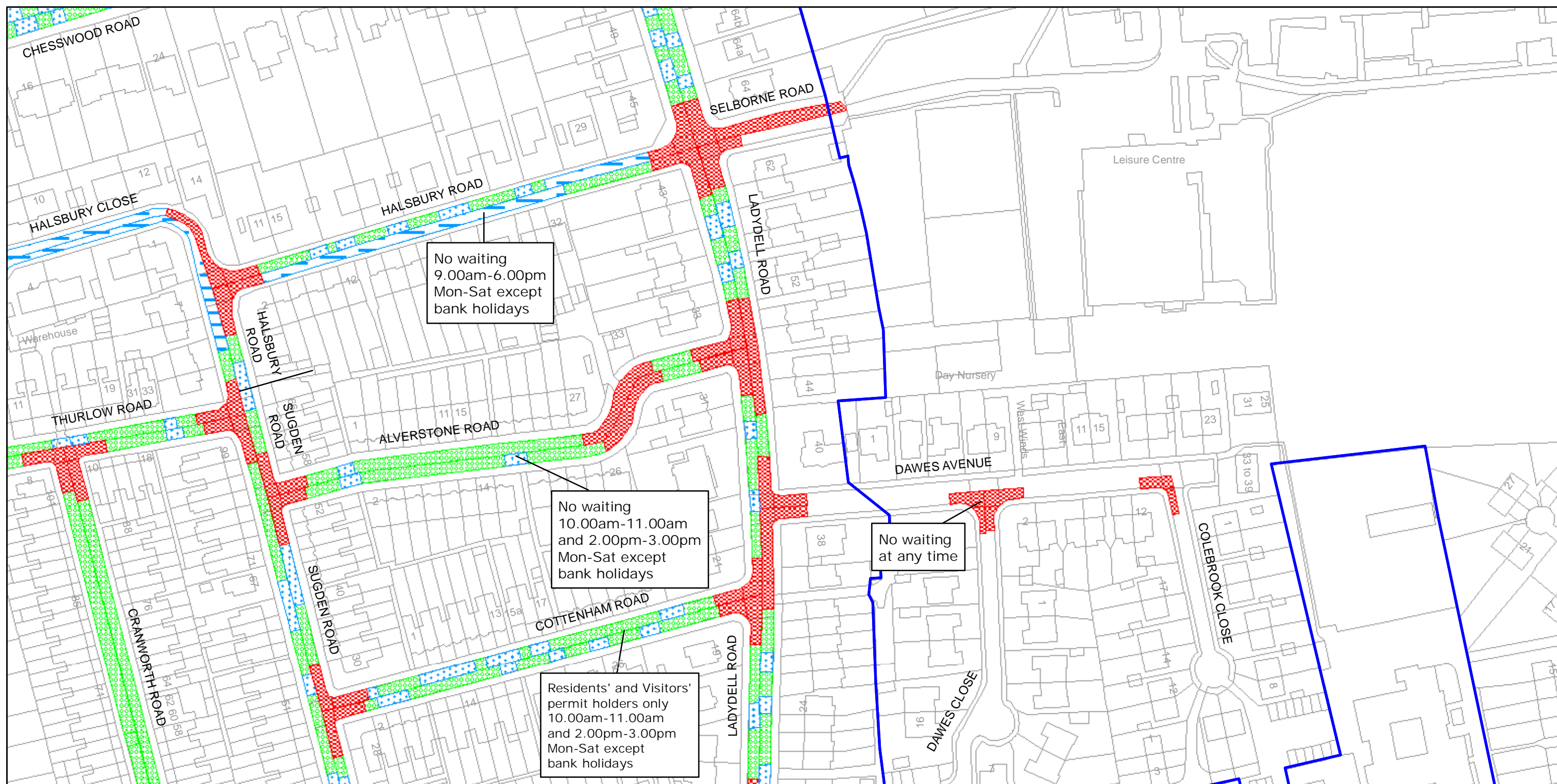

West Sussex County Council
Infrastructure
The Grange
Tower Street
Chichester
West Sussex
PO19 1RH

WORTHING BOROUGH: CENTRAL SELDEN WARD WAITING RESTRICTIONS

Reproduced from or based upon 2009 Ordnance Survey mapping with permission of the Controller of HMSO (c) Crown Copyright reserved.
Unauthorised reproduction infringes Crown copyright and may lead to prosecution or civil proceedings West Sussex County Council Licence No. 100023447

TILE REF NO:
TQ1503SEN

SHEET ISSUE NO 2

SHEET ACTIVE FROM - 12/04/2010



SCALE:
1:1250
at A3 size

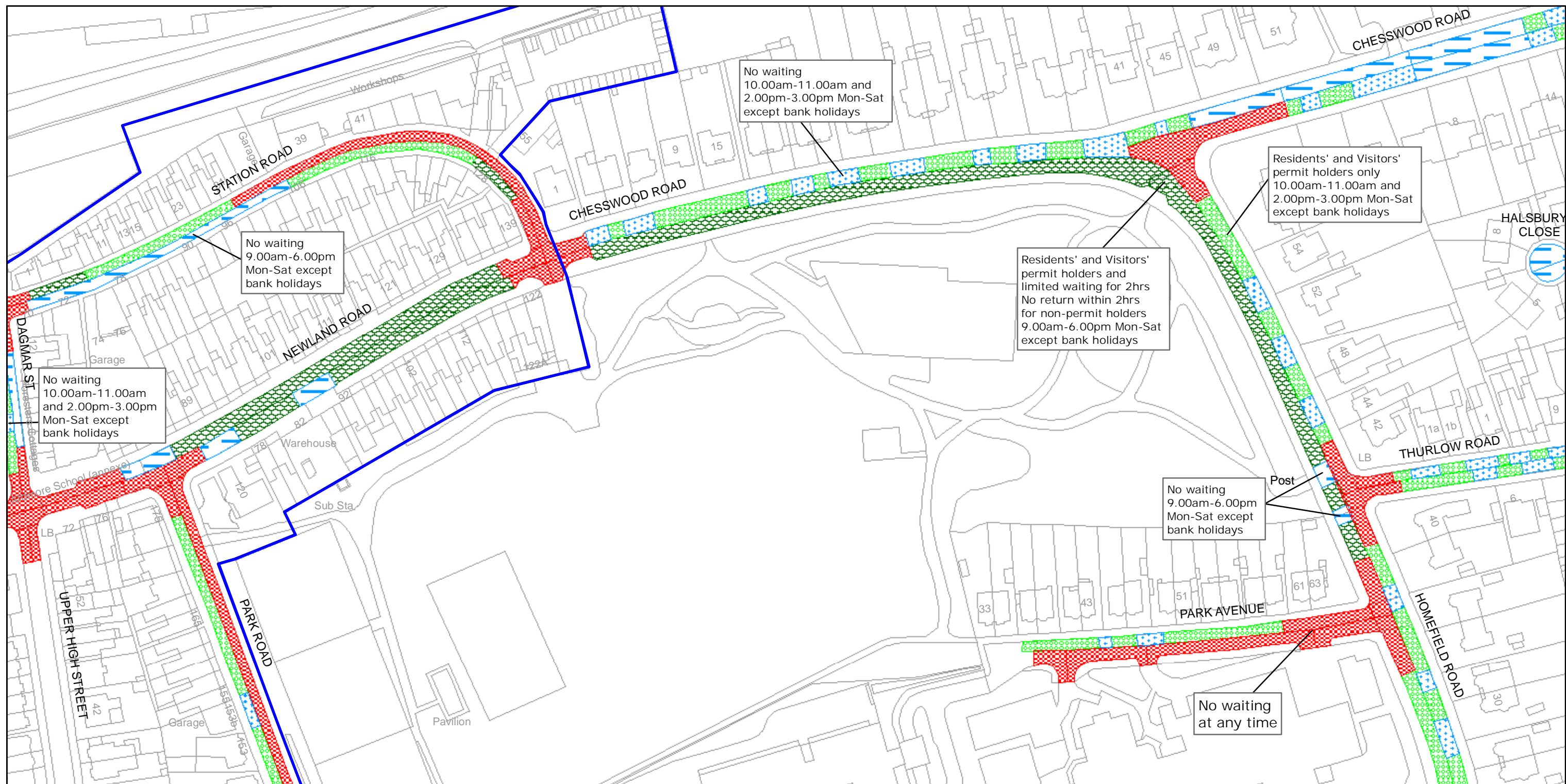

West Sussex County Council
Infrastructure
The Grange
Tower Street
Chichester
West Sussex
PO19 1RH

WORTHING BOROUGH: CENTRAL AND SELDEN WARDS WAITING RESTRICTIONS

Reproduced from or based upon 2009 Ordnance Survey mapping with permission of the Controller of HMSO (c) Crown Copyright reserved.
Unauthorised reproduction infringes Crown copyright and may lead to prosecution or civil proceedings West Sussex County Council Licence No. 100023447

TILE REF NO:
TQ1503SWN

SHEET ISSUE NO 3

SHEET ACTIVE FROM - 12/04/2010

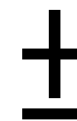

SCALE:
1:1250
at A3 size

