

FINAL

29207

**THE BOROUGH OF WORTHING  
(OFF-STREET PARKING PLACES)  
CONSOLIDATION ORDER 2007**

The Council of The Borough of Worthing (hereinafter called "the Council") in exercise of its powers under Section 32, 35 and Part IV of Schedule 9 of the Road Traffic Regulation Act, 1984, as amended ("the 1984 Act") and under the Road Traffic Act 1991 as amended ("the 1991 Act") and of all other enabling powers, with the consent of West Sussex County Council and after consultation with the Chief Office of Police in accordance with Part III of Schedule 9 to the Act hereby makes the following Order:

**PART I  
GENERAL**

Commencement and Citation

1. This Order shall come into operation on the 10<sup>th</sup> day of September 2007 and may be cited as The Borough of Worthing (Off-Street Parking Places) Order 2007.

Interpretation

2. In this Order, except where the context otherwise requires, the following expressions have the meanings respectively assigned to them:

"approved method of payment" means payment by debit or credit card facilitated by on site or remote verification by, for example, card reader or mobile phone text or phone call;

"charging days" means those days which are specified in the Schedules for each parking place respectively;

"charging hours" means the period specified in the Schedules for each parking place on all charging days;

"Council" means the Council of the Borough of Worthing and includes any parking services contractors or authorised agent appointed by or acting on behalf of the Council;

"day" printed on the front of a parking ticket indicates the day that the pay and display ticket is valid;

"disabled persons' badge" means a badge issued by any Local Authority in accordance with the provisions of the Local Authorities' Traffic Orders (Exemptions for Disabled Persons (England) Regulations 2000 or a badge having effect under those regulations as if it were a disabled person's badge;

"goods vehicle" means a vehicle which is constructed or adapted for use for the carriage of goods or burden of any description, the overall height of which does not exceed 1.85 metres and the unladen weight of which does not exceed 2540 kilograms and is not drawing a trailer;

"motor cycle" refers to a solo motor cycle only and excludes any motor cycle which has a side-car or trailer, or which has more than two wheels;

"owner" means the person in whose name the vehicle was at that time registered under the Vehicle Excise and Registration Act 1994;

"parking attendant" means a person authorised by or on behalf of the Council to supervise the parking places and enforce the restrictions imposed by this Order;

"parking bay" means an area of a parking place which is provided for the leaving of a vehicle of a class specified and indicated by markings on the

surface of the parking place or signed or otherwise indicated by signs in the parking place;

"parking place" means an area of land specified by name in the Schedules and provided by the Council pursuant to Section 32(1) of the 1984 Act for the purpose of vehicle parking and not closed (in part or in whole) by a Notice erected thereon by authority of the Council;

"passenger vehicle" means a vehicle constructed or adapted solely for the carriage of passengers and their effects;

"pay and display ticket" means a ticket issued by a ticket machine located in the parking place in which the vehicle has been left or issued by a person nominated by the Council on payment of a charge and valid for a parking period as detailed in the Schedules;

"penalty charge" means the charge set by the Council under Section 43 and Section 82(1) of the 1991 Act, which is to be paid to the Council following the issue of a Penalty Charge Notice and within 28 days of the issue of that Notice;

"penalty charge notice" means a notice issued by or served by a Parking Attendant pursuant to the provisions of Section 43 and Section 66 of the 1991 Act;

"permit" means any document issued by the Council (including a residents permit) allowing a vehicle to be parked in a specific parking place and a permit may specify conditions of use;

"relevant position" means

- (a) in respect of a vehicle displaying a disabled person's badge -

- (i) in the case of a vehicle fitted with a dashboard or fascia panel, the badge is exhibited thereon so that Part 1 of the badge is legible from outside the vehicle; or
  - (ii) in the case of a vehicle not fitted with a dashboard or fascia panel, the badge is exhibited in a conspicuous position on the vehicle so that Part 1 of the badge is legible from outside the vehicle
- (b) in respect of a vehicle displaying a ticket, season ticket, weekly ticket, permit or indication of participation in a scheme of approved method of payment,
  - (i) in the case of a vehicle which is fitted with a transparent windscreen, the ticket or permit is exhibited on the inside surface of the windscreen so that it is facing forwards and can be easily seen and read from the front of the vehicle; or
  - (ii) in the case of a vehicle which is not fitted with a transparent windscreen, the ticket or permit is exhibited on the front of the vehicle facing forwards not more than 2 metres and not less than 1.75 metres above the surface of the parking place in the immediate vicinity;

"season ticket" and "weekly ticket" mean a ticket purchased, subject to certain conditions, valid for the period specified on the ticket for use in parking places specified and indicated on the ticket;

"ticket machine" means an apparatus of a type and design approved by the Secretary of State for Transport for the purpose of this order, being apparatus designed to indicate the time by a clock and to issue parking tickets which show that a payment has been made of an amount or for a period specified thereon and which specify the date and, either the time of such payment, or the time at which the vehicle must leave the parking place;

"vehicle" means a mechanically propelled vehicle intended or adapted for use on roads and includes a motor cycle.

3. Except where the context requires otherwise, any reference in this Order to an Article or Schedule shall be construed as a reference to that Article or Schedule in this Order.
4. Any reference in this Order to any enactment shall be construed as a reference to that enactment as amended, applied, consolidated, re-enacted by or as having effect by virtue of any subsequent enactment.
5. The Interpretation Act 1978 shall apply for the interpretation of this Order.

## **PART II**

### **DESIGNATION AND USE OF PARKING PLACES**

#### Designation

6. Each area of land referred to in the Schedules and Plans may be used, subject to the provisions of this Order, as a place to leave vehicles of such classes, in such positions, on such days, during such hours, for such period and on payment of such charges as are specified in relation thereto in the Schedules.

#### Class and position of vehicle

7. Where in the Schedules a parking place is described as available for vehicles of a specified class or vehicles to be left in a specified location, no person shall permit a vehicle to wait in that parking place or in any parking bay within the parking place,
  - (i) unless it is of the specified class;
  - (ii) unless it is wholly within a marked parking bay; or
  - (iii) in a position other than that specified.

#### Maximum period of stay

8. Where in the Schedules a parking place is described as available on specified days, during specified hours or for a maximum period of stay, no person shall permit a vehicle to wait in that parking place on any day, during such hours or for any period other or longer than those specified.

#### Period of no return

9. Where in the Schedules a parking place is described as having a period within which a vehicle may not return, no person shall permit a vehicle to wait in that parking place on any day, during such hours within which the vehicle is excluded from waiting in the parking place.

#### Season ticket and weekly ticket

10. Nothing in Articles 17 or 18 shall preclude a vehicle left in a pay and display parking place and displaying a valid season ticket or weekly ticket in the relevant position from being parked without payment of the daily charge in the relevant parking places specified in the Schedules.

#### Disabled person's parking bays

11. No person shall cause or permit a vehicle to park in a parking bay marked for Disabled Persons unless the vehicle displays a Disabled Person's Badge in the relevant position and immediately before or immediately after the act of parking the vehicle has been or is about to be used by the person(s) in respect of whom the badge has been issued.

#### Power to close or suspend parking places

12. Nothing in this Order shall prevent the Council by notice, sign or barrier displayed in the parking place,
  - (i) from closing the parking place or any part thereof for any period; and/or
  - (ii) from setting aside the parking place or any part or parts thereof on all days or on certain days or during certain parts of days for use only by particular vehicles or organisations.
13. Any person suspending the use of a parking place or any part thereof in accordance with the provisions of Article 13 shall thereupon place or cause to be placed in or adjacent to that parking place or that part thereof a notice or traffic sign indicating that the use of that parking place or that part thereof is suspended and that waiting by vehicles is prohibited.

14. No person shall cause or permit a vehicle to be left in a parking place or any part thereof during such periods that the use of that parking place or that part thereof is suspended or during such period as there is in or adjacent thereto a notice or traffic sign placed by or on behalf of the Council in pursuance of the preceding Article.

### **PART III**

#### **CHARGES FOR PARKING**

##### Payment

15. The driver of a vehicle using a parking place shall upon leaving the vehicle in the parking place pay the appropriate charge (if any) in accordance with the scale of charges specified in the Schedules.

##### Pay on foot parking places

16. The driver of a vehicle using a pay on foot parking place shall, upon arriving at the parking place, either
- (a) take a ticket from the entry machine to establish time of entry and shall before returning to his/her vehicle, pay, by cash into the ticket machine or by another approved method of payment, a parking fee at the level of charge and for the period used in accordance with the scale of charges specified in the Schedules, or
  - (b) insert a valid credit card into the entry machine to gain entrance and insert it again at a payment machine or the exit machine so that an appropriate parking fee for the period used in accordance with the scale of charges specified in the Schedules can be calculated and charged to the credit card.

##### Pay and display parking places

17. The driver of a vehicle using a pay and display parking place shall upon leaving the vehicle in the parking place,



- (i) purchase a pay and display ticket at the level of charge and for the period required in accordance with the scale of charges specified in the Schedules, or
- (ii) make arrangements to pay the appropriate fee through an approved method of payment at the level of charge and for the period required in accordance with the scale of charges specified in the Schedules.

Means of payment in pay and display parking places

18. The charge referred to in the preceding Article shall be payable by the insertion of an appropriate coin, coins or banknotes, together making up the amount of the charge into the ticket machine situated in that parking place or by other approved method of payment.

Display of ticket in pay and display parking places

19. On obtaining a pay and display ticket, the driver of the vehicle shall,
- (i) display the pay and display ticket issued on payment of the charge in the relevant position on the vehicle in respect of which it was issued, and
  - (ii) ensure that a pay and display ticket is purchased and continuously displayed to cover the entire period that the vehicle is parked in the parking place.

Validity of pay and display tickets in pay and display parking places

20. A pay and display ticket is not transferable from one vehicle to another.
21. A pay and display ticket is valid only in the parking place in which it was issued. This is defined by the reference code of the parking ticket machine located in that parking place printed on the pay and display ticket.

Expiry of parking period in pay and display parking places

22. The expiry of the period for which the charge specified for that parking place in the Schedules has been paid shall be indicated,

- (i) when there is exhibited on the vehicle a parking ticket and the time shown on the clock of the issuing ticket machine is later than the time at which the period for which a charge has been paid expired, or
- (ii) where an approved method of payment has been used, the period for which payment has been made and recorded has been exceeded.

No ticket displayed in pay and display parking places

23. If at any time while a vehicle is left in a parking place an approved method of payment has been used to pay the appropriate charge and no ticket has been obtained from the ticket machine, an indication shall be displayed on the vehicle in the relevant position that the driver participates in the scheme for the approved method of payment.
24. If at any time while a vehicle is left in a parking place no pay and display ticket or indication of participation in a scheme of approved method of payment is displayed on that vehicle in the relevant position, it shall be deemed that the charge has not been paid.

Ticket machine(s) out of action

25. If at the time when a vehicle is left during the permitted hours in a parking place on the nearest ticket machine in that parking place there is a notice placed by any person duly authorised by the Council, indicating that the said ticket machine is out of order, then a ticket shall be obtained from another machine (where provided).
26. Where no valid pay and display ticket can be obtained and displayed vehicles may be left in a parking place but may not be left for longer than the maximum period of waiting in that parking place as specified in the Schedules.

Season tickets and weekly tickets

27. Season tickets and weekly tickets are available at the appropriate fee, for a vehicle of a specific class and for the parking places as specified on the season ticket or weekly ticket subject to conditions determined from time to time by the Council.
28. The driver shall abide by the terms stipulated by the Council for the use of the season ticket or weekly ticket.

29. A season ticket or weekly ticket is only valid in the parking place in respect of which it was issued and up to the date of expiry shown on or programmed into the season ticket or weekly ticket.
30. A season ticket remains the property of the Council and must be surrendered on request. In such instances where a refund fee is appropriate this will be provided in accordance with the Council's policies.

#### Pay on foot season ticket and weekly ticket

31. The driver of a vehicle shall use the season ticket or weekly ticket to gain access to and egress from a pay on foot parking place by entering the season ticket into the ticket reading machine at the entry and exit lanes respectively.

#### Pay and display season ticket and weekly ticket

32. The driver of the vehicle shall display the season ticket or weekly ticket in the relevant position on the vehicle in respect of which it was issued at all times during which the vehicle is left in a pay and display parking place during the hours of operation.

#### Replacement season tickets

33. Damaged or lost season tickets will be replaced on application to the Council subject to certain conditions and payment of an appropriate fee determined from time to time by the Council. The damaged or lost season ticket will then become immediately invalid.

#### Surrender of season ticket

34. A holder of a season ticket on surrendering the ticket shall be entitled to a refund based upon the number of complete units remaining un-expired from the beginning of the unit following the date on which the Council receives the surrendered ticket. The refund will be pro rata for each un-expired unit.

#### Residents permits

35. Permits may be issued to residents in the properties situated in Park Crescent to allow a vehicle displaying such a permit to be left in a residents parking bay in Amelia Park parking place; the permit to be subject to such charge and conditions as determined from time to time by the Council.

#### Restriction on removal

36. When a pay and display ticket, season ticket or weekly has been exhibited on a vehicle in the relevant position no person shall remove the pay and display ticket or season ticket from the vehicle until the vehicle is removed from the parking place.

### **PART IV**

#### **EXEMPTIONS FROM DAILY CHARGES**

37. No daily charge shall be payable in a pay and display parking place in respect of;
- (i) a vehicle which displays in the relevant position a valid disabled person's badge, provided that the vehicle is left in a marked disabled person's bay and immediately before or after the act of parking has been used or is about to be used by the person(s) in respect of whom the badge is issued;
  - (ii) a vehicle left displaying in a relevant position a season ticket or weekly ticket valid for that day and that parking place; or
  - (iii) a vehicle left displaying in a relevant position a permit issued by or approved by the Council valid for that time and for that parking place.

#### Absence of ticket machine

38. If at the time when a vehicle is left in a pay and display parking place during the charging hours there is no working ticket machine at the parking place, or all the ticket machines at that parking place carry notices placed upon them by a person duly authorised by the council indicating that they are out

of order, the driver of that vehicle shall be exempt from purchasing a parking ticket.

## **PART V**

### **RELOCATION AND REMOVAL OF VEHICLES**

#### Relocation of a vehicle

39. Where any vehicle is standing in a parking place in contravention of the provisions of this Order, or is left in such a manner so as to cause danger or obstruction a parking attendant or a person authorised by the Council may alter or cause to be altered the position of the vehicle.

#### Removal of a vehicle

40. Where a parking attendant or a person authorised by the Council is of the opinion that any of the provisions contained in this Order have been contravened or not complied with in respect of a vehicle left in a parking place he/she may, using such measures as are appropriate, remove or cause to be removed the vehicle from the parking place.

#### Emergencies

41. A parking attendant, a person authorised by the Council or a police officer in uniform may, using such measures as are appropriate, move or cause to be moved/removed in the case of an emergency to any place he/she thinks fit, any vehicle left in a parking place.

#### Safe keeping

42. Any person removing a vehicle from a parking place under the preceding Articles shall make such arrangements as may be reasonably necessary to provide for the safe keeping of the vehicle

## **PART VI**

### **OTHER PROVISIONS**

#### Stop engine and apply brakes

43. The driver of a motor vehicle using a parking place shall stop the engine as soon as the vehicle is in the parking space and shall not start the engine except when about to change the position of the vehicle in or to depart from the parking place;

Manner of parking of trailers

44. The driver of a vehicle drawing a trailer shall not permit the vehicle or the trailer to wait in a parking place unless they have been disconnected, and for the purposes of this Order the vehicle and the trailer shall be deemed to be separate vehicles and the driver of the leading vehicle shall be deemed to be the driver of both of the vehicles.

Repair of vehicles in parking places

45. No person shall, while a vehicle is in a parking place, permit the carrying out of any work of maintenance or repair thereto except such as may be necessary to enable the vehicle to be moved from the parking place.

Vehicle tax and insurance

46. No person shall permit any vehicle to wait in a parking place:
- (i) unless the vehicle displays a current licence issued in accordance with the provisions of the Vehicle Excise and Registration Act 1994;
  - (ii) unless there is in relation to the use of the vehicle by the driver such a policy of insurance as complies with requirements of the Road Traffic Act 1988;

Entry and Exit

47. Where signs are erected or surface markings are laid for the purpose of indicating the entrances to or exits from the parking place; or indicating that a vehicle proceed in a specified direction, no person should drive or cause to be driven any vehicle;
- (i) so that it enters the parking place otherwise than by an entrance, or leaves the parking place otherwise than by an exit;
  - (ii) in a direction other than that specified, as the case may be;

- (iii) in a manner or at a speed so as to cause danger to other users of the parking place.

#### Use of vehicles and parking places

48. No person shall in a parking place:

- (i) without the express written permission of the Council, use a vehicle, in connection with the sale of any article, including the vehicle itself, to any person in or near the parking place or in connection with the selling or offering for hire of skill or services in any other capacity;
- (ii) use a vehicle, in connection with the sale of any article unless so doing as part of a market the existence of which has been duly authorised by the Council;
- (iii) sound any horn or other similar instrument except when about to change the position of the vehicle in or to depart from the parking place;
- (iv) except with the permission or at the direction of a parking attendant or a person authorised by the Council or a police officer in uniform, drive any vehicle other than for the purpose of leaving the vehicle in the parking place in accordance with the provisions of this Order or for the purpose of departing from the parking place or for the purpose of visiting any amenity site in the parking place;
- (v) use any part of the parking place or a vehicle in a parking place without the express written permission of the Council for;
  - (a) sleeping or camping purposes;
  - (b) cooking purposes;
  - (c) the purpose of washing, valeting or servicing any vehicle or part thereof other than is reasonably necessary to enable that vehicle to depart from the parking place;
- (vi) use that parking place solely as a means of passage proceeding from one road to another;
- (vii) deposit or leave any vehicle, trailer, or anything which formed part of a vehicle or trailer, or any rubbish, litter or anything with the purpose of abandoning it there.



- (viii) wantonly shout or otherwise make any noise to cause disturbance or annoyance of users of the parking place or residents or other occupiers of adjacent premises;
- (ix) act in a manner to cause nuisance or danger to any car park user, resident or other person;
- (x) erect or cause or permit to be erected, any tent, booth, stand, building or other structure;
- (xi) light or cause to be lit a fire;

#### Liability

49. The Council accepts no liability for the loss or damage to vehicles or other property left in any of the Council's parking places to which this Order applies.

#### Wilful damage

50. Any person who with intent to defraud interferes with the parking ticket machine or operates or attempts to operate it by the insertion of objects other than undamaged and unaltered coins of legal tender and of the appropriate denomination, or other approved method of payment, shall be liable to prosecution.

### **PART VII**

#### **CONTRAVENTION AND PENALTY CHARGE**

#### Contravention

51. If a vehicle is left in a parking place referred to in the Schedules without complying with the requirements of this Order, a contravention shall have occurred and a penalty charge shall be payable and/or the vehicle may be removed from the parking place. A penalty charge notice showing the information required by the 1991 Act may then be issued by a parking attendant in accordance with the requirements of the 1991 Act.

#### Notice of penalty charge

52. In the case of a vehicle in respect of which the penalty charge may have been incurred, it shall be the duty of a parking attendant to attach to the vehicle in a conspicuous position a notice which shall include the following particulars:

- (i) The grounds on which the parking attendant believes that a penalty charge is payable with respect to the vehicle;
- (ii) The amount of the penalty charge which is payable;
- (iii) That the penalty charge must be paid before the end of the period of 28 days beginning with the date of the Notice;
- (iv) that if the penalty charge is paid before the end of the period of 14 days beginning with the date of the Notice, the amount of the penalty charge will be reduced by the specified proportion;
- (v) that if the penalty charge is not paid before the end of the 28 day period a Notice to the owner may be served by the Local Authority on the person appearing to them to be the owner of the vehicle;
- (vi) the address to which payment of the penalty charge must be sent.

In sub-section (iv) above "specified proportion" means such proportion, applicable to all cases, as may be determined by the Local Authorities acting through the Joint Committee.

#### Restriction on removal of notices

53. A penalty charge notice fixed to a vehicle in accordance with the preceding Article shall not be removed or interfered with except by or under the authority of:

- (i) the owner, or person in charge of, of the vehicle;
- (ii) the Authority for the place in which the vehicle in question was found.

#### Payment of penalty charge

54. The owner of a vehicle in respect of which the penalty charge has been incurred shall pay the penalty charge to the Council as indicated on the penalty charge notice within 28 days of the date of issue of the penalty charge notice.

55. If the penalty charge is paid before the end of the period of 14 days beginning with the date of the notice, the amount of the penalty charge will be reduced by the specified proportion.
56. If the owner fails to pay the penalty charge by the end of the 28 day period, a notice to owner may be served; and if the charge is then not paid within a further 28 days it may be increased by 50%.
57. Payment shall be received not later than 1600 on the 28th day following the day on which such penalty charge was incurred or the 14th day following the day on which the charge was incurred if the reduced charge is paid. Provided that if the said 28th or 14th day falls upon a day on which the office to which payments should be made is closed, the period within which payment of the said Penalty Charge shall be made to the Council shall be extended until 1600 on the next full day on which the said office is open.

#### Indications as Evidence

58. The particulars given in the penalty charge notice attached to a vehicle in accordance with Article 52 shall be treated as evidence in any proceedings relating to failure to pay such Penalty Charge.

### **PART VIII**

### **DISPOSAL OF VEHICLES**

#### Disposal of vehicles abandoned in parking places

59. The Council may sell or otherwise dispose of a vehicle which has been, or could at any time be, removed from a parking place pursuant to Articles 40 or 51, if the vehicle appears to have been abandoned, provided that this power of disposal shall not be exercisable unless the Council has taken such of the following steps as are applicable to the vehicle in question, and there has elapsed a period of six weeks beginning with the taking of the first of those steps.

60. Where the vehicle carries a registration mark the Council shall ascertain from the appropriate body the name and address of the person who is the Registered Keeper of the vehicle pursuant to the Vehicles (Excise) Act 1971, unless the Council is satisfied that the true owner of the vehicle has identified himself to it.
61. The Council shall, where it is by virtue of Articles 60, 62 and 63, aware of the name and address of a person who it appears may be the owner of the vehicle, send a Notice to that person at that address stating that it is the intention of the Council to sell or otherwise dispose of the vehicle (which shall be sufficiently described in the Notice) on or after a specified date (which shall not be less than two weeks from the date of the Notice and in any event not earlier than six weeks from the date of the first step taken by the Council under this Part of this Order) unless it is in the meantime removed by or on behalf of that person from such place as is specified by the Council in the said Notice or from such place as may be subsequently notified in writing by the Council to that person.
62. If any person to whom a Notice is sent in accordance with Article 61 informs the Council of the name and address of some other person who he/she alleges may be the owner of the vehicle, a Notice stating the particulars mentioned in the last preceding Article shall be sent to that other person and to any further person who the Council may in consequence of the sending of the Notice to the said other person be led to believe may be the owner of the vehicle.
63. Where a vehicle does not carry a registration mark the first step to be taken by the Council shall be to apply in writing to the Chief Officer of Police in whose area the parking place is situated enquiring whom that officer considers is the owner of the vehicle and the address of that person.
64. The Council shall then make such further enquiries as to ownership as it thinks fit.

65. Upon the sale of a vehicle by the Council, the Council shall apply the proceeds of sale in or towards the satisfaction of any costs incurred by it in connection with the disposal thereof and of any charge or payment to which it is entitled.
66. In the event that any such costs incurred by the Council in connection with the disposal of the vehicle are not satisfied by virtue of the last preceding Article, the Council may recoup those costs from the person who was the owner of the vehicle immediately before it was removed from the parking place, provided that that person was sent by the Council a Notice under Article 61.
67. Any sums received by the Council on a sale of a vehicle shall, after deducting any sum applied thereabouts by virtue of Article 65, be payable within a period of one year from receipt hereof to any person to whom, but for such sale, the vehicle would have belonged and insofar as any such sums are not claimed within the said period they shall be paid into the General Rate Fund of the Council.
68. Where under the foregoing provisions of this Order a Notice is required to be or may be sent to a person the Notice shall be sent by recorded delivery post.

## **PART IX**

### **REVOCATIONS**

#### Revocations

69. The Orders listed below having been made by Worthing Borough Council are hereby revoked:

The Borough of Worthing (Off-Street Parking Places Orders) (Variation)  
Order 1993 (Variation) Order 2000

The Borough Council of Worthing (Liverpool Road Off-Street Parking Places Order) (Variation) Order 1998

The Borough Council of Worthing (Amelia Park Off-Street Parking Places) Order 1994

The Borough Council of Worthing (Civic Centre Car Park Off-Street Parking Places) Order 1994

The Borough of Worthing (Sea Place and Marine Crescent Off-Street Parking Places) Order 1993

The Borough of Worthing (Off-Street Parking Places Orders) (Variation) Order 1993

The Borough of Worthing (High Street Multi-Storey Parking Place Order) (Variation) Order 1991

The Borough of Worthing (Liverpool Road Off-Street Parking Places) Order 1989

The Borough of Worthing (Off-Street Parking Places Orders) (Variation) Order 1982

The Borough of Worthing (Various Off-Street Parking Places) Order 1977

The Borough of Worthing (High Street Multi-Storey Parking Place) Order 1976

GIVEN under the Common Seal of The Borough Council of Worthing the 15<sup>th</sup> day of June 2007

THE COMMON SEAL of THE BOROUGH )  
COUNCIL OF WORTHING was hereunto )  
affixed in the presence of: )

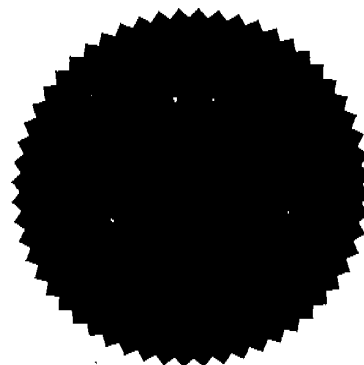

8680

*W. A. Brown*

ASSISTANT DIRECTOR  
(LEGAL & DEMOCRATIC SERVICES)

**SCHEDULE 1**  
**PAY ON FOOT PARKING PLACES**

Name of parking place	Classes of vehicles	Days of operation Hours of operation	Charging days Charging hours	Scale of charges  Maximum period of waiting
Buckingham Road Multi-storey	All vehicles except (a) goods vehicles exceeding 1.5 tonnes unladen weight; (b) passenger vehicles adapted to carry more than 12 passengers; (c) motor cycles; (d) caravans (e) vehicles over 1.83 metres in height	All days All hours	All days All hours	Each 30 minutes - 80p Up to maximum daily rate £10.00  Night rate 1800 to 0600 - £1.00 per hour up to maximum of £3.00  Sunday 0600 to 1800 - £1.00 per hour up to maximum of £3.00  Weekly ticket valid 7 days - £33.00  Season tickets - Monthly £ 103.00 Quarterly £ 280.00 Annual £1,084.00
Grafton Multi-storey	All vehicles except (a) goods vehicles exceeding 1.5 tonnes unladen weight; (b) passenger vehicles adapted to carry more than 12 passengers; (c) motor cycles; (d) caravans	All days All hours	All days All hours	Each 30 minutes - 80p Up to maximum daily rate £10.00  Night rate 1800 to 0600 - £1.00 per hour up to maximum of £3.00  Sunday 0600 to 1800 - £1.00 per hour up to maximum of £3.00  Weekly ticket valid 7 days - £33.00



	(e) vehicles over 1.8 metres in height			Season tickets - Monthly £ 103.00 Quarterly £ 280.00 Annual £1,084.00
High Street Multi-storey	All vehicles except (a) goods vehicles exceeding 1.5 tonnes unladen weight; (b) passenger vehicles adapted to carry more than 12 passengers; (c) motor cycles; (d) caravans (e) vehicles over 1.83 metres in height	All days All hours	All days All hours	Each 30 minutes - 80p Up to maximum daily rate £10.00  Night rate 1800 to 0600 - £1.00 per hour up to maximum of £3.00  Sunday 0 600 to 1800 - £1.00 per hour up to maximum of £3.00  Weekly ticket valid 7 days - £33.00  Season tickets - Monthly £ 103.00 Quarterly £ 280.00 Annual £1,084.00

**SCHEDULE 2**  
**PAY AND DISPLAY PARKING PLACES**

Name of parking place	Classes of vehicles	Days of operation Hours of operation	Charging days Charging hours	Scale of charges Maximum period of waiting
Teville Gate Multi-storey	All vehicles except (a) goods vehicles exceeding 1.5 tonnes unladen weight; (b) passenger vehicles adapted to carry more than 12 passengers; (c) motor cycles; (d) caravans (e) vehicles over 1.83 metres in height	All days Monday to Sunday 0600 to 2000	All days All hours	Up to 14 hours - £1.60 Weekly ticket - £5.50 Season tickets - Monthly £ 12.00 Quarterly £ 33.00 Annual £ 108.00 Maximum stay 14 hours
* Beach House East	All vehicles except (a) passenger vehicles capable of carrying more than 12 passengers (b) goods vehicles exceeding 1.5 tonnes unladen weight (c) caravans	All days All hours	All days All hours	Up to 1 hour - £1.20 1 to 2 hours - £2.10 2 to 3 hours - £3.20 3 to 4 hours - £4.30 4 to 6 hours - £5.40 6 to 24 hours - £6.50 Weekly ticket £30.00
Beach House West	All vehicles except (a) passenger vehicles capable of carrying more than 12 passengers (b) goods vehicles exceeding 1.5 tonnes unladen weight (c) caravans	All days All hours	All days All hours	Up to 1 hour - £1.20 1 to 2 hours - £2.10 2 to 3 hours - £3.20 3 to 4 hours - £4.30 4 to 6 hours - £5.40 6 to 24 hours - £6.50

				Weekly ticket £30.00  Season tickets - Monthly £ 106.00 Quarterly £ 287.00 Annual £ 975.00
Brooklands – Brighton Road West	All vehicles except (a) passenger vehicles capable of carrying more than 12 passengers (b) goods vehicles exceeding 1.5 tonnes unladen weight (c) vehicles over 1.83 metres in height	All days  All hours	All days  All hours	Up to 30 minutes -50p 30 minutes to 1 hour - £1.20 1 to 2 hours - £1.70 2 to 3 hours - £2.20 3 to 6 hours - £3.00
Brooklands – Brighton Road East	Ditto	Ditto	Ditto	Ditto
Brooklands – Western Road	Ditto	Ditto	Ditto	Ditto
Civic Centre	All vehicles except (a) passenger vehicles capable of carrying more than 12 passengers (b) goods vehicles exceeding 1tonne unladen weight save those fronting part of any duly authorised market	All days  All hours	Monday to Friday – private car park  Saturday 0800 to 1800	Up to 1 hour - £1.60 1 to 2 hours - £3.00 2 to 3 hours - £4.30 3 to 4 hours - £5.50 4 to 6 hours - £7.50 6 to 12 hours - £9.00 Vehicles displaying special permits - free Sundays - free
High Street Surface	All vehicles except (a) passenger vehicles capable of carrying more than 12 passengers (b) goods vehicles exceeding 1.5 tonnes unladen weight (c) caravans (d) motor cycles	All days  All hours	All days  All hours	Up to 1 hour - £1.60 1 to 2 hours - £3.20 2 to 3 hours - £4.80  Maximum stay 3 hours
Lyndhurst Road East	All vehicles except (a) passenger vehicles capable of	All days	All days	Up to 1 hour - £1.20 1 to 2 hours - £2.10

	carrying more than 12 passengers (b) goods vehicles exceeding 1.5 tonnes unladen weight (c) caravans (d) vehicles over 1.83 metres in height	All hours	All hours	2 to 3 hours - £3.20 3 to 4 hours - £4.30 4 to 6 hours - £5.40 6 to 24 hours - £6.50  Weekly ticket £30.00
Lyndhurst Road west	All vehicles except (a) passenger vehicles capable of carrying more than 12 passengers (b) goods vehicles exceeding 1.5 tonnes unladen weight (c) caravans (d) vehicles over 1.83 metres in height	All days  All hours	All days  All hours	Up to 1 hour - £1.20 1 to 2 hours - £2.10 2 to 3 hours - £3.20 3 to 4 hours - £4.30 4 to 6 hours - £5.40 6 to 24 hours - £6.50  Weekly ticket £30.00 Season tickets - Monthly £ 106.00 Quarterly £ 287.00 Annual £ 975.00
Marine Crescent	All vehicles except (a) passenger vehicles capable of carrying more than 12 passengers (b) goods vehicles exceeding 1 tonne unladen weight (c) vehicles over 1.83 metres in height	All days  All hours	All days  All hours	Up to 30 minutes -50p 30 minutes to 1 hour - £1.20 1 to 2 hours - £1.80 2 to 3 hours - £2.20 3 to 6 hours - £3.20  Season tickets - Monthly £ 11.00 Quarterly £ 30.00 Annual £ 115.00
Sea Place	All vehicles except (a) passenger vehicles capable of carrying more than 12 passengers (b) goods vehicles exceeding 1 tonne unladen weight (c) vehicles over 1.83 metres in height	All days  All hours	All days  All hours	Up to 30 minutes -50p 30 minutes to 1 hour - £1.20 1 to 2 hours - £1.80 2 to 3 hours - £2.20 3 to 6 hours - £3.20 6 to 24 hours - £4.20

**SCHEDULE 3  
FREE PARKING PLACES**

Name of parking place	Classes of vehicles	a) Days of operation b) Hours of operation	Charging days and hours	Scale of charges  Maximum period of waiting
Amelia Park	All vehicles except (a) passenger vehicles capable of carrying more than 12 passengers (b) goods vehicles exceeding 7.5 tonnes unladen weight (c) caravans  In bays marked for residents, only vehicles displaying a valid residents permit	All days  All hours	Monday to Saturday  0900 to 1800	Vehicles displaying a valid residents permit and waiting in a space reserved for residents – no maximum stay  Vehicles displaying a disabled persons badge and waiting in a space marked for disabled badge holders – in accordance with time limit (if any) for maximum stay  Public spaces - No charge 1 hour maximum stay, no return same day

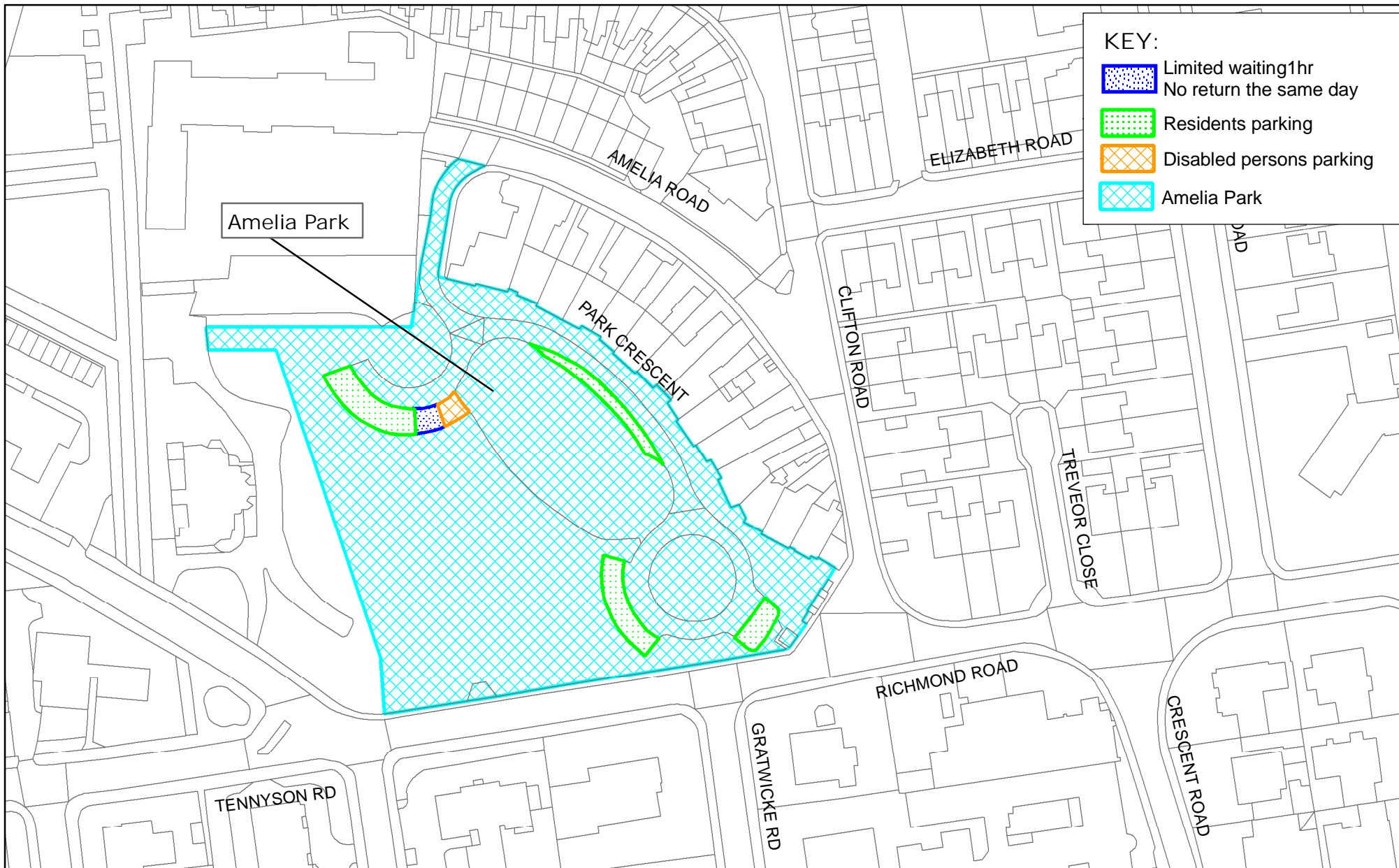

Reproduced from or based upon 2006 Ordnance Survey mapping with permission of the Controller of HMSO (c) Crown Copyright reserved. Unauthorised reproduction infringes Crown copyright and may lead to prosecution or civil proceedings West Sussex County Council Licence No. 100018485

WORTHING OFF STREET PARKING PLACES

AMELIA PARK

SCALE: 1:1,250



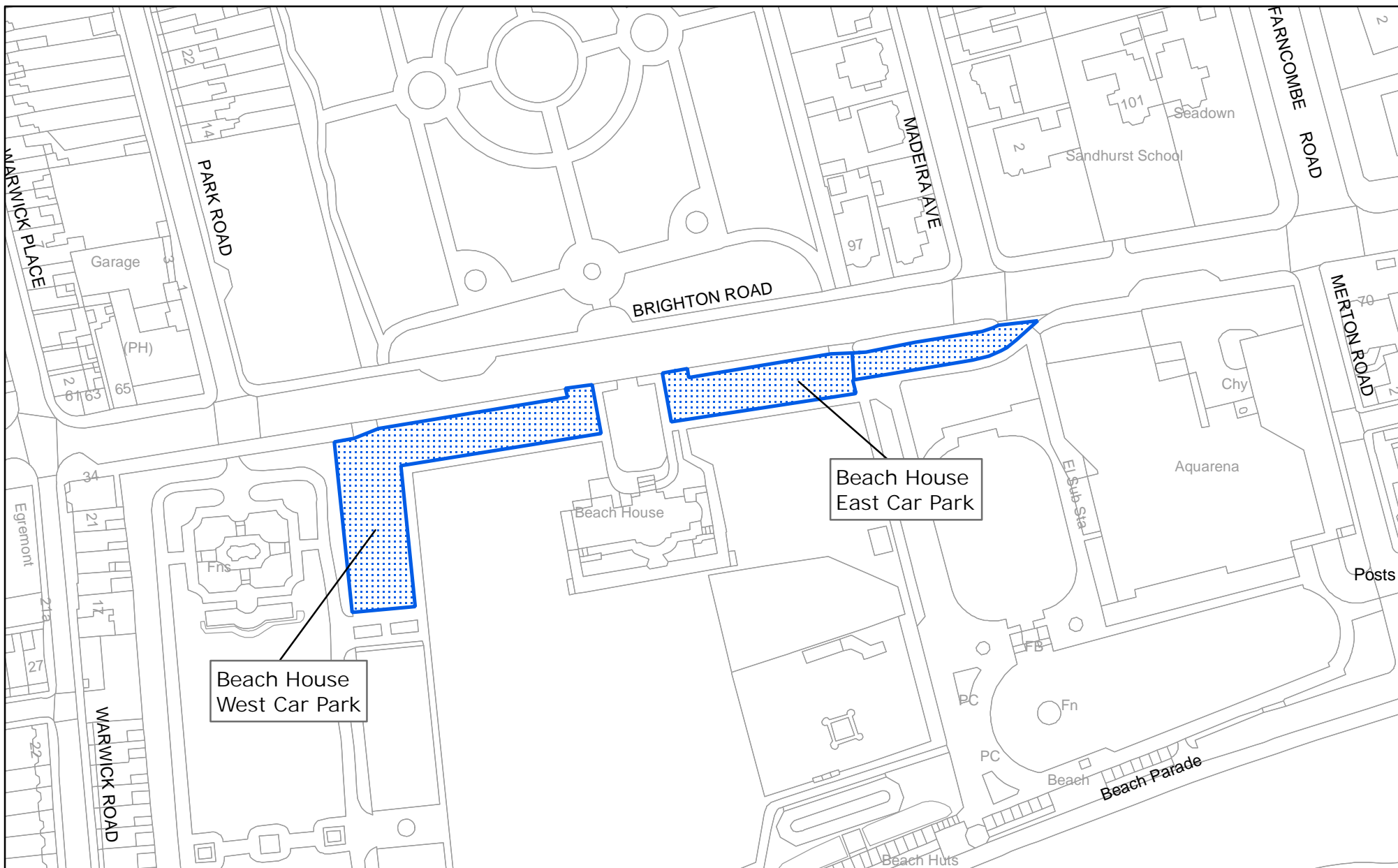

Reproduced from or based upon 2006 Ordnance Survey mapping  
with permission of the Controller of HMSO (c) Crown Copyright reserved.  
Unauthorised reproduction infringes Crown copyright and may lead to  
prosecution or civil proceedings West Sussex County Council Licence No. 100018485

## WORTHING OFF STREET PARKING PLACES

### BEACH HOUSE CAR PARKS

SCALE: 1:1,250



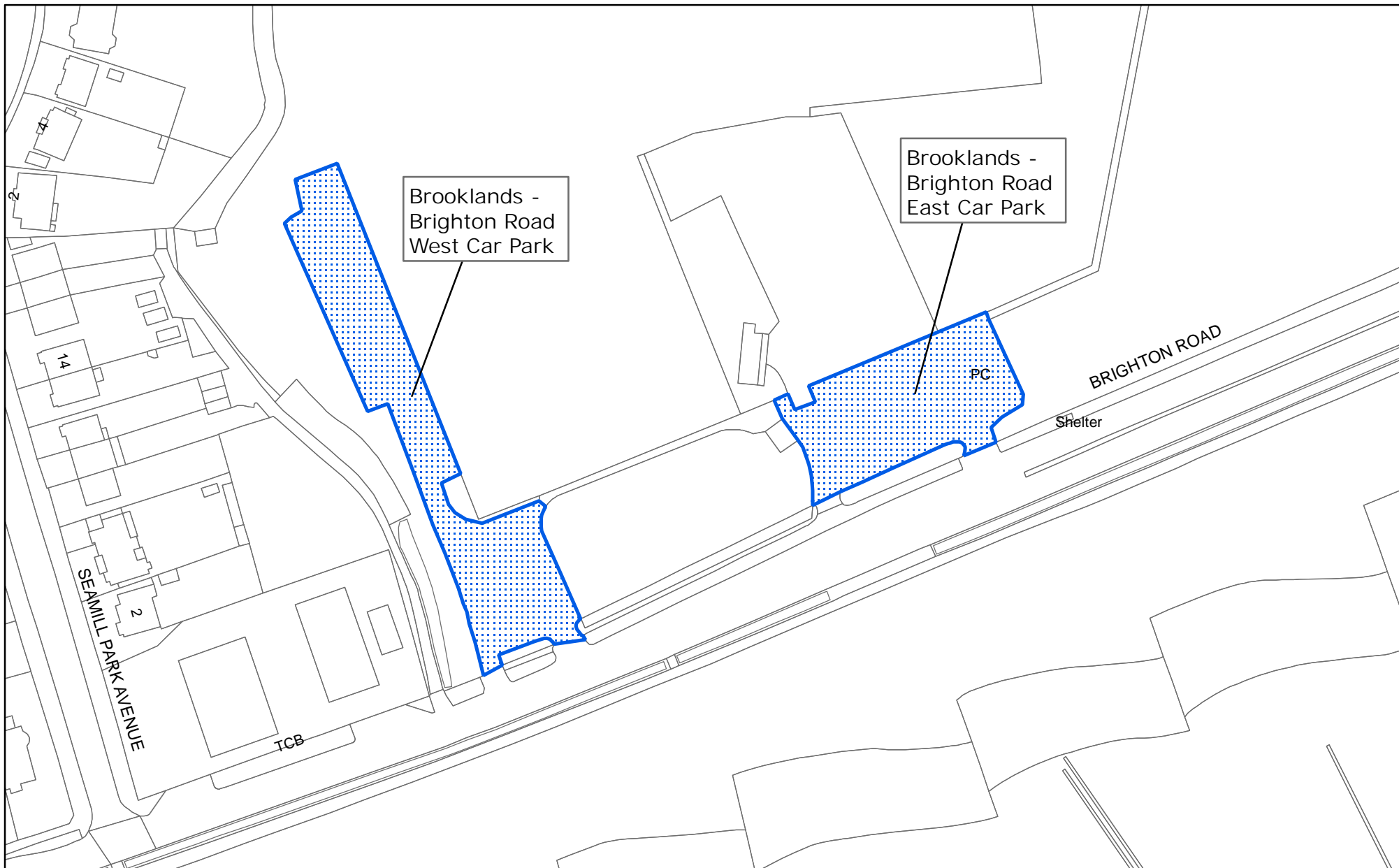

Reproduced from or based upon 2006 Ordnance Survey mapping with permission of the Controller of HMSO (c) Crown Copyright reserved. Unauthorised reproduction infringes Crown copyright and may lead to prosecution or civil proceedings West Sussex County Council Licence No. 100018485

## WORTHING OFF STREET PARKING PLACES

### BROOKLANDS - BRIGHTON ROAD CAR PARKS

SCALE: 1:1,250







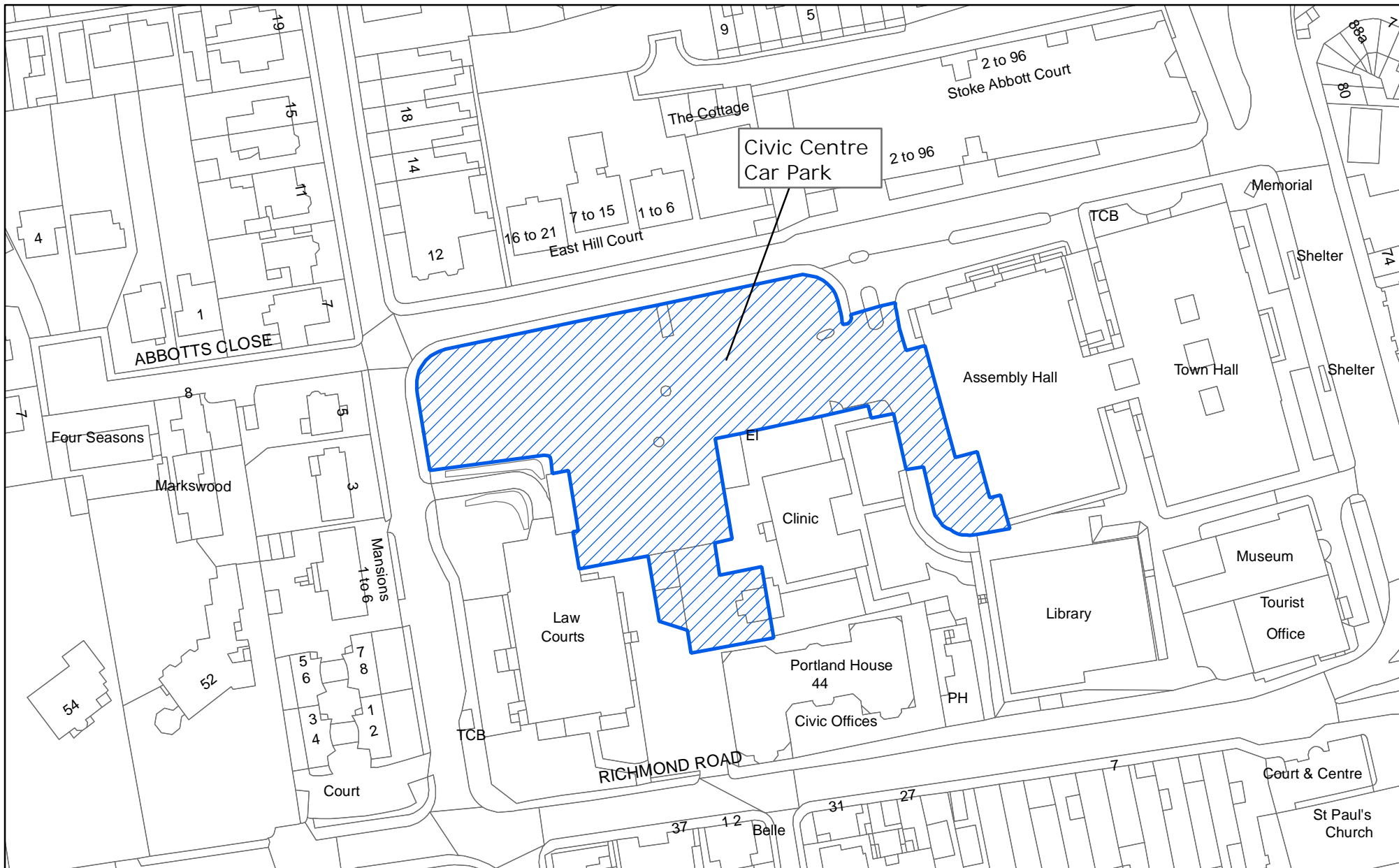

Reproduced from or based upon 2006 Ordnance Survey mapping with permission of the Controller of HMSO (c) Crown Copyright reserved. Unauthorised reproduction infringes Crown copyright and may lead to prosecution or civil proceedings West Sussex County Council Licence No. 100018485

## WORTHING OFF STREET PARKING PLACES

CIVIC CENTRE CAR PARK

SCALE: 1:1,250



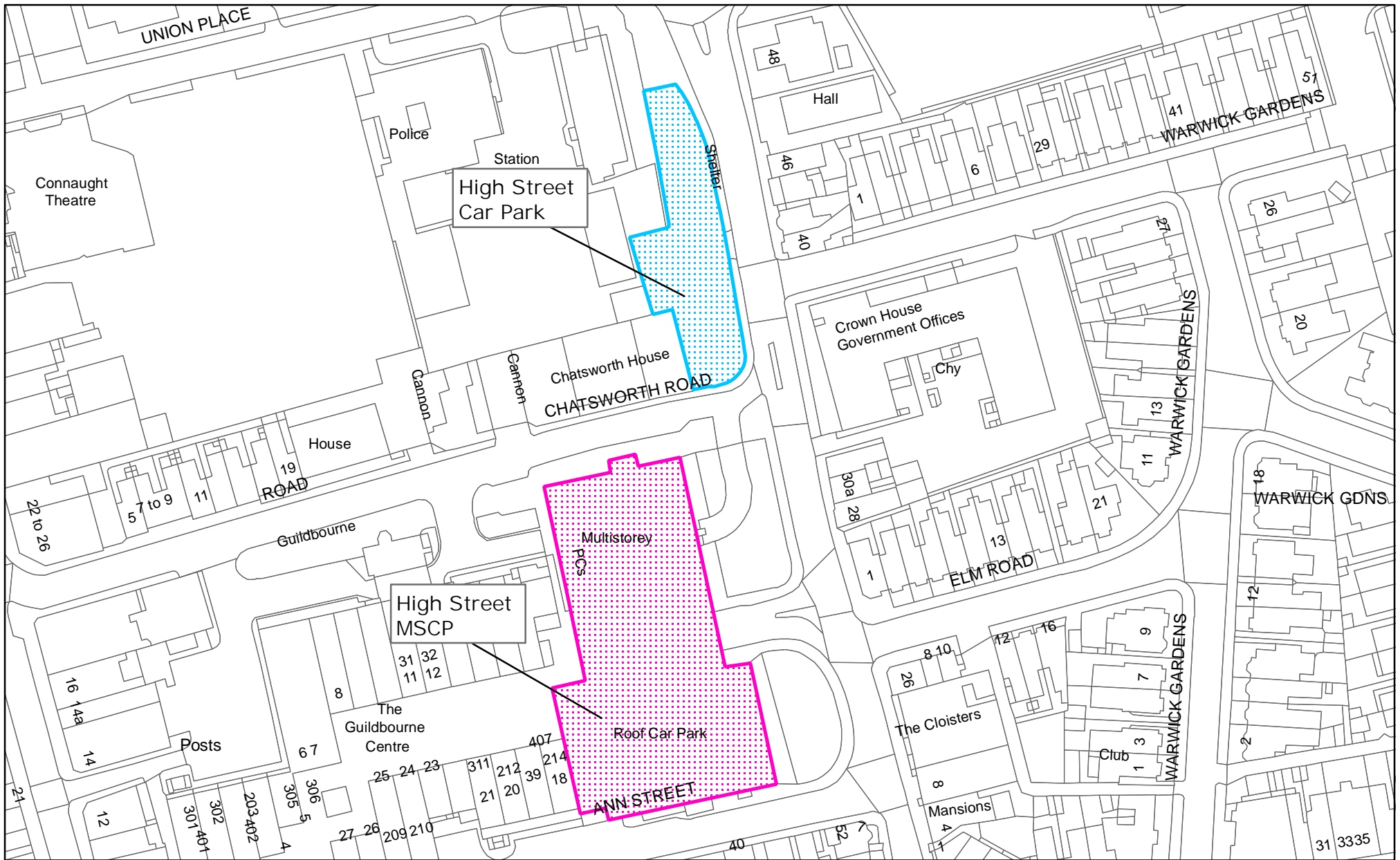

Reproduced from or based upon 2006 Ordnance Survey mapping with permission of the Controller of HMSO (c) Crown Copyright reserved. Unauthorised reproduction infringes Crown copyright and may lead to prosecution or civil proceedings West Sussex County Council Licence No. 100018485

## WORTHING OFF STREET PARKING PLACES

### HIGH STREET CAR PARKS

SCALE: 1:1,250



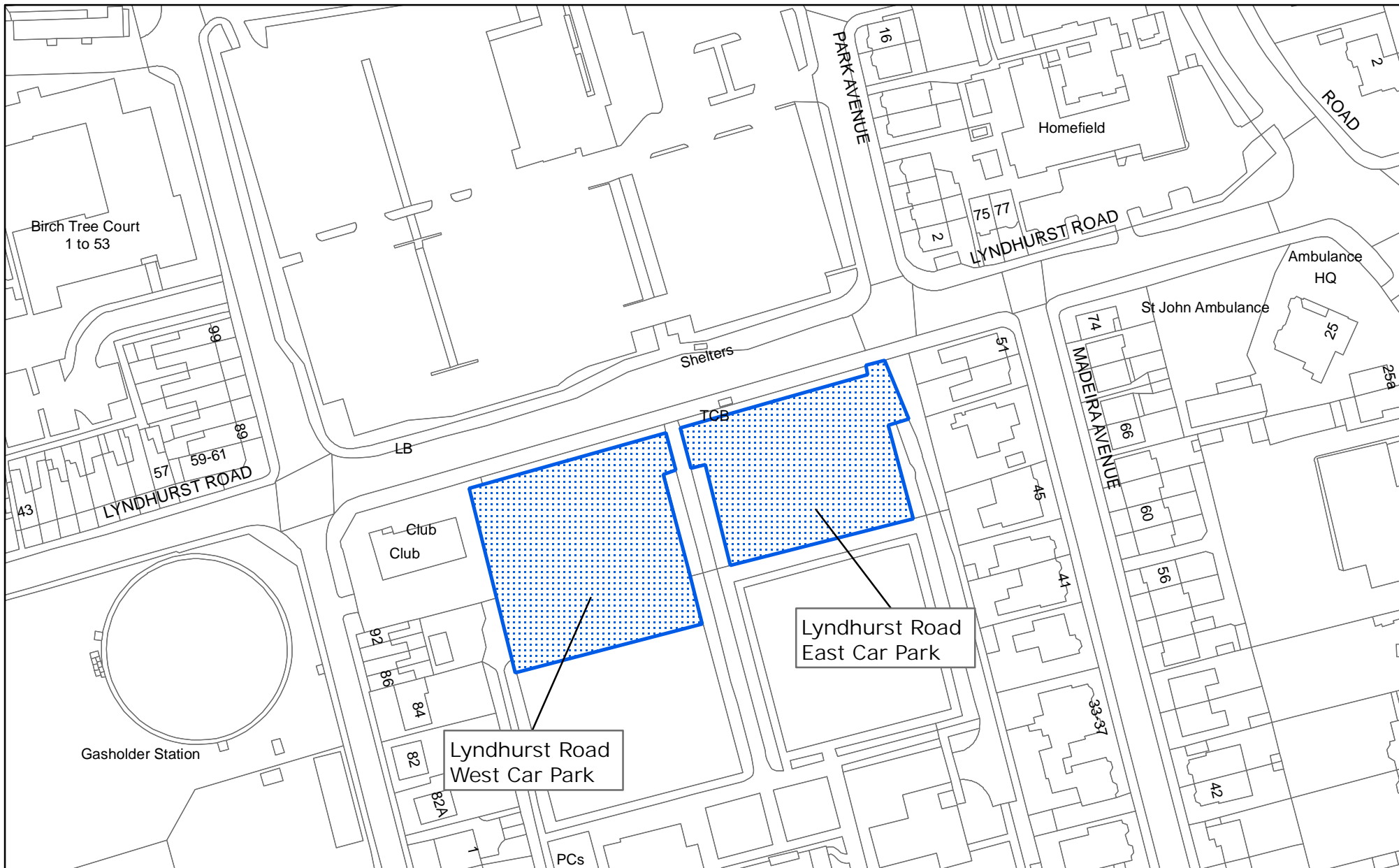

Reproduced from or based upon 2006 Ordnance Survey mapping with permission of the Controller of HMSO (c) Crown Copyright reserved. Unauthorised reproduction infringes Crown copyright and may lead to prosecution or civil proceedings West Sussex County Council Licence No. 100018485

## WORTHING OFF STREET PARKING PLACES

### LYNDHURST ROAD CAR PARKS

SCALE: 1:1,250



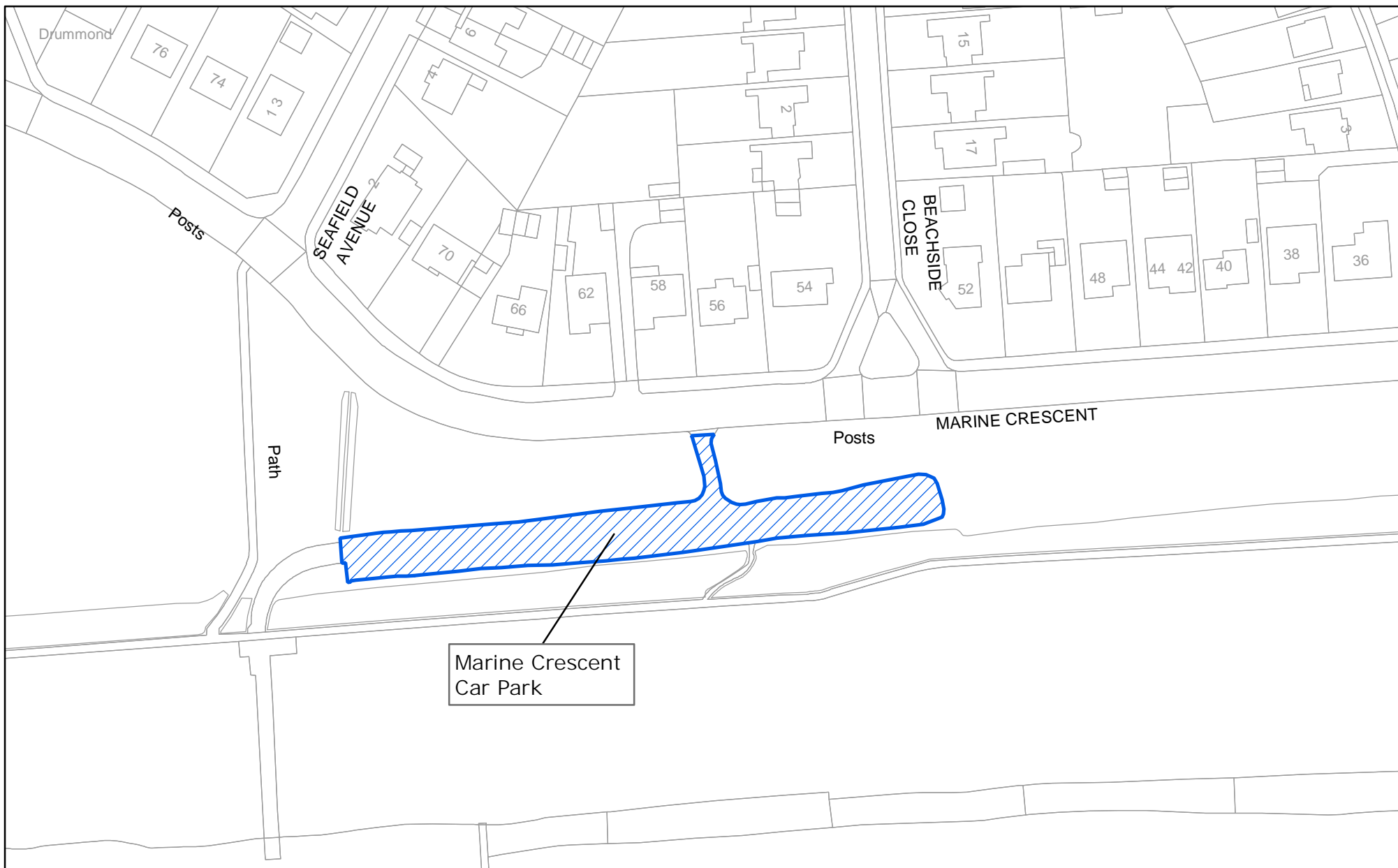

Reproduced from or based upon 2006 Ordnance Survey mapping with permission of the Controller of HMSO (c) Crown Copyright reserved. Unauthorised reproduction infringes Crown copyright and may lead to prosecution or civil proceedings West Sussex County Council Licence No. 100018485

WORTHING OFF STREET PARKING PLACES

MARINE CRESCENT CAR PARK

SCALE: 1:1,250





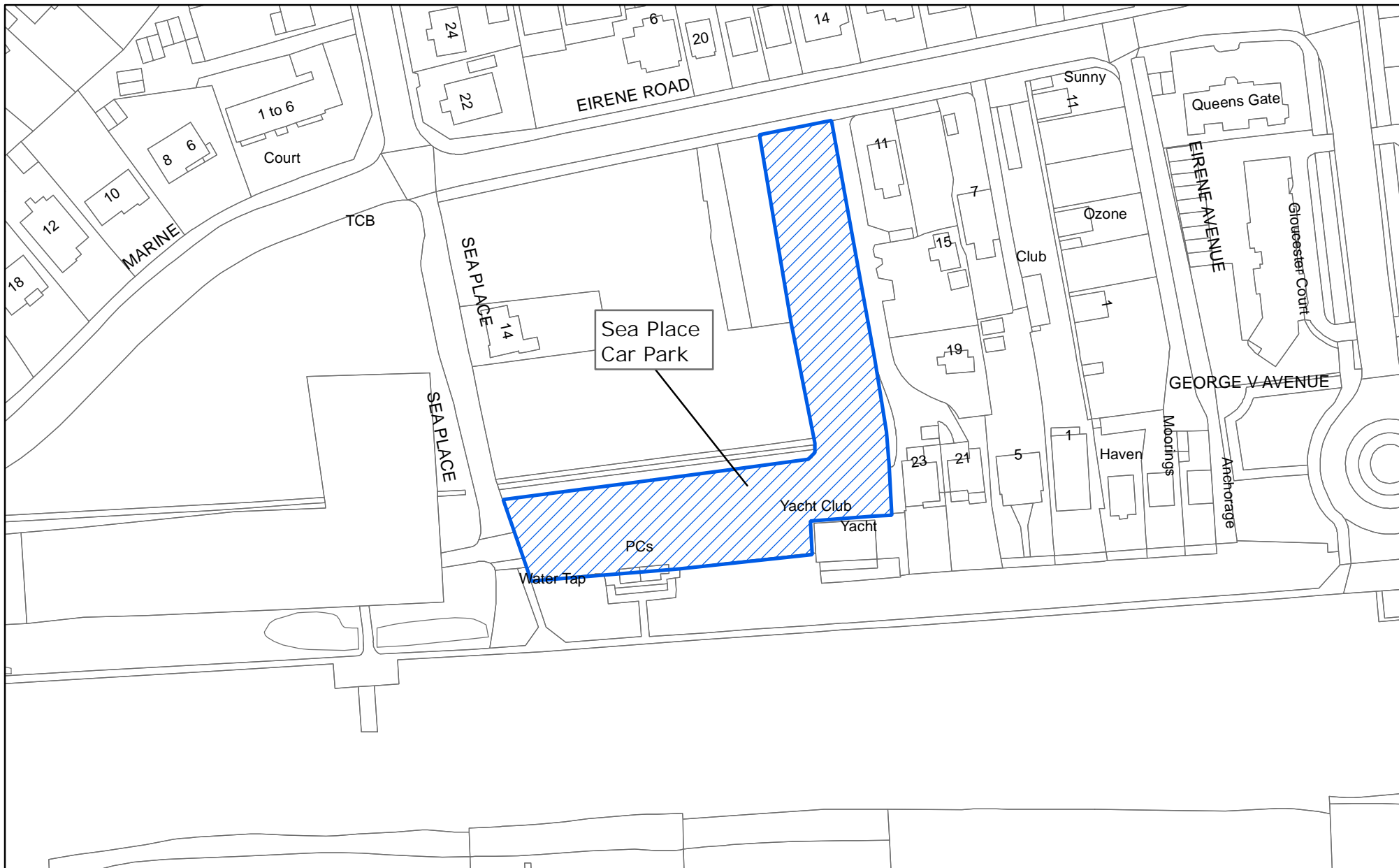

Reproduced from or based upon 2006 Ordnance Survey mapping with permission of the Controller of HMSO (c) Crown Copyright reserved. Unauthorised reproduction infringes Crown copyright and may lead to prosecution or civil proceedings West Sussex County Council Licence No. 100018485

## WORTHING OFF STREET PARKING PLACES

### SEA PLACE CAR PARK

SCALE: 1:1,250



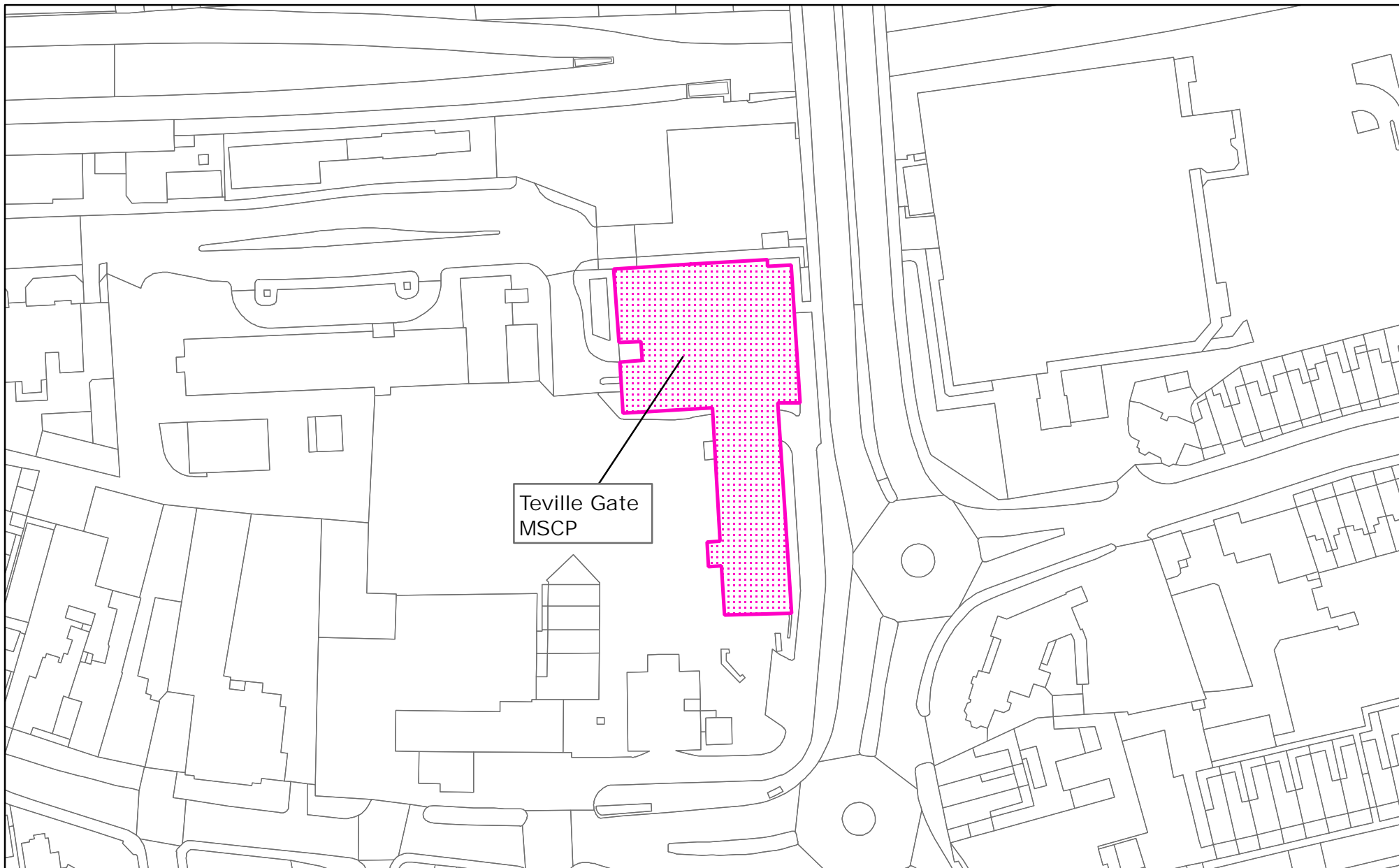

Reproduced from or based upon 2006 Ordnance Survey mapping with permission of the Controller of HMSO (c) Crown Copyright reserved. Unauthorised reproduction infringes Crown copyright and may lead to prosecution or civil proceedings West Sussex County Council Licence No. 100018485

## WORTHING OFF STREET PARKING PLACES

TEVILLE GATE MULTI-STOREY CAR PARK

SCALE: 1:1,250

