

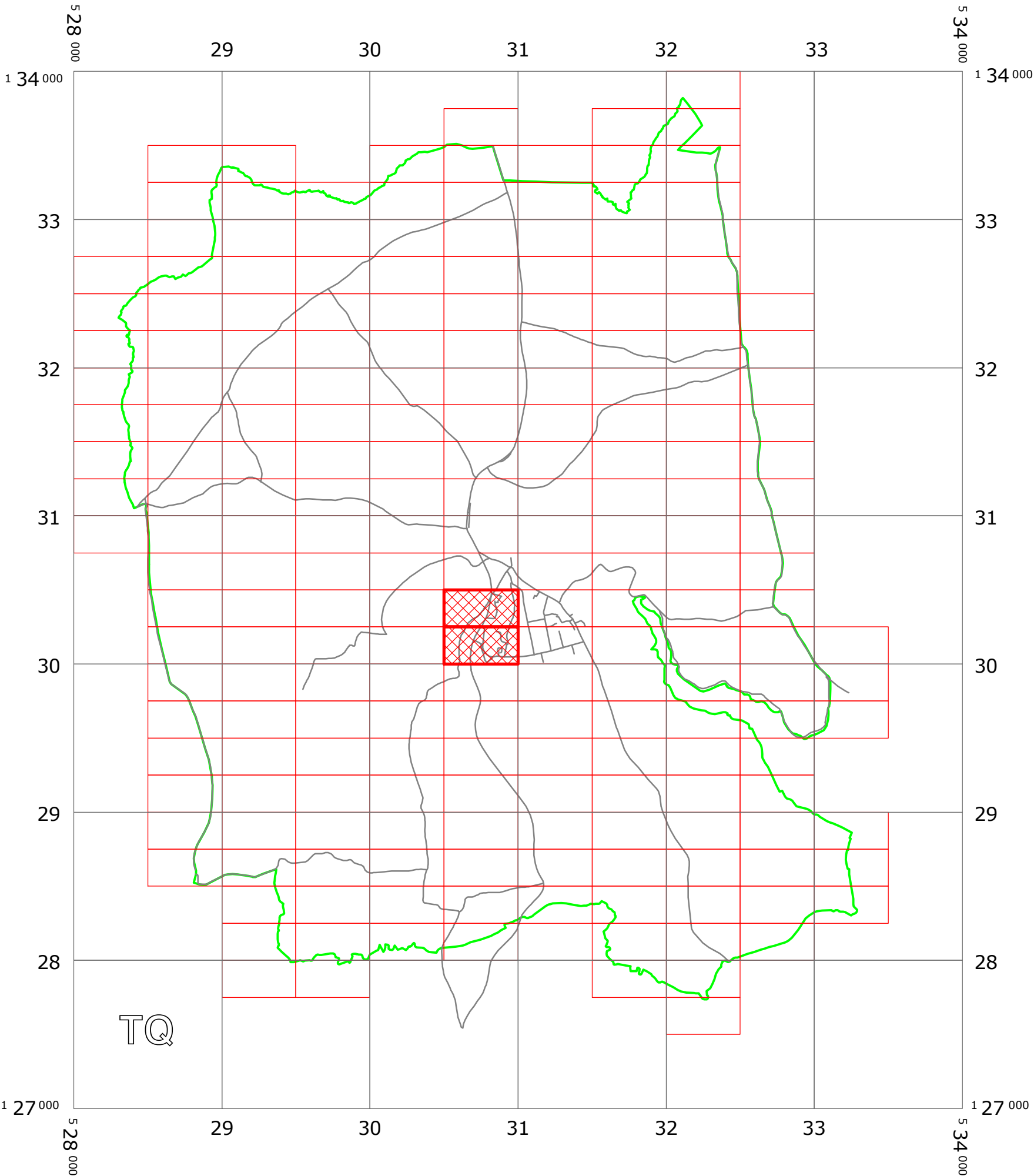

WEST SUSSEX COUNTY COUNCIL ((MID SUSSEX DISTRICT)  
(PARKING PLACES AND TRAFFIC REGULATION)  
(CONSOLIDATION No.2) ORDER 2006)  
(BALCOMBE: LONDON ROAD AND NEWLANDS AMENDMENT)  
ORDER 2015

BALCOMBE: LOCATION OF WAITING RESTRICTIONS



KEY:



OS TILE GRID



PARKING TILE GRID



LOCATION OF WAITING RESTRICTIONS



PARISH BOUNDARY



ROAD NETWORK



West Sussex County Council  
Communities & Infrastructure  
The Grange  
Tower Street  
Chichester  
West Sussex  
PO19 1RH

WEST SUSSEX COUNTY COUNCIL ((MID SUSSEX DISTRICT)  
(PARKING PLACES AND TRAFFIC REGULATION)  
(CONSOLIDATION No.2) ORDER 2006)  
(BALCOMBE: LONDON ROAD AND NEWLANDS AMENDMENT) ORDER 2015

LOCATION OF WAITING RESTRICTIONS

Reproduced from or based upon 2013 Ordnance Survey material with permission of the Controller of HMSO  
(c) Crown Copyright reserved. Unauthorised reproduction infringes Crown copyright and may lead to  
prosecution or civil proceedings West Sussex County Council Licence No. 100023447



SCALE: 1:30,000  
DATE: 15/06/2015

Key for Waiting Restrictions

All areas over which the provision of the orders apply are defined by the shaded areas as shown on the following plans plus a contiguous area not indicated on the plans of verge and/or footway between the carriageway edge and the highway boundary. The plans in this schedule are based upon grid references of the Ordnance Survey National Grid defined by the OSGB 36 triangulation.

Prohibition of waiting at any time

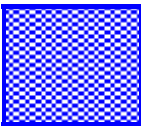
101		check	No waiting at any time
123		check	No waiting 11.00am-Midday Mon-Fri

**WEST SUSSEX COUNTY COUNCIL**  
**((MID SUSSEX DISTRICT) (PARKING PLACES & TRAFFIC REGULATION)**  
**(CONSOLIDATION NO.2) ORDER 2006)**

**(BALCOMBE: LONDON ROAD AND NEWLANDS AMENDMENT) ORDER 2015**

West Sussex County Council in exercise of their powers under Sections 1 (1) 2 (1) and (2), 4 (2), 45, 46, 49 and 53 and Part IV of Schedule 9 of the Road Traffic Regulation Act 1984 ("the Act") as amended and of all other enabling powers and after consultation with the Chief Officer of Police in accordance with Part III of Schedule 9 to the Act hereby make the following Order:-

1. This Order shall come into operation on the Fifteenth day of June 2015 and may be cited as "West Sussex County Council ((Mid Sussex District) (Parking Places & Traffic Regulation) (Consolidation No.2) Order 2006) (Balcombe: London Road and Newlands Amendment) Order 2015".
2. The "West Sussex County Council (Mid Sussex District) (Parking Places & Traffic Regulation) (Consolidation No.2) Order 2006" is hereby amended by the insertion of the plans specified in the Schedule to this Order, attached hereto.

**SCHEDULE**  
**Plans to be Inserted**

TQ3030SEN (Issue Number 1)  
TQ3030SES (Issue Number 1)

THE Common Seal of THE  
WEST SUSSEX COUNTY COUNCIL  
was hereto affixed the  
ELEVANTH  
day of JUNE 2015

Authorised Signatory  
CMS1401-MM



04/08 DELEGATED AUTHORITY

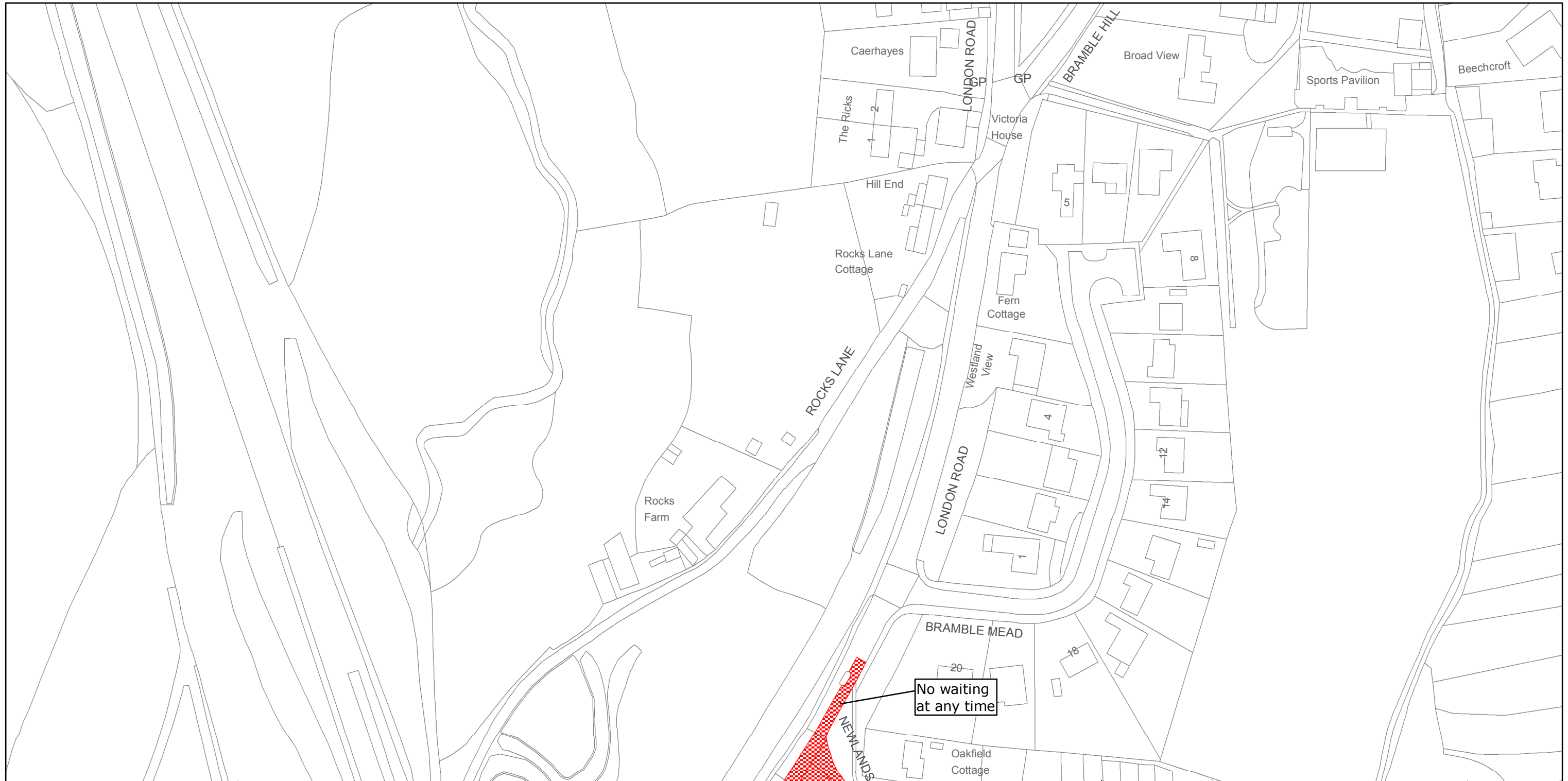

West Sussex County Council  
Highways & Transport  
The Grange  
Tower Street  
Chichester  
West Sussex  
PO19 1RH

MID SUSSEX DISTRICT: BALCOMBE  
WAITING RESTRICTIONS

Reproduced from or based upon 2013 Ordnance Survey material with permission of the Controller of HMSO (c) Crown Copyright reserved.  
Unauthorised reproduction infringes Crown copyright and may lead to prosecution or civil proceedings West Sussex County Council Licence No. 100023447

TILE REF NO:  
TQ3030SEN

SHEET ISSUE NO 1  
SHEET ACTIVE FROM - 15/06/2015



SCALE:  
1:1250

at A3 size



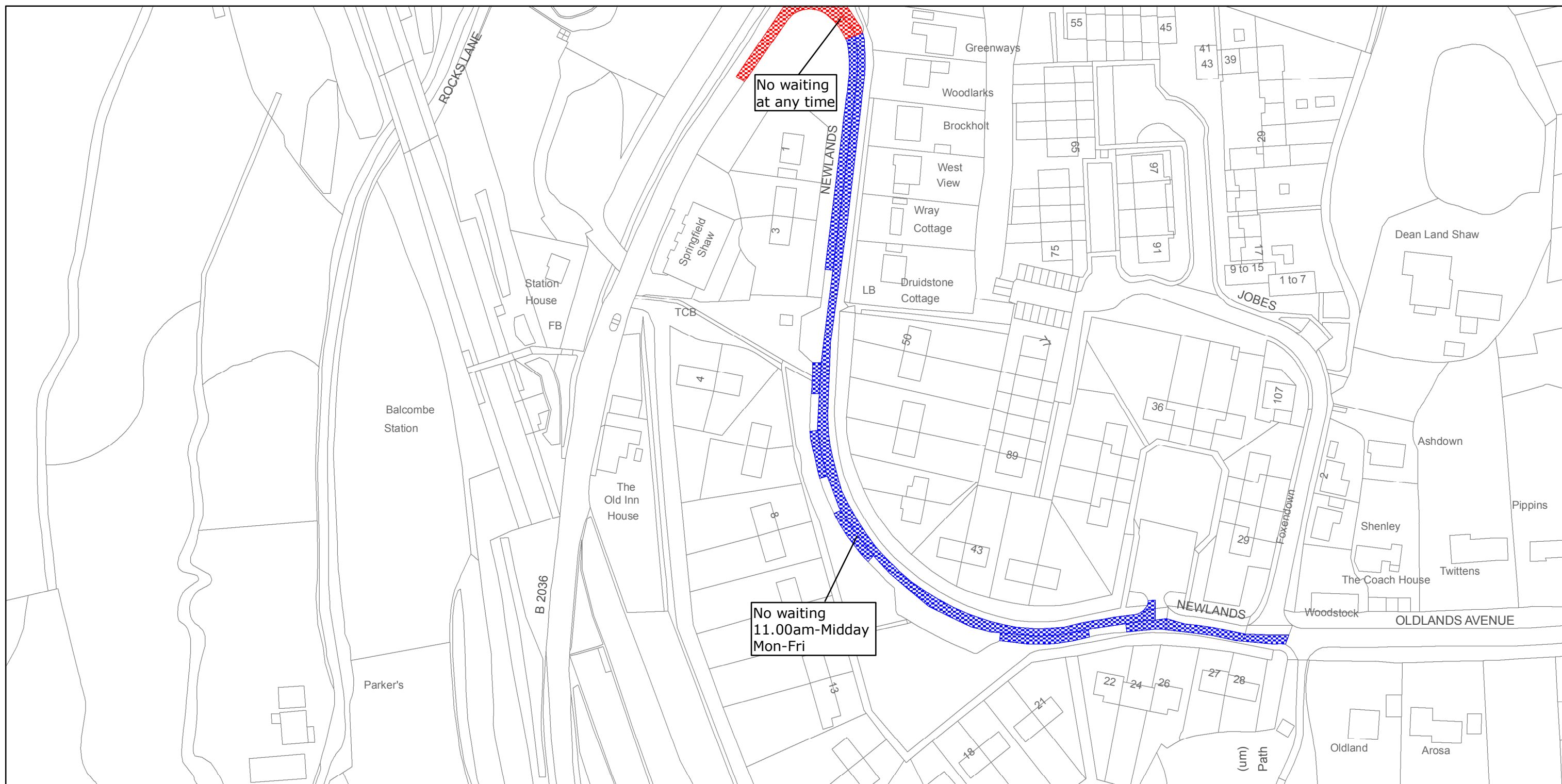

West Sussex County Council  
Highways & Transport  
The Grange  
Tower Street  
Chichester  
West Sussex  
PO19 1RH

MID SUSSEX DISTRICT: BALCOMBE  
WAITING RESTRICTIONS

Reproduced from or based upon 2013 Ordnance Survey material with permission of the Controller of HMSO (c) Crown Copyright reserved.  
Unauthorised reproduction infringes Crown copyright and may lead to prosecution or civil proceedings West Sussex County Council Licence No. 100023447

TILE REF NO:  
TQ3030SES

SHEET ISSUE NO 1  
SHEET ACTIVE FROM - 15/06/2015



SCALE:  
1:1250  
at A3 size