

WEST SUSSEX COUNTY COUNCIL ((MID SUSSEX DISTRICT)  
(PARKING PLACES AND TRAFFIC REGULATION)  
(CONSOLIDATION No.2) ORDER 2006)  
(HAYWARDS HEATH: LINCOLN WOOD AND ADJOINING ROADS AMENDMENT)  
ORDER 2015

HAYWARDS HEATH: LOCATION OF WAITING RESTRICTIONS

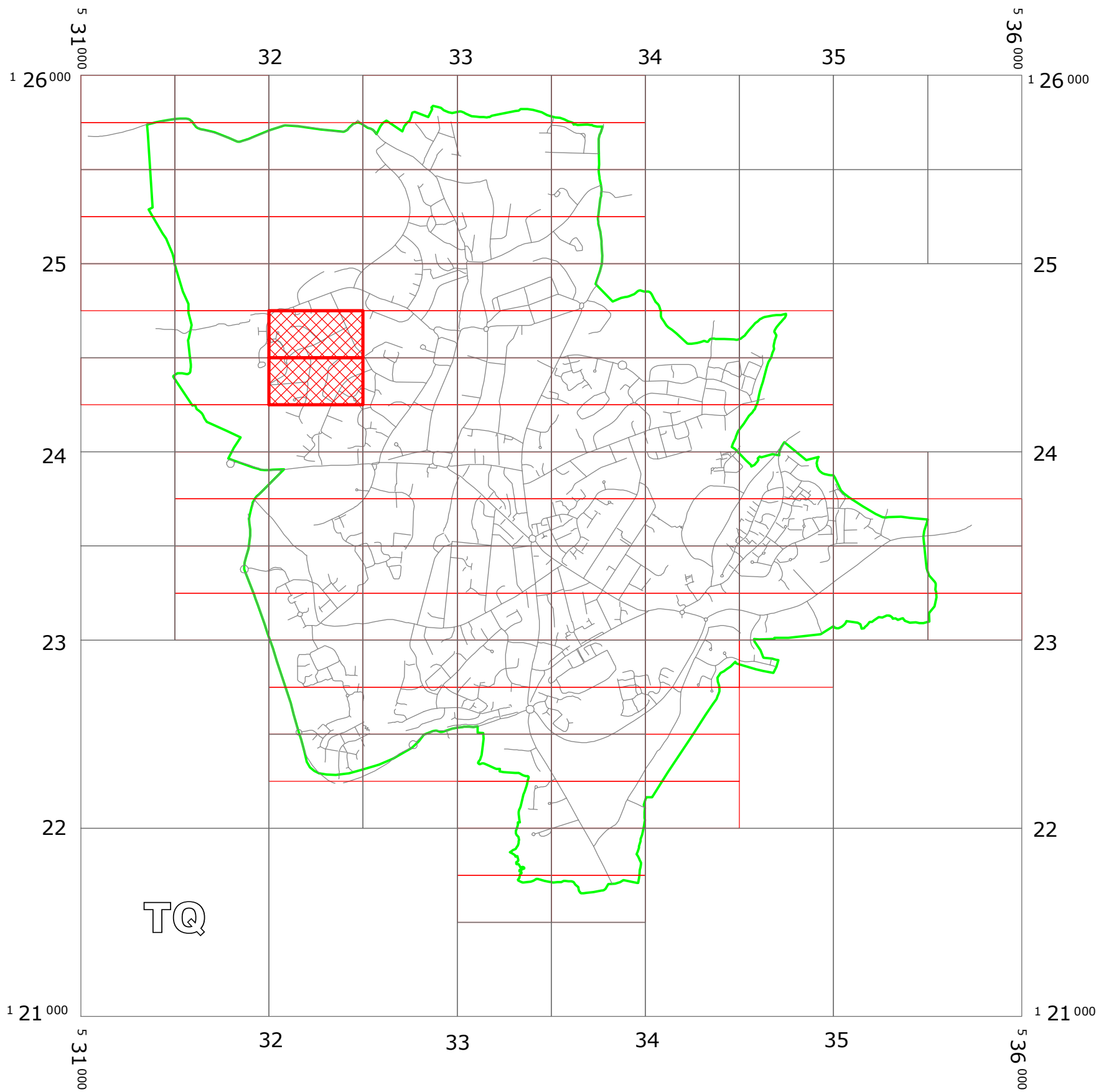

**KEY:**

- OS TILE GRID
- PARKING TILE GRID
- LOCATION OF WAITING RESTRICTIONS
- PARISH BOUNDARY
- ROAD NETWORK



West Sussex County Council  
Communities & Infrastructure  
The Grange  
Tower Street  
Chichester  
West Sussex  
PO19 1RH

WEST SUSSEX COUNTY COUNCIL ((MID SUSSEX DISTRICT)  
(PARKING PLACES AND TRAFFIC REGULATION)  
(CONSOLIDATION No.2) ORDER 2006)  
(HAYWARDS HEATH: LINCOLN WOOD AND ADJOINING ROADS  
AMENDMENT) ORDER 2015  
LOCATION OF WAITING RESTRICTIONS



Reproduced from or based upon 2013 Ordnance Survey material with permission of the Controller of HMSO  
(c) Crown Copyright reserved. Unauthorised reproduction infringes Crown copyright and may lead to  
prosecution or civil proceedings West Sussex County Council Licence No. 100023447

SCALE: 1:25,000  
DATE: 18/05/2015

Key for Waiting Restrictions

All areas over which the provision of the orders apply are defined by the shaded areas as shown on the following plans plus a contiguous area not indicated on the plans of verge and/or footway between the carriageway edge and the highway boundary. The plans in this schedule are based upon grid references of the Ordnance Survey National Grid defined by the OSGB 36 triangulation.

Prohibition of waiting at any time

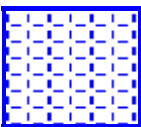
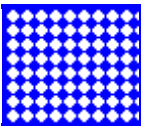
101		check	No waiting at any time
107		pat020	No waiting 8.00am-6.00pm Mon–Sat
126		z_circle	No waiting 9.00am-10.00am, 1.00pm-2.00pm Mon-Fri

**WEST SUSSEX COUNTY COUNCIL**  
**((MID SUSSEX DISTRICT) (PARKING PLACES & TRAFFIC REGULATION)**  
**(CONSOLIDATION NO.2) ORDER 2006)**

**(HAYWARDS HEATH: LINCOLN WOOD AND ADJOINING ROADS**  
**AMENDMENT) ORDER 2015**

West Sussex County Council in exercise of their powers under Sections 1 (1) 2 (1) and (2), 4 (2), 45, 46, 49 and 53 and Part IV of Schedule 9 of the Road Traffic Regulation Act 1984 ("the Act") as amended and of all other enabling powers and after consultation with the Chief Officer of Police in accordance with Part III of Schedule 9 to the Act hereby make the following Order:-

1. This Order shall come into operation on the Eighteenth day of May 2015 and may be cited as "West Sussex County Council ((Mid Sussex District) (Parking Places & Traffic Regulation) (Consolidation No.2) Order 2006) (Haywards Heath: Lincoln Wood and Adjoining Roads Amendment) Order 2015".
2. The "West Sussex County Council (Mid Sussex District) (Parking Places & Traffic Regulation) (Consolidation No.2) Order 2006" is hereby amended by the replacement of the plans specified in the First Schedule to this Order, with the plans specified in the Second Schedule, attached hereto.

**FIRST SCHEDULE**  
**Plans to be Replaced**

TQ3224NWS (Issue Number 4)  
TQ3224SWN (Issue Number 5) *11/1*

**SECOND SCHEDULE**  
**Replacement Plans**

TQ3224NWS (Issue Number 5)  
TQ3224SWN (Issue Number 6) *11/1*

THE Common Seal of THE  
WEST SUSSEX COUNTY COUNCIL  
was hereto affixed the  
*FOURTEENTH*  
day of *MAY* 2015

*M. Henshaw*  
Authorised Signatory  
CMS1402-MM



*04/08 DELEGATED AUTHORITY*

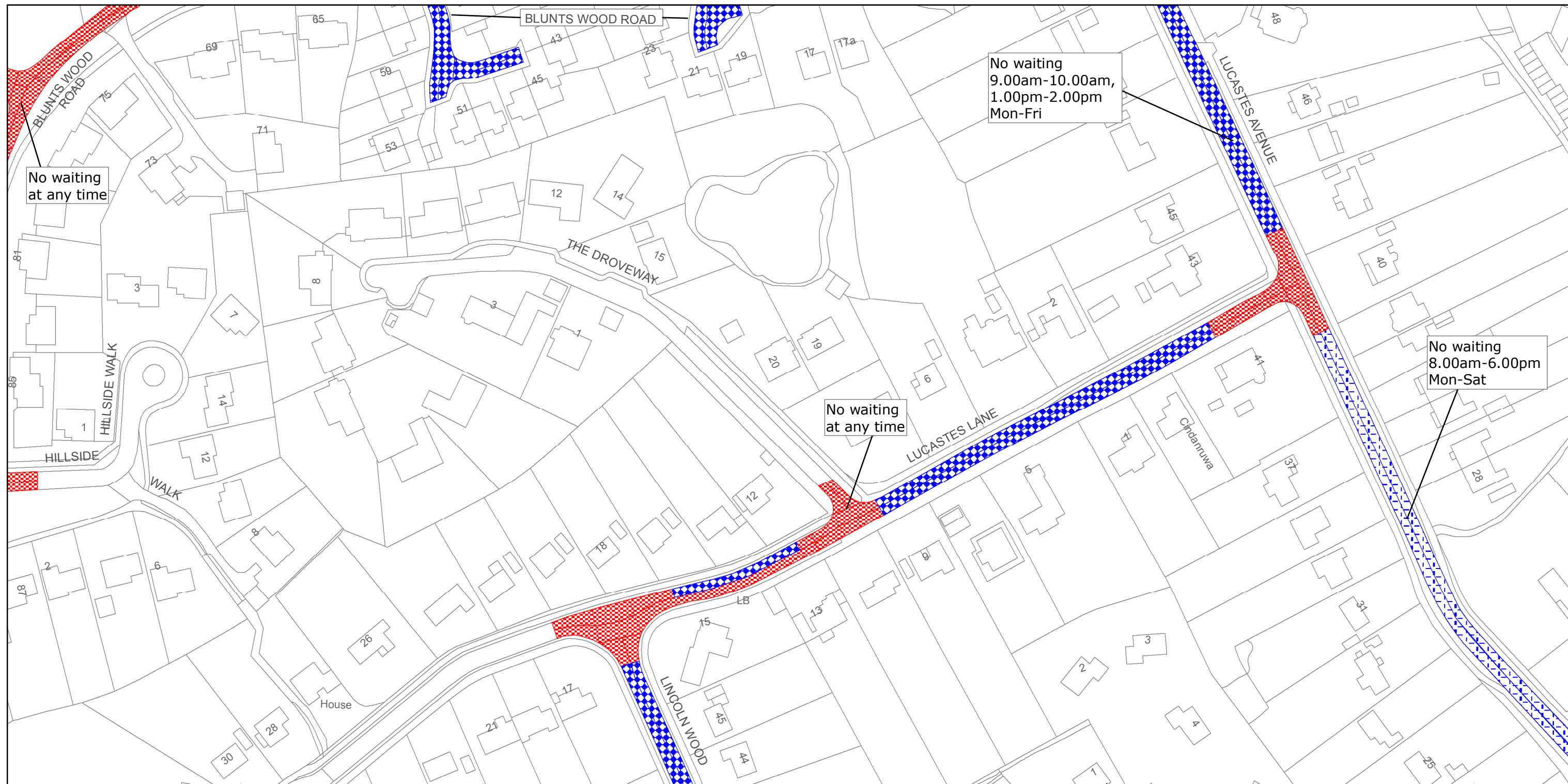

West Sussex County Council  
Highways & Transport  
The Grange  
Tower Street  
Chichester  
West Sussex  
PO19 1RH

MID SUSSEX DISTRICT: HAYWARDS HEATH  
WAITING RESTRICTIONS

Reproduced from or based upon 2013 Ordnance Survey material with permission of the Controller of HMSO (c) Crown Copyright reserved.  
Unauthorised reproduction infringes Crown copyright and may lead to prosecution or civil proceedings West Sussex County Council Licence No. 100023447

TILE REF NO:  
TQ3224NWS

SHEET ISSUE NO 5  
SHEET ACTIVE FROM - 18/05/2015



SCALE:  
1:1250  
at A3 size



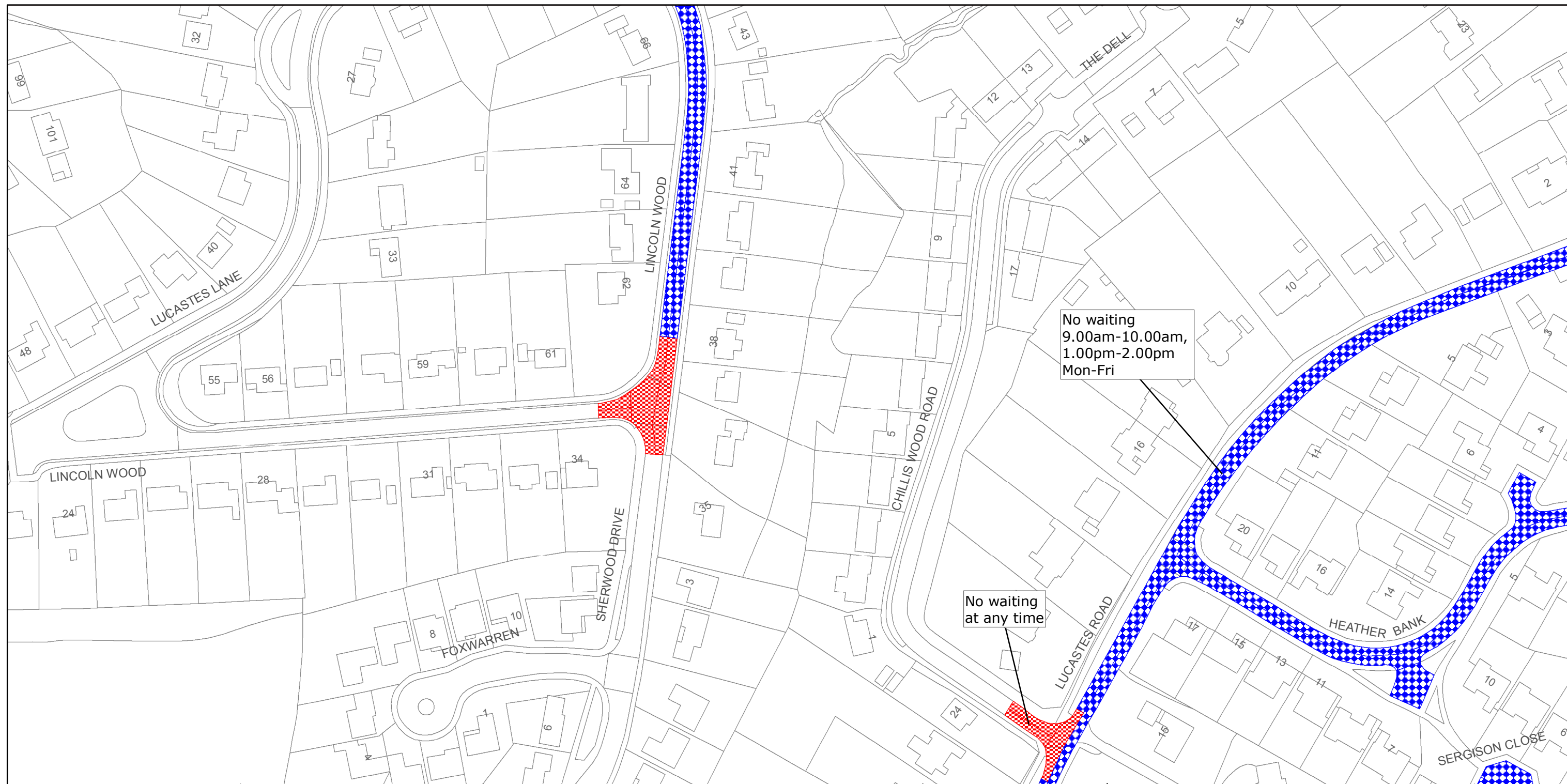

West Sussex County Council  
Highways & Transport  
The Grange  
Tower Street  
Chichester  
West Sussex  
PO19 1RH

MID SUSSEX DISTRICT: HAYWARDS HEATH  
WAITING RESTRICTIONS

Reproduced from or based upon 2013 Ordnance Survey material with permission of the Controller of HMSO (c) Crown Copyright reserved.  
Unauthorised reproduction infringes Crown copyright and may lead to prosecution or civil proceedings West Sussex County Council Licence No. 100023447

TILE REF NO:  
TQ3224SWN

SHEET ISSUE NO 6  
SHEET ACTIVE FROM - 18/05/2015



SCALE:  
1:1250  
at A3 size