

WEST SUSSEX COUNTY COUNCIL  
((MID SUSSEX DISTRICT) (PARKING PLACES AND TRAFFIC REGULATION)  
(CONSOLIDATION No. 2) ORDER 2006)  
(COPTHORNE: VARIOUS ROADS AMENDMENT) ORDER 2012

WORTH: LOCATION OF WAITING RESTRICTIONS

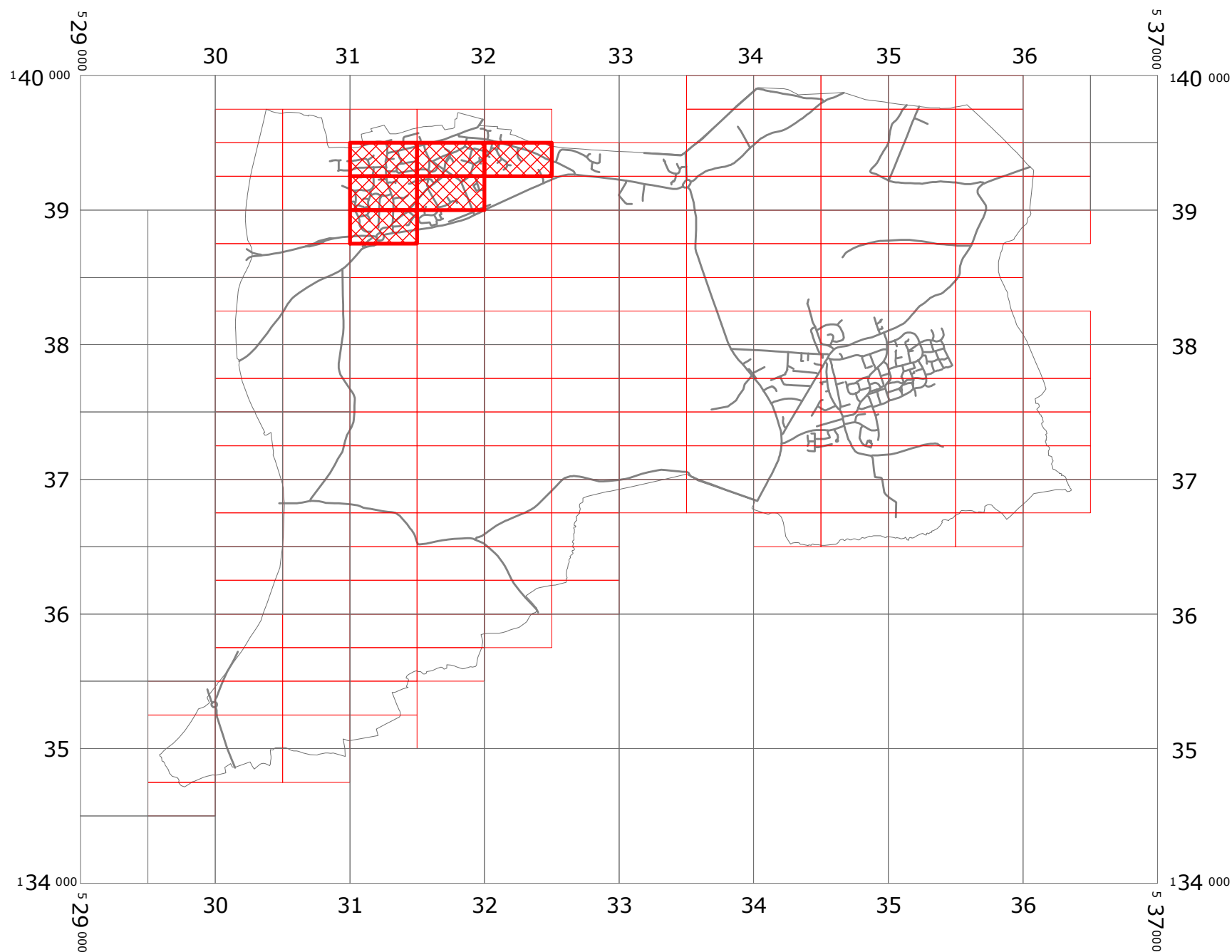

KEY:



LOCATION OF WAITING RESTRICTIONS



PARKING TILE GRID



OS TILE GRID



WORTH PARISH BOUNDARY



WORTH ROAD NETWORK



West Sussex County Council  
Infrastructure  
The Grange  
Tower Street  
Chichester  
West Sussex  
PO19 1RH

WEST SUSSEX COUNTY COUNCIL  
(MID SUSSEX DISTRICT)  
(PARKING PLACES AND TRAFFIC REGULATION)  
(CONSOLIDATION No.2) ORDER 2006)  
(COPTHORNE: VARIOUS ROADS AMENDMENT)  
ORDER 2012  
LOCATION OF WAITING RESTRICTIONS



Reproduced from or based upon 2010 Ordnance Survey mapping  
with permission of the Controller of HMSO (c) Crown Copyright reserved.  
Unauthorised reproduction infringes Crown copyright and may lead  
to prosecution or civil proceedings West Sussex County Council Licence No. 100023447

SCALE: 1:40,000  
DATE: 10/09/2012

**WEST SUSSEX COUNTY COUNCIL**  
**((MID SUSSEX DISTRICT) (PARKING PLACES & TRAFFIC REGULATION)**  
**(CONSOLIDATION NO.2) ORDER 2006)**

**(COPTHORNE: VARIOUS ROADS AMENDMENT) ORDER 2012**

West Sussex County Council in exercise of their powers under Sections 1 (1) 2 (1) and (2), 4 (2), 45, 46, 49 and 53 and Part IV of Schedule 9 of the Road Traffic Regulation Act 1984 ("the Act") as amended and of all other enabling powers and after consultation with the Chief Officer of Police in accordance with Part III of Schedule 9 to the Act hereby make the following Order:-

1. This Order shall come into operation on the Tenth day of September 2012 and may be cited as "West Sussex County Council ((Mid Sussex District) (Parking Places & Traffic Regulation) (Consolidation No.2) Order 2006) (Copthorne: Various Roads Amendment) Order 2012".
2. The "West Sussex County Council (Mid Sussex District) (Parking Places & Traffic Regulation) (Consolidation No.2) Order 2006" is hereby amended by the replacement of the plans specified in the First Schedule to this Order, with the plans specified in the Second Schedule, attached hereto.
3. The "West Sussex County Council (Mid Sussex District) (Parking Places & Traffic Regulation) (Consolidation No.2) Order 2006" is hereby amended by the insertion of the plans specified in the Third Schedule to this Order, attached hereto.

**FIRST SCHEDULE**  
**Plans to be Replaced**

TQ3138NWN (Issue Number 1)

**SECOND SCHEDULE**  
**Replacement Plans**

TQ3138NWN (Issue Number 2)

**THIRD SCHEDULE**  
**Plans to be Inserted**

TQ3139SWN (Issue Number 1)  
TQ3139SES (Issue Number 1)  
TQ3139SEN (Issue Number 1)  
TQ3139SWS (Issue Number 1)  
TQ3239SWN (Issue Number 1)

THE Common Seal of THE  
WEST SUSSEX COUNTY COUNCIL  
was hereto affixed the ~~SIXTH~~

day of SEPTEMBER 2012



Authorised Signatory  
NMS-015-MM



04/08 DELEGATED AUTHORITY

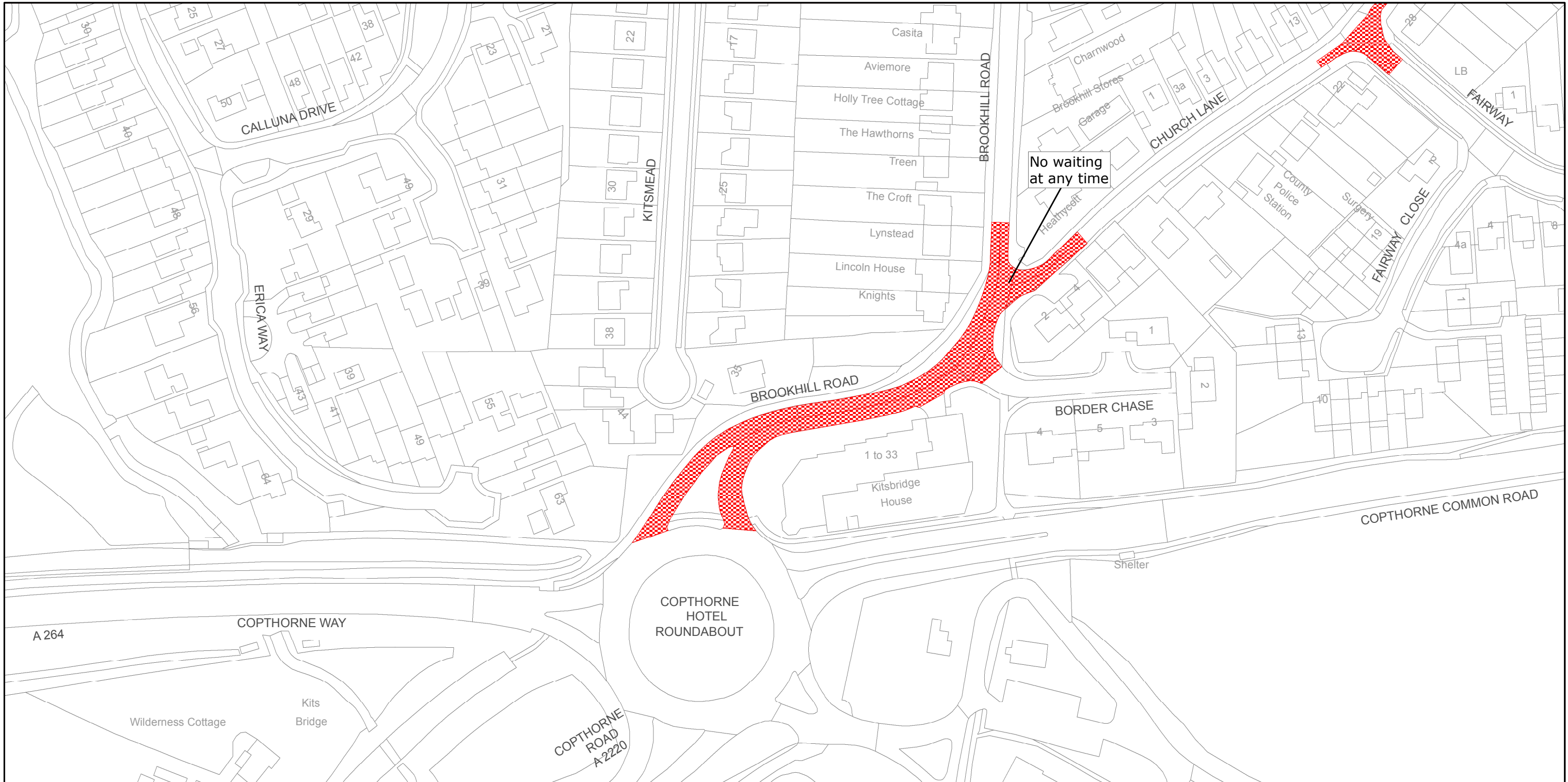

West Sussex County Council  
Communities & Infrastructure  
The Grange  
Tower Street  
Chichester  
West Sussex  
PO19 1RH

MID SUSSEX DISTRICT: WORTH  
WAITING RESTRICTIONS

Reproduced from or based upon 2010 Ordnance Survey mapping with permission of the Controller of HMSO (c) Crown Copyright reserved.  
Unauthorised reproduction infringes Crown copyright and may lead to prosecution or civil proceedings West Sussex County Council Licence No. 100023447

TILE REF NO:  
TQ3138NWN

SHEET ISSUE NO 2  
SHEET ACTIVE FROM 10/09/2012



SCALE:  
1:1250  
at A3 size



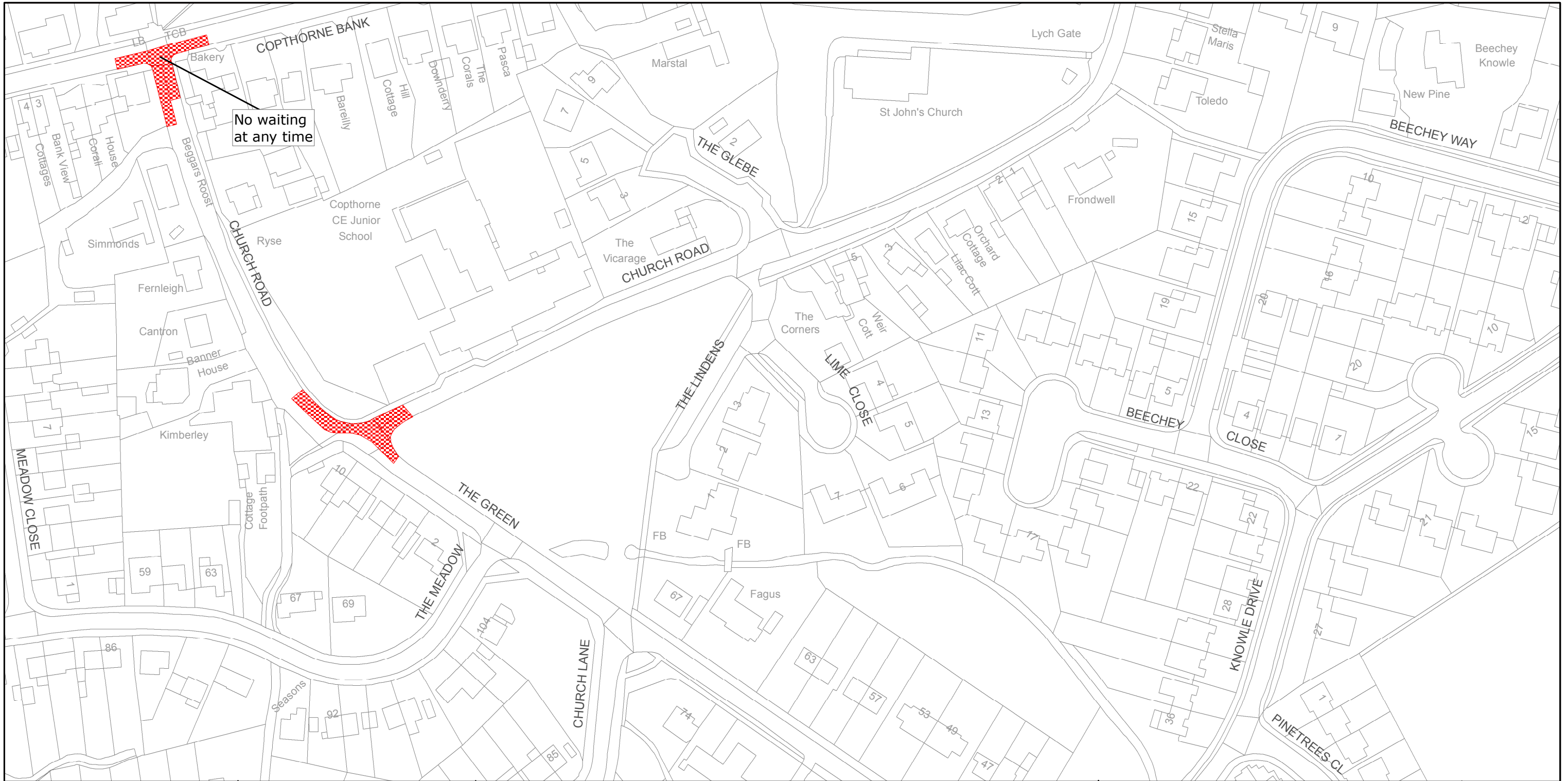

West Sussex County Council  
Communities & Infrastructure  
The Grange  
Tower Street  
Chichester  
West Sussex  
PO19 1RH

MID SUSSEX DISTRICT: WORTH  
WAITING RESTRICTIONS

Reproduced from or based upon 2010 Ordnance Survey mapping with permission of the Controller of HMSO (c) Crown Copyright reserved.  
Unauthorised reproduction infringes Crown copyright and may lead to prosecution or civil proceedings West Sussex County Council Licence No. 100023447

TILE REF NO:  
TQ3139SEN

SHEET ISSUE NO 1  
SHEET ACTIVE FROM 10/09/2012



SCALE:  
1:1250  
at A3 size



West Sussex County Council  
Communities & Infrastructure  
The Grange  
Tower Street  
Chichester  
West Sussex  
PO19 1RH

MID SUSSEX DISTRICT: WORTH  
WAITING RESTRICTIONS

Reproduced from or based upon 2010 Ordnance Survey mapping with permission of the Controller of HMSO (c) Crown Copyright reserved.  
Unauthorised reproduction infringes Crown copyright and may lead to prosecution or civil proceedings West Sussex County Council Licence No. 100023447

TILE REF NO:  
TQ3139SES

SHEET ISSUE NO 1  
SHEET ACTIVE FROM 10/09/2012



SCALE:  
1:1250  
at A3 size



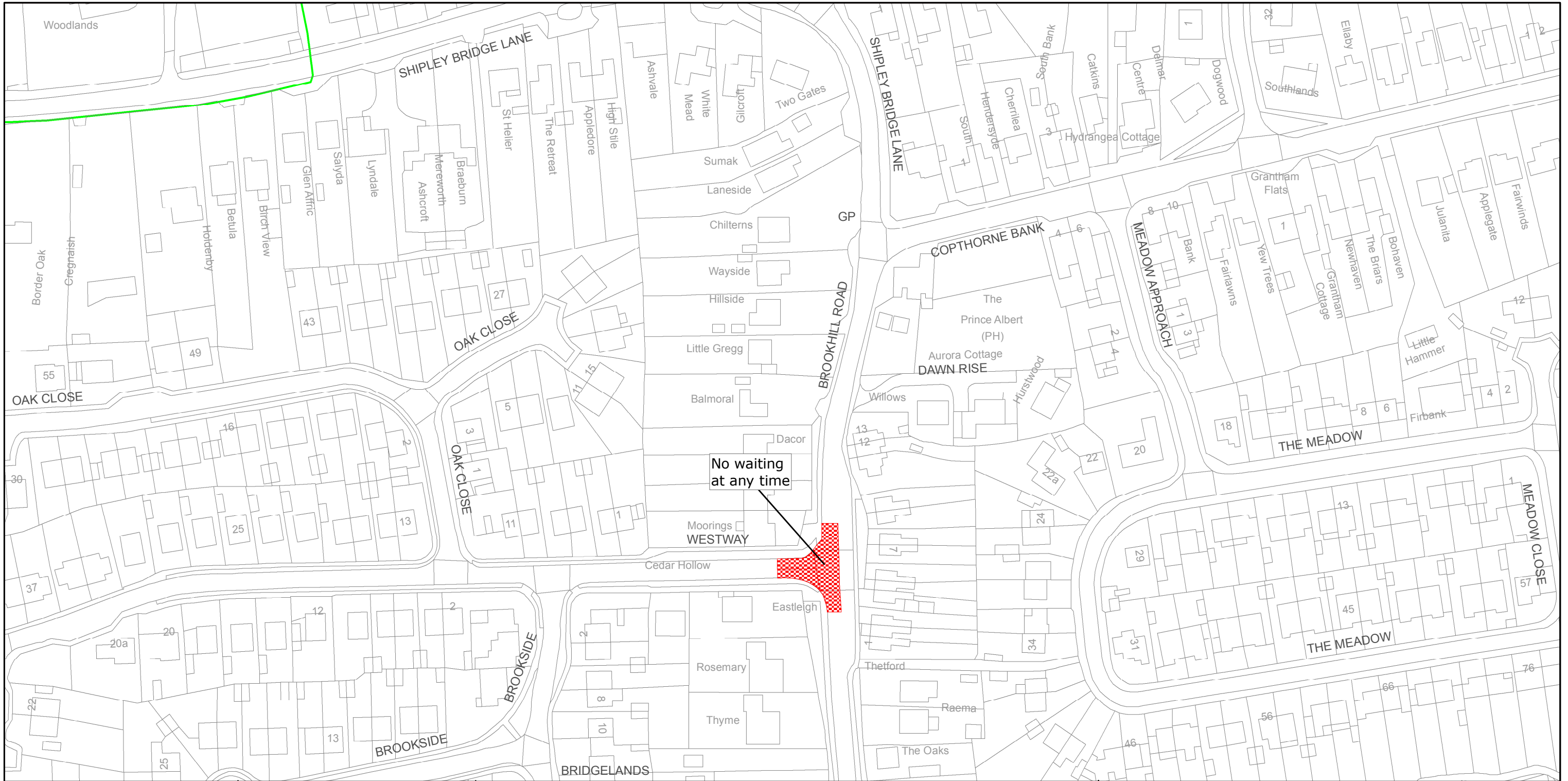

West Sussex County Council  
Communities & Infrastructure  
The Grange  
Tower Street  
Chichester  
West Sussex  
PO19 1RH

Reproduced from or based upon 2010 Ordnance Survey mapping with permission of the Controller of HMSO (c) Crown Copyright reserved.  
Unauthorised reproduction infringes Crown copyright and may lead to prosecution or civil proceedings West Sussex County Council Licence No. 100023447

MID SUSSEX DISTRICT: WORTH  
WAITING RESTRICTIONS

TILE REF NO:  
TQ3139SWN

SHEET ISSUE NO 1  
SHEET ACTIVE FROM 10/09/2012

N

SCALE:  
1:1250  
at A3 size



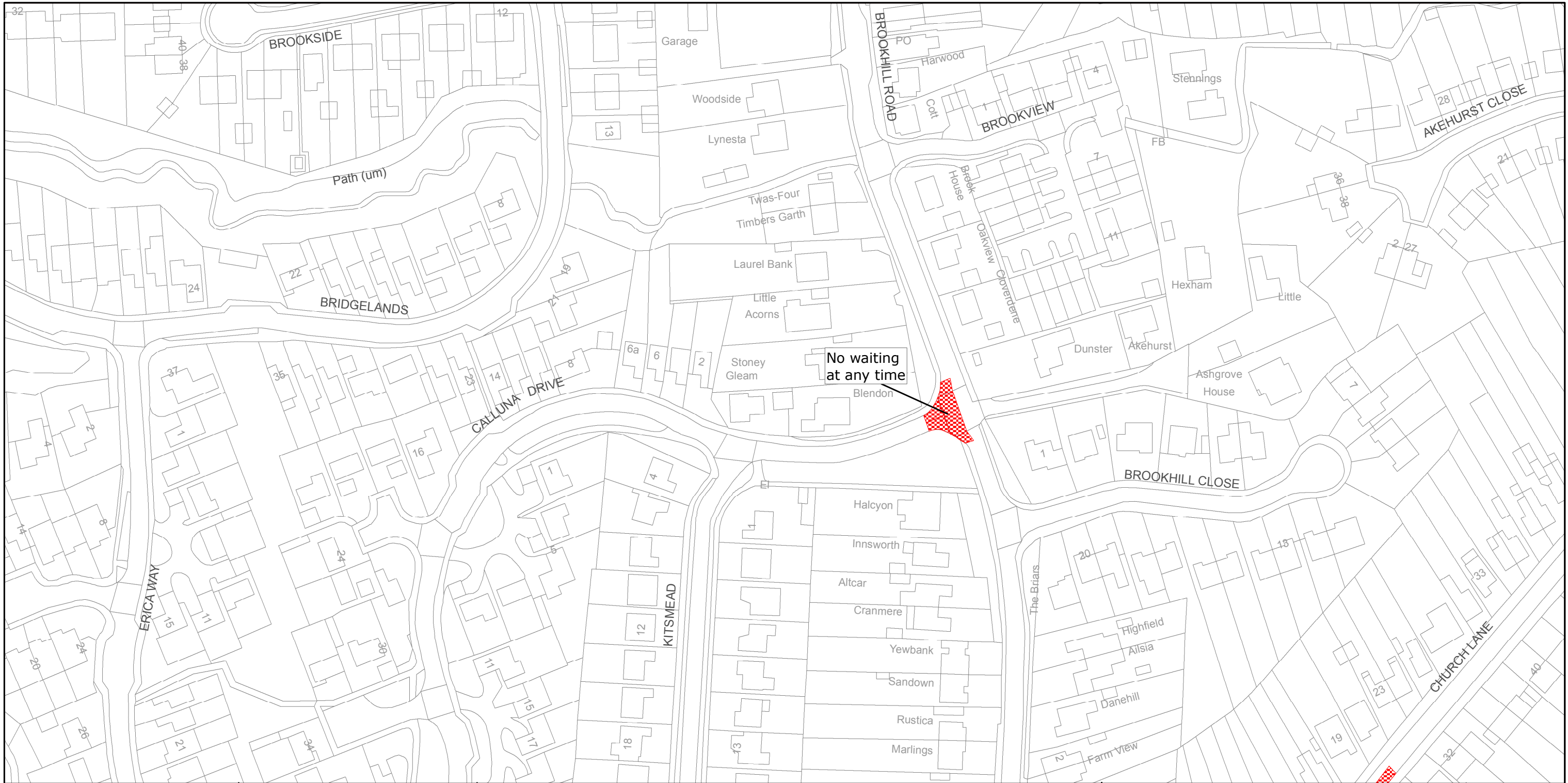

West Sussex County Council  
Communities & Infrastructure  
The Grange  
Tower Street  
Chichester  
West Sussex  
PO19 1RH

MID SUSSEX DISTRICT: WORTH  
WAITING RESTRICTIONS

Reproduced from or based upon 2010 Ordnance Survey mapping with permission of the Controller of HMSO (c) Crown Copyright reserved.  
Unauthorised reproduction infringes Crown copyright and may lead to prosecution or civil proceedings West Sussex County Council Licence No. 100023447

TILE REF NO:  
TQ3139SWS

SHEET ISSUE NO 1  
SHEET ACTIVE FROM 10/09/2012



SCALE:  
1:1250  
at A3 size



West Sussex County Council  
Communities & Infrastructure  
The Grange  
Tower Street  
Chichester  
West Sussex  
PO19 1RH

MID SUSSEX DISTRICT: WORTH  
WAITING RESTRICTIONS

Reproduced from or based upon 2010 Ordnance Survey mapping with permission of the Controller of HMSO (c) Crown Copyright reserved.  
Unauthorised reproduction infringes Crown copyright and may lead to prosecution or civil proceedings West Sussex County Council Licence No. 100023447

TILE REF NO:  
TQ3239SWN

SHEET ISSUE NO 1  
SHEET ACTIVE FROM 10/09/2012



SCALE:  
1:1250  
at A3 size