

WEST SUSSEX COUNTY COUNCIL ((MID SUSSEX DISTRICT)
(PARKING PLACES AND TRAFFIC REGULATION) (CONSOLIDATION No.2) ORDER 2006))
(AMENDMENT No.1) ORDER 2007.

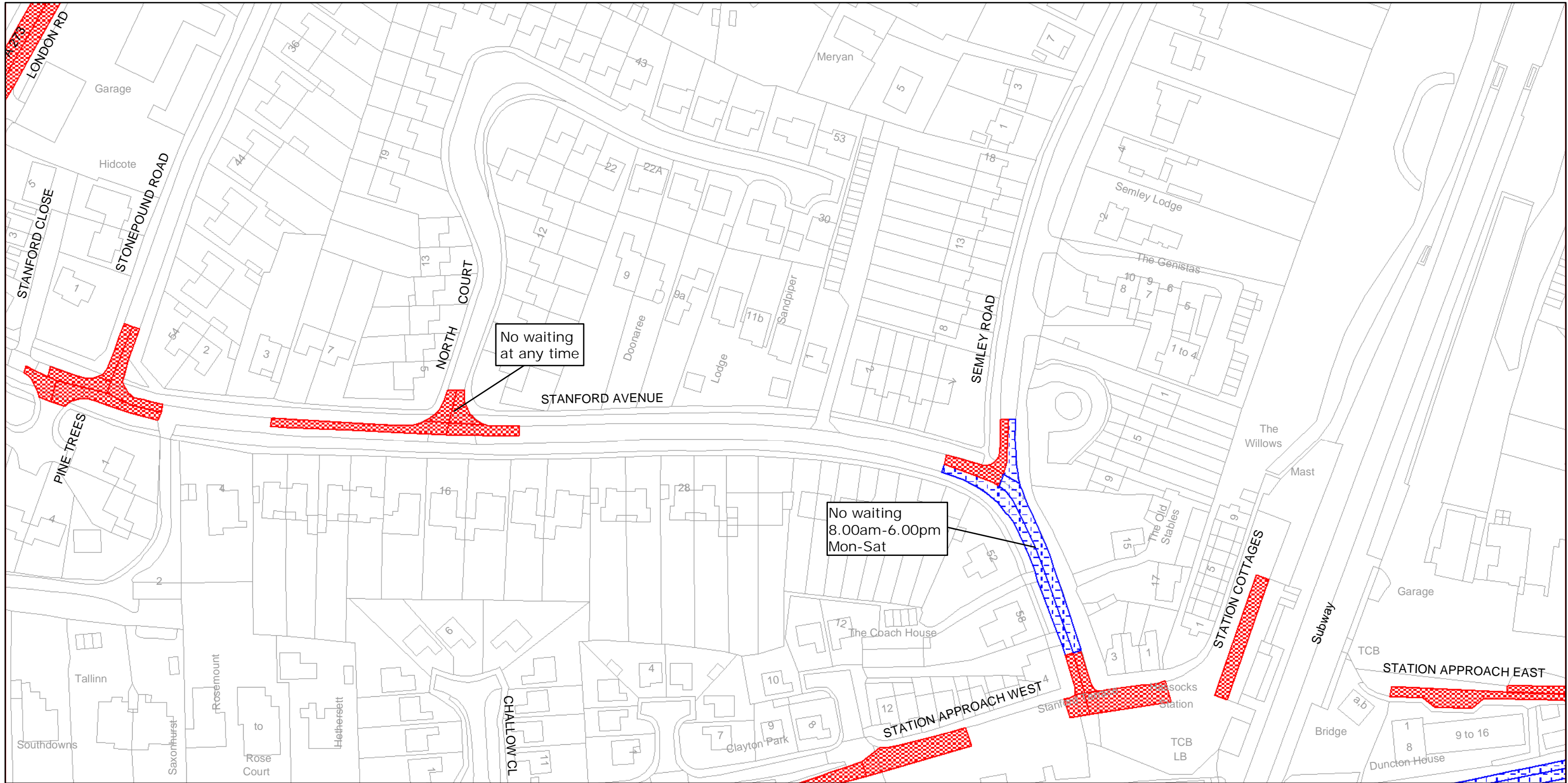

No waiting
at any time

No waiting
8.00am-6.00pm
Mon-Sat



West Sussex County Council
Highways & Transport
The Grange
Tower Street
Chichester
West Sussex
PO19 1RH

MID SUSSEX DISTRICT: HAS SOCKS
WAITING RESTRICTIONS

TILE REF NO:
TQ3015NWS

SHEET ISSUE NO 4
SHEET ACTIVE FROM - 30/04/2007



SCALE:
1:1250
at A3 size

Reproduced from or based upon 2006 Ordnance Survey mapping with permission of the Controller of HMSO (c) Crown Copyright reserved.
Unauthorised reproduction infringes Crown copyright and may lead to prosecution or civil proceedings West Sussex County Council Licence No. 100018485