

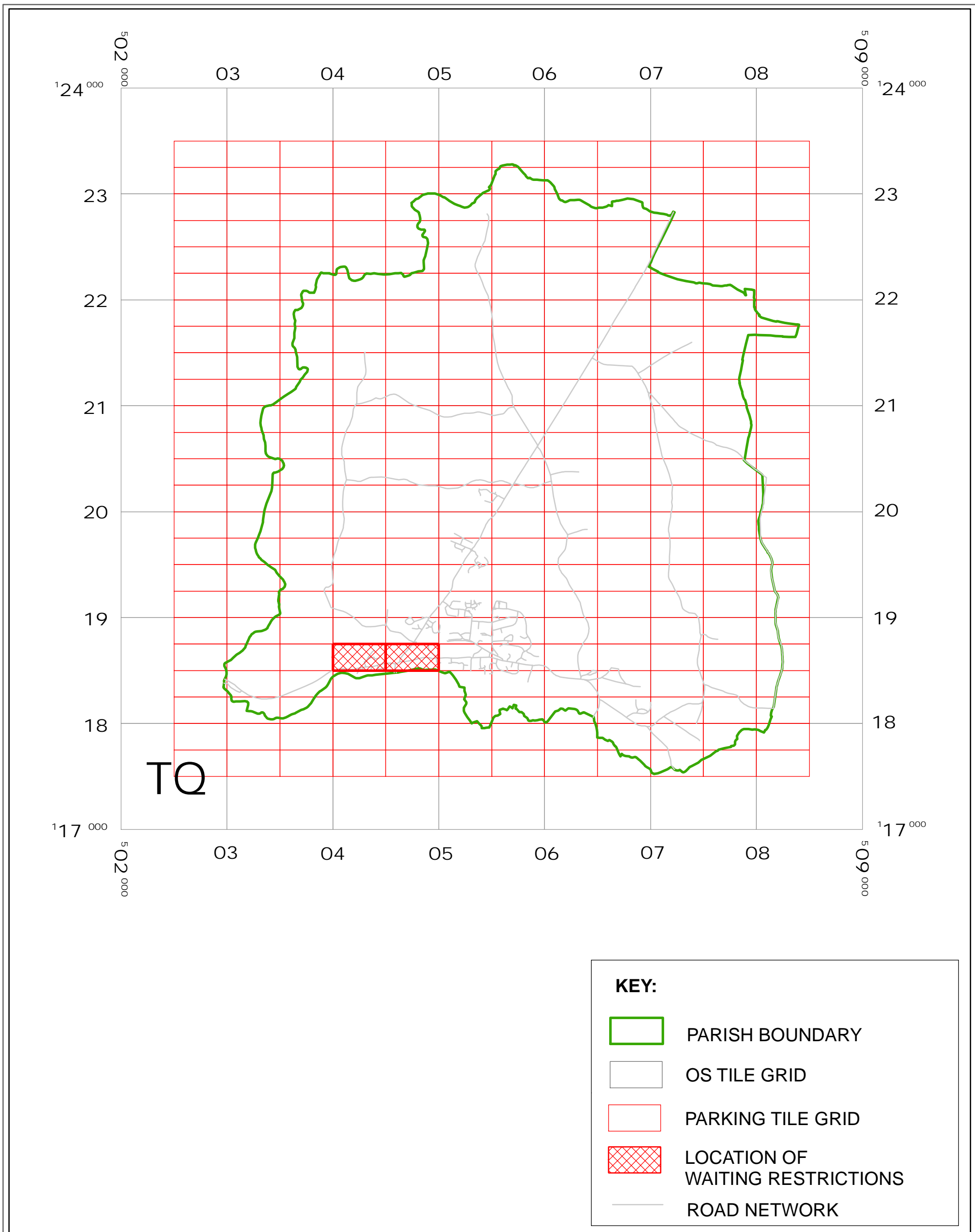





WEST SUSSEX COUNTY COUNCIL  
((HORSHAM DISTRICT) (PARKING PLACES AND TRAFFIC REGULATION)  
(CONSOLIDATION No.2) ORDER 2006)  
(AMENDMENT No.2) ORDER 2010

# PULBOROUGH: LOCATION OF WAITING RESTRICTIONS



**KEY:**

-  PARISH BOUNDARY
-  OS TILE GRID
-  PARKING TILE GRID
-  LOCATION OF WAITING RESTRICTIONS
-  ROAD NETWORK



West Sussex County Council  
 Infrastructure  
 The Grange  
 Tower Street  
 Chichester  
 West Sussex  
 PO19 1RH

WEST SUSSEX COUNTY COUNCIL  
 ((HORSHAM DISTRICT)  
 (PARKING PLACES AND TRAFFIC REGULATION)  
 (CONSOLIDATION No.2) ORDER 2006)  
 (AMENDMENT No.2) ORDER 2010

LOCATION OF WAITING RESTRICTIONS



Reproduced from or based upon 2009 Ordnance Survey mapping with permission of the Controller of HMSO (c) Crown Copyright reserved. Unauthorised reproduction infringes Crown copyright and may lead to prosecution or civil proceedings West Sussex County Council Licence No. 100023447

SCALE: 1:35,000  
 22/02/2010

**WEST SUSSEX COUNTY COUNCIL**  
**((HORSHAM DISTRICT) (PARKING PLACES AND TRAFFIC REGULATION)**  
**(CONSOLIDATION NO. 2) ORDER 2006)**  
**(AMENDMENT NO. 2) ORDER 2010**

West Sussex County Council in exercise of their powers under Sections 1 (1) 2 (1) and (2), 4 (2), 45, 46, 49 and 53 and Part IV of Schedule 9 of the Road Traffic Regulation Act 1984 "the Act" as amended and of all other enabling powers and after consultation with the chief officer of police in accordance with Part III of Schedule 9 to the Act hereby make the following Order:-

1. This Order shall come into operation on the twenty second day of February 2010 and may be cited as "West Sussex County Council ((Horsham District) (Parking Places and Traffic Regulation) (Consolidation No. 2) Order 2006) (Amendment No. 2) Order 2010."
2. The "West Sussex County Council (Horsham District) (Parking Places and Traffic Regulation) (Consolidation No.2) Order 2006" is hereby amended by the deletion from it of the plans specified in the First Schedule to this Order and the substitution of the plans attached in the Second Schedule to this Order.

**FIRST SCHEDULE**  
**Plan numbers to be revoked**

TQ0418NES (Issue No. 3)  
TQ0418NWS (Issue No.3)

**SECOND SCHEDULE**  
**Plan numbers to be substituted**  
**(as attached)**

TQ0418NES (Issue No. 4)  
TQ0418NWS (Issue No. 4)

The COMMON SEAL of WEST SUSSEX COUNTY COUNCIL was hereto affixed )  
 )  
 the SIXTEENTH day of FEBRUARY 2010 )  
 in the presence of ) (L.S.)  
 )  
 )  
 )  
 )  
 )  
 )

*D. Rowland*  
Authorised Signatory



7/14/10  
04/08 DELEGATED AUTHORITY

I HEREBY CERTIFY THIS TO  
BE A TRUE COPY OF THE  
ORIGINAL DOCUMENT  
.....  
Authorised Officer *Tony Kershaw*  
WEST SUSSEX COUNTY COUNCIL

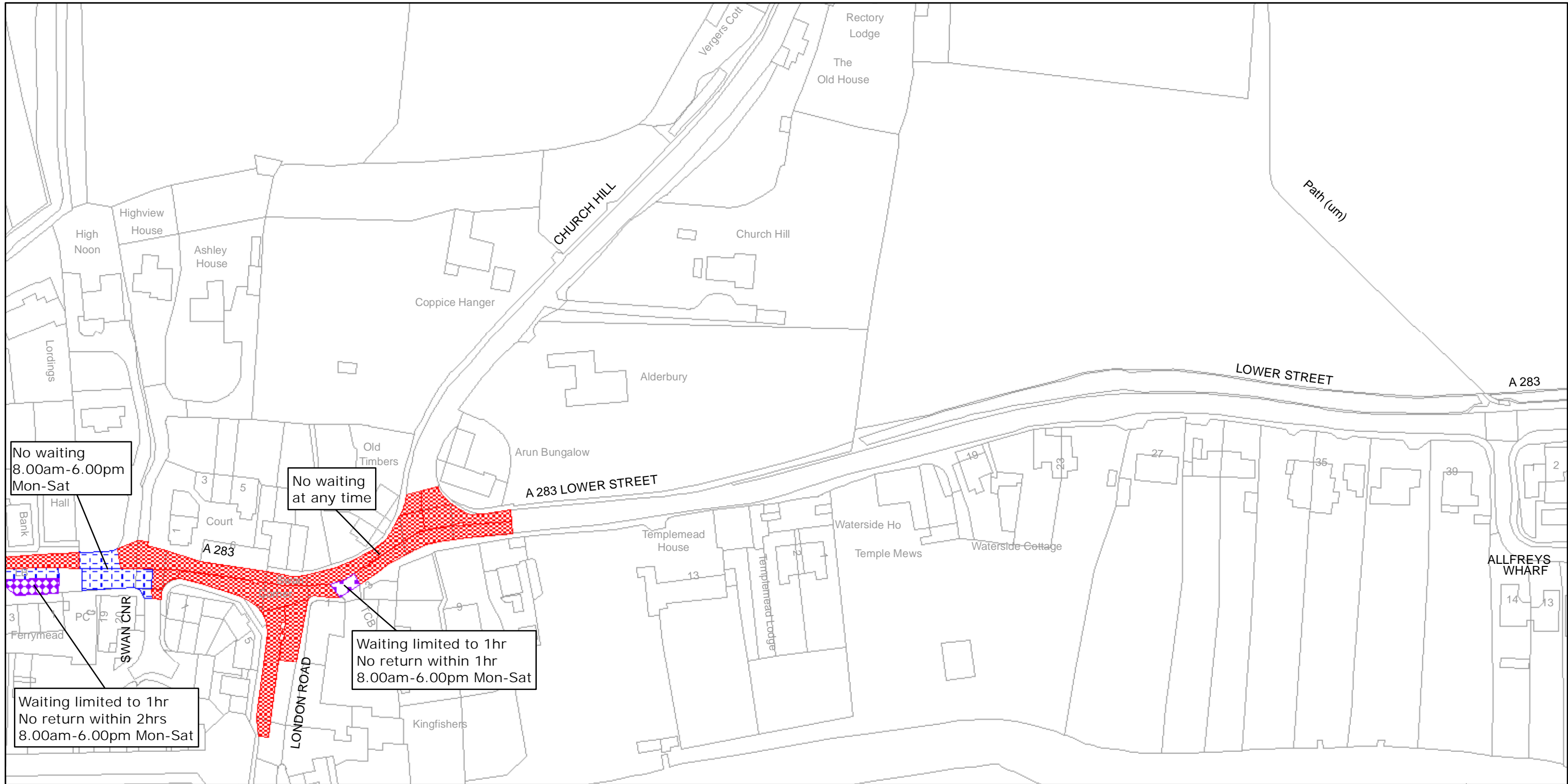

West Sussex County Council  
 Infrastructure  
 The Grange  
 Tower Street  
 Chichester  
 West Sussex  
 PO19 1RH

HORSHAM DISTRICT: PULBOROUGH

WAITING RESTRICTIONS

TILE REF NO:  
 TQ0418NES

SHEET ISSUE NO 4

SHEET ACTIVE FROM - 22/02/2010



SCALE:  
 1:1250  
 at A3 size

Reproduced from or based upon 2009 Ordnance Survey mapping with permission of the Controller of HMSO (c) Crown Copyright reserved.  
 Unauthorised reproduction infringes Crown copyright and may lead to prosecution or civil proceedings West Sussex County Council Licence No. 100023447

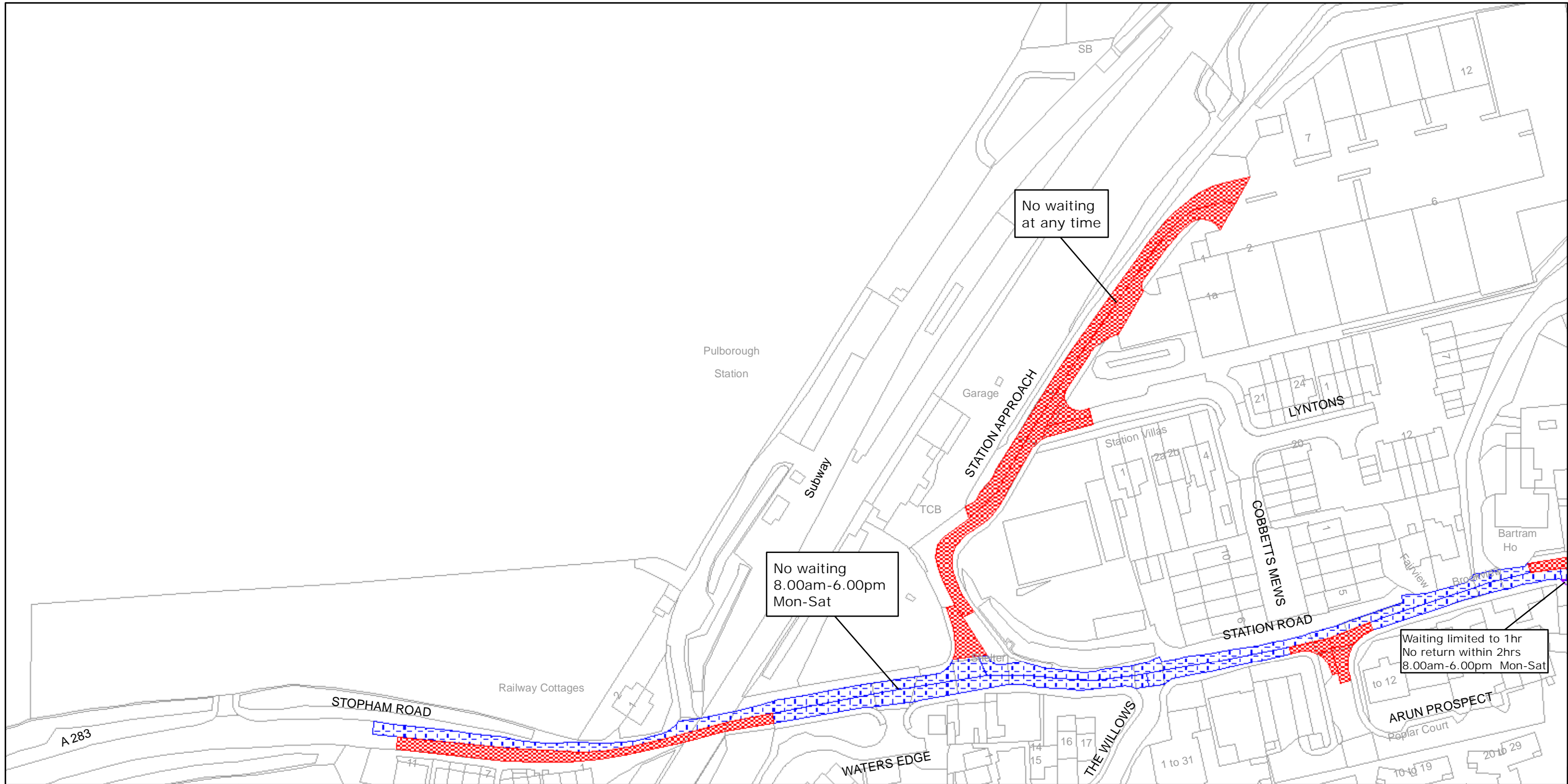

West Sussex County Council  
 Infrastructure  
 The Grange  
 Tower Street  
 Chichester  
 West Sussex  
 PO19 1RH

HORSHAM DISTRICT: PULBOROUGH

WAITING RESTRICTIONS

TILE REF NO:  
 TQ0418NWS

SHEET ISSUE NO 4

SHEET ACTIVE FROM - 22/02/2010



SCALE:  
 1:1250  
 at A3 size

Reproduced from or based upon 2009 Ordnance Survey mapping with permission of the Controller of HMSO (c) Crown Copyright reserved.  
 Unauthorised reproduction infringes Crown copyright and may lead to prosecution or civil proceedings West Sussex County Council Licence No. 100023447