

WEST SUSSEX COUNTY COUNCIL
((HORSHAM DISTRICT) (PARKING PLACES AND TRAFFIC REGULATION)
(CONSOLIDATION No.2) ORDER 2006)
(AMENDMENT No.1) ORDER 2009

STORRINGTON: LOCATION OF WAITING RESTRICTIONS

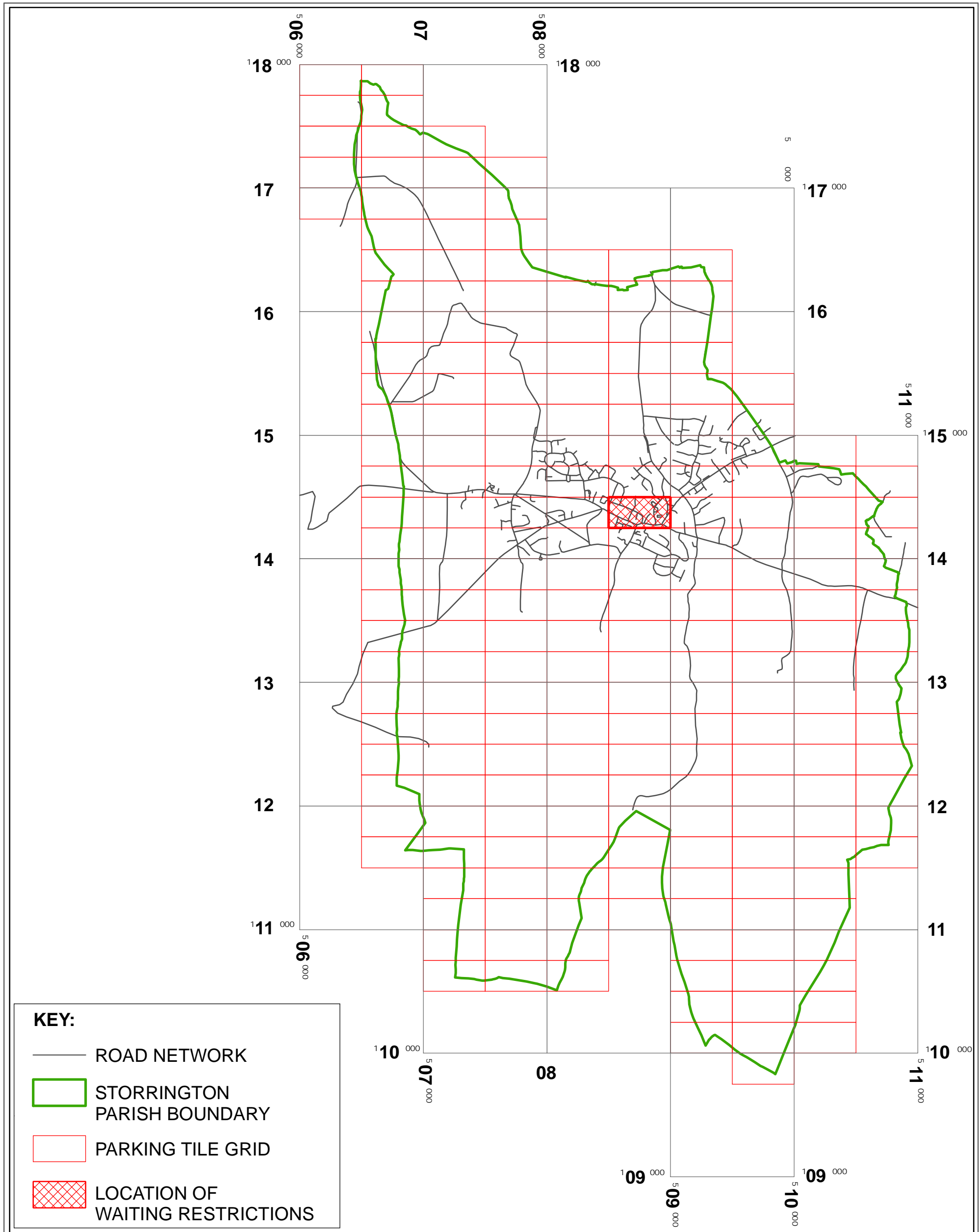

West Sussex County Council
 Infrastructure
 The Grange
 Tower Street
 Chichester
 West Sussex
 PO19 1RH

WEST SUSSEX COUNTY COUNCIL
 ((HORSHAM DISTRICT) (PARKING PLACES AND
 TRAFFIC REGULATION) (CONSOLIDATION No.2)
 ORDER 2006) (AMENDMENT No.1) ORDER 2009

LOCATION OF WAITING RESTRICTIONS



Reproduced from or based upon 2008 Ordnance Survey mapping
 with permission of the Controller of HMSO (c) Crown Copyright reserved.
 Unauthorised reproduction infringes Crown copyright and may lead
 to prosecution or civil proceedings West Sussex County Council Licence No. 100023447

SCALE: 1:30,000
 19/01/2009

WEST SUSSEX COUNTY COUNCIL
((HORSHAM DISTRICT) (PARKING PLACES AND TRAFFIC REGULATION)
(CONSOLIDATION NO. 2) ORDER 2006)
(AMENDMENT NO. 1) ORDER 2009

West Sussex County Council in exercise of their powers under Sections 1 (1) 2 (1) and (2), 4 (2), 45, 46, 49 and 53 and Part IV of Schedule 9 of the Road Traffic Regulation Act 1984 "the Act" as amended and of all other enabling powers and after consultation with the chief officer of police in accordance with Part III of Schedule 9 to the Act hereby make the following Order:-

1. This Order shall come into operation on the nineteenth day of January 2009 and may be cited as "West Sussex County Council ((Horsham District) (Parking Places and Traffic Regulation) (Consolidation No. 2) Order 2006) (Amendment No. 1) Order 2009."
2. The "West Sussex County Council (Horsham District) (Parking Places and Traffic Regulation) (Consolidation No.2) Order 2006" is hereby amended by the deletion from it of the plan specified in the First Schedule to this Order and the substitution of the plan attached in the Second Schedule to this Order.

FIRST SCHEDULE
Plan number to be revoked

TQ0814SEN (Issue No. 4)

SECOND SCHEDULE
Plan to be substituted
(as attached)

TQ0814SEN (Issue No. 5)

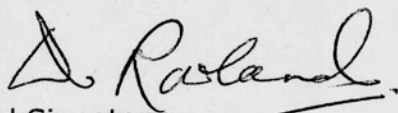
The COMMON SEAL of WEST SUSSEX)
 COUNTY COUNCIL was hereto affixed)
 the THIRTEENTH day of JANUARY 2009)
 in the presence of) (L.S.)
)
 Authorised Signatory)



I HEREBY CERTIFY THIS TO
BE A TRUE COPY OF THE
ORIGINAL DOCUMENT

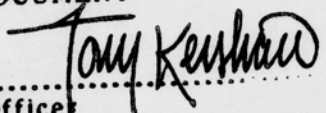

 Authorised Officer
 WEST SUSSEX COUNTY COUNCIL

04/08 DELEGATED AUTHORITY

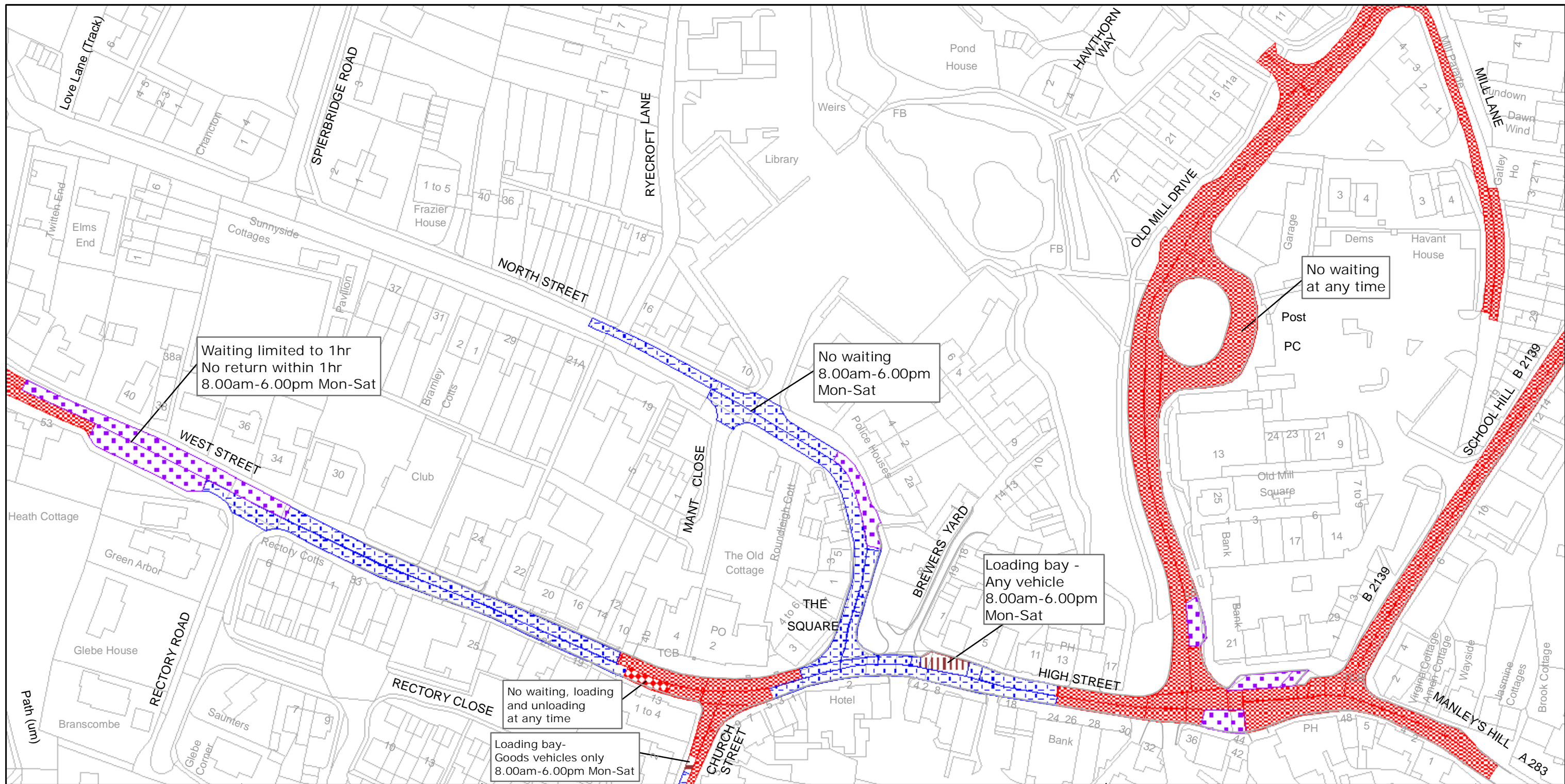

Waiting limited to 1hr
No return within 1hr
8.00am-6.00pm Mon-Sat

No waiting
8.00am-6.00pm
Mon-Sat

No waiting
at any time

Loading bay -
Any vehicle
8.00am-6.00pm
Mon-Sat

No waiting, loading
and unloading
at any time

Loading bay -
Goods vehicles only
8.00am-6.00pm Mon-Sat



West Sussex County Council
Infrastructure
The Grange
Tower Street
Chichester
West Sussex
PO19 1RH

HORSHAM DISTRICT: STORRINGTON
WAITING RESTRICTIONS

TILE REF NO:
TQ0814SEN

SHEET ISSUE NO 5
SHEET ACTIVE FROM - 19/01/2009

SCALE:
1:1250
at A3 size

Reproduced from or based upon 2008 Ordnance Survey mapping with permission of the Controller of HMSO (c) Crown Copyright reserved.
Unauthorised reproduction infringes Crown copyright and may lead to prosecution or civil proceedings West Sussex County Council Licence No. 100023447