

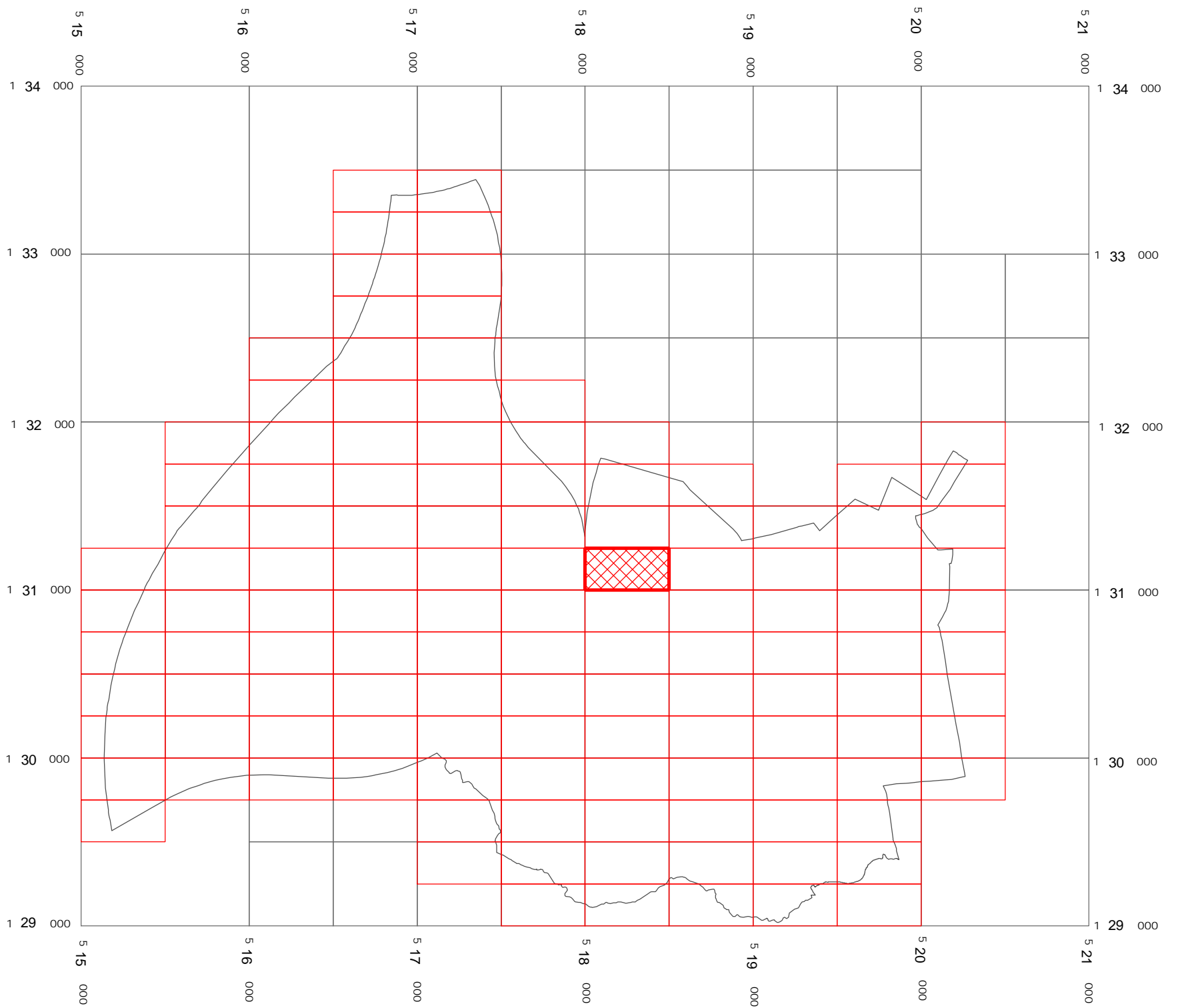



WEST SUSSEX COUNTY COUNCIL
((HORSHAM DISTRICT) (PARKING PLACES AND TRAFFIC REGULATION)
(CONSOLIDATION No.2) ORDER 2006)
(AMENDMENT No.5) ORDER 2008

HORSHAM: LOCATION OF WAITING RESTRICTIONS



KEY:

-  HORSHAM PARISH BOUNDARY
-  PARKING TILE GRID
-  LOCATION OF WAITING RESTRICTIONS



West Sussex County Council
 Infrastructure
 The Grange
 Tower Street
 Chichester
 West Sussex
 PO19 1RH

WEST SUSSEX COUNTY COUNCIL
 ((HORSHAM DISTRICT)
 (PARKING PLACES AND TRAFFIC REGULATION)
 (CONSOLIDATION No.2) ORDER 2006)
 (AMENDMENT No.5) ORDER 2008 :
LOCATIONS OF WAITING RESTRICTIONS



Reproduced from or based upon 2008 Ordnance Survey mapping with permission of the Controller of HMSO (c) Crown Copyright reserved. Unauthorised reproduction infringes Crown copyright and may lead to prosecution or civil proceedings West Sussex County Council Licence No. 100023447

SCALE: 1:30,000
06/10/2008

SUPPLEMENT TO THE FOURTH SCHEDULE
Schedule of Waiting Restrictions

All areas over which the provision of the orders apply are defined by the shaded areas as shown on the following plans plus a contiguous area not indicated on the plans of verge and/or footway between the carriageway edge and the highway boundary. The plans in this schedule are based upon grid references of the Ordnance Survey National Grid defined by the OSGB 36 triangulation.

Prohibition of waiting

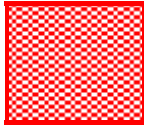
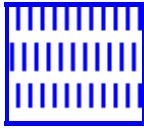
- 101  check No waiting at any time
- 111  pat 046 No waiting 9.00am-5.00pm Mon-Sat

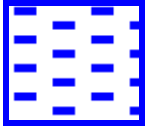
- 114  pat063 No waiting 9:00am-5:00pm Mon-Fri

Residents Parking

- 505  pat038 Residents' and Visitors' permit holders only
8.00am-10.00am Mon-Sat

 Boundary of Controlled Parking Zone

WEST SUSSEX COUNTY COUNCIL
((HORSHAM DISTRICT) (PARKING PLACES AND TRAFFIC REGULATION)
(CONSOLIDATION NO. 2) ORDER 2006)
(AMENDMENT NO 5) ORDER 2008

West Sussex County Council in exercise of their powers under Sections 1 (1) 2 (1) and (2), 4 (2), 45, 46, 49 and 53 and Part IV of Schedule 9 of the Road Traffic Regulation Act 1984 ("the Act") as amended and of all other enabling powers and after consultation with the Chief Officer of Police in accordance with Part III of Schedule 9 to the Act hereby make the following Order:-

1. This Order shall come into operation on the 6th day of October 2008 and may be cited as "West Sussex County Council ((Horsham District) (Parking Places and Traffic Regulation) (Consolidation No. 2) Order 2006) (Amendment No. 6) Order 2008".
2. The "West Sussex County Council (Horsham District) (Parking Places and Traffic Regulation) (Consolidation No.2) Order 2006" is hereby amended by the replacement of the plans specified in the First Schedule to this Order, with the plans specified in the Second Schedule to this Order, attached hereto.

FIRST SCHEDULE
Plan to be Replaced

TQ1831SWS (Issue Number 2)

SECOND SCHEDULE
Replacement Plans

TQ1831SWS (Issue Number 3)

THE Common Seal of THE)
WEST SUSSEX COUNTY COUNCIL)
was hereto affixed the)
TWENTY THREE)
day of SEPTEMBER 2008)
)
)
D. Rowland)
Authorised Signatory)

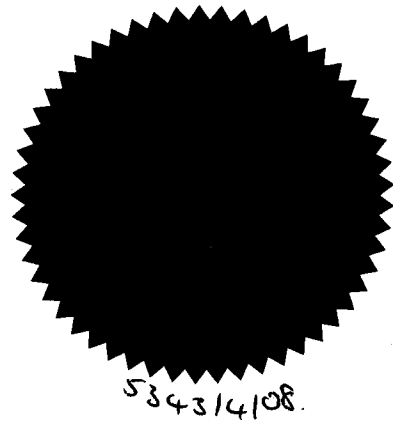

TRO/63/MM

I HEREBY CERTIFY THIS TO
BE A TRUE COPY OF THE
ORIGINAL DOCUMENT
Tony Kenshaw

04/08 DELEGATED AUTHORITY

.....
Authorised Officer
WEST SUSSEX COUNTY COUNCIL

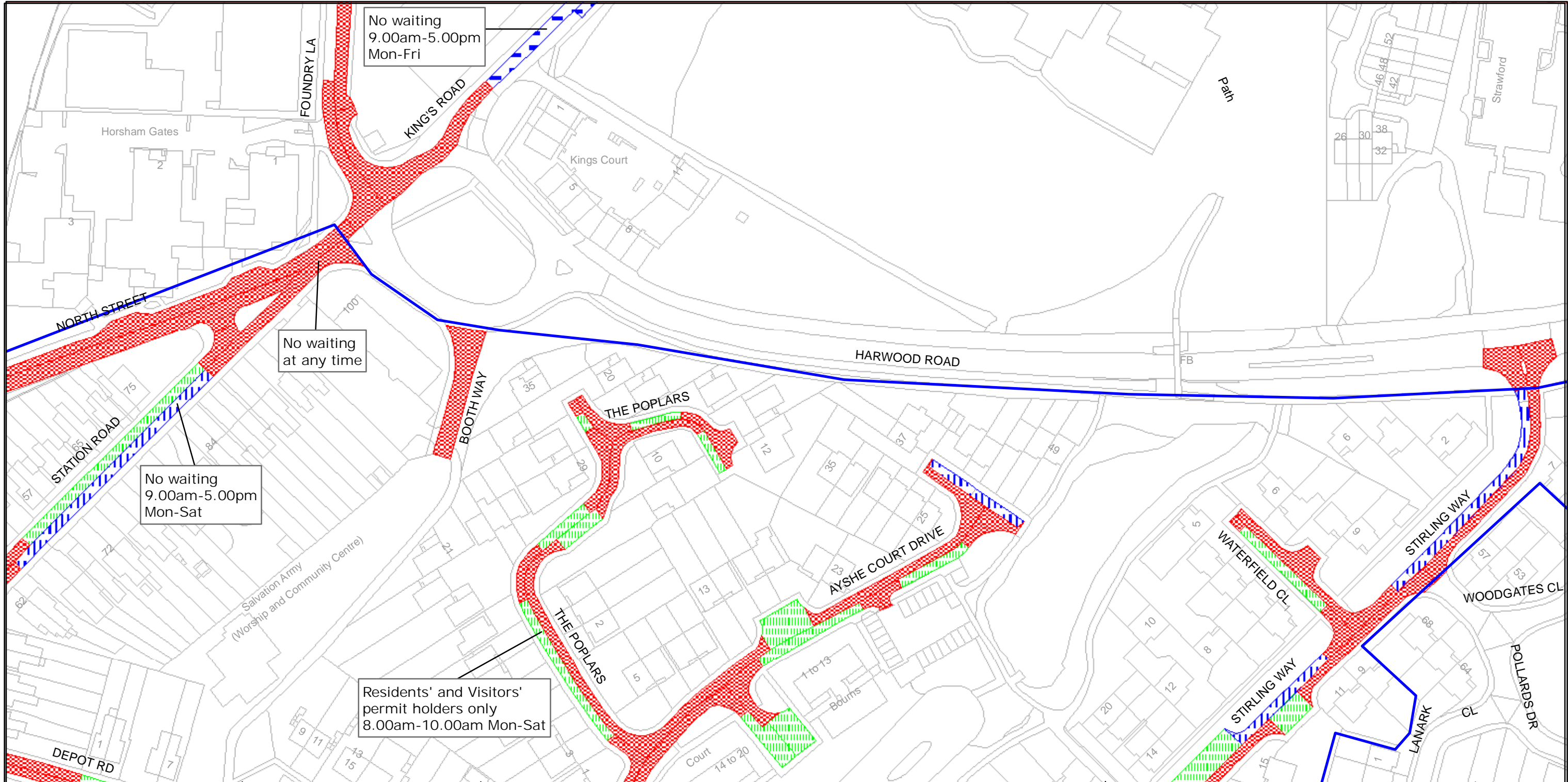

West Sussex County Council
 Infrastructure
 The Grange
 Tower Street
 Chichester
 West Sussex
 PO19 1RH

HORSHAM DISTRICT: HORSHAM
 WAITING RESTRICTIONS

Reproduced from or based upon 2008 Ordnance Survey mapping with permission of the Controller of HMSO (c) Crown Copyright reserved.
 Unauthorised reproduction infringes Crown copyright and may lead to prosecution or civil proceedings West Sussex County Council Licence No. 100023447

TILE REF NO:
 TQ1831SWS

SHEET NO 3
 SHEET ACTIVE FROM - 06/10/2008



SCALE:
 1:1250