

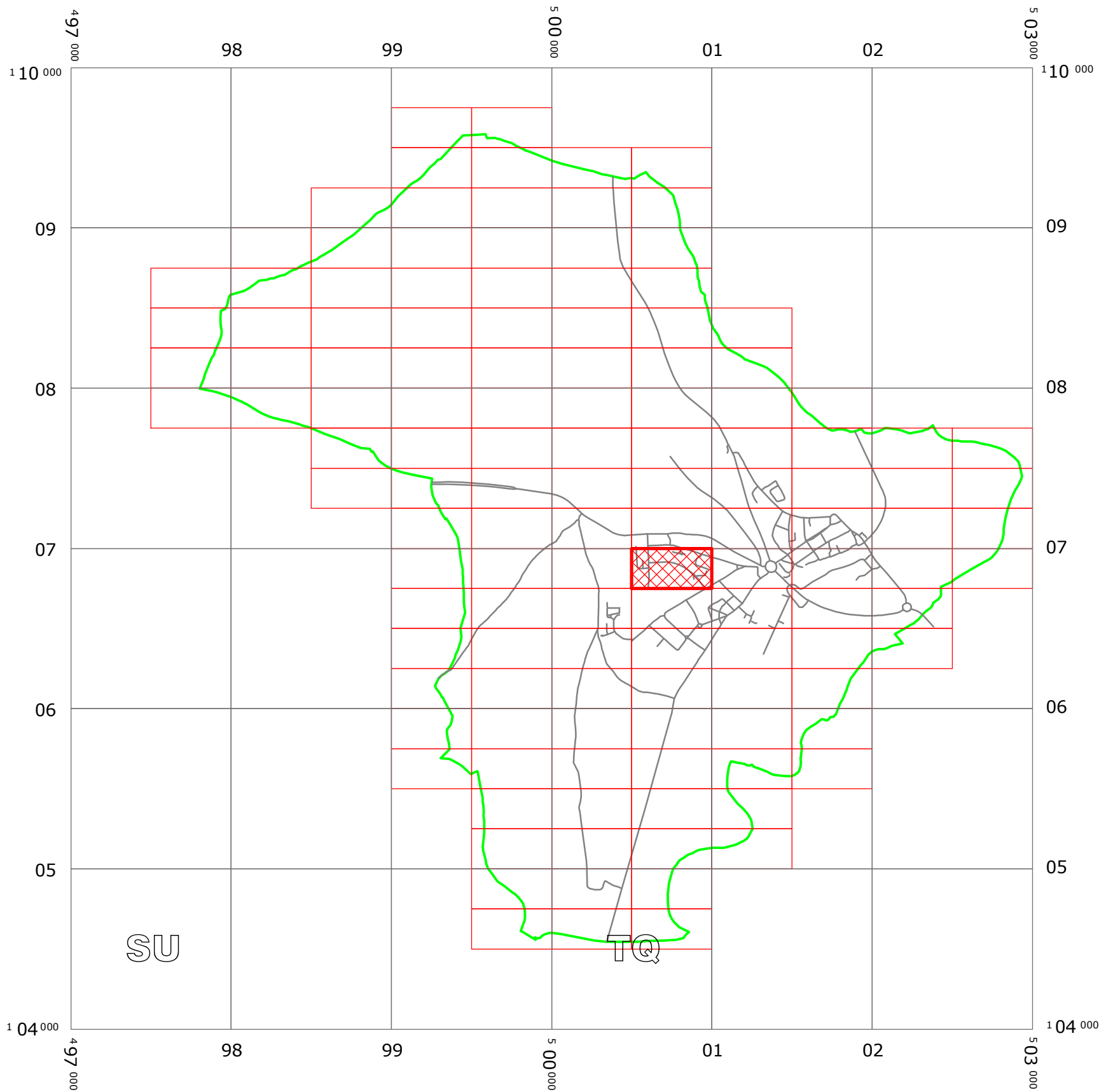





WEST SUSSEX COUNTY COUNCIL ((ARUN DISTRICT)
(PARKING PLACES AND TRAFFIC REGULATION)
(CONSOLIDATION) ORDER 2010)
(ARUNDEL: JARVIS ROAD AMENDMENT) ORDER 2015

ARUNDEL: LOCATION OF WAITING RESTRICTIONS



KEY:

-  OS TILE GRID
-  PARKING TILE GRID
-  LOCATION OF WAITING RESTRICTIONS
-  PARISH BOUNDARY
-  ROAD NETWORK



West Sussex County Council
Residents &
Environmental Services
The Grange, Tower Street
Chichester
West Sussex
PO19 1RH

WEST SUSSEX COUNTY COUNCIL ((ARUN DISTRICT)
(PARKING PLACES AND TRAFFIC REGULATION)
(CONSOLIDATION) ORDER 2010)
(ARUNDEL: JARVIS ROAD AMENDMENT) ORDER 2015

LOCATION OF WAITING RESTRICTIONS



Reproduced from or based upon 2013 Ordnance Survey material with permission of the Controller of HMSO
(c) Crown Copyright reserved. Unauthorised reproduction infringes Crown copyright and may lead to
prosecution or civil proceedings West Sussex County Council Licence No. 100023447

SCALE: 1:30,000
DATE: 26/01/2015

Key for Waiting Restrictions

All areas over which the provision of the orders apply are defined by the shaded areas as shown on the following plans plus a contiguous area not indicated on the plans of verge and/or footway between the carriageway edge and the highway boundary. The plans in this schedule are based upon grid references of the Ordnance Survey National Grid defined by the OSGB 36 triangulation.

Prohibition of waiting at any time

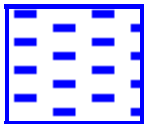
101		check	No waiting at any time
114		pat063	No waiting 9:00am-5:00pm Mon-Fri

Free Limited Waiting

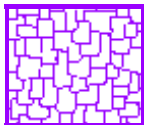
715		scale1	Waiting limited to 1hr No return within 1hr 8.00am-6.00pm any day
-----	---	--------	--

Clearways

1100		usgs503	School Keep Clear-No stopping at any time
------	---	---------	---

WEST SUSSEX COUNTY COUNCIL
((ARUN DISTRICT) (PARKING PLACES & TRAFFIC REGULATION)
(CONSOLIDATION) ORDER 2010)

(ARUNDEL: JARVIS ROAD AMENDMENT) ORDER 2015

West Sussex County Council in exercise of their powers under Sections 1 (1) 2 (1) and (2), 4 (2), 45, 46, 49 and 53 and Part IV of Schedule 9 of the Road Traffic Regulation Act 1984 ("the Act") as amended and of all other enabling powers and after consultation with the Chief Officer of Police in accordance with Part III of Schedule 9 to the Act hereby make the following Order:-

1. This Order shall come into operation on the Twenty Sixth day of January 2015 and may be cited as "West Sussex County Council ((Arun District) (Parking Places & Traffic Regulation) (Consolidation) Order 2010) (Arundel: Jarvis Road Amendment) Order 2015".
2. The "West Sussex County Council (Arun District) (Parking Places & Traffic Regulation) (Consolidation) Order 2010" is hereby amended by the replacement of the plan specified in the First Schedule to this Order, with the plan specified in the Second Schedule, attached hereto.

FIRST SCHEDULE
Plan to be Replaced

TQ0006NEN (Issue Number 2)

SECOND SCHEDULE
Replacement Plans

TQ0006NEN (Issue Number 3)

THE Common Seal of THE)
 WEST SUSSEX COUNTY COUNCIL)
 was hereto affixed the)
 day of *TWENTY SECOND*)
JANUARY 2015)
)
 Authorised Signatory)
 JDA1401-MM)



04/08 DELEGATED AUTHORITY

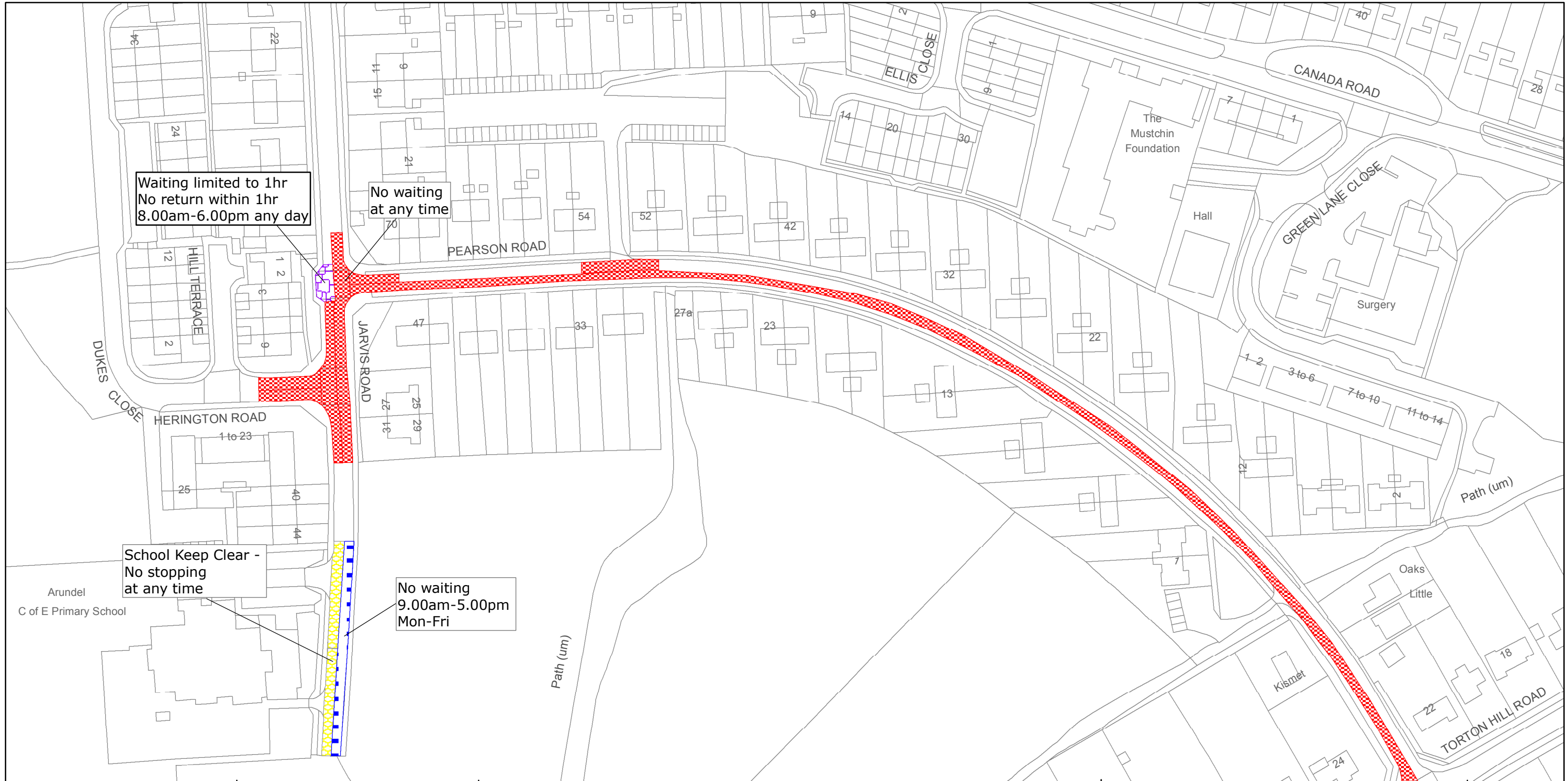

Waiting limited to 1hr
No return within 1hr
8.00am-6.00pm any day

No waiting
at any time

School Keep Clear -
No stopping
at any time

No waiting
9.00am-5.00pm
Mon-Fri



West Sussex County Council
Highways & Transport
The Grange
Tower Street
Chichester
West Sussex
PO19 1RH

ARUN DISTRICT: ARUNDEL
WAITING RESTRICTIONS

TILE REF NO:
TQ0006NEN

SHEET ISSUE NO 3
SHEET ACTIVE FROM - 26/01/2015



SCALE:
1:1250
at A3 size

Reproduced from or based upon 2013 Ordnance Survey material with permission of the Controller of HMSO (c) Crown Copyright reserved.
Unauthorised reproduction infringes Crown copyright and may lead to prosecution or civil proceedings West Sussex County Council Licence No. 100023447