

## HERTFORDSHIRE COUNTY COUNCIL

### THE HERTFORDSHIRE (LEMSFORD ROAD, HATFIELD) (RESTRICTION OF WAITING) ORDER 2015

NOTICE is given that the Hertfordshire County Council has made an Order under the Road Traffic Regulation Act 1984 to introduce waiting restrictions in part of Hatfield as specified in the Schedule to this Order. The Order will come into effect on Monday 26 October 2015.

Documents giving more detailed particulars of the Order may be inspected from 21 October 2015 to 2 December 2015 during normal office hours at the offices of Welwyn Hatfield Council, Council Offices, The Campus, Welwyn Garden City; Hatfield Town Council, Council Offices, Birchwood Leisure Centre, Longmead, Hatfield and at Main Reception, Hertfordshire County Council, County Hall, Pegs Lane, Hertford or viewed at [www.hertsdirect.org/trafficorders](http://www.hertsdirect.org/trafficorders) by clicking on the relevant local area (Under Ref: WH/004/15)

Enquiries relating to the Order should be referred to the Highways Engineer concerned Renato Mapembe tel: 01992 658496 or [renato.mapembe@hertfordshire.gov.uk](mailto:renato.mapembe@hertfordshire.gov.uk)

Any person wishing to question the validity of the Order, or of any provision contained in it, on the grounds that it is not within the powers conferred by the Road Traffic Regulation Act 1984, or on the grounds that any requirement of the Act or any Instrument made under it has not been complied with in relation to the Order, may within 6 weeks from the date of this Notice apply to the High Court for this purpose.

**SCHEDULE:** No waiting at any time –effecting those sections of road herein listed and as set out in the Order and accompanying plan - Parts of Lemsford Road.

County Hall  
Hertford  
Herts SG13 8DN

21 October 2015  
John Wood  
Chief Executive & Director of Environment

## STATEMENT OF REASONS FOR MAKING

### THE HERTFODSHIRE (LEMSFORD ROAD, HATFIELD) (RESTRICTION OF WAITING) ORDER 2015

Hertfordshire County Council is proposing to introduce waiting restrictions in part of Hatfield.

The proposals will comprise of –

- 'No waiting at any time' restrictions in parts of Lemsford Road.

The proposals are intended to address safety and access concerns that are arising due to the current on road parking habits of motorists. The measures aim to aid visibility and access of vehicles on Lemsford Road.

Therefore, it appears to the Highway Authority that it is necessary and expedient to make the Order in the interests of; avoiding danger to persons or other traffic using the road or any other road or for preventing the likelihood of any such danger arising, for facilitating the passage on the road or any other road of any class of traffic (including pedestrians) and for preserving or improving the amenities of the area through which the road runs.

The proposal has been subject to consultation with local and County Councillors representing the area and Welwyn Hatfield Borough Council. The local Police, Ambulance, Fire and Rescue Services, Hertfordshire County Council Passenger Transport Unit, local residents and businesses have also been consulted.

**HERTFORDSHIRE COUNTY COUNCIL**

**ROAD TRAFFIC REGULATION ACT 1984**

Date of Order: 16 October 2015

Order No: 7935

**THE HERTFORDSHIRE (LEMSFORD ROAD, HATFIELD)  
(RESTRICTION OF WAITING) ORDER 2015**

The Hertfordshire County Council in exercise of their powers under Sections 1, 2 and 3 of the Road Traffic Regulation Act 1984 (which said Act of 1984 is hereinafter referred to as "the Act of 1984"), and Part IV of Schedule 9 of the Act of 1984 and of all other enabling powers and after consultation with the Chief Officer of Police in accordance with Part III of Schedule 9 of the Act of 1984, hereby make the following Order:-

1. This Order may be cited as "The Hertfordshire (Lemsford Road, Hatfield) (Restriction of Waiting) Order 2015" and shall come into effect on Monday 26 October 2015.
2. Save as provided in Articles 3, 4 and 5 of this Order, no person shall cause or permit any vehicle to wait at any time in those lengths of Lemsford Road, Hatfield, as specified in the Schedule to this Order.
3. (1) Nothing in Article 2 of this Order applies to the lengths of road restricted by that Article (which said lengths of road are referred to in this Article as "the restricted area") in relation to –
  - (a) a vehicle being used for Fire and Rescue, Ambulance or Police purposes.
  - (b) anything done with the permission of or at the direction of a Police Constable in uniform; or with permission of a Civil Enforcement Officer as defined by the Traffic Management Act 2004 and appointed by Welwyn Hatfield Borough Council.
  - (c) a vehicle which is prevented from proceeding by circumstances beyond the drivers control or which has stopped in order to avoid injury or damage to persons or property or when required to do so by law;
  - (d) a vehicle which is stationary in order that it may be used for one or more of the purposes specified in sub-Article (2) of this Article and which cannot reasonably be used for such a purpose without stopping in the restricted area;
  - (e) a marked vehicle which, whilst used by a universal service provider in the course of the provision of a universal postal service, is stationary only for so long as may be reasonably necessary for postal packets to be delivered or collected;

In this Article -

The expressions "universal service provider", "provision of a universal postal Service" and "postal packet" shall bear the same meanings as in the Section 65 of the Postal Services Act 2011.

- (2) The "purposes" referred to in sub-Article (1)(d) of this Article are –
  - (a) any operation involving building, demolition or excavation;
  - (b) the removal of any obstruction to traffic;
  - (c) the maintenance, improvement or reconstruction of a road;
  - (d) constructing, improving, maintaining, or cleaning of any street furniture; or
  - (e) the laying, erection, alteration, repair or cleaning of any sewer or of any main pipe or apparatus for the supply of gas, water or electricity, or of any telecommunications apparatus kept or installed for the purposes of a telecommunications code system or of any other telecommunications apparatus lawfully kept installed in any position.

4. Nothing in Article 2 of this Order applies to the lengths of road restricted by that Article (which said lengths of road are referred to in this Article as “the restricted area”) so as to render it unlawful to cause or permit any vehicle to wait only for so long as may be reasonably necessary –
  - (a) to enable goods to be loaded on or unloaded from the vehicle from or to premises adjacent to the restricted area; or
  - (b) to enable a passenger to board or alight and to load and unload any luggage.
5. (1) Nothing in Article 2 of this Order shall render it unlawful to cause or permit a disabled person’s vehicle which displays in the relevant position a disabled person’s badge and a parking disc, to wait at any time in the lengths of road specified in the Schedule of this Order for a period not exceeding 3 hours (not being a period separated by an interval of less than 1 hour from a previous period of waiting by the same vehicle in the same length of road).
  - (2) In this Article -
    - “disabled person’s vehicle” has the same meaning as in Section 142(1) of the Act of 1984;
    - “disabled person’s badge” has the same meaning as given in Regulation 3(1) of The Local Authorities’ Traffic Orders (Exemptions for Disabled Persons) (England) Regulations 2000
    - “parking disc” has the same meaning as given in Regulation 8(5) of The Local Authorities’ Traffic Orders (Exemptions for Disabled Persons) (England) Regulations 2000; and
    - “relevant position” has the same meaning as given in Regulation 4 of The Local Authorities’ Traffic Orders (Exemptions for Disabled Persons) (England) Regulations 2000
6. The Interpretation Act 1978 shall apply for the interpretation of this Order as it applies for the interpretation of an Act of Parliament.
7. The provisions of the following Order are hereby revoked but only in so far as they are affected by the restrictions imposed by this Order:
 

The Borough of Welwyn Hatfield (Control of Parking) (Consolidation) Order 2012
8. The restrictions imposed by this Order shall be in addition to and not in derogation from any restriction or requirement imposed by any other regulations made or having effect as if made under the Act of 1984 or by or under any other enactment.

### **SCHEDULE**

#### lengths of Lemsford Road, Hatfield – no waiting at any time

- Lemsford Road (north east side) (a) from a point 13 metres south east of a point in line with the boundary between 33 and 35 Lemsford Road south eastwards for approximately 76.5 metres to a point 14.5 metres south east of a point in line with the projected south east kerbline of Fiddle Bridge Lane.
- (b) from a point 55.5 metres south east of a point in line with the projected south east kerbline of Fiddle Bridge Lane south eastwards for approximately 24.5 metres to a point 3.5 metres north west of a point in line with the projected north west kerbline of Stockbreach Road.
- (south west side) (a) from a point 8.5 metres south east of a point in line with the projected south east kerbline of the access road to Fiddlebridge Industrial Centre south eastwards for approximately 23 metres to a point 10 metres north west of a point in line with the projected north west kerbline of Fiddle Bridge Lane.

(b) from a point 11.5 metres south east of a point in line with the projected south east kerbline of Fiddle Bridge Lane south eastwards for approximately 90 metres to a point 14 metres south east of a point in line with the projected south east kerbline of Stockbreach Road.

IN WITNESS whereof the Common Seal of the Hertfordshire County Council was hereunto affixed this 16<sup>th</sup> day of October 2015.

The Common Seal of )  
Hertfordshire County Council )  
was hereunto affixed )  
in the presence of:- )

15/3/15



K.P. Pettitt

Kathryn Pettitt

**Chief Legal Officer**

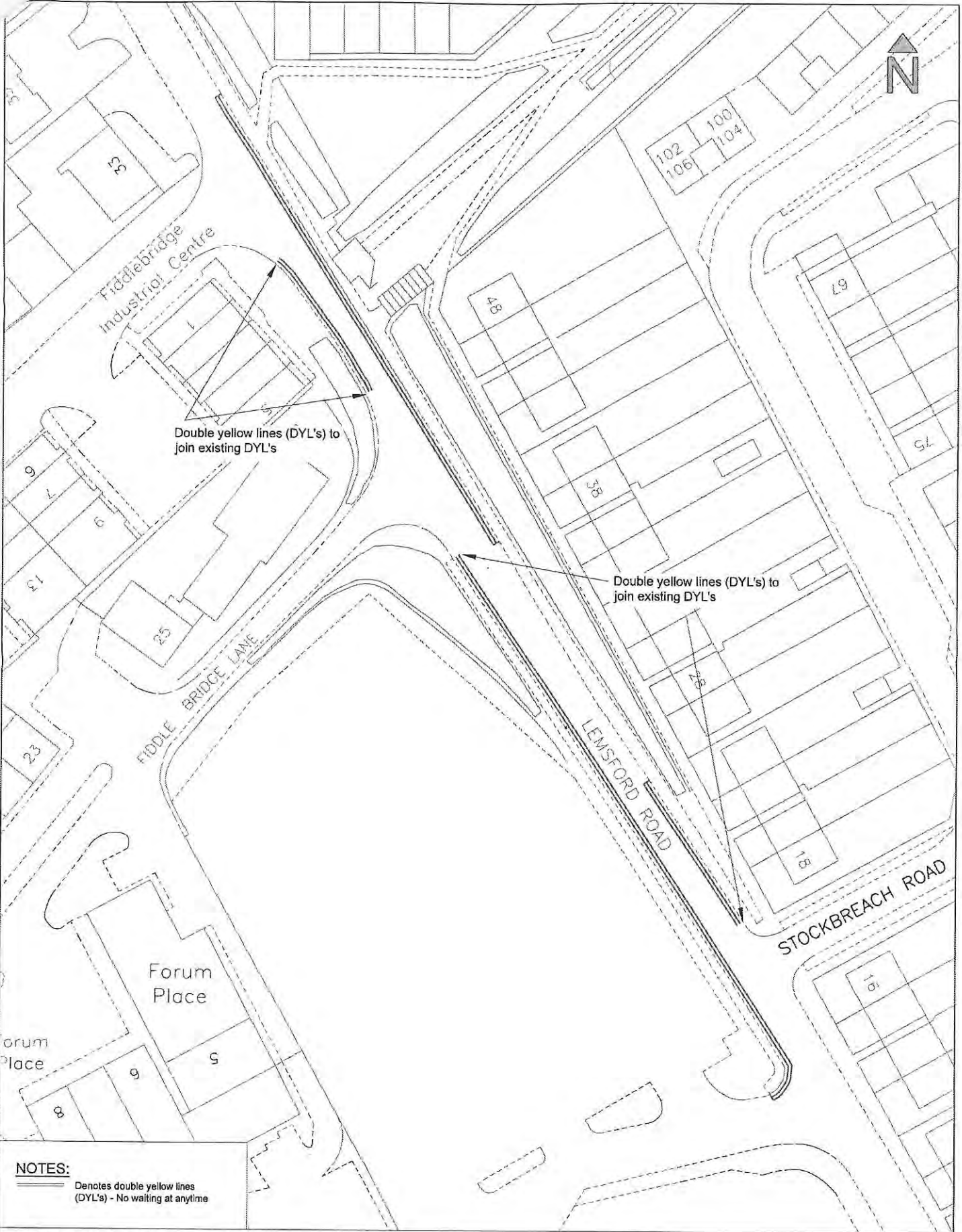

Double yellow lines (DYL's) to join existing DYL's

Double yellow lines (DYL's) to join existing DYL's

**NOTES:**  
 Denotes double yellow lines (DYL's) - No waiting at anytime

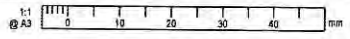

Control / Amendment	Approved / Date
R1	HM 09/2015
Layout update to the residents	



COUNTY HALL  
 Pegs Lane  
 Hertford, Herts  
 SG13 8BN  
 Phone: 01992 565655

Based upon the Ordnance Survey material with the permission of Ordnance Survey on behalf of the Controller of Her Majesty's Stationery Office © Crown copyright. Unauthorised reproduction infringes Crown copyright and may lead to prosecution or civil proceedings. Hertfordshire County Council, 100019554 2015

Drawn	Checked	Approved	Checked	Issued Date
LES	LES	HM 12/14		June 2015

G-MSC073 Y2/001 1:500

Project: Lemsford Road PTRO

Proposed Waiting Restrictions

Drawing No: HC G MSC073(001)

Sheet No: 001  
 Edition: R1