

# WATFORD BOROUGH COUNCIL

## THE BOROUGH OF WATFORD (NASCOT AREA) (PROHIBITION OF WAITING) ORDER 2012 TRO no. 741

The Watford Borough Council, pursuant to arrangements made under Section 19 of the Local Government Act 2000 and the Local Government (Arrangements for Discharge of Functions) (England) Regulations 2000 with the Hertfordshire County Council, and in exercise of powers conferred on that County under Sections 1, 2 and 3 of the Road Traffic Regulation Act 1984 (which said Act of 1984 is hereinafter referred to as "the Act of 1984") and Part IV of Schedule 9 of the Act of 1984 and of all other enabling powers and after consultation with the Chief Officer of Police in accordance with Part III of Schedule 9 of the Act of 1984, hereby make the following Order

- 1) This Order may be cited as THE BOROUGH OF WATFORD (NASCOT AREA) (PROHIBITION AND RESTRICTION OF WAITING) ORDER 2012 and shall come into operation on Friday 12 October 2012.
- 2) Save as provided in Articles 3, 4 and 5(1) of this Order no person shall cause or permit any vehicle to wait at any time in those lengths of road specified in the Schedule to this Order.
- 3) (1) Nothing in Article 2 of this Order applies to the lengths of road restricted by the said Article (which said lengths of road are referred to in this Article as "the restricted area") in relation to –
  - a) A vehicle being used for Fire and Rescue, Ambulance or police purposes.
  - b) Anything done with the permission of or at the direction of a police constable in uniform or with permission of a Civil Enforcement Officer as defined by the Traffic Management Act 2004 and appointed by Watford Borough Council
  - c) A vehicle which is prevented from proceeding by circumstances beyond the drivers control or which has stopped in order to avoid injury or damage to persons or property or when required to do so by law;
  - d) A vehicle which is stationary in order that it may be used for one or more of the purposes specified in sub-Article (2) of this Article and which cannot reasonably be used for such a purpose without stopping in the restricted area;
  - e) A marked vehicle which, whilst used by a universal service provider in the course of the provision of a universal postal service, is stationary only for so long as may be reasonably necessary for postal packets to be delivered or collected;

In this Article –

The expression "universal service provider", "provision of a universal postal service" and "postal packet" shall have the same meanings as in the Postal Services Act 2000.

- (2) The "purposes" referred to in sub-Article (1) (d) of this Article are-
  - a) Any operation involving building, demolition or excavation;
  - b) The removal of any obstruction to traffic;
  - c) The maintenance, improvement or reconstruction of a road;
  - d) Constructing, improving, maintaining or cleaning of any street furniture; or
  - e) The laying, erection, alteration, repair or cleaning of any sewer or of any main, pipe or apparatus for the supply of gas, water or electricity or of any telecommunications apparatus kept or installed for the purposes of a telecommunications code system or any other telecommunications apparatus lawfully installed in any position.

4) Nothing in Article 2 of this Order applies to the lengths of road restricted by the said Article (which said lengths of road are referred to in this article as "the restricted area") so as to render it unlawful to cause or permit any vehicle to wait only for so long as may be reasonably necessary –

- c) To enable goods to be loaded or unloaded from the vehicle from or to premises adjacent to the restricted area; or
- d) To enable a passenger to board or alight and to load and unload luggage.

5)(1) Nothing in Article 2 of this Order shall render it unlawful to cause or permit a disabled person's vehicle which displays in the relevant position a disabled person's badge and a parking disc, to wait at any time in the lengths of road specified in the Schedule of this Order for a period not exceeding 3 hours (not being a period separated by an interval of less than 1 hour from a previous period of waiting by the same vehicle in the same length of road).

(2) In this Article –

"disabled persons vehicle" shall have the same meaning as in Section 142(1) of the Act 1984;

"disabled person's badge" has the same meaning as given in Regulation 3(1) of The Local Authorities' Traffic Orders (Exemptions for Disabled Persons) (England) Regulations 2000

"parking disc" has the same meaning as given in Regulation 8(5) of The Local Authorities' Traffic Orders (Exemptions for Disabled Persons) (England) Regulations 2000

"relevant position" has the same meaning as given in Regulation 4 of The Local Authorities' Traffic Orders (Exemptions for Disabled Persons) (England) Regulations 2000

- 6) Schedule 4 of The Borough of Watford (Various Streets) (Prohibition and Restriction of Waiting and Loading) (No. 2) Order 2008 is revoked.
- 7) The Interpretation Act 1978 shall apply for the interpretation of this Order as it applies for the interpretation of an Act of Parliament.
- 8) The provisions of the following Orders are hereby revoked but only in so far as they are affected by the restrictions imposed by this Order  
 The Borough of Watford (Nascot Area) (Prohibition of Waiting) Order 2000  
 The Borough of Watford (Various Streets, Watford) (Restriction and Prohibition of Waiting) Order 2008
- 9) The restrictions imposed by this Order shall be in addition to, and not in derogation from any restriction or requirement imposed by any regulation made or having effect as if made under the Act of 1984 or by or under any other enactment.

THE COMMON SEAL of THE WATFORD )  
BOROUGH COUNCIL was hereunto )  
affixed this 11<sup>th</sup> day of October 2012 )  
in the presence of: )

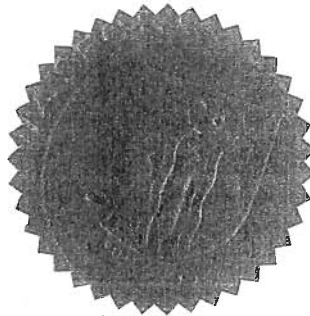

4336/12

VERIFIED	
MIN No	<i>Desk</i>
O/O S/H	<i>Hoff</i>
	<i>20/10/12</i>
	<i>BS</i>

*[Signature]*  
(for + on behalf of)  
Head of Legal and Property Services

## SCHEDULE

no waiting at any time

	Road		side	
1	Courtlands Drive		South east	From a point on the line of the north east boundary of no. 94 south westwards to a point on the line of the north kerb line of Fairview Drive
2	Fairview Drive		north	From a point on the east channel of Courtlands Drive eastwards for a distance of 16 metres.
3	Langwood Gardens (North east arm)	a	North west	From a point on the south west channel of Langley Road south westwards to a point in line with the north east kerb of the north west arm of Langwood Gardens
		b	South east	From a point on the south west channel of Langley Road south westwards for a distance of 10 metres
		c	South east	From a point on the line of the south western wall of no.1 Pinewood Close south westwards to a point on the line of the east kerb of Pinewood Close
4	Langwood Gardens (North west arm)		Both sides	For it's entire length including the entirety of the turning head
5	Maple Grove	a	North west	From a point on the line of the south west kerb of the north west arm of Langwood Gardens south westwards for it's entire length including the entirety of the turning head
		b	South east	From a point on the line of the west kerb of Pinewood Close south westwards for a distance of 10 metres.
		c	South east	From a point 34 metres west of a point on the line of the west kerb of Pinewood Close south westwards to the end.
6	Tunnel Wood Road	a	North west	From a point on the north east channel of Nascot Wood Road north eastwards for a distance of approximately 34 m metres to a point on the line of the boundary between no. 46 Nascot Wood Road and no. 9 Tunnel Wood Road.
		b	South east	From a point on the north east channel of Nascot Wood Road north eastwards for a distance of 20 m metres

		c	South east	From a point 5 metres south west of a point on the line of the south west kerb of Rufford Close north eastwards to a point 5 metres north east of a point on the line of the north east kerb of Rufford Close
--	--	---	------------	---

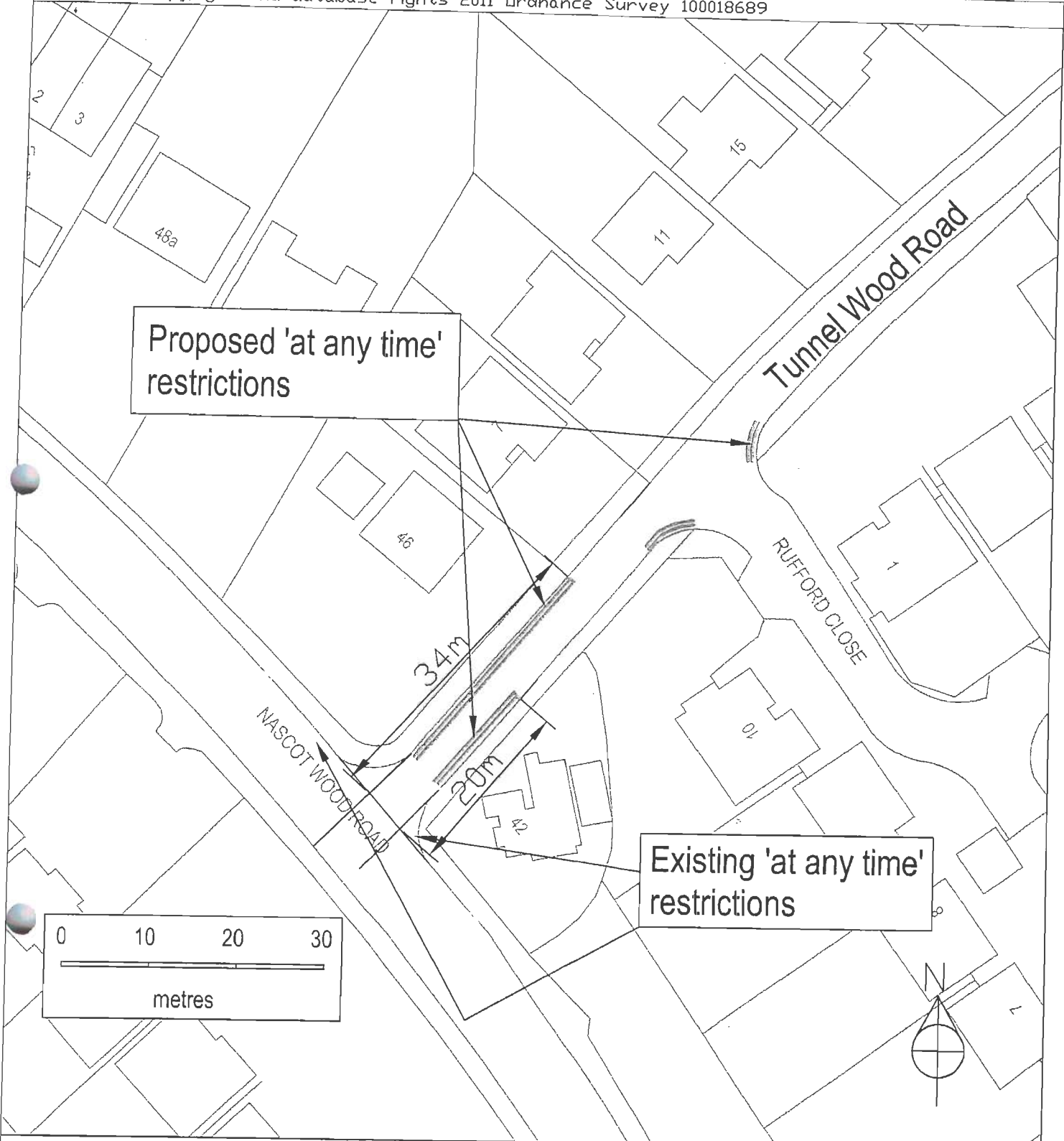

Location Nascot Wood Rd/ Tunnel Wood Rd. junction, Watford

Description Proposed 'at any time' restrictions

Date June 2012

scale:  
not to scale

**Watford Borough Council**  
Town Hall  
Watford  
Herts  
WD17 3 EX

Drawn by BS

drawing no.  
7414-C

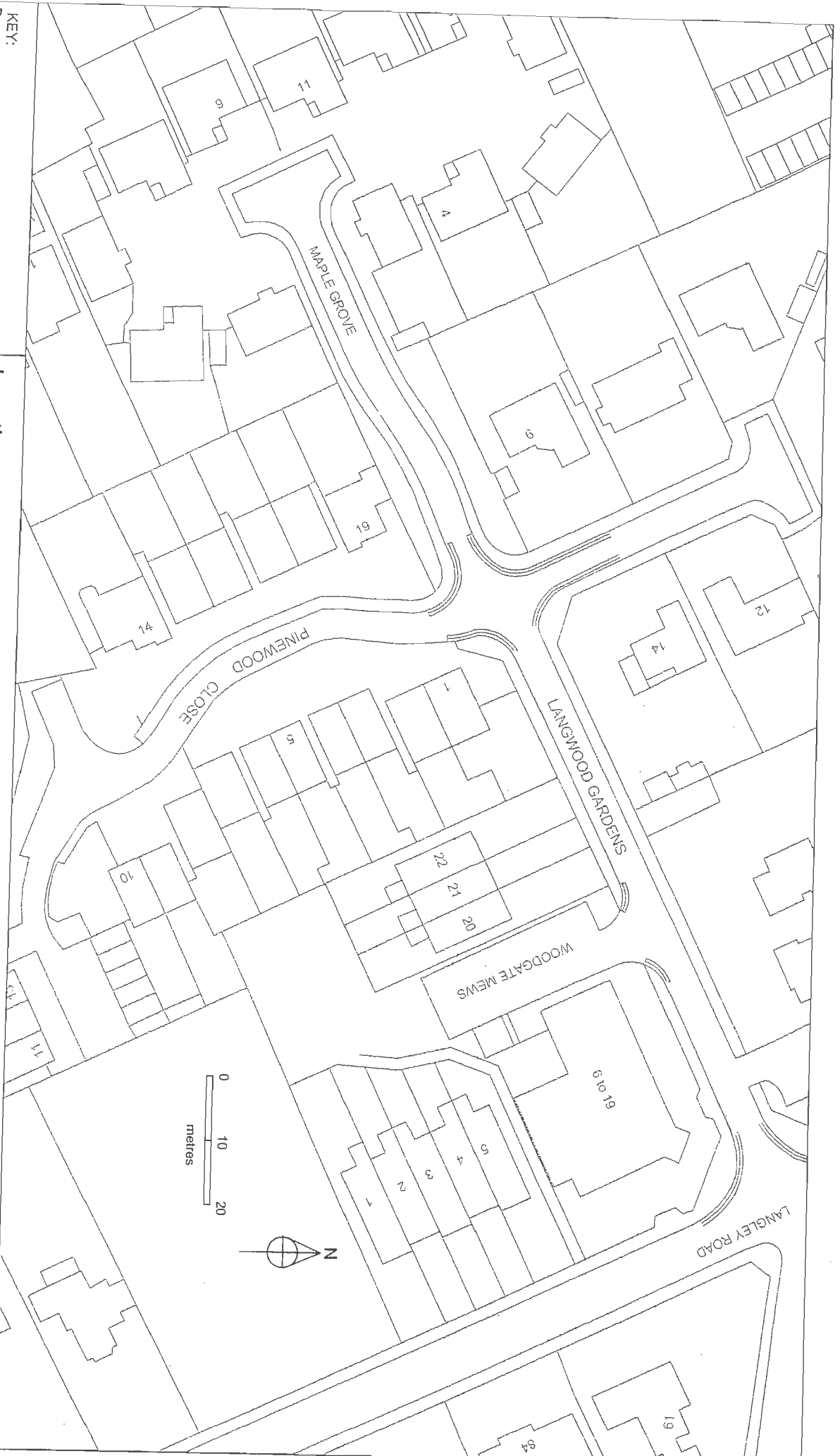

**KEY:**  
 Proposed 'At any time' restrictions  
 Proposed no parking  
 10:00am - 12:00 noon Mon - Fri  
 Proposed removal of existing  
 restrictions

EXISTING RESTRICTIONS SHOWN IN GREY

**Location:** Langwood Gardens and Maple Grove, Watford

**Description:** Proposed Parking Restrictions

**Date:** March 2012

**Drawn by:** BS

**Scale:** not to scale

**WATFORD**  
 BOROUGH COUNCIL  
 Planning  
 Town Hall  
 Watford  
 DW17 3EX

Drwg. No.  
**741-2-C**



Courtlands Drive

Existing 'at any time' restrictions

Proposed 'at any time' restrictions

no. 14 crossover

FAIRVIEW DRIVE

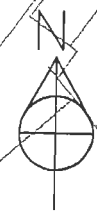
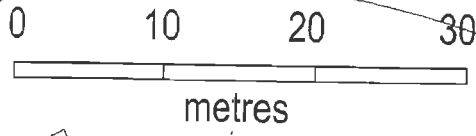

Location Courtlands Drive/ Fairview Dr. junction, Watford

Description Proposed 'at any time' restrictions

Date March 2012

scale: not to scale

Watford Borough Council  
Town Hall  
Watford  
Herts  
WD17 3 EX

Drawn by BS

drawing no. 741-3-B