

THE BOROUGH OF WARRINGTON (TRAFFIC MANAGEMENT) (CIVIL ENFORCEMENT) (AMENDMENT NO. 119)(PART 1) CONSOLIDATION ORDER 2016

The Warrington Borough Council (hereinafter referred to as "the Council"), in exercise of their powers under Sections 1, 2, 4, 32, 35 and Part IV of Schedule 9 to the Road Traffic Regulation Act 1984 (hereinafter referred to as "the Act"), and of all other enabling powers, and after consultation with the Chief Officer of Police in accordance with Part III of Schedule 9 to the Act, hereby makes the following Order: -

1. Any reference in this Order to any enactment shall be construed as a reference to that enactment as amended, applied, consolidated, re-enacted by or as having effect by virtue of any subsequent enactment.
2. The Interpretation Act 1978 shall apply to the interpretation of this Order as it applies for the interpretation of an Act of Parliament and as if for the purposes of Section 21 of that Act this Order were an Act of Parliament and the Orders revoked by this Order were Acts of Parliament thereby repealed.
3. The making of this Order by the Council is done so under the duty imposed by Section 122(1) of The Road Traffic Regulation Act 1984 to secure the expeditious, convenient and safe movement of vehicular and other traffic and the provision of suitable and adequate parking facilities on and off the Highway, insofar as practicable having regard to the matters in Section 122(2) of the said Act.
4. The Borough of Warrington (Slater Street, Grosvenor Avenue, Derby Road, Cross Street and Laira Street) (Revocation and Disabled Persons Parking Places) Order 2009 is revoked in so far as it relates to the Disabled Persons Parking Place on Derby Road.
5. The Borough of Warrington (Padgate Lane, St Mary's Street, Oxford Street, Chester Road, Warrington Road and Earl Street) (Revocation and Disabled Persons Parking Places) Order 2007 is revoked in so far as it relates to the Disabled Persons Parking Place on Padgate Lane.
6. The Borough of Warrington (Traffic Management) (Civil Enforcement) (Amendment No. 8) Consolidation Order 2009 is revoked in so far as it relates to the Disabled Persons Parking Place on Thynne Street.
7. The Borough of Warrington (Traffic Management) (Civil Enforcement) (Amendment No. 16) Consolidation Order 2010 is revoked in so far as it relates to No Waiting Between The Hours of 8.00a.m. and 8.00p.m. Monday to Saturday on Sandy Lane (North West Side and South East Side).
8. The Borough of Warrington (Traffic Management) (Civil Enforcement) (Amendment No. 32) Consolidation Order 2011, is revoked in so far as it relates to No Waiting At Any Time on Myddleton Lane (South East Side).
9. The Borough of Warrington (Traffic Management) (Civil Enforcement) (Amendment No. 52) Consolidation Order 2012 is revoked in so far as it relates to the following:-

DISABLED PERSONS PARKING PLACES

| Areas of Highway Designated as Disabled Person's Parking Places. Each area described below in this column being an area forming part of the carriageway of a specified highway, as a Designated Disabled Person's parking Place | Special Manner of Standing of Vehicle in Parking Place |
|--|---|
|--|---|

| | |
|--|----------------------|
| All that part of the south west side of Leonard Street which is bounded on the south west side by so much of the edge of the carriageway of that highway as extends from a point 76 metres north west of its junction with Battersby Lane, in a north westerly direction for a distance of 6.6 metres, all measured along the said road and which has a width throughout of 1.8 metres. | Parallel to the kerb |
|--|----------------------|

10. The Borough of Warrington (Traffic Management) (Civil Enforcement) (Amendment No. 72) Consolidation Order 2014 is revoked in so far as it relates to the No Waiting At Any Time on Thorneycroft Drive (South West Side).
11. The Borough of Warrington (Traffic Management) (Civil Enforcement) (Amendment No. 100) Consolidation Order 2015 is revoked in so far as it relates to the Disabled Persons Parking Place on Minerva Close.
12. The Borough of Warrington (Traffic Management) (Civil Enforcement) (Amendment No. 111) Consolidation order 2016 is revoked in so far as it relates to the No Stopping on School Entrance Markings, Monday to Friday 8.00a.m. to 5.00p.m. on Henshall Avenue (North Side).
13. The Borough of Warrington (Traffic Management) (Civil Enforcement) Consolidation Order 2008, is hereby further varied or amended as follows: -
 - (a) In the Thirty Seventh Schedule by the deletion of: -

BUS PARKING PLACES, ANY TIME, EVERY DAY

| Areas of Highway Designated as Parking Places. Each area described below in this column being an area forming part of the carriageway of a specified highway, is a Bus Parking Place | Special Manner of Standing of Vehicle in Parking Place |
|---|---|
| All that part of the southern kerb line of Selby Street which is bounded on the south side by so much of the edge of the carriageway of that highway as extends from its most western point of its junction with Kimberley Street for a distance of 25 metres in an easterly direction which has a width throughout of 3 metres. | Parallel to the kerb |

- (b) In the Fortieth Schedule by the deletion of:-

DISABLED PERSONS PARKING PLACES

| Areas of Highway Designated as Disabled Person's Parking Places. Each area described below in this column being an area forming part of the carriageway of a specified highway, as a Designated Disabled Person's parking Place | Special Manner of Standing of Vehicle in Parking Place |
|---|---|
| All that part of the west side of Wellfield Street which is bounded on the west by so much of the edge of the carriageway of that highway as extends from a point 19 metres north of Selby Street, in a northerly direction for a distance of 6.6 metres, all measured along the said road and which has a width throughout of 2.7 metres. | Parallel to the kerb |

(c) In the Sixth Schedule by the addition of:-

NO WAITING AT ANY TIME

Column 1

Column 2

Chapel Lane
(South West Side)

Between a point 10 metres north west and a point 10 metres south east of Perrins Road.

Ludlow Close
(Both Sides)

From its junction with Whitchurch Close, for a distance of 3 metres, in a northerly direction.

Myddleton Lane
(South East Side)

From the projected kerb line of Golborne Road, for a distance of 29 metres, in an easterly direction.

Nook Lane
(Both Sides)

From its junction with Thelwall Lane, for a distance of 10 metres, in a northerly direction.

Parkgate Road
(South East Side)

From its most northerly point, for a distance of 14 metres, in a south westerly direction.

Perrins Road
(Both Sides)

From its junction with Chapel Lane, for a distance of 10 metres, in a southerly direction.

Sandy Lane
(North West Side)

Between a point 10 metres south west and a point 10 metres north east of its junction with Arley Avenue.

South Avenue
(East Side)

Between a point 5 metres north and a point 5 metres south of its junction with Shaw's Avenue.

South Avenue
(East Side)

Between a point 5 metres north and a point 50 metres south of its junction with West Avenue.

Thelwall Lane
(North East Side)

From its junction with Nook Lane, for a distance of 10 metres, in a south easterly direction.

Thornycroft Drive
(South West Side)

From its junction with Manchester Road, following the kerb line, in a northerly direction for a distance of 75 metres.

Whitchurch Close
(Both Sides)

From the most easterly point of Whitchurch Close, for a distance of 17 metres, in a westerly direction.

(d) In the Tenth Schedule by the addition of:-

NO WAITING BETWEEN THE HOURS OF 6.00PM to 8.00AM, EVERY DAY

Column 1

Column 2

Tarporley Road
(North East Side)

From a point 30 metres south east of its junction with Fir Tree Close, for a distance of 65 metres, in a south easterly direction

(e) In the Twentieth Schedule by the addition of:-

**NO WAITING BETWEEN THE HOURS OF 8.45AM to 9.15AM
& 2.45PM to 3.30PM, MONDAY TO FRIDAY**

Column 1

Column 2

Myddleton Lane
(South East Side)

From a point 86 metres north east of its junction with Golborne Road, for a distance of 22 metres, in a north easterly direction.

Parkgate Road
(North West Side)

From its junction with Alexandra Road, for a distance of 50 metres, in a north easterly direction.

(f) In the Fortieth Schedule by the addition of:-

DISABLED PERONS PARKING PLACES

| Areas of Highway Designated as Disabled Person's Parking Places. Each area described below in this column being an area forming part of the carriageway of a specified highway, as a Designated Disabled Person's Parking Place | Special Manner of Standing Of Vehicle in Parking Place |
|--|---|
| All that part of the south west side of Arley Avenue which is bounded on the south west side by so much of the edge of the carriageway of that highway as extends from a point 60 metres north west of its junction with Sandy Lane, in a north westerly direction for a distance of 6.6 metres, all measured along the said road and which has a width throughout of 1.8 metres. | Parallel to the kerb |
| All that part of the north east side of Cartmel Avenue which is bounded on the north east side by so much of the edge of the carriageway of that highway as extends from a point 34 metres north west of its junction with Mardale Avenue, in a north westerly direction for a distance of 6.6 metres, all measured along the said road and which has a width throughout of 1.8 metres. | Parallel to the kerb |
| All that part of the south west side of Dudley Street which is bounded on the south west side by so much of the edge of the carriageway of that highway as extends from a point 45 metres north west of its junction with Orford Lane, in a north westerly direction for a distance of 6.6 metres, all measured along the said road and which has a width throughout of 1.8 metres. | Parallel to the kerb |
| All that part of the north west side of Gerrard Avenue which is bounded on the north west side by so much of the edge of the carriageway of that highway as extends from a point 18 metres north east of its junction with Dalton Avenue, in a north easterly direction for a distance of 6.6 metres, all measured along the said road and which has a width throughout of 1.8 metres. | Parallel to the kerb |
| All that part of the south side of Springfield Avenue which is bounded on the south side by so much of the edge of the carriageway of that highway as extends from a point 16 metres west of its junction with Green Lane, in a westerly direction for a distance of 6.6 metres, all measured along the said road and which has a width throughout of 1.8 metres. | Parallel to the kerb |

(g) In the Fifty Third Schedule by the addition of:-

**NO STOPPING ON SCHOOL ENTRANCE MARKINGS,
MONDAY TO FRIDAY 8.00AM to 5.00PM**

| <u>Column 1</u> | <u>Column 2</u> |
|----------------------------------|--|
| Henshall Avenue (North Side) | From a point 101 metres east of its junction with Griffiths Street, in an easterly direction for a distance of 31.56 metres. |
| Henshall Avenue (North Side) | From a point 133 metres east of its junction with Griffiths Street, in an easterly direction for a distance of 31.56 metres. |
| Myddleton Lane (South East Side) | From a point 42 metres north east of its junction with Golborne Road, for a distance of 43.56 metres, in a north easterly direction. |
| Parkgate Road | From a point 50 metres north east of its junction with Alexandra |

(North West Side) Road, in a north easterly direction for a distance of 31.56 metres.
Steel Street From a point 146 metres north east of its junction with Gorsey
(South East Side) Lane, in a north easterly direction, for a distance of 25.56 metres.

(h) In the Fifty Sixth Schedule by the addition of:-

**NO WAITING BETWEEN THE HOURS OF 8.00AM TO 8.00PM,
MONDAY TO SATURDAY**

| <u>Column 1</u> | <u>Column 2</u> |
|---------------------------------|---|
| Sandy Lane (North West Side) | From a point 18 metres north east of its junction with the A49 London Road for a distance of 22 metres in a north easterly direction. |
| Sandy Lane (South East Side) | From a point 18 metres north east of its junction with the A49 London Road for a distance of 97 metres in a north easterly direction. |

(i) In the Sixtieth Schedule by the addition of:-

WAITING LIMITED TO 2 HOURS, NO RETURN WITHIN 1 HOUR

| <u>Column 1</u> | <u>Column 2</u> |
|-------------------------------------|--|
| Tarporley Road (North East Side) | From a point 95 metres south east of its junction with Fir Tree Close, for a distance of 65 metres, in a south easterly direction. |

13. The restrictions imposed by this Order shall be in addition to and not in derogation from any restriction or requirements imposed by any regulations made or having effect as if made under the Act or by or under any other enactment.
14. This Order shall come into operation on the 22nd day of August 2016 and may be cited as "The Borough of Warrington (Traffic Management) (Civil Enforcement) (Amendment No. 119) Consolidation Order 2016".

Given under the Common Seal of the Council of the Borough of Warrington this 10th day of August 2016.

The Common Seal of **WARRINGTON BOROUGH**)
COUNCIL was hereunto affixed in the presence of: -)

Authorised Signatory



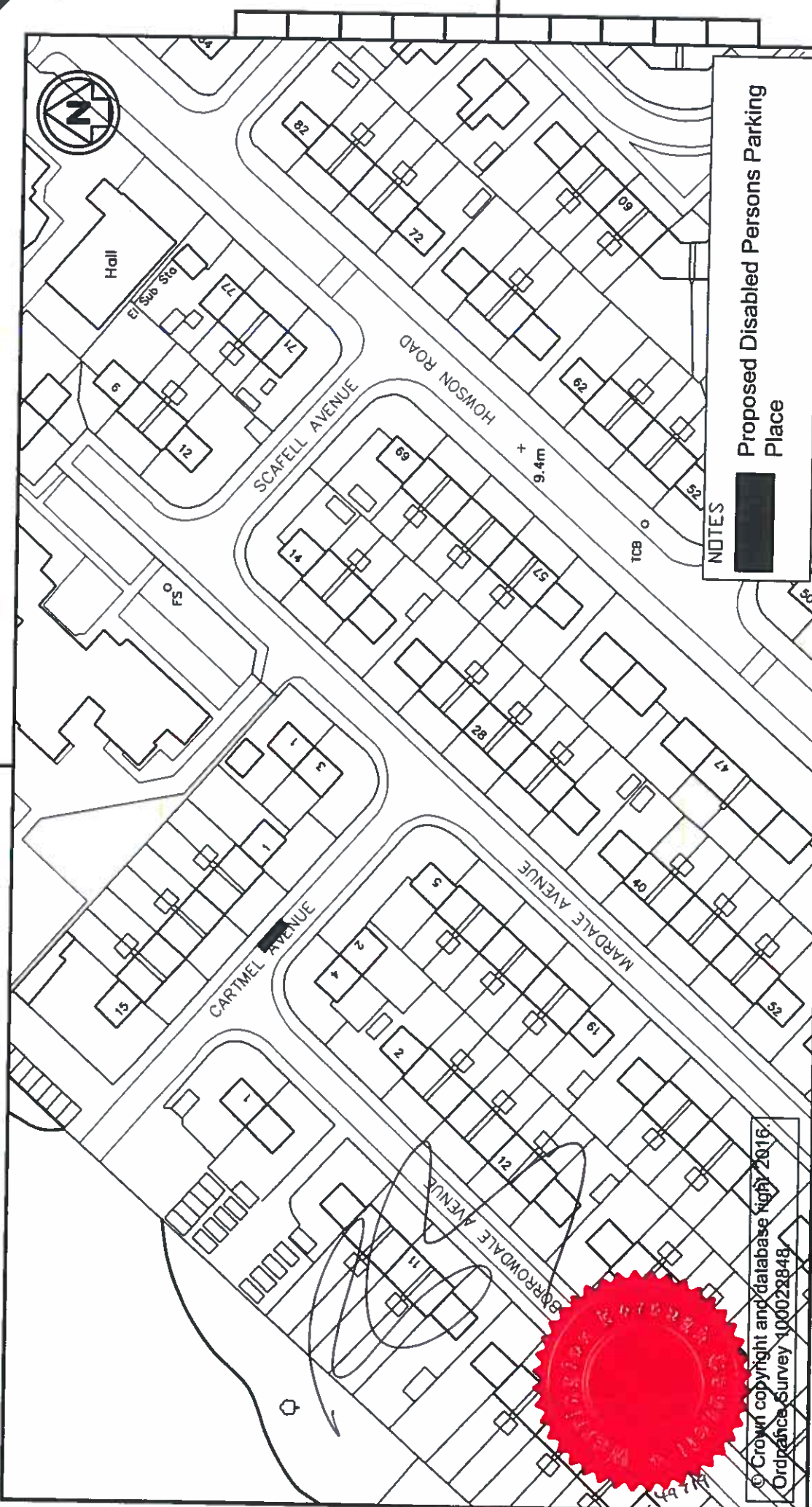

NOTES

Proposed Disabled Persons Parking Place

© Crown copyright and database right 2016.
Ordnance Survey 100028848

Project

Disabled Persons Parking Place
5 Cartmel Avenue

Drawing Title

TRO Plan

Rev.

| | | | | |
|------|------------------|-------------------|--------------------------|------------------|
| Rev. | Revision Details | Rev By | Chk by | Date: |
| | Drawn by J Evans | e-mail | jevans@warrington.gov.uk | |
| | Approved by MT | Telephone | 01925 442691 | |
| | Date | March 2016 | Fax | 01925 443255 |
| | Scale | Drawing No. | | Sheet 1 of 1 |
| | 1:1000 | ERGE/TMRS/TRO/692 | | Phase / Revision |



WARRINGTON
Borough Council

Economic Regeneration, Growth and Environment Directorate
Transport and Environment
New Town House, Buttermarket Street, Warrington WA1 2NH



NOTES

Proposed Disabled Persons Parking Place

| | | | |
|-------------------------|-------------------|---------------------------|------------------|
| Rev. / Revision Details | Rev by | Chk by | Date: |
| Drawn by J Evans | e-mail | jevans1@warrington.gov.uk | |
| Approved by MT | Telephone | 01925 442691 | |
| Date | March 2016 | Fax | 01925 443255 |
| Scales | Drawing No. | | Sheet 1 of 1 |
| 1:1000 | ERGE/TMRS/TRO/693 | | Phase / Revision |

| | |
|---------------|--|
| Project | Disabled Persons Parking Place 10 Dudley Street |
| Drawing Title | TRO Plan |

WARRINGTON Borough Council

Economic Regeneration, Growth and Environment Directorate
Transport and Environment
New Town House, Buttermarket Street, Warrington WA1 2NH

© Crown copyright and database right 2016.
Ordnance Survey, 100022848.





Proposed Disabled Persons Parking Place

NOTES

© Crown copyright and database right 2015.
Ordnance Survey 100022848.

| | | | |
|---|--|---|--|
| WARRINGTON Borough Council Economic Regeneration, Growth and Environment Directorate Transport and Environment New Town House, Buttermarket Street, Warrington WA1 2NH | | Project Disabled Persons Parking Place 44 Gerrard Avenue Drawing Title TRO Plan | |
| Revn. / Revision Details Drawn by J Evans Approved by MT Date January 2016 Scales 1:500 | Rev by J Evans e-mail jevans1@warrington.gov.uk Telephone 01925 442691 Fax 01925 443255 | Date Scales Drawing No. ERGE/TMRS/TRO/684 | Date Sheet 1 of 1 Phase / Revision |

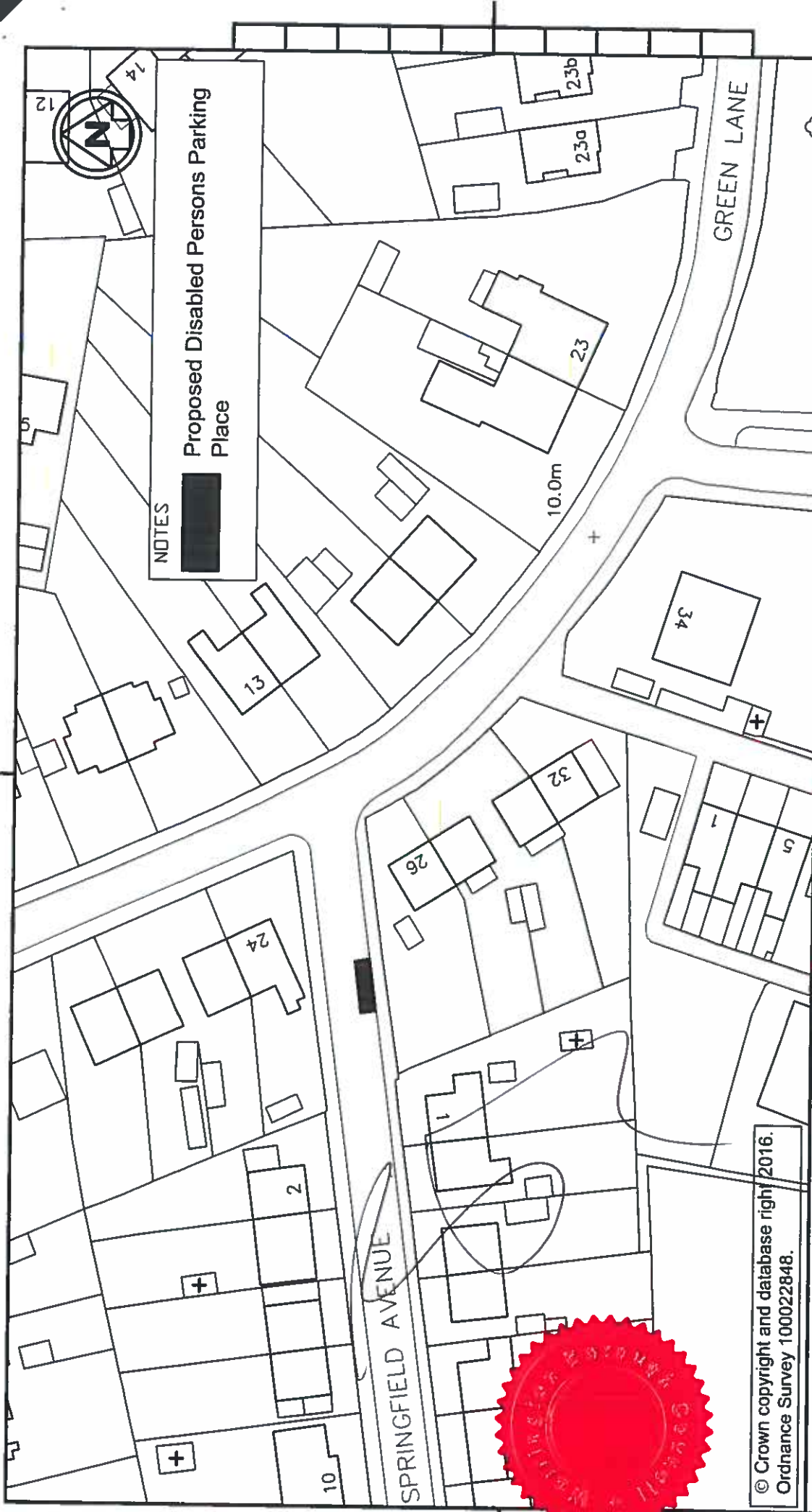

NOTES



Proposed Disabled Persons Parking Place

© Crown copyright and database right 2016.
Ordnance Survey 100022848.



WARRINGTON
Borough Council

Economic Regeneration, Growth and Environment Directorate
Transport and Environment
New Town House, Buttermarket Street, Warrington WA1 2NH

Project

Proposed Disabled Persons Parking Place
Springfield Avenue

Drawing Title

TRO Plan

| | | | | |
|-------------|------------------|-----------|---------------------------|--------------|
| Revn. | Revision Details | Rev by | Chk by | Date: |
| Drawn by | J Evans | e-mail | jevans1@warrington.gov.uk | |
| Approved by | MT | Telephone | 01925 442691 | |
| Date | May 2016 | Fax | 01925 443255 | Sheet 1 of 1 |

Scales

Drawing No.

ERGE/TMRS/TRO/705

Phase / Revision

4779



Notes
 = Proposed School Keep Clear Markings

© Crown copyright and database right 2015.
 Ordnance Survey 100022848

| | | | | | | | |
|--|--|--|--|------------------------------------|-----------|------------------|--------------------------|
| | | | | Drawn by | TC | e-mail | tcowie@warrington.gov.uk |
| | | | | Approved by | MT/MMCh | Telephone | 01925 443248 |
| | | | | Date | July 2015 | Fax | 01925 443324 |
| | | | | Sheet 1 of 1 | | | |
| | | | | Project | | | |
| | | | | School Parking Programme | | | |
| | | | | St Augustines CP School, Latchford | | | |
| | | | | Drawing Title | | | |
| | | | | TRO Plan | | | |
| | | | | Scales | | Drawing No. | |
| | | | | NTS | | Phase / Revision | |
| | | | | | | A | |



Economic Regeneration, Growth and Environment Directorate
 Transport and Environment
 New Town House, Buttermarket Street, Warrington WA1 2NH

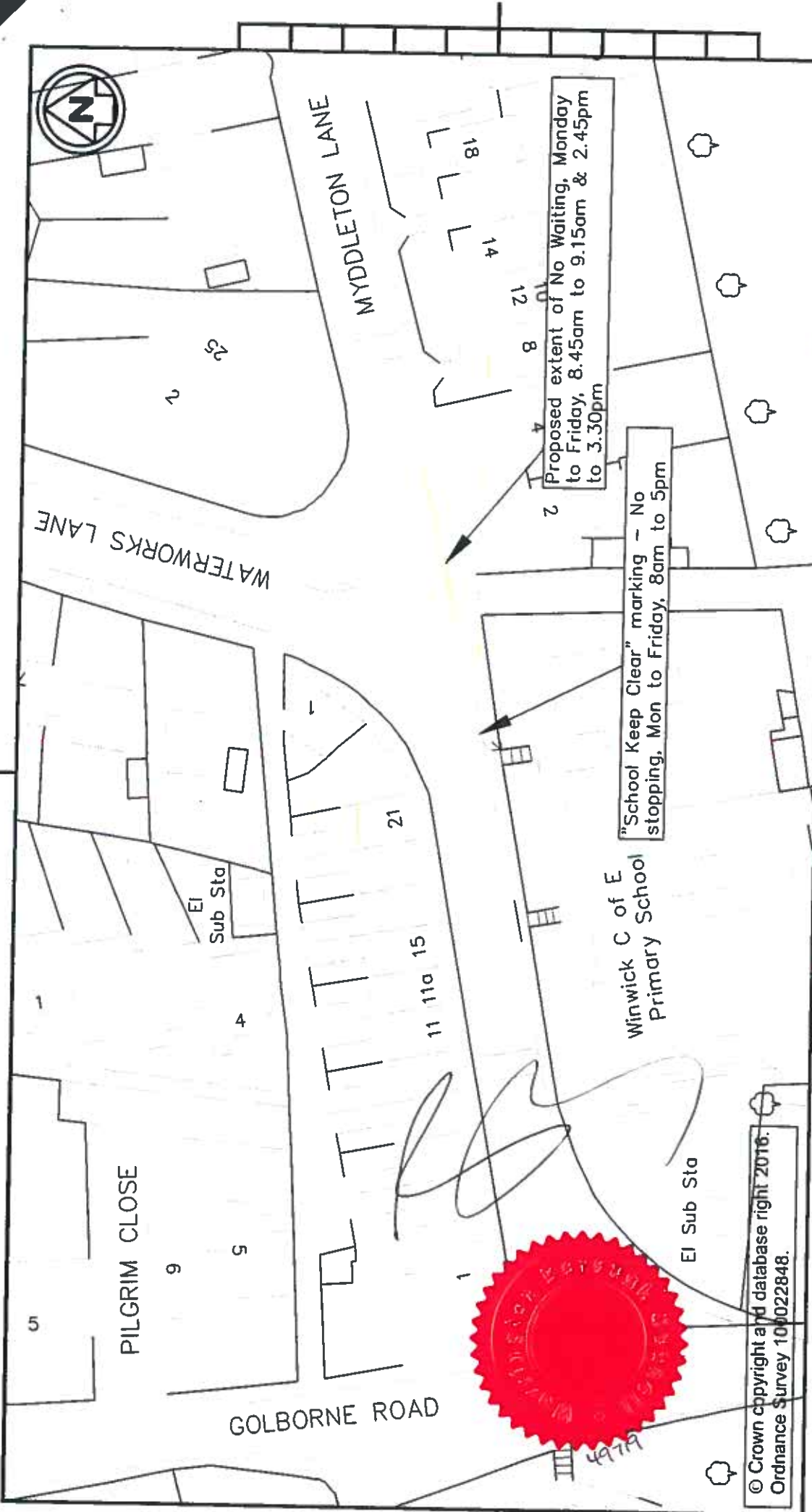

© Crown copyright and database right 2016.
Ordnance Survey 100022848.

WARRINGTON
Borough Council

Economic Regeneration, Growth and Environment Directorate
Transport and Environment
New Town House, Buttermarket Street, Warrington WA1 2NH

Project

Proposed Waiting Restrictions
Myddleton Lane, Winwick

Drawing Title

TRO Plan

| | | | | |
|-------------|------------------|-------------|---------------------------|------------------|
| Revn. | Revision Details | Rev by | Chk by | Date: |
| Drawn by | J Evans | e-mail | jevans1@warrington.gov.uk | |
| Approved by | MT | Telephone | 01925 442691 | |
| Date | May 2016 | Fax | 01925 443255 | Sheet 1 of 1 |
| Scales | NTS | Drawing No. | ERGE/TMRS/TRO/706 | Phase / Revision |



ST THOMAS'S C of E
PRIMARY SCHOOL

PARKGATE ROAD

Scout HQ

EI
SUB Sta

16

14

Parksway





Loronda

ALEXANDRA ROAD



© Crown copyright and database right 2016.
Ordnance Survey 100022848.

KEY

-  Proposed No Waiting at Any Time
-  Proposed No Stopping, Monday to Friday, 8am to 5pm
-  Proposed No Waiting Monday to Friday, 8.45am - 9.15am & 2.45pm - 3.30pm.
-  Proposed Access Protection Marking ('H' Bar).

| | | | | | |
|--|--|--|--|---|--|
| Project St Thomas's Primary School Proposed Traffic Management Measures | | Revn. / Revision Details Drawn by J Evans Approved by MT Date April 2016 Scales NTS | | Rev by / Chk by / Date: jevens1@warrington.gov.uk Telephone 01925 442691 Fax 01925 443255 Sheet 1 of 1 Phase / Revision | |
| Drawing Title TRO Plan | | Drawing No. ERGE/TMRS/TRO/702 | | | |
| WARRINGTON Borough Council Economic Regeneration, Growth and Environment Directorate Transport and Environment New Town House, Buttermarket Street, Warrington WA1 2NH | | AutoCAD File Ref: St Thomas's Primary.dwg | | | |

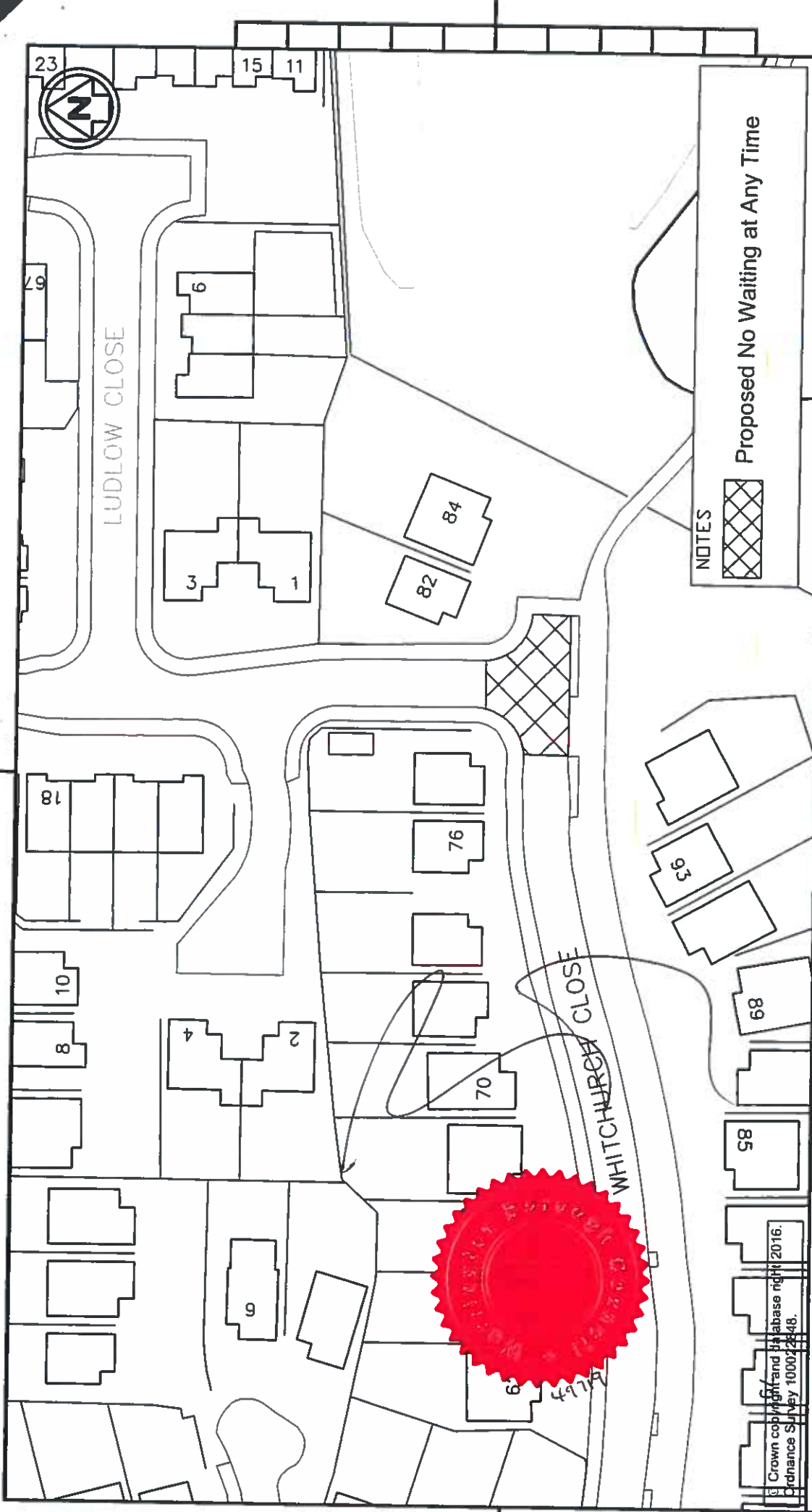

NOTES



Proposed No Waiting at Any Time

Project

Proposed Waiting Restrictions
Whitchurch Close / Ludlow Close



WARRINGTON
Borough Council

Economic Regeneration, Growth and Environment Directorate
Transport and Environment
New Town House, Buttermarket Street, Warrington WA1 2NH

Drawing Title

TRO Plan

| | | | |
|--------------------------|-----------|---------------------------|-------------------|
| Revn. / Revision Details | Rev by | Chk by | Date: |
| Drawn by J Evans | e-mail | jevans1@warrington.gov.uk | |
| Approved by MT | Telephone | 01925 442691 | |
| Date | May 2016 | Fax | 01925 443255 |
| Scales | | Drawing No. | ERGE/TMRS/TRO/708 |
| NTS | | Sheet | 1 of 1 |
| | | Phase / Revision | |

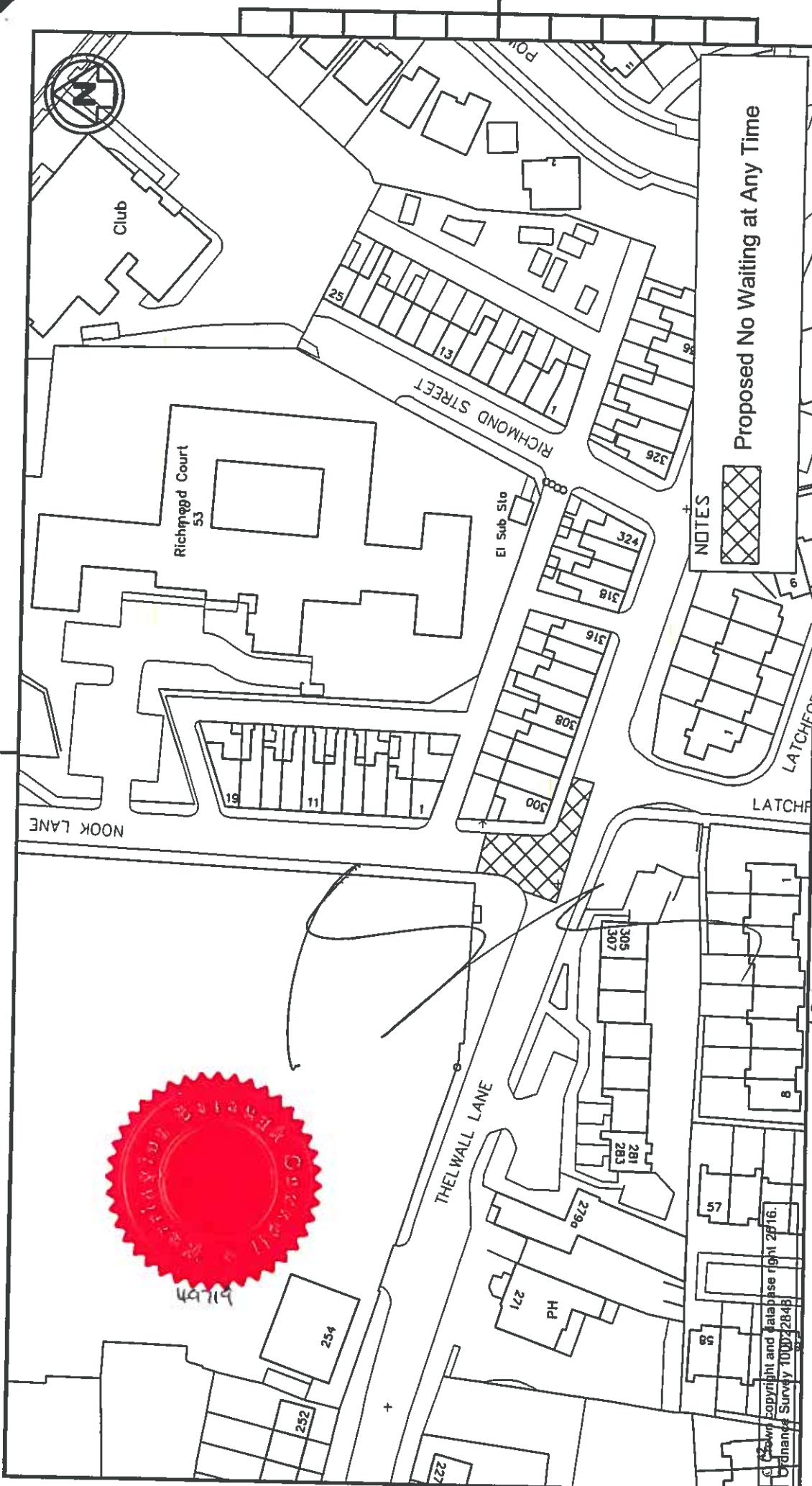

Proposed No Waiting at Any Time

NOTES

| | | | | |
|-------------|-------------------|-----------|---------------------------|-------|
| Revn. | Revision Details | Rev by | Chk by | Date: |
| Drawn by | J Evans | e-mail | jevans1@warrington.gov.uk | |
| Approved by | MT | Telephone | 01925 442691 | |
| Date | May 2016 | Fax | 01925 443255 | |
| Scales | Drawing No. | | Sheet 1 of 1 | |
| 1:1000 | ERGE/TMRS/TRO/707 | | Phase / Revision | |

Proposed Waiting Restrictions
Nook Lane / Thelwall Lane

Drawing Title
TRO Plan

Project

WARRINGTON
 Borough Council

Economic Regeneration, Growth and Environment Directorate
 Transport and Environment
 New Town House, Buttermarket Street, Warrington WA1 2NH



| | | | | | | | | | |
|---|--|---|--|---|--|---|--|----------------------------------|--|
| WARRINGTON Borough Council Economic Regeneration, Growth and Environment Directorate Transport and Environment New Town House, Buttermarket Street, Warrington WA1 2NH | | Project Proposed Double Yellow Lines Sandy Lane, Stockton Heath Drawing Title TRO Plan | | Revn. Revision Details Drawn by J Evans Approved by MT Date August 2015 Scales 1:1000 | | Rev by Chk by Date: jevens1@warrington.gov.uk Telephone 01925 442691 Fax 01925 443255 Drawing No. ERGE/TMRS/TRO/700 | | Sheet 1 of 1 Phase / Revision | |
|---|--|---|--|---|--|---|--|----------------------------------|--|

© Crown copyright and database right 2015.
 Ordnance Survey 100022848

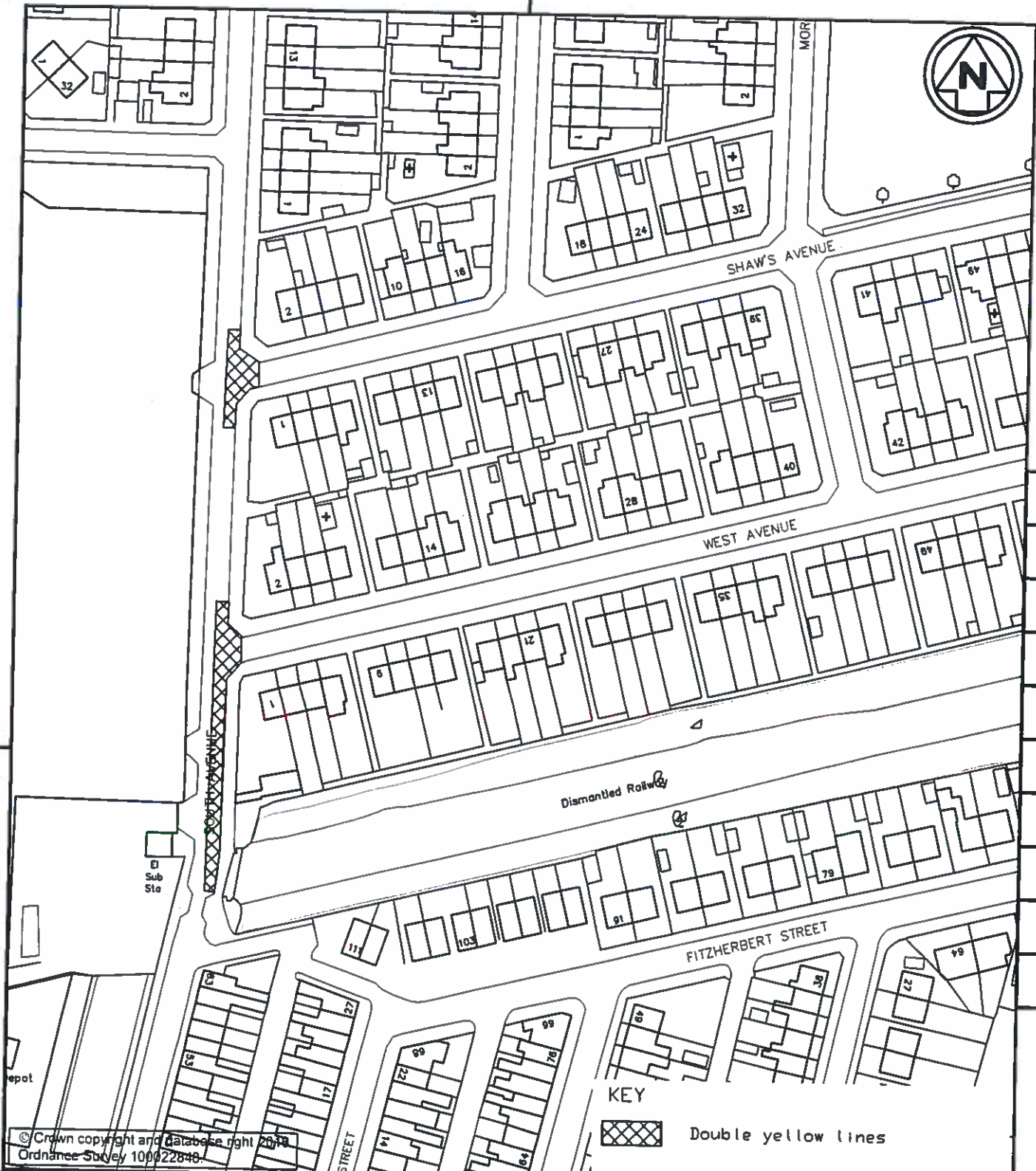

© Crown copyright and database right 2018
 Ordnance Survey 100022848

| Rev. | Revision Details | Rev by | Chk by | Date: |
|------|------------------|--------|--------|-------|
| | | | | |

| | | | |
|---------------|---------------------------------|------------------|---------------------------|
| Drawn by | J Evans | e-mail | jevans1@warrington.gov.uk |
| Approved by | MT | Telephone | 01925 44255 |
| Date | May 2016 | Fax | 01925 44255 |
| Project | Hale Street, Orford | | |
| Drawing Title | Proposed No Waiting at Any Time | | |
| | TRO Plan | | |
| | 4979 | | |
| Scales | 1:1000 | Drawing No. | ERGE/TMRS/TRO/709 |
| | | Phase / Revision | |



WARRINGTON 
 Borough Council

Economic Regeneration, Growth and Environment Directorate
 Transport and Environment
 New Town House, Buttermarket Street, Warrington WA1 2NH





KEY

-  Proposed extension to No Waiting at Any Time
-  Existing No Waiting at Any Time (to remain)

| | | | |
|------------------|--|----------------------------------|--|
| Project | | Thorneycroft Drive | |
| Drawing Title | | Proposed Waiting Restrictions | |
| Drawing No. | | ERGE/TMRS/TRO/696 | |
| Scales | | 1:1000 | |
| Date | | April 2016 | |
| Approved by MT | | Telephone 01925 442691 | |
| Drawn by J Evans | | e-mail jevans1@warrington.gov.uk | |
| Rev by | | Date: | |
| Telephone | | Fax 01925 443255 | |
| Sheet | | 1 of 1 | |
| Phase / Revision | | | |

© Crown copyright and database right 2016.
 Ordnance Survey 100022848.

WARRINGTON
 Borough Council

Economic Regeneration, Growth and Environment Directorate
 Transport and Environment
 New Town House, Buttermarket Street, Warrington WA1 2NH

AutocAD File Ref: Thorneycroft Drive.dwg



Handwritten signature or initials.

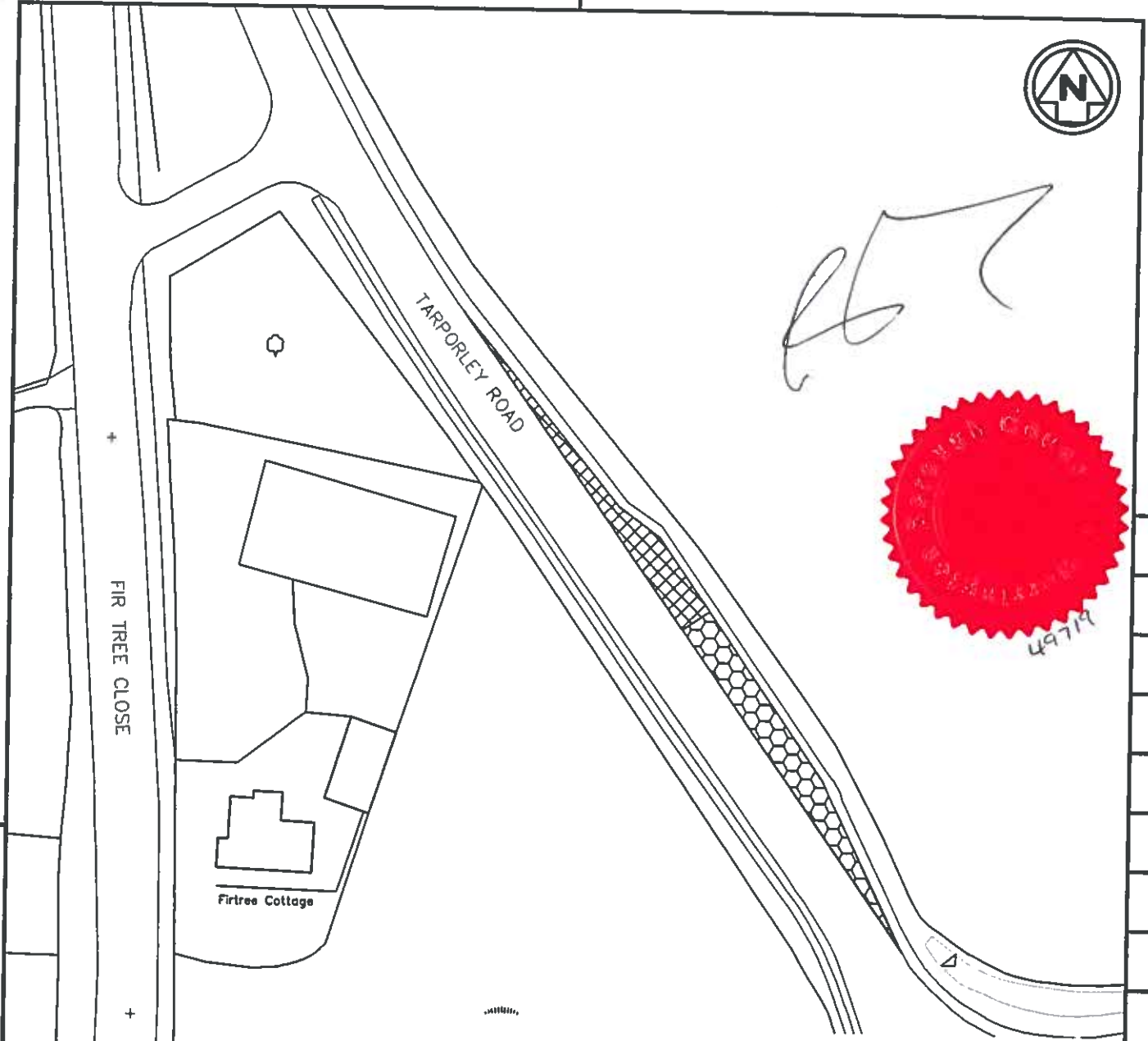

KEY



Proposed Limited Waiting Bay - 2 hours maximum, no return within 1 hour



Proposed No Waiting 6pm to 8am

© Crown copyright and database right 2016. Ordnance Survey 100022848.

| | | | | | | | | |
|--|--|--|--|---|------------|-------------------|---------------------------|------------------|
| | | | | Drawn by | J Evans | e-mail | jevans1@warrington.gov.uk | |
| | | | | Approved by | MT | Telephone | 01925 442691 | |
| | | | | Date | March 2016 | Fax | 01925 443255 | Sheet 1 of 1 |
| | | | | Project | | | | |
| | | | | Tarporley Road, Stretton | | | | |
| | | | | Limited Waiting Bays & Waiting Restrictions | | | | |
| | | | | Drawing Title | | | | |
| | | | | Proposed TRO Plan | | | | |
| | | | | Scales | | Drawing No. | | Phase / Revision |
| | | | | 1:1000 | | ERGE/TMRS/TRO/704 | | |

| Revn. | Revision Details | Rev by | Chk by | Date: |
|-------|------------------|--------|--------|-------|
| | | | | |

WARRINGTON
Borough Council

Economic Regeneration, Growth and Environment Directorate
Transport and Environment
New Town House, Buttermarket Street, Warrington WA1 2NH

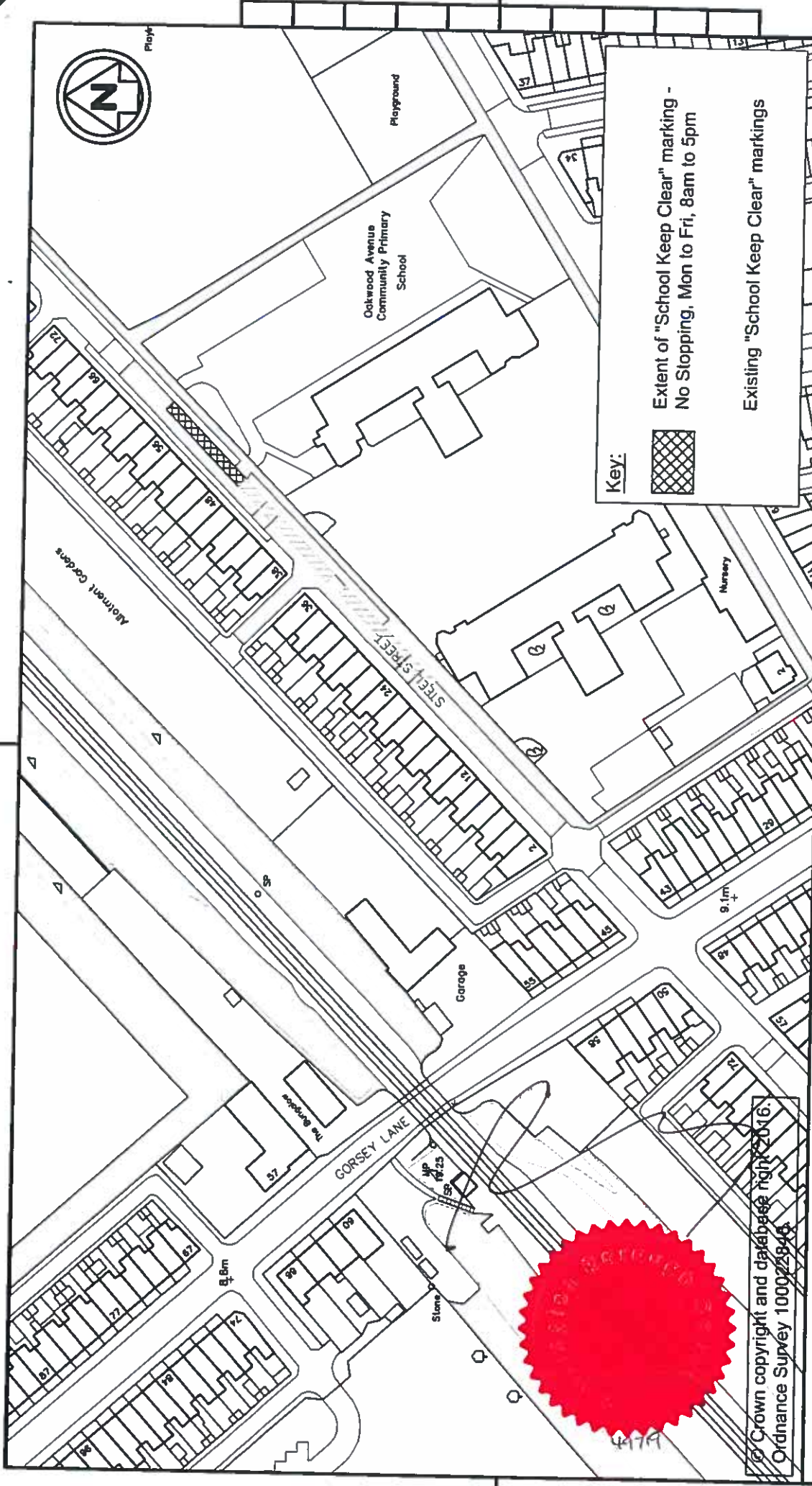

Key:

 Extent of "School Keep Clear" marking - No Stopping, Mon to Fri, 8am to 5pm

 Existing "School Keep Clear" markings

© Crown copyright and database right 2016.
Ordnance Survey 100022845

WARRINGTON
Borough Council

Economic Regeneration, Growth and Environment Directorate
Transport and Environment
New Town House, Buttermarket Street, Warrington WA1 2NH

Project
**Proposed "School Keep Clear" Marking
Steel Street**

Drawing Title
TRO Plan

Revn. Revision Details
Drawn by J Evans
Approved by MT
Date April 2016
Scales
NTS

Rev by Cnk by Date:
jevans1@warrington.gov.uk
01925 442691
01925 443255
Drawing No.
ERGE/TMRS/TRO/703

Sheet 1 of 1
Phase / Revision