

**THE BOROUGH OF WARRINGTON (WAITING RESTRICTIONS, LOADING  
RESTRICTIONS AND STREET PARKING PLACES) (AMENDMENT NO. 1)  
CONSOLIDATION ORDER 2007**

The Warrington Borough Council (hereinafter referred to as "the Council"), in exercise of their powers under Sections 1, 2, 4, 32, 35 and Part IV of Schedule 9 to the Road Traffic Regulation Act 1984 (hereinafter referred to as "the Act"), and by virtue of the Road Traffic (Permitted Parking Area and Special Parking Area) (Borough of Warrington) Order 2006 (Statutory Instrument No. 3421 2006), and of all other enabling powers, and after consultation with the Chief Officer of Police in accordance with Part III of Schedule 9 to the Act, hereby makes amendments to The Borough of Warrington (Waiting Restrictions, Loading Restrictions and Street Parking Places) Consolidation order 2006 as follows:-

1. The Orders specified in Schedule 1 to this Order are hereby revoked in their entirety.
2. The Order specified in Schedule 2 to this Order is hereby varied as detailed in the said Schedule 2 to this Order.
3. The addition of Schedules 43, 44, 45 and 46 as detailed thereto.
4. The restrictions imposed by this Order shall be in addition to and not in derogation from any restriction or requirements imposed by any regulations made or having effect as if made under the Act or by or under any other enactment.
5. This Order shall come into operation on the 21<sup>st</sup> day of December 2007 and may be cited as "The Borough of Warrington (Waiting Restrictions, Loading Restrictions and Street Parking Places) (Amendment No. 1) Consolidation Order 2007".

**SCHEDULE 1**  
**Revocations**

The Borough of Warrington (Windermere Avenue, Grasmere Avenue, Forshaw Street and Wellfield Street)(Revocation and Disabled Persons Parking Places) Order 2007

The Borough of Warrington (Fir Tree Close and Access Road)(Prohibition of Waiting) Order 2003

The Borough of Warrington (Sankey Way/Liverpool Road, Great Sankey)(Prohibition of Waiting and Bus Stops)(Clearways) Order 1978

The Borough of Warrington (Tesco/Stadium Residents Parking Scheme) (Amendment No. 1) Order 2007

**SCHEDULE 2**  
**Variations**

The Borough of Warrington (Waiting Restrictions, Loading Restrictions and Street Parking Places) Consolidation Order 2006, is hereby further varied as follows: -

- (a) In the Sixth Schedule by the deletion of: -

Dalton Bank (South East Side)	From the gable end of No. 9 Dalton Bank for a distance of 37.7 metres in a south westerly direction.
----------------------------------	--



Dalton Bank (North West Side)	From a point 4.8 metres south west of the gable end of No. 2 Dalton Bank for a distance of 8.1 metres in a south westerly direction.
Eustace Street (North East Side)	From its junction with Walker Street for a distance of 13 metres in a south easterly direction.
Eustace Street (North East Side)	Between a point 23 metres south east of its junction with Walker Street and a point 28 metres south east of its junction with Walker Street.
Eustace Street (North East Side)	From its junction with Arthur Street for a distance of 14 metres in a north westerly direction.
Eustace Street (South West Side)	From its junction with Arthur Street for a distance of 20 metres in a north westerly direction.
Eustace Street (South West Side)	Between a point 28 metres north west of its junction with Arthur Street and a point 35 metres north west of its junction with Arthur Street.
Eustace Street (South West Side)	Between a point 43 metres north west of its junction with Arthur Street and a point 49.5 metres north west of its junction with Arthur Street.
Eustace Street (South West Side)	Between a point 57 metres north west of its junction with Arthur Street and a point 63.5 metres north west of its junction with Arthur Street.
Eustace Street (South West Side)	Between a point 71 metres north west of its junction with Arthur Street and its junction with Dalewood Close.

(b) In the Sixth Schedule by the addition of: -

Eustace Street (North East Side)	From its junction with Walker Street for a distance of 4.5 metres in a south easterly direction.
Eustace Street (North East Side)	From a point 9.2 metres south east of its junction with Walker Street to a point 13.8 metres south east of its junction with Walker Street.
Eustace Street (North East Side)	From a point 24.1 metres south east of its junction with Walker Street and a point 29.1 metres south east of its junction with Walker Street.
Eustace Street (North East Side)	From its junction with Arthur Street in a north westerly direction to a point 42.3 metres south east of its junction with Walker Street.
Eustace Street (South West Side)	From its junction with Arthur Street for a distance of 5.8 metres in a north westerly direction.
Eustace Street (South West Side)	From a point 14.1 metres north west of its junction with Arthur Street to a point 21 metres north west of its junction with Arthur Street.
Eustace Street (South West Side)	From a point 27.5 metres north west of its junction with Arthur Street to a point 36.8 metres north west of its junction with Arthur Street.
Eustace Street (South West Side)	From a point 42.4 metres north west of its junction with Arthur Street to a point 50.5 metres north west of its junction with Arthur Street.



Eustace Street (South West Side)	From a point 59.3 metres north west of its junction with Arthur Street to a point 65.8 metres north west of its junction with Arthur Street.
Eustace Street (South West Side)	From a point 74.1 metres north west of its junction with Arthur Street to its junction with Dalewood Close.
Kelvin Close (Northern Arm)	From its junction with Birchwood Park Avenue, in a north easterly direction for a distance of 64 metres.
Kelvin Close (Eastern Arm)	From its junction with Kelvin Close, in a north easterly direction, for a distance of 162 metres.
St Peters Way (The cul-de-sac section fronting the properties numbered 1-17 St Peters Way) (North West Side)	From its junction with St Peters Way in a north easterly direction for a distance of 41.5 metres.

(c) In the Sixteenth Schedule by the addition of: -

Town Hall West Drive For its entire length

Town Hall East Drive For its entire length

Town Hall South Drive For its entire length

(d) In the Thirty Fifth Schedule by the deletion of: -

<b>Areas of Highway designated as Parking Places, each area described below in this column being an area forming part of the carriageway of a specified highway, is a Resident Permit Holder Only Parking Place.</b>	<b>Special Manner of Standing of Vehicles in Parking Place</b>	<b>Maximum Number of Parking Places</b>
All that part of the north eastern kerbline of <b>Eustace Street</b> which is bounded on the north east side by so much of the highway as extends from a point 14 metres north west of its junction with Arthur Street for a distance of 13 metres in a north westerly direction.	Parallel to the kerb	2
All that part of the north eastern kerbline of <b>Eustace Street</b> which is bounded on the north east side by so much of the highway as extends from a point 13 metres south east of its junction with Walker Street for a distance of 10 metres in a south easterly direction.	Parallel to the kerb	2
All that part of the south western kerbline of <b>Eustace Street</b> which is bounded on the south west side by so much of the highway as extends from a point 20 metres north west of its junction with Arthur Street for a distance of 8 metres in a north westerly direction.	Parallel to the kerb	1



All that part of the south western kerbline of <b>Eustace Street</b> which is bounded on the south west side by so much of the highway as extends from a point 35 metres north west of its junction with Arthur Street for a distance of 8 metres in a north westerly direction.	Parallel to the kerb	1
All that part of the south western kerbline of <b>Eustace Street</b> which is bounded on the south west side by so much of the highway as extends from a point 49.5 metres north west of its junction with Arthur Street for a distance of 7.5 metres in a north westerly direction.	Parallel to the kerb	1
All that part of the south western kerbline of <b>Eustace Street</b> which is bounded on the south west side by so much of the highway as extends from a point 63.5 metres north west of its junction with Arthur Street for a distance of 7.5 metres in a north westerly direction.	Parallel to the kerb	1

(e) In the Thirty Fifth Schedule by the addition of: -

<b>Areas of Highway designated as Parking Places, each area described below in this column being an area forming part of the carriageway of a specified highway, is a Resident Permit Holder Only Parking Place.</b>	<b>Special Manner of Standing of Vehicles in Parking Place</b>	<b>Maximum Number of Parking Places</b>
All that part of the north eastern kerbline of <b>Eustace Street</b> which is bounded on the north east side by so much of the highway as extends from a point 4.5 metres south east of its junction with Walker Street for a distance of 4.7 metres in a south easterly direction.	Parallel to the kerb	1
All that part of the north eastern kerbline of <b>Eustace Street</b> which is bounded on the north east side by so much of the highway as extends from a point 13.8 metres south east of its junction with Walker Street for a distance of 10.3 metres in a south easterly direction.	Parallel to the kerb	2
All that part of the north eastern kerbline of <b>Eustace Street</b> which is bounded on the north east side by so much of the highway as extends from a point 14 metres north west of its junction Arthur Street in a north westerly direction to a point 42.3 metres south west of its junction with Walker Street.	Parallel to the kerb	2
All that part of the south western kerbline of <b>Eustace Street</b> which is bounded on the south west side by so much of the highway as extends from a point 5.8 metres north west of its junction with Arthur Street for a distance of 8.3 metres in a north westerly direction.	Parallel to the kerb	1
All that part of the south western kerbline of <b>Eustace Street</b> which is bounded on the south west side by so much of the highway as extends from a point 21 metres north west of its junction with Arthur Street for a distance of 6.5 metres in a north westerly direction.	Parallel to the kerb	1
All that part of the south western kerbline of <b>Eustace Street</b> which is bounded on the south west side by so much of the highway as extends from a point 36.8 metres north west of its junction with Arthur Street for a distance of 5.6 metres in a north westerly direction.	Parallel to the kerb	1



All that part of the south western kerbline of <b>Eustace Street</b> which is bounded on the south west side by so much of the highway as extends from a point 50.5 metres north west of its junction with Arthur Street for a distance of 8.8 metres in a north westerly direction.	Parallel to the kerb	1
All that part of the south western kerbline of <b>Eustace Street</b> which is bounded on the south west side by so much of the highway as extends from a point 65.8 metres north west of its junction with Arthur Street for a distance of 8.3 metres in a north westerly direction.	Parallel to the kerb	1

(f) In the Fortieth Schedule by the addition of: -

<b>Column 1</b> <b>Areas of Highway Designated as Disabled Persons' Parking Places. Each Area described below in this column being an area forming part of the carriageway of a specific highway, as a designated Disabled Persons' Parking Place</b>	<b>Column 2</b> <b>Special Manner of Standing of Vehicle in Parking Place</b>
All that part of the north east side of <b>Windermere Avenue</b> which is bounded on the north east side by so much of the edge of the carriageway of that highway as extends from a point 13 metres north west of the entrance to the parking area adjacent to 73 Windermere Avenue in a north westerly direction for a distance of 6.6 metres, all measured along the said road and which has a width of 2.7 metres	Parallel to the kerb
All that part of the south west side of <b>Grasmere Avenue</b> which is bounded on the south west side by so much of the edge of the carriageway of that highway as extends from a point 39 metres south east of Grasmere Avenue in a southerly direction for a distance of 6.6 metres, all measured along the said road and which has a width of 2.7 metres	Parallel to the kerb

### **ADDITIONAL SCHEDULES**

(g) By the addition of a Forty Third Schedule and the following entry thereunder: -

#### **NO LOADING AND UNLOADING BETWEEN THE HOURS OF 9.00AM – 6.00PM**

Sankey Street      From its junction with Town Hall East Drive for a  
(North Side)      distance of 20 metres in a westerly direction.

(h) By the addition of a Forty Fourth Schedule and the following entry thereunder: -

#### **WAITING LIMITED TO 2 MINUTES, NO RETURN WITHIN 20 MINUTES**

Dickenson Street      From its point of closure adjacent to Orford Lane for a distance of 20  
(South West Side)      metres in a south easterly direction.



- (i) By the addition of a Forty Fifth Schedule and the following entry thereunder: -

**LOADING AND UNLOADING ONLY BAYS BETWEEN 8:00AM – 6:00PM**

<b>Column 1</b> <b>Part of road authorised to be used as a parking place for vehicles loading and unloading</b>	<b>Column 2</b> <b>Position in which vehicles may wait</b>
All that part of the east kerbline of <b>Erwood Street</b> which is bounded on the east by so much of that highway as extends from a point 28.5 metres south east of its junction with Buckley Street for a distance of 10 metres in a south easterly direction and which has a width throughout of 2.7 metres.	Wholly within the limits of the loading bay and parallel to the kerb.

- (j) By the addition of a Forty Sixth Schedule and the following entry thereunder: -

**MOTORCYCLE PARKING PLACE**

<b>Column 1</b> <b>Part of road authorised to be used as a parking place for Motorcycles</b>	<b>Column 2</b> <b>Position in which vehicles may wait</b>
All that part of the east kerbline of <b>Crown Street</b> which is bounded on the east by so much of that highway as extends from the northern kerbline of Crown Street to the southern kerbline of Crown Street and which has a width throughout of 4 metres.	At 90° to the kerb.

Given under the Common Seal of the Council of the Borough of Warrington this 17<sup>th</sup> day of December 2007.

The Common Seal of **WARRINGTON** )  
**BOROUGH COUNCIL** was hereunto )  
affixed in the presence of:- )

*C. Cavanagh*  
Authorised Signatory





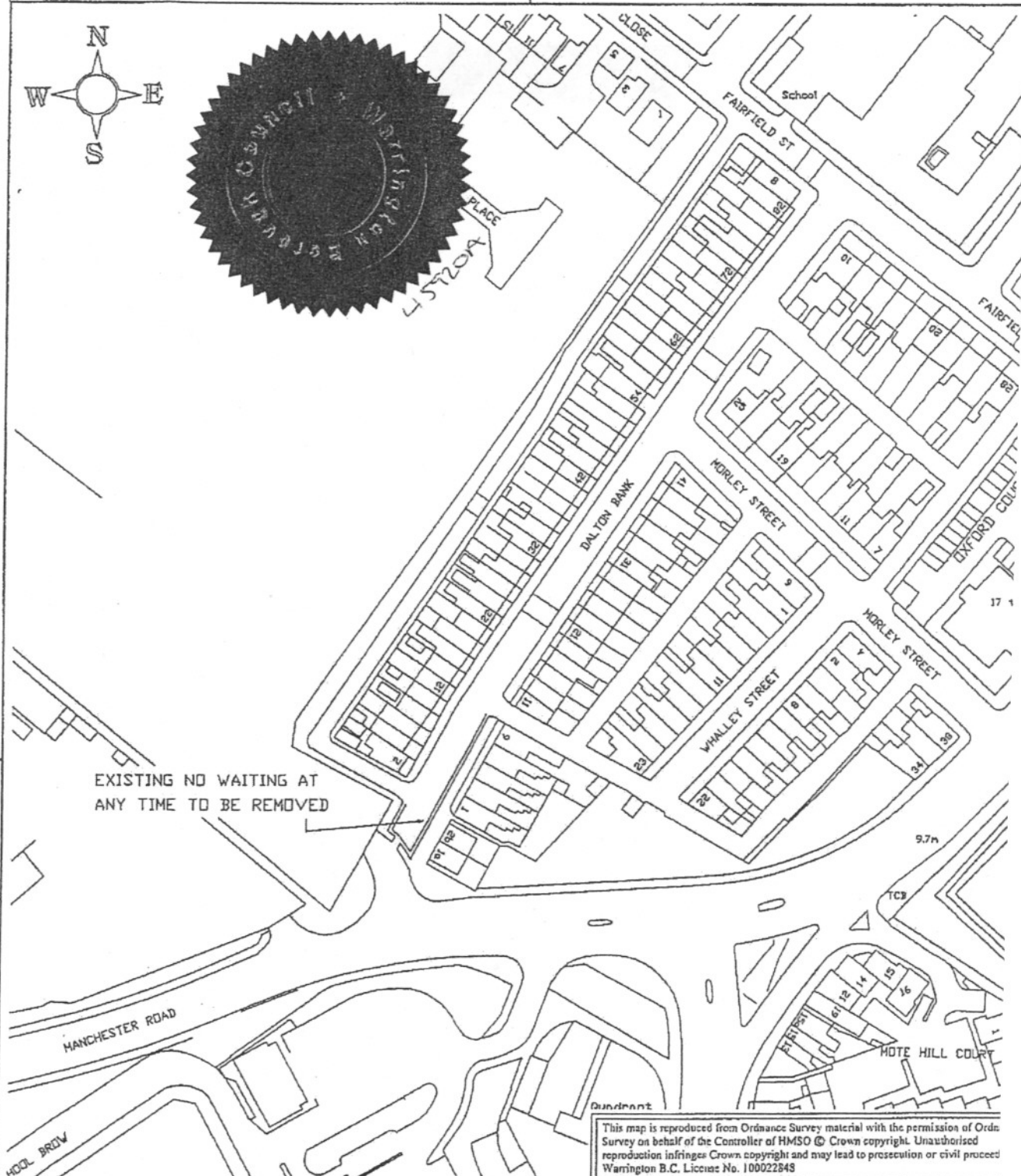
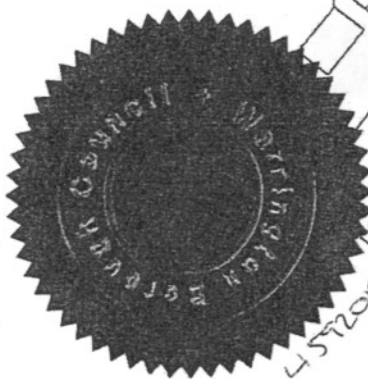
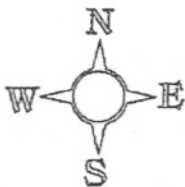

This map is reproduced from Ordnance Survey material with the permission of Ordnance Survey on behalf of the Controller of HMSO © Crown copyright. Unauthorised reproduction infringes Crown copyright and may lead to prosecution or civil proceedings Warrington B.C. Licence No. 100022848

Executed as a Deed by affixing the Common Seal of Warrington Borough Council in the presence of:

*C. C. C. C.*  
Authorised Signatory



## ENVIRONMENT SERVICES DIRECTORATE

Palmyra House  
Palmyra Square North  
Warrington WA1 1JN

Drawn by	e-mail	shalewood@warrington.gov.uk
Approved by	Telephone	01925 442634
Date	MAY 2007	Fax 01925 443255
Project	Sheet	c

THE BOROUGH OF WARRINGTON (WAITING RESTRICTIONS

LOADING AND STREET PARKING PLACES) (AMENDMENT No.1) ORDER.

Drawing Title		
REMOVAL OF WAITING RESTRICTIONS		
DALTON BANK		
Scales	Drawing No.	Phase / R/c
1:1250	ERD/TMS/TRO/232	

AutoCAD File Ref: db1.dwg

NOTES

KEY

Existing No Waiting At Any Time (to remain)

Proposed Residents parking Bay to be Extended

Existing resident permit holders parking (At all times)

Proposed Resident permit holders parking (At all times)

Authorised Signatory

Executed as a Deed by affixing the Common Seal of Warrington Borough Council in the presence of:



CON	DATE

WARRINGTON

WARRINGTON

N/A

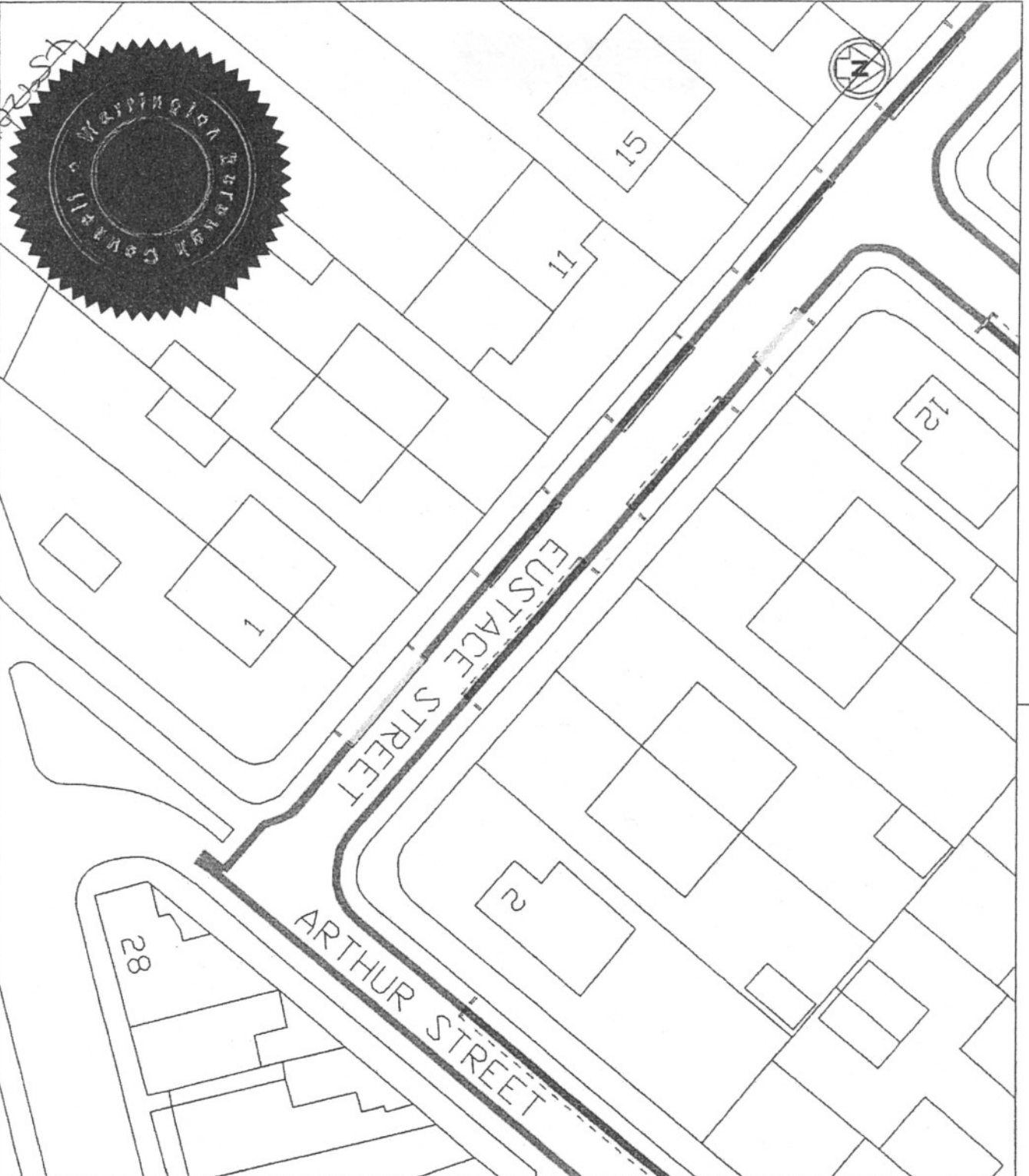



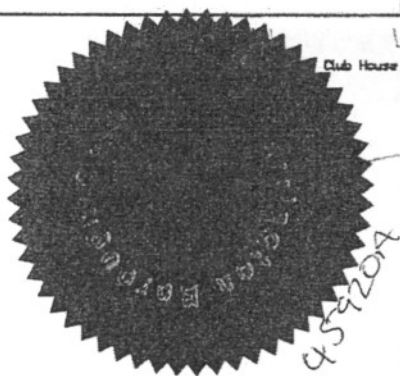

Club House

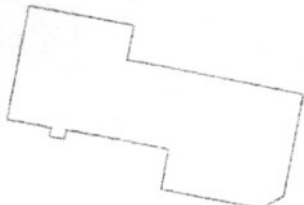

Ingot House

KELVIN CLOSE

Drain

Drain

KELVIN CLOSE

Drain

Drain

KELVIN CLOSE

BIRCHWOOD PARK AVENUE

25.7m

El Sub Sta

25.25m

Pond

Proposed Double Yellow Lines

This map is reproduced from Ordnance Survey material with the permission of Ordnance Survey on behalf of the Controller of HMSO © Crown copyright. Unauthorised reproduction infringes Crown copyright and may lead to prosecution or civil proceedings. Warrington B.C. Licence No. 100022848

Executed as a Deed by affixing the Common Seal of Warrington Borough Council in the presence of:

*C. G. G. G.*  
Authorised Signatory

& REGENERATION

Palmyra House  
Palmyra Square North  
Warrington WA1 1JN



Interim Strategic Director: Chris McCarthy

Drawn by	K Moyles	e-mail	kmoyles@warrington.gov.uk
Approved by		Telephone	01925 442680
Date	July 07	Fax	01925 443255
		Sheet	1 of 1
Project			
Kelvin Close Birchwood			
Drawing Title			
The Borough of Warrington (Kelvin Close)			
(Prohibition of Waiting) Order 2007			
Scales	Drawing No		Phase / Revision
NTS	ER/TM/KM/TRO241/01		

AutoCAD File Ref: Kelvin Close TRO.dwg

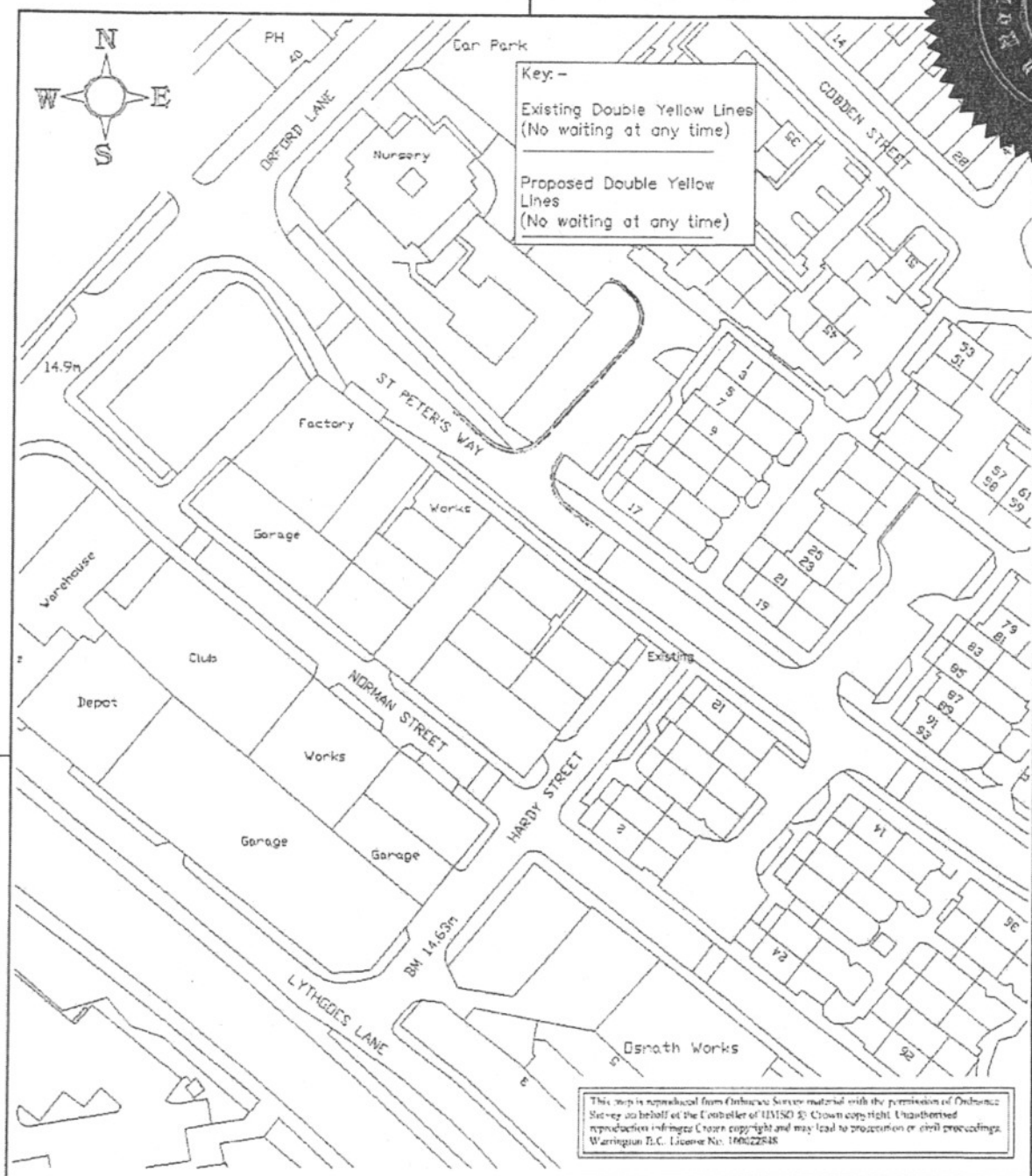
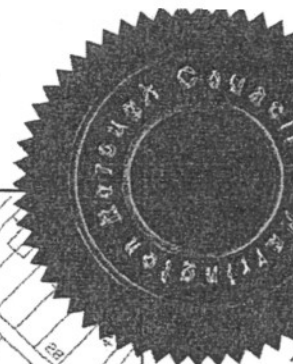

Executed as a Deed by affixing the Common Seal of Warrington Borough Council in the presence of:

*C. Hughes*  
Authorised Signatory

CH	e-mail	chughes@warrington.gov.uk
	Telephone	01925 442580
17/11/2005	Fax	01925 443255 Sheet 1 of 1

The Borough of Warrington  
Proposed Waiting Restrictions

St Peter's Way  
Warrington



Palmyra House  
Palmyra Square North  
Warrington WA1 1JN  
Strategic Director: A STEPHENSON BSc(Hons) DipTP

Scales	Drawing No.	Phase / Revision
1:1000	ERTMS/CH/TRO190	

AutoCAD File Ref:



*C. Galloway*  
Authorised Signatory

Def

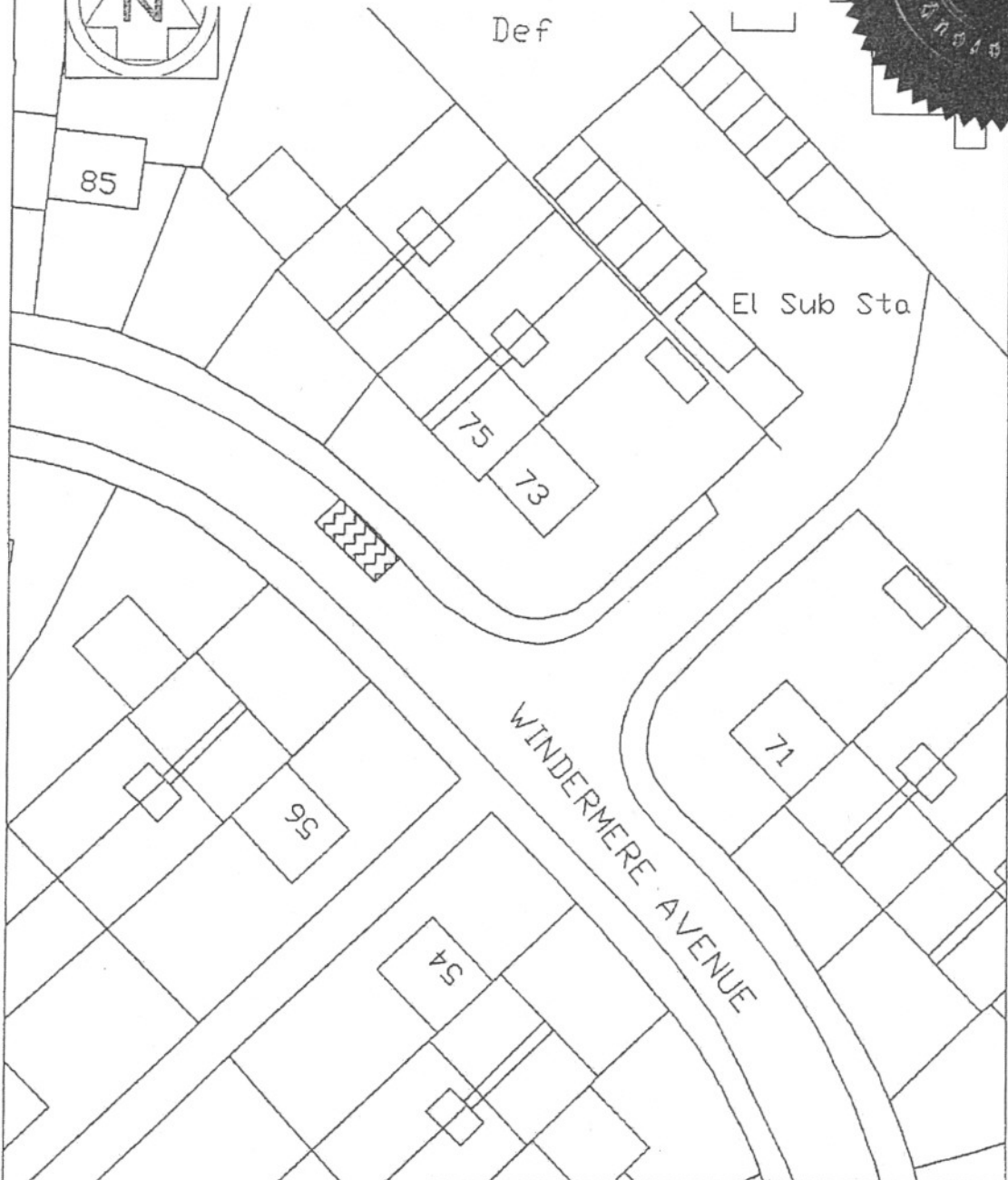

This map is reproduced from Ordnance Survey material with the permission of Ordnance Survey on behalf of the controller of HMSO © Crown copyright. Unauthorised reproduction infringes Crown copyright and may lead to prosecution or civil proceedings. Warrington B.C. 100022848 Published 2004.

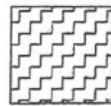

**Proposed  
Disabled Persons Parking  
Place for one vehicle.**

**The Borough of Warrington (Windermere Avenue, Stockton Lane, Grasmere Avenue, Forshaw Street and Wellfield Street)(Disabled Persons Parking Place) Order, 2006**

ENVIRONMENT SERVICES  
DIRECTORATE  
PALMYRA HOUSE  
PALMYRA SQUARE NORTH  
WARRINGTON WA1 1JN  
Strategic Director  
A. STEPHENSON BSc (HONS) Dip T. P.  
Tel: (01925) 444400  
Fax: (01925) 443255



Scale 1:500

Drawn By CT

Date SEP 2006

Plan No. ER/TMS/CT/TRO208/01



*C. Gough*  
Authorised Signatory



This map is reproduced from Ordnance Survey material with the permission of Ordnance Survey on behalf of the controller of HMSO © Crown copyright. Unauthorised reproduction infringes Crown copyright and may lead to prosecution or civil proceedings. Warrington B.C. 100022848 Published 2004.

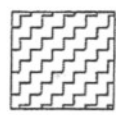

**Proposed  
Disabled Persons Parking  
Place for one vehicle.**

**The Borough of Warrington (Windermere Avenue, Stockton Lane, Grasmere Avenue, Forshaw Street and Wellfield Street)(Disabled Persons Parking Place) Order, 2006**

ENVIRONMENT SERVICES  
DIRECTORATE  
PALMYRA HOUSE  
PALMYRA SQUARE NORTH  
WARRINGTON WA1 1JH  
Strategic Director  
A. STEPHENSON BSc (HONS) Dip T. P.  
Tel: (01925) 444400  
Fax: (01925) 443255



Scale 1:500	Drawn By CT	Date SEP 2006	Plan No. ER/TMS/CT/TRO208/03
-------------	-------------	---------------	------------------------------



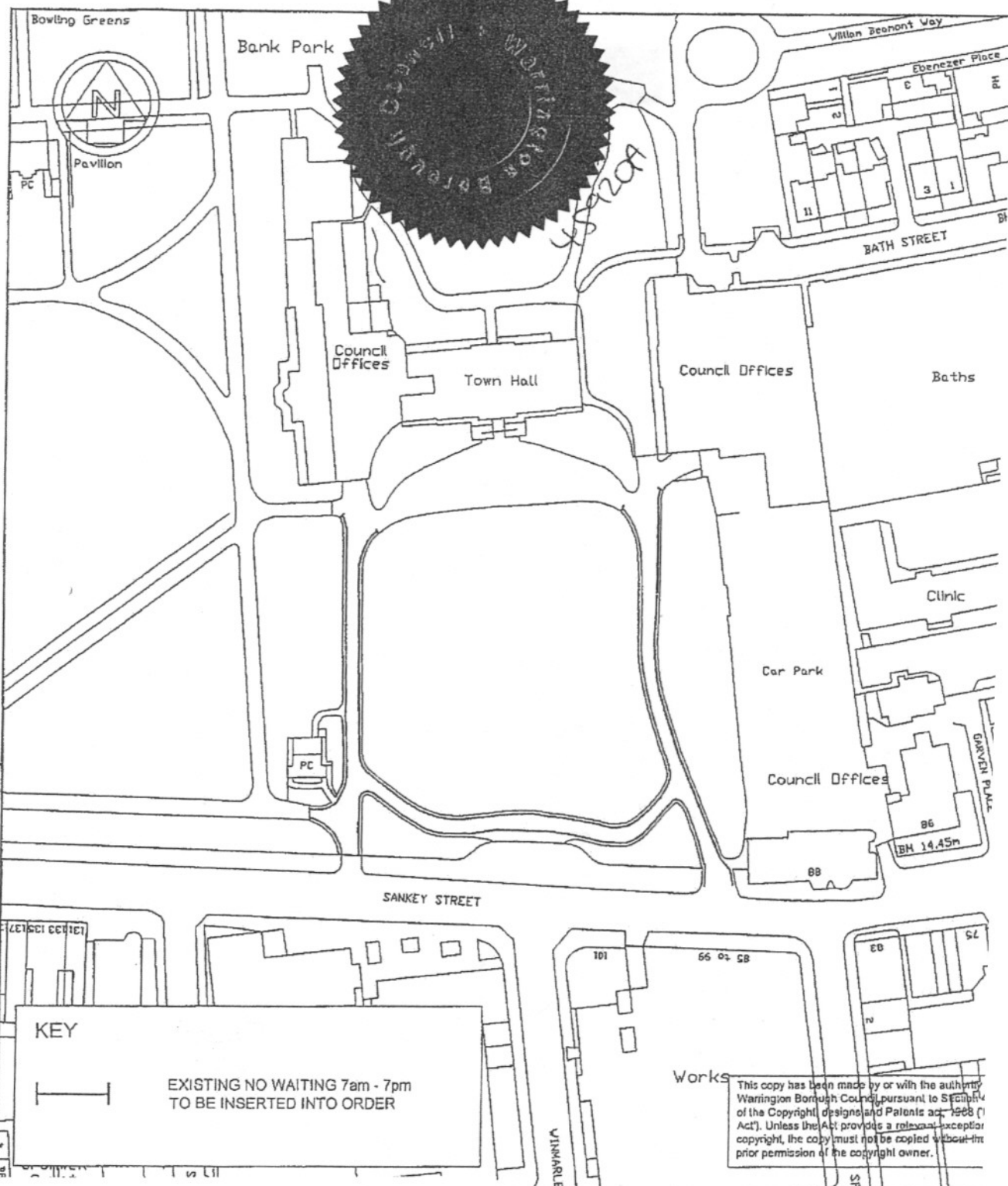

Executed as a Deed by affixing the Common Seal of Warrington Borough Council in the presence of:

*E. Cane*  
Authorised Signatory



ENVIRONMENT & REGENERATION  
DIRECTORATE

Palmyra House  
Palmyra Square North  
Warrington WA1 1JN

Drawn by: SH e-mail: sean.halewood@warrington.gov.  
Approved by: Telephone: 01925 442634  
Date: Fax: 01925 443255 SH 1 of 1  
Project

THE BOROUGH OF WARRINGTON (WAITING RESTRICTIONS, LOADS  
AND STREET PARKING PLACES) (AMENDMENT No.1) ORDER, 200

Drawing Title

WAITING RESTRICTION, 7am-7pm  
TOWN HALL DRIVES

Scales

1:1250

Drawing No.

ER/TMS/SH/TRO/224

Phase /

AutoCAD File Ref: am1.dwg



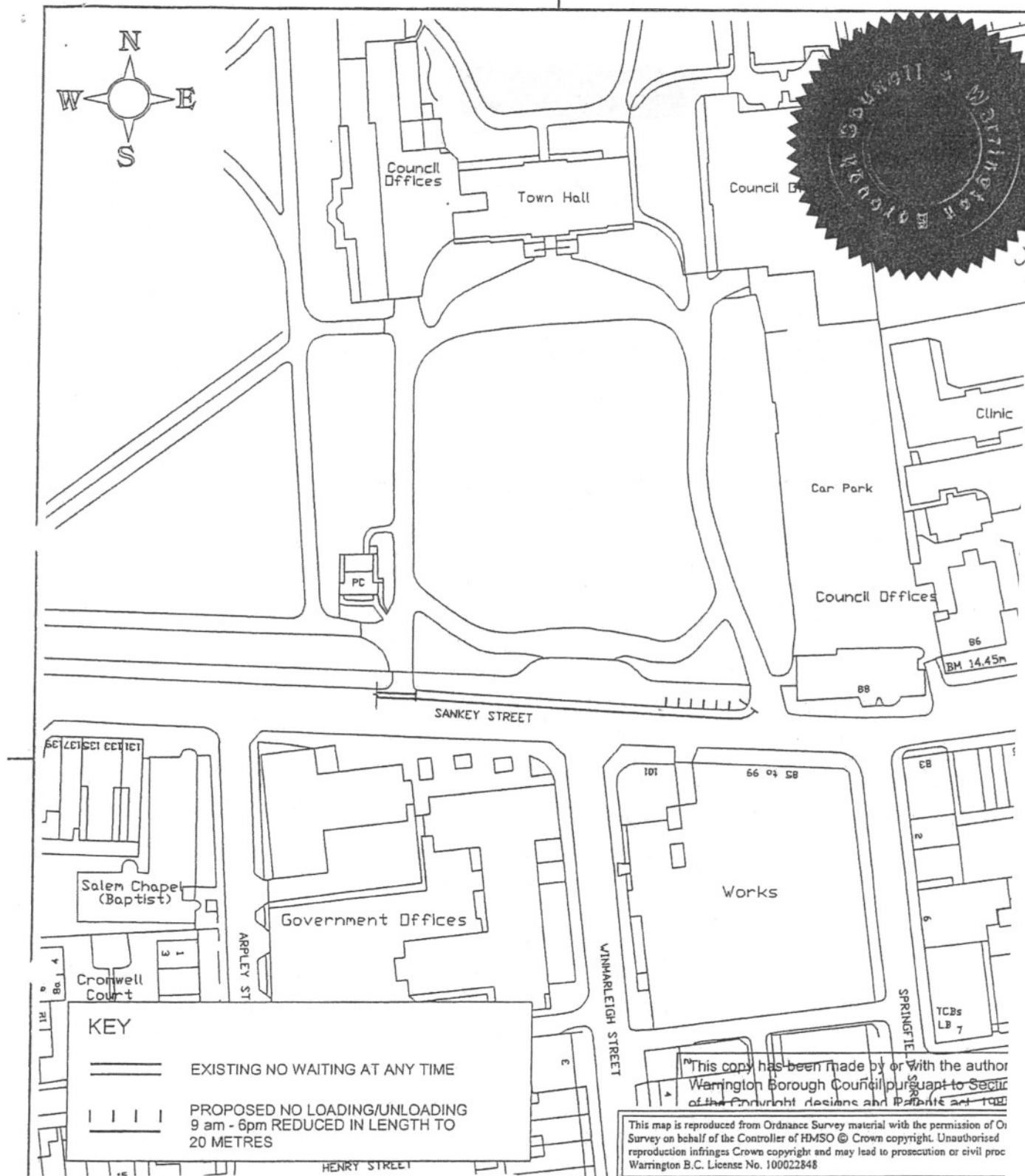

Executed as a Deed by affixing the Common Seal of Warrington Borough Council in the presence of:

*C. Gough*  
 Authorised Signatory

Drawn by	e-mail	@warrington.gov.uk
Approved by	Telephone	01925 44
Date	Fax	01925 443255
Project		

The Borough of Warrington (Sankey Str  
 (Restriction of Loading & Unloading

Drawing Title Amended Proposal		
Scales 1:1250	Drawing No. ER/TMS/SH/AM2/002	Phase /

AutoCAD File Ref: am2.dwg



**ENVIRONMENT SERVICES  
 DIRECTORATE**  
 Palmyra House  
 Palmyra Square North  
 Warrington WA1 1JN  
 Strategic Director:

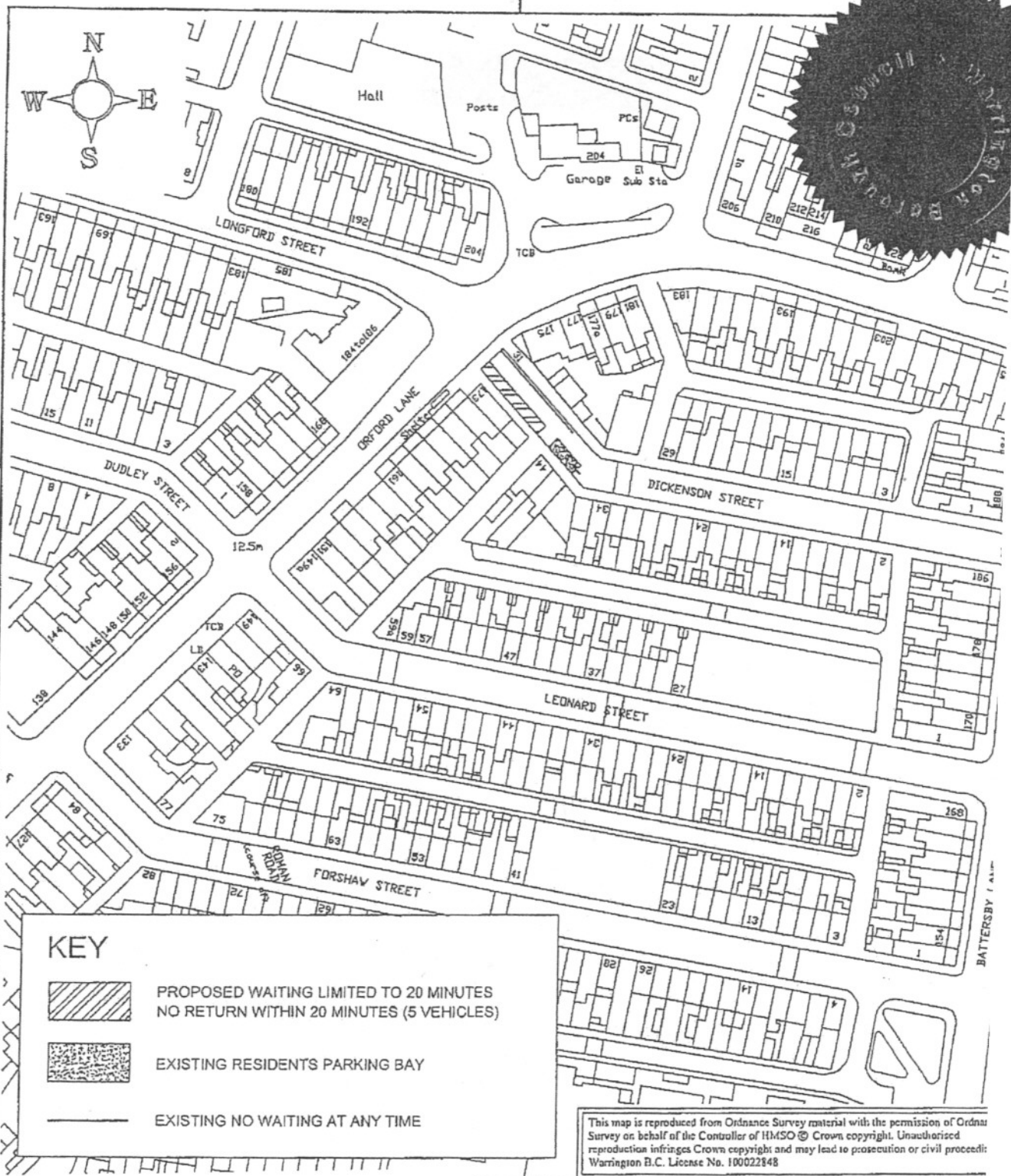

Executed as a Deed by affixing the Common Seal of Warrington Borough Council in the presence of:

*C. Caughn*  
 Authorised Signatory



**ENVIRONMENT SERVICES  
 DIRECTORATE**

Palmyra House  
 Palmyra Square North  
 Warrington WA1 1JN

Drawn by	e-mail	shalewood@warrington.gov.uk
Approved by	Telephone	01925 442634
Date	MAY 2007	Fax 01925 443255
Project	Sheet of	

THE BOROUGH OF WARRINGTON (WAITING RESTRICTIONS, LOAD  
 AND STREET PARKING PLACES) (AMENDMENT No. 1) ORDER, 2

Drawing Title		
PROPOSED LIMITED WAITING BAY		
DICKENSON STREET		
Scales	Drawing No.	Phase / Rev
1:1250	ERD/TMS/TRO/233	

AutoCAD File Ref: dick.dwg

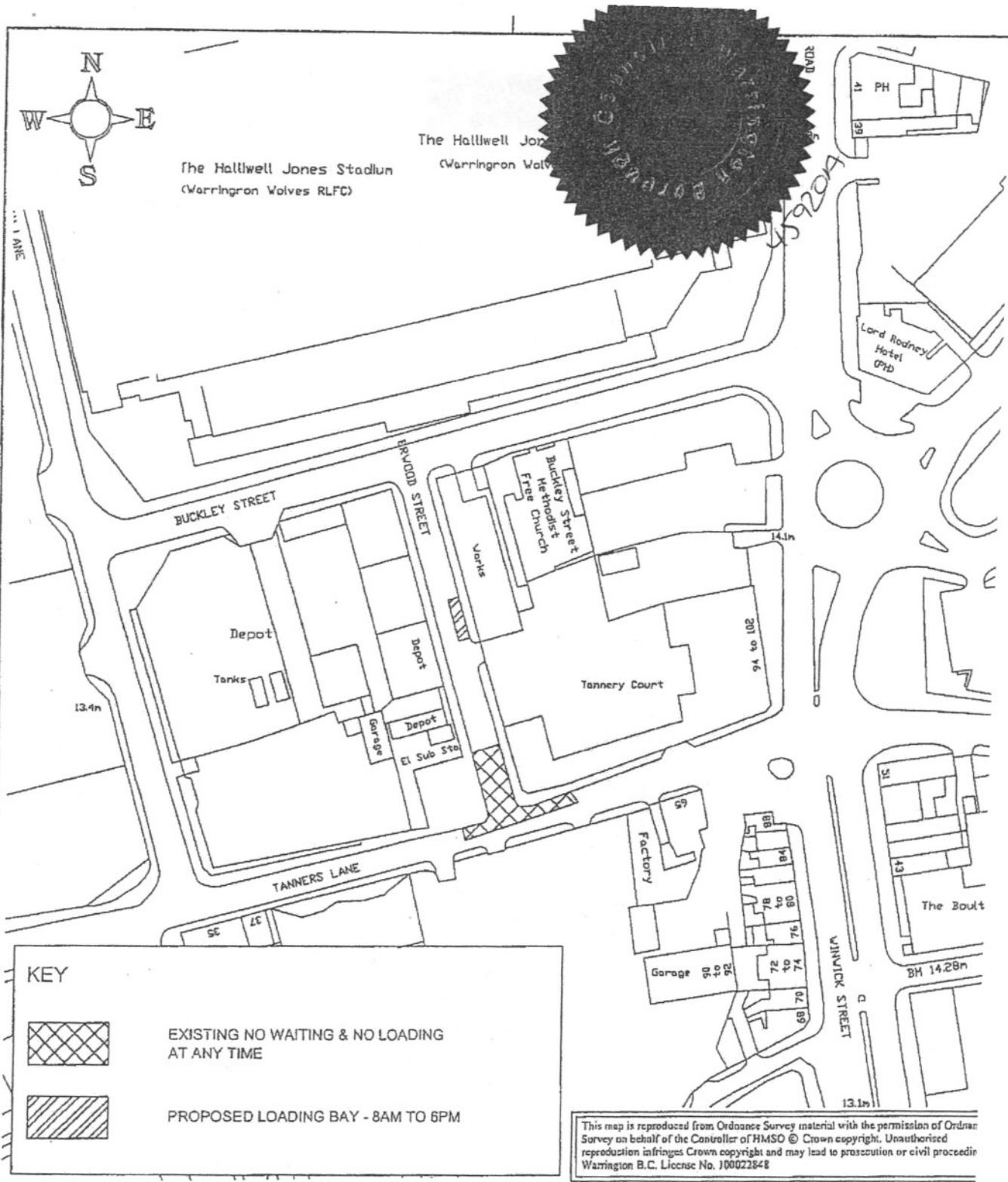

Executed as a Deed by affixing the Common Seal of Warrington Borough Council in the presence of:

*C. Gough*  
Authorised Signatory



**ENVIRONMENT SERVICES  
DIRECTORATE**  
Palmyra House  
Palmyra Square North  
Warrington WA1 1JN

Drawn by	e-mail	@warrington.gov.uk
Approved by	Telephone	01925 44
Date	Fax	01925 443255
Project	Sheet	of

THE BOROUGH OF WARRINGTON (WAITING RESTRICTIONS, LOADING AND STREET PARKING PLACES) (AMENDMENT No.1) ORDER, 2011

Drawing Title PROPOSED LOADING BAY		
ERWOOD STREET		
Scales 1:1250	Drawing No. ERD/TMS/TRO/234	Phase / Revision

AutoCAD File Ref: ERWOOD.dwg

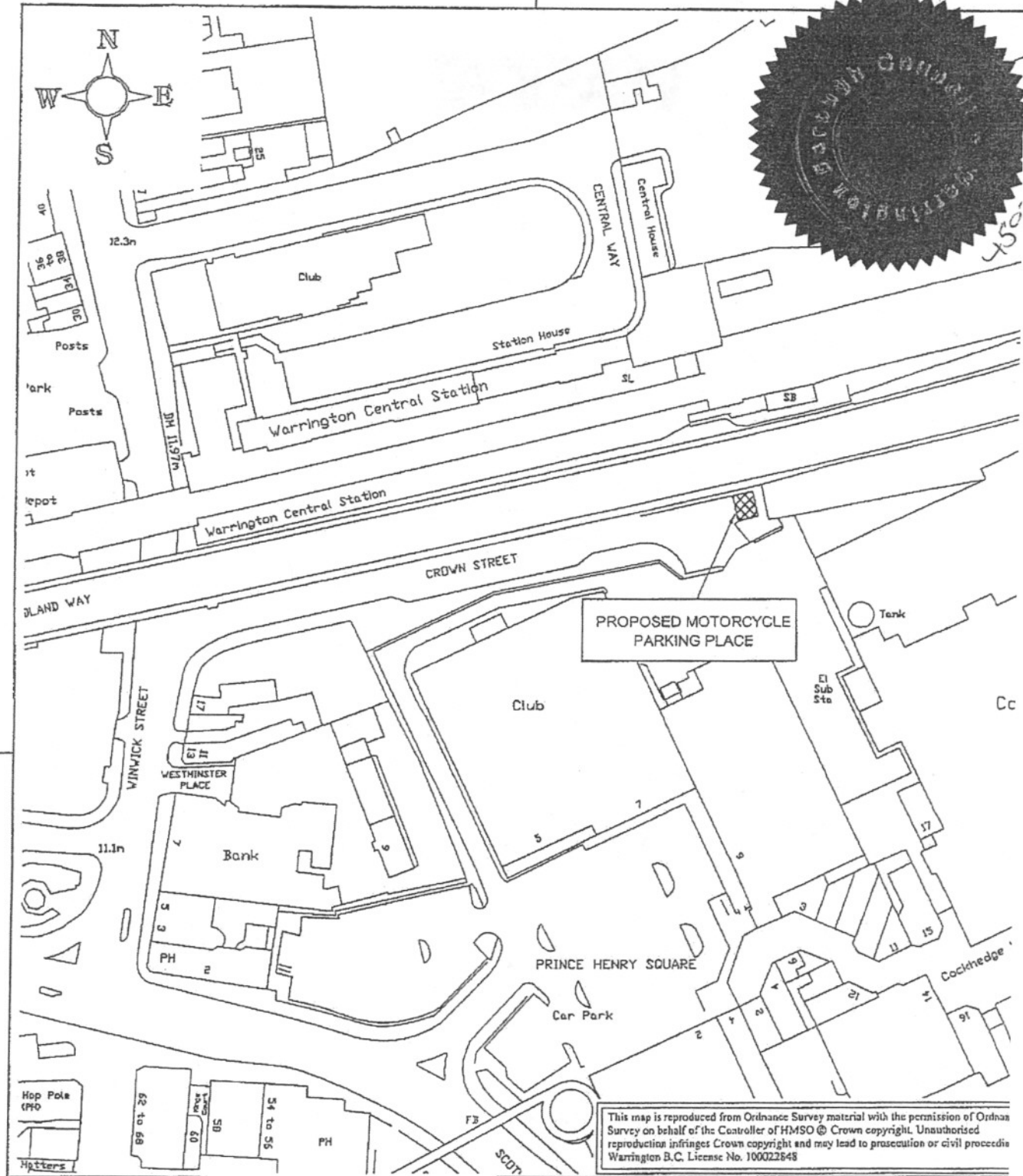

Executed as a Deed by affixing the Common Seal of  
Warrington Borough Council in the presence of:

*C. Gough*  
Authorised Signatory



## DIRECTORATE

Palmyra House  
Palmyra Square North  
Warrington WA1 1JN

Drawn by	SH	e-mail	shalewood@warrington.gov.uk
Approved by		Telephone	01925 442634
Date		Fax	01925 443255
Project		Sheet	of

THE BOROUGH OF WARRINGTON ( WAITING RESTRICTIONS, LOA

AND STREET PARKING PLACES) (AMENDMENT No.1) ORDER, 20

Drawing Title

PROPOSED MOTORCYCLE PARKING PLACE

CROWN STREET

Scales

1:1250

Drawing No.

ER/TMS/TRO/235

Phase / Revi

AutoCAD File Ref: crown.dwg