



**THE VALE OF GLAMORGAN COUNCIL
(PROHIBITION AND RESTRICTION OF WAITING AND
LOADING AND PARKING PLACES)
(CIVIL ENFORCEMENT) (AMENDMENT) (NO 6) ORDER 2013**

The Vale of Glamorgan Council in exercise of its powers under Sections 1, 2, 3, 4, 32, 35, 45, 46, 53 and 124 of and Part IV of Schedule 9 of the Road Traffic Regulation Act 1984 and Part 6 of the Traffic Management Act 2004 and of all other powers enabling it in that behalf and after consultation with the Chief Officer of South Wales Police, in accordance with Part III of Schedule 9 to the said Act of 1984 hereby makes the following Order:-

RESTRICTIONS AND LIMITATIONS

Limited Waiting 9.00a.m. to 6.00p.m. Monday to Saturday, for a maximum period of one hour, no return within one hour.

No person, except upon the direction or with the permission of a Police Constable in uniform or a Civil Parking Enforcement Officer, shall cause or permit any vehicle to wait, between the hours of 9.00am and 6.00pm Monday to Saturday for a period longer than one hour with no return within one hour in the lengths of road as described below.

The following Traffic Regulation Order is to be amended as follows:

Vale of Glamorgan Council (Prohibition and Restriction of Waiting and Loading and Parking Places) (Civil Enforcement) Order 2013

SCHEDULE 1

Delete from map schedules AA27 and AA28 - Limited Waiting, Monday to Saturday, 9:00am to 6:00pm, 1 hour no return within 1 hour.

High Street (Part), Cowbridge

On the northern side, from a point 62.7 metres west of its junction with the western entrance to Town Hall Square, westwards for a distance of 45 metres.

On the northern side, from a point 148 metres west of its junction with the western entrance to Town Hall Square, westwards for a distance of 44 metres.

AA27/6-13 AA28/6-13.

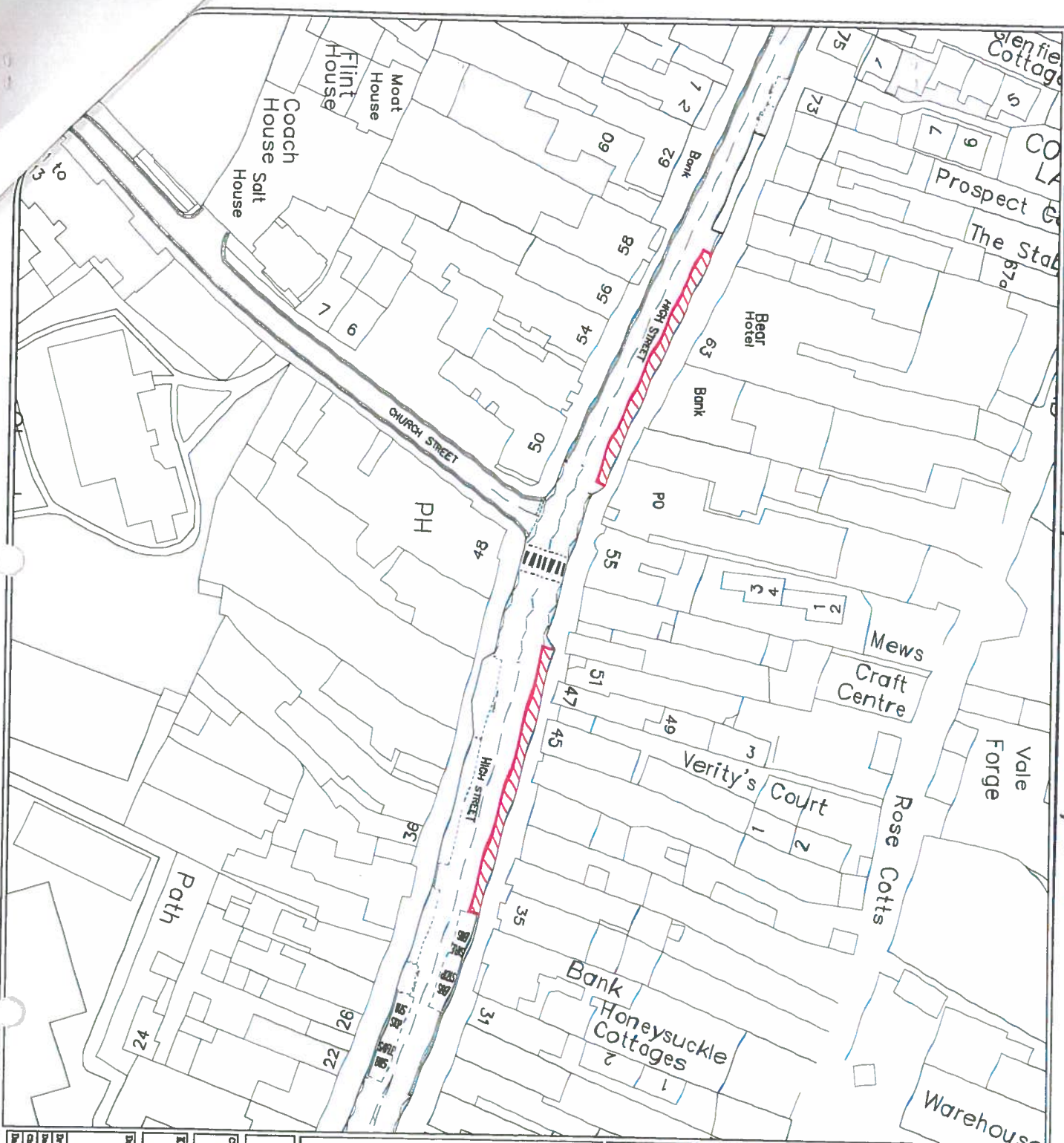

Ormauer

© Crown Copyright. All rights reserved The Vale of Glamorgan Council.
 Licence No. 100023424, 2009.
 © Hawlitraini y Goron. Cedwir pob hawl Cyngror Bro Morgannwg.
 Rhif Trwydded: 100023424, 2009.

Ref	Description of Amendment	Proposed	Out to	Date

VALE OF GLAMORGAN
 ENVIRONMENTAL AND ECONOMIC
 REGENERATION

Director:
 Huw Iwan Jones, Dip.P., M.B.A., P.I.
 Head of various services
 Miles Furler

BRO MORGANNWG
 ENGINEERING DESIGN
 AND PROCUREMENT

The Vale of Glamorgan Council

Key
 Proposed Amendment to Limited Working Monday to Saturday, 9:00am to 6:00pm, 1 hour no return within 1 hour

Drawing Title
 Proposed Amendment to Limited Working Orders,
 High Street (A4222), Cowbridge.

Drawn By	Scale	Project No.	Drawing No.
Diana M. Simpson	1:1000	1860	T/13/100/MS
Date	Rev		
20/08/13			

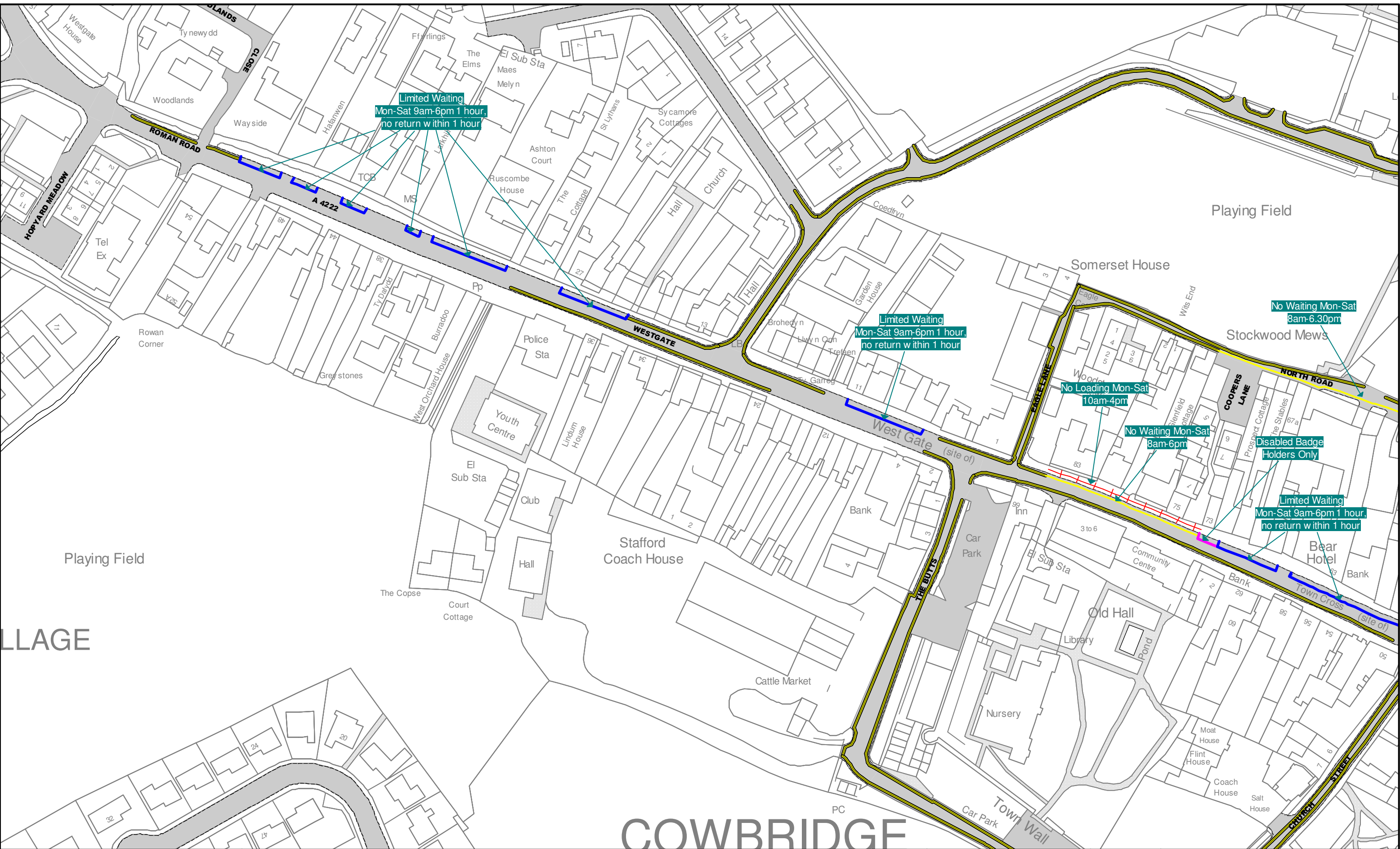

COWBRIDGE

Title: The Vale of Glamorgan Council (Prohibition and Restriction of Waiting and Loading and Parking Places) (Civil Enforcement) Order 2013

Key to TRO Restriction Types	
	No Waiting At Any Time
	No Waiting
	No Loading At Any Time
	No Loading
	School Keep Clear
	Limited Waiting
	Taxi Rank
	Disabled Parking Place
	Residents Parking Place
	Shared Use Parking Place (Permit/LW)
	Ambulance Parking Place
	Motorcycle Parking Place
	Loading Bay (any vehicle)
	Loading Bay (goods vehicle)
	Police Vehicle Parking Place
	Doctors Parking Place
	Emergency Vehicles Parking Place

W N E S

Crown copyright and database rights 2013 Ordnance Survey 100023424
Hawfrant y Goron a hawliau cronfa ddata 2013 Arolwg Ordans 100023424
Vale of Glamorgan Council
Licence No: 100023424

SCALE	1 : 1250 @ A3
DATE	09/12/2013
MAP	Tile Ref: AA27
REVISION	2

VALE of GLAMORGAN
The Vale of Glamorgan Council
The Alps
Wenvoe
CF5 6AA

Cyngor Bro Morgannwg
Yr Alpau
Wenvoe
CF5 6AA

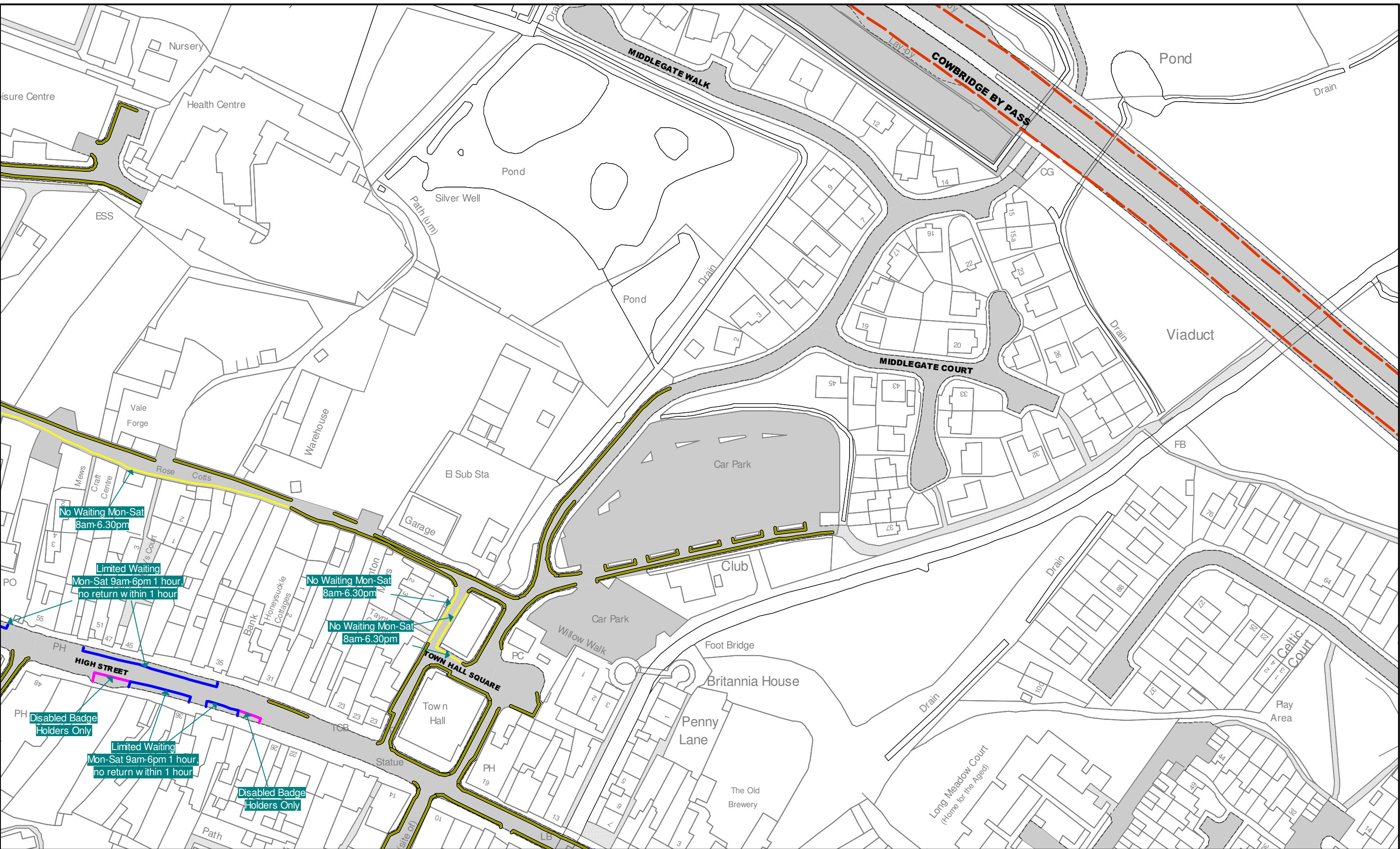

Title: The Vale of Glamorgan Council (Prohibition and Restriction of Waiting and Loading and Parking Places) (Civil Enforcement) Order 2013

Key to TRO Restriction Types	
	No Waiting At Any Time
	No Waiting
	No Loading At Any Time
	No Loading
	School Keep Clear
	Limited Waiting
	Taxi Rank
	Disabled Parking Place
	No Loading At Any Time
	Residents Parking Place
	Shared Use Parking Place (Permit/LW)
	Ambulance Parking Place
	24 Hour Clearway
	Motorcycle Parking Place
	Loading Bay (any vehicle)
	Loading Bay (goods vehicle)
	Police Vehicle Parking Place
	Doctors Parking Place
	Emergency Vehicles Parking Place

Crown copyright and database rights 2013 Ordnance Survey 100023424
 Hawfrain y Goron a hawliau cronfa ddata 2013 Arolwg Ordans 100023424
 Vale of Glamorgan Council
 Licence No: 100023424

SCALE	1 : 1250 @ A3
DATE	09/12/2013
MAP	Tile Ref: AA28
REVISION	2

VALE of GLAMORGAN
 The Vale of Glamorgan Council
 The Alps
 Wenvoe
 CF5 6AA

 Cyngor Bro Morgannwg
 Yr Alpau
 Gwenvo
 CF5 6AA

