

**TRAFFIC REGULATION ORDER**

DATED 18<sup>th</sup> August 2015

**THE BOROUGH OF TEST VALLEY  
(CRICKETERS WAY / RIVER WAY ARCH, ANDOVER)  
(PROHIBITION OF DRIVING) ORDER 2015**

W. Lynds,  
Head of Legal & Democratic Service  
Test Valley Borough Council  
Beech Hurst, Weyhill Road  
Andover, Hampshire SP10 3AJ

Ref: LJB 13/3/2/3/16(37)

**TEST VALLEY BOROUGH COUNCIL**

**ROAD TRAFFIC REGULATION ACT 1984**

**THE BOROUGH OF TEST VALLEY (CRICKETERS WAY / RIVER WAY ARCH,  
ANDOVER) (PROHIBITION OF DRIVING) ORDER 2015**

The Borough Council of Test Valley as agent of Hampshire County Council (being the Traffic Authority) in exercise of its powers under Sections 1, 2, and 3 of the Road Traffic Regulation Act 1984 ("the Act") as amended, Part IV of Schedule 9 to the Act and of all other enabling powers, and after consultation with the Chief Officer of Police in accordance with Part III of Schedule 9 to the Act, hereby makes the following order:-

1. In this order and the preamble and schedule hereto:
  - "the Act" means the Road Traffic Regulation Act 1984;
  - "pedal cycle" means a unicycle, bicycle, tricycle, or a cycle having four or more wheels, not being in any case mechanically propelled unless it is an electrically assisted cycle of such class as is to be treated as not being a motor vehicle for the purposes of the 1984 Act;
  - "local bus" means local bus services registered under the 1985 Transport Act; and
  - "road" means any length of highway or any other length of road to which the public has access, and includes bridges over which a road passes.
  
2. No person shall cause any vehicle to proceed in that length of road between Cricketers Way and River Way as shown delineated and edged red on the plan attached hereto.
  
3. Nothing in article 2 of this Order shall apply so as to prevent any person from causing any vehicle to proceed in the length of road referred to in that article if the vehicle is:
  - (a) a local bus;
  - (b) a pedal cycle which is not a motor vehicle;
  - (c) being used in connection with any building operation or demolition in or adjacent to that length of road, the removal of any obstruction to traffic in that length of road, the maintenance, improvement or reconstruction of that length of road, or the laying, erection, alteration or repair in or

10

22412

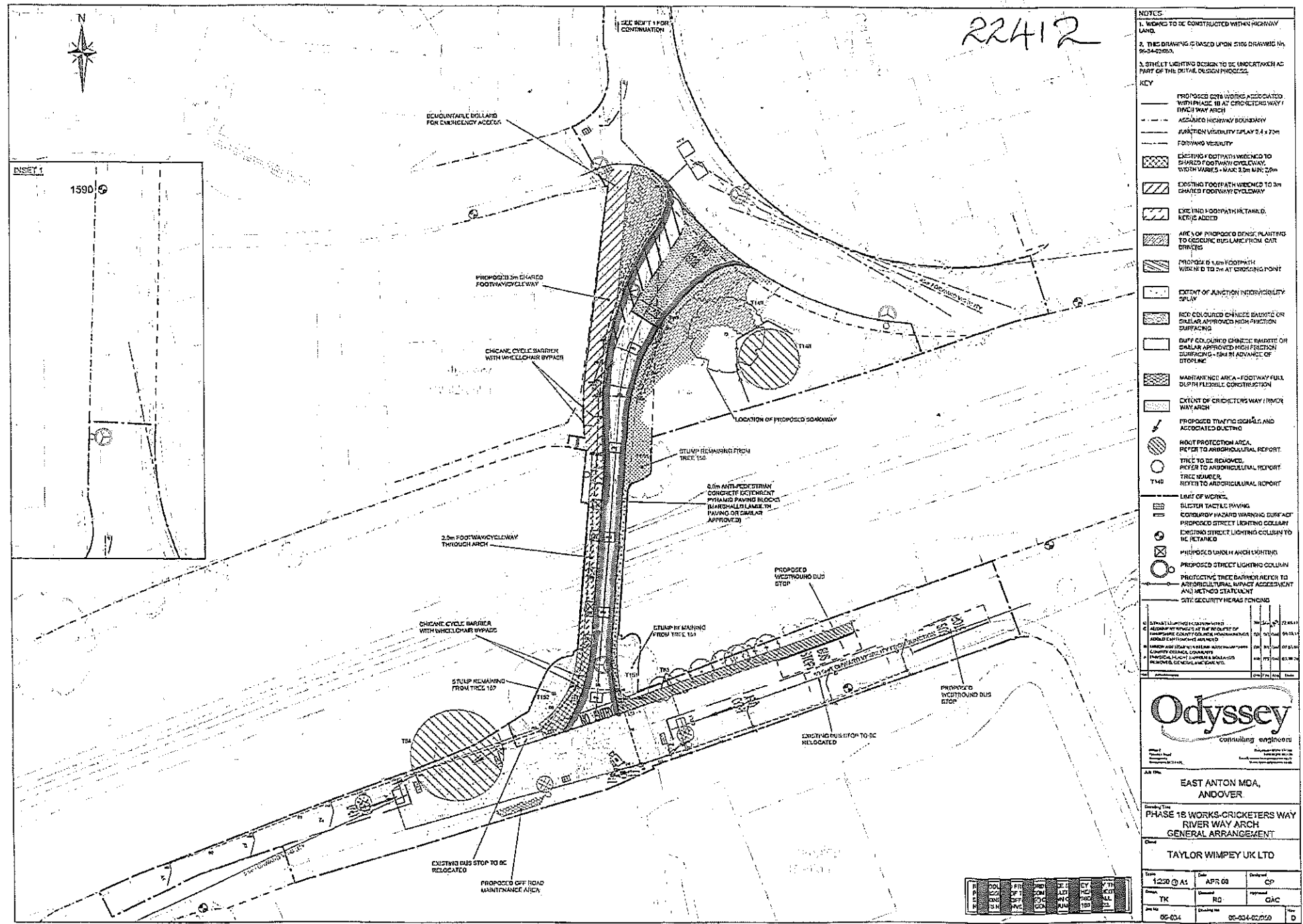

**NOTES**

- WORKS TO BE CONSTRUCTED WITHIN HIGHWAY LAND.
- THIS DRAWING IS BASED UPON SITE DRAWING NO. 05-034-02/050.
- STREET LIGHTING DESIGN TO BE UNDERTAKEN AS PART OF THE DESIGN PROCESS.

**KEY**

- PROPOSED DATA WORKS ASSOCIATED WITH PHASE 18 AT CRICKETERS WAY RIVER WAY ARCH
- ASSUMED HIGHWAY BOUNDARY
- JUNCTION VISIBILITY SUPPLY 3.4 x 7.0M
- FOOTWAY VISIBILITY
- EXISTING FOOTPATH WIDENED TO SHARED FOOTWAY CYCLEWAY WITH MAX 2.0M MIN 1.2M
- EXISTING FOOTPATH WIDENED TO 3M GRATED FOOTWAY CYCLEWAY
- EXISTING FOOTPATH RETAINED, NETS TO BE ADDED
- AREA OF PROPOSED DENSE PLANTING TO SCREEN BUS LANE FROM OUT DRIVES
- PROPOSED 1.5M FOOTPATH WIDENED TO 2M AT CROSSING POINT
- EXTENT OF JUNCTION INTERVISIBILITY SUPPLY
- RED COLOURED CHINESE BARRIERS OR SIMILAR APPROVED HIGH FRICTION SURFACING
- DUFF COLOURED CHINESE BARRIERS OR SIMILAR APPROVED HIGH FRICTION SURFACING - 5M IN ADVANCE OF STOPLINE
- MAINTENANCE AREA - ROADWAY FULL DEPTH FLEXIBLE CONSTRUCTION
- EXTENT OF CRICKETERS WAY (RIVER WAY) ARCH
- PROPOSED TRAFFIC SIGNALS AND ASSOCIATED DUCTING
- NOISE PROTECTION AREA, REFER TO ARCHITECTURAL REPORT
- TREE TO BE REMOVED, REFER TO ARCHITECTURAL REPORT
- TREE REMAINDER, REFER TO ARCHITECTURAL REPORT
- T140
- LIMIT OF WORKS
- SELECT TACTILE PAVING
- COLOUR BY HAZARD WARNING SURFACE
- PROPOSED STREET LIGHTING COLUMN
- EXISTING STREET LIGHTING COLUMN TO BE RETAINED
- PROPOSED UNDER ARCH LIGHTING
- PROPOSED STREET LIGHTING COLUMN
- PROTECTIVE TREE BARRIER REFER TO ARCHITECTURAL IMPACT ASSESSMENT AND ICHES STATUTORY
- CITY SECURITY HERAS FENCING

1	2	3	4	5	6	7	8	9	10	11	12	13	14	15	16	17	18	19	20	21	22	23	24	25	26	27	28	29	30	31	32	33	34	35	36	37	38	39	40	41	42	43	44	45	46	47	48	49	50	51	52	53	54	55	56	57	58	59	60	61	62	63	64	65	66	67	68	69	70	71	72	73	74	75	76	77	78	79	80	81	82	83	84	85	86	87	88	89	90	91	92	93	94	95	96	97	98	99	100
---	---	---	---	---	---	---	---	---	----	----	----	----	----	----	----	----	----	----	----	----	----	----	----	----	----	----	----	----	----	----	----	----	----	----	----	----	----	----	----	----	----	----	----	----	----	----	----	----	----	----	----	----	----	----	----	----	----	----	----	----	----	----	----	----	----	----	----	----	----	----	----	----	----	----	----	----	----	----	----	----	----	----	----	----	----	----	----	----	----	----	----	----	----	----	----	----	----	----	-----

**Odyssey**  
consulting engineers

**EAST ANTON MDA, ANDOVER**

**PHASE 18 WORKS-CRICKETERS WAY RIVER WAY ARCH GENERAL ARRANGEMENT**

**TAYLOR WIMPEY UK LTD**

Scale	1:200 @ A1	Date	APR 08	Drawn	CP
Checked	TK	Reviewed	RD	Approved	GAC
Job No	05-034	Drawing No	05-034-02/050	Sheet	D

adjacent to that length of road of any sewer or of any main, pipe or apparatus for the supply of gas, water, electricity or telecommunications; or

(d) police, ambulance, local authority or fire and rescue service purposes.

4. The Borough of Test Valley (Cricketers Way/River Way Arch, Andover) (One Way Bus Route) Order 2011 is hereby revoked.

5. This order shall come into operation on the 1<sup>st</sup> November 2015 and may be cited as "The Borough of Test Valley (Cricketers Way / River Way Arch, Andover) (Prohibition of Driving) Order 2015".

GIVEN this 18<sup>th</sup> day of August 2015

THE COMMON SEAL of THE BOROUGH )  
COUNCIL of TEST VALLEY was hereunto affixed )  
in the presence of: )

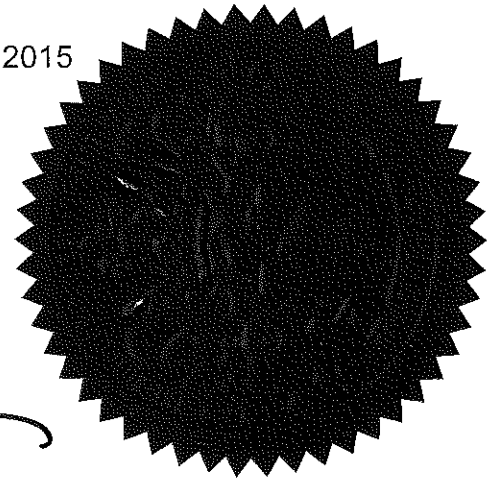

Authorised Signatory

22412