

80

**TAMESIDE METROPOLITAN BOROUGH COUNCIL**  
**THE TAMESIDE METROPOLITAN BOROUGH**  
**(MEDLOCK LEISURE CENTRE AREA, DROYLSDEN)**  
**(20MPH SPEED LIMIT) ORDER 2005**

**THE TAMESIDE METROPOLITAN BOROUGH COUNCIL** in exercise of its powers under Sections 84(1)(a), 2, and 3 of the Road Traffic Regulation Act 1984 ("the Act") and of all other enabling powers and after consultation with the Chief Officer of Police in accordance with Part III of Schedule 9 to the Act hereby makes the following Order:-

1. No person shall drive any motor vehicle at a speed exceeding 20 miles per hour on the lengths of roads specified in the Schedule to this Order.

This Order will come into operation on the 15<sup>th</sup> day of August 2005 and may be cited as "THE TAMESIDE METROPOLITAN BOROUGH (MEDLOCK LEISURE CENTRE AREA) (20MPH SPEED LIMIT) ORDER 2005".

THE COMMON SEAL OF TAMESIDE METROPOLITAN BOROUGH COUNCIL was hereunto affixed on the 11<sup>th</sup> day of August 2005, in the presence of

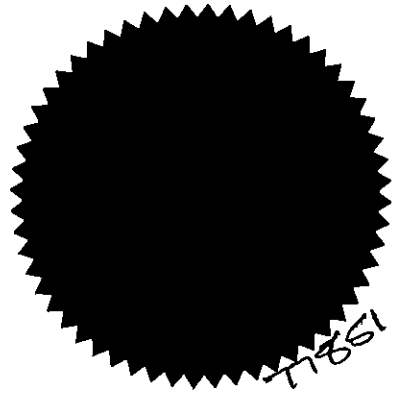

*[Handwritten signature]*  
for Borough Solicitor

**SCHEDULE**

Medlock Leisure Centre Service Road	All of its length
Fold Avenue	All of its length
Garden Avenue	All of its length

DRC / 80

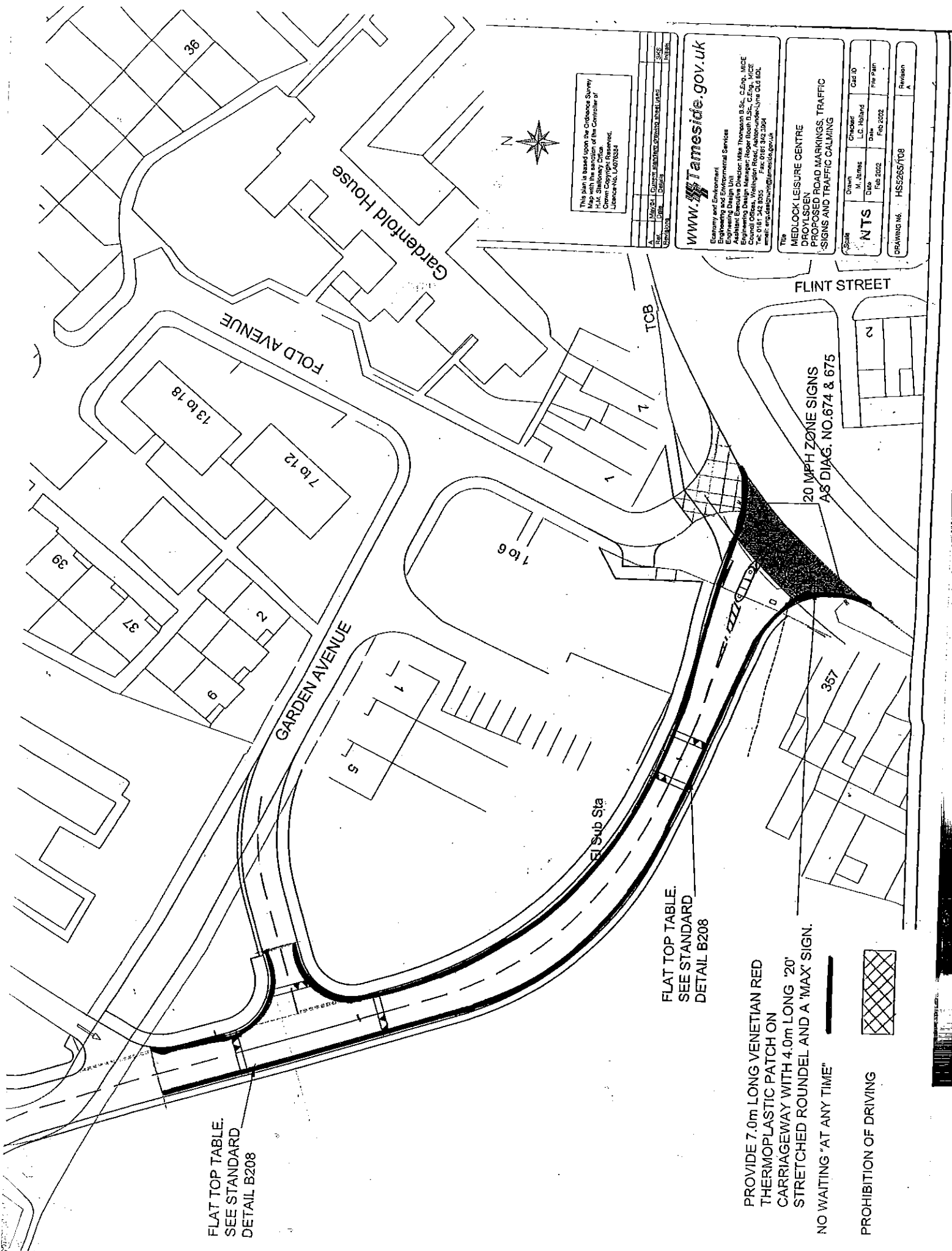

FLAT TOP TABLE.  
SEE STANDARD  
DETAIL B208

FLAT TOP TABLE.  
SEE STANDARD  
DETAIL B208

PROVIDE 7.0m LONG VENETIAN RED  
THERMOPLASTIC PATCH ON  
CARRIAGEWAY WITH 4.0m LONG '20'  
STRETCHED ROUNDEL AND A 'MAX' SIGN.  
NO WAITING 'AT ANY TIME'



PROHIBITION OF DRIVING



This plan is based upon the Ordnance Survey  
Map No. 100 000 000 of the Controller of  
H.M. Stationery Office  
Drawn Copyright Reserved.  
Licence No. LA070324

Author	M. JAMES	Checked	L.C. HOLLAND
Drawn	M. JAMES	Date	FEB 2002
Scale	1:100	Rev	A

[www.tameside.gov.uk](http://www.tameside.gov.uk)  
Economy and Environment  
Engineering and Environmental Services  
Planning and Design Unit  
Tameside Council Offices, Wallingford Road, Ashton-under-Lyne OL14 6DL  
Tel: 0161 342 3955 Fax: 0161 342 3954  
email: [enquiries@tameside.gov.uk](mailto:enquiries@tameside.gov.uk)

MEDLOCK LEISURE CENTRE PROYLSSEN PROPOSED ROAD MARKINGS, TRAFFIC SIGNS AND TRAFFIC CALMING			
Drawn	Checked	Case ID	
M. James	L.C. Holland		
Date	Date	Rev	Rev
FEB 2002	FEB 2002	A	1

DRAWING NO.	HSS2365/T08	Revision	A
-------------	-------------	----------	---