

**TAMESIDE METROPOLITAN BOROUGH COUNCIL**



**THE TAMESIDE METROPOLITAN BOROUGH COUNCIL**  
**(GODLEY HILL AREA, HYDE)**  
**(PROHIBITION OF DRIVING) ORDER 2014**

**THE TAMESIDE METROPOLITAN BOROUGH COUNCIL** in exercise of its powers under Sections 1(1), 2(1), 2(2) and 4(2) of the Road Traffic Regulation Act 1984 ("the Act") and of all other enabling powers and after consultation with the Chief Officer of Police in accordance with Schedule 9 of the Act hereby makes the following Order:-

1. Save as provided in Article 2 to this Order no person shall except upon the direction or with the permission of a police constable in uniform or of a civil enforcement officer, cause or permit any vehicle to proceed in on that length of road specified in the Schedule to this Order.
2. Nothing in Article 2 shall render it unlawful for any person to cause or permit any vehicle to proceed in the specified length of road:-
  - (a) if the vehicle is being used for the removal of any obstruction to traffic;
  - (b) if the vehicle is being used in the service of a local authority or any other authority in exercise of statutory powers or duties and whilst being so used in such service or in such connection it is necessary for the vehicle to wait in the specified length of road;
  - (c) if the vehicle is being used for police, fire brigade or ambulance purposes;

This Order shall come into operation on the 28<sup>th</sup> day February 2014 and may be cited as "**THE TAMESIDE METROPOLITAN BOROUGH COUNCIL (GODLEY HILL AREA, HYDE) (PROHIBITION OF DRIVING) ORDER 2014**"

THE COMMON SEAL OF TAMESIDE  
METROPOLITAN BOROUGH COUNCIL  
was hereunto affixed on the 24<sup>th</sup> day of  
February 2014 in the presence of

  
Borough Solicitor  



84999

## SCHEDULE

### PROHIBITION OF DRIVING

#### **Unnamed Road**

that runs under Godley Hill Railway bridge.  
Situating 190 metres south-east of Mottram  
Road (measured along the centre line of Kerry  
Way) more clearly defined on the attached  
plan.

from its junction with Station Road to its junction  
with Kerry Way.

#### **Unnamed Road**

Situating 56 metres south-east of Mottram  
Road (measured along the centre line of  
Godley Hill Road) more clearly defined on the  
attached plan.

from a point 15 metres south west of its junction  
with Godley Hill Road for a distance of 100  
metres in a southerly direction



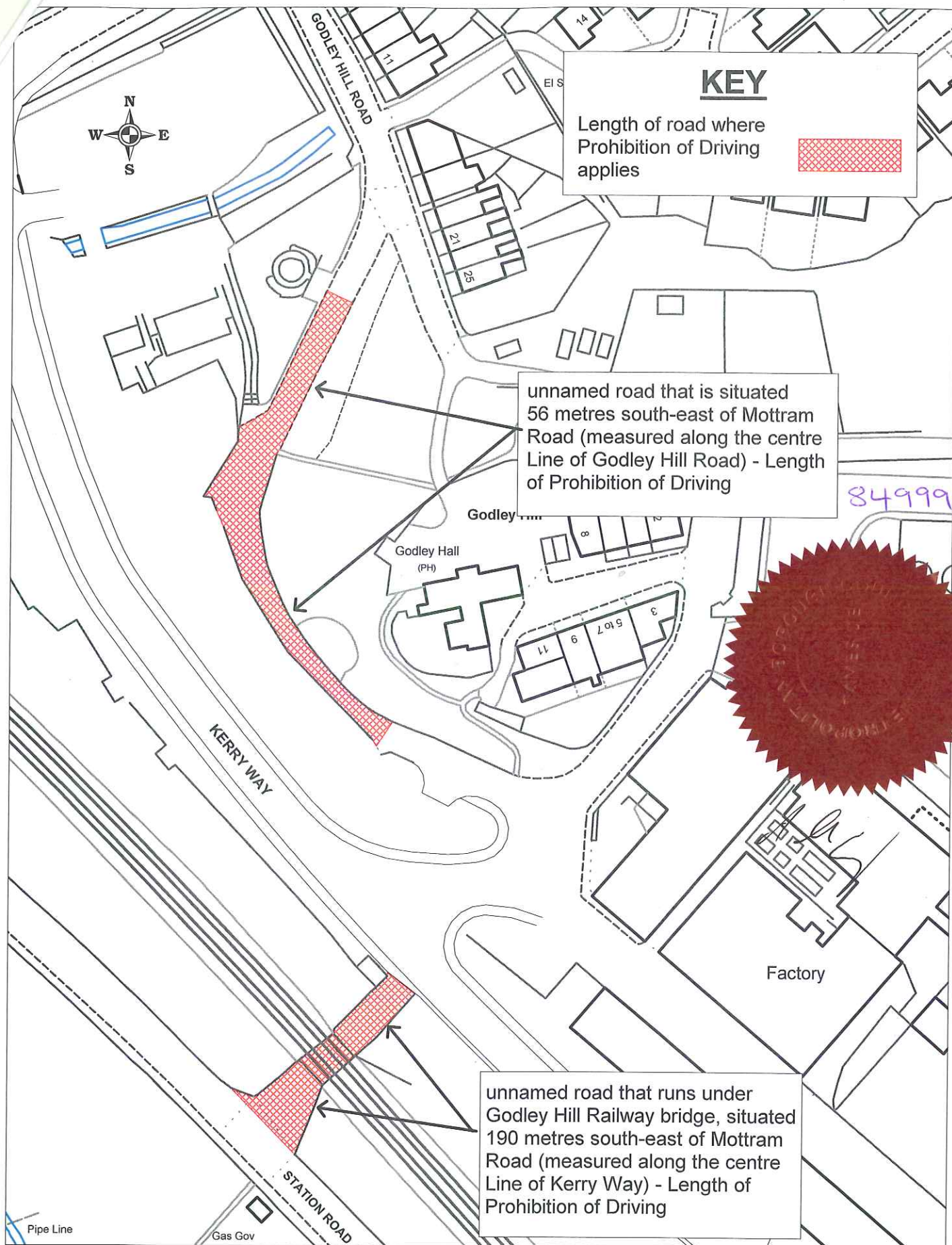

**THE TAMESIDE METROPOLITAN BOROUGH COUNCIL (GODLEY HILL AREA, HYDE)  
(PROHIBITION OF DRIVING) ORDER 2014 (PLAN)**

Engineering Service  
Tameside MBC  
Council Offices  
Wellington Road, Ashton-Under-Lyne  
Tameside, OL6 6DL

Drawn By : Ian Hall

Date : February 2014

Scale : NTS

Drawing No. GodleyHillAreaPOD