

SWINDON BOROUGH COUNCIL
(WAITING AND LOADING RESTRICTIONS AND PARKING PLACES
CONSOLIDATION) ORDER 2014 (VARIATION NO. 6) ORDER 2014

Swindon Borough Council in exercise of the powers conferred by Sections 1(1), 2(1) to (3), 4(2), 19, 32, 35, 45, 46, 47 and 124 of and Part IV of Schedule 9 of the Road Traffic Regulation Act 1984 (the Act of 1984), as amended and the Traffic Management Act 2004 ("the Act of 2004") and of all other enabling powers and after consultation with the Chief Officer of Police in accordance with Part III of Schedule 9 to the Act of 1984, hereby make the following Order:-

- 1 The Order shall come into operation on the 2nd day of October 2016 and may be cited as the "Swindon Borough Council (Waiting and Loading Restrictions and Parking Places Consolidation) Order 2011(Variation No. 6) Order 2014".
- 2 The Swindon Borough Council (Waiting and Loading Restrictions and Parking Places Consolidation) Order 2014 is hereby varied as follows:
 - A) The addition of the plans marked tile reference "CK32, CK33, CL32 and CL33".
 - B) The effect of the Order is to introduce a 'Restricted Parking Zone' in East Wichel where parking will be prohibited except for in marked parking bays.

THE COMMON SEAL of

SWINDON BOROUGH COUNCIL

was hereunto affixed this

28th day of September 2016

in the presence of:

CERTIFIED TO BE A TRUE
COPY OF THE ORIGINAL



S. J. TAYLOR

DIRECTOR OF LAW AND
DEMOCRATIC SERVICES

863780

HEAD OF CONVEYANCING,
ENVIRONMENT AND CONTRACTS

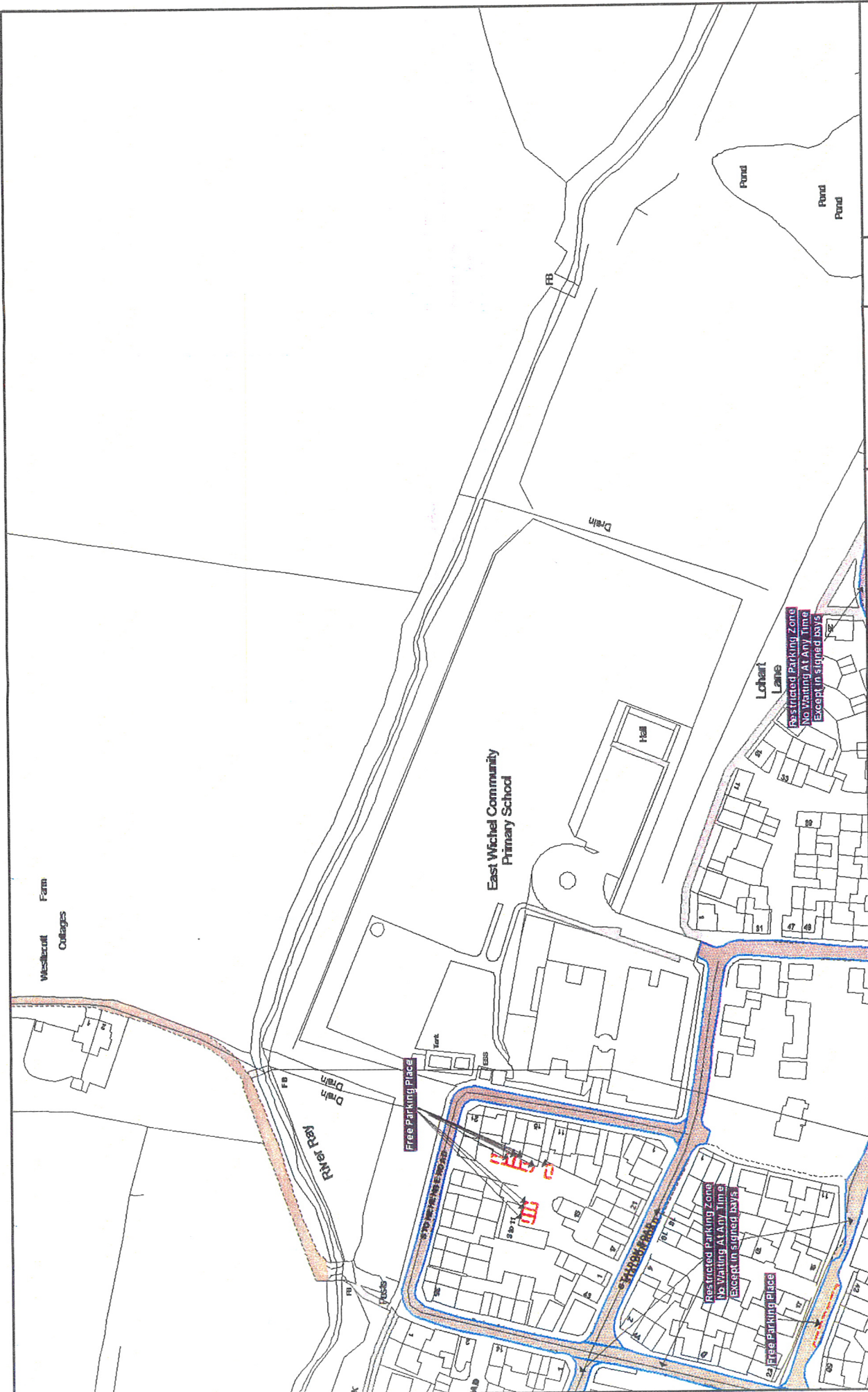



Swindon

Order Title: SWINDON BOROUGH COUNCIL (WAITING AND LOADING RESTRICTIONS AND PARKING PLACES CONSOLIDATION) ORDER 2014

NOTE: SEE KEY SHEET FOR RESTRICTIONS DISPLAYED

Scale 1 : 1250 @ A3

Date 02/10/2016

Map Title Ref: CK33

Revision 2 **CONFIRMED**

North Arrow

N

Key Sheet

CK33 CK32 CK34 CK33

This map is a plan of the Swindon Borough Council (Waiting and Loading Restrictions and Parking Places Consolidation) Order 2014. It is a plan of the Swindon Borough Council (Waiting and Loading Restrictions and Parking Places Consolidation) Order 2014. It is a plan of the Swindon Borough Council (Waiting and Loading Restrictions and Parking Places Consolidation) Order 2014.

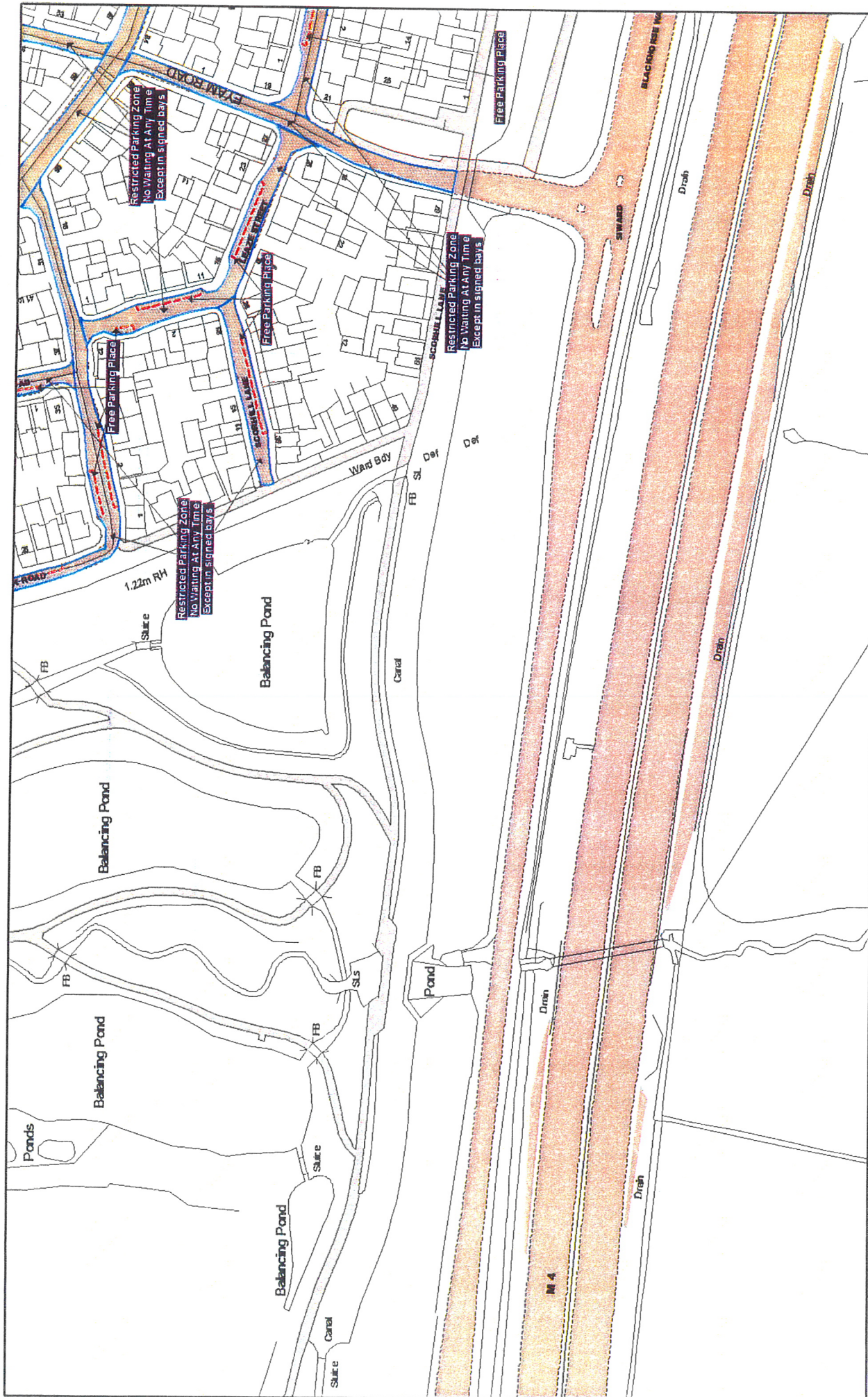

Order Title: SWINDON BOROUGH COUNCIL (WAITING AND LOADING
RESTRICTIONS AND PARKING PLACES CONSOLIDATION) ORDER 2014

NOTE: SEE KEY SHEET FOR RESTRICTIONS DISPLAYED

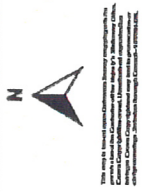

SCALE	1 : 1250 @ A3
DATE	02/10/2016
MAP	Tb Ref: CL32
REVISION	2
CONFIRMED	

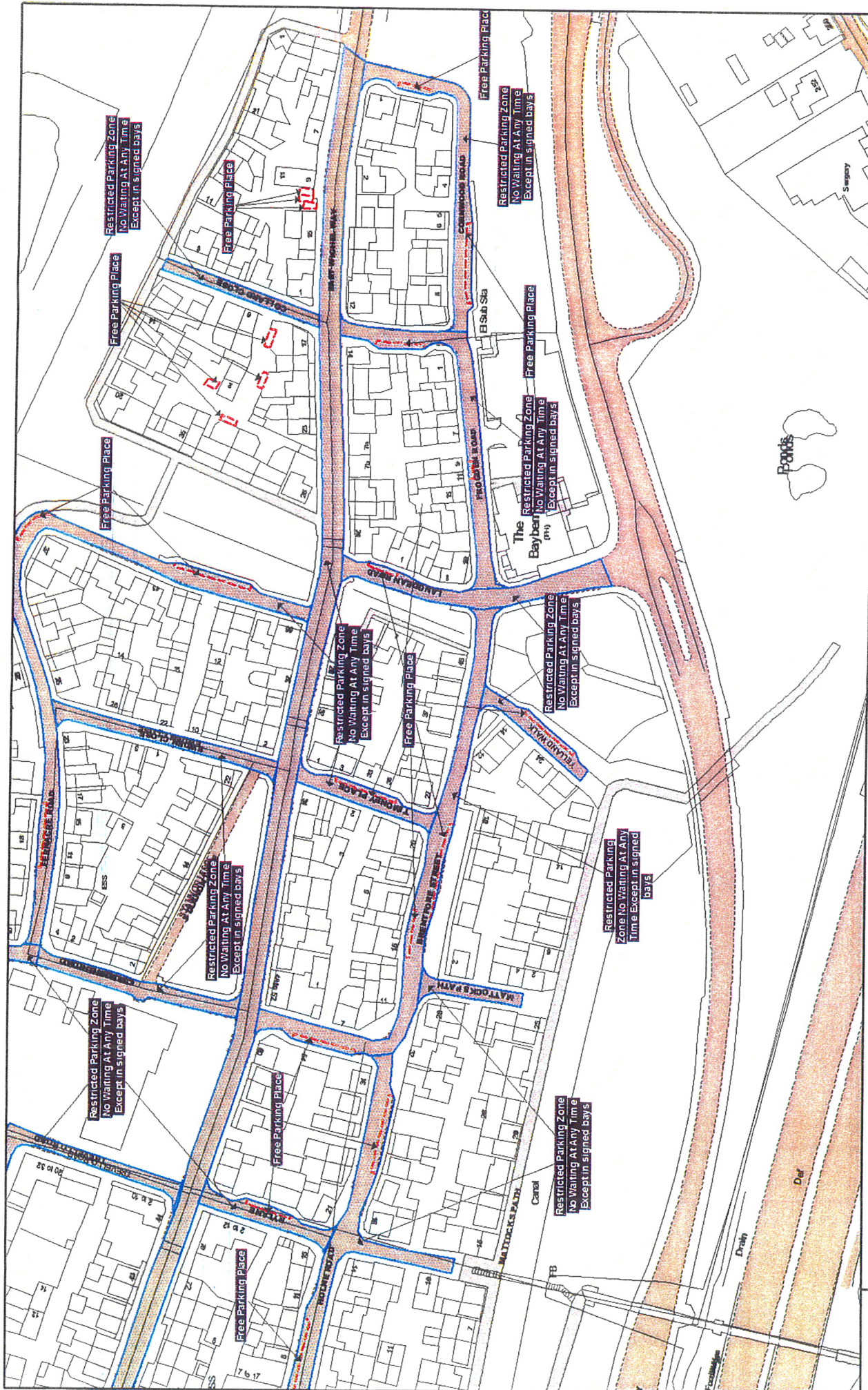

Order Title: SWINDON BOROUGH COUNCIL (WAITING AND LOADING RESTRICTIONS AND PARKING PLACES CONSOLIDATION) ORDER 2014

NOTE: SEE KEY SHEET FOR RESTRICTIONS DISPLAYED

CL32

CL34

CL33

N

SCALE	1 : 1250	@ A3
DATE	02/10/2016	
MAP	The Ref: CL33	
REVISION	2	CONFIRMED