

Dated the 17th day of April 2020

THE METROPOLITAN BOROUGH COUNCIL OF STOCKPORT

**THE METROPOLITAN BOROUGH COUNCIL OF STOCKPORT (TATTON CINEMA
DEVELOPMENT, GATLEY) (PROHIBITION OF WAITING, LIMITED WAITING,
PROHIBITION OF LOADING/UNLOADING, LOADING BAY) AND (REVOCATION)
ORDER 2020**

**V. Bates
Strategic Head of Service (Legal)
Town Hall
Stockport
SK1 3XE**

**THE METROPOLITAN BOROUGH COUNCIL OF STOCKPORT (TATTON CINEMA
DEVELOPMENT, GATLEY) (PROHIBITION OF WAITING, LIMITED WAITING,
PROHIBITION OF LOADING/UNLOADING, LOADING BAY) AND (REVOCATION)
ORDER 2020**

The Council of the Metropolitan Borough of Stockport ("the Council") in exercise of its powers under Section 1 (1), 2(1) to (3), 4(2) and Part IV of Schedule 9 of the Road Traffic Regulation Act 1984 ("the 1984 Act"), the Road Traffic Act 1991 ("the 1991 Act") and the Traffic Management Act 2004 and of all other enabling powers and after consultation with the Chief Officer of Police in accordance with Part III of Schedule 9 to the 1984 Act and with the 1991 Act, hereby makes the following Order:-

Interpretation

1. (1) In this Order:-

"Civil Enforcement Officer" means a person employed in accordance with section 63A of the 1984 Act as amended by the 2004 Act to carry out the functions referred to therein

"Disabled Persons" and "Disabled Person's Badge" have the same meaning as in the Disabled Persons (Badges for Motor Vehicles) (England) Regulations 2000;

"Disabled Persons' Vehicle" has the same meaning as section 142 of the 1984 Act and which is a vehicle, which immediately before or after any period of waiting, has been or is to be driven by a disabled person or, as the case may be, used for carrying Disabled Person(s) as passenger(s);

"Higher Level Contravention" means the contravention of the Waiting and Loading restrictions of this Order.

"Lower Level Contravention" means the contravention of any other Articles of this Order

"Owner" in relation to a vehicle means the person by whom the vehicle is kept. In determining who was the Owner at any time it shall be presumed that the Owner was the person who is named in the vehicle registration document as the registered keeper of a goods light goods or passenger vehicle or the person who has the use of such a vehicle in the course of his employment and who is entitled to use such a vehicle as though he were the registered keeper thereof;

"Parking Disc" means a disc, issued by a Local Authority, 125 millimetres square, coloured blue or orange and capable of showing the quarter hour period during which a period of waiting begins.

"Penalty Charge" has the same meaning as in section 82(1) of the 1991 Act and is £70 in respect of a Higher Level Contravention and £50 in respect of a Lower Level Contravention or such other charges as may be set by the Council under the provisions of section 74 of the 1991 Act in accordance with guidance given by the Secretary of State for Transport;

"Penalty Charge Notice" means a notice issued or served by a Civil Enforcement Officer pursuant to the provisions of section 66 of the 1991 Act;

“Relevant Position” in respect of a Disabled Person’s Badge and Parking Disc has the same meaning as in the Local Authorities Traffic Orders (Exemptions for Disabled Persons) (England) Regulations 2000.

- (2) The Interpretation Act 1978 shall apply for the interpretation of this Order as it applies for the interpretation of an Act of Parliament.
- (3) Unless the context otherwise requires any reference in this Order to a numbered Article or Schedule is a reference to an Article or Schedule so numbered in this Order
- (4) Any reference in this Order to any Act or Regulation shall be construed as a reference to that Act or Regulation as amended, applied, consolidated, re-enacted or as having effect by virtue of any subsequent Act or Regulation;
- (5) Words importing the singular meaning shall where the context so admits include the plural meaning and vice versa. Words of the masculine gender include the feminine and neuter genders

Prohibition of Waiting

2. Save as provided in Articles 5 and 6 no person shall, except upon the direction or with the permission of a constable in uniform or of a Civil Enforcement Officer, cause or permit any vehicle to wait at any time on the sides of lengths of road specified in Schedule 1.

Limited Waiting

3. Save as provided in Article 5 & 7 no person shall except upon the direction of with the permission of a constable in uniform or of a Civil Enforcement Officer cause or permit any vehicle to wait for longer than 1 hour, no return within 1 hour, between the hours of 8.00 am to 6.00 pm inclusive on the sides of lengths of road specified in Schedule 2.

Prohibition of Loading and Unloading and Loading Bay

4. Save as provided in Article 5 no person shall load or unload goods from any vehicle at any time and there will be a Loading Bay for Goods Vehicles on the sides of lengths of roads specified in Schedule 3.

Exemptions

5. Nothing in Articles 2, 3, and 4 shall render it unlawful to cause or permit any vehicle to wait on the sides of lengths of roads referred to in those Articles for so long as may be necessary to enable:-
 - (a) a person to board or alight from the vehicle;
 - (b) the vehicle, if it cannot conveniently be used for such purpose in any other road, to be used in connection with any of the following operations namely:-

- (i) building, industrial or demolition operations;
 - (ii) the removal of any obstruction to traffic;
 - (iii) the maintenance, improvement or re-construction of the said sides of lengths of road; or
 - (iv) the laying, erection, alteration or repair, in or on land adjacent to the said sides of lengths of road, of any sewer or of any main, pipe or apparatus for the supply of gas, water or electricity or of any telegraphic line as defined in the Telecommunications Act 1984;
- (c) the vehicle, if it cannot conveniently be used for such purpose in any other road, to be used in the service of a local authority or a water authority in pursuance of statutory powers or duties;
- (d) the vehicle to take in petrol, oil, water or air from any garage situated on or adjacent to the said sides of lengths of roads;
- (e) the vehicle to wait at or near to any premises situated on or adjacent to the said sides of lengths of roads for so long as such waiting by that vehicle is reasonably necessary in connection with any wedding or funeral.
- (f) the vehicle to be used for fire brigade, ambulance or police purposes.
- 6 Nothing in Article 2 shall render it unlawful to cause or permit a disabled persons vehicle which displays in the relevant position a disabled persons' badge and a parking disc (on which the driver, or other person in charge of the vehicle, has marked the time at which the period of waiting began) to wait on the sides of lengths of road referred to in that Article for a period not exceeding 3 hours (not being a period separated by an interval of less than 1 hour from the previous period of waiting by the same vehicle on the same side of length of road on the same day).
- 7 Nothing in Article 3 shall render it unlawful to cause or permit a disabled person's vehicle which displays in the relevant position a disabled person's badge to wait on the sides of lengths of roads referred to therein.

CONTRAVENTION OF ORDER

8. Contravention

If a vehicle is left in a parking place during the permitted hours or in any road or length of road in contravention or without complying with the requirements of this Order a contravention shall have occurred and the penalty charge shall be payable and/or the vehicle may be removed from that location.

9. Penalty Charge Notice

In the case of vehicle in respect of which a penalty charge may have been incurred, it shall be the duty of a Civil Enforcement Officer to issue a penalty charge notice which shall include the information required by the 1991 Act.

10. Manner of payment of Penalty Charge

The owner of the vehicle in respect of which the penalty charge has been incurred shall pay the penalty charge to the Council as indicated on the penalty charge notice.

11. Indications as evidence

The particulars given in the penalty charge notice attached to a vehicle in accordance with this Article shall be treated as evidence in any proceedings relating to failure to pay such penalty charge.

12. Removal of vehicle

Where a Civil Enforcement Officer has removed or caused to be removed a vehicle in accordance with Article 8,

- (a) he shall provide for the safe custody of the vehicle;
- (b) the Council shall be entitled to recover from the person responsible such charges in respect of the removal, storage and disposal of the vehicle as it might prescribe from time to time;
- (c) the provisions of the 1984 Act as amended shall apply to the disposal of such vehicles removed by or on behalf of the Council pursuant to this Article.
- (d) Nothing in Article 8 shall apply in respect of a vehicle displaying in a relevant position a valid disabled person's badge.

13. Restriction on removal of notices

Where a penalty charge notice has been attached to a vehicle in accordance with the provisions of Article 9, no person, not being the driver of the vehicle, a police constable in uniform, a Civil Enforcement Officer or some other person duly authorised by the Council, shall remove the notice from the vehicle unless authorised to do so by the driver.

REVOCATION

- 14 The restrictions in Schedule 4 to this Order are hereby revoked.

COMMENCEMENT & CITATION

- 15 This Order shall come into operation on the 18th day of April 2020 and may be cited as The Metropolitan Borough Council of Stockport (Tatton Cinema Development, Gatley) (Prohibition of Waiting, Limited Waiting, Prohibition of Loading/Unloading, Loading Bay) and (Revocation) order 2020

SCHEDULE 1
No Waiting at Any Time

Tatton Buildings: North Easterly side from the Easterly kerb line of Old Hall Road for a distance of 46 metres in a South Easterly direction to the Westerly kerb line of the Matinee Road.
Matinee Road : North Westerly side from the North Easterly kerb line of the Tatton Buildings for a distance of 2.5 metres in a North Easterly direction; from a point 14 metres North East of the North Easterly kerb line of Tatton Buildings for a distance of 35 metres in a North Easterly direction to the Adopted limit (Inc. all parts of the adjacent service points for their Adopted limits).
Old Hall Road: North Easterly side from the North Easterly kerb line of Tatton Buildings for a distance of 10 metres in a North Westerly direction.

SCHEDULE 2
Limited Waiting 8am–6pm 1 Hour No Return within 1 Hour 8 Echelon Parking Spaces

Tatton Buildings: South Westerly side from a point 10 metres South East of the North Easterly kerb line of Old Hall Road for a distance of 25 metres in a South Easterly direction.

SCHEDULE 3
Loading Bay & Prohibition of Loading and Unloading

Loading Only (Goods Vehicles):

Matinee Road, North Westerly side from a point 2.5 metres North East of the North Easterly kerb line of Tatton Buildings for a distance of 11.5 metres in a North Easterly direction

No Loading/Unloading at Any Time:

Tatton Buildings: North Easterly side from the Easterly kerb line of Old Hall Road for a distance of 46 metres in a South Easterly direction to the Westerly kerb line of the Matinee Road.

Matinee Road: North Westerly side from the North Easterly kerb line of the Tatton Buildings for a distance of 2.5 metres in a North Easterly direction; from a point 14 metres North East of the North Easterly kerb line of Tatton Buildings for a distance of 35 metres in a North Easterly direction to the Adopted limit (Inc. all parts of the adjacent service points for their Adopted limits).

Old Hall Road North Easterly side from the North Easterly kerb line of Tatton Buildings for a distance of 10 metres in a North Westerly direction.

SCHEDULE 4
Revocation of existing Traffic Regulation Orders

Revoke No Waiting at Any Time:

Matinee Road:

North Westerly side from the North Easterly kerb line of Tatton Buildings for a distance of 50 metres in a North Easterly direction.

Tatton Buildings

North Easterly side from the North Westerly kerb line of Matinee Road for a distance of 2 metres in a North Westerly direction.

South Westerly side from a point 5 metres East of the North Easterly kerb line of Old Hall Road for a distance of 30 metres in a South Easterly direction.

Revoke Limited Waiting 1 Hour 8am – 6pm No Return within 1 Hour:

Tatton Buildings

North Easterly side from the North Easterly kerb line of Old Hall Road for a distance of 45 metres in a South Easterly direction.

Revoke No Waiting Monday to Saturday 8am – 8pm:

Old Hall Road

Westerly side from the Northerly kerb line of Gatley Road for a distance of 6 metres in a North Easterly direction.

Revoke No Waiting 8am – 11pm:

Old Hall Road

Westerly side from a point 6 metres North East of the Northerly kerb line of Gatley Road for a distance of 93 metres in a Northerly direction.

This map is reproduced from Ordnance Survey material with the permission of Ordnance Survey on behalf of the Controller of Her Majesty's Stationary Office
 © Crown copyright. Unauthorised reproduction infringes Crown copyright and may lead to prosecution or civil proceedings. Stockport Metropolitan Borough Council 100019571 2019

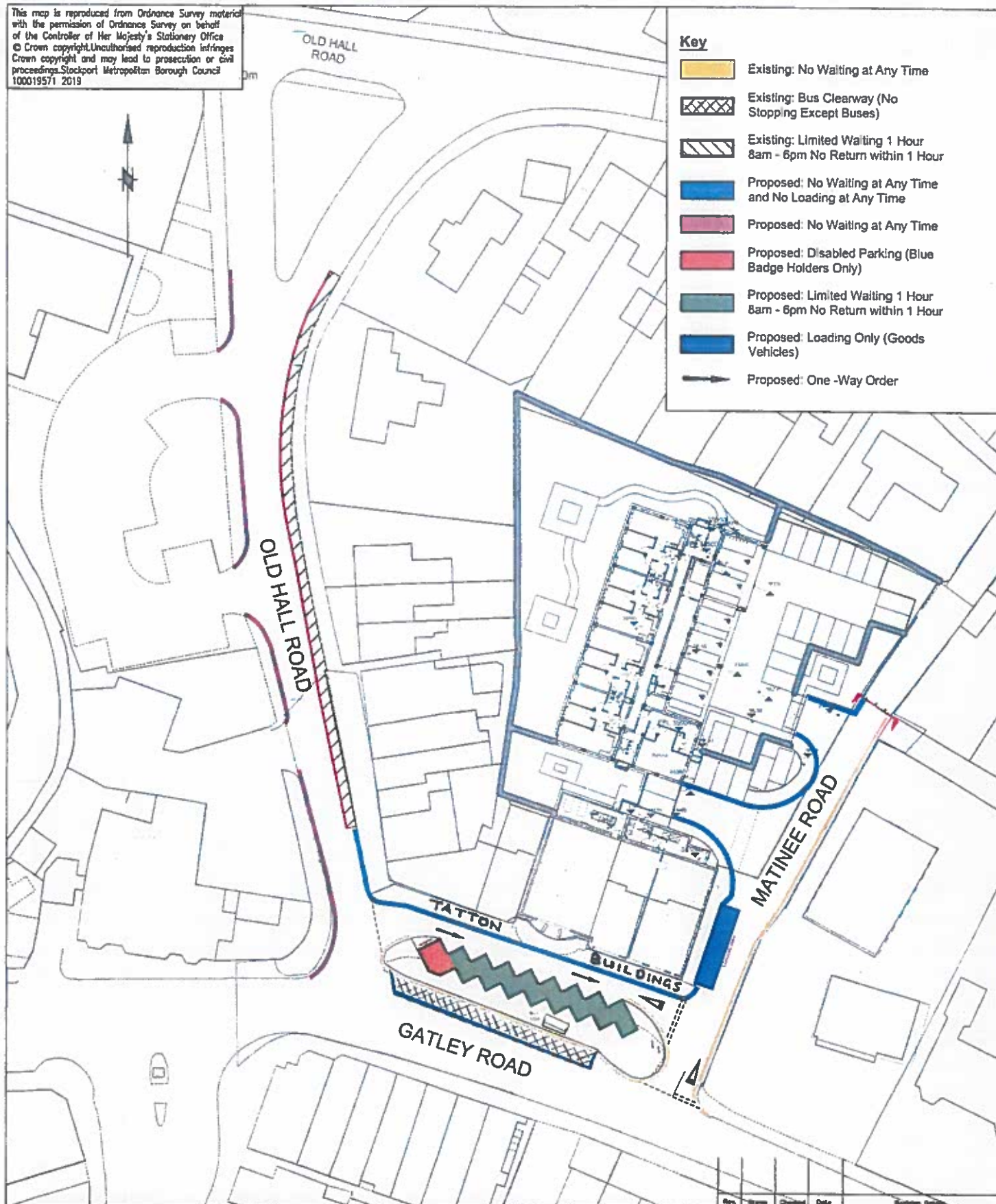

STOCKPORT
 METROPOLITAN BOROUGH COUNCIL

HIGHWAYS AND TRANSPORTATION
 STOPFORD HOUSE
 STOCKPORT SK1 3XE
 Tel: 0161 474

CAROLINE SIMPSON
 CORPORATE DIRECTOR
 PLACE

JOB TITLE

Tatton Cinema Development, Gatley

DRAWN	ENGINEER	CHECKED	APPROVED
DA	MT	JG	EPS
DATE	DATE	DATE	DATE
NOV 2019	NOV 2019	NOV 2019	NOV 2019
SCALE	SCG No.		
1:500			
DRAWING NUMBER	Revision		
NM8 - 5111-002			
DRAWING TITLE			
Proposed Traffic Regulation Orders			

This map is reproduced from Ordnance Survey material with the permission of Ordnance Survey on behalf of the Controller of Her Majesty's Stationery Office. © Crown copyright. Unauthorised reproduction infringes Crown copyright and may lead to prosecution or civil proceedings. Stockport Metropolitan Borough Council 100019571 2019

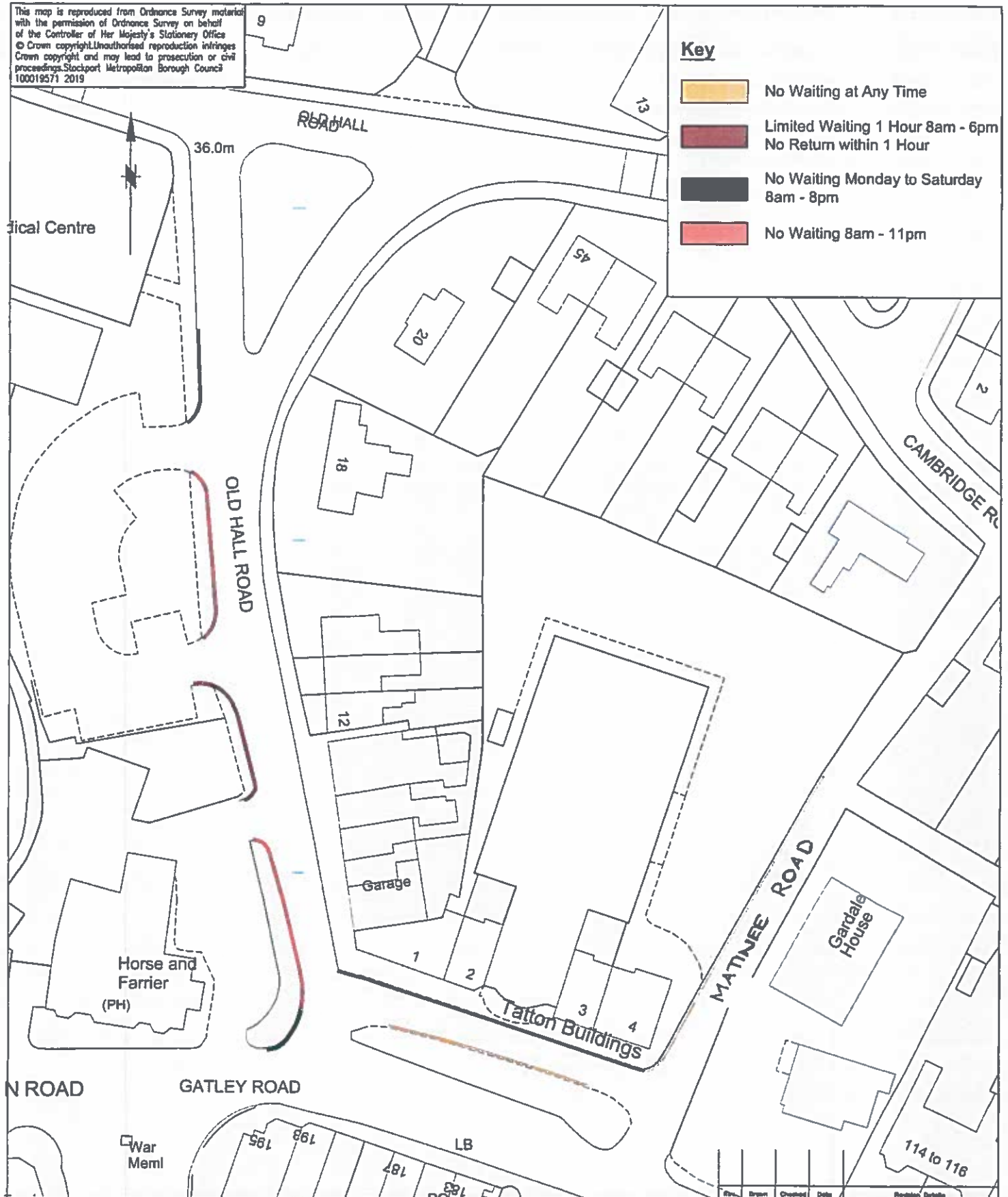

STOCKPORT
METROPOLITAN BOROUGH COUNCIL

HIGHWAYS AND TRANSPORTATION
STOPFORD HOUSE
STOCKPORT SK1 3XE
Tel: 0161 474

CAROLINE SIMPSON
CORPORATE DIRECTOR
PLACE

JOB TITLE

Tatton Cinema Development, Gatley

DRAWN DA	ENGINEER MT	CHECKED JG	APPROVED EPS
DATE NOV 2019	DATE NOV 2019	DATE NOV 2019	DATE NOV 2019
SCALE 1:500		SCG No.	
DRAWING NUMBER NM8 - 5111 - 001			Revision
DRAWING TITLE Traffic Regulation Orders to be Revoked			

THE COMMON SEAL of the
METROPOLITAN BOROUGH
COUNCIL OF STOCKPORT was
hereunto affixed
this 17th day of April 2020
in the presence of:

)
)
)
)
)
)



Strategic Head of Service (Legal, Democratic Governance & Estates
Management) Monitoring Officer



Authorised Signatory

