

**THE BOROUGH OF STAFFORD
(BRIDGE STREET MULTI-STOREY CAR PARK, STAFFORD) ORDER 2008**

The Council of the Borough of Stafford (hereinafter referred to as "the Council") in exercise of their powers under Section 35 and 124 of the Road Traffic Regulation Act 1984 (hereinafter referred to as "the Act of 1984"), and of all other enabling powers with the consent of the County Council of Staffordshire in accordance with Section 39(3) of the Act of 1984, and after consultation with the Chief Officer of Police in accordance with paragraph 20(1) Schedule 9 to the Act of 1984, hereby make the following Order:-

PART I

GENERAL

1 This Order shall come into operation on the 31st day of March 2008 and may be cited as the Borough of Stafford (Bridge Street Multi-Storey Car Park, Stafford) Order 2008.

2 In this Order, except where the context otherwise requires, the following expressions have the meanings hereby respectively assigned to them:-

"disabled person's vehicle" has the same meaning as in the Local Authorities' Traffic Orders (Exemptions for Disabled Persons) (England and Wales) Regulations 1986 as amended;

"disabled person's badge" has the same meaning as in the Disabled Persons (Badges for Motor Vehicles) Regulations 1982 as amended;

"driver", in relation to a vehicle waiting in a parking place, means the person driving the vehicle at the time it was left in the parking place;

"owner" has the same meaning as in Section 142(1) of the Act of 1984;

"Civil Enforcement Officer" means a person authorised by or on behalf of the Council to supervise a parking place and enforce the restrictions imposed by this Order;

"parking place" means any area of land specified by name in column 1 of Schedule 1 to this Order and shown on the plan accompanying the Order provided by the Council under Section 32(1) of the Act of 1984 for use as a parking place; and

"valid parking ticket" means a ticket issued for that parking place by an apparatus or device specially or generally approved by the Minister of Transport for such purpose.

"The 2004 Act" means the Traffic Management Act 2004

"The Parking Authority" means the Council of the Borough of Stafford

"Penalty Charge" means the charge referred to in Article 6 hereof

"Penalty Charge Notice" means a notice issued or served under regulations made pursuant to the 2004 Act.

PART II

USE OF PARKING PLACES

- 3 (1) Each area of land specified by name in column 1 of the Schedule to this Order may be used, subject to the following provisions of this Order, as a parking place for such classes of vehicles, in such positions and on such days and during such hours and on payment of such charges as are specified in the said Schedule.
- (2) The driver of a vehicle shall gain access to the parking place by collecting an automatically issued time-stamped ticket at the entrance to the parking place which shall be surrendered by the driver upon leaving the parking place to enable the level of charge payable by him to be determined in accordance with the charges specified in the Schedule to this Order.
- (3) Notwithstanding the provisions of sub-article (1), nothing shall restrict the power of the Council temporarily to close any of the parking places referred to therein.
- 4 Where in the Schedule to this Order a parking place is described as available for vehicles of a specified class or in a specified position, the driver of a vehicle shall not permit it to wait in that parking place:-
- (a) unless it is of the specified class; or
- (b) in a position other than that specified.
- 5 (1) The driver of a vehicle shall not permit it to wait in a parking place for longer than the maximum period permitted for waiting specified in the Schedule to this Order in relation to that parking place.
- (2) When a vehicle has left a parking place after waiting therein the driver thereof shall not within one hour after its leaving permit it to wait again in that parking place.
- 6 The charge for a vehicle left in a parking place otherwise than in accordance with these regulations shall be that set by the Council in accordance with Section 77 and Schedule 9 of the 2004 Act.
- 7 In the case of a vehicle in respect of which a Penalty Charge may have been incurred it shall be the duty of a Civil Enforcement Officer to either hand the

Penalty Charge Notice to the driver of the vehicle, post the Penalty Charge Notice to the owner of the vehicle or attach the Penalty Charge Notice to the vehicle in a conspicuous position.

- 8 Where a notice has been attached to a vehicle in accordance with the provisions of Article 7 of this Order, no person not being a Civil Enforcement Officer or some other person duly authorised by the Council shall remove the notice from the vehicle until the vehicle is removed from the parking place.
- 9 Upon removing the vehicle from the parking place, the driver of the vehicle shall surrender a valid parking ticket, or valid season ticket, and shall pay a charge in accordance with Article 3 herein.
- 10 The owner of a vehicle may on application to the Council purchase a season ticket in respect of that vehicle for a charge ascertained by reference to the Scale of Charges specified in Column 7 of the Schedule to this Order, and that season ticket shall be valid in such parking places as are specified thereon during the period for which it is issued.
- 11 Nothing in Articles 3, 4 or 5 of this Order shall prevent any person from causing or permitting a vehicle to wait in the parking places referred to in those Articles for so long as may be necessary and without payment of any charge to enable the vehicle, if it cannot conveniently be used for such purpose in any other place, to be used in connection with any building operations or demolition, the removal of any obstruction to traffic, the maintenance, improvement or reconstruction of the parking places so referred to or the laying, erection, alteration or repair in or near to the said parking places, of any sewer, or of any main, pipe or apparatus for the supply of gas, water or electricity or of any telecommunications services subject to the prior written consent of Stafford Borough Council.
- 12 The driver of a vehicle shall not permit that vehicle to wait in a parking place unless the vehicle is licensed in accordance with the provisions of the Vehicle Excise and Registration Act 1994 unless there is in relation to the use of the vehicle by the driver such a policy of insurance as complies with the requirements of the Road Traffic Act 1988.
- 13 (1) The following vehicles left in a parking place shall be exempt from the payment of any charge specified in Article 6, or in column 6 or 7, as the case may be, of the Schedule to this Order:-
 - (i) a pedal cycle;
 - (ii) a motor cycle not having a sidecar attached;provided that in the case of sub-paragraphs (i) and (ii) such vehicles shall only be exempt from the payment of a charge when the vehicle is in a parking place specifically allocated for that class of vehicle.

- (2) The following vehicles left in a parking place shall be exempt from any limitation on time and from the payment of any charge specified in Article 6 or in column 6 or 7, as the case may be, of the Schedule to this Order:-

a disabled person's vehicle which displays a disabled person's badge where the disabled person is in the vehicle and intends to leave the vehicle.

- 14 No person shall cause any vehicle except a disabled person's vehicle displaying a disabled person's badge to park in those parking spaces on which is marked the disabled logo in yellow.
- 15 The driver of a motor vehicle using a parking place shall stop the engine as soon as the vehicle is in position in the parking place and shall not start the engine except when about to change the position of the vehicle in or to depart from the parking place.
- 16 No person shall, while a vehicle is in a parking place, permit or cause to permit the carrying out of any work of maintenance or repair thereto except such as may be necessary to enable the vehicle to be moved from the parking place.
- 17 No person shall use a vehicle, while it is in a parking place, in connection with the sale of any article to persons in or near the parking place or in connection with the selling or offering for hire of his or her skill or services.
- 18 Subject to the proviso hereto, when a vehicle is left in a parking place in contravention of any of the provisions of Articles 3, 4 or 5 of this Order, a person authorised in that behalf by the Council may remove the vehicle or arrange for its removal from that parking place:-
- Provided that when a vehicle is waiting in a parking place in contravention of the provision of Article 4(b) of this Order, a person authorised in that behalf by the Council may alter or cause to be altered the position of the vehicle in order that its position shall comply with that provision.
- 19 The driver of a motor vehicle using a parking place shall not sound any horn or other similar instrument except when about to change the position of the vehicle in or to depart from the parking place.
- 20 Save as provided in Article 11 of this Order, no person shall, except with the permission of any person duly authorised by the Council, drive any vehicle in a parking place other than for the purpose of leaving that vehicle in the parking place in accordance with the provisions of this Order or for the purpose of departure from the parking place.

this Order he shall make such arrangements as may be reasonably necessary for the safe custody of the vehicle.

29 The following Order is hereby revoked:-

The Borough of Stafford (Off-Street Parking Places) (Bridge Street Multi-Storey Car Park, Stafford) Order 2008

THE COMMON SEAL OF THE COUNCIL OF)
THE BOROUGH OF STAFFORD was)
hereunto affixed this 27th day of March)
Two thousand and Eight in the presence of:-)

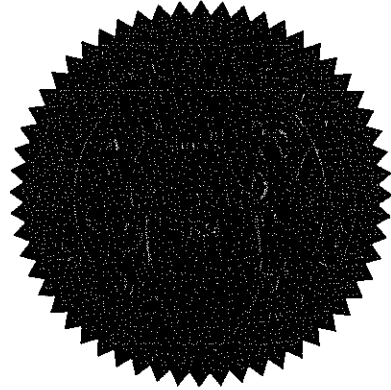

14749

Legal Services Manager

Head of Law and Administration

- 21 No person shall in a parking place wantonly shout or otherwise make any loud noise to the disturbance or annoyance of users of the parking place or residents of premises in the neighbourhood.
- 22 No person shall in a parking place use any threatening, abusive or insulting language, gesture or conduct with intent to put any person in fear or so as to occasion a breach of the peace or whereby a breach of the peace is likely to be occasioned.
- 23 No person shall use any part of a parking place or any vehicle left in a parking place:-
- (a) for sleeping or camping purposes;
 - (b) for eating or cooking purposes; or
 - (c) for the purpose of servicing or washing any vehicle or part thereof other than is reasonably necessary to enable that vehicle to depart from the parking place.
- 24 No person shall use a parking place as a means of passage proceeding from one road to another road.
- 25 Where in a parking place signs are erected or surface markings are laid for the purpose of:-
- (a) indicating the entrance to or exit from the parking place; or
 - (b) indicating that a vehicle using the parking place shall proceed in a specified direction within the parking place;
- no person shall drive or cause or permit to be driven any vehicle (i) so that it enters the parking place otherwise than by an entrance or leaves the parking place otherwise than by an exit so indicated, or (ii) in a direction other than that specified as the case may be.
- 26 In a parking place no person shall:-
- (a) erect or cause or permit to be erected any tent, booth, stand building or other structure without the written consent of the Council;
 - (b) light or cause or permit to be lit any fire.
- 27 Any person removing a vehicle by virtue of Article 18 of this Order may do so by towing or driving the vehicle or in such other manner as he may think necessary and may take such measures in relation to the vehicle as he may think necessary to enable him to remove it or alter its position as the case may be.
- 28 When a person authorised by the Council removes or makes arrangements for the removal of a vehicle from the parking place by virtue of Article 18 of

SCHEDULE

1	2	3	4	5	6	7
Name of Parking Place	Position in which vehicle may wait	Classes of Vehicle	Days of Operation of Parking	Hours of Operation of Parking	Max Period for which vehicles may wait	Scale of Charges for Parking
Bridge Street Multi-Storey Car Park, Bafford floors 1 & 2 levels 1A, levels 1B, (A, 2B)	Wholly within a parking bay	Motor cars, estate cars, station wagons, motor cycles (with or without sidecars), light vans the unladen weight of which does not exceed 1 tonne, invalid carriages, pedal cycles	All days	Monday to Wednesday 7.00 am - 9.00 pm Thursday & Friday 7.00 am - 10.00 pm Saturday 7.00 am - 9.00 pm Sunday 9.00 am - 5.00 pm	Between 8.00 am and 6.00 pm on any day except Sunday - max 4 hours. At other times when car park in operation - no limit Christmas Day - Car Park closed	Between 8.00 am and 6.00 pm on any day except Sunday Up to 1 hour £1.00 Up to 2 hours £1.80 Up to 3 hours £2.40 Up to 4 hours £3.00 Over 4 hours/lost tickets £20.00 Penalty Charge Sundays - no charge Monthly tickets not valid
Bridge Street Multi-Storey Car Park, Bafford levels 3A and 3B)	"	"	"	"	Between 8.00 am and 6.00 pm on any day except Sunday - max 10 hours. At other times when car park in operation - no limit Christmas Day - Car Park closed	Monthly ticket £40.00 3 Monthly ticket £108.00 6 Monthly ticket £192.00 12 Monthly ticket £336.00 Sundays - no charge

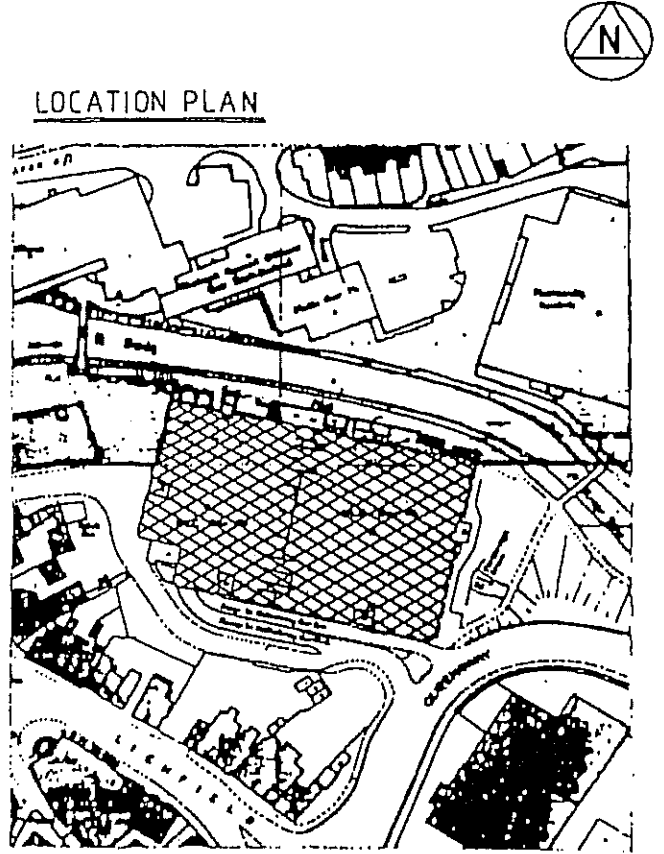
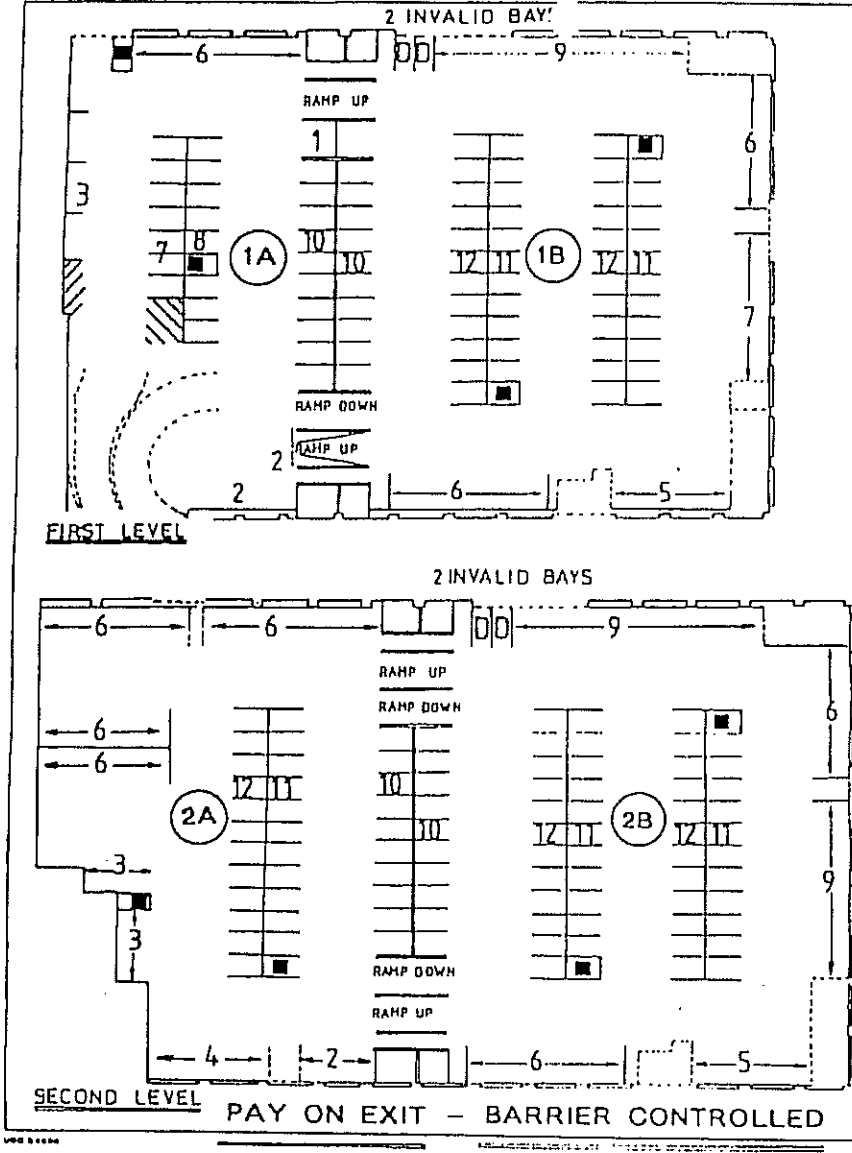

SHORT STAY CAR PARK 288 SPACES + 4 INV BAYS

Stafford Borough Council	BRIDGE STREET MULTI STOREY	
Scale	Date 5.8.08	Drawing No
Drawn	Traced	8
Clerk Office, Riverside, Stafford, ST16 3AD. Tel: 323181		

CAR PARK LAYOUT

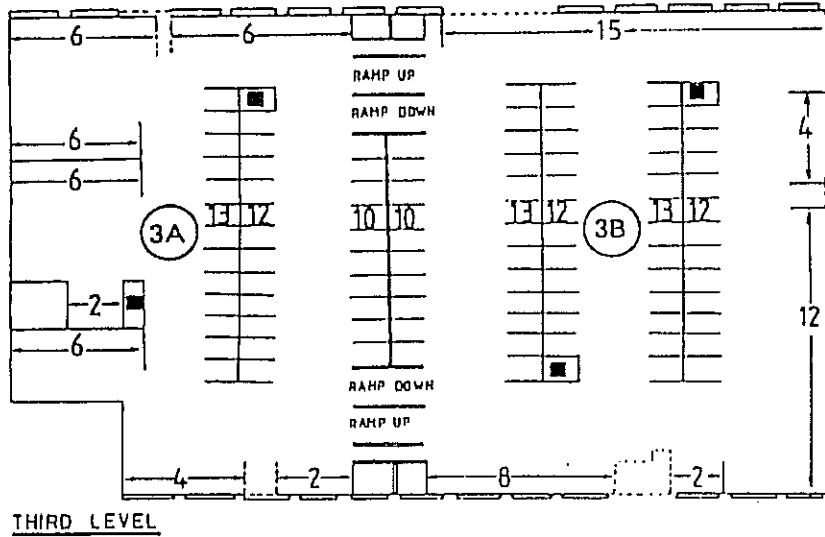

LOCATION PLAN

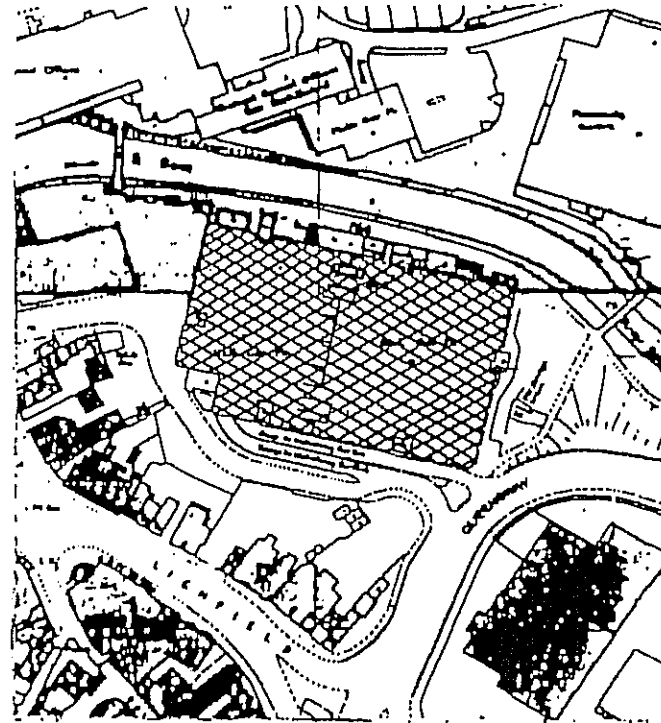

PERMIT HOLDERS & SEASON TICKETS. 174 SPACES

Stafford Borough Council	BRIDGE STREET MULTI STOREY	
Scale	Date 13.11.90	Drawing No.
Drawn	Issued	1

Civil Offices, Riverside, Stafford, ST10 3AD. Tel. 223161