

THE BOROUGH OF SLOUGH

WAITING RESTRICTIONS AND RESIDENTS' PARKING

ORDER 2006 (AMENDMENT No.1) 2007

The Council of the Borough of Slough, in exercise of the powers conferred on it under Sections 1(1) and (2), 2(1) and (2), 4, 32, 45, 51, 124 and Part IV of Schedule 9 to the Road Traffic Regulation Act 1984 ('the Act') and of all other enabling powers and after consultation with the Chief Officer of Police in accordance with Part III of Schedule 9 to the Act, hereby makes the following Order:-

1. This Order shall come into effect on the 19th February 2007 and may be cited as "The Borough of Slough Waiting Restrictions and Residents' Parking Order 2006 (Amendment No.1) 2007"
2. The Borough of Slough Waiting Restrictions and Residents' Parking Order 2006 shall have effect as though;
 - (a) Schedule 2.01 were amended by the deletion of all reference to Montem Lane;
 - (b) Schedule 3.01 were amended by the deletion of all references to Arthur Road, Beechwood Gardens, Chalvey Park, Everard Avenue, Henry Road, King Edward Street and Montem Lane;
 - (c) Schedule 3.02 were amended by the deletion of all references to Chalvey Road East, Chalvey Road West, Darvills Lane, Edwards Court, High Street, Chalvey and Oban Court;
 - (d) Schedule 4.01 were amended by the deletion of all references to Chalvey Park, Everard Avenue;
 - (e) Schedule 4.09 were amended by the deletion of all references to High Street, Chalvey;
 - (f) Schedule 8.02 were amended by the deletion of all references to Beechwood Gardens and Chalvey Park;
 - (g) Schedule 10.01 were amended by the deletion of all references to Chalvey Road East, Chalvey Road West and Church Street, Chalvey;
 - (h) Schedule 2.01 were amended by the addition of the wording in Schedule A hereto;
 - (i) Schedule 2.01 were further amended in respect of Chalvey Gardens, West side by the deletion of the wording '12 metres' and insertion in the same position of the wording '8 metres';
 - (j) Schedule 3.03 were amended by the addition of the wording in Schedule F hereto;
 - (k) Schedule 3.08 were amended by the addition of the wording in Schedule E hereto;
 - (l) Schedule 8.01 were amended by the addition of the wording in Schedule B hereto;
 - (m) Schedule 8.02 were amended by the addition of the wording in Schedule C hereto;
 - (n) Schedule 8.02 were further amended in respect of Chalvey Gardens, West side by the deletion of the wording '12 metres' and the insertion in the same position of the wording '8 metres';
 - (o) Schedule 9.02 were amended by the addition of the wording in Schedule D hereto;

SCHEDULE A

NO WAITING AT ANY TIME

Arthur Road	Both sides: From its junction with Montem Lane south-westwards for 8 metres.
Beechwood Gardens North/south arm	East side: (i) From its northern end southwards for 6 metres. (ii) From its junction with Chalvey Park northwards for 8 metres. West side: From its junction with Chalvey Park northwards for 23 metres. North side: From a point 9 metres east of the western kerb line westwards and southwards for 9 metres.
East/west arm	North side: (i) From its junction with the north/south arm of Beechwood Gardens westwards for 16 metres.
Chalvey Park	North and west sides: From its junction with Windsor Road westwards and southwards to a point 36 metres north of its southern end. South side: (i) From its junction with Windsor Road westwards for 27 metres. (ii) From a point 36 metres west of its junction with Windsor Road westwards for 8 metres. (iii) From a point 107 metres west of its junction with Windsor Road westwards for 10 metres. (iii) From a point 157 metres west of its junction with Windsor Road westwards for 24 metres.
Chalvey Road East	Both sides: Between its junctions with Windsor Road and its junction with Chalvey Road West.
Chalvey Road West	Both sides: Between its junction with Chalvey Road East and its junction with Church Street, Chalvey but excluding the lay-by on the north side between Darvills Lane and King Edwards Street and on the south side between Alexandra Road and High Street, Chalvey.
Church Street, Chalvey	Both sides: Between its junction with Chalvey Road West and a point 18 metres west of Newbery Way.
Clive Court	Both sides: From its junction with High Street westwards for 8 metres.
Darvills Lane	East side: (i) From its junction with Chalvey Road West northwards for 34 metres. (ii) From a point 54 metres north of its junction with Chalvey Road West northwards for 15 metres. (iii) From a point 76 metres north of its junction with Chalvey Road West northwards for 29 metres.

	South-west side: From its junction with High Street north-westwards for 19 metres.
Turton Way	North-east side: (i) From its junction with High Street south-eastwards for 42 metres. (ii) From its junction with Alexandra Road north-westwards for 4 metres. South-west side: From its junction with High Street to its junction with Alexandra Road.

SCHEDULE B

RESIDENTIAL ADDRESSES ELIGIBLE FOR THE ISSUE OF RESIDENT PARKING PERMITS

ZONE	ROAD NAME	ADDRESSES ELIGIBLE FOR PERMITS
AG	Beechwood Gardens Chalvey Park	Both sides for its entire length Both sides for its entire length
P1	Darvills Lane	Odds - Nos.1 to 23 Evens - Nos.4 and 6
P4	Everard Avenue	Both sides: For its entire length.
P2	High Street, Chalvey	Nos.16 to 31
P3	Turton Way	Both sides: For its entire length.

SCHEDULE C

LENGTHS OF ROADS DESIGNATED AS PARKING PLACES FOR RESIDENT PERMIT HOLDERS

ZONE	ROAD NAME	LOCATION	POSITION	TIMES OF OPERATION
A	Beechwood Gardens North/south arm	Central Island: (i) The carriageway immediately adjacent to and around the entire circumference of the central grassed island. (ii) From a point 6 metres south of its northern end northwards for 10 metres. North side: From a point 1 metres west of the eastern kerb line westwards for 8 metres. East side: (i) From a point 6 metres south of the northern kerb line southwards for 10 metres. West side: (i) From a point 8 metres north of the northern kerb line of the east/west arm of Beechwood Gardens northwards and	Parallel to the kerb Parallel to the kerb Parallel to the kerb Parallel to the kerb	At all times

		<p>(ii) From a point 69 metres north of its junction with Chalvey Road West northwards for 7 metres.</p> <p>West side: From a point 18 metres north of its junction with Chalvey Road West northwards for 75 metres.</p>	<p>Echelon parking.</p> <p>Parallel to the kerb</p>	
P4	Everard Avenue	<p>North side: From a point 12 metres east of its junction with Ledgers Road eastwards for 70 metres.</p>	Parallel to the kerb	Monday to Friday 9am to 5pm
P2	High Street, Chalvey (Service Road fronting Nos.16 to 31)	<p>North-west side: (i) From its junction with the access road leading to High Street south-westwards for 5 metres.</p> <p>(ii) From a point 2 metres north-east of its junction with the access road leading to High Street north-eastwards for 15 metres.</p> <p>(iii)) From a point 17 metres north-east of its junction with the access road leading to High Street north-eastwards for 9 metres.</p> <p>(iv) From a point 26 metres north-east of its junction with the access road leading to High Street north-eastwards for 7 metres.</p>	<p>Parallel to the kerb.</p> <p>Parallel to the kerb.</p> <p>Right angle to the north-western kerb.</p> <p>Parallel to the kerb.</p>	At all times
P3	Turton Way	<p>(i) From a point 42 metres south-east of its junction with High Street south-eastwards for 23 metres.</p> <p>(ii) From a point 89 metres south-east of its junction with High Street south-eastwards for 14 metres.</p>	<p>Parallel to the kerb.</p> <p>Parallel to the kerb</p>	All days 8am to 6pm

SCHEDULE D

PAY AND DISPLAY

ROAD NAME	LOCATION	POSITION	CONTROLLED DAYS	CONTROLLED HOURS	TARRIF BAND
Beechwood Gardens	<p>East side: From a point 8 metres north of its junction with Chalvey Park northwards for 11 metres.</p>	Parallel to the kerb	All days	<p>8am to 6pm</p> <p>Resident permit holders Zones 'A' and 'G' exempt</p>	B
Chalvey Park	<p>South side: (i) From a point 27 metres west of its junction with</p>	Parallel to the kerb	All days	<p>8am to 6pm</p> <p>Resident permit holders Zones</p>	B

	of its junction with High Street south-eastwards for 23 metres.		Holders exempt	holders (Zone P3) exempt	
	(ii) From a point 85 metres south-east of its junction with High Street south-eastwards for 18 metres.	Parallel to the kerb			

SCHEDULE E
NO WAITING 9AM TO 5PM
MONDAY TO FRIDAY

Everard Avenue	North side: From a point 12 metres east of its junction with Ledgers Road eastwards for 70 metres.
-----------------------	--

SCHEDULE F
NO WAITING 8AM TO 6PM MONDAY TO SATURDAY

Beechwood Gardens North/south arm	East side: From a point 19 metres north of its junction with Chalvey Park northwards to a point 16 metres south of its north end.
East/west arm	West side: From a point 23 metres north of its junction with Chalvey Park northwards to its junction with the east/west arm. North side: (i) From a point 23 metres west of its junction with the north/south arm westwards for 52 metres. (ii) From a point 61 metres west of its junction with the east/west arm of Beechwood Gardens westwards to its western end. South side: (i) From its junction with the north/south arm of Beechwood Gardens westwards for 8 metres. (ii) From a point 62 metres west of its junction with the north/south arm of Beechwood Gardens westwards to its western end.
Chalvey Park	East side: From its southern end northwards for 51 metres.
Montem Lane	North-east side: (i) From a point 25 metres north-west of its junction with Ledgers Road north-westwards for 19 metres. (ii) From a point 102 metres north-west of its junction with Ledgers Road north-westwards for 28 metres. (iii) From a point 180 metres north-west of its junction with Ledgers Road north-westwards for 62 metres.

THE BOROUGH OF SLOUGH
WAITING RESTRICTIONS AND RESIDENTS' PARKING
ORDER 2006 (AMENDMENT No.1) 2007

STATEMENT OF REASONS

Following complaints from residents regarding obstructive parking and parking by non-residents and having considered the responses received following extensive consultation with residents and other interested parties, Slough Borough Council proposes to vary existing waiting restrictions by removing those which are considered to be out of keeping with current parking habits and introducing more stringent waiting restrictions on lengths of some roads in the interests of road safety. It is also proposed to extend existing residents' parking facilities where appropriate, introduce additional residents' parking facilities in some roads and pay and display parking where it is considered necessary to regulate the length of parking by non-residents in mainly residential areas.

THIS INDEX DOES NOT FORM PART OF THE SEALED ORDER

DELETE FROM STREET INDEX

ZONE	ROAD NAME	RESTRICITION	SCHEDULE
	Arthur Road	No waiting 8am to 9pm Monday to Saturday	3.01
	Beechwood Gardens	No waiting 8am to 9pm Monday to Saturday	3.01
	Chalvey Park	No waiting 8am to 9pm Monday to Saturday	3.01
	Chalvey Road East	No waiting 8am to 7pm Monday to Saturday	3.02
	Chalvey Road West	No waiting 8am to 7pm Monday to Saturday	3.02
	Everard Avenue	No waiting 8am to 9pm Monday to Saturday	3.01
	High Street, Chalvey	Waiting limited to 20 minutes 8am to 7pm Monday to Saturday. No return within 1 hour.	4.09
	Henry Road	No waiting 8am to 9pm Monday to Saturday	3.01
	King Edward Street	No waiting 8am to 9pm Monday to Saturday	3.01
	Montem Lane	No waiting 8am to 9pm Monday to Saturday	3.01
	Oban Court	No waiting 8am to 7pm Monday to Saturday	3.02

ADD TO STREET INDEX

ZONE	ROAD NAME	RESTRICITION	SCHEDULE
	Arthur Road	No waiting at any time	2.01
	Beechwood Gardens	No waiting at any time No waiting 8am to 6pm Monday to Saturday Pay and Display	2.01 3.03 9.02
	Chalvey Park	No waiting at any time Pay and Display	2.01 9.02
	Chalvey Road East	No waiting at any time	2.01
	Chalvey Road West	No waiting at any time	2.01
P1	Darvills Lane	No waiting at any time Streets or parts of streets for the purpose of the issue of permits.	2.01 8.01
P1		Areas of highway designated as parking places with permits.	8.02
		Pay and Display	9.02
	Darvills Lane Access Road leading to Nos.20 to 42.	No waiting at any time	2.01
	Emerald Court	No waiting at any time	2.01
P4	Everard Avenue	No waiting at any time No waiting 9am to 5pm Mon to Fri Streets or parts of streets for the purpose of the issue of permits.	2.01 2.11 8.01
P4		Areas of highway designated as parking places with permits.	8.02
		Pay and Display	9.02
	Henry Road	No waiting at any time	2.01
	High Street, Chalvey	No waiting at any time Pay and Display	2.01 9.02
P2	High Street, Chalvey (Service Road fronting Nos.16 - 31)	Streets or parts of streets for the purpose of the issue of permits.	8.01
P2		Areas of highway designated as parking places with permits.	8.02
	Montem Lane	No waiting 8am to 6pm Monday to Saturday	3.03
	Oban Court	No waiting 8am to 6pm Monday to Saturday	3.03
	The Green	No waiting at any time	2.01

P3	Turton Way	No waiting at any time	2.01
		Streets or parts of streets for the purpose of the issue of permits.	8.01
P3		Areas of highway designated as parking places with permits.	8.02
		Pay and Display	9.02

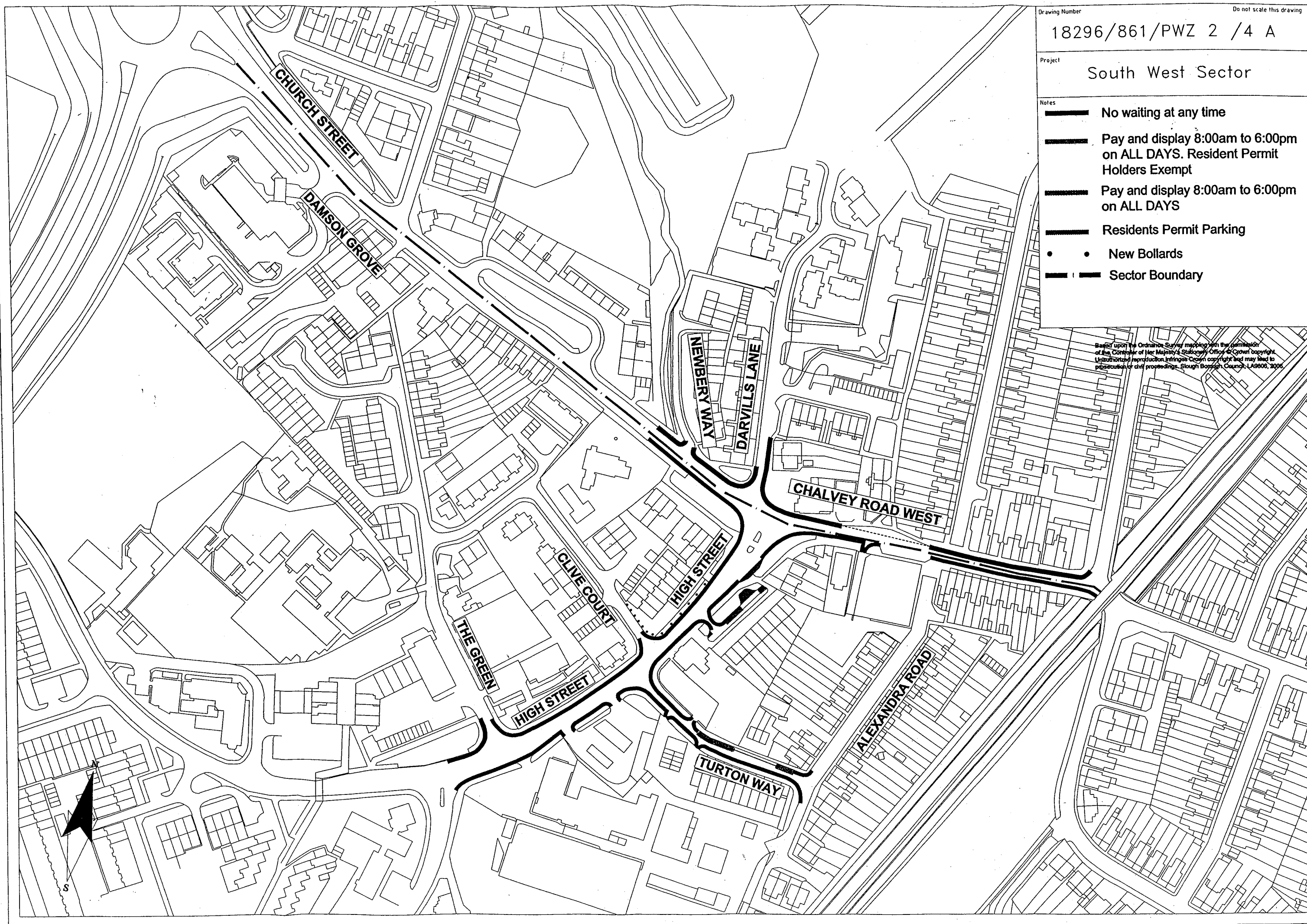

18296/861/PWZ 2 /4 A

Project South West Sector

- Notes
- No waiting at any time
 - Pay and display 8:00am to 6:00pm on ALL DAYS. Resident Permit Holders Exempt
 - Pay and display 8:00am to 6:00pm on ALL DAYS
 - Residents Permit Parking
 - New Bollards
 - Sector Boundary

Based upon the Ordnance Survey mapping with the permission of the Controller of Her Majesty's Stationery Office. Copyright. Unauthorised reproduction infringes Crown copyright and may lead to prosecution or civil proceedings. Slough Borough Council, LA9806, 2006

Drawing Number

Do not scale this drawing

18296/861/PWZ 2 /3 A

Project

South East Sector

Notes

— No waiting at any time

— | — Sector Boundary

Based upon the Ordnance Survey mapping with the permission of the Controller of Her Majesty's Stationery Office © Crown copyright. Unauthorized reproduction infringes Crown copyright and may lead to prosecution or civil proceedings. Slough Borough Council, LA9806, 2006.

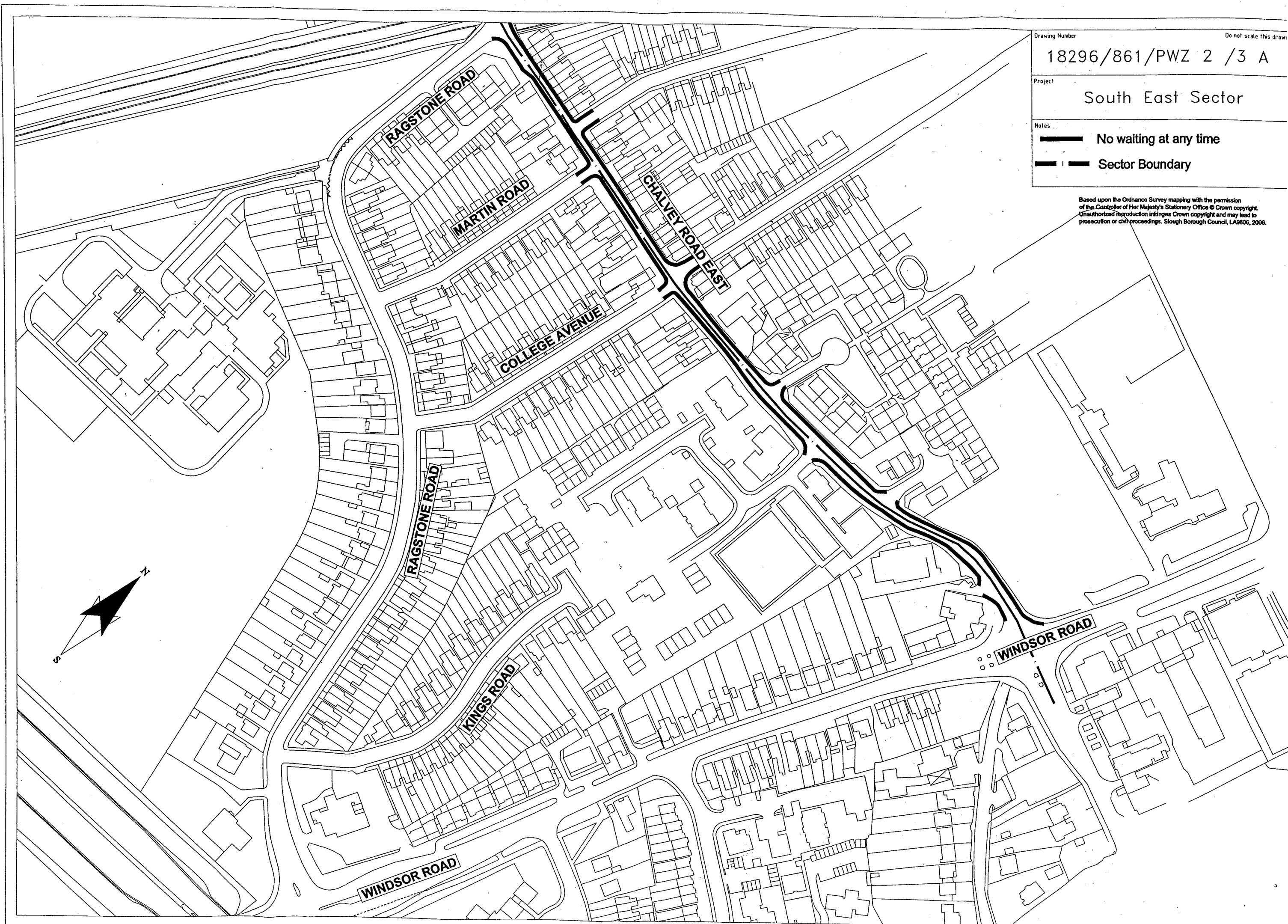

THE BOROUGH OF SLOUGH

WAITING RESTRICTIONS AND RESIDENTS' PARKING

ORDER 2006 (AMENDMENT No.1) 2007

The Council of the Borough of Slough, in exercise of the powers conferred on it under Sections 1(1) and (2), 2(1) and (2), 4, 32, 45, 51, 124 and Part IV of Schedule 9 to the Road Traffic Regulation Act 1984 ('the Act') and of all other enabling powers and after consultation with the Chief Officer of Police in accordance with Part III of Schedule 9 to the Act, hereby makes the following Order:-

1. This Order shall come into effect on the 19th February 2007 and may be cited as "The Borough of Slough Waiting Restrictions and Residents' Parking Order 2006 (Amendment No.1) 2007"
2. The Borough of Slough Waiting Restrictions and Residents' Parking Order 2006 shall have effect as though;
 - (a) Schedule 2.01 were amended by the deletion of all reference to Montem Lane;
 - (b) Schedule 3.01 were amended by the deletion of all references to Arthur Road, Beechwood Gardens, Chalvey Park, Everard Avenue, Henry Road, King Edward Street and Montem Lane;
 - (c) Schedule 3.02 were amended by the deletion of all references to Chalvey Road East, Chalvey Road West, Darvills Lane, Edwards Court, High Street, Chalvey and Oban Court;
 - (d) Schedule 4.01 were amended by the deletion of all references to Chalvey Park, Everard Avenue;
 - (e) Schedule 4.09 were amended by the deletion of all references to High Street, Chalvey;
 - (f) Schedule 8.02 were amended by the deletion of all references to Beechwood Gardens and Chalvey Park;
 - (g) Schedule 10.01 were amended by the deletion of all references to Chalvey Road East, Chalvey Road West and Church Street, Chalvey;
 - (h) Schedule 2.01 were amended by the addition of the wording in Schedule A hereto;
 - (i) Schedule 2.01 were further amended in respect of Chalvey Gardens, West side by the deletion of the wording '12 metres' and insertion in the same position of the wording '8 metres';
 - (j) Schedule 3.03 were amended by the addition of the wording in Schedule F hereto;
 - (k) Schedule 3.08 were amended by the addition of the wording in Schedule E hereto;
 - (l) Schedule 8.01 were amended by the addition of the wording in Schedule B hereto;
 - (m) Schedule 8.02 were amended by the addition of the wording in Schedule C hereto;
 - (n) Schedule 8.02 were further amended in respect of Chalvey Gardens, West side by the deletion of the wording '12 metres' and the insertion in the same position of the wording '8 metres';
 - (o) Schedule 9.02 were amended by the addition of the wording in Schedule D hereto;