

**THE SHROPSHIRE COUNCIL (WYLE COP AND DOGPOLE, SHREWSBURY)
(VARIOUS EXPERIMENTAL RESTRICTIONS) ORDER 2020**

Shropshire Council (hereinafter referred to as "the Council"), in exercise of their powers under Sections 9 and 10 of the Road Traffic Regulation Act 1984 ("the Act"), and of all other enabling powers and after consultation with the Chief Officer of Police in accordance with Part III of Schedule 9 of the Act, hereby make the following Order:

1. This Order shall come into effect on 2 December 2020 and may be cited as The Shropshire Council (Wyle Cop and Dogpole, Shrewsbury) (Various Experimental Restrictions) Order 2020.

2. In this Order, except where the context otherwise requires, the following expressions have the meaning hereby respectively assigned to them:

"Council" means The Shropshire Council and includes any parking services contractors or authorised agent appointed by or acting on behalf of the Council for the purposes of any function under the provisions of this Order;

"parking enforcement officer" means a person employed in accordance with Section 76 of the Traffic Management Act 2004 to supervise and enforce the road traffic contraventions for which Shropshire Council is the enforcement authority;

"collection of cash or valuables" means vehicles owned by banks, security companies or similar organisations actively being used for the purposes of loading or unloading money or other valuables from properties adjacent to the highway on which the vehicle is parked;

"enactment" means any enactment, whether public, general or local, and includes any order, byelaw rule, regulation, scheme or other instrument having effect by virtue of an enactment;

"goods" means goods of any kind whether animate or inanimate and includes postal packets of any description;

"wait" and "waiting" refer to the stopping of a vehicle and it remaining at rest for some time whether or not the driver is still in the vehicle;

3. Any reference in this Order to a numbered Article or Schedule shall, unless the context requires otherwise, be construed as a reference to the Article bearing that number in this Order.
4. Any reference in this Order to any enactment shall be construed as a reference to that enactment as amended, applied, consolidated, re-enacted by or as having effect by virtue of any subsequent enactment.
5. The Interpretation Act 1978 shall apply to the interpretation of this Order as it applies for the interpretation of an Act of Parliament and as if for the purposes of Section 21 of that Act this Order were an Act of Parliament and the Orders revoked by this Order were Acts of Parliament thereby repealed.
6. The restrictions imposed by this Order shall be in addition to and not in derogation from any restriction or requirements imposed by any regulations

made or having effect as if made under the Act of 1984 or by or under any other enactment.

7. If a court, the Department for Transport, the Traffic Penalty Tribunal or the Traffic Enforcement Centre declares any part of this Order to be invalid or unenforceable, such declaration shall not invalidate the remainder of the Order.
8. No person shall cause or permit any motor vehicle proceeding on Dogpole to make a right turn onto Wyle Cop in Shrewsbury, between the hours of 11am and 4pm.
9. Save as provided in Article 10, no person shall use, cause or permit any motor vehicle to proceed in the length of road specified in Schedule 1, between the hours of 11am and 4pm.
10. Nothing in Article 9 shall make it unlawful to use, cause or permit any vehicle to proceed in the said length of road referred to in that Article if the vehicle is, or is being used:
 - a) in connection with the carrying out on, or on premises situated on or adjacent to the said length of road of any of the following operations, namely:
 - i) the removal of any obstruction to traffic;
 - ii) the maintenance, improvement or reconstruction of the said length of road;
 - iii) the laying, erection, alteration or repair in, or in land adjacent to the said length of road, of any sewer or of any main, pipe or apparatus for the supply of gas, water, electricity or of any telecommunications apparatus as defined in paragraph 1(1) of the Telecommunications Code contained in Schedule 2 of the Telecommunications Act 1984;
 - b) in an emergency for fire brigade, ambulance or police purposes;
 - c) in the service of a local authority, or a water undertaker or sewerage undertaker, or the Environment Agency in pursuance of statutory powers or duties.
11. The waiting restrictions listed in Schedule 2 are hereby suspended for the duration of this experimental order.
12. Save as provided in Article 13, no person shall except upon the direction or with the permission of a police constable in uniform or of a parking enforcement officer, cause or permit any vehicle to wait on any of the sides of road specified within Schedule 3.
13. (1) Nothing in Article 12 of this Order shall render it unlawful to cause or permit any vehicle to wait in the road or in any of the lengths of road or on any of the sides of road referred to in that Article, as the case may be, for so long as may be necessary to enable :-
 - (a) a person to board or alight from the vehicle;

- (b) the vehicle, if it cannot conveniently be used for such purpose in any other road, to be used in connection with any of the following operations, namely:-
 - i) building, industrial or demolition operations;
 - ii) the removal of any obstruction to traffic;
 - iii) the maintenance, improvement or reconstruction of said lengths of roads or sides of roads; or
 - iv) the laying, erection, alteration or repair in, or in land adjacent to said lengths of roads or sides of roads of any sewer of any main, pipe or apparatus for the supply of gas, water or electricity or of any Telecommunications apparatus as defined in paragraph 1(1) of the Telecommunications Code contained in Schedule 2 of the Telecommunications Act 1984;
 - (c) the vehicle, if it cannot conveniently be used for such purpose in any other road, to be used in the service of a local authority, or a water undertaker or sewerage undertaker or the Environmental Agency in pursuance of statutory powers or duties;
 - (d) the vehicle to be used for the purpose of delivering or collecting postal packets as defined in section 125(1) of the Postal Services Act 2000;
 - (e) the vehicle to be used for fire brigade, ambulance or police purposes;
 - (f) the vehicle to take in petrol, oil, water or air from any garage situated on or adjacent to the said lengths of roads or sides of roads; or
 - (g) the vehicle to wait near at or near to any premises situated on or adjacent to said lengths of road or sides of road for so long as such waiting by that vehicle is reasonably necessary in connection with any wedding or funeral.
14. Save as provided in Article 15, the side of road specified in Schedule 4 is hereby designated to be used as a loading and unloading only area.
15. No person shall, except upon the direction or with the permission of a police officer or a parking enforcement officer, cause or permit any vehicle to wait in the side of road specified in Schedule 4 except for the loading or unloading of goods in connection with nearby trade or business premises.
16. This Order may be suspended, modified or extended by the Assistant Director - Infrastructure & Communities, or any person so authorised by them to do so.
17. The prohibitions and restrictions imposed by this order shall be in addition to and not in derogation from any restriction or requirement imposed by any

regulation made or having effect as if made under the Act or by or under any other enactment.

THE COMMON SEAL OF THE)
SHROPSHIRE COUNCIL)
was affixed hereto the 25th day) LS
of November 2020)
in the presence of)

Tim Collard
Legal Services Manager

SCHEDULE 1

Prohibition of Motor Vehicles – 11:00am-4:00pm

Length of Road in Shrewsbury in the County of Shropshire

Wyle Cop From its junction with Beeches Lane to its junction with Dogpole
in a north-westerly direction

SCHEDULE 2

SUSPENDED RESTRICTIONS

Sides of Road in Shrewsbury in the County of Shropshire

Restricted Zone – No Waiting or Loading At Any Time

Wyle Cop Between a point 10 metres west and a point 51 metres
(north side) south-east of its junction with Dogpole

Wyle Cop From its junction with High Street to a point 80.8 metres south-
(south-west side) east of its junction with Milk Street

Restricted Zone – No Waiting At Any Time, No Loading Mon – Sat 8:15am – 9:15am and 4pm – 6pm

Wyle Cop Between its junction with Beeches Lane and a point 51 metres
(north side) south-east of its junction with Dogpole

Wyle Cop Between its junction with Beeches Lane and a point 119.9
(south side) metres south-east of its junction with Milk Street

Pay and Display Parking Bay 08:00-18:00

Wyle Cop Between points 80.8 metres and 107.3 metres south-east of its
(south-west side) junction with Milk Street

Loading Bay 07:30-20:00

Wyle Cop (south side) Between points 107.3 metres and 119.9 metres south-east of its junction with Milk Street

SCHEDULE 3

Restricted Zone – No Waiting or Loading At Any Time

Sides of Road in Shrewsbury in the County of Shropshire

Wyle Cop (north side) From a point 10 metres west of its junction with Dogpole to a point in line with the property boundary of No's 11 and 12 Wyle Cop

Wyle Cop (north side) From a point in line with the property boundary of No's 14 and 15 Wyle Cop to its junction with Beeches Lane

Wyle Cop (south side) From its junction with High Street to its junction with Beeches Lane

SCHEDULE 4

Loading Bay

Side of Road in Shrewsbury in the County of Shropshire

Wyle Cop (north side) From a point in line with the property boundary of No's 11 and 12 Wyle Cop to a point in line with the property boundary of No's 14 and 15 Wyle Cop

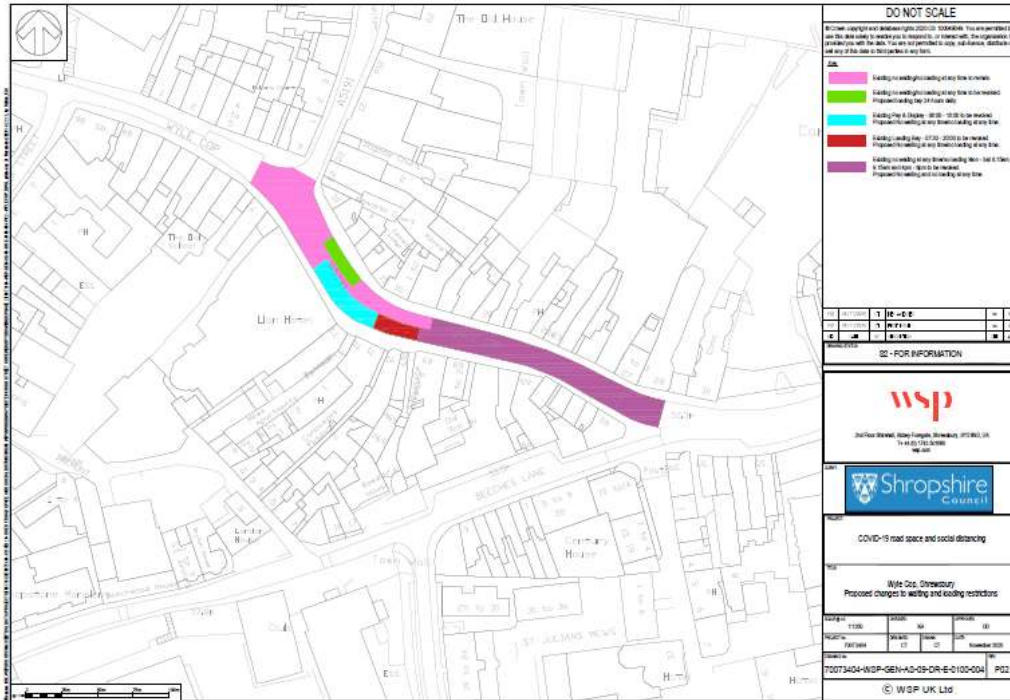

DO NOT SCALE

© Crown copyright and database rights 2020 OS. 10004946. You are permitted to use this data subject to the conditions of the Ordnance Survey Licence. This data is provided for information only and should not be used for any other purpose. All rights reserved.

Legend:

- No entry to any direction at any time
- No entry to any direction at any time to be needed from Monday 01/10/2020
- No entry to any direction at any time to be needed from Monday 01/10/2020 to be needed from Monday 01/10/2020
- No entry to any direction at any time to be needed from Monday 01/10/2020 to be needed from Monday 01/10/2020
- No entry to any direction at any time to be needed from Monday 01/10/2020 to be needed from Monday 01/10/2020

DATE	TIME	TYPE	STATUS
01/10/2020	11:00	SE - E	CP
01/10/2020	11:00	SE - E	CP
01/10/2020	11:00	SE - E	CP

SE - FOR INFORMATION

wsp

2nd Floor Bristol, 1000, Temple, Bristol, BS1 2JG, UK
T: +44 (0) 117 325 5000
www.wsp.co.uk

Shropshire Council

COVID-19 road space and social distancing

Wyle Cop, Shrewsbury
Proposed changes to existing and existing restrictions

DATE	TIME	STATUS	TYPE	STATUS
01/10/2020	11:00	CP	SE	CP
01/10/2020	11:00	CP	SE	CP
01/10/2020	11:00	CP	SE	CP

72073404-WSP-GEN-A3-03-DR-E-0100-004 P03

© WSP UK Ltd

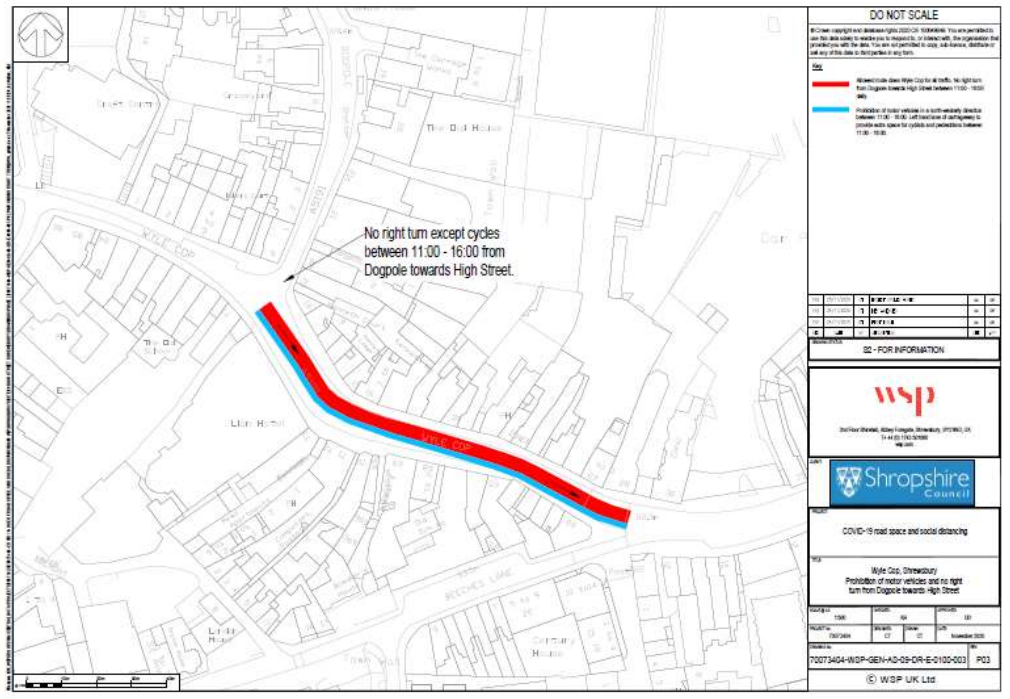

DO NOT SCALE

© Crown copyright and database rights 2020 OS. 10004946. You are permitted to use this data subject to the conditions of the Ordnance Survey Licence. This data is provided for information only and should not be used for any other purpose. All rights reserved.

Legend:

- No right turn except cycles between 11:00 - 16:00 from Dogpole towards High Street
- Prohibition of motor vehicles and no right turn from Dogpole towards High Street

DATE	TIME	TYPE	STATUS
01/10/2020	11:00	SE - E	CP
01/10/2020	11:00	SE - E	CP
01/10/2020	11:00	SE - E	CP

SE - FOR INFORMATION

wsp

2nd Floor Bristol, 1000, Temple, Bristol, BS1 2JG, UK
T: +44 (0) 117 325 5000
www.wsp.co.uk

Shropshire Council

COVID-19 road space and social distancing

Wyle Cop, Shrewsbury
Prohibition of motor vehicles and no right turn from Dogpole towards High Street

DATE	TIME	STATUS	TYPE	STATUS
01/10/2020	11:00	CP	SE	CP
01/10/2020	11:00	CP	SE	CP
01/10/2020	11:00	CP	SE	CP

72073404-WSP-GEN-A3-03-DR-E-0100-003 P03

© WSP UK Ltd