

**BOROUGH OF ROCHDALE  
((CIVIL ENFORCEMENT OF TRAFFIC CONTRAVENTIONS) (VARIOUS STREETS)  
(ROCHDALE TOWNSHIP) ORDER 2008)  
(AMENDMENT) (NO. 99) ORDER 2015**

**ROCHDALE TOWN CENTRE ON-STREET PARKING**

The Rochdale Borough Council, in exercise of its powers under Sections 1(1), 2 and 4 of the Road Traffic Regulation Act 1984 ("the Act") and of all other enabling powers, and after consultation with the Chief Officer of Police in accordance with Section 124(1) and paragraph 20(1) of Part III of Schedule 9 to the Act, hereby make the following Order:-

1. This Order may be cited as the Borough of Rochdale ((Civil Enforcement of Traffic Contraventions) (Various Streets) (Rochdale Township) Order 2008) (Amendment) (No. 99) Order 2015 and shall come into operation on 1<sup>st</sup> November 2015.
2. The Borough of Rochdale (Civil Enforcement of Traffic Contraventions) (Various Streets) (Rochdale Township) Order 2008 is hereby amended by inserting the wording shown in Schedule One to this Order.
3. Those parts of the Borough of Rochdale (Civil Enforcement of Traffic Contraventions) (Various Streets) (Rochdale Township) Order 2008, as shown in Schedule Two to this Order be hereby revoked.
4. The Interpretation Act 1978 shall apply for the interpretation of this Order as it applies for the interpretation of an Act of Parliament.

**SCHEDULE ONE**

**Schedule No. 1.1**

**No Waiting At Any Time**

**Fleece Street, Milkstone & Deeplish Ward**

(nv) the northerly side from its junction with Packer Street to its junction with King Street.

**Kelsall Street, Milkstone & Deeplish Ward**

n(i) The southerly side from its junction with Milton Street for its entire length.

n(ii) The northerly side from a point 71 metres east of its junction with Milton Street for its entire length in an easterly direction.

n(iii) The northerly side from its junction with Milton Street for a distance of 16 metres in an easterly direction.

**Nelson Street, Milkstone & Deeplish Ward**

n(i) The southerly side from a point 65 metres west of its junction with Church Lane to its junction with Packer Street.

**Packer Street, Milkstone & Deeplish Ward**

n(i) The south side from its junction with Nelson Street for a distance of 35 metres in a westerly direction.

**Vicar's Gate, Milkstone & Deeplish Ward**

n(i) the southerly side from its junction with The Esplanade for a distance of 22 metres in an easterly direction.

n(ii) the south-westerly side from a point 37 metres east of its junction with The Esplanade to its junction with Packer Street.

n(iii) The northerly side from its most westerly junction with The Esplanade for a distance of 25 metres in an easterly direction

n(iv) The north-easterly side from its junction with Packer Street to a point 49 metres south-east of its most westerly junction with The Esplanade .

n(v) The south-easterly kerbline from a point 49 metres south-east of its most westerly junction with The Esplanade to its south-westerly kerbline.

**Water Street, Milkstone & Deeplish Ward**

n(i) The south side from a point 92 metres west of its junction with Molesworth Street to its junction with Drake Street.

n(ii) The northerly side from its junction with Drake Street to its junction with Molesworth Street.

**Schedule No. 3.4**

**Waiting Limited Mon-Sat 8am-6pm 1 Hours, No Return Within 1 Hour**

**Cheetham Street, Milkstone & Deeplish Ward**

n(i) The north-east side from a point 8 metres north of its junction with East Gate Street to a point 47 metres north-west of its junction with East Gate Street.

n(ii) The south-west side from a point 8 metres north of its junction with Hunter's Lane for a distance of 33 metres in a westerly direction.

**Church Lane, Milkstone & Deeplish Ward**

n(i) The westerly side from a point 43 metres south of its junction with Fleece Street to a point 5 metres north of its junction with Nelson Street.

n(ii) The easterly side from a point 10 metres north of its junction with Nelson Street for a distance of 27 metres in a northerly direction.

**Hunter's Lane, Milkstone & Deeplish Ward**

n(i) The south side from a point 10 metres east of its junction with Reed Hill for a distance of 17 metres in an easterly direction.

n(ii) The south side from a point 7 metres west of its junction with Reed Hill for a distance of 23 metres in a westerly direction.

**King Street, Milkstone & Deeplish Ward**

n(i) The east side from a point 5 metres north of its junction with Nelson Street to a point 39 metres south of its junction with Fleece Street.

**Nelson Street, Milkstone & Deeplish Ward**

n(i) The south side from a point 9 metres west of its junction with Church Lane for a distance of 56 metres in a westerly direction.

**South Lane, Milkstone & Deeplish Ward**

n(i) The north side from a point 11 metres east of its junction with Union Street for a distance of 22 metres in an easterly direction.

**Whitehall Street, Milkstone & Deeplish Ward**

n(i) The east side from its junction with East Gate Street to a point 19 metres south of its junction with East Gate Street.

**Yorkshire Street, Milkstone & Deeplish Ward**

n(i) The north-west side from a point 11 metres north-east of its junction with Whitehall Street for a distance of 22 metres in a north-easterly direction.

n(ii) The north-west side from a point 8 metres south-west of its junction with Whitehall Street to a point 46 metres south-west of its junction with Whitehall Street.

n(iii) The north-west side from a point 10 metres south-west of its junction with Union Street for a distance of 32 metres in a south-westerly direction.

n(iv) The south-east side from a point opposite the south-westerly kerbline of Whitehall Street for a distance of 32 metres in a north-easterly direction.

n(v) The south-east side from a point 5 metres north-east of its junction with Penn Street to a point 29 metres north-east of Penn Street.

**Schedule No. 3.35**

**Waiting Limited Mon-Sat 8am-6pm 3 Hours, No Return Within 1 Hour**

**Church Lane, Milkstone & Deeplish Ward**

n(i) The west side from a point 13.6 metres south of its junction with Nelson Street to its junction with Church Stile.

**Church Stile, Milkstone & Deeplish Ward**

n(i) The north-west side from its junction with Church Lane for a distance of 54 metres in a south-westerly direction.

**Drake Street, Milkstone & Deeplish Ward**

n(i) The south westerly side from a point 42 metres north of its junction with School Lane for a distance of 19 metres in a north westerly direction.

**High Street, Milkstone & Deeplish Ward**

n(i) The south-easterly side from a point 10 metres south-west of its junction with Redcross Street to a point 86 metres south-west of Redcross Street.

n(ii) The south-easterly side from a point 10 metres north-east of its junction with Redcross Street to a point 54 metres north-east of Redcross Street.

**Kelsall Street, Milkstone & Deeplish Ward**

n(i) The northerly side from a point 16 metres east of its junction with Milton Street for a distance of 55 metres in an easterly direction

**Newgate Car Park, Milkstone & Deeplish Ward**

n(i) The north side from the west edge of the Car Park for a distance of 22.6 metres in an easterly direction.

**Oldham Road, Milkstone & Deeplish Ward**

n(i) The north easterly side from its junction with Junction Alley for a distance of 22 metres in a south easterly direction.

n(ii) The north easterly side from a point 25 metres south east of its junction with Junction Alley for a distance of 20 metres in a south easterly direction.

n(iii) The north easterly side from a point 79 metres south east of its junction with Junction Alley for a distance of 27 metres in a south easterly direction.

n(iv) The south westerly side from a point 22 metres south east of its junction with Drake Street for a distance of 67 metres in a south easterly direction.

**Packer Street, Milkstone & Deeplish Ward**

n(i) The east side from a point 59 metres south of its junction with Fleece Street to a point 3 metres north of its junction with Nelson Street.

**St Mary's Gate, Milkstone & Deeplish Ward**

n(i) The south east side from a point 20 metres south west of its junction with Howard Place to a point 60 metres south west of its junction with Howard Place.

**The Esplanade, Milkstone & Deeplish Ward**

n(i) The northerly side of the southerly carriageway from a point 73 metres south-west of the westerly channel line of The Esplanade/South Parade Roundabout for a distance of 49 metres in a south-westerly direction.

n(ii) The northerly side of the southerly carriageway from a point 39 metres south-west of the westerly channel line of The Esplanade/South Parade Roundabout for a distance of 23 metres in a south-westerly direction.

n(iii) The north side from a point 25 metres south-west of its junction with Town Meadows to a point 92 metres north-west of its junction with St Mary's Gate.

n(iv) The north side of the northerly carriageway from its junction with Town Meadows to a point 50 metres south-west of its junction with Newgate.

n(v) The south side of the northerly carriageway from a point 82 metres south west of the westerly channel line of The Esplanade/South Parade Roundabout for a distance of 37 metres in a south-westerly direction.

n(vi) The south side of the northerly carriageway from a point 20 metres south west of the westerly channel line of The Esplanade/South Parade Roundabout for a distance of 33 metres in a south-westerly direction.

**Town Hall Square, Milkstone & Deeplish Ward**

n(i) The generally triangular shaped area enclosed to the south by the northern edge of Packer Street, to the east by the western edge of Packer Street and to the north-west by Rochdale Town Hall.

**Water Street, Milkstone & Deeplish Ward**

n(i) The south side from a point 23 metres west of its junction with Molesworth Street for a distance of 27 metres in a westerly direction.

n(ii) The south side from a point 64 metres west of its junction with Molesworth Street for a distance of 6 metres in a westerly direction.

n(iii) The south side from a point 80 metres west of its junction with Molesworth Street for a distance of 12 metres in a westerly direction.

**Schedule No. 4.1**

**No Loading At Any Time**

**Fleece Street, Milkstone & Deeplish Ward**

(niii) the northerly side from its junction with Packer Street to its junction with King Street.

**Schedule No. 7.17**

**Buses Only Bay (24 hours)**

**Packer Street, Milkstone & Deeplish Ward**

n(i) The south side from a point 35 metres west of its junction with Nelson Street for a distance of 46 metres in a westerly direction.

**Schedule No. 9.1**

**Disabled Parking Place 24hr any day**

**Town Hall Square, Milkstone & Deeplish Ward**

n(i) The west side from a point 20 metres south-east of its junction with Town Hall Tower for a distance of 13 metres in a southerly direction.

**Schedule No. 9.5**

**Privileged Parking Place**

**Vicar's Gate, Milkstone & Deeplish Ward**

n(i) The north-easterly side from a point 49 metres south-east of its most westerly junction with The Esplanade for a distance of 13 metres in a north-westerly direction.

n(ii) the southerly side from a point 22 metres east of its junction with The Esplanade for a distance of 15 metres in an easterly direction.

**SCHEDULE TWO**

**Schedule No. 1.1**

**No Waiting At Any Time**

**Fleece Street, Milkstone & Deeplish Ward**

(ii) the north side from its junction with Packer Street to a point 12 metres east of its junction with Packer Street.

(niv) the northerly side from its junction with King Street for a distance of 5 metres in a westerly direction.

**Kelsall Street, Milkstone & Deeplish Ward**

both sides from its junction with Milton Street for its entire duration including the turning point.

**Nelson Street, Milkstone & Deeplish Ward**

(v) the south side from a point 65 metres west of its junction with Church Lane for a distance of 20 metres in a westerly direction.

**Packer Street, Milkstone & Deeplish Ward**

- (vi) the south side from a point 4 metres east of its junction with Vicar's Gate for a distance of 22 metres in an easterly direction.

**Vicar's Gate, Milkstone & Deeplish Ward**

- (i) both sides from a point 18 metres north-west of its junction with Packer Street for a distance of 7 metres in a north-westerly direction, before traversing the street and proceeding for 17 metres in an easterly direction.
- (ii) the north-east side from its junction with The Esplanade to its junction with Town Hall Car Park.
- (iii) the south-west side from its junction with The Esplanade for a distance of 35 metres in a south-easterly direction, before running to the north-east side for a further 8 metres.
- (iv) the south-west side from its junction with Packer Street for a distance of 7 metres in a north-westerly direction.

**Water Street, Milkstone & Deeplish Ward**

- (i) the north side from its junction with Drake Street to its junction with River Street.
- (ii) the north side from its junction with River Street for a distance of 65 metres in an easterly direction.
- (iii) the north side from a point 110 metres east of its junction with River Street to its junction with Molesworth Street.
- (iv) the south side from its junction with Drake Street to its junction with Baron Street Car Park entrance.
- (v) the south side from its junction with Baron Street for a distance of 6 metres in an easterly direction.
- (vi) the south side from a point 21 metres east of its junction with Baron Street for a distance of 110 metres in an easterly direction.

**Schedule No 7.14**

**Taxi Rank No Waiting 7pm-5am Except Taxis**

**Fleece Street, Milkstone & Deeplish Ward**

- (ni) the northerly side from a point 12 metres east of its junction with Packer Street to a point 5 metres west of its junction with King Street.

**Schedule No 9.1**

**Disabled Parking Place 24hr any day**

**Town Hall, Milkstone & Deeplish Ward**

The west side from a point 20 metres south-east of its junction with Town Hall Tower for a distance of 13 metres in a southerly direction.

**Water Street, Milkstone & Deeplish Ward**

the south side from a point 5 metres east of its junction with Baron Street for a distance of 16 metres in an easterly direction

**Schedule No. 9.7**

**Pay & Display Mon-Sat 8am-6pm Maximum Stay Up To 40 Minutes**

**Cheetham Street, Milkstone & Deeplish Ward**

- (i) The north-east side from a point 8 metres north of its junction with East Gate Street to a point 47 metres north-west of its junction with East Gate Street.
- (ii) The south-west side from a point 8 metres north of its junction with Hunter's Lane for a distance of 33 metres in a westerly direction.

**Church Lane, Milkstone & Deeplish Ward**

- n(i) The westerly side from a point 43 metres south of its junction with Fleece Street to a point 5 metres north of its junction with Nelson Street.
- n(ii) The easterly side from a point 10 metres north of its junction with Nelson Street for a distance of 27 metres in a northerly direction.
- (iv) The west side from a point 13.6 metres south of its junction with Nelson Street to its junction with Church Stile.

**Church Stile, Milkstone & Deeplish Ward**

The north-west side from its junction with Church Lane for a distance of 54 metres in a south-westerly direction.

**Drake Street, Milkstone & Deeplish Ward**

- n(i) The south westerly side from a point 42 metres north of its junction with School Lane for a distance of 19 metres in a north westerly direction.

**Fleece Street, Milkstone & Deeplish Ward**

- n(i) The northerly side from a point 12 metres east of its junction with Packer Street to a point 5 metres west of its junction with King Street.

**Hunter's Lane, Milkstone & Deeplish Ward**

- (i) The south side from a point 10 metres east of its junction with Reed Hill for a distance of 17 metres in an easterly direction.
- (ii) The south side from a point 7 metres west of its junction with Reed Hill for a distance of 23 metres in a westerly direction.

**King Street, Milkstone & Deeplish Ward**

The east side from a point 5 metres north of its junction with Nelson Street to a point 39 metres south of its junction with Fleece Street.

**Nelson Street, Milkstone & Deeplish Ward**

The south side from a point 9 metres west of its junction with Church Lane for a distance of 56 metres in a westerly direction.

**Newgate Car Park, Milkstone & Deeplish Ward**

- (i) The north side from a point 5 metres west of the east edge of the Car Park for a distance of 30 metres in a westerly direction.
- (ii) The north side from the west edge of the Car Park for a distance of 22.6 metres in a westerly direction.

**Oldham Road, Milkstone & Deeplish Ward**

- n(i) The north easterly side from its junction with Junction Alley for a distance of 22 metres in a south easterly direction.

n(ii) The north easterly side from a point 25 metres south east of its junction with Junction Alley for a distance of 20 metres in a south easterly direction.

n(iii) The north easterly side from a point 79 metres south east of its junction with Junction Alley for a distance of 27 metres in a south easterly direction.

n(iv) The south westerly side from a point 22 metres south east of its junction with Drake Street for a distance of 67 metres in a south easterly direction.

**Packer Street, Milkstone & Deeplish Ward**

(i) The south side from a point 35 metres west of its junction with Nelson Street for a distance of 43 metres in a westerly direction.

(ii) The south side from a point 8 metres west of its junction with Nelson Street for a distance of 20 metres in a westerly direction.

**South Lane, Milkstone & Deeplish Ward**

The north side from a point 11 metres east of its junction with Union Street for a distance of 22 metres in an easterly direction.

**St Mary's Gate, Milkstone & Deeplish Ward**

(i) The south east side from a point 20 metres south west of its junction with Howard Place to a point 60 metres south west of its junction with Howard Place.

**Water Street, Milkstone & Deeplish Ward**

(i) The north side from a point 66 metres east of its junction with River Street for a distance of 45 metres in an easterly.

(ii) The south side from a point 22 metres west of its junction with Molesworth Street for a distance of 27 metres in a westerly direction.

(iii) The south side from a point 64 metres west of its junction with Molesworth Street for a distance of 6 metres in a westerly direction.

(iv) The south side from a point 80 metres west of its junction with Molesworth Street for a distance of 12 metres in a westerly direction.

(v) The south side from a point 109 metres west of its junction with Molesworth Street for a distance of 5 metres in a westerly direction.

(vi) The south side from a point 118 metres west of its junction with Molesworth Street for a distance of 22 metres in a westerly direction.

(vii) The south side from a point 146 metres west of its junction with Molesworth Street for a distance of 8 metres in a westerly direction.

**Whitehall Street, Milkstone & Deeplish Ward**

The east side from its junction with East Gate Street to a point 19 metres south of its junction with East Gate Street.

**Yorkshire Street, Milkstone & Deeplish Ward**

(i) The north-east side from a point 11 metres north-east of its junction with Whitehall Street for a distance of 22 metres in a north-easterly direction.

(ii) The north-west side from a point 8 metres west of its junction with Whitehall Street to a point 46 metres south-west of its junction with Whitehall Street.



# Key

- Schedule 1.1
- Schedule 3.4
- Schedule 3.35
- Schedule 4.1
- Schedule 7.17
- Schedule 9.1
- Schedule 9.5

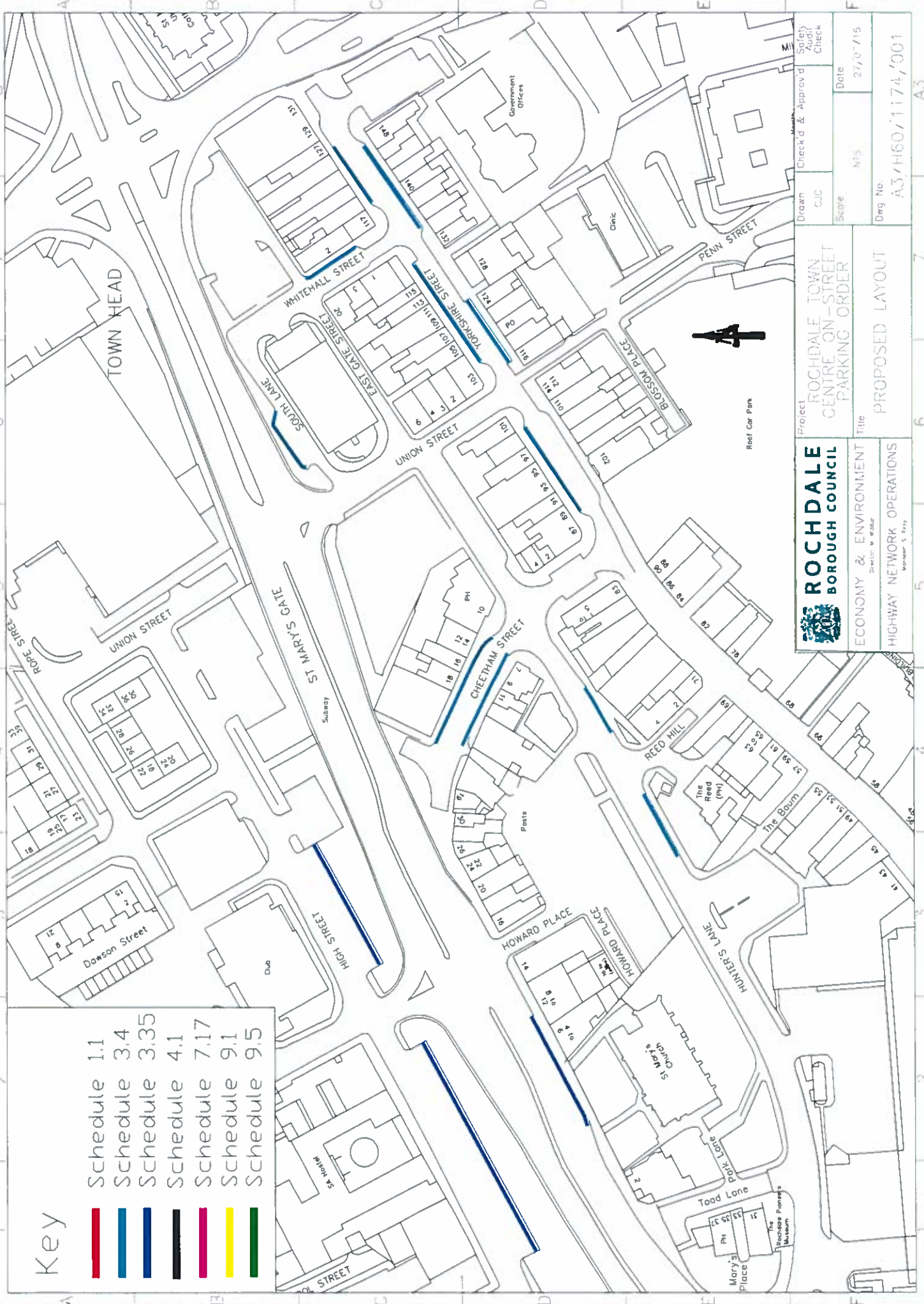

**ROCHDALE**  
BOROUGH COUNCIL

ECONOMY & ENVIRONMENT  
Director of Roads

HIGHWAY NETWORK OPERATIONS  
November 5 2015

|         |  |
|---------|--|
| Project | ROCHDALE TOWN CENTRE ON-STREET PARKING ORDER |
| Title   | PROPOSED LAYOUT                              |

|       |     |                    |          |
|-------|-----|--------------------|----------|
| Drawn | CJC | Checked & Approved | MW       |
| Scale | N/S | Date               | 27/07/15 |
| Drawn | CJC | Safety Audit       | Check    |
| Scale | N/S | Date               | 27/07/15 |

Drawn: CJC  
Scale: N/S  
Date: 27/07/15  
Checked & Approved: MW  
Safety Audit: Check

Project: ROCHDALE TOWN CENTRE ON-STREET PARKING ORDER  
Title: PROPOSED LAYOUT

ROCHDALE BOROUGH COUNCIL  
ECONOMY & ENVIRONMENT  
Director of Roads  
HIGHWAY NETWORK OPERATIONS  
November 5 2015

Drawn: CJC  
Scale: N/S  
Date: 27/07/15  
Checked & Approved: MW  
Safety Audit: Check

Dwg No. A3/H60/1174/001

# Key

- Schedule 1.1
- Schedule 3.4
- Schedule 3.35
- Schedule 4.1
- Schedule 7.17
- Schedule 9.1
- Schedule 9.5

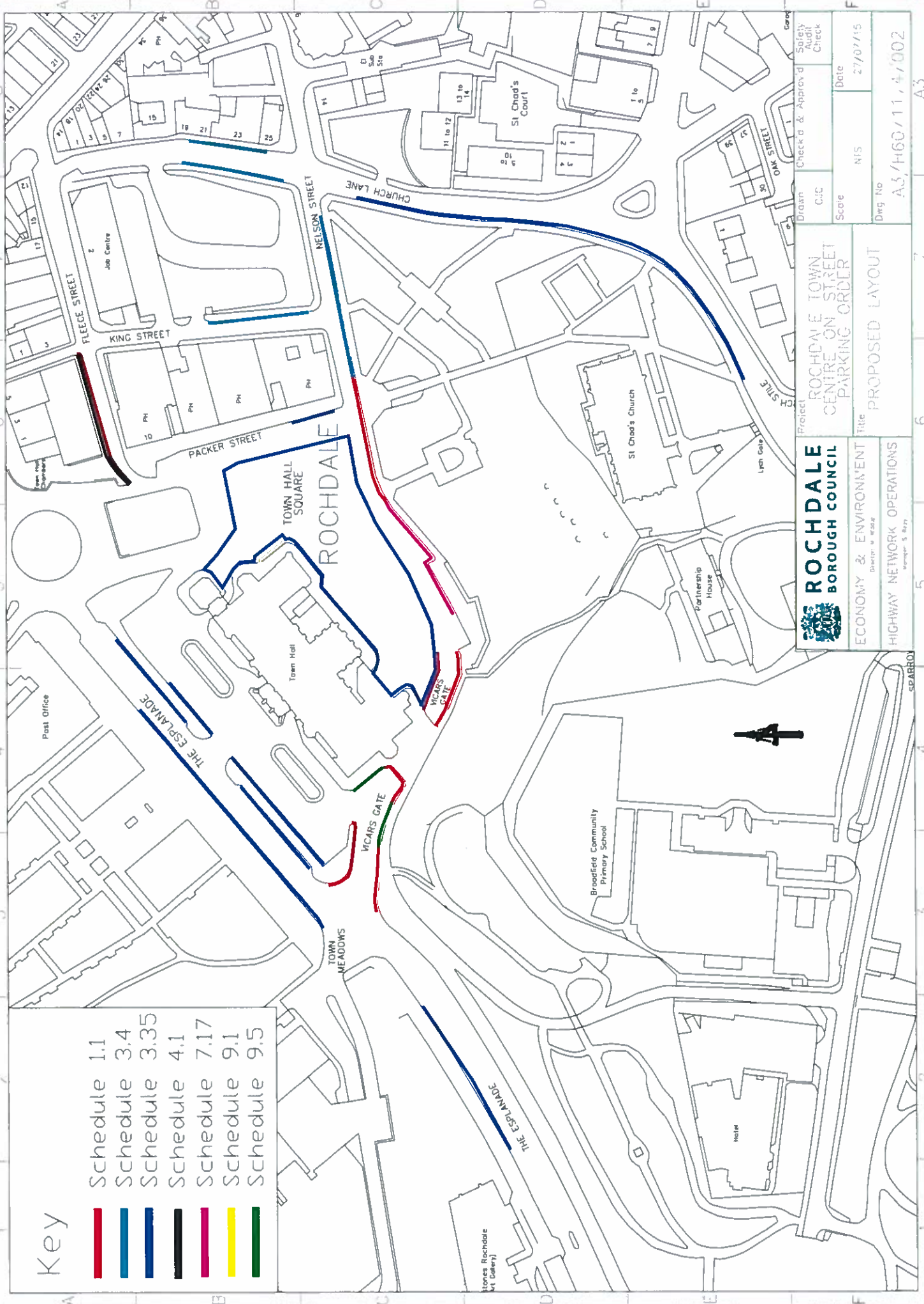

**ROCHDALE**  
BOROUGH COUNCIL

ECONOMY & ENVIRONMENT  
Director: V. Wozniak  
Manager: S. Kelly

Project: ROCHDALE TOWN CENTRE ON STREET PARKING ORDER  
Title: PROPOSED LAYOUT

Drawn: C.J.C.  
Score: NIS  
Date: 27/07/15  
Draw No: A3/H60/11,4/002

# Key

- Schedule 1.1
- Schedule 3.4
- Schedule 3.35
- Schedule 4.1
- Schedule 7.17
- Schedule 9.1
- Schedule 9.5

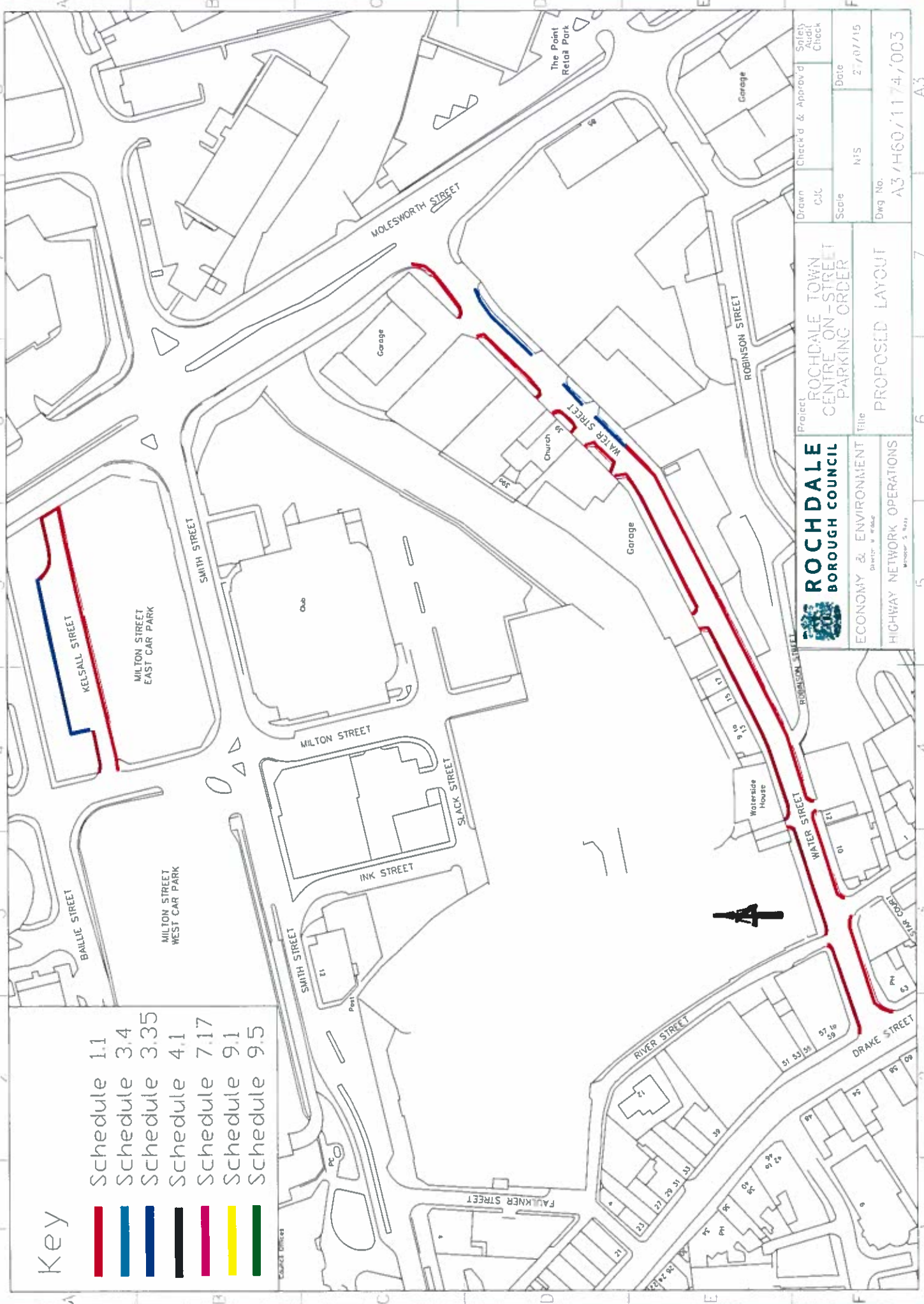

|         |                 |                    |                    |
|---------|-----------------|--------------------|--------------------|
| Drawn   | CJK             | Check d & Approved | Safety Audit Check |
| Scale   | N15             | Date               | 27/07/15           |
| Dwg No. | A3/H60/1174/003 |                    |                    |

Project  
**ROCHDALE TOWN CENTRE ON-STREET PARKING ORDER**

Title  
**PROPOSED LAYOUT**

**ROCHDALE BOROUGH COUNCIL**

ECONOMY & ENVIRONMENT  
Director of Trade

HIGHWAY NETWORK OPERATIONS  
Manager S. Hays



# Key

- Schedule 1.1
- Schedule 3.4
- Schedule 3.35
- Schedule 4.1
- Schedule 7.17
- Schedule 9.1
- Schedule 9.5

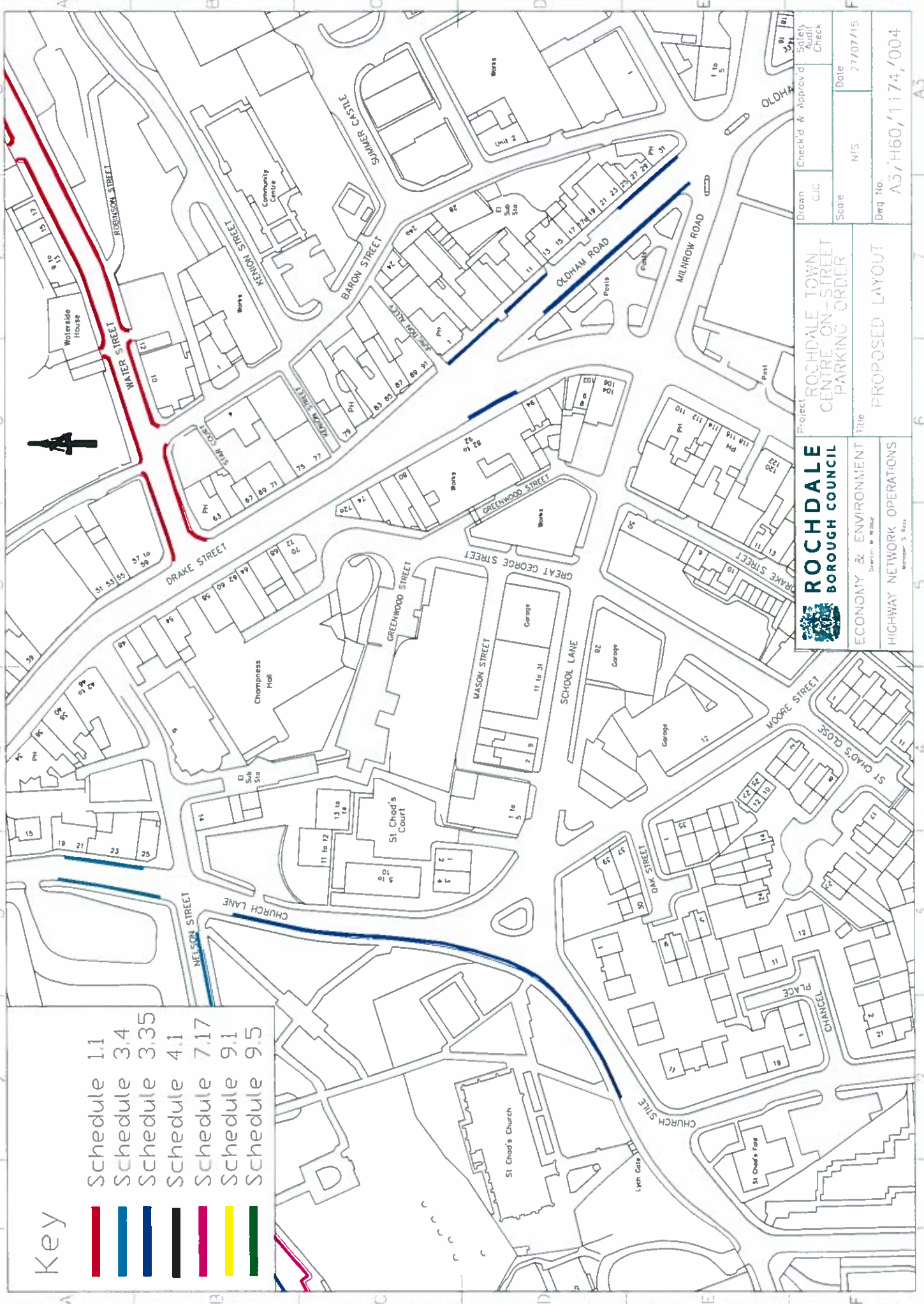

**ROCHDALE BOROUGH COUNCIL**  
 ECONOMY & ENVIRONMENT  
 Director: M. Wilson  
 Highway Network Operations  
 Manager: S. Hays

Project: **ROCHDALE TOWN CENTRE ON-STREET PARKING ORDER**  
 Title: **PROPOSED LAYOUT**

|                         |                                 |                                 |
|-------------------------|---------------------------------|---------------------------------|
| Drawn: CJC              | Check'd & Approved: [Signature] | Safety Audit Check: [Signature] |
| Scale: NTS              | Date: 27/07/15                  |                                 |
| Dwg No. A3/H60/1174/004 |                                 |                                 |

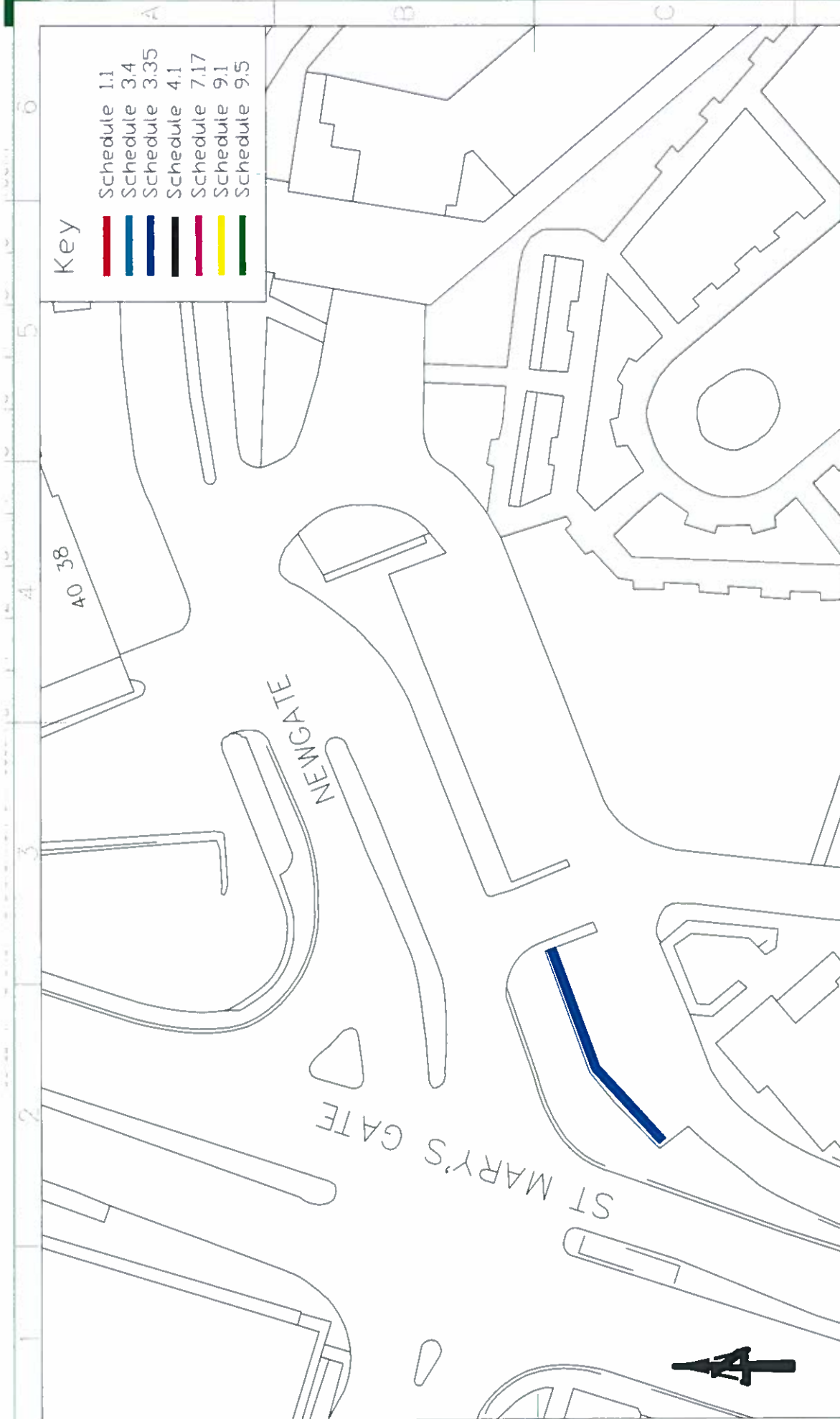

**Key**

- Schedule 1.1
- Schedule 3.4
- Schedule 3.35
- Schedule 4.1
- Schedule 7.17
- Schedule 9.1
- Schedule 9.5



**ROCHDALE**  
BOROUGH COUNCIL

ECONOMY & ENVIRONMENT  
Director: M. Widdup  
 HIGHWAY NETWORK OPERATIONS  
Manager: S. Reay

Project

ROCHDALE TOWN  
CENTRE ON-STREET  
PARKING ORDER

Title

PROPOSED LAYOUT

Drawn

CJC

Check'd & Approved

Safety  
Audit  
Check

Scale

NTS

Date

27/07/15

Dwg No.

A4/H60/1174/001

A4

- (iii) The north-west side from a point 10 metres south-west of its junction with Union Street for a distance of 32 metres in a south-westerly direction.
- (iv) The south-east side from a point opposite the south-westerly kerbline of Whitehall Street for a distance of 32 metres in an north-easterly direction.
- (v) The south-east side from a point 5 metres north-east of its junction with Penn Street to a point 29 metres north-east of Penn Street.

**Schedule No. 9.8**

**Pay & Display Mon-Sat 8am-6pm Maximum Stay Up To 10 Hours**

**Packer Street, Milkstone & Deeplish Ward**

The east side from a point 59 metres south of its junction with Fleece Street to a point 3 metres north of its junction with Nelson Street.

**The Esplanade, Milkstone & Deeplish Ward**

- (i) The northerly side of the southerly carriageway from a point 73 metres southwest of the westerly channel line of The Esplanade / South Parade Roundabout for a distance of 49 metres in a southwesterly direction.
- (iii) The north side from a point 25 metres south-west of its junction with Town Meadows to a point 92 metres north-west of its junction with St Mary's Gate.
- (iv) The north side of the northerly carriageway from its junction with Town Meadows to a point 50 metres south-west of its junction with Newgate.
- (v) The south side of the northerly carriageway from a point 82 metres south west of the westerly channel line of The Esplanade / South Parade Roundabout for a distance of 37 metres in an southwesterly direction.
- (vi) The south side of the northerly carriageway from a point 20 metres south west of the westerly channel line of The Esplanade / South Parade Roundabout for a distance of 33 metres in an southwesterly direction.
- n(i) the northerly side of the southerly carriageway from a point 39 metres south-west of the westerly channel line of The Esplanade/South Parade Roundabout for a distance of 23 metres in a south-westerly direction.

Dated this 1<sup>st</sup> day of October 2015

**THE COMMON SEAL of THE ROCHDALE**

**BOROUGH COUNCIL was hereunto affixed**

in the presence of:

  
**Authorised Signatory** 

