

**BOROUGH OF ROCHDALE
((CIVIL ENFORCEMENT OF TRAFFIC CONTRAVENTIONS) (VARIOUS STREETS)
(PENNINES TOWNSHIP) ORDER 2008)
(AMENDMENT) (NO. 43) ORDER 2014**

Smithy Bridge Road, Littleborough

The Rochdale Borough Council, in exercise of its powers under Sections 1(1), 2 and 4 of the Road Traffic Regulation Act 1984 ("the Act") and of all other enabling powers, and after consultation with the Chief Officer of Police in accordance with Section 124(1) and paragraph 20(1) of Part III of Schedule 9 to the Act, hereby make the following Order:-

1. This Order may be cited as the Borough of Rochdale ((Civil Enforcement of Traffic Contraventions) (Various Streets) (Pennines Township) Order 2008) (Amendment) (No.43) Order 2014 and shall come into operation on 1st April 2014.
2. The Borough of Rochdale (Civil Enforcement of Traffic Contraventions) (Various Streets) (Pennines Township) Order 2008 is hereby amended by inserting the wording shown in Schedule 1 to this Order.
3. That part of the Borough of Rochdale (Civil Enforcement of Traffic Contraventions) (Various Streets) (Pennines Township) Order 2008, as shown in Schedule 2 to this Order be hereby revoked.
4. The Interpretation Act 1978 shall apply for the interpretation of this Order as it applies for the interpretation of an Act of Parliament.

SCHEDULE 1

**Schedule No. 1.1
No Waiting At Any Time**

Smithy Bridge Road, Littleborough Lakeside Ward

n (ii) the south side from its junction with Walmsley Avenue to a point 45 metres south-east of its junction with Barke Street.

n (iii) the west side from a point 29 metres south-east of its junction with Eafield Road to its junction with Fletcher's Road.

**Schedule No 6.4
Cycle Lane Mandatory**

Smithy Bridge Road, Littleborough Lakeside Ward

n (i) the east side from a point 20 metres south-east of its junction Stubbley Mill Road to a point 5 metres north-west of its junction with Rose Avenue.

SCHEDULE 2

**Schedule No. 1.1
No Waiting At Any Time**

Smithy Bridge Road, Littleborough Lakeside Ward

(ix) the south side from a point 45 metres east of its junction with Barke Street for a distance of 28 metres in an easterly direction.

n (i) the south side from its junction with Little Clegg Road to a point 40 metres north-west of its junction with Walmsley Avenue.

Dated this 27th day of February 2014

THE COMMON SEAL of **THE ROCHDALE**)

BOROUGH COUNCIL was hereunto affixed)

in the presence of:)

Authorised Signatory (S)



NUMBER IN SEAL BOOK
37844

SCALE WITH CAUTION AS DISTORTION CAN OCCUR 0 1 2 3 4 5 6 7 8 9 10cm

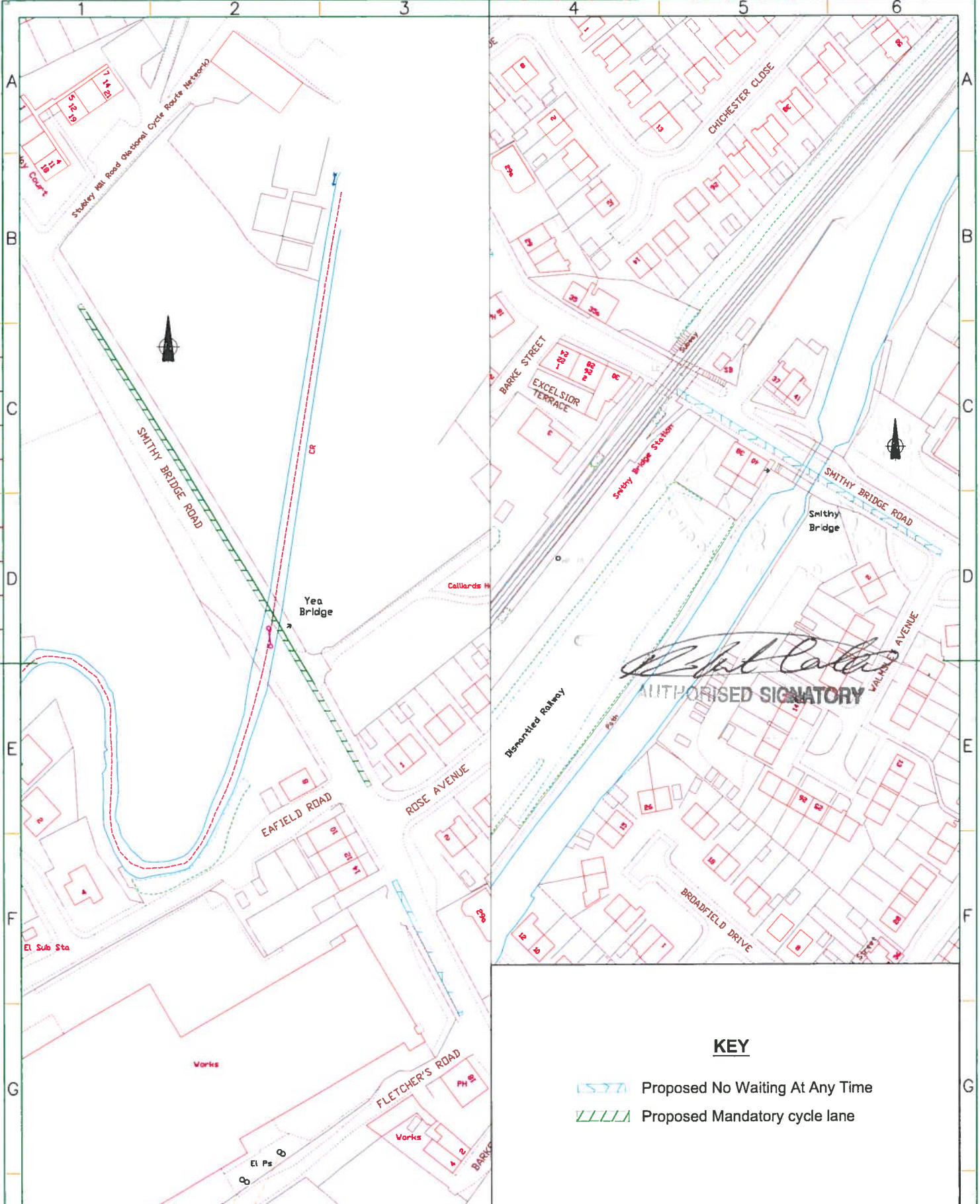

[Signature]
AUTHORISED SIGNATORY

KEY

- Proposed No Waiting At Any Time
- Proposed Mandatory cycle lane

Rochdale Metropolitan Borough Council	Project Local Sustainable Transport Fund Smithy Bridge Road, Smithy Bridge	Drawn DJS	Check'd & Approv'd *
Title Overall view of Proposed Waiting restrictions and mandatory cycle lane	Scale NTS	Date Dec 13	
HIGHWAYS & ENGINEERING SERVICE <small>Helen Smith</small>	Dwg No. H60/1129/001	A3	

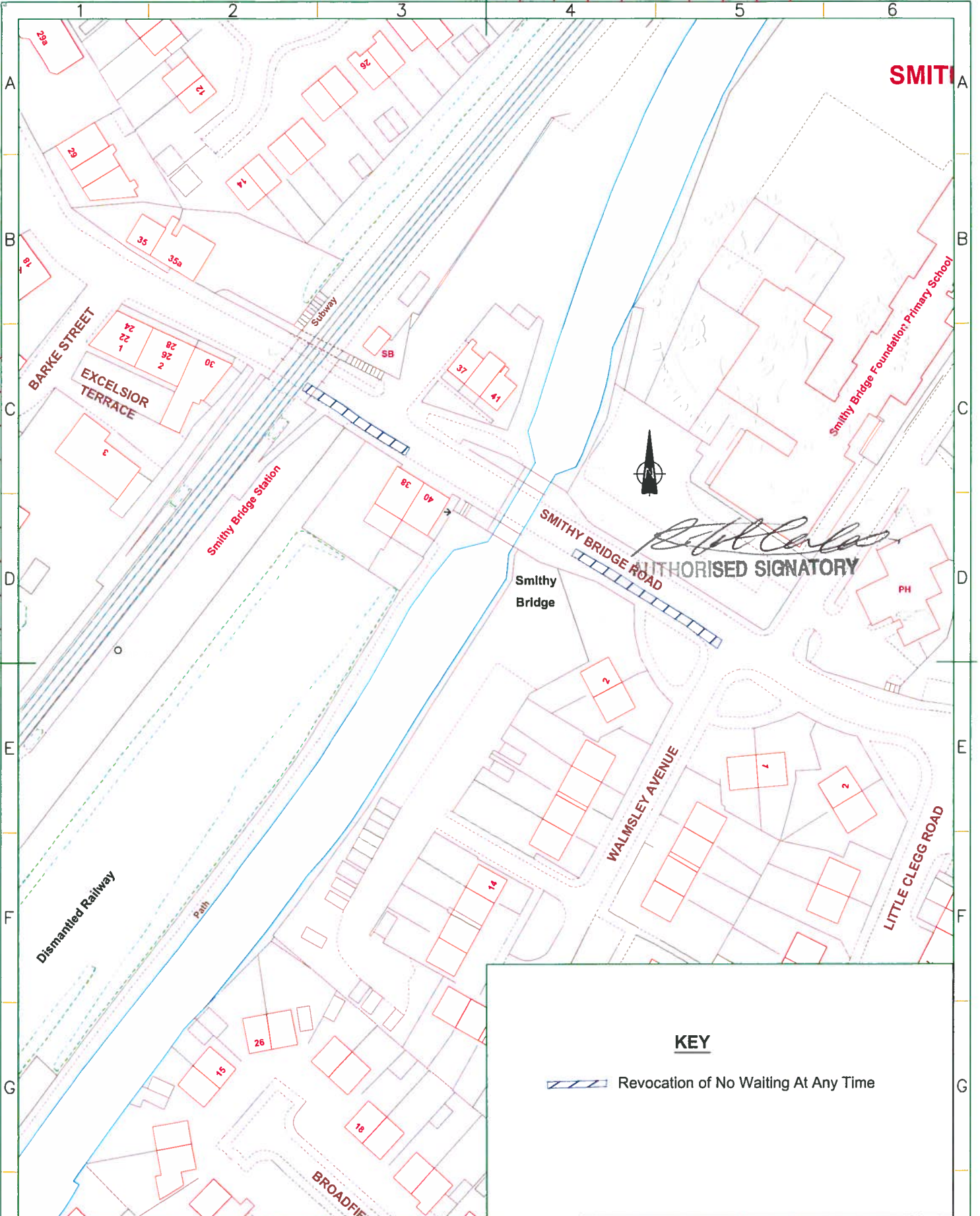

KEY

 Revocation of No Waiting At Any Time

Rochdale Metropolitan
Borough Council

Project
Local Sustainable Transport Fund
Smithy Bridge Road, Smithy Bridge

Drawn
DJS

Check'd & Approv'd
*

Scale

NTS

Date

Dec 13

HIGHWAYS & ENGINEERING SERVICE
Helen Smith

Title
Revocation of Waiting restrictions

Dwg No.

H60/1129/002

A3