

BOROUGH OF ROCHDALE
((CIVIL ENFORCEMENT OF TRAFFIC CONTRAVENTIONS) (VARIOUS STREETS)
(MIDDLETON TOWNSHIP) ORDER 2008)
(AMENDMENT) (NO. 10) ORDER 2010

MIDDLETON TOWN CENTRE AREA

The Rochdale Borough Council, in exercise of its powers under Sections 1(1), 2 and 4 of the Road Traffic Regulation Act 1984 ("the Act") and of all other enabling powers, and after consultation with the Chief Officer of Police in accordance with Section 124(1) and paragraph 20(1) of Part III of Schedule 9 to the Act, hereby make the following Order:-

1. This Order may be cited as the Borough of Rochdale ((Civil Enforcement of Traffic Contraventions) (Various Streets) (Middleton Township) Order 2008) (Amendment) (No. 10) Order 2010 and shall come into operation on 1st March 2010.
2. The Borough of Rochdale (Civil Enforcement of Traffic Contraventions) (Various Streets) (Middleton Township) Order 2008 is hereby amended by inserting the wording shown in Schedule 1 to this Order.
3. Those parts of the Borough of Rochdale (Civil Enforcement of Traffic Contraventions) (Various Streets) (Middleton Township) Order 2008, as shown in Schedule 2 to this Order be hereby revoked.
4. The Interpretation Act 1978 shall apply for the interpretation of this Order as it applies for the interpretation of an Act of Parliament.

SCHEDULE 1

Add to **Index to Schedules** the following:

7.11 Loading Only Bay(any Class of Vehicle)

Add to Article 7 the following:

7(j) any Class of Vehicle to be loaded/unloaded at any time in any of the lengths of roads specified in Schedule 7.11

SCHEDULE No 1.1

No Waiting At Any Time

Ashton Lane, North Middleton Ward

(ni) easterly side from its junction with the roundabout at Oldham Road/Ashton Lane/Assheton Way for a distance of 35 metres in a southerly direction

Assheton Way, North Middleton Ward

(ni) westerly side from its junction with the roundabout at Long Street/Market Place/Assheton Way/Eastway for a distance of 68 metres in a southerly direction

(nii) easterly side for its entire length, from its junction with the roundabout at Long Street/Market Place/Assheton Way/Eastway to its junction with the roundabout at Oldham Road/Ashton Lane/Assheton Way

Barton Road, North Middleton Ward

(ni) both Sides from its junction with Park Road to a point 57 metres north east of its junction with Manchester New Road

(nii) north westerly side from its junction with Manchester New Road for a distance of 15 metres in a north easterly direction

Eastway, North Middleton Ward

- (ni) both sides from its junction with the roundabout at Long Street/Market Place/Assheton Way/Eastway to its junction with Wood Street

Fountain Street, North Middleton Ward

- (ni) northerly side from a point 13 metres west of its junction with the unnamed access road between Long Street and Fountain Street for a distance of 5 metres in a westerly direction
- (nii) northerly side from a point 13 metres east of its junction with the unnamed access road between Long Street and Fountain Street for a distance of 5 metres in an easterly direction
- (niii) southerly side from a point 18 metres west of its junction with the unnamed access road between Long Street and Fountain Street to a point 18 metres east of its junction with the unnamed access road between Long Street and Fountain Street, including both ends of the street at these points

Long Street, North Middleton Ward

- (ni) north westerly side from its junction with Wood Street for a distance of 40 metres in a north easterly direction
- (nii) north westerly side from a point 65 metres north east of its junction with Wood Street to its junction with the roundabout at Long Street/Market Place/Assheton Way/Eastway
- (niii) south easterly side from its junction with the roundabout at Long Street/Market Place/Assheton Way/Eastway to a point 40 metres south west of its junction with the unnamed access road between Long Street and the supermarket service yard / car park
- (niv) south easterly side from a point 58 metres south west of its junction with the unnamed access road between Long Street and the supermarket service yard / car park to its junction with Wood Street
- (nv) north westerly side from its junction with the roundabout at Long Street/Market Place/Assheton Way/Eastway to a point 179 metres south of its junction with Durnford Street
- (nvi) south easterly side from its junction with the roundabout at Long Street/Market Place/Assheton Way/Eastway for a distance of 15 metres in a northerly direction

Long Street/Market Place/Assheton Way/Eastway Roundabout (including the lay-by on the northerly side), North Middleton Ward

- (ni) both sides for its entire circumference

Market Place, North Middleton Ward

- (ni) northerly side from its junction with the roundabout at Long Street/Market Place/Assheton Way/Eastway to its junction with Lodge Street
- (nii) southerly side from its junction with the roundabout at Long Street/Market Place/Assheton Way/Eastway to a point 8 metres east of its junction with Harbord Street

Oldham Road, North Middleton Ward

- (ni) both sides of the northerly carriageway from its junction with the roundabout at Manchester New Road/ Middleton Way/Oldham Road to its junction with the roundabout at Oldham Road/Assheton Way/ Ashton Lane
- (nii) northerly side from its junction with the roundabout at Oldham Road/Assheton Way/ Ashton Lane to a point 80 metres west of its junction with Townley Street
- (niii) southerly side from its junction with the roundabout at Oldham Road/Assheton Way/ Ashton Lane to a point 84 metres west of its junction with Townley Street

Oldham Road/Assheton Way/Ashton Lane Roundabout, North Middleton Ward
(ni) both sides for its entire circumference

Park Road, North Middleton Ward
(ni) both sides from its junction with Manchester New Road to its termination in a north easterly direction, including the turning circle and the turning head

Unnamed Access Road between Long Street and the Supermarket Service Yard/Car Park, North Middleton Ward
(ni) both sides from its junction with Long Street to its termination in a south easterly direction

Unnamed Access Road between Long Street and Fountain Street, North Middleton Ward
(ni) both sides for its entire length

Unnamed Road between Park Road and Oldham Road, North Middleton Ward
(ni) both sides for its entire length

Wood Street, South Middleton Ward
(ni) south westerly side from its junction with Long Street to its junction with Factory Street.

Ashton Lane, East Middleton Ward
(ni) westerly side from its junction with the roundabout at Oldham Road/Ashton Lane/Assheton Way for a distance of 35 metres in a southerly direction

Oldham Road, East Middleton Ward
(ni) both sides of the southerly carriageway from its junction with the roundabout at Manchester New Road/ Middleton Way/Oldham Road to its junction with the roundabout at Oldham Road/Assheton Way/ Ashton Lane

SCHEDULE No 4.1

No Loading At Any Time

Ashton Lane, North Middleton Ward
(ni) easterly side from its junction with the roundabout at Oldham Road/Ashton Lane/Assheton Way for a distance of 35 metres in a southerly direction.

Assheton Way, North Middleton Ward
(ni) westerly side from its junction with the roundabout at Long Street/Market Place/Assheton Way/Eastway for a distance of 68 metres in a southerly direction.
(nii) easterly side for its entire length, from its junction with the roundabout at Long Street/Market Place/Assheton Way/Eastway to its junction with the roundabout at Oldham Road/Ashton Lane/Assheton Way.

Barton Road, North Middleton Ward
(ni) both Sides from its junction with Park Road to a point 57 metres north east of its junction with Manchester New Road
(nii) north westerly side from its junction with Manchester New Road for a distance of 15 metres in a north easterly direction

Eastway, North Middleton Ward

- (ni) both sides from its junction with the roundabout at Long Street/Market Place/Assheton Way/Eastway to its junction with Wood Street

Fountain Street, North Middleton Ward

- (ni) northerly side from a point 13 metres west of its junction with the unnamed access road between Long Street and Fountain Street for a distance of 5 metres in a westerly direction
- (nii) northerly side from a point 13 metres east of its junction with the unnamed access road between Long Street and Fountain Street for a distance of 5 metres in an easterly direction
- (niii) southerly side from a point 18 metres west of its junction with the unnamed access road between Long Street and Fountain Street to a point 18 metres east of its junction with the unnamed access road between Long Street and Fountain Street, including both ends of the street at these points

Long Street, North Middleton Ward

- (ni) north westerly side from its junction with Wood Street for a distance of 40 metres in a north easterly direction
- (nii) north westerly side from a point 65 metres north east of its junction with Wood Street to its junction with the roundabout at Long Street/Market Place/Assheton Way/Eastway
- (niii) south easterly side from its junction with the roundabout at Long Street/Market Place/Assheton Way/Eastway to a point 40 metres south west of its junction with the unnamed access road between Long Street and the supermarket service yard / car park
- (niv) south easterly side from a point 58 metres south west of its junction with the unnamed access road between Long Street and the supermarket service yard / car park to its junction with Wood Street
- (nv) north westerly side from its junction with the roundabout at Long Street/Market Place/Assheton Way/Eastway to a point 179 metres south of its junction with Durnford Street
- (nvi) south easterly side from its junction with the roundabout at Long Street/Market Place/Assheton Way/Eastway for a distance of 15 metres in a northerly direction

Long Street/Market Place/Assheton Way/Eastway Roundabout (including the lay-by on the northerly side), North Middleton Ward

- (ni) both sides for its entire circumference

Market Place, North Middleton Ward

- (ni) northerly side from its junction with the roundabout at Long Street/Market Place/Assheton Way/Eastway to its junction with Lodge Street.
- (nii) southerly side from its junction with the roundabout at Long Street/Market Place/Assheton Way/Eastway to a point 8 metres east of its junction with Harbord Street.

Oldham Road, North Middleton Ward

- (ni) both sides of the northerly carriageway from its junction with the roundabout at Manchester New Road/ Middleton Way/Oldham Road to its junction with the roundabout at Oldham Road/Assheton Way/ Ashton Lane
- (nii) northerly side from its junction with the roundabout at Oldham Road/Assheton Way/ Ashton Lane to a point 80 metres west of its junction with Townley Street
- (niii) southerly side from its junction with the roundabout at Oldham Road/Assheton Way/ Ashton Lane to a point 84 metres west of its junction with Townley Street

Oldham Road/Assheton Way/Ashton Lane Roundabout, North Middleton Ward

- (ni) both sides for its entire circumference

Park Road, North Middleton Ward

- (ni) both sides from its junction with Manchester New Road to its termination in a north easterly direction, including the turning circle and the turning head

Unnamed Access Road between Long Street and the Supermarket Service Yard/Car Park, North Middleton Ward

- (ni) both sides from its junction with Long Street to its termination in a south easterly direction

Unnamed Access Road between Long Street and Fountain Street, North Middleton Ward

- (ni) both sides for its entire length

Unnamed Road between Park Road and Oldham Road, North Middleton Ward

- (ni) both sides for its entire length.

Wood Street, South Middleton Ward

- (ni) south westerly side from its junction with Long Street to its junction with Factory Street

Ashton Lane, East Middleton Ward

- (ni) westerly side from its junction with the roundabout at Oldham Road/Ashton Lane/Assheton Way for a distance of 35 metres in a southerly direction

Oldham Road, East Middleton Ward

- (ni) both sides of the southerly carriageway from its junction with the roundabout at Manchester New Road/ Middleton Way/Oldham Road to its junction with the roundabout at Oldham Road/Assheton Way/ Ashton Lane

SCHEDULE No 6.1

Bus Lane Any Day 24 Hour

Assheton Way, North Middleton Ward

- (ni) the westerly near-side lane from its junction with the roundabout at Oldham Road/Ashton Lane/Assheton Way to a point 68 metres south of its junction with the roundabout at Long Street/Market Place/Assheton Way/Eastway

Oldham Road, North Middleton Ward

- (ni) the off-side lane of the southerly carriageway from its junction with the roundabout at Oldham Road/Ashton Lane/Assheton Way for a distance of 155 metres in a westerly direction

SCHEDULE No 7.5

Taxi Rank No Waiting Anytime Except Taxis

Barton Road, North Middleton Ward

- (ni) north westerly side from a point 15 metres north east of its junction with Manchester New Road to a point 57 metres north east of its junction with Manchester New Road
- (nii) south easterly side from its junction with Manchester New Road to a point 57 metres north east of its junction with Manchester New Road

Long Street, North Middleton Ward

- (ni) north westerly side from a point 40 metres north east of its junction with Wood Street to a point 65 metres north east of its junction with Wood Street

SCHEDULE No 7.11

Loading Only Bay (any Class of vehicle)

Fountain Street, North Middleton Ward

- (ni) northerly side from its junction with the unnamed access road between Long Street and Fountain Street for a distance of 13 metres in a westerly direction
- (nii) northerly side from its junction with the unnamed access road between Long Street and Fountain Street for a distance of 13 metres in an easterly direction

Long Street, North Middleton Ward

- (ni) south easterly side from a point 40 metres south west of its junction with the unnamed access road between Long Street and the supermarket service yard / car park for a distance of 18 metres in a south westerly direction

Wood Street, North Middleton Ward

- (ni) north easterly side from a point 10 metres north west of its junction with Long Street to a point 40 metres north west of its junction with Long Street

SCHEDULE 2

SCHEDULE No 1.1

No Waiting At Any Time.

Barton Road, North Middleton Ward

both sides for its entire length

Fountain Street, North Middleton Ward

- (i) the north side from its junction with Park Road to a point 5 metres east of its north westerly termination
- (ii) the south side from its junction with Park Road to a point 43 metres west of its junction with Park Road
- (iii) the south side from a point 135 metres west of its junction with Park Road for the remainder of its length in a westerly direction including the turning head, but excluding an area of approximately 5.5 metres by 5.5 metres at the south west end

Long Street, North Middleton Ward

the south east side from the south westerly kerb line of Wood Street for a distance of 23 metres in a north easterly direction

Long Street Roundabout at Assheton Way/Eastway/Long Street/Market Place, North Middleton Ward

the north side from a point 15 metres east of its junction with Long Street to a point 30 metres east of its junction with Long Street

Long Street, North Middleton Ward

- (iv) the east side from a point 13 metres south of its junction with the roundabout at Assheton Way/Eastway/Market Place/Long Street to its junction with Park Road
- (vi) the north side from its junction with Wood Street to a point 12 metres east of its junction with Wood Street
- (vii) the north west side from a point 13 metres south west of its junction with the roundabout at Assheton Way/Market Place/Eastway/Long Street to a point 41 metres south west of its junction with the roundabout at Assheton Way/Market Place/Eastway/Long Street
- (viii) the south side from its junction with Park Road to a point 14 metres west of its junction with Park Road

Market Place, North Middleton Ward

- (i) the north side from a point 18 metres east of its junction with the roundabout at Long Street/Market Place/Assheton Way/Eastway to a point 133 metres east of its junction with the roundabout at Long Street/Market Place/Assheton Way/Eastway
- (ii) the north side from its junction with Lodge Street for a distance of 8 metres in a westerly direction
- (iii) the south side from its junction with Harbord Street to a point 8 metres east of its junction with Harbord Street
- (iv) the south side from its junction with Harbord Street to a point 30 metres west of its junction with Harbord Street

Oldham Road, East Middleton Ward

the south side from its junction with the roundabout at Manchester New Road/ Oldham Road/Middleton Way to a point 37 metres east of its junction with the roundabout at Manchester New Road/ Oldham Road/Middleton Way

Oldham Road, East Middleton Ward

(ii) the south side from a point 37 metres east of its junction with the roundabout at Manchester New Road/Middleton Way/Oldham Road to a point 20 metres west of its junction with Assheton Way/Ashton Lane/Oldham Road roundabout

Oldham Road, North Middleton Ward

the north side from its junction with the roundabout at Manchester New Road/Oldham Road/Middleton Way to a point 31 metres east of its junction with the roundabout at Manchester New Road/ Oldham Road/Middleton Way

Oldham Road, North Middleton Ward

(v) the north side from a point 31 metres east of its junction with the roundabout at Manchester New Road/Middleton Way/Oldham Road to a point 240 metres east of its junction with the roundabout at Manchester New Road/Middleton Way/Oldham Road

Park Road Car Park Access Road, North Middleton Ward

both sides for its entire length

Park Road Lay-by, North Middleton Ward

- (i) the inner side from its northerly junction with Park Road to its southerly junction with Park Road
- (ii) the north east side from a point 30 metres east of its northerly junction with Park Road to its southerly junction with Park Road

Park Road, North Middleton Ward

- (i) the north side from its junction with Long Street to its junction with Park Road Lay-by
- (ii) the north side from a point 34 metres east of its junction with Long Street to a point 59 metres east of its junction with Long Street

- (iii) the north side from its junction with Manchester New Road to its junction with Barton Road
- (iv) the north east side and southerly side from its junction with Park Road Lay-by to its junction with Manchester New Road
- (v) the north west side from its junction with Barton Road to its junction with Park Road Car Park Access Road
- (vi) the south side from its junction with Long Street to a point 50 metres east of its junction with Long Street
- (vii) the south west side from its junction with Fountain Street to a point 14 metres west of its junction with Fountain Street
- (viii) the south west side from its junction with Fountain Street to its junction with Suffield Street
- (ix) the south west side from its junction with Fountain Street to its junction with Park Road Car Park Access Road

Suffield Street, North Middleton Ward

- (i) the north side from its junction with Park Road to a point 65 metres west of its junction with Park Road
- (ii) the north side from a point 127 metres west of its junction with Park Road to a point 148 metres west of its junction with Park Road
- (iii) the north side from a point 156 metres west of its junction with Park Road to a point 164 metres west of its junction with Park Road
- (iv) the north side from a point 77 metres west of its junction with Park Road for the remainder of its length in a westerly direction
- (v) the south side from its junction with Park Road to its junction with Park Road Car Park Access Road
- (vi) the south side from its junction with Park Road Car Park Access Road for the remainder of its length in a west and then northerly direction including the turning head

Wood Street, South Middleton Ward

- (i) the south side from a point 38 metres west of its junction with Manchester New Road to its junction with Factory Street

Schedule No. 3.4

Waiting Limited Mon-Sat 8am-6pm 1 Hour, No Return Within 1 Hour

Fountain Street, North Middleton Ward

- (i) the south side from a point 85 metres west of its junction with Park Road to a point 135 metres west of its junction with Park Road
- (ii) the south side from a point 43 metres west of its junction with Park Road to a point 67 metres west of its junction with Park Road

Schedule No. 4.1

No Loading At Any Time

Long Street, North Middleton Ward

the south east side from the south westerly kerb line of Wood Street for a distance of 23 metres in a north easterly direction

Long Street, North Middleton Ward

the north west side from its junction with Wood Street to a point 12 metres north east of its junction with Wood Street

Oldham Road, East Middleton Ward
the south side from its junction with the roundabout at Manchester New Road/ Oldham Road/Middleton Way to a point 37 metres east of its junction with the roundabout at Manchester New Road/ Oldham Road/Middleton Way

Oldham Road, North Middleton Ward
the north side from its junction with the roundabout at Manchester New Road/ Oldham Road/Middleton Way to a point 31 metres east of its junction with the roundabout at Manchester New Road/Oldham Road/Middleton Way

Wood Street, South Middleton Ward
the south side from a point 38 metres west of its junction with Manchester New Road to its junction with Factory Street.

Schedule No 5.3

No Loading 8.00 - 9.00am and 4.30 - 6.00pm.

Fountain Street, North Middleton Ward
(i) the north side from its junction with Park Road to a point 41 metres west of its junction with Park Road
(ii) the south side from its junction with Park Road to a point 43 metres west of its junction with Park Road

Long Street, North Middleton Ward
(i) the north west side from a point 13 metres south west of its junction with the roundabout at Assheton Way/Market Place/Eastway/Long Street to a point 41 metres south west of its junction with the roundabout at Assheton Way/Market Place/Eastway/Long Street
(ii) the south east side from its junction with Park Road to a point 14 metres south west of its junction with Park Road

Market Place, North Middleton Ward
the south side from its junction with Harbord Street to a point 8 metres east of its junction with Harbord Street

Park Road Lay-by, North Middleton Ward
The inner side from a point 34 metres east of its junction with Long Street to a point 59 metres east of its junction with Long Street

Park Road, North Middleton Ward
(i) the north side from its junction with Long Street to a point 26 metres east of its junction with Long Street
(ii) the north side from a point 34 metres east of its junction with Long Street to a point 59 metres east of its junction with Long Street

Schedule No 5.9

No Loading Mon-Sat 8.00am-6.00pm.

Barton Road, North Middleton Ward
(i) the east side from a point 28 metres north of its junction with Park Road to a point 64 metres north of its junction with Park Road

- (ii) the north side from its junction with Manchester New Road to a point 60 metres east of its junction with Manchester New Road
- (iii) the south side from its junction with Manchester New Road to a point 95 metres east of its junction with Manchester New Road
- (iv) the west side from its junction with Park Road to a point 15 metres north of its junction with Park Road

Schedule No 5.10

No Loading 8.00-9.30am And 4.00-6.00pm

Long Street, North Middleton Ward

the east side from a point 13 metres south of its junction with the roundabout at Assheton Way/Eastway/Market Place/Long Street to its junction with Park Road

Park Road Car Park Access Road, North Middleton Ward

the west side from its junction with Park Road to a point 10 metres north of its junction with Park Road

Park Road Lay-by, North Middleton Ward

the north east side from a point 30 metres east of its northerly junction with Park Road to its southerly junction with Park Road

Park Road, North Middleton Ward

- (i) the north side from its junction with Manchester New Road to its junction with Barton Road
- (ii) the north east side and southerly side from its junction with Park Road Lay-by to its junction with Manchester New Road
- (iii) the north west side from its junction with Barton Road to its junction with Park Road Car Park Access Road
- (iv) the south side from its junction with Long Street to a point 50 metres east of its junction with Long Street
- (v) the south side from its junction with Fountain Street to a point 14 metres west of its junction with Fountain Street
- (vi) the south west side from its junction with Fountain Street to its junction with Suffield Street
- (vii) the south west side from its junction with Fountain Street to its junction with Park Road Car Park Access Road

Suffield Street, North Middleton Ward

- (i) the north side from its junction with Park Road to a point 65 metres west of its junction with Park Road
- (ii) the north side from a point 127 metres west of its junction with Park Road to a point 148 metres west of its junction with Park Road
- (iii) the north side from a point 156 metres west of its junction with Park Road to a point 164 metres west of its junction with Park Road
- (iv) the north side from a point 77 metres west of its junction with Park Road for the remainder of its length in a westerly direction
- (v) the south side from its junction with Park Road to a point 116 metres west of its junction with Park Road
- (vi) the south side from a point 110 metres west of its junction with Park Road for the remainder of its length in a west northerly direction

Schedule No 5.12

No Loading Mon-Sat 7.30am-9.30am and Mon-Fri 4pm-6.30pm.

Oldham Road, East Middleton Ward

the south side from a point 37 metres east of its junction with the roundabout at Manchester New Road/Middleton Way/Oldham Road to a point 20 metres west of its junction with Assheton Way/Ashton Lane/Oldham Road roundabout

Oldham Road, North Middleton Ward

the north side from a point 31 metres east of its junction with the roundabout at Manchester New Road/Middleton Way/Oldham Road to a point 240 metres east of its junction with the roundabout at Manchester New Road/Middleton Way/Oldham Road

Schedule No 5.17

No Loading Mon-Sat 8am-9.30am and 4pm-6pm.

Barton Road, North Middleton Ward

the east side from its junction with Park Road to a point 28 metres north of its junction with Park Road

Schedule No 6.6

24 Hour Clearway

Ashton Lane, East Middleton Ward

- (i) both sides from a point 35 metres south of the roundabout at the junction of Oldham Road/Assheton Way/Ashton Lane to the roundabout at the junction of Oldham Road/Assheton Way/Ashton Lane.

Oldham Road, East Middleton Ward

the south side from a point its junction with the roundabout at Middleton Way/Manchester Road/Oldham Road to a point 20 metres west of its junction with the roundabout at Assheton Way/Ashton Lane/Oldham Road

Ashton Lane, North Middleton Ward

- (i) both sides from a point 35 metres south of the roundabout at the junction of Oldham Road/Assheton Way/Ashton Lane to the roundabout at the junction of Oldham Road/Assheton Way/Ashton Lane

Assheton Way, North Middleton Ward

- (i) both sides from its junction with the roundabout at Oldham Road/Ashton Lane to its junction with the roundabout at Long Street/Market Place/Eastway including the terminal roundabouts

Eastway, North Middleton Ward

both sides from its junction with the roundabout at Long Street/Market Place/Assheton Way/Eastway to its junction with Wood Street

Long Street, North Middleton Ward

- (i) both sides from its junction with the roundabout at Assheton Way/Eastway/

- Market Place/Long Street to a point 13 metres south of its junction with the roundabout at Assheton Way/Eastway/Market Place/Long Street
- (ii) the east side from its junction with the roundabout at Assheton Way/Market Place/Eastway for a distance of 15 metres in a northerly direction
 - (iii) the west side from its junction with the roundabout at Assheton Way/Eastway/ Market Place to a point 179 metres south of its junction with Durnford Street

Market Place, North Middleton Ward

- (i) the north side from its junction with the roundabout at Long Street/Market Place/Assheton Way/Eastway to a point 18 metres east of its junction with the roundabout at Long Street/Market Place/Assheton Way/Eastway
- (ii) the south side from its junction with the Assheton Way/Market Place/Long Street/Eastway roundabout to a point 30 metres west of its junction with Harbord Street

Oldham Road, North Middleton Ward

- (i) the north side from its junction with the roundabout at Assheton Way/Ashton Lane/Oldham Road to a point 80 metres west of its junction with Townley Street
- (ii) the north side from a point 240 metres from the roundabout at Manchester New Road/Middleton Way/Oldham Road to its junction with the roundabout at Assheton Way/Oldham Road/Ashton Lane
- (iii) the south side from its junction with the roundabout at Assheton Way/Ashton Lane/Oldham Road to a point 84 metres west of its junction with Townley Street

Schedule No 7.1

Loading Only Bay

Long Street, North Middleton Ward

- (i) the north west side from a point 8 metres north east of its junction with Wood Street to a point 23 metres north east of its junction with Wood Street
- (ii) the north west side from a point 38 metres south west of its junction with the roundabout at Assheton Way/Market Place/Eastway/Long Street to a point 49 metres south west of its junction with the roundabout at Assheton Way/Market Place/Eastway/Long Street
- (iii) the south east side from a point 50 metres south west of its junction with Park Road to a point 68 metres south west of its junction with Park Road
- (iv) the south east side from a point 14 metres south west of its junction with Park Road to a point 35 metres south west of its junction with Park Road

Park Road, North Middleton Ward

the south side from a point 14 metres west of its junction with Fountain Street to a point 21 metres west of its junction with Fountain Street

Wood Street, North Middleton Ward

the north east side from a point 10 metres north west of its junction with Long Street to a point 40 metres north west of its junction with Long Street

Wood Street, South Middleton Ward

the south side from its junction with Manchester New Road to a point 21 metres west of its junction with Manchester New Road

Schedule No 7.5

Taxi Rank No Waiting Anytime Except Taxis

Barton Road, North Middleton Ward
both sides from its junction with Manchester New Road for a distance of 57 metres in a north easterly direction

Schedule No 9.1

Disabled Parking Place 24hr any day

Fountain Street, North Middleton Ward

- (i) both sides from a point at its westerly termination for a distance of 5 metres in a north easterly direction including the turning head (creating two spaces)
- (ii) the south side from a point 67 metres west of its junction with Park Road to a point 85 metres west of its junction with Park Road

Long Street, North Middleton Ward

- (i) the north west side from a point 49 metres south west of its junction with the roundabout to a point 85 metres south west of its junction with the roundabout
- (ii) the south east side from a point 35 metres south west of its junction with Park Road to a point 50 metres south west of its junction with Park Road

Park Road Lay-by, North Middleton Ward

the north east side from its junction with Park Road for a distance of 30 metres in a south easterly direction

Suffield Street, North Middleton Ward

the north side from a point 73 metres west of its junction with Park Road to a point 85 metres west of its junction with Park Road creating two parking bays

Wood Street, South Middleton Ward

the south side from a point 21 metres west of its junction with Manchester New Road to a point 38 metres west of its junction with Manchester New Road

Dated this 11th day of February 2010

THE COMMON SEAL of THE ROCHDALE)

BOROUGH COUNCIL was hereunto affixed)

in the presence of:

Authorised Signatory

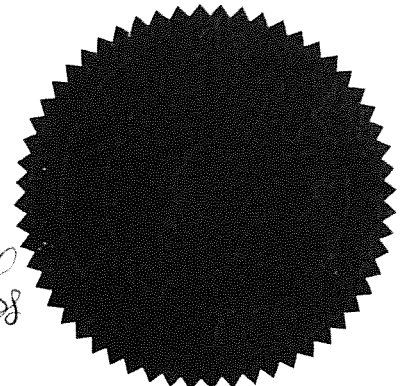

NUMBER IN SEAL BOOK
35482

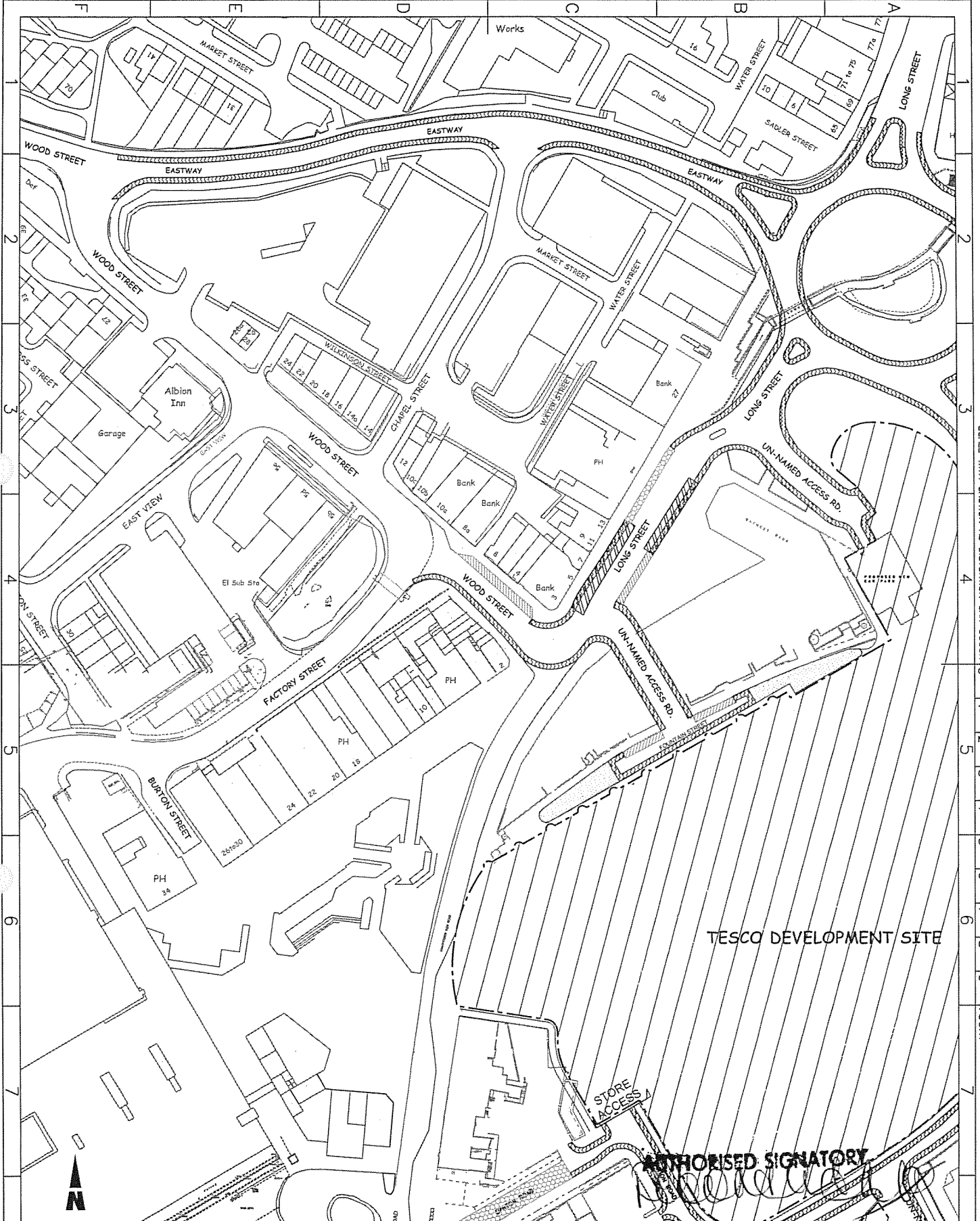

TESCO DEVELOPMENT SITE

AUTHORISED SIGNATORY

[Handwritten Signature]

KEY

	No Waiting & No Loading/Unloading At Any Time.
	Loading Only Bay, Anyday 24 Hour (Any Class of Vehicle).
	Taxi Rank, No Waiting Anytime Except Taxis.
	Bus Stop Clearway, Anyday 24 Hour (no TRO required).
	Prohibition of Vehicles.

impact Eschdale Metropolitan Borough Council working in partnership with Macclesfield Parkman and Adkins to support regeneration

HIGHWAYS AND ENGINEERING SERVICE
 Head of Service:
 D. Farrister
 B.Sc., M.B.A., C.Eng., M.I.C.E.

TRAFFIC AND ROAD SAFETY UNIT
 Manager:
 A. Shaw
 I Eng., A.M.I.C.E., F.I.H.I.E.

Project
TESCO DEVELOPMENT, MIDDLETON.

Title
PROPOSED TRAFFIC REGULATION ORDERS. (SHEET 1 OF 7)

Drawn JK	Traced •	Checked •	Safety Audit Check •
Scale 1:1000		Date Aug 2008	
Dwg No. 800256/002/2			

A3

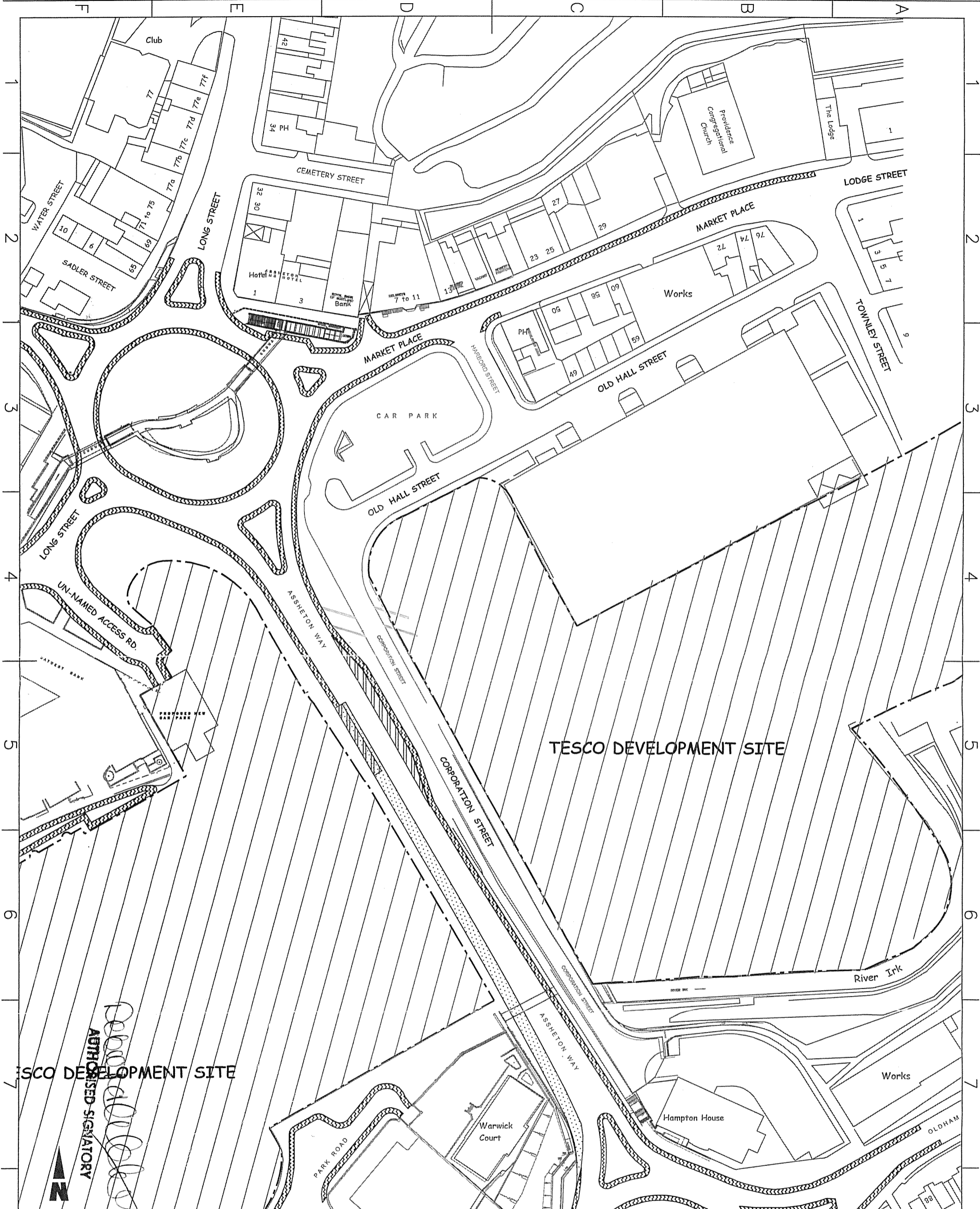

KEY

	No Waiting & No Loading/Unloading At Any Time.
	Bus Lane, Anyday 24 Hour.
	Taxi Rank, No Waiting Anytime Except Taxis.
	Bus Stop Clearway, Anyday 24 Hour (no TRO required).

impact partnership
 Rochdale Metropolitan Borough Council working in partnership with Mouchel Parkman and Agilisys to support regeneration
HIGHWAYS AND ENGINEERING SERVICE
 Head of Service:
 D. Forrester
 B.Sc., M.B.A., C.Eng., M.I.C.E.
TRAFFIC AND ROAD SAFETY UNIT
 Manager:
 A. Shaw
 I Eng., A.M.I.C.E., F.I.H.I.E.

Project
 TESCO DEVELOPMENT, MIDDLETON.
Title
 PROPOSED TRAFFIC REGULATION ORDERS. (SHEET 2 OF 6)

Drawn JK	Traced *	Checked *	Safety Audit Check *
Scale 1:1000		Date Aug 2008	
Dwg No. 800256/002/3			

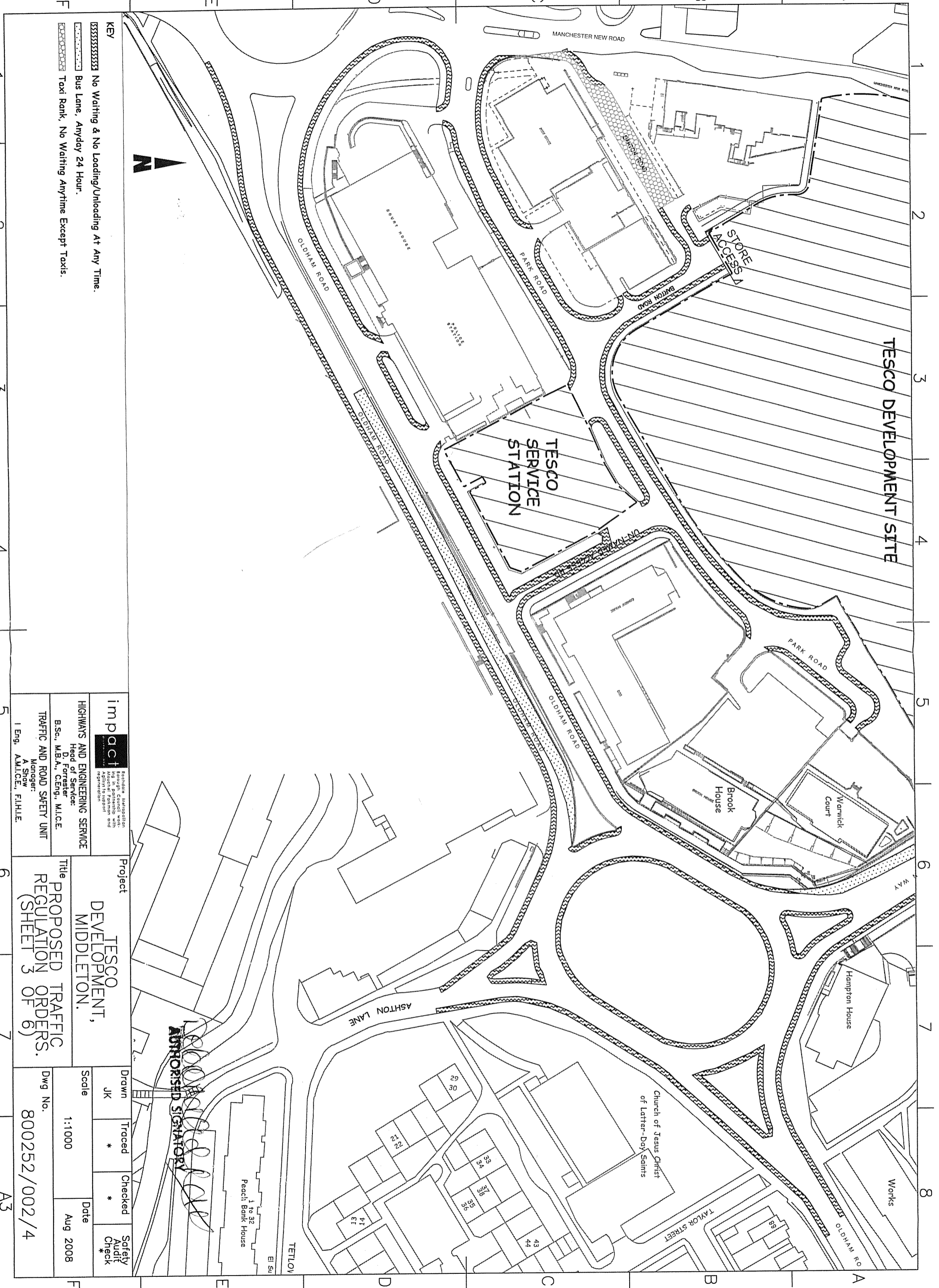

KEY No Waiting & No Loading/Unloading At Any Time. Bus Lane, Anyday 24 Hour. Taxi Rank, No Waiting Anytime Except Taxis.		impact Residential Management Ltd in Partnership with Mott MacDonald Transportation Engineering	Project TESCO DEVELOPMENT, MIDDLETON.	
			TRAFFIC AND ROAD SAFETY UNIT Manager: A Show I Eng, AM.I.C.E., FI.H.I.E.	
HIGHWAYS AND ENGINEERING SERVICE Head of Service: D. Forrester B.Sc., M.B.A., C.Eng., M.I.C.E.		Title PROPOSED TRAFFIC REGULATION ORDERS. (SHEET 3 OF 6)		
Drawn JK		Traced *		Checked *
Scale 1:1000		Date Aug 2008		
Dwg No. 800252/002/4		Safety Audit Check *		

[Signature]
 AUTHORIZED SIGNATORY

1 to 32
 Peach Bank House
 El Su

TETLOY

29
 30
 31
 32
 33
 34
 35
 36
 37
 38
 39
 40
 41
 42
 43
 44
 45

Church of Jesus Christ
 of Latter-Day Saints

TAYLOR STREET

OLDHAM RO

Works

Hampton House

Brook House

Warwick Court

TESCO
 SERVICE
 STATION

TESCO DEVELOPMENT SITE

STORE
 ACCESS

MANCHESTER NEW ROAD

PARK ROAD

BAYTON ROAD

OLDHAM ROAD

ASHTON LANE

PARK ROAD

OLDHAM ROAD

WAY

