

REDCAR AND CLEVELAND BOROUGH COUNCIL
(DORMANSTOWN, GRANGETOWN, LAZENBY AND SOUTH BANK)
(WAITING AND LOADING AND PARKING PLACES)
(CONSOLIDATION) (AMENDMENT) ORDER (NO. 1) 2004

The Council of the Borough of Redcar and Cleveland (hereinafter referred to as 'The Council') under Sections 1, 2, 4, 32, 35, 45, 46, 47, 53 and Part IV of Schedule 9 of the Road Traffic Regulations Act 1984 (hereinafter referred to as the 'Act of 1984') and of all other enabling powers and after consultation with the Chief Officers of Police in accordance with Part III of Schedule 9 of the Act of 1984 hereby makes the following Orders:-

1. This Order shall come into operation on the *20th* day of *September* 2004 and may be cited as the Redcar and Cleveland Borough Council (Dormanstown, Grangetown, Lazenby and south Bank) (Waiting and Loading and Parking Places) (Consolidation) (Amendment) Order (No. 1) 2004.
2. The Redcar and Cleveland Borough Council (Dormanstown, Grangetown, Lazenby and South Bank) (Waiting and Loading and Parking Places) (Consolidation) Order 2003 ("the Order") is hereby amended as follows:-

- (a) Insert to Dormanstown – Schedule No. 1. – No waiting at anytime:-

LIMERICK ROAD

North Side. From the western side of the access gate approximately 152 metres west of Ennis Road for a distance of 15 metres in a westerly direction.

From the access gate approximately 214 metres west of its junction with Ennis Road for a distance of 15 metres in an easterly direction and 15 metres in a westerly direction.

- (b) Save as provides in Article 45 and 46 of "the Order". No person shall, except upon the direction or with the permission of a Police Officer in uniform or of a Parking Attendant, permit any vehicle to wait between the hours of 8:30 a.m. to 9:30 a.m. and 2:45 p.m. to 3:45 p.m. Monday to Friday, in the sides and lengths of road specified in Schedule 2.12 hereto.
- (c) Save as provided in Article 49 "of the Order" no person shall except upon the direction of or with the permission of a Police Officer in uniform or a Parking Attendant cause or permit any vehicle to wait for the purpose of loading and unloading between the hours of 8:30 a.m. to 9:30 a.m. and 2:45 p.m. to 3:45 p.m. Monday to Friday, in the sides and lengths of road specified in Schedule 3.11 hereto.
- (d) Insert to Lazenby – Schedule no. 1 – No waiting at any time:-

NORTH ROW

North Side From its junction with Lilac Close for a distance of 14 metres in an easterly direction and 11 metres in a westerly direction.

South Side. From its junction with Chapel Street for a distance of 15 metres in an easterly direction.

LILAC CLOSE

Both Sides. From its junction with North Row for a distance of 23 metres in a northerly direction.

(e) Insert to South Bank – Schedule No. 1 – No waiting at any time:-

DORMER WAY

Both Sides. From the entrance to South Bank Motor Sports Park for a distance of 30 metres in a south-easterly direction.

NORMANBY ROAD

West Side. From its junction with Poplar Grove for a distance of 15 metres in a northerly direction and 15 metres in a southerly direction.

POPLAR GROVE

Both Sides. From its junction with Normanby Road for a distance of 15 metres in a westerly direction.

- 3. The provisions of existing Traffic Regulations Orders are revoked insofar as there are inconsistencies with this Order.
- 4. The Interpretation Act 1978 shall apply for the interpretation of this Order as it applies for the interpretation of an Act of Parliament.

GIVEN under the Common Seal of the Council of the Borough of Redcar and Cleveland this 31st day of August 2004.

THE COMMON SEAL OF THE))
COUNCIL OF THE BOROUGH OF))
REDCAR AND CLEVELAND was))
hereunto affixed in the presence of:-

[Handwritten Signature]

Authorised Signatory
(Legal and Democratic service)

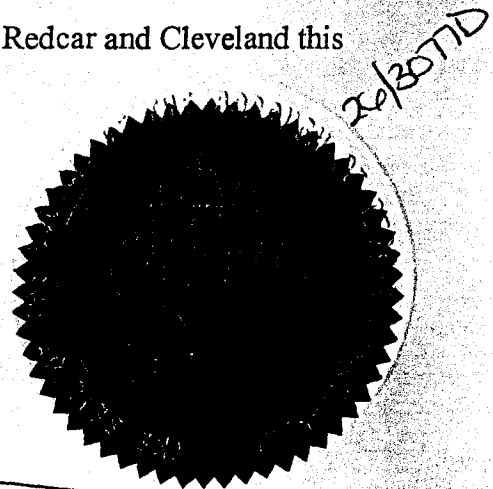

SCHEDULE 2.12

**DORMANSTOWN, GRANGETOWN, LAZENBY AND SOUTH BANK
CONSOLIDATION ORDER 2003
(WAITING AND LOADING AND PARKING PLACES)**

**GRANGETOWN – SCHEDULE 2.12 – NO WAITING – MONDAY – FRIDAY
8.30 A.M. TO 9.30 A.M. AND 2.45 P.M. TO 3.45 P.M.**

ATTLEE ROAD

- (i) East Side. From a point 22 metres south of its junction with Griffiths Road for a distance of 43 metres in a southerly direction.
- (ii) West Side. From a point 22 metres south of its junction with Griffiths Road for a distance of 18 metres in a southerly direction.

SCHEDULE 3.11

**DORMANSTOWN, GRANGETOWN, LAZENBY AND SOUTH BANK
CONSOLIDATION ORDER 2003
(WAITING AND LOADING AND PARKING PLACES)**

**GRANGETOWN – SCHEDULE 3.11 – NO LOADING AND UNLOADING
MONDAY – FRIDAY
8:30 A.M. TO 9:30 A.M. AND 2:45 P.M. TO 3:45 P.M.**

ATTLEE ROAD

- (i) East Side. From a point 22 metres south of its junction with Griffiths Road for a distance of 43 metres in a southerly direction.
- (ii) West Side. From a point 22 metres south of its junction with Griffiths Road for a distance of 18 metres in a southerly direction.

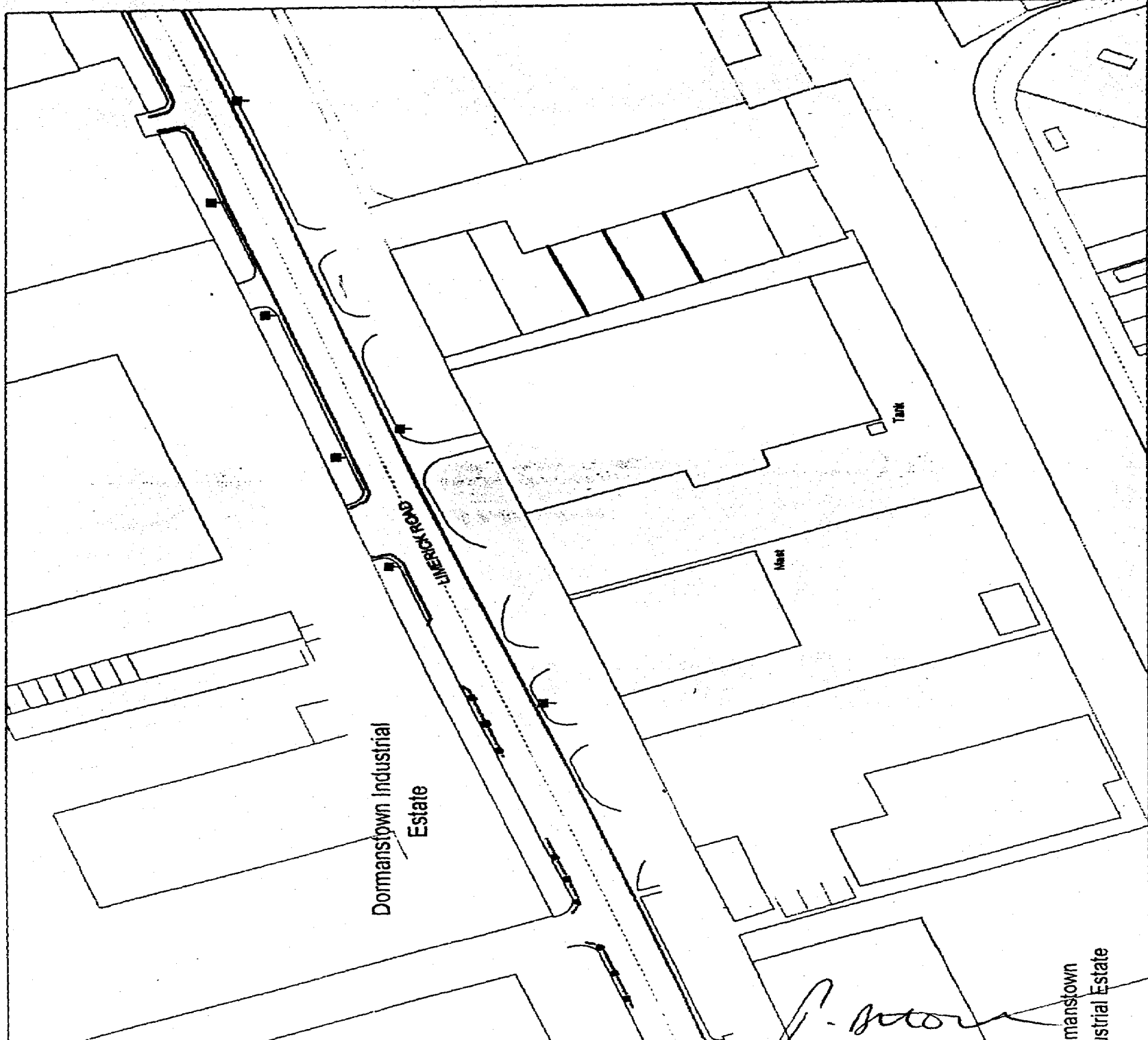

Dormanstown Industrial Estate

Tank

Main

Dormanstown Industrial Estate

[Handwritten signature]

1770

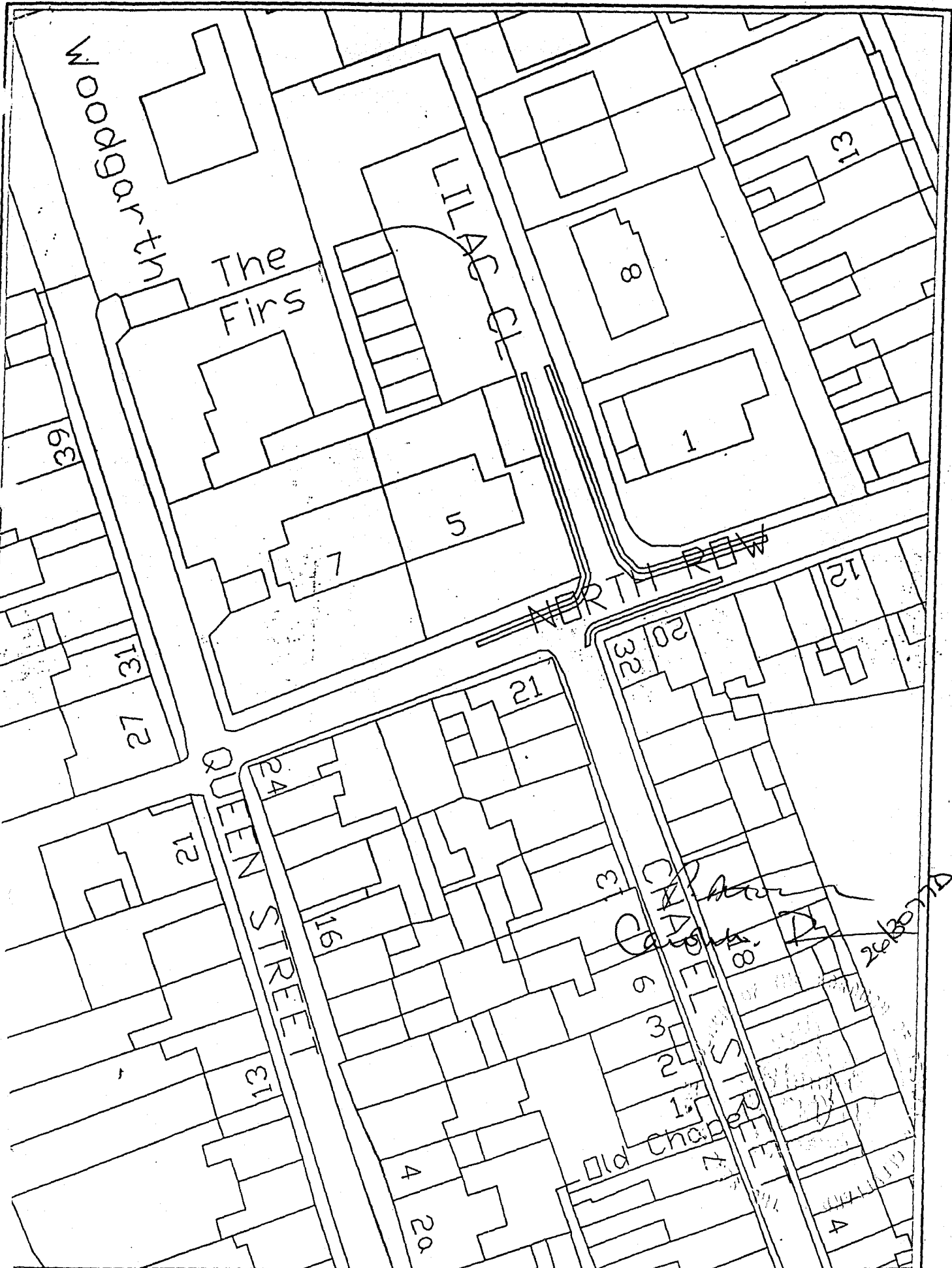

Development Department
 Belmont House,
 Rectory Lane,
 Guisborough
 TS11 7FD
 Tel: (01642) 844000
 Fax: (01642) 912565

Joan Rees PhD, MRTPI
 Director of Development

Scale Hor. 1/500
 Vert.

Drawn by NPH
 Traced by NPH
 Checked by NPH

Date 11.3.04

File No.

NEWAL PROPOSALS LAZINBY

HEIGHTS IN METRES



PLAN NZ 522C

Engraved 1959

SOUTH BANK WARD

52

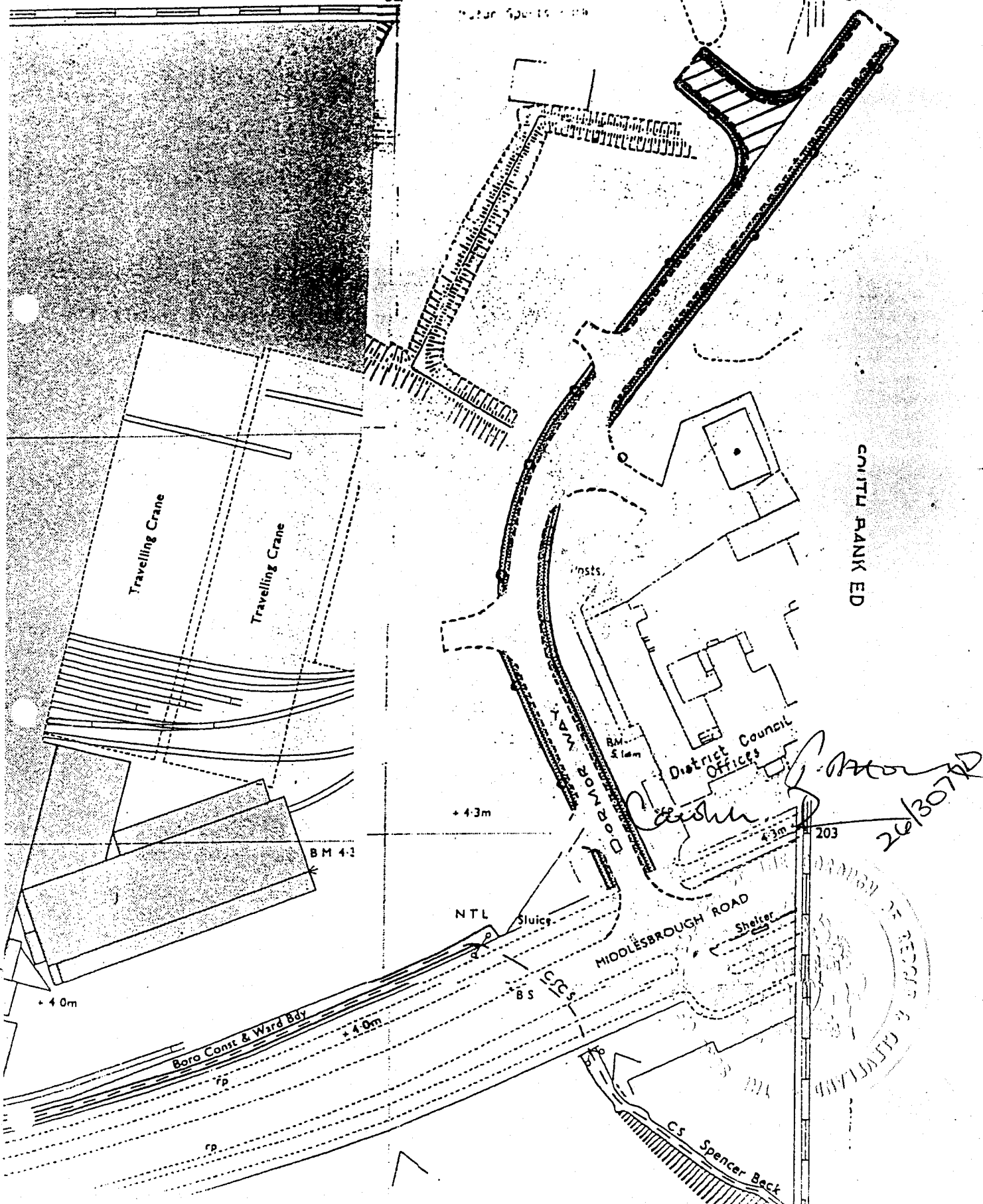

GUTHRIE BANK ED

District Council
OFFICES

MIDDLESBROUGH ROAD

DORSET WAY

Boro Const & Ward Bdy

Spencer Beck

Handwritten signature
26/307AD

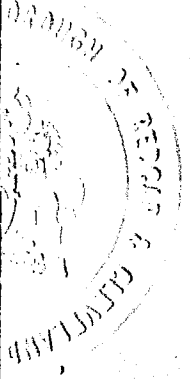

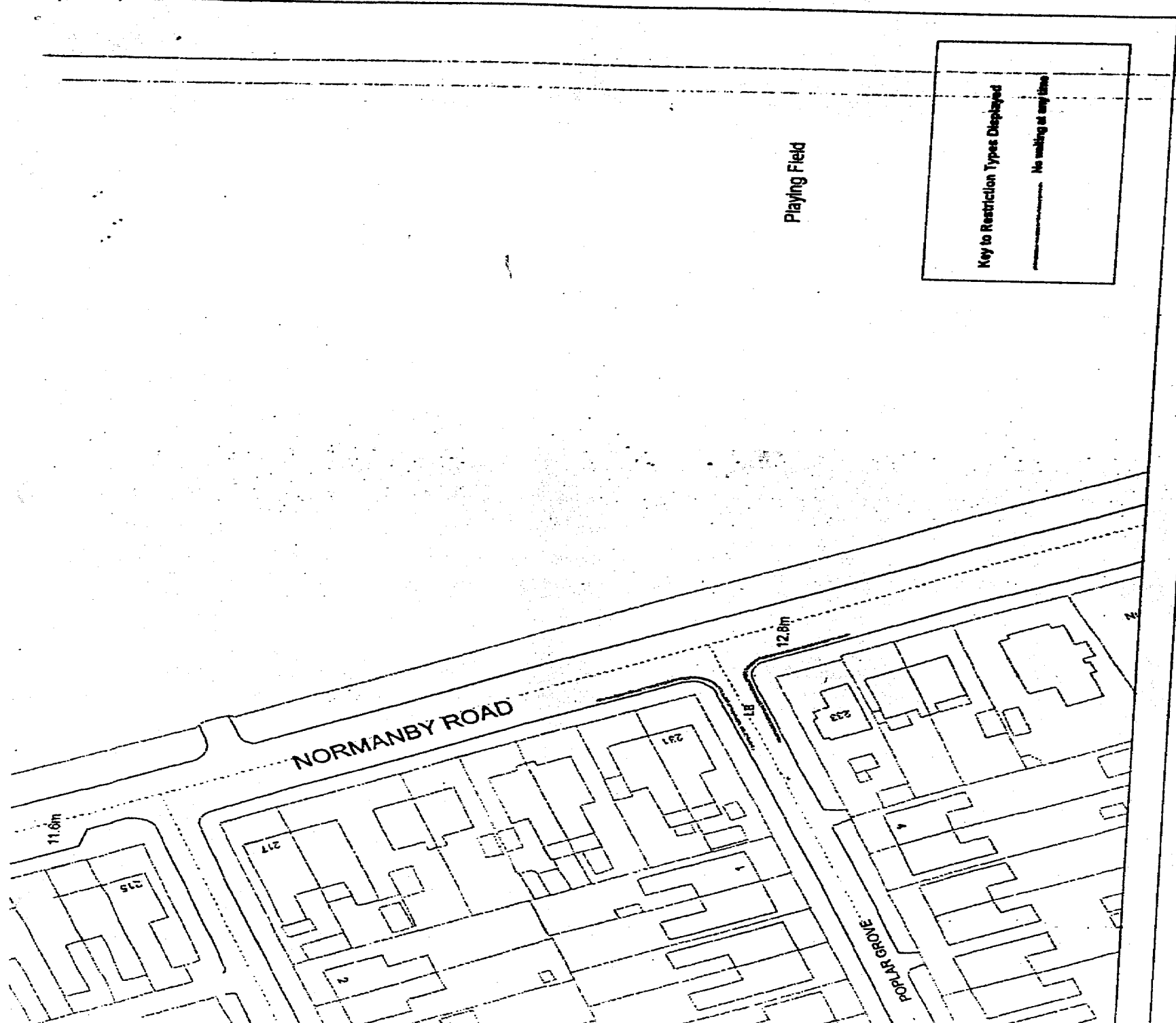

Key to Restriction Types Displayed

..... No waiting at any time

SCALE	1 : 1000
DATE	24/03/2004
DRAWING No.	
DRAWN BY	

Normanby Road/Poplar Grove - No waiting at any time

2070

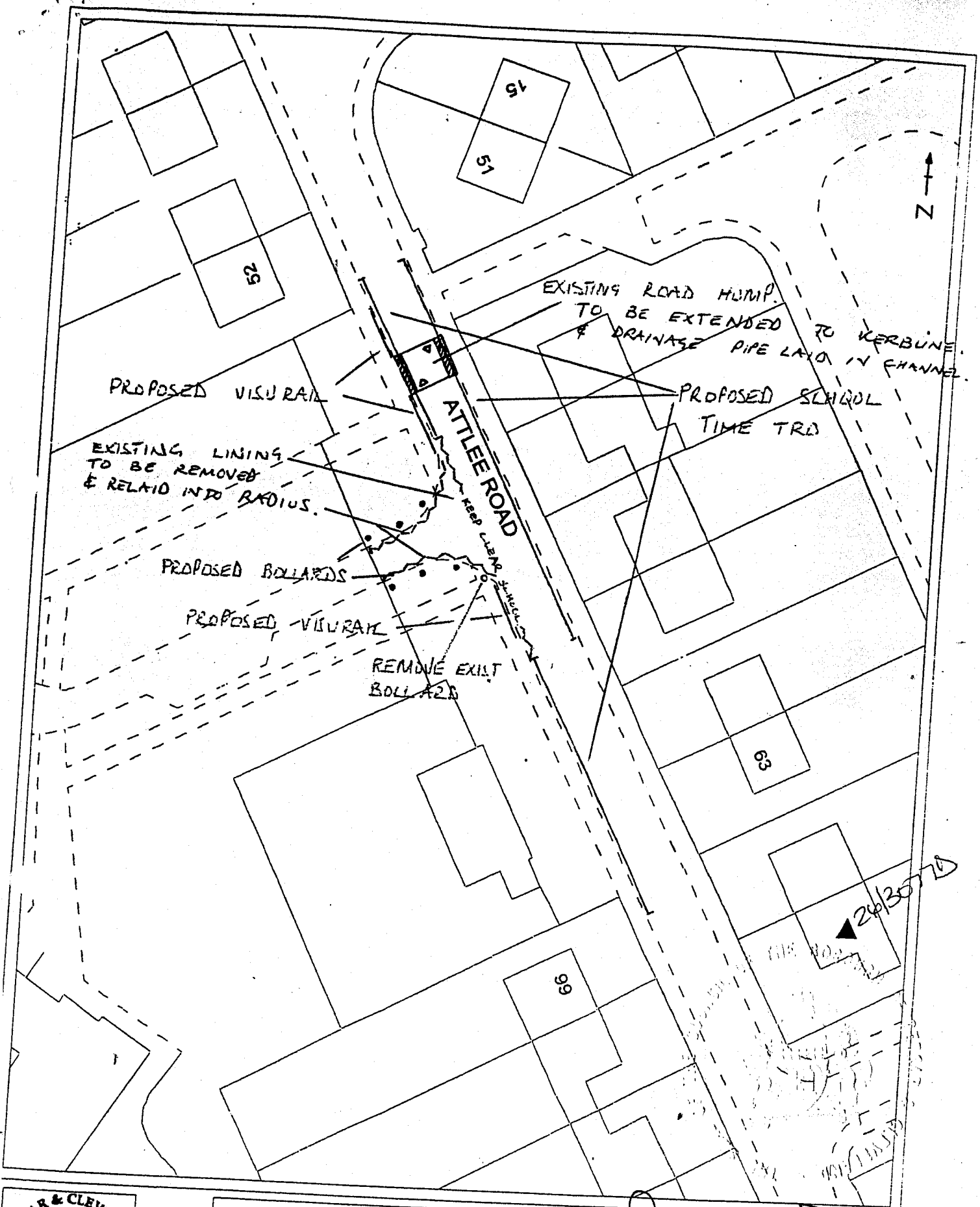

ATLEE ROAD - GRANGETOWN

Johnston
- Ator

SCALE 100
DEPARTMENT

SUBJECT

Director of Development
Belmont House
Rectory Lane
Guisborough
TS14 7FD

DATE 18th August

Prepared from the 1983 Ordnance Survey 1:250 map with the permission of the Controller of the Ordnance Survey Office
© Crown Copyright. Unauthorised copying for any purpose is prohibited and is an offence under the Copyright, Designs and Patents Act 1988.