

OLDHAM BOROUGH COUNCIL

THE OLDHAM (ALBION STREET)
PROHIBITION OF LOADING/UNLOADING ORDER, 1988

The Oldham Borough Council in exercise of its powers under Sections 1(1) and (2) and 2(1) to (3) and 4(2) of the Road Traffic Regulation Act 1984 as amended ("the Act") and of all other enabling powers, and after consultation with the Chief Officer of Police in accordance with Part III of Schedule 9 to the Act hereby makes the following Order:-

1. This Order shall come into operation on *9th November*, 1988 and may be cited as the Oldham (Albion Street) Prohibition of Loading/Unloading Order, 1988.
2. No person shall, except upon the direction or with the permission of a police constable in uniform or a traffic warden, cause or permit any vehicle to wait at any time in the length of road specified in the Schedule hereto for the purpose of enabling goods to be loaded on to or unloaded from the vehicle.
3. (1) Nothing in Article 2 of this Order shall render it unlawful to cause or permit any vehicle to wait in the length of road referred to therein for so long as may be necessary to enable:-
 - (a) the vehicle, if it cannot conveniently be used for such purpose in any other road, to be used in connection with any of the following operations, namely:-
 - (i) building or demolition operations;
 - (ii) the removal of any obstruction to traffic;
 - (iii) the maintenance, improvement or reconstruction of the length of road or any other adjacent length of road;
 - (iv) the laying, erection, alteration or repair in, or in land adjacent to, the length of road of any sewer or of any main, pipe or apparatus for the supply of gas, water or electricity or of any telecommunications apparatus as defined in Schedule 2 to the Telecommunications Act 1984;
 - (b) the vehicle, if it cannot conveniently be used for such purpose in any other road, to be used in the service of a local authority or a water authority in pursuance of statutory powers or duties;
 - (c) the vehicle to wait at or near to any premises situated on or adjacent to the length of road for so long as is reasonably necessary in connection with any wedding or funeral; or

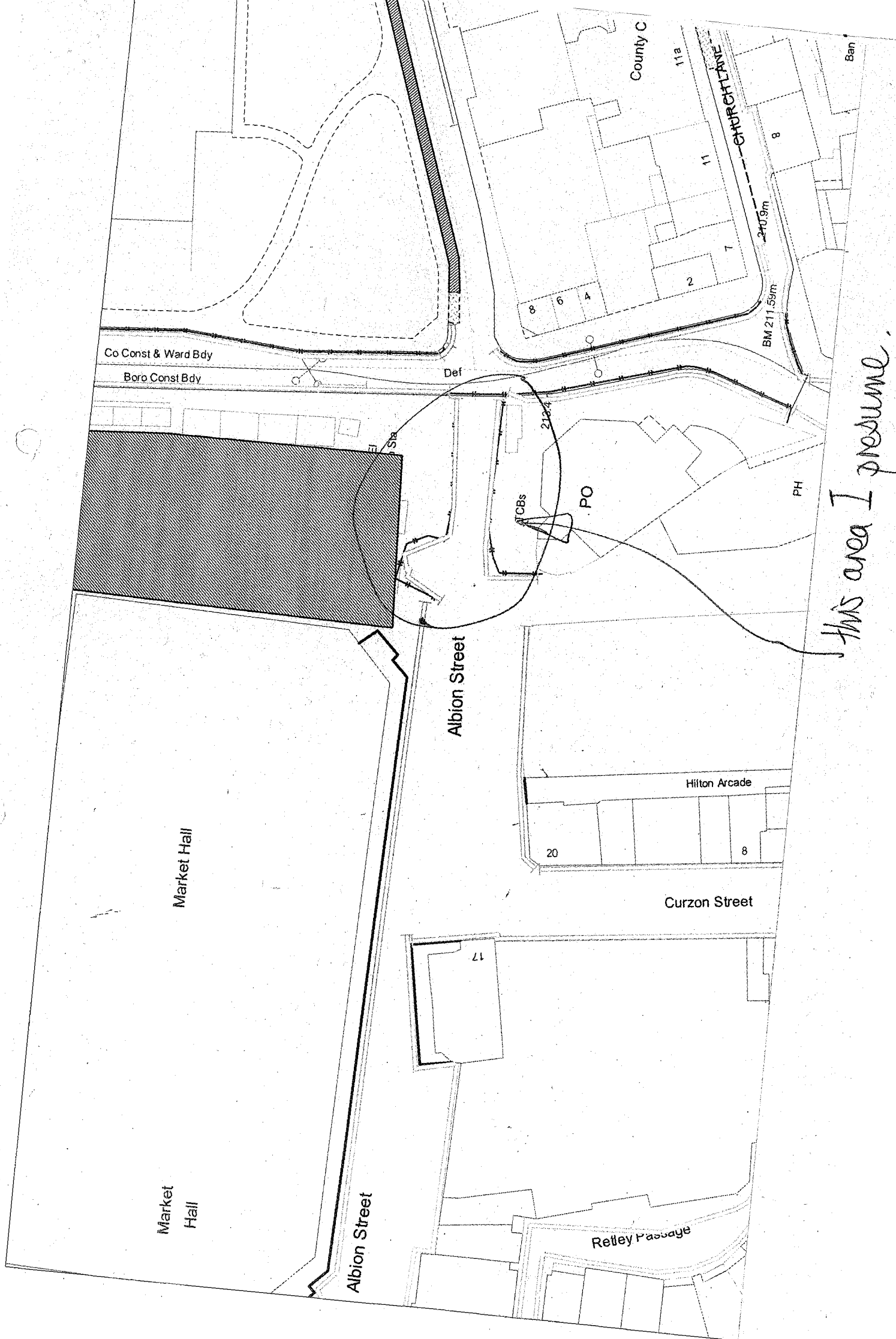

this area I presume.

County C

11a

11

7

2

8

6

4

8

270.9m

BM 211.50m

CHURCH LANE

Ban

Co Const & Ward Bdy

Boro Const Bdy

Def

21.2

PO

PH

PH

Albion Street

Market Hall

Market Hall

Albion Street

Hilton Arcade

20

8

Curzon Street

17

Retley Passage