

NORTHUMBERLAND COUNTY COUNCIL

TRAFFIC REGULATION ORDER

(Ref: TRO_009_28)

Northumberland County Council

NCC North Northumberland (Southern) Area (Waiting and Loading)

Composite Order 2011

Amendment No 28 Order 2017

Made: 25th October 2017

Coming into Force: 6th November 2017

Northumberland County Council (hereinafter referred to as "the Council") in exercise of their powers under Sections 1, 2 and 4 and Paragraphs 20 and 27 of Schedule 9 of the Road Traffic Regulation Act 1984 ("the Act of 1984"), and after consulting with the Chief Officer of Police in accordance with Part III of Schedule 9 to the Act of 1984 and of all other enabling powers hereby make the following Order:-

1. Commencement and Citation

This Order shall come into operation on the 6th November 2017 and may be cited as "Northumberland County Council North Northumberland (Southern) Area (Waiting and Loading) Composite Order 2011 - Amendment No 28 Order 2017".

2. In the Order:-

"Order" means "Northumberland County Council North Northumberland (Southern) Area (Waiting and Loading) Composite Order 2011".

"Amendment Order" means "Northumberland County Council North Northumberland (Southern) Area (Waiting and Loadings) Composite Order 2011- Amendment No 28 Order 2017".

The Interpretation Act 1978 shall apply to this Order as it applies to an Act of Parliament.

3. Provisions

The following provisions set out below and in The Schedule to this Amendment Order shall be additions to, deletions from, or substitutions in the restrictions in the Order:

(A) Additions

to Schedule 1 –Waiting

(Referenced in this Amendment Order as: The Schedule - ADDITIONS)

(B) Deletions

None

(C) Substitutions

None

GIVEN under the Common Seal of the County Council of Northumberland this 25th day of October 2017.

THE COMMON SEAL OF THE COUNTY COUNCIL OF NORTHUMBERLAND was hereunto affixed in the presence of:-



Duly Authorised Officer

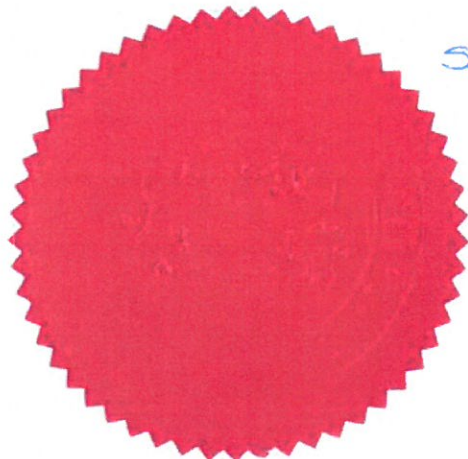

Seal No -
16971

THE SCHEDULE

ADDITIONS – Northumberland County Council North Northumberland (southern) Area (Waiting and Loadings) Composite Order 2011 - Amendment No 15 Order 2017- TRO_009_28

Schedule 1 –Waiting

Ref No	Town	Street	Side	Description	Proscribed Hours
009-28-000-6263	Morpeth	Kingswell	South	From its junction with Shields Road to its junction with Stobhill Villas	A
009-28-000-6264	Morpeth	Kingswell	South	From its junction with Stobhill Villas to a point 28 metres east of its junction with Stobhill Villas	A
009-28-000-6265	Morpeth	Kingswell	North	From its junction with Shields Road to a point 65 metres east of its junction with Shields Road	A
009-28-000-6266	Morpeth	Kingswell	North	From a point 92 metres east of its junction with Shields Road to a point 135 metres east of its junction with Shields Road	A
009-28-000-6267	Morpeth	Kingswell	North	From a point 163 metres east of its junction with Shields Road to a point 193 metres east of its junction with Shields Road	A
009-28-000-6356	Morpeth	Stobhill Villas	West	From its junction with Kingswell to a point 6 metres south of its junction with Kingswell	A
009-28-000-6357	Morpeth	Stobhill Villas	East	From its junction with Kingswell to a point 8 metres south of its junction with Kingswell	A

**ROAD TRAFFIC REGULATION ACT 1984
THE COUNTY OF NORTHUMBERLAND
(KINGSWELL MORPETH)**

**NORTHUMBERLAND COUNTY COUNCIL
NORTH NORTHUMBERLAND (SOUTHERN) AREA
COMPOSITE ORDER 2011 - AMENDMENT NO 28 ORDER 2017**

(TRO_009_28)

**STATEMENT OF THE COUNCILS REASONS FOR
MAKING THE ORDER**

The introduction of parking restrictions in Kingswell Morpeth is to reduce congestion and improve road safety.

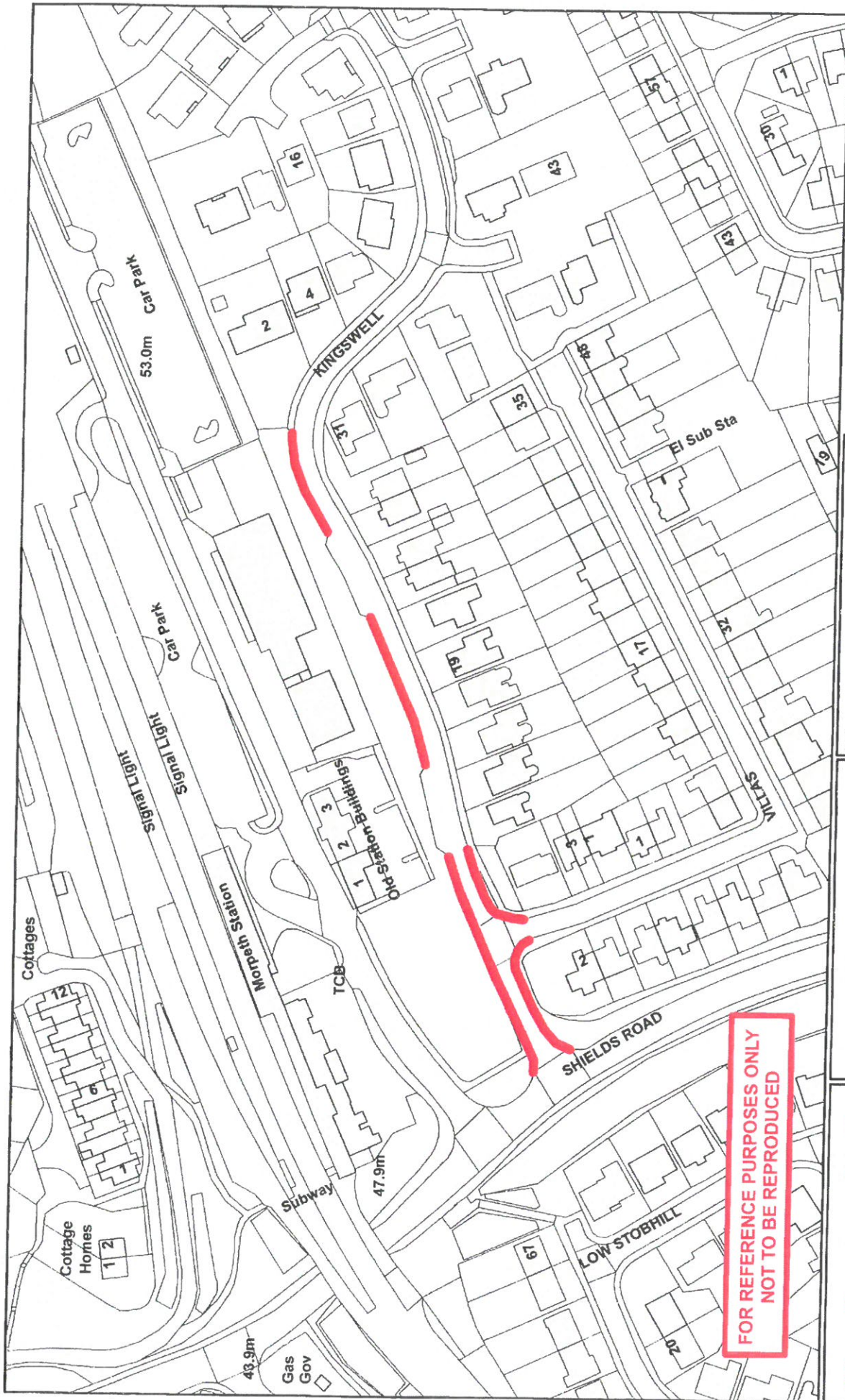

**FOR REFERENCE PURPOSES ONLY
NOT TO BE REPRODUCED**

<p>Northumberland Northumberland County Council</p> <p>Northumberland County Council County Hall Morpeth Northumberland NE61 2EF Tel: 01670 533000</p>	<p>Network Management Information System</p> <p><small>This map is reproduced from Ordnance Survey material with the permission of Ordnance Survey on behalf of the Controller of Her Majesty's Stationary Office. Crown Copyright. Unauthorised reproduction infringes Crown Copyright and may lead to prosecution or civil proceedings. License no. 100049048 (2008).</small></p>	<p>Title: Proposed No Waiting at Any Time restrictions, Kingswell, Morpeth</p> <table border="1"> <tr> <td>Drm: RM</td><td>Date: 17.05.2017</td><td>Scale: NTS</td></tr> </table>	Drm: RM	Date: 17.05.2017	Scale: NTS
Drm: RM	Date: 17.05.2017	Scale: NTS			