

NORTHUMBERLAND COUNTY COUNCIL

TRAFFIC REGULATION ORDER

(Ref: TRO_012_04)

Northumberland County Council
South East Northumberland Area (Parking Places) Composite Order 2011
Amendment No 4 Order 2014

Made: 3 April 2014

Coming into Force: 14 April 2014

Northumberland County Council (hereinafter referred to as "the Council") in exercise of their powers under Sections 1, 2, 4, 35, 32, 45 and 46 and Part IV of Schedule 9 of the Road Traffic Regulation Act 1984 ("the Act of 1984"), and after consulting with the Chief Officer of Police in accordance with Part III of Schedule 9 to the Act of 1984 and of all other enabling powers hereby make the following Order:

1. Commencement and Citation

This Order shall come into operation on the 14th April 2014 and may be cited as "Northumberland County Council South East Northumberland Area (Parking Places) Composite Order 2011 – Amendment No 4 Order 2014".

2. In the Order:-

"Order" means "Northumberland County Council South East Northumberland Area (Parking Places) Composite Order 2011".

"Amendment Order" means "NCC South East Northumberland Area (Parking Places) Composite Order 2011 – Amendment Order No 4 2014".

The Interpretation Act 1978 shall apply to this Order as it applies to an Act of Parliament.

3. Provisions

The following provisions set out below and in The Schedule to this Amendment Order shall be additions to, deletions from, or substitutions in the restrictions in the Order:

(A) Additions

to Schedule 1 – Resident Permit Holders Parking Places

(Referenced in this Amendment Order as: The Schedule - ADDITIONS)

(B) Deletions

None

(C) Substitutions

None

GIVEN under the Common Seal of the County Council of Northumberland this 3rd day of April 2014.

THE COMMON SEAL OF THE COUNTY COUNCIL OF NORTHUMBERLAND was hereunto affixed in the presence of:-



Duly Authorised Officer



THE SCHEDULE

**ADDITIONS – South East Northumberland Area (Parking Places) Composite Order 2011 updated by Amendment Number 4 Order TRO_012_04
Schedule 1 – Resident Permit Parking Places**

Ref No	Town	Street	Side	Description	Permitted Hours	Special Manner of Standing	Zone
012-004-000	CRAMLINGTON	Station Road	NORTH	From a point 70 metres west of its junction with East West Link Road Access Road to a point 76 metres west of its junction with East West Link Road Access Road	1	N/A	CR1
012-004-000	CRAMLINGTON	Station Road	NORTH	From a point 103 metres west of its junction with East West Link Road Access Road to a point 153 metres west of its junction with East West Link Road Access Road	1	N/A	CR1
012-004-000	CRAMLINGTON	Station Road	NORTH	From a point 172 metres west of its junction with East West Link Road Access Road to a point 300 metres west of its junction with East West Link Road Access Road	1	N/A	CR1
012-004-000	CRAMLINGTON	Station Road	SOUTH	From a point 135 metres west of its junction with East West Link Road Access Road to a point 188 metres west of its junction with East West Link Road Access Road	1	N/A	CR1

**ROAD TRAFFIC REGULATION ACT 1984
THE COUNTY OF NORTHUMBERLAND
(STATION ROAD - CRAMLINGTON)**

**TRO 012_04 South East Northumberland Area (Parking Places) Composite Order
2011**

Amendment No 4 Order 2014

STATEMENT OF THE COUNCIL'S REASONS FOR MAKING THE ORDER

The proposals are considered necessary for facilitating the passage of vehicular traffic on the road and for avoiding danger to persons or other traffic using the road.

CONTRACT DRAWING No. **A4**



NOTES

- PROPOSED 'NO WAITING AT ANY TIME' RESTRICTIONS
- - - - - PROPOSED PERMIT PARKING 'BAYS'
- PROPOSED 'NO WAITING EVERY DAY 8AM - 6PM' RESTRICTIONS
- EXISTING 'NO WAITING' RESTRICTIONS
- PROPOSED ADVISORY H BAR MARKINGS

REVISION LINE 1 BY DATE

CHECKED : PASSED :

REVISION Drawing Status

By Date Rev. **NOTICE REV A**

Client **NORTHUMBERLAND COUNTY COUNCIL**
 COUNTY HALL, MORPETH,
 NORTHUMBERLAND, NE61 2EF Tel. 01670 533000

Job Title **B1326 STATION ROAD - CRAMLINGTON**

Drawing Title **NO WAITING AND RESIDENT PERMIT HOLDER ONLY PARKING**

Scales **AS SHOWN**



Date **06/03/14**

Drawing Number **H0125437 - B1326-04**

Job Number/File Number

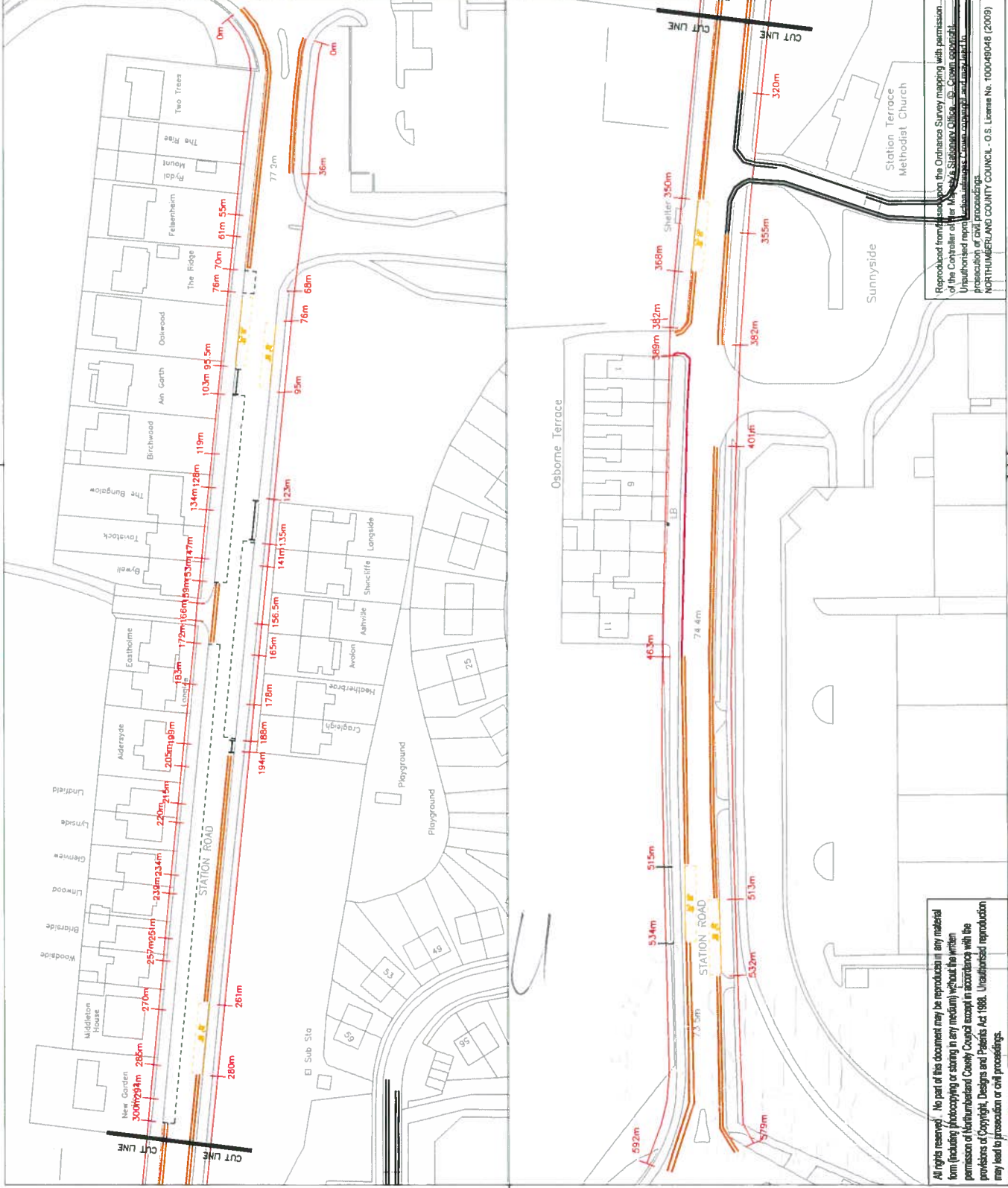

Reproduced from the Ordnance Survey mapping with permission of the Controller of Her Majesty's Stationery Office. No Crown Copyright. Unauthorised reproduction is prohibited. Copyright and map data © NORTHUMBERLAND COUNTY COUNCIL - O.S. License No. 100049048 (2009)

All rights reserved. No part of this document may be reproduced in any material form (including photocopying or storing in any medium) without the written permission of Northumberland County Council except in accordance with the provisions of Copyright, Designs and Patents Act 1988. Unauthorised reproduction may lead to prosecution or civil proceedings.