

NORTHUMBERLAND COUNTY COUNCIL

TRAFFIC REGULATION ORDER

(Ref: TRO_011_12)

Northumberland County Council

South East Northumberland Area (Waiting and Loading) Composite Order 2011

Amendment No 12 Order 2014

Made: 3 April 2014

Coming into Force: 14th April 2014

Northumberland County Council (hereinafter referred to as "the Council") in exercise of their powers under Sections 1, 2 and 4 and Paragraphs 20 and 27 of Schedule 9 of the Road Traffic Regulation Act 1984 ("the Act of 1984"), and after consulting with the Chief Officer of Police in accordance with Part III of Schedule 9 to the Act of 1984 and of all other enabling powers hereby make the following Order:-

1. Commencement and Citation

This Order shall come into operation on the 14th October 2014 and may be cited as "South East Northumberland Area (Waiting and Loading) Composite Order 2011 – Amendment No 12 Order 2014".

2. In the Order:-

"Order" means "Northumberland County Council South East Northumberland Area (Waiting and Loading) Composite Order 2011".

"Amendment Order" means "NCC South East Northumberland Area (Waiting and Loading) Composite Order 2011 – Amendment No 12 Order 2014".

The Interpretation Act 1978 shall apply to this Order as it applies to an Act of Parliament.

3. Provisions

The following provisions set out below and in The Schedule to this Amendment Order shall be additions to, deletions from, or substitutions in the restrictions in the Order:

(A) Additions

to Schedule 1 – Waiting of the Order

(Referenced in this Amendment Order as: The Schedule - ADDITIONS)

(B) Deletions

from Schedule 1 – Waiting of the Order

(Referenced in this Amendment Order as: The Schedule - DELETIONS)

(C) Substitutions

None.

GIVEN under the Common Seal of the County Council of Northumberland this 3rd day of April 2014.

THE COMMON SEAL OF THE COUNTY COUNCIL OF NORTHUMBERLAND was hereunto affixed in the presence of:-

a

Duly Authorised Officer



THE SCHEDULE
ADDITIONS – South East Northumberland Area (Waiting and Loading) Composite Order 2011 updated by Amendment Number 12 Order
2014 - TRO 011_12
Schedule 1 – Waiting

Ref No	Town	Street	Side	Description	Proscribed Hours
011-012-000	CRAMLINGTON	Station Road	NORTH	From its junction with East West Link Road Access Road to a point 70 metres west of its junction with East West Link Road Access Road	A
011-012-000	CRAMLINGTON	Station Road	NORTH	From a point 153 metres west of its junction with East West Link Road Access Road to a point 172 metres west of its junction with East West Link Road Access Road	A
011-012-000	CRAMLINGTON	Station Road	NORTH	From a point 300 metres west of its junction with East West Link Road Access Road to its junction with Osborne Terrace Back Lane	A
011-012-000	CRAMLINGTON	Station Road	NORTH	From a point 74 metres west of its junction with Osborne Terrace Back Lane to its junction with Westmorland Way Roundabout	A
011-012-000	CRAMLINGTON	Station Road	SOUTH	From its junction with East West Link Road Access Road to its junction with Commercial Way	A
011-012-000	CRAMLINGTON	Station Road	SOUTH	From a point 194 metres west of its junction with East West Link Road Access Road to its junction with Westmorland Way Roundabout	A
011-012-000	CRAMLINGTON	Station Road	NORTH	From its junction with Osborne Terrace Back Lane to a point 74 metres west of its junction with Osborne Terrace Back Lane	R

THE SCHEDULE
DELETIONS – South East Northumberland Area (Waiting and Loading) Composite Order 2011 updated by Amendment Number 12 Order
2014 - TRO 011_12
Schedule 1 – Waiting

Ref No	Town	Street	Side	Description	Proscribed Hours
011-200-003	CRAMLINGTON	Station Road	SOUTH	At its junction with Sunnyside to a point 13 metres east of its junction with Sunnyside	A
011-200-004	CRAMLINGTON	Station Road	SOUTH	At its junction with Sunnyside to a point 14 metres west of Sunnyside	A

**ROAD TRAFFIC REGULATION ACT 1984
THE COUNTY OF NORTHUMBERLAND
(STATION ROAD - CRAMLINGTON)**

**TRO 011_12 South East Northumberland Area (Waiting and Loading) Composite
Order 2011**

Amendment No 12 Order 2014

**STATEMENT OF THE COUNCIL'S REASONS FOR
MAKING THE ORDER**

The proposal is being considered for facilitating the passage of vehicular traffic on the road.

CONTRACT DRAWING No. **A4**

Northumberland
Northumberland County Council

NOTES

- PROPOSED 'NO WAITING AT ANY TIME' RESTRICTIONS
- - - - - PROPOSED PERMIT PARKING BAYS
- PROPOSED 'NO WAITING EVERY DAY 8AM - 6PM' RESTRICTIONS
- EXISTING 'NO WAITING' RESTRICTIONS
- PROPOSED ADVISORY H BAR MARKINGS

REVISION LINE 1 PASSED : BY DATE

CHECKED : PASSED : BY DATE

REVISION By Date Rev.

Drawing Status **NOTICE REV A**

Client **NORTHUMBERLAND COUNTY COUNCIL**
COUNTY HALL, MORPETH.
NORTHUMBERLAND. NE61 2EF Tel. 01670 533000

Job Title **B1326 STATION ROAD - CRAMLINGTON**

Drawing Title **NO WAITING AND RESIDENT PERMIT HOLDER ONLY PARKING**

Scales **AS SHOWN**

Northumberland
Northumberland County Council

Dm	PM	Date	Checked	Passed
		06/03/14	JL	JL

Drawing Number	Rev
HO125437 - B1326-04	A
Job Number/File Number	Rev

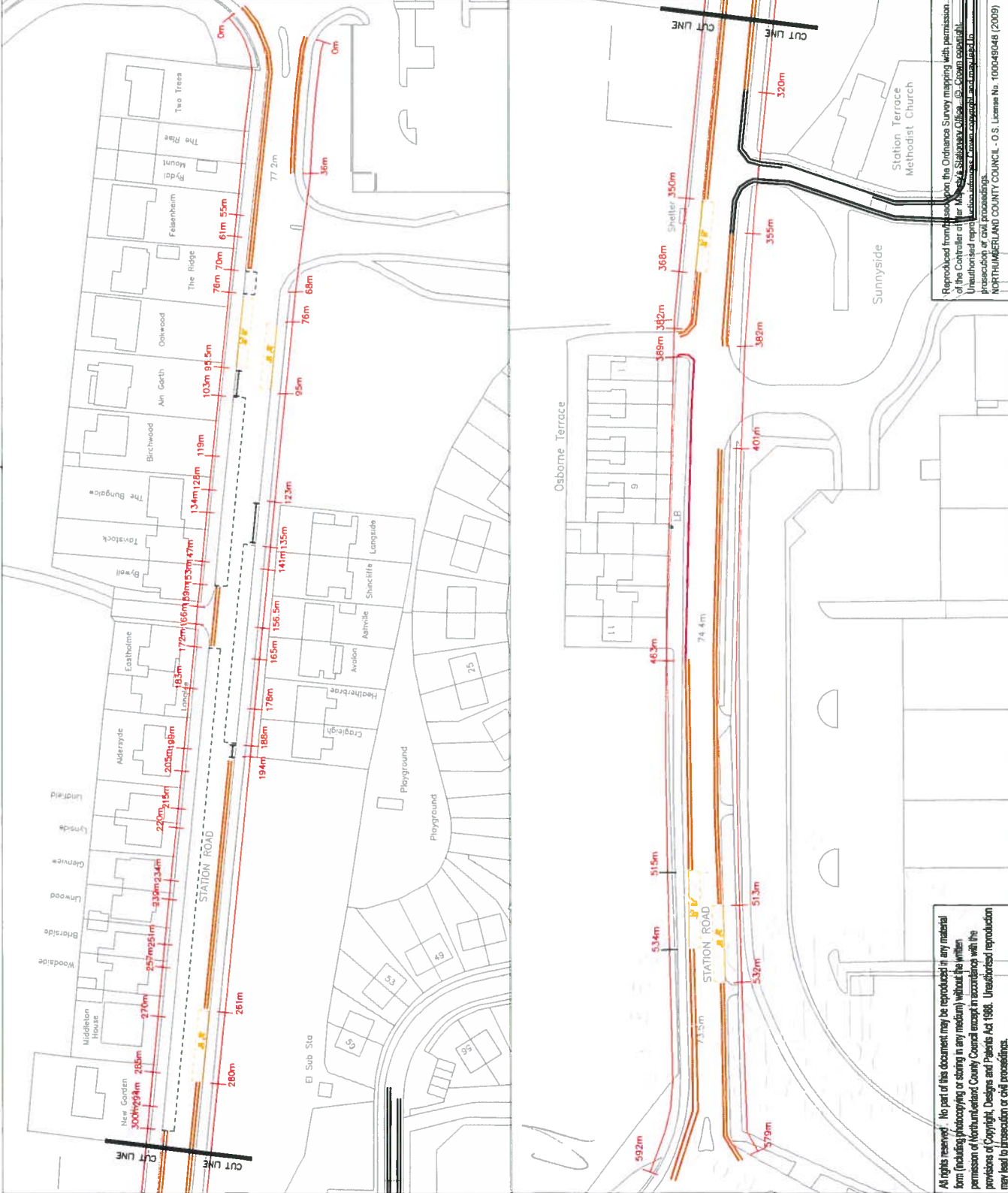

Reproduced from the Ordnance Survey mapping with permission of the Controller of Her Majesty's Stationery Office. © Crown copyright. Unauthorised reproduction is prohibited. All rights reserved. NORTHUMBERLAND COUNTY COUNCIL - O.S. License No. 100049048 (2009)

All rights reserved. No part of this document may be reproduced in any material form (including photocopying or storing in any medium) without the written permission of Northumberland County Council except in accordance with the provisions of Copyright, Designs and Patents Act 1988. Unauthorised reproduction may lead to prosecution or civil proceedings.