

NORTHUMBERLAND COUNTY COUNCIL

TRAFFIC REGULATION ORDER

(Ref: TRO_011_11)

Northumberland County Council

South East Northumberland Area (Waiting and Loading) Composite Order 2011

Amendment No 11 Order 2014

Made: 16th January 2014

Coming into Force: 27th January 2014

Northumberland County Council (hereinafter referred to as "the Council") in exercise of their powers under Sections 1, 2 and 4 and Paragraphs 20 and 27 of Schedule 9 of the Road Traffic Regulation Act 1984 ("the Act of 1984"), and after consulting with the Chief Officer of Police in accordance with Part III of Schedule 9 to the Act of 1984 and of all other enabling powers hereby make the following Order:-

1. Commencement and Citation

This Order shall come into operation on the 27th January 2014 and may be cited as "Northumberland County Council South East Northumberland Area (Waiting and Loading) Composite Order 2011 – Amendment No 11 Order 2014".

2. In the Order:-

"Order" means "South East Northumberland Area (Waiting and Loading) Composite Order 2011".

"Amendment Order" means "Northumberland County Council South East Northumberland Area (Waiting and Loading) Composite Order 2011 – Amendment No 11 Order 2014".

The Interpretation Act 1978 shall apply to this Order as it applies to an Act of Parliament.

3. Provisions

The following provisions shall be additions to, deletions from, or substitutions in the restrictions detailed in the Order:

(A) Additions

(Referenced in this Amendment Order as: The Schedule - ADDITIONS)

(B) Deletions

None

(C) Substitutions

None

GIVEN under the Common Seal of the County Council of Northumberland this 16th day of January 2014.

THE COMMON SEAL OF THE COUNTY COUNCIL OF NORTHUMBERLAND was hereunto affixed in the presence of:-

A

Duly Authorised Officer



**ROAD TRAFFIC REGULATION ACT 1984
THE COUNTY OF NORTHUMBERLAND
SOUTH EAST NORTHUMBERLAND AREA (WAITING AND LOADING)
COMPOSITE ORDER 2011
Amendment No 11 Order 2014**

**STATEMENT OF THE COUNCIL'S REASONS FOR
MAKING THE ORDER**

The proposal is being considered in order to improve road safety at St Wilfrid's RC Voluntary Aided Primary School.

THE SCHEDULE

ADDITIONS – South East Northumberland Area (Waiting and Loading) Composite Order 2011 updated by Amendment Number 11 Order
2013 - TRO_011_11
Schedule 4 – Keep Clear

Ref No	Town	Street	Side	Description	Proscribed Hours
011-011-003-001	BLYTH	CLAREMONT TERRACE BACK LANE	South	At a point 78 metres west of its junction with Renwick Road to a point 122 metres west of its junction with Renwick Road	C
011-011-003-002	BLYTH	CLAREMONT TERRACE BACK LANE	South	At a point 206 metres west of its junction with Renwick Road to its junction with Railway Terrace	C
011-011-004-001	BLYTH	RAILWAY TERRACE	West	At its junction with Claremont Terrace Back Lane to a point 16 metres north of its junction with Claremont Terrace Back Lane	C

THE SCHEDULE

**ADDITIONS – South East Northumberland Area (Waiting and Loading) Composite Order 2011 updated by Amendment Number 11 Order
2013 - TRO_011_11
Schedule 1 – Waiting**

Ref No	Town	Street	Side	Description	Proscribed Hours
011-011-000-001	BLYTH	CLAREMONT TERRACE BACK LANE	South	At its junction with Renwick Road to a point 78 metres west of its junction with Renwick Road	A
011-011-000-002	BLYTH	CLAREMONT TERRACE BACK LANE	South	At a point 122 metres west of its junction with Renwick Road to a point 206 metres west of its junction with Renwick Road	A
011-011-000-003	BLYTH	CLAREMONT TERRACE BACK LANE	North	At its junction with Renwick Road to its junction with Charlton Street	A
011-011-000-004	BLYTH	CLAREMONT TERRACE BACK LANE	North	At its junction with Charlton Street to its junction with Rutherford Street	A
011-011-000-005	BLYTH	CLAREMONT TERRACE BACK LANE	North	At its junction with Rutherford Street to its junction with Railway Terrace	A
011-011-001-001	BLYTH	CHARLTON STREET	East	At its junction with Claremont Terrace Back Lane to its junction with Claremont Terrace	A
011-011-001-002	BLYTH	CHARLTON STREET	West	At its junction with Claremont Terrace Back Lane to a point 6 metres north of its junction with Claremont Terrace Back Lane	A
011-011-002-001	BLYTH	RUTHERFORD STREET	East	At its junction with Claremont Terrace Back Lane to a point 6 metres north of its junction with Claremont Terrace Back Lane	A
011-011-002-002	BLYTH	RUTHERFORD STREET	West	At its junction with Claremont Terrace Back Lane to its junction with Claremont Terrace	A

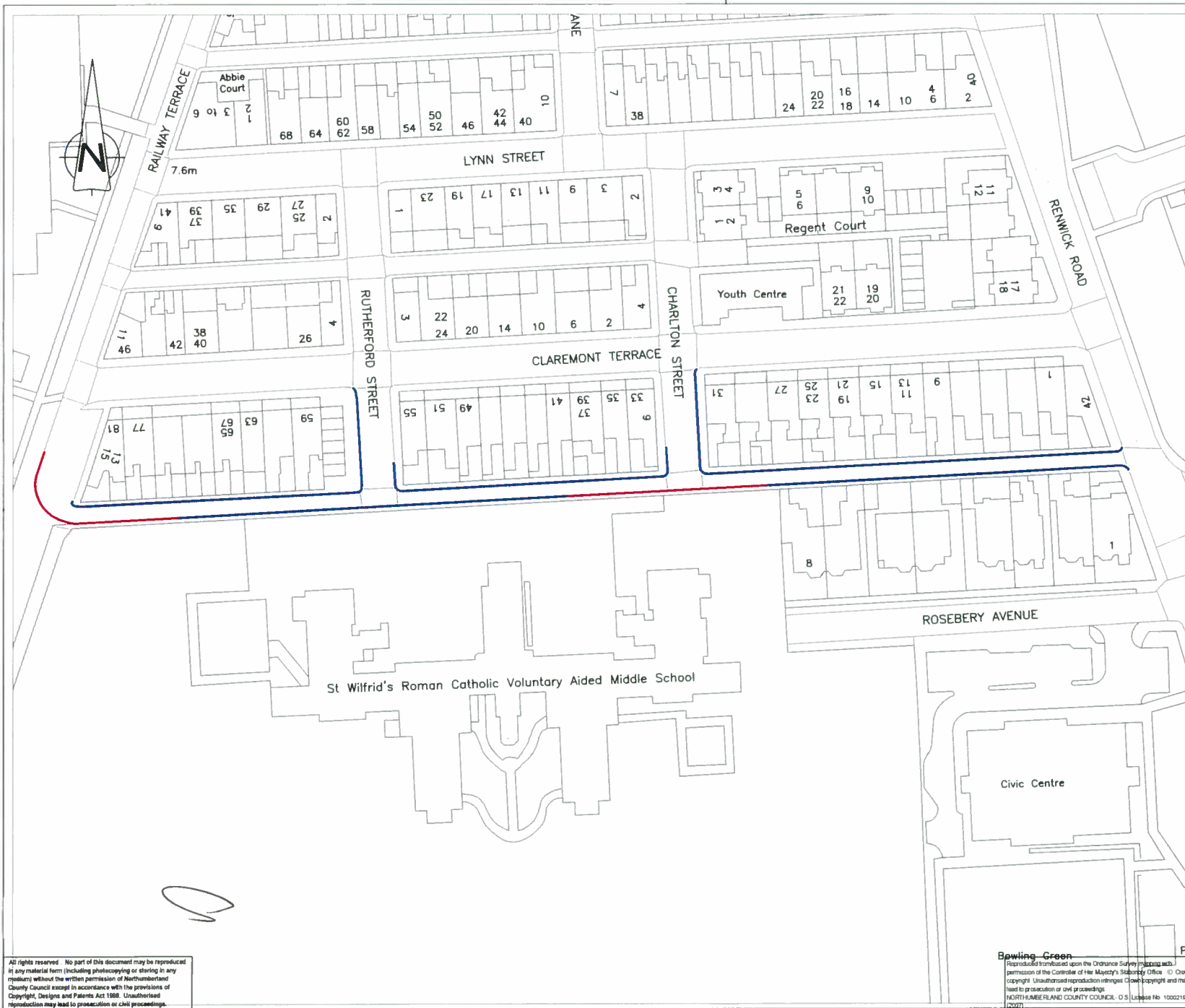

CONTRACT 1 OF 1
DRAWING No. A3

Northumberland
Northumberland County Council

- KEY:-**
- PROPOSED SCHOOL KEEP CLEAR MARKINGS - 43.58m IN LENGTH
 - PROPOSED NO WAITING AT ANY TIME RESTRICTIONS

REVISION By Date Rev.

Drawing Status
CONSULTATION

Client
NORTHUMBERLAND COUNTY COUNCIL
COUNTY HALL, MORPETH.
NORTHUMBERLAND. NE61 2EF Tel. 01670 533000

Job Title
PROPOSED SCHOOL KEEP CLEAR ROAD MARKINGS & NO WAITING AT ANY TIME RESTRICTIONS

Drawing Title
ST WILFRED'S SCHOOL, BACK CLAREMONT TERRACE, BLYTH

Scales **NOT TO SCALE**

Northumberland
Northumberland County Council
SUSTAINABLE TRANSPORT

Drm	Date	Checked	Passed
NS	OCT 13	JL	JL

Drawing Number	Rev
Negative Number/Job Number/File Number	Rev

All rights reserved. No part of this document may be reproduced in any material form (including photocopying or storing in any retrieval system) without the written permission of Northumberland County Council except in accordance with the provisions of Copyright, Designs and Patents Act 1988. Unauthorised reproduction may lead to prosecution or civil proceedings.

Bewling-Green
Reproduced from the Ordnance Survey map with the permission of the Controller of Her Majesty's Stationery Office. Copyright. Unauthorised reproduction infringes Crown copyright and may lead to prosecution or civil proceedings.
NORTHUMBERLAND COUNTY COUNCIL. O.S. Licence No. 100021501 (2007)