

NEATH PORT TALBOT COUNTY BOROUGH COUNCIL
CYNGOR BWRDEISTREF SIROL CASTELL-NEDD PORT TALBOT

(MONASTERY ROAD, NEATH ABBEY)
(REVOCATION) AND (PROHIBITION OF WAITING)

ORDER 2018

The Neath Port Talbot County Borough Council in exercise of their powers under Sections 1, 2 and Part IV of Schedule 9 of the Road Traffic Regulation Act 1984 (hereinafter referred to as “the Act of 1984”) and of all other powers them enabling and after consultation with the Chief Officer of Police in accordance with Part III of Schedule 9 of the Act of 1984 hereby make the following Order: -

1. This Order shall come into force on the 14th day of May 2018 and may be cited as the “Neath Port Talbot County Borough Council (Monastery Road, Neath Abbey) (Revocation) and (Prohibition of Waiting) Order 2018”.
2. (1) In this Order –

“Disabled Person’s Vehicle” has the same meaning as in The Local Authorities’ Traffic Orders (Exemptions for Disabled Persons) (Wales) Regulations 2000;

“Disabled Person’s Badge” has the same meaning as in The Disabled Person’s (Badges for Motor Vehicles) (Wales) (Amended) Regulations 2000;

“Relevant Position” has the same meaning as in the Disabled Persons (Badges for Motor Vehicles) (Wales) (Amended) Regulations 2000”;

“Public Service Vehicle” shall have the same meaning as in Section 1 of the Public Passenger Vehicles Act 1981 and “local service” shall have the same meaning as in Section 1 of the Transport Act 1985;

“Universal Providers” means those operators of postal services who are licensed to provide all or part of a Universal Postal Service under the provisions contained in the Postal Services Act 2000.

(2) Except where otherwise stated, any reference in this Order to a numbered Article or Schedule is a reference to the Article or Schedule bearing that number in this Order.

(3) The Interpretation Act 1978 shall apply for the interpretation of this Order as it applies for the Interpretation of an Act of Parliament.
3. The provisions contained in The Glamorgan County Council (Monastery Road, Neath Abbey) (Prohibition of Waiting) Order 1970 are hereby revoked.
4. Save as provided in Articles 5, 6, 7 and 8 of this Order, no person except on the direction of a Police Constable in uniform or a Parking Attendant shall cause or

permit any vehicle to wait between the hours of 8.00am and 6.00pm, Monday to Saturday on the length of side of road set out in Schedule 1 to this Order.

5. Nothing in Article 4 of this Order shall render it unlawful to cause or permit a Disabled Person's Vehicle which displays in the relevant position a Disabled Person's Badge and a parking disc (on which the driver, or other person in charge of the vehicle, has marked the time at which the period of waiting began) to wait on the lengths of side of road referred to in the Article for a period not exceeding 3 hours (not being a period separated by an interval of less than 1 hour from a previous period of waiting by the same vehicle on the same length of side of road on which that vehicle had previously been waiting).
6. Nothing in Article 4 of this Order shall render it unlawful to cause or permit any vehicle to wait on the length of side of road specified therein for so long as may be necessary to enable: -
 - (A) A person to board or alight from a vehicle;
 - (B) The vehicle, if it cannot conveniently be used for such purpose in any other road, to be used in connection with any of the following operations, namely: -
 - (i) Building, industrial or demolition operations;
 - (ii) The removal of any obstruction to traffic;
 - (iii) The laying, erection, alteration or repair in or on land adjacent to the said lengths of sides of road of any sewer or any main pipe or apparatus for the supply of gas, water or electricity or any telecommunications apparatus defined in the Telecommunications Act 1984;
 - (C) The vehicle, if it cannot conveniently be used for such purpose in any other road, to be used in the service of a Local Authority or a Water Authority in pursuance of statutory powers or duties;
 - (D) The vehicle to be used by a Universal Service Provider for the purpose of delivering or collecting postal packets;
 - (E) Public Service Vehicles operating a local service when waiting at an authorised bus stop to set down or pick up passengers, or to school buses;
 - (F) The vehicle to take in petrol, oil, water or air from any garage situated on or adjacent to the said length of road.
7. Nothing in Article 4 of this Order shall render it unlawful to cause or permit any vehicle to wait on the length of side of road specified therein for so long as may be necessary to enable goods to be loaded and unloaded from the vehicle.

8. The prohibitions imposed by Articles 4 of this Order shall not apply to Police, Fire, Ambulance or other Emergency Service vehicles or to Local Authority vehicles when in pursuance of statutory duties or powers.

SCHEDULE

Schedule 1 – Prohibition of Waiting, Monday to Saturday, 8.00am to 6.00pm

2.1 Monastery Road, Neath Abbey (West Side)

From a point approximately 23 metres south of its junction with A4230 Neath Abbey Road / New Road for a distance of approximately 122 metres in a South Westerly direction.

THE COMMON SEAL of)
THE COUNCIL was hereunto)
affixed on this 9th day of)
May 2018 in the presence of: -)



PROPER OFFICER



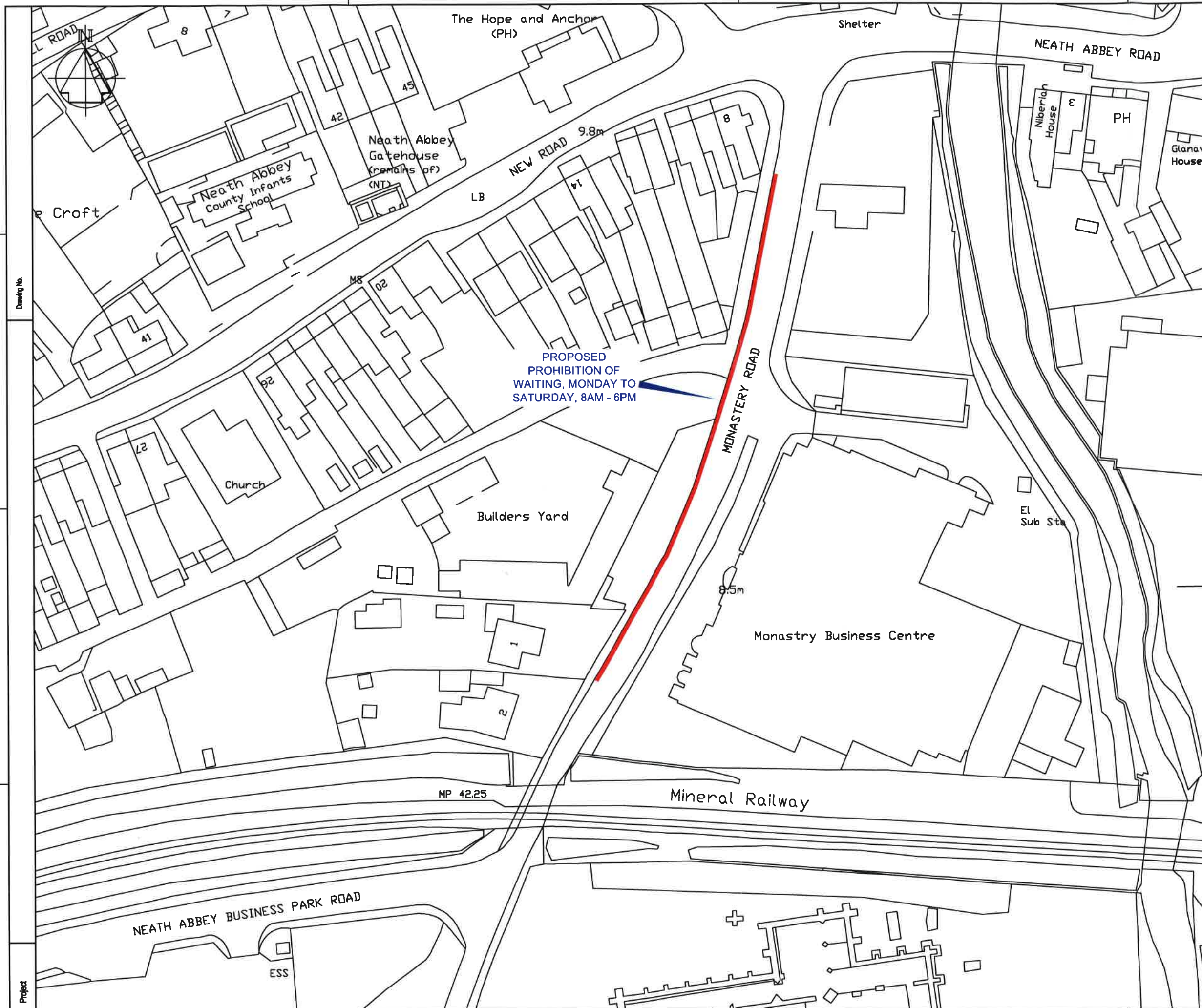

NOTES

A3

- 1 THIS IS A C.A.D. DRAWING AND SHOULD NOT BE AMENDED BY HAND.
- 2 All dimensions in millimetres unless otherwise stated.

 - PROPOSED PROHIBITION OF WAITING, MONDAY TO SATURDAY, 8AM - 6PM (SINGLE YELLOW LINE)

| Rev | Details | Dr | Ch | Ap | Date |
|-----|---------|----|----|----|------|
|-----|---------|----|----|----|------|

Client

PROPER OFFICER

 **Neath Port Talbot**
Castell-nedd Port Talbot
County Borough Council / Cyngor Bwrdeistref Sirol
ENGINEERING AND TRANSPORT

GARETH NUTT
CORPORATE DIRECTOR OF ENVIRONMENT
THE QUAYS, BRUNEL WAY
BAGLAN ENERGY PARK
NEATH SA11 2GG

Project
MONASTERY ROAD
NEATHY ABBEY
NEATH
PROPOSED TRAFFIC ORDER

| File No. | | Financial Code No. | | | |
|-------------|---------------------|--------------------|---------|----------|---------|
| Drawn | CGD | Checked | MCB | Approved | HH |
| Date | JAN '18 | Date | JAN '18 | Date | JAN '18 |
| Scales | NOT TO SCALE | | | | |
| Drawing No. | C98080 / MR / TRO 2 | | | | |