

MALVERN HILLS DISTRICT COUNCIL
(OFF-STREET PARKING PLACES)
(CIVIL ENFORCEMENT)
ORDER 2017

MALVERN HILLS DISTRICT COUNCIL

(OFF-STREET PARKING PLACES)

(CIVIL ENFORCEMENT)

ORDER 2017

Malvern Hills District Council ("the Council") in exercise of its powers under Sections 32, 35 and Part IV of Schedule 9 of the Road Traffic Regulation Act 1984, as amended ("the 1984 Act") and of all other enabling powers, with the consent of Worcestershire County Council in accordance with section 39(3) of the 1984 Act and after consultation with the Chief Constable of Police in accordance with Part III of Schedule 9 to the 1984 Act hereby makes the following Order:

PART 1

GENERAL

Commencement and Citation

1. This Order shall come into operation on the 6 day of November 2017 and may be cited as the Malvern Hills District Council (Off-Street Parking Places) (Civil Enforcement) Order 2017.

Interpretation

2. In this Order, except where the context otherwise requires, the following expressions have the meanings respectively assigned to them:

"the 1984 Act" means the Road Traffic Regulation Act 1984;

"the 2004 Act" means the Traffic Management Act 2004;

"alternative approved method of payment" means cashless payments, park and phone, payment by debit or credit card facilitated by on site or remote verification by, for example, card reader or mobile phone text or phone call or decrementing card;

"authorised permit" means either a member's permit, contractor or visitors permit or staff permit issued by the Council;

“bank holiday” has the same meaning as described in the ‘Banking and Financial Dealings Act 1971. The first Monday of May shall be treated as if it were a Bank Holiday for the purposes of this Order;

“charging days”, means those days which are as specified in Schedule 1 and at each parking place respectively;

“charging hours”, means the period as specified in Schedule 1 at each parking place on all charging days;

“coach” means a chartered bus constructed to carry more than eight seated passengers in addition to the driver;

“caravan” means a non-mechanically propelled and habitable vehicle not exceeding 4.8 metres in length;

“community transport permit” means a permit issued by the Council to organisations providing community transport;

“Council” means Malvern Hills District Council or its successor authority;

“daily charge” means the charge imposed by the Council for parking in a parking place on any one day and for a specified period of time as is identified in the scale of charges specified in Column 6 of Schedule 1 to this Order and by notice at the parking place;

“disabled persons' badge” means a badge and time wheel issued by a Local Authority in accordance with the provisions of The Disabled Persons (Badges for Motor Vehicles) (England) Regulations 2000 or similar legislation for member countries of the EU.

“electric vehicle” means an vehicle that is propelled by one or more electric motors powered by a rechargeable battery;

“expiry time” is the time indicated on the pay and display ticket or alternative approved method and is the time by which the vehicle must leave the parking place;

“HGV” means any vehicle which is constructed or adapted for use for the carriage of goods or burden of any description that has an operating weight exceeding 7.5 tonnes.

“light goods vehicle” means a vehicle which is constructed or adapted for use for the carriage of goods or burden of any description, the overall height of which does not exceed 2.40 metres and the unladen weight of which does not exceed 3050 kilograms and is not drawing a trailer;

“member’s permit” means a parking permit issued to a District Councillor of the Council for use by the District Councillor in exercise of their official duties;

“motor cycle” means a mechanically propelled vehicle with fewer than 4 wheels of which the unladen weight does not exceed 410 kilograms;

“motor home” means a mechanically propelled habitable vehicle not exceeding 4.8m in length;

“owner” in relation to a vehicle means the person who is recorded as the registered keeper by the Driver and Vehicle Licensing Agency on the date on which the vehicle was parked in the parking place in question;

“contractor or visitor permit” means a parking permit issued in exercise of their official duties;

“park” and “parked” refer to the stopping of a vehicle and it remaining at rest for some time whether or not the driver is still in the vehicle and a vehicle shall be deemed to be parked for any period in the same parking place or parking bay (as the case may be) if any part of it is below the vehicle or the vehicle’s load (if any) whether or not the vehicle is moved during that period;

“park and phone” means a method of payment of the parking charge involving registration of payment by phone or electronic means and, on first use, registration of the relevant registration number of the vehicle, location of the parking place, credit or debit card details or any such other details as the Council may from time to time require which is accepted by the Council as a valid method of payment for the relevant time of use of the parking place;

“parking bay” means an area of a parking place, which is provided for the leaving of a vehicle of a class specified and indicated by markings on the surface of the parking place or signed or otherwise indicated by signs in the parking place;

“parking permit” means any or all (as the context shall require) community transport permit, disabled person’s badge, member’s permit, parish council permit, resident permit, season ticket, temporary permit or a permit of a type and design issued by the Council;

“parking place” means an area of land provided by the Council pursuant to Section 32(1) of the 1984 Act for the purpose of parking of vehicles and not closed (in part or in whole) by a notice erected thereon by authority of the Council;

“pay and display ticket” means a ticket issued by a ticket machine located in the parking place in which the vehicle has been parked or issued by a person nominated by the Council on payment of a charge and valid for a parking period as advertised at that parking place;

“penalty charge” and “reduced penalty charge” means a charge set by the Council under the provisions of section 77 of and schedule 9 to the 2004 Act and with the approval of the Secretary of State for Transport which is to be paid to the Council within 28 days beginning with the date of the notice, or 14 days in the case of a reduced penalty charge, following the issue of a penalty charge notice;

“plan” means the plans of parking places appended to this Order;

“public holiday” means Christmas Day, Good Friday and any other day designated by the Government as a public holiday;

“relevant position” means

- (a) in respect of a vehicle displaying a valid disabled person’s badge-
 - (i) in the case of a vehicle fitted with a dashboard or fascia panel, the badge is exhibited thereon so that Part 1 (the front of the badge), is legible from outside the vehicle; or
 - (ii) in the case of a vehicle not fitted with a dashboard or fascia panel, the badge is exhibited in a conspicuous position on the vehicle so that Part 1 of the badge is legible from outside the vehicle;
- (b) in respect of a vehicle displaying a pay and display ticket or parking permit -
 - (i) the ticket or permit is exhibited on the inside surface of the windscreen or in a clearly visible position so that it is facing forwards and can be easily seen and read from the front or side of the vehicle; or
 - (ii) in the case of a vehicle that is not fitted with a transparent windscreen, the ticket or permit is exhibited on the front of the vehicle facing forwards and clearly visible;

“resident permit” means a virtual parking permit issued by the Council in accordance with terms of use;

“season ticket” means a virtual parking permit issued by the Council in accordance with terms of use;

“staff permit” means a parking permit issued by the Council to an employee, worker, contractor, or other such person performing services to the Council from time to time;

“ticket machine” means an apparatus of a type designed to indicate the time by a clock and to issue parking tickets which show that a payment has been made of an amount or for a period specified thereon and which specify the date and, either the time of such payment, or the expiry time of the parking period for which payment has been made;

“trailer” refer to an object or vehicle being drawn by another vehicle not including a caravan;

“vehicle” includes any motor car, motor cycle, coach, goods vehicle or other mechanically propelled automobile.

“virtual parking permit” means an electronic record of parking ticket, permit or dispensation issued and confirmed by the Council to exempt a vehicle from a restriction in the provisions of this order, under the terms applicable at the time of issue. A virtual parking permit may be obtained by any of the methods provided from time to time by the Council and to be valid must be registered on an account in an electronic database approved by the Council with an indication that the permit has been issued and validated in accordance with Council procedures.

“wait” and “waiting” refer to the stopping of a vehicle and it remaining at rest for some time whether or not the driver is still in the vehicle; “wait” and “waiting” apply as for “park” and “parked”

3. Except where the context requires otherwise, any reference in this Order to a numbered Article shall be construed as a reference to the Article bearing that number in this Order and any reference in this Order to the schedule is a reference to schedules 1 and 2 to this order, otherwise they shall be referred to independently as Schedule 1 or Schedule 2 etc.
4. Any reference in this Order to any enactment shall be construed as a reference to that enactment as amended, applied, consolidated, re-enacted by or as having effect by virtue of any subsequent enactment and to any subordinate legislation or by-law made under that enactment.
5. Unless the context otherwise requires, words denoting the singular shall include the plural and vice versa and words denoting the persons shall include either gender, bodies corporate, unincorporated associations and partnerships.
6. The Interpretation Act 1978 shall apply for the interpretation of this Order as it applies for the interpretation of an Act of Parliament.

PART 2

DESIGNATION AND USE OF PARKING PLACES

Designation

7. Each area of land or building named and specified by the Plans in Schedule 2 to this Order may be used, subject to the provisions of this Order, as a place to park vehicles of such classes, in such positions, on such days, during such hours, for such periods as are advertised at each parking place and on payment of such charges as stated in Schedule 1 to this Order and as advertised at the parking place.

Class and position of vehicle

8. Where by notice at a parking place, the parking place, or any parking bay within the parking place, is described as available for vehicles of a specified class or vehicles to be parked in a specified location, no person shall cause or permit a vehicle to be parked in that parking place or in any parking bay within the parking place,
 - (i) unless it is of the specified class; or is;
 - (ii) in a position other than that specified; or
 - (iii) for a purpose other than provided for in this Order.

Classes of vehicle

9. No person shall cause or permit a vehicle to be parked in a parking bay unless it is a class specifically prescribed in column 2 of Schedule 1 or advertised at the parking place.

Position of vehicle

10. A driver of a vehicle (other than a HGV or a coach not parking in a coach bay) shall ensure that the vehicle or anything drawn by it is not parked beyond the parking bay markings and shall not permit it to wait in that parking place unless it is so positioned.
11. A driver of a HGV or a coach not parking in a coach bay shall ensure that the vehicle is positioned so that it does not obstruct or potentially obstruct other vehicles using the parking place, the free flow of traffic circulating within the parking place or the entrances to and exits from the parking place.

Disabled person's parking bays

12. No person shall cause or permit a vehicle to be parked in a parking bay marked for disabled persons unless the vehicle displays a valid disabled person's badge and

immediately before or immediately after the act of parking the vehicle has been or is about to be used by the person(s) in respect of whom the disabled person's badge has been issued.

13. Any persons intending to park for a period over the specified no charge period must pay for the additional period.

Electric vehicle parking bays

14. No person shall cause or permit a vehicle to be parked in a parking bay marked for the charging of electric vehicles unless it is an electric vehicle charging.

Motorcycle parking bays

15. No person shall cause or permit a vehicle to park in a parking bay marked for motor cycles unless the vehicle is a motorcycle.

Motor homes, caravans and trailers

16. Motor homes, caravans and trailers are only permitted to wait in accordance with Schedule 1 of this Order and are liable to a parking charge.

Hours of operation and maximum period of stay

17. A parking place or in any parking bay within the parking place as described in Schedule 1 as being in operation on specified days, during specified hours or for a maximum period of stay, no person shall cause or permit a vehicle to be parked in that parking place or in any parking bay within the parking place on any day, during such hours or for any period other or longer than those specified.

Period of no return

18. Where specified in Column 5 of Schedule 1 and by notice at the parking place, a parking place is described as having a period within which a vehicle may not return, no person shall cause or permit a vehicle to be parked again in that parking place on any day, during such hours within which the vehicle is excluded from waiting in the parking place.

Power to close or suspend parking places

19. Nothing in this Order shall prevent the Council by notice, sign or barrier displayed or erected in a parking place:

- (i) from closing a parking place or any part thereof for any period; or
 - (ii) from setting aside a parking place or any part or parts thereof on all days or on certain days or during certain parts of days for use only by particular vehicles or organisations.
20. Any person closing or suspending the use of a parking place or any part thereof shall thereupon place or cause to be placed in or adjacent to that parking place or that part thereof a notice or traffic sign indicating that of that parking place or that part thereof is closed or the use is suspended and that parking by vehicles is prohibited.
21. No person shall cause or permit a vehicle to be parked in a parking place or any part thereof during such periods that the parking place or that part thereof is closed or the use is suspended or during such period as there is in or adjacent thereto a notice or traffic sign indicating the closure or suspension placed by or on behalf of the Council.

Sale of Goods

22. No person shall in a parking place without the express written permission of the Council, use a vehicle, in connection with the sale of any article, including the vehicle itself, to any person in or near the parking place or in connection with the selling or offering for hire of skill or services in any other capacity.

Parked with engine running

23. No person shall in a parking place continue to run the engine when the vehicle is in the parking space and shall not start the engine except when about to change the position of the vehicle in or to depart from the parking place.

Parked causing an obstruction or potential obstruction

24. No person shall in a parking place park the vehicle in such a manner or place where it causes an obstruction or potential obstruction to any other users of the parking place.

PART 3 CHARGES FOR PARKING

Pay and Display Parking Places

25. The person in charge of a vehicle, upon parking the vehicle in a parking bay, shall immediately

- (i) arrange for the purchase of a pay and display ticket from a ticket machine situated at that parking place at the level of daily charge and for the period required in accordance with the scale of charges as stated in Column 6 of Schedule 1 to this Order and as advertised at the parking place.

or

- (ii) make arrangements to pay the appropriate fee through an alternative approved method of payment such as pay by phone at the level of charge and for the period required in accordance with the scale of charges as stated in Column 6 of Schedule 1 to this Order and as advertised at the parking place.

Payment

26. No person shall cause or permit any vehicle to be parked in a parking place without arranging for the appropriate charge (if any) to be paid in accordance with the scale of current charges as specified in Column 6 of Schedule 1 to this Order and as advertised at the parking place.

Means of payment

27. The charges referred to in the preceding Article shall be payable in the manner as advertised at that parking place.

Display of ticket

28. Save for payment by an alternative approved method of payment, once a vehicle has been parked within a parking place that is liable to a parking charge the person in charge of the vehicle shall ensure that:

- (i) a valid pay and display ticket has been obtained to cover the entire period that the vehicle is parked in the parking place, and
- (ii) the valid pay and display ticket is displayed in the relevant position on the vehicle in respect of which it was issued at all times the vehicle is parked.

Validity of pay and display tickets

29. A pay and display ticket is not transferable from one vehicle to another and on transfer the pay and display ticket ceases to be valid.
30. A pay and display ticket is only valid in the parking place in which it was issued.

Expiry of parking period

31. The expiry of the period for which the appropriate charge has been paid shall be
- (i) where a pay and display ticket has been purchased, when the time is later than the expiry time shown on the pay and display ticket displayed, or
 - (ii) where an alternative approved method of payment has been used, when the period for which payment has been made and recorded has been exceeded.

No pay and display ticket displayed

32. If at any time while a vehicle is parked in a parking place, no pay and display ticket is displayed on that vehicle in the relevant position and in accordance with the provisions of this Order, it shall be deemed that the charge has not been paid.
33. If at the time when a vehicle is parked during the charging hours in a parking place and the nearest ticket machine in that parking place is out of order, then a ticket shall be obtained from another ticket machine within the same parking place (where provided) or as directed in the parking place, or alternative approved method.
34. Where an alternative approved method of payment has been obtained, any requirement for a pay and display ticket to be displayed on the vehicle to which it relates shall not apply.

Parking permits

35. The Council may issue a resident permit in accordance with the provisions of the Council's terms of use.
36. The Council may issue a season ticket in accordance with the provisions of the Council's terms of use.
37. The Council may issue a community transport permit in accordance with the Council's Community Transport Policy to a member of the Worcestershire Concessionary Travel Schedule or to any scheme from time to time in place or at the Council's

discretion to those organisations providing community transport in the Council's administrative area.

38. The Council may issue member's permits for District Councillors to park in any parking place subject to such rules as the Council may impose from time to time but otherwise in accordance with this Order.
39. The Council may issue staff permits to park in any parking place subject to such rules as the Council may impose from time to time but otherwise in accordance with this Order.
40. A parking permit as set out in Articles 35 – 42 is only valid in the parking places(s) in respect of which it was issued, for the vehicle in respect of which it was issued and up to the date of expiry shown on the parking permit or virtual parking permit as the case may be.
41. A driver who has a parking permit shall abide by the terms stipulated by the Council for use of the parking permit.
42. Nothing in this Order shall prevent the Council from exercising its discretion to issue a temporary permit to an individual or organisation to park in a specific parking place for a defined period of time.

Display of parking permit

43. A parking permit shall be displayed in the relevant position on the vehicle in respect of which it was issued at all times during which the vehicle is parked in the parking place.
44. Where a virtual parking permit has been obtained as an alternative to a pay and display ticket and remains valid, any requirement in this Order for the pay and display ticket to be displayed on the vehicle to which it relates shall not apply.

Replacement of parking permits

45. Damaged or lost parking permits will be replaced on application to the Council and on payment of an administration fee in accordance with Council policies. The damaged or lost parking permit will then become immediately invalid.

Restriction on removal

46. When a pay and display ticket or parking permit has been exhibited on a vehicle in the relevant position no person shall remove the pay and display ticket or parking permit from the vehicle until the vehicle is removed from the parking place.

PART 4 EXEMPTIONS

Exemption from charge

47. No charge shall be payable in respect of;
- (i) a motorcycle unless parked in a parking bay other than marked for motorcycles; or
 - (ii) a vehicle parked displaying in a relevant position a parking permit valid for that parking place; or
 - (iii) emergency service vehicles in the course of undertaking emergency duties.

Payment by alternative approved method of payment

48. Where arrangements to pay the charge have been made through an alternative approved method of payment and no pay and display ticket is produced by following the process, the driver of a vehicle shall be exempt from the requirement to display such a ticket.

PART 5 RELOCATION, REMOVAL, CLAMPING AND DISPOSAL OF VEHICLES

Emergencies

49. A person authorised by the Council or a police officer in uniform may, using such measures as are appropriate, move or cause to be moved in the case of an emergency to any place he/she thinks fit, any vehicle parked in a parking place.

Contraventions in suspended parking place

50. A person authorised by the Council may, using such measures as are appropriate, move or cause to be moved to any place he/she thinks fit, any vehicle parked in a

parking place which has been closed or suspended in whole or in part by the Council and the cost of movement or removal and safe keeping shall be the liability of the owner of the vehicle.

Safe keeping

51. Any person removing a vehicle from a parking place under the provisions of this Order shall make such arrangements as may be reasonably necessary to provide for the safe keeping of the vehicle.

Disposal of vehicles abandoned in parking places

52. The Council may sell or otherwise dispose of, in accordance with current legislation, a vehicle which has been, or could at any time be, removed from a parking place if the vehicle appears to have been abandoned and will be dealt with under the abandoned vehicle legislation.

PART 6

CONTRAVENTION AND PENALTY CHARGE

Contravention

53. Save for the provisions in Part 7, if a vehicle is parked in a parking place without complying with the requirements of this Order, a contravention shall have occurred and a penalty charge shall be payable.

Restriction on removal of notices

54. Any notice fixed to a vehicle in accordance with this Order shall not be removed or interfered with except by or under the authority of:
- (i) the owner, or person in charge of, the vehicle; or
 - (ii) the Council.

Indications as Evidence

55. The particulars given in any notice served on a vehicle in accordance with the provisions of this Order shall be treated as evidence in any proceedings relating to failure to pay the penalty charge.

PART 7

LIABILITY AND OTHER PROVISIONS

Liability

56. The Council accepts no liability for the loss or damage to vehicles or other property left in any of the parking places to which this Order applies save for that arising from the negligence of the Council.

Validity

57. If a Court, the Department for Transport, the Traffic Penalty Tribunal or the Traffic Enforcement Centre declares any part of this Order to be invalid or unenforceable; such declaration shall not invalidate the remainder of the Order.

Driving within a parking place

58. Where in a parking place signs are erected or surface markings are laid for the purpose of
- (i) indicating the entrance to or exit from the parking place, or
 - (ii) indicating that a vehicle using the parking place shall proceed in a specified direction within the parking place, any person who drives or permits to be driven any vehicle
 - (i) so that it enters the parking place otherwise than by an entrance or leaves the parking place otherwise than by an exit, so indicated, or
 - (ii) in a direction other than so specified shall be liable to prosecution.
59. Any person who, without the permission of a person authorised by the Council in that behalf, drives or permits to be driven any vehicle in a parking place for any purpose other than the purpose of leaving that vehicle in the parking place in accordance with the provisions of this Order or for the purpose of departing from the parking place shall be liable to prosecution.

Wilful damage

60. Any person who with intent to defraud interferes with a ticket machine or operates or attempts to operate it by the insertion of objects other than undamaged and unaltered coins of legal tender and of the appropriate denomination, shall be liable to prosecution.

Domestic purposes

61. Any person who uses any part of the parking place or any vehicle parked in a parking place
- (i) for sleeping (except HGV in accordance with Schedule 1) or camping or cooking, or
 - (ii) for the purpose of servicing or washing any vehicle or part thereof other than is reasonably necessary to enable the vehicle to depart from the parking place, shall be liable to prosecution.

Behaviour

62. Any person who wilfully sounds any horn or any other similar instrument on a vehicle except when about to change the position of the vehicle in or to depart from the parking place shall be liable to prosecution.
63. Any person who in a parking place shouts or otherwise makes any loud noise to the disturbance or annoyance of users of the parking place or residents or premises in the neighbourhood shall be liable to prosecution.
64. Any person who in a parking place uses any threatening, abusive or insulting language, gesture or conduct with intent to put any person in fear or so as to occasion a breach of the peace or whereby a breach of the peace is likely to be occasioned shall be liable to prosecution.

Other activities

65. Any person who in a parking place
- (i) erects or causes or permits to be erected any tent, booth, stand, building or other structure without the written consent of the Council, or
 - (ii) lights or causes to be lit any fire,
 - (iii) causes wilful or deliberate damage to the fabric of the parking place
 - (iv) cycles or skateboards
 - (v) takes part in or undertakes ball games or sporting activities
- shall be liable to prosecution.

PART 8

REVOCATIONS

Revocations

66. The following Order made by the Council and all their amendments and any other Orders and Regulations of whatever nature relating to off-street parking places specified in the Schedules within the area of the Council made before the introduction of this Order are hereby revoked:

The Malvern Hills District Council (Off Street Parking Places) (Civil Enforcement) Order 2013

The Malvern Hills District Council (Off Street Parking Places) (Civil Enforcement) (Amendment No. 1) Order 2014

EXECUTED as a Deed by affixing the COMMON SEAL
of Malvern Hills District Council
in the presence of

Dated this

MALVERN HILLS DISTRICT COUNCIL

(OFF-STREET PARKING PLACES)

(CIVIL ENFORCEMENT) ORDER 2017

SCHEDULE 1

1	2	3	4	5	6
Name of parking place and Plan number	Permitted classes of vehicles	Days and hours of operation of parking place	Maximum waiting time	No return within	Scale of Charges
Belle Vue Terrace (1)	Motor cars Electric vehicles Light goods vehicles Motor cycles	All days between 08:00 – 16:00	2 hours	2 hours	Up to 1 hour £0.50 Up to 2 hours £1.40 Motor cycles parked in a motor cycle bay – no charge Vehicles displaying a valid disabled person's badge and time wheel set at time of arrival – no charge for 2 hours
Belle Vue Terrace (1)	Motor cars Electric vehicles Light goods	All days between 16:00 – 08:00	16 hours	No restriction	Between 16:00 – 08:00 £1.50 Motor cycles parked in a motor cycle bay – no charge Vehicles displaying a valid disabled person's badge and

1	2	3	4	5	6
Name of parking place and Plan number	Permitted classes of vehicles	Days and hours of operation of parking place	Maximum waiting time	No return within	Scale of Charges
	vehicles Motor cycles				time wheel set at time of arrival – no charge for 2 hours
Council House (2)	Motor cars Electric vehicles Light goods vehicles Motor cycles	All days, all hours	24 hours	No restriction	Up to 2 hours £1.40 Only between 16:00 – 08:00 £1.50 Up to 24 hours £3.00 Motor cycles parked in a motor cycle bay – no charge Vehicles displaying a valid disabled person's badge and time wheel set at time of arrival – no charge for 3 hours
Edith Walk (3)	Motor cars Electric vehicles Motor cycles Light goods vehicles	All days between 08:00 – 16:00	2 hours	2 hours	Up to 1 hour £0.50 Up to 2 hours £1.40 Motor cycles parked in a motor cycle bay – no charge Vehicles displaying a valid disabled person's badge position and time wheel set at time of arrival – no charge for 2 hours

1	2	3	4	5	6
Name of parking place and Plan number	Permitted classes of vehicles	Days and hours of operation of parking place	Maximum waiting time	No return within	Scale of Charges
Edith Walk (3)	Motor cars Electric vehicles Light goods vehicles Motor cycles	All days between 16:00 – 08:00	16 hours	No restriction	Between 16:00 – 08:00 £1.50 Motor cycles parked in a motor cycle bay – no charge Vehicles displaying a valid disabled person's badge and time wheel set at time of arrival – no charge for 2 hours
Geraldine Road (4)	Motor cars Electric vehicles Light goods vehicles Motor cycles	All days between 08:00 – 16:00	4 hours	2 hours	Up to 1 hour £0.50 Up to 2 hours £1.00 Up to 4 hours £2.00 Motor cycles parked in a motor cycle bay – no charge Vehicles displaying a valid disabled person's badge and time wheel set at time of arrival – no charge for 3 hours

1	2	3	4	5	6
Name of parking place and Plan number	Permitted classes of vehicles	Days and hours of operation of parking place	Maximum waiting time	No return within	Scale of Charges
Geraldine Road (4)	Motor cars Electric vehicles Light goods vehicles Motor cycles	All days between 16:00 – 08:00	16 hours	No restriction	Between 16:00 – 08:00 £1.50 Motor cycles parked in a motor cycle bay – no charge Vehicles displaying a valid disabled person's badge and time wheel set at time of arrival – no charge for 3 hours
Grange Road North (5)	Motor cars Electric vehicles Light goods vehicles Motor cycles	All days between 08:00 – 16:00	2 hours	2 hours	Up to 1 hour £0.50 Up to 2 hours £1.40 Motor cycles parked in a motor cycle bay – no charge Vehicles displaying a valid disabled person's badge and time wheel set at time of arrival – no charge for 2 hours
Grange Road North (5)	Motor cars Electric vehicles Light goods	All days between 16:00 – 08:00	16 hours	No restriction	Between 16:00 – 08:00 £1.50 Motor cycles parked in a motor cycle bay – no charge Vehicles displaying a valid disabled person's badge and

1	2	3	4	5	6
Name of parking place and Plan number	Permitted classes of vehicles	Days and hours of operation of parking place	Maximum waiting time	No return within	Scale of Charges
	vehicles Motor cycles				time wheel set at time of arrival – no charge for 2 hours
Grange Road South (6)	Motor cars Electric vehicles Light goods vehicles Motor cycles	All days between 08:00 – 16:00	2 hours	2 hours	Up to 1 hour £0.50 Up to 2 hours £1.40 Motor cycles parked in a motor cycle bay – no charge Vehicles displaying a valid disabled person's badge and time wheel set at time of arrival – no charge for 2 hours
Grange Road South (6)	Motor cars Electric vehicles Motor cycles Light goods vehicles	All days between 16:00 – 08:00	16 hours	No restriction	Between 16:00 – 08:00 £1.50 Motor cycles parked in a motor cycle bay – no charge Vehicles displaying a valid disabled person's badge and time wheel set at time of arrival – no charge for 2 hours

1	2	3	4	5	6
Name of parking place and Plan number	Permitted classes of vehicles	Days and hours of operation of parking place	Maximum waiting time	No return within	Scale of Charges
Hanley Road (7)	Motor cars Electric vehicles Light goods vehicles Motor cycles Caravans Motor homes Coaches HGVs	All days, all hours	24 hours	No restriction	Up to 2 hours £1.00 (08:00 – 16:00) Up to 4 hours £2.00 (08:00 – 16:00) Only between 16:00 – 08:00 £1.50 Up to 24 hours £3.00 £9.00 for a 7 day ticket Up to 24 hours (Coaches only): £0.10 if parked in a coach bay otherwise £7.00 Up to 24 hours (HGVs only): £7.00 Motor cycles parked in a motor cycle bay – no charge Vehicles displaying a valid disabled person's badge and time wheel set at time of arrival – no charge for 3 hours
Link Top (8)	Motor cars	All days, all hours	24 hours	No restriction	None

1	2	3	4	5	6
Name of parking place and Plan number	Permitted classes of vehicles	Days and hours of operation of parking place	Maximum waiting time	No return within	Scale of Charges
	Electric vehicles Light goods vehicles Motor cycles				
New Street (9)	Motor cars Electric vehicles Light goods vehicles Motor cycles	All days, all hours	24 hours	No restriction	Up to 2 hours £1.00 (08:00 – 16:00) Up to 4 hours £2.00 (08:00 – 16:00) Only between 16:00 – 08:00 £1.50 Up to 24 hours £3.00 £9.00 for a 7 day ticket Motor cycles parked in a motor cycle bay – no charge Vehicles displaying a valid disabled person's badge and time wheel set at time of arrival – no charge for 3 hours
Newtown Road (10)	Motor cars Electric vehicles	All days, all hours	24 hours	No restriction	None

1	2	3	4	5	6
Name of parking place and Plan number	Permitted classes of vehicles	Days and hours of operation of parking place	Maximum waiting time	No return within	Scale of Charges
	Light goods vehicles Motor cycles				
Priory Road North (11)	Motor cars Electric vehicles Light goods vehicles Motor cycles	All days, all hours	24 hours	No restriction	Up to 2 hours £1.00 (08:00 – 16:00) Up to 4 hours £2.00 (08:00 – 16:00) Only between 16:00 – 08:00 £1.50 Up to 24 hours £3.00 £9.00 for a 7 day ticket

1	2	3	4	5	6
Name of parking place and Plan number	Permitted classes of vehicles	Days and hours of operation of parking place	Maximum waiting time	No return within	Scale of Charges
					Motor cycles parked in a motor cycle bay – no charge Vehicles displaying a valid disabled person's badge and time wheel set at time of arrival – no charge for 3 hours
Priory Road South (12)	Motor cars Electric vehicles Light goods vehicles Motor homes Coaches Motor cycles	All days, all hours	24 hours	No restriction	Up to 2 hours £1.00 (08:00 – 16:00) Up to 4 hours £2.00 (08:00 – 16:00) Only between 16:00 – 08:00 £1.50 Up to 24 hours £3.00 £9.00 for a 7 day ticket Up to 24 hours (Coaches only): £0.10 if parked in a coach bay otherwise £7.00 Motor cycles parked in a motor cycle bay – no charge Vehicles displaying a valid disabled person's badge and time wheel set at time of arrival – no charge for 3 hours

1	2	3	4	5	6
Name of parking place and Plan number	Permitted classes of vehicles	Days and hours of operation of parking place	Maximum waiting time	No return within	Scale of Charges
Teme Street (13)	Motor cars Electric vehicles Light goods vehicles Motor cycles	All days, all hours	24 hours	No restriction	Up to 2 hours £1.00 (08:00 – 16:00) Up to 4 hours £2.00 (08:00 – 16:00) Only between 16:00 – 08:00 £1.50 Up to 24 hours £3.00 £9.00 for a 7 day ticket Motor cycles parked in a motor cycle bay – no charge Vehicles displaying a valid disabled person's badge and time wheel set at time of arrival – no charge for 3 hours
Victoria Road (14)	Motor cars Electric vehicles Light goods vehicles Motor cycles	All days, all hours	24 hours	No restriction	Up to 2 hours £1.00 (08:00 – 16:00) Up to 4 hours £2.00 (08:00 – 16:00) Only between 16:00 – 08:00 £1.50 Up to 24 hours £3.00 £9.00 for a 7 day ticket Motor cycles parked in a motor cycle bay – no charge

1	2	3	4	5	6
Name of parking place and Plan number	Permitted classes of vehicles	Days and hours of operation of parking place	Maximum waiting time	No return within	Scale of Charges
					Vehicles displaying a valid disabled person's badge and time wheel set at time of arrival – no charge for 3 hours

Payment Option	Permitted classes of vehicles	Days and hours of operation of parking place	Maximum waiting time	No return within	Scale of Charges					
Season Tickets	Motor cars	All days, all hours	24 hours	No restriction	Area	Quarterly season ticket	Annual season ticket			
	Electric vehicles	Specified car parks ¹			Malvern	£40	£120			
	Light goods vehicles				Tenbury Wells	£40	£120			
	Motor cycles				Upton-upon-Severn	£25	£75			
Residents Permits	Motor cars	All days, all hours	2 hours	2 hours	Annual permit £25					
	Electric vehicles	All Council car parks ²								
	Light goods vehicles									
	Motor cycles									

¹ Full terms and conditions are issued with every season ticket purchased

² Full terms and conditions are issued with every residents permit purchased

The map is a detailed street plan of the Mount Pleasant Hotel area in London. The hotel building is centrally located, outlined in a thick black line. It is situated on a plot numbered 171. To the north of the hotel is a large open area labeled 'The Courtyard'. To the east of the hotel is a row of buildings numbered 1 through 27. To the south of the hotel is a row of buildings numbered 28 through 44. To the west of the hotel is a row of buildings numbered 45 through 52. The map also shows several streets: St. Ann's Road to the north, Wells Road to the east, and Cross Street to the south. Other landmarks include St. Thomas's Church, a Post Office, and a Head Post Office. The map includes a north arrow in the top right corner and a scale bar in the bottom right corner. The title 'Mount Pleasant Hotel' is printed at the bottom center of the map.



Malvern Hills District Council

© Crown copyright. All rights reserved
(Malvern Hills District Council) (0100018590) 2013.

2 - Council House Parking Place

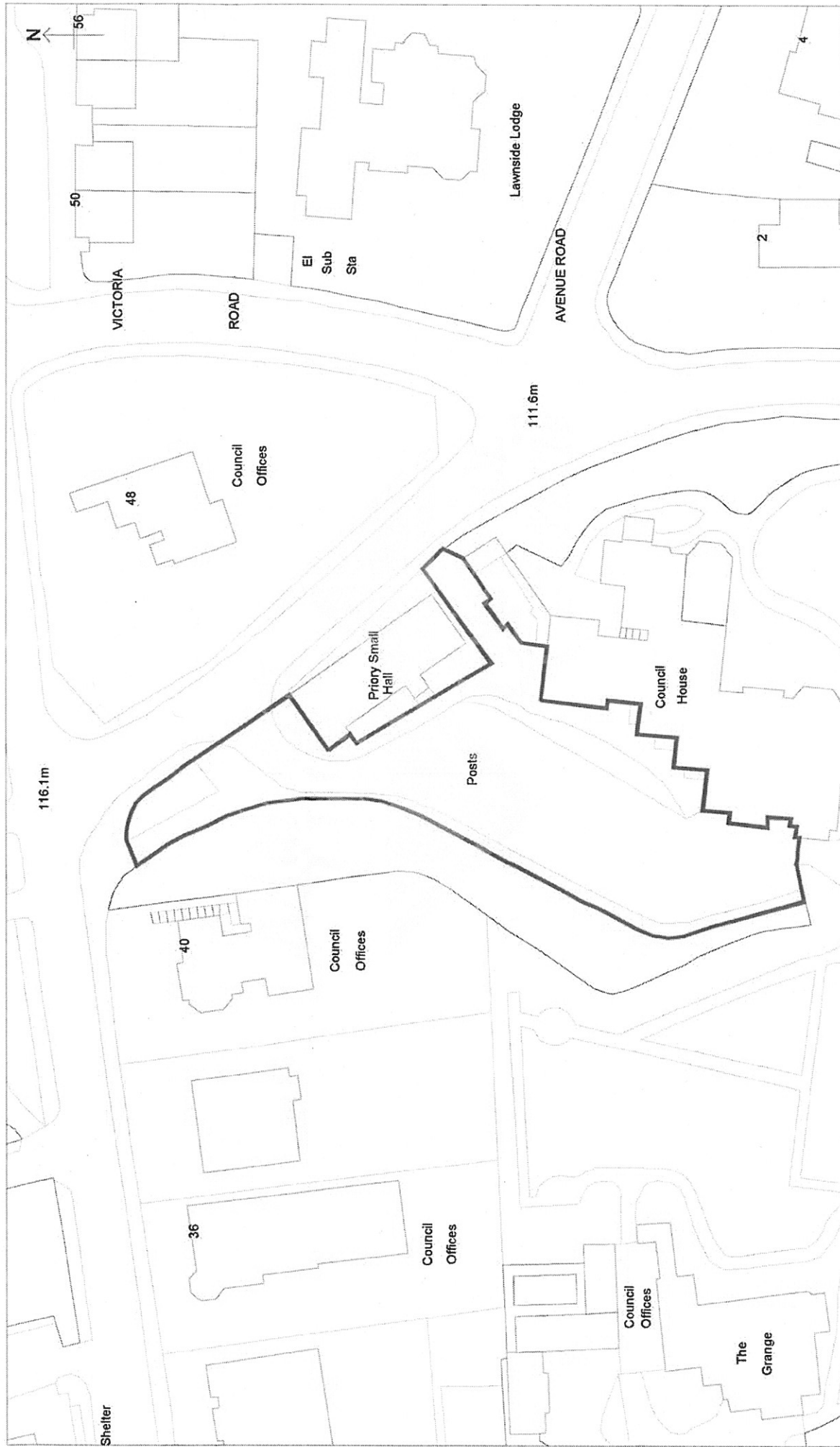

Scale: 1:500

3 - Edith Walk Parking Place

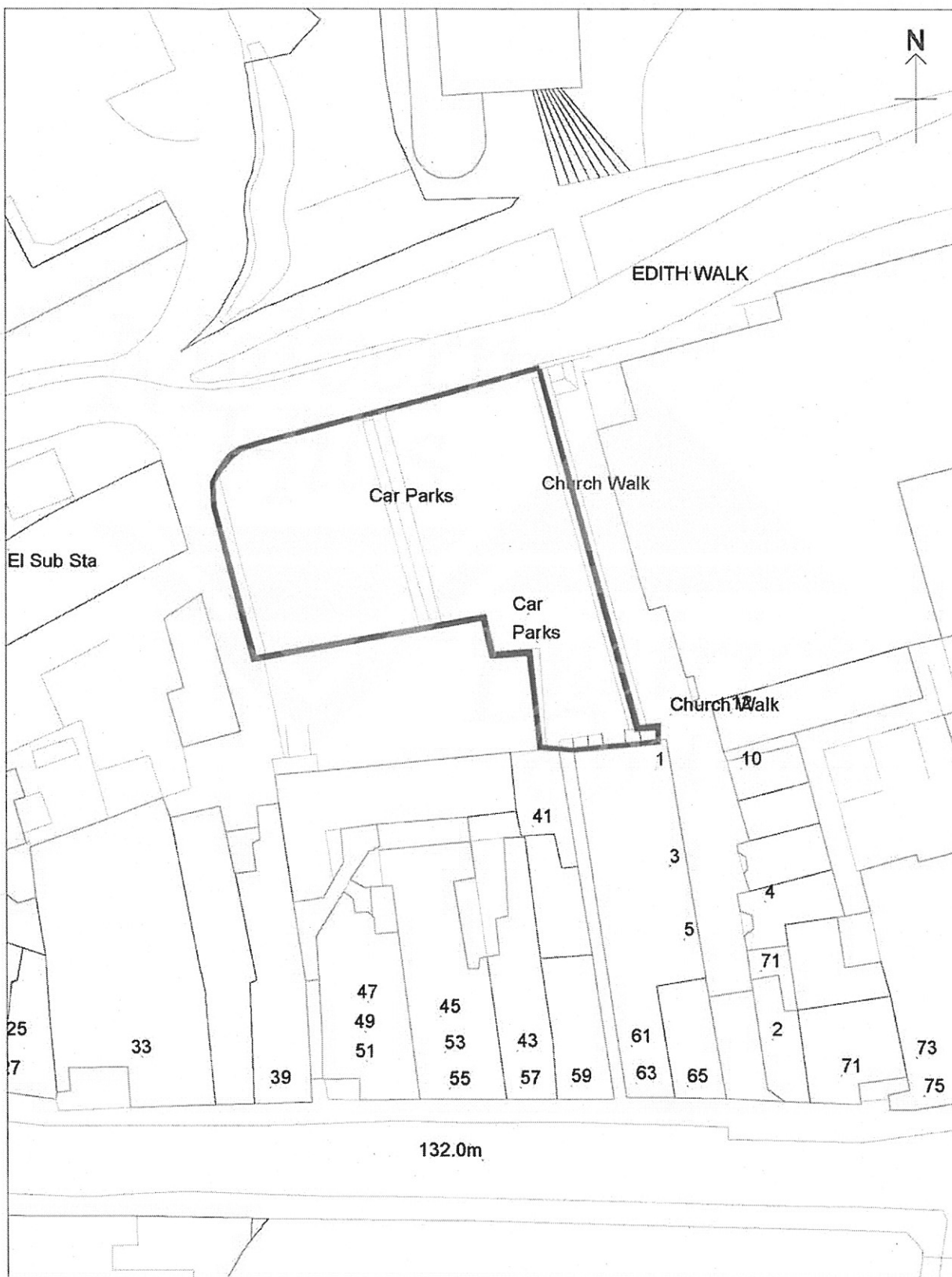

Scale: 1:500

4 - Geraldine Road Parking Place

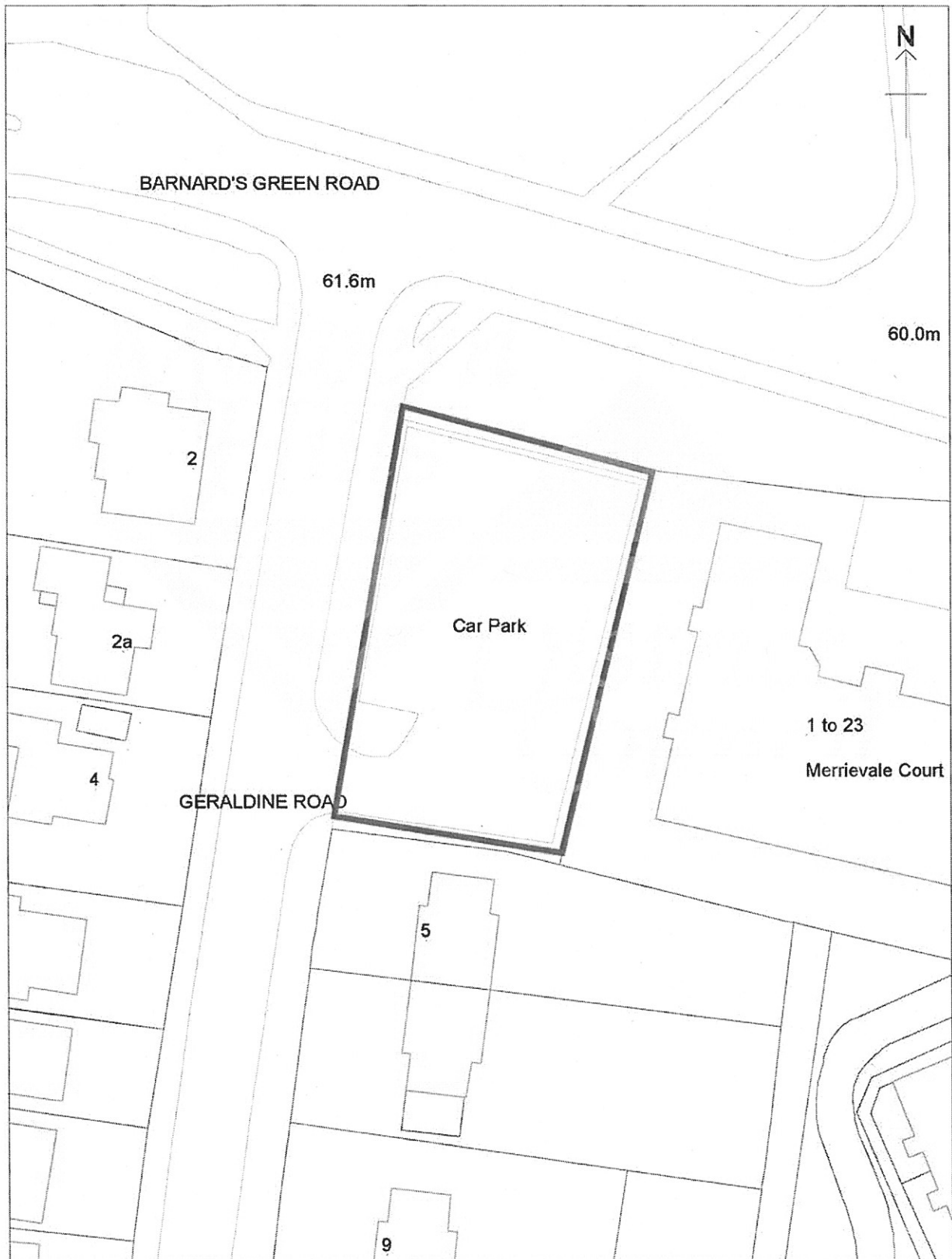

Scale: 1:500

5 - Grange Road North Parking Place



Scale: 1:500

6 - Grange Road South Parking Place

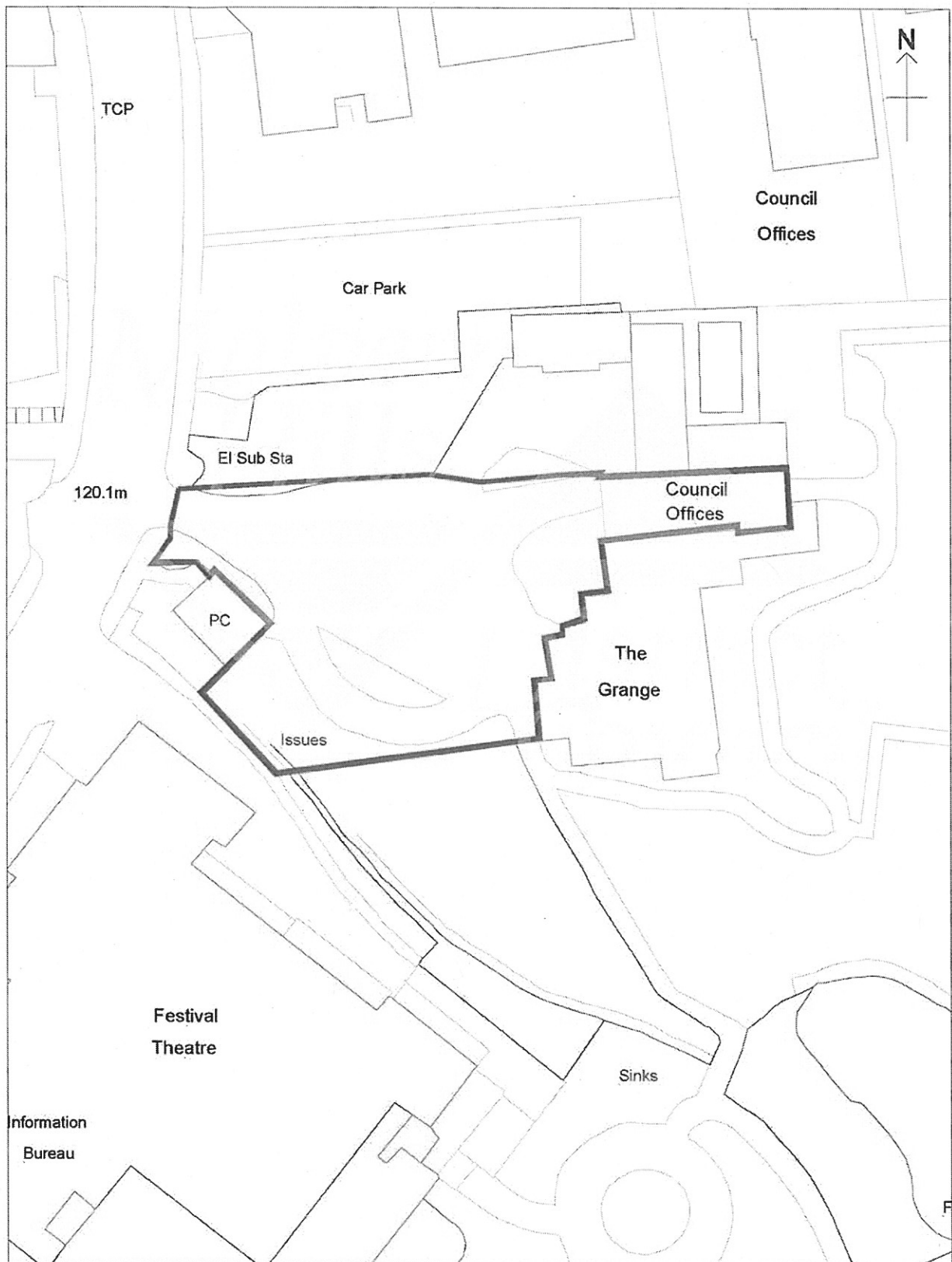

Scale: 1:500

7 - Hanley Road, Upton Parking Place

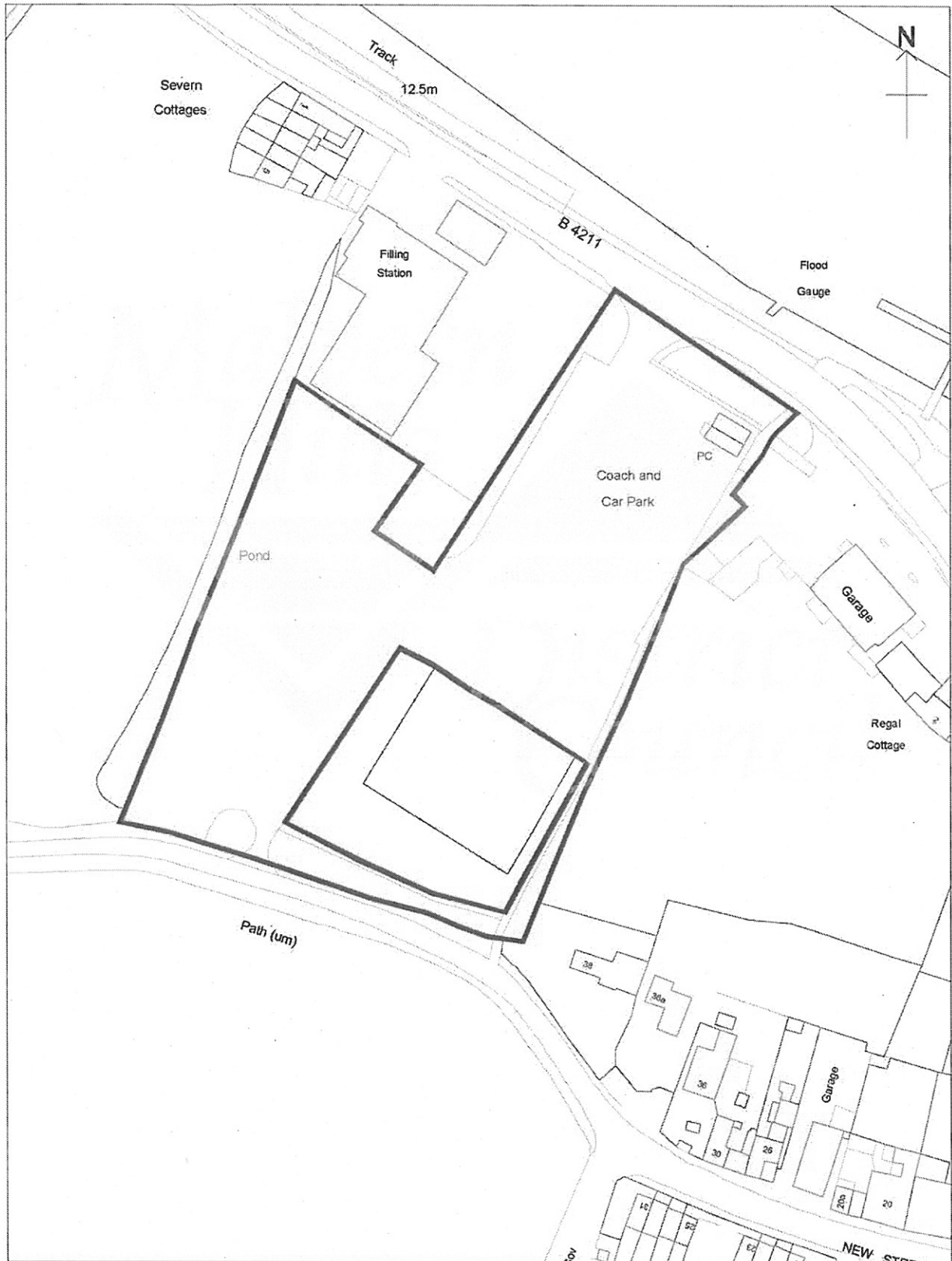

Scale: 1:1250

8 - Link Top Parking Place

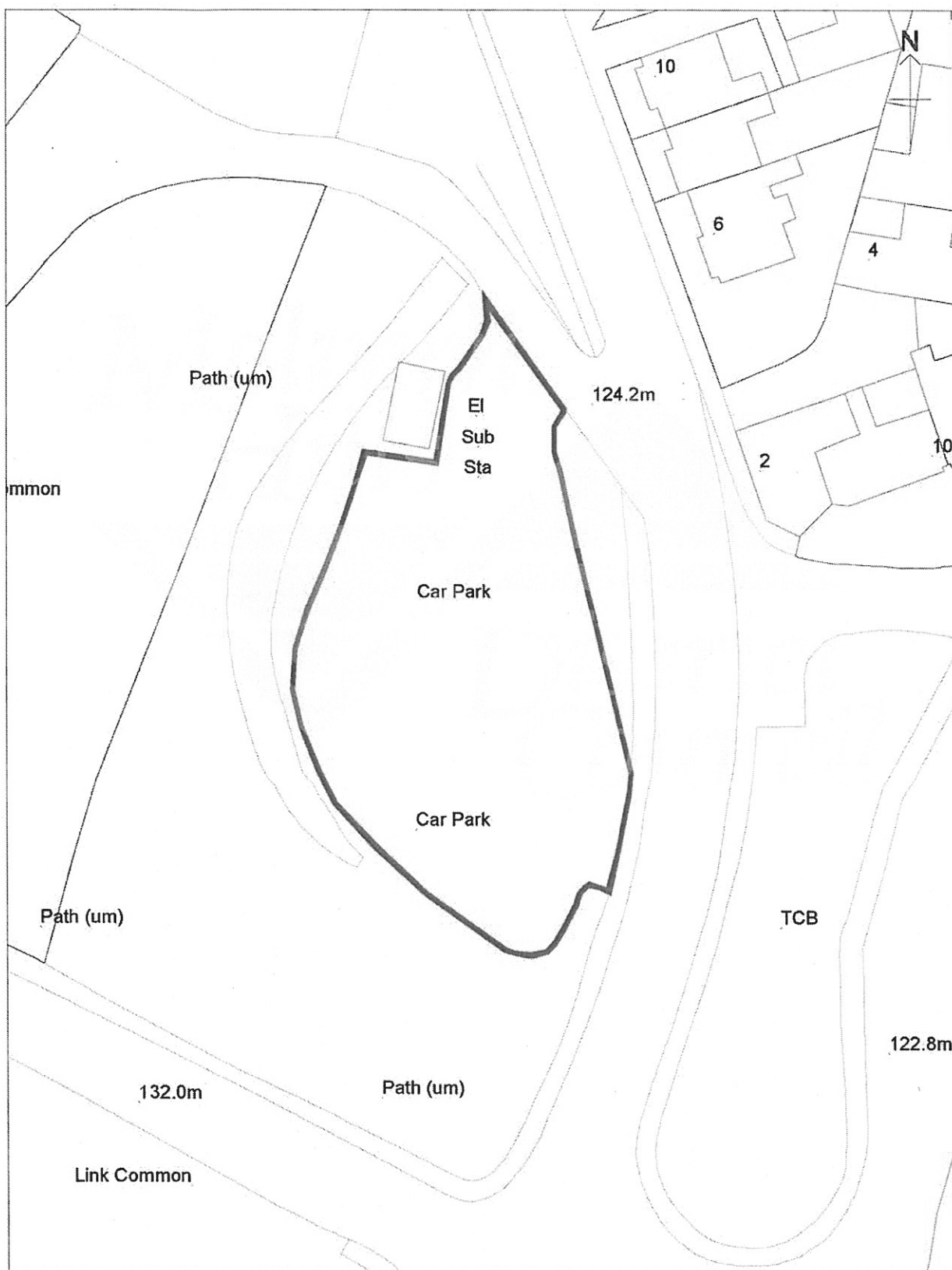

Scale: 1:500

9 - New Street, Upton Parking Place

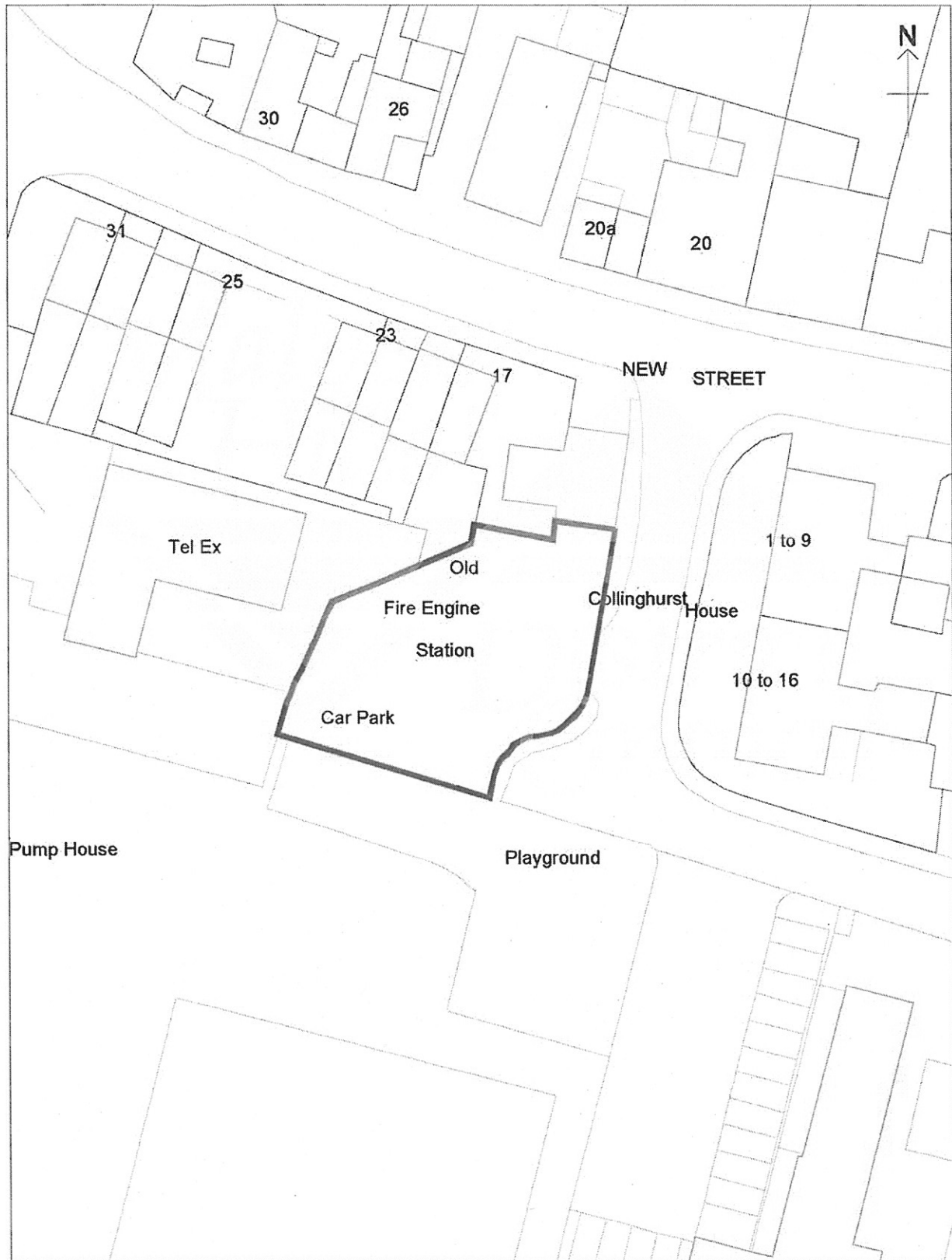

Scale: 1:500

10 - Newtown Road Parking Place

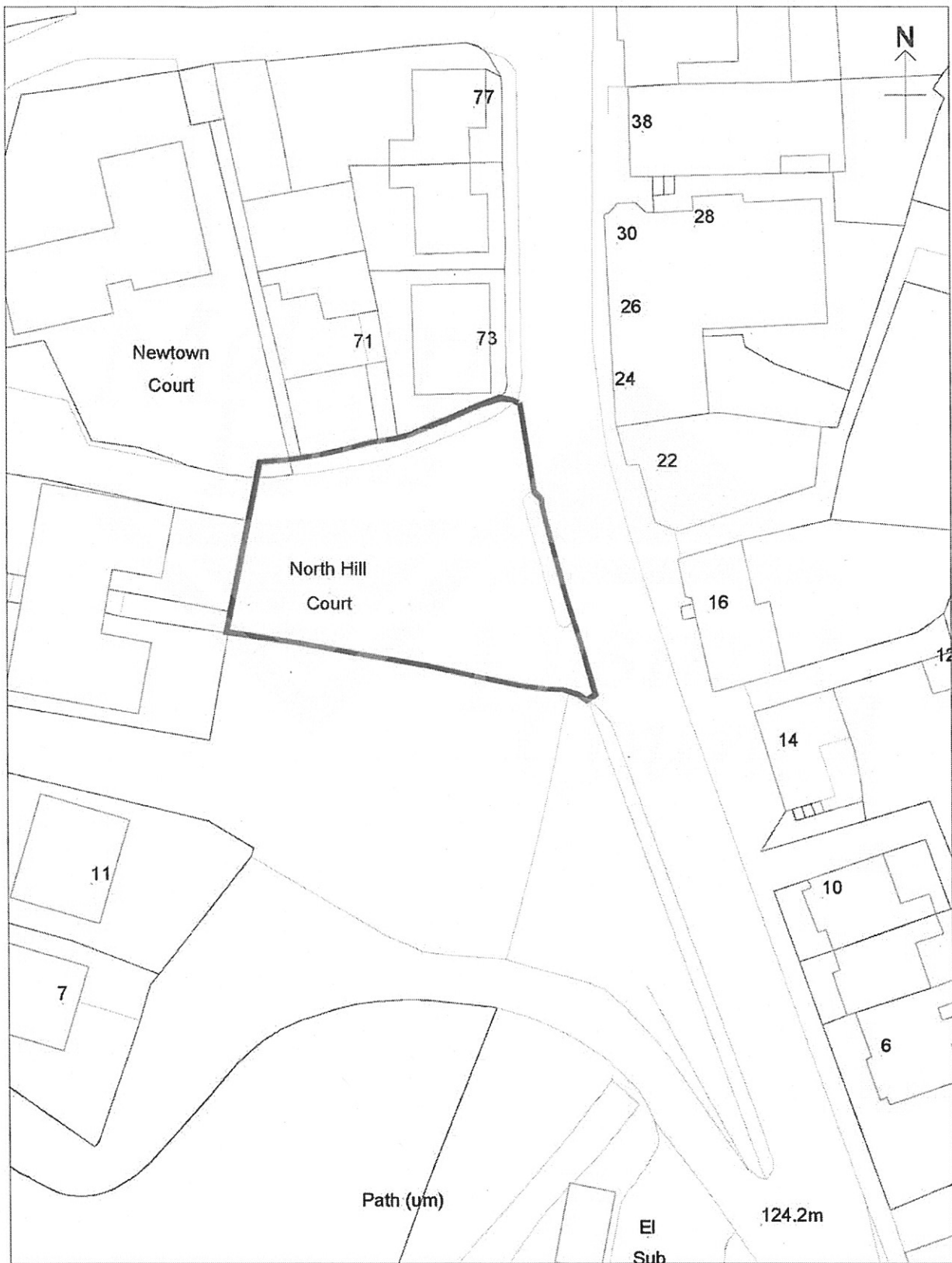

Scale: 1:500

11 - Priory Road North Parking Place

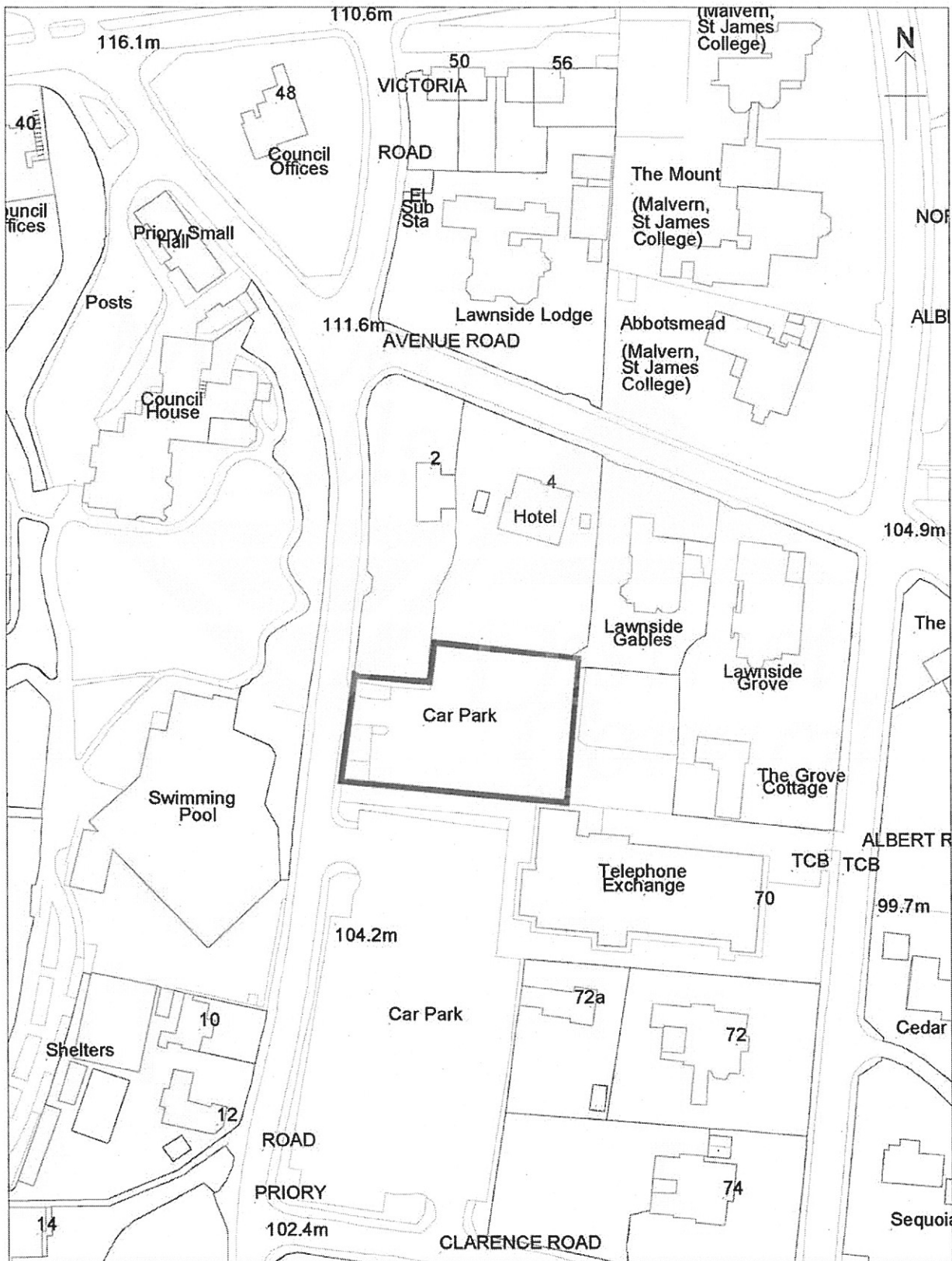

Scale: 1:1250

12 - Priory Road South Parking Place

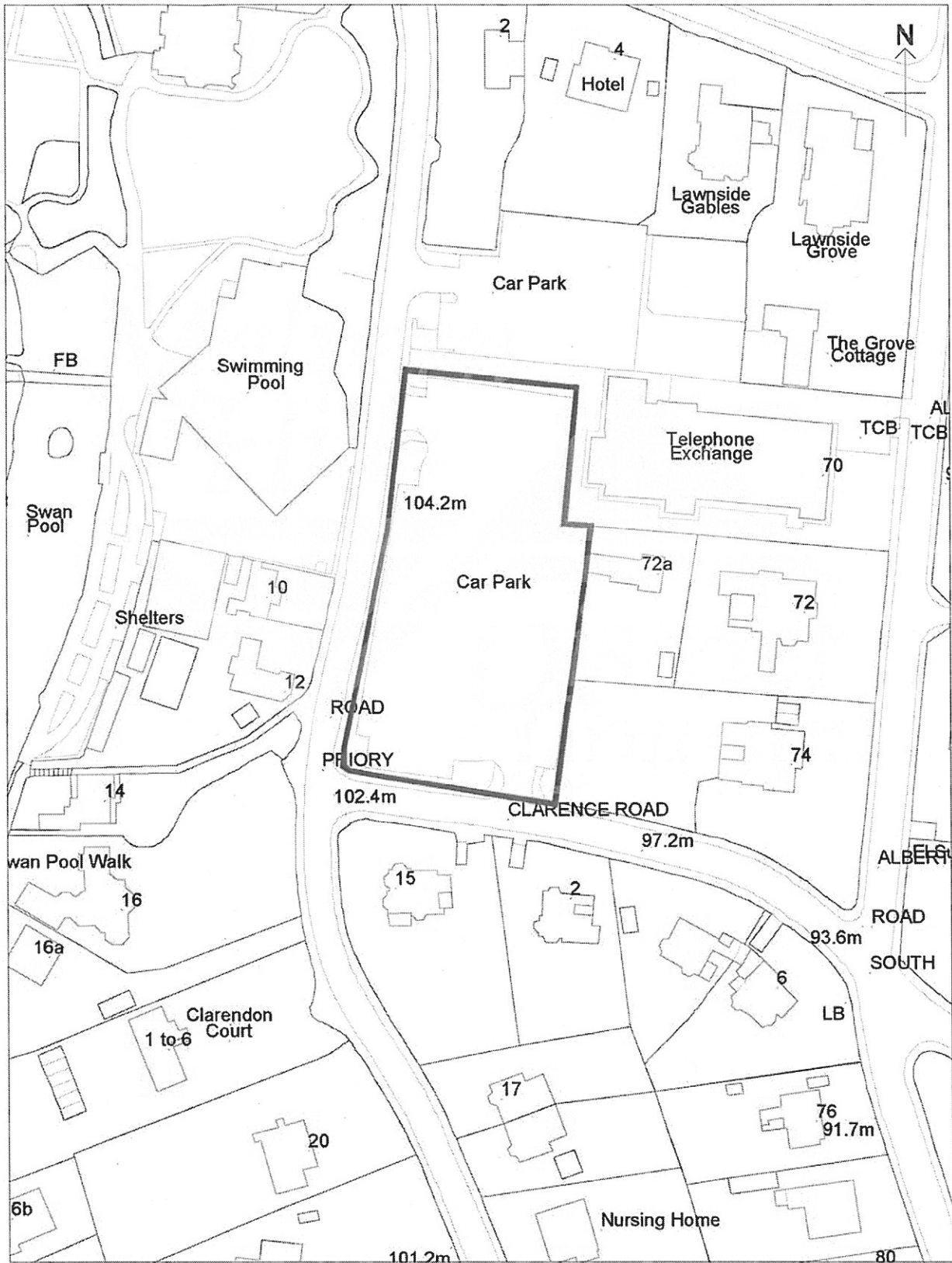

Scale: 1:1250

13 - Teme Street, Tenbury Parking Place

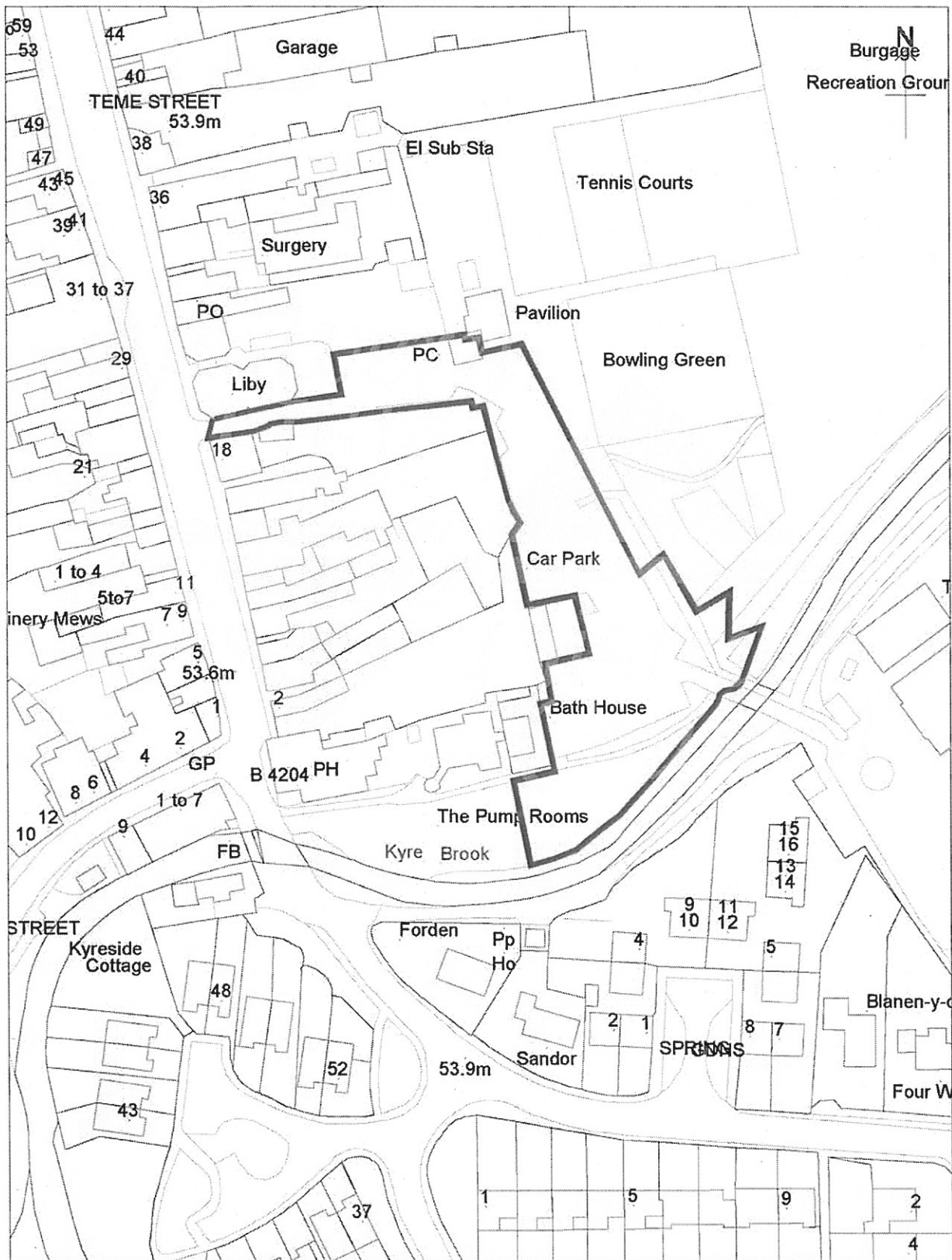

Scale: 1:1250

13 - Victoria Road Parking Place



Scale: 1:1250

Mr P Griffiths
3 The Gables
Beckford Road
Evesham
WR11 7QW

Direct Dial No: 01386 565009

Our Ref: ZW00994640

Date: 19th October 2017

Dear Mr Griffiths

Part 6 of the Traffic Management Act (2004)

PCN No : ZW00994640 / 16
Amount due : £70.00
Date of Contravention : 09/03/2017 10:24:17
Location : Queen's Road
Vehicle Registration No : SL06KXR

The County Court has sent us a copy of your recent Witness Statement

The Order for Recovery has been revoked and the Charge Certificate has been cancelled but the County Court order did not cancel the Penalty Charge Notice.

This means that the penalty charge of £70.00 is outstanding.

We note what you have said in the Witness Statement but:

We have no record of having received any representations from you.

As the County Court has cancelled the Charge Certificate, you now have the opportunity to pay the penalty at the original charge of £70.00

Payment can be made as follows:

Payment can be made as follows:-

By Internet: You can pay by debit or credit card by visiting
www.wychavon.gov.uk and following the
instructions for online payments.

Parking Services Unit
Direct Dial 01386-565009 **Fax** 01386-565119
E-mail parking@wychavon.gov.uk



By Telephone: Using Debit or Credit card, payments can be made Monday to Friday 9.00am to 5.00pm, on 01386 565200 or 01386 565009, please have your card with you when you phone.

By Post: Send to Parking Services Unit, Wychavon District Council, Civic Centre, Queen Elizabeth Drive, Pershore, Worcs WR10 1PT.

Cheques and Postal Orders should be made payable to Wychavon District Council enclosing this Notice. Please write the Penalty Charge Notice number and vehicle registration number on the reverse of your cheque or postal order.

In Person: Payments can be made with cash, cheque, postal order or by Debit or Credit card at any of the following

Pershore - Civic Centre, Queen Elizabeth Drive, Pershore, Worcs. WR10 1PT
Monday-Friday 9am-5pm

Or await Adjudicator directions

If you decide not to make payment of the penalty charge, or the payment is not received within 14 days of the date of this letter, the case will be referred to the Traffic Penalty Tribunal and the independent Adjudicator will decide what should happen next.

The Adjudicator may contact you if they need further clarification about your case.

Yours sincerely

Laura Taylor
Parking Administration Supervisor