

SCALE: 1:500

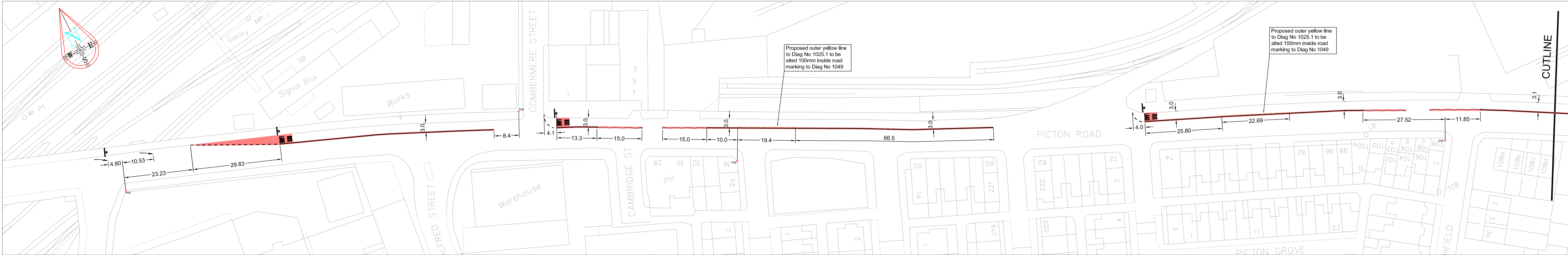

SCALE: 1:500

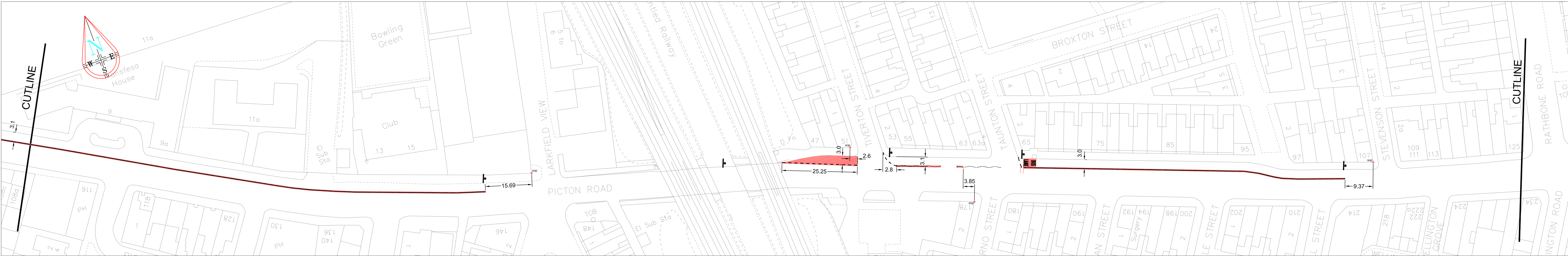

SCALE: 1:500

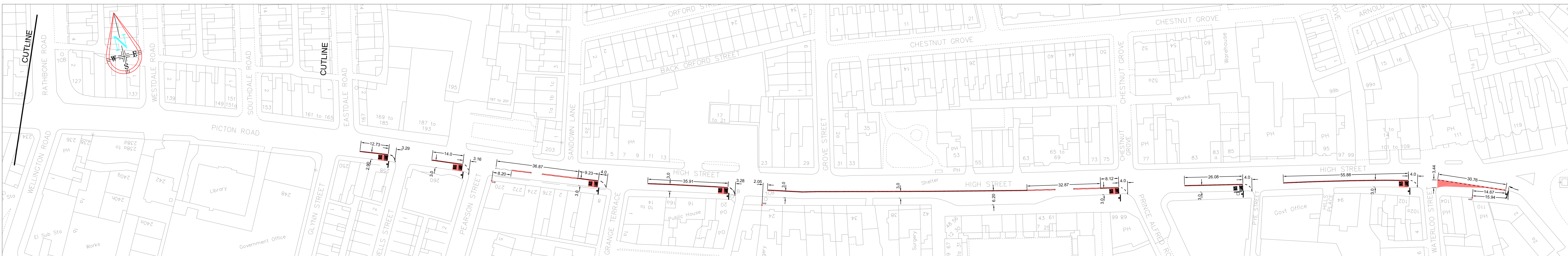

SCALE: 1:750

NOTES

This Drawing is an instrument of service and shall remain the property of 2020 Liverpool / Mouchel. It may not be reproduced or copied in any form. It shall not be used for the construction, enlargement or alteration of a building or area other than the said project without the authorisation of the issuing office. Contractors shall verify and be responsible for all dimensions and conditions and shall report any discrepancies to the issuing office before proceeding with any work. Drawings shall not be scaled.

Key

- Proposed thermoplastic road markings to Diag No 1010 (white, 250mm wide), Diag No 1049 (white, 250mm wide) and Diag No 1048 (white), 1048 & 1049 to be in line with post of bus lane signs as located on site. Red surface treatment to be applied to area within top and bottom of Diag No 1048 and 600mm wide strip flanking Diag No 1049 as shown.
- Proposed thermoplastic road marking to Diag No 1010 (white, 250mm wide) and Diag No 1048 (white), 1048 & 1049 to be in line with post of bus lane signs as located on site. Red surface treatment to be applied to area within top and bottom of Diag No 1048 and 600mm wide strip flanking Diag No 1049 as shown.
- Proposed thermoplastic road markings to Diag No 1001.3 with 600mm wide flanking strip of red surface treatment as indicated on plan.
- Proposed thermoplastic road marking to Diag No 1014 (white, 4.5m long)
- Proposed thermoplastic yellow road marking to Diag No 1025.1 to be laid 100mm inside proposed road marking to Diag No 1049 over red flanking strip.
- Proposed thermoplastic yellow road markings to Diag No 1025.1
- Setting out point for reference.

Notes:-

- All road markings to be in accordance with TSRGD 2002 and the Traffic Signs Manual.
- All dimensions in metres unless otherwise stated.
- This drawing must be read in conjunction with Drg No 1032881/1200/05 and the Bill of Quantities.

REVISION HISTORY

Rev	Description
-----	-------------



First Floor Station House, Mercury Court,
Timbham Street, Liverpool L2 2GP
Tel: 0151-527 2020 Fax: 0151-527 4000
www.2020liverpool.co.uk

Mouchel working in Partnership with Liverpool City Council

PROJECT TITLE
Bus Lane Camera Enforcement

DRAWING INFORMATION
**Proposed Road Markings
Wavertree Rd, Picton Rd
and High Street**

Survey By CG	Design Date Apr 11
Drawn By CG	Creation Date Apr 11
Checked By SS	Checked Date May 11
Approved By JB	Approved Date May 11

Drawing Status Contract	Drawing Scale As Shown
----------------------------	---------------------------

Drawing Number
1032881/1200/06

File Name
TCSU Site Ref

A0 1164 x 816mm

Printed on B-Jul-11 by Nealey, Linda