



GT46/2/132

**ROAD TRAFFIC REGULATION ACT 1984 – SECTIONS 64 AND 65  
AUTHORISATION OF TRAFFIC SIGNS AND SPECIAL DIRECTIONS**

The Secretary of State for Transport, in exercise of his powers under Sections 64 and 65 of the Road Traffic Regulation Act 1984 and of all other powers enabling him in that behalf, for the purpose of informing road users of resident permit holder parking places in Westmorland Drive, Liverpool, hereby:-

1. authorises the erection at or within 5 metres of the sites marked with a blue cross on the attached schedule of plans numbered GT46/2/132(Pt2)-1 of a traffic sign (hereinafter referred to as “the authorised sign”) conforming as to size, colour and character with that shown on the attached drawing numbered GT46/2/132(Pt2)-2; and
2. authorises the placing at or within the vicinity of the site highlighted in orange on the said schedule of plans of a traffic sign consisting of a white road marking (hereinafter referred to as “the authorised marking”) with the legend “RESIDENTS PARKING” in which a) the size of the letters shall be between 350mm and 700mm and b) the characters shall conform to those shown at (c) in Schedule 13 Part VI to the Traffic Signs Regulations 2002 (Part I of SI 2002/3113, “the 2002 Regulations”)
3. directs that the authorised marking shall be used only in conjunction with the authorised sign; and
4. directs that it is a condition of this authorisation that the authorised sign and authorised marking may be placed only to indicate the effect of a corresponding Traffic Regulation Order; and



GT46/2/132

**ROAD TRAFFIC REGULATION ACT 1984 – SECTIONS 64 AND 65  
AUTHORISATION OF TRAFFIC SIGNS AND SPECIAL DIRECTIONS**

The Secretary of State for Transport, in exercise of his powers under Sections 64 and 65 of the Road Traffic Regulation Act 1984 and of all other powers enabling him in that behalf, for the purpose of informing road users of resident permit holder parking places in Westmorland Drive, Liverpool, hereby:-

1. authorises the erection at or within 5 metres of the sites marked with a blue cross on the attached schedule of plans numbered GT46/2/132(Pt2)-1 of a traffic sign (hereinafter referred to as “the authorised sign”) conforming as to size, colour and character with that shown on the attached drawing numbered GT46/2/132(Pt2)-2; and
2. authorises the placing at or within the vicinity of the site highlighted in orange on the said schedule of plans of a traffic sign consisting of a white road marking (hereinafter referred to as “the authorised marking”) with the legend “RESIDENTS PARKING” in which a) the size of the letters shall be between 350mm and 700mm and b) the characters shall conform to those shown at (c) in Schedule 13 Part VI to the Traffic Signs Regulations 2002 (Part I of SI 2002/3113, “the 2002 Regulations”)
3. directs that the authorised marking shall be used only in conjunction with the authorised sign; and
4. directs that it is a condition of this authorisation that the authorised sign and authorised marking may be placed only to indicate the effect of a corresponding Traffic Regulation Order; and

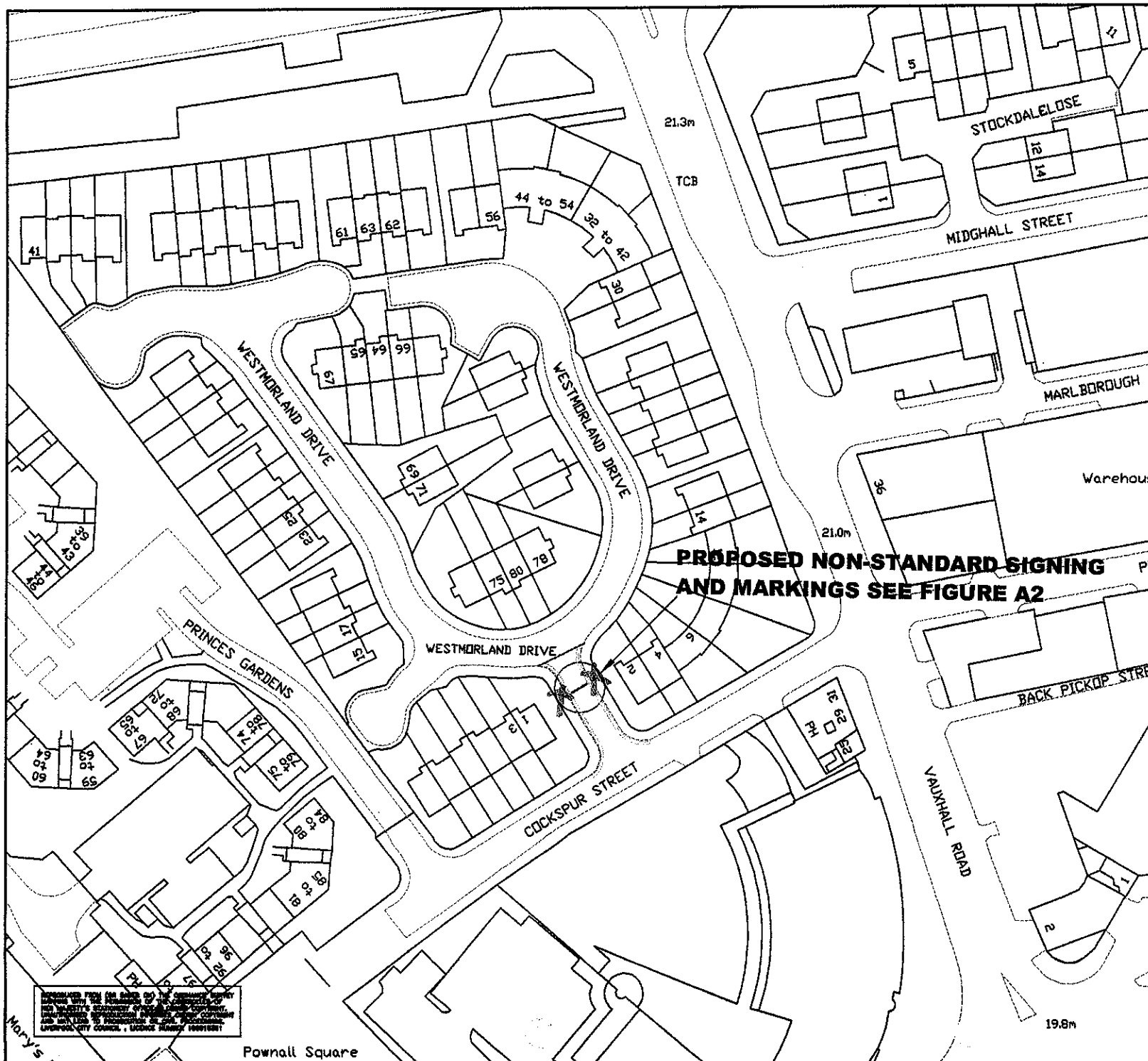

Ref.	Notes	By	Date
	<b>KEY</b>		
	Westmorland Drive Proposed Permit Parking Area (PPA)		
	Extent of Existing Parking Restrictions (Double Yellow Lines)		
Department for Transport			
Date 19 April 2004			
No. 0746/2/132(P-2)-1			
Rev.	Addition/Amendment	By	Date

**PROPOSED NON-STANDARD SIGNING  
AND MARKINGS SEE FIGURE A2**



**20/20**  
**Liverpool**

2020 Liverpool, West House, Mercury Court,  
Tithebarn Street, Liverpool L2 2QP  
Tel: 0151-237 2020 Fax: 0151-237 4000  
www.2020liverpool.co.uk



Mouchel Parkman working in Partnership with Liverpool City Council

<b>Drawing Status</b>	<b>Cad Ref.</b>
<b>PRELIMINARY DESIGN</b>	Scale 1:1000
<b>Dwg Registrar</b>	044

**Title** **FIGURE A1**  
**WESTMORLAND DRIVE PPA**

Survey	Drawn by	Designed	Checked	Approved
Initial M.G.	M.G.	M.G.	MW	JB
Date 16/12/03	07/12/03	07/12/03	09/01/04	09/01/04
<b>Drawing Number</b>	<b>2020/TP/0208/002</b>			<b>Rev</b>

This drawing is the property of 20/20 Liverpool and is not to be used for any other purpose without the written consent of 20/20 Liverpool. It is to be used only for the purposes for which it was prepared. Liverpool City Council - License Number 10000001

Mary's

Pownall Square

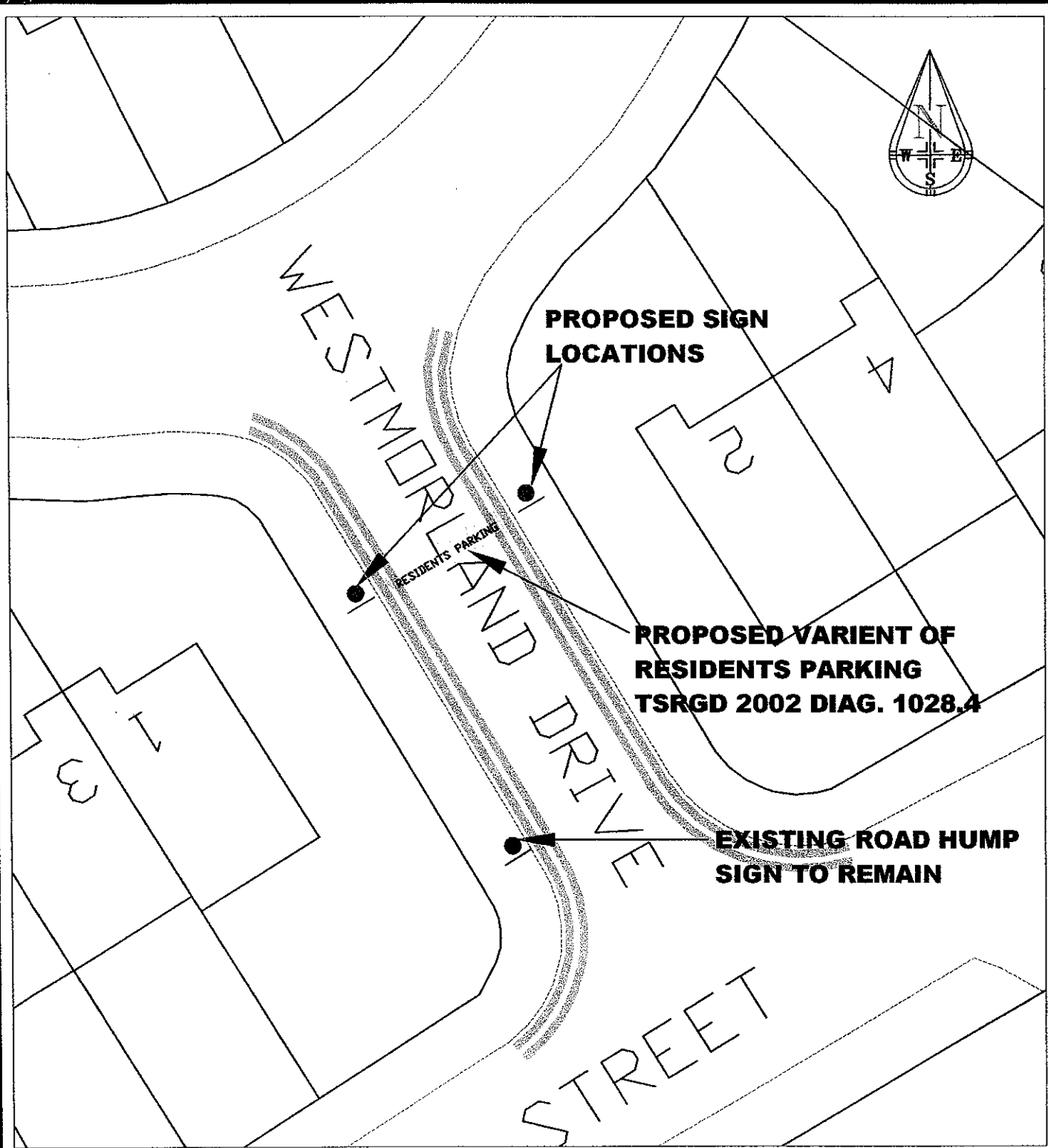

REPRODUCED FROM (OR BASED ON) THE ORDINANCE SURVEY MAPPING WITH THE PERMISSION OF THE CONTROLLER OF HER MAJESTY'S STATIONERY OFFICE © CROWN COPYRIGHT. UNAUTHORISED REPRODUCTION INFRINGES CROWN COPYRIGHT AND MAY LEAD TO PROSECUTION OR CIVIL PROCEEDINGS. LIVERPOOL CITY COUNCIL, LICENCE NUMBER LA078228.

Rev.	Addition/Amendment	By	Date
Drawing Status		Cad Ref.	
PRELIMINARY		Scale	1:200
Title		Dwg Register	
FIGURE A2 WESTMORLAND DRIVE PPA			
Survey	Drawn by	Designed	Checked
Initial	M.G.	M.G.	M.W.
Date			S.T.

# 20/20

## Liverpool

PO Box 88, Municipal Buildings, Liverpool L69 2DH  
Tel: 0151-225 4037 Fax: 0151-225 4080  
www.2020liverpool.co.uk



INVESTOR IN PEOPLE



BS REGISTERED FIRM  
FS38931

Mouchel Parkman working in Partnership with Liverpool City Council

Drawing Number	Rev.
----------------	------

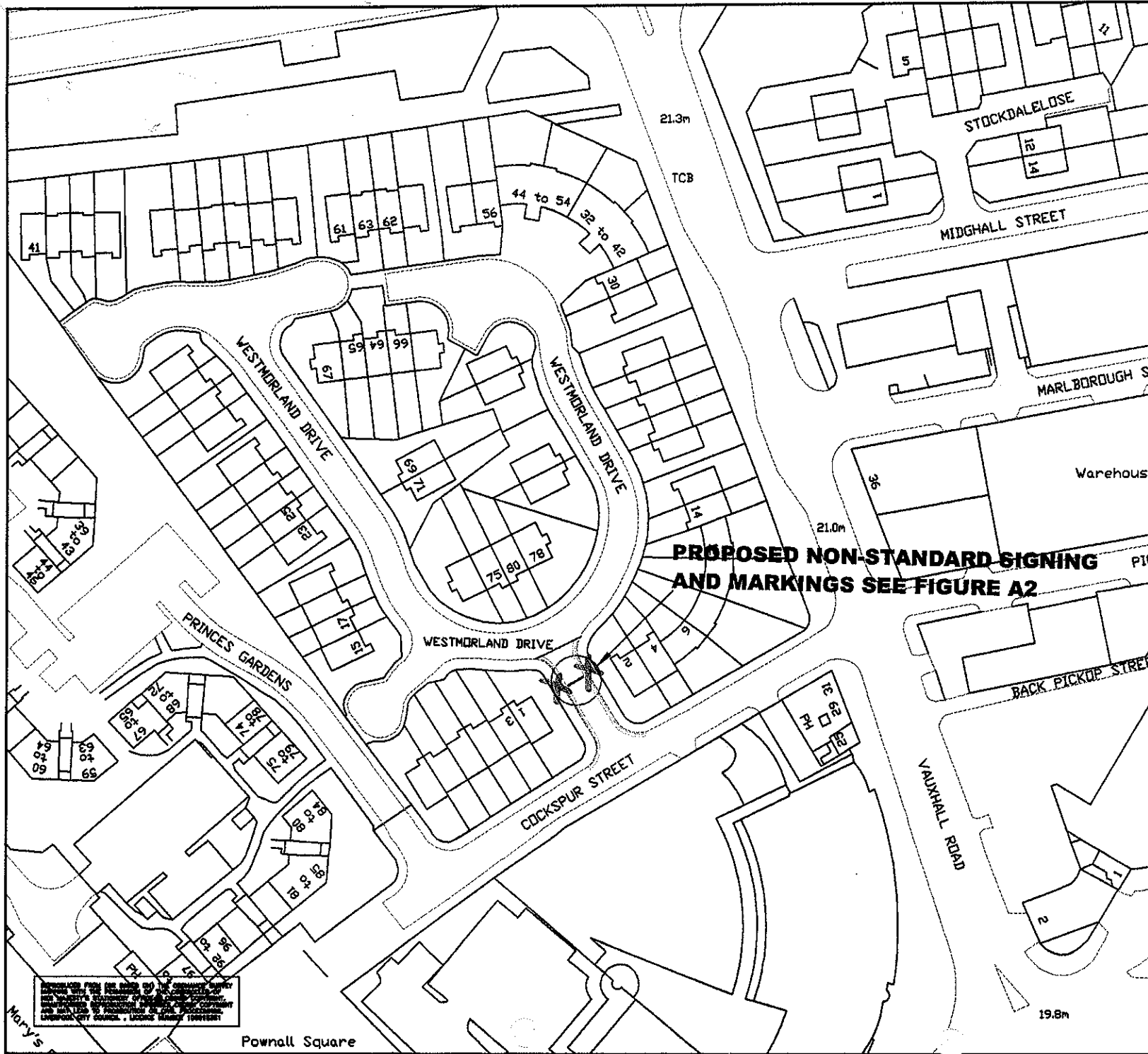

Ref.	Notes	By	Date
	<b>KEY</b> Westmorland Drive Proposed Permit Parking Area (PPA) Extent of Existing Parking Restrictions (Double Yellow Lines)		
Department for Transport			
Date	19 April 2004		
No.	CT40/2/132(P2)-1		
Rev.	Addition/Amendment	By	Date
2020 Liverpool, West House, Mercury Court, Tithebarn Street, Liverpool L2 2QP Tel: 0151-237 2020 Fax: 0151-237 4000 www.2020liverpool.co.uk			
<i>Mouchel Parkman working in Partnership with Liverpool City Council</i>			
Drawing Status		Cad Ref.	
PRELIMINARY DESIGN		Scale 1:1000	044
Title		Dwg Register	
<b>FIGURE A1</b> <b>WESTMORLAND DRIVE PPA</b>			
Survey	Drawn by	Designed	Checked
Initial M.G.	M.G.	M.G.	MW
Date 16/12/03	7/12/03	7/12/03	9/01/04
Drawing Number 2020/TP/0208/002			Rev

INFORMATION FROM THE DRAWING IS FOR INFORMATION ONLY AND DOES NOT CONSTITUTE A CONTRACT. THE CONTRACT IS THE AGREEMENT BETWEEN THE CLIENT AND THE CONSULTANT. THE CONSULTANT'S LIABILITY IS LIMITED TO THE AMOUNT PAID TO THEM BY THE CLIENT. THE CLIENT ACCEPTS FULL RESPONSIBILITY FOR THE ACCURACY OF THE INFORMATION PROVIDED TO THE CONSULTANT. THE CONSULTANT'S LIABILITY IS LIMITED TO THE AMOUNT PAID TO THEM BY THE CLIENT. THE CLIENT ACCEPTS FULL RESPONSIBILITY FOR THE ACCURACY OF THE INFORMATION PROVIDED TO THE CONSULTANT.

Mary's

Pownall Square

FIGURE 1.

Department for Transport  
Date 19 April 2004  
No. C1140/2/132 (P72) - 2

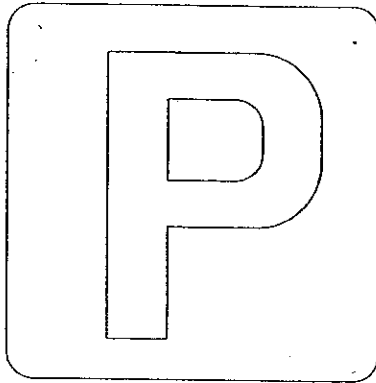

Resident permit  
parking only  
past this point  
8 am - 6 pm

FIGURE 1.

Department for T  
Date 19 April 2004  
No. CT440/2/132 (P72) - 2

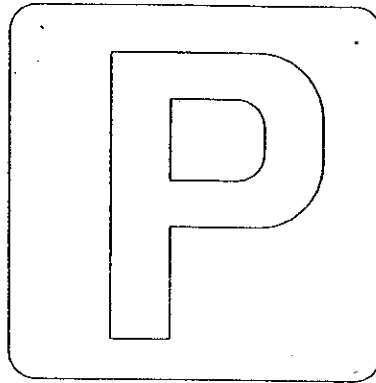

Resident permit  
parking only  
past this point  
8 am - 6 pm