

THE LEICESTERSHIRE COUNTY COUNCIL  
(VARIOUS ROADS, LOUGHBOROUGH, BOROUGH OF CHARNWOOD )  
(IMPOSITION OF WAITING AND LOADING RESTRICTIONS) CONFIRMATION OF  
EXPERIMENTAL ORDER 2016

The Leicestershire County Council ("the Council") in exercise of its powers under Sections 1(1), 2(1), 2(2), 4, 9, 10(2), 32, 35 and Part IV of Schedule 9 of the Road Traffic Regulation Act 1984 ("The Act") and of all other enabling powers, hereby makes the following Order:-

1. This Order shall come into force on the twenty ninth day of March 2016 and may be cited as "The Leicestershire County Council (Various Roads, Loughborough, Borough of Charnwood) (Imposition of Waiting and Loading Restrictions) Confirmation of Experimental Order 2016".
2. "The Leicestershire County Council (Various Roads, Loughborough, Borough of Charnwood) (Imposition of Waiting and Loading Restrictions) Experimental Order 2014" came into force on the thirty first day of October 2014 bringing into effect waiting and loading restrictions around the Town Centre, Loughborough.
3. In accordance with the provisions of Sections 22, 23 and Schedule 5 of the Local Authorities' Traffic Orders (Procedure) (England and Wales) Regulations 1996 the restrictions contained in "The Leicestershire County Council (Various Roads, Loughborough, Borough of Charnwood) (Imposition of Waiting and Loading Restrictions) Experimental Order 2014" are hereby reproduced and made permanent.
4. The exemptions contained in this Order as set out in column 1 of Schedule 1 shall hereafter be referred to by reference to the code letters given in column 2 of Schedule 1.

5. (1) In this Order –

"Authorised Cab Rank" means any area of carriageway which is comprised within and indicated by a road marking complying with diagram 1028.2 in Schedule 6 of The Traffic Signs Regulations and General Directions 2002;

"Authorised Parking Place" means any parking place on a road authorised or designated by an Order made or having effect as if made under the Act;

"Bus" has the same meaning as in Regulation 22 of the Traffic Signs Regulations and General Directions 2002;

"Bus Stop Area" means any area of carriageway on the sides of roads specified in this Order which is comprised within and indicated by a road marking complying with either diagram 1025.2 or diagram 1025.3 to the Traffic Signs Regulations and General Directions 2002;

"C.E.O." means a duly authorised Civil Enforcement Officer;

"disabled person's badge" has the same meaning as in The Disabled Persons (Badges for Motor Vehicles)(England) Regulations 2000 and subsequent Amendment Regulations;

"disabled persons designated parking bay" means the part of the carriageway or side of road marked in accordance with Schedule 6 of the Traffic Signs Regulations and General Directions 2002 (as amended) by the marking shown in diagram 1028.3, 1032 or 1033 (or permitted variants thereof);

"doctors' permit holders" means a vehicle which displays a valid permit issued to a Doctor for use in a specified location;

"footway parking area" means an area of the footway specifically designated for the purpose of waiting;

**"goods vehicle" has the same meaning as that ascribed to it in Section 192(1) of the Road Traffic Act 1988;**

**"heavy commercial vehicle" has the same meaning as in Section 138 of the Act;**

**"loading" and "unloading" means the collection or delivery of goods (parcels, stock and other items of that nature) to or from a vehicle where the goods cannot be reasonably collected or delivered except by the use of that vehicle in a particular length of road;**

**"market day" means any day of the week approved and authorised under a market charter for the holding of a market or such other bona fide licensed market;**

**"market trader" means any person duly authorised an appropriate body to trade from an authorised market stall or stand or location as from time to time may be specified by the appropriate body for the purposes of his or her trading;**

**"motor cycle" has the same meaning as in Section 136 of The Act;**

**"motor vehicle" means any vehicle as defined by the Construction and Use Regulations 1986 (as amended) which is mechanically propelled except where otherwise provided;**

**"parking disc" means a disc, issued by a local authority, complying with the requirements of the British Standard Specification for Parking Discs (BS No.4631:1970) but coloured blue, and capable of showing the quarter hour period during which a period of waiting begins, or a blue badge under the Disabled Persons (Badges for Motor Vehicles)(England) Regulations 2000;**

**"permitted parking place" means any part of a road hereby authorised by the Council for use as a parking place, bay or space where vehicles may wait;**

**"permit" means a written warrant issued by or on behalf of Leicestershire County Council allowing the holder to wait in a specified location;**

**"permit holder" means a vehicle which displays a valid permit;**

"residents' parking permit holder / residents' permit holder" means a vehicle which displays a valid permit issued to a resident of the specified location;

"road / roads" means the carriageway the footway and any verges being the full width of the highway extent from one boundary to another;

"school entrance" means any area of carriageway on the side of the road where vehicles are not permitted to stop and indicated by a road marking complying with diagram 1027.1 of the 2002 Regulations;

"solo motor cycle" means a motor cycle without a sidecar and having two wheels;

"taxi" means a Hackney Carriage vehicle licensed under section 37 of the Town Police Clauses Act 1847;

"vehicle" means any Motor Vehicle as defined in this Order and any other vehicle (capable of the carriage of persons or goods) except cycles unless otherwise provided;

"4.00 p.m. to 10.00 a.m. the following morning" wherever referred to in this Order means that period of time commencing at 4.00 p.m. in the afternoon of any day and terminating at 10.00 a.m. on the morning of the next day;

"The Act" means The Road Traffic Regulation Act 1984.

- (2) For the purpose of this Order a vehicle shall be regarded as displaying a disabled person's badge in the relevant position, where in accordance with The Disabled Persons (Badges for Motor Vehicles) (England) Regulations 2000 (as amended):
  - (i) the Badge is displayed on the vehicle's dashboard or fascia panel with the front of the Badge facing forward with the details thereon clearly visible from an external position, or

- (ii) where the vehicle has no dashboard or fascia panel or windscreen where the Badge may be exhibited or displayed it shall be exhibited in a conspicuous position on the front or near side of the vehicle and

in either case a parking disc is exhibited in the relevant position prescribed in The Disabled Persons (Badges for Motor Vehicles) (England) Regulations 2000 (as amended).

- 6. For the purposes of this Order and where any article permits, it shall not be unlawful to cause or permit a disabled person's vehicle which displays in the relevant position a disabled person's badge and a parking disc (on which the driver, or other person in charge of the vehicle, has marked the time at which the period of waiting began) to wait on the sides of roads referred to in the specific article, for a period not exceeding 3 hours unless otherwise stated (not being a period separated by an interval of less than one hour, unless otherwise stated, from a previous period of waiting by the same vehicle on the same side of road on the same day) provided that no such vehicle shall wait in any length of road where there is for the time being a prohibition of loading and unloading.
- 7. "The Leicestershire County Council (Various Roads, Loughborough (Area 5), District of Charnwood) Consolidation and Amendment Order 2009", "The Leicestershire County Council (A6, Leicester Road, Loughborough (Area 5), District of Charnwood) Order 2011", "The Leicestershire County Council (Various Roads, Loughborough (Area 5) District of Charnwood) Amendment Order No. 2 2011" and "The Leicestershire County Council (Inner Relief Road, Loughborough (Borough of Charnwood) (Prohibition and Restriction of Waiting, Loading and Parking Places) Order 2014" is hereby revoked in respect of that length of road specified in Schedule 2 to this Order.
- 8.1 No person shall, except upon the direction or with the permission of a police officer in uniform, a community support officer or a C.E.O., cause or permit any vehicle to wait between the hours of 8.00 a.m. and 6.00 p.m. on any day other than a Sunday, in the permitted parking place specified in Schedule 3 Part 1 to this Order:-
  - (a) For a period longer than 1 hour, or
  - (b) If a period of less than 1 hour has elapsed since the last period of waiting by that vehicle on the same permitted parking place;

- 8.2 No person shall, except upon the direction or with the permission of a police officer in uniform, a community support officer or a C.E.O., cause or permit any vehicle to wait between the hours of 8.00 a.m. and 6.00 p.m. on any day other than a Sunday, in the permitted parking place specified in Schedule 3 Part 2 to this Order:-
- (a) For a period longer than 2 hours, or
  - (b) If a period of less than 1 hour has elapsed since the last period of waiting by that vehicle on the same permitted parking place;
- 8.3 No person shall, except upon the direction or with the permission of a police officer in uniform, a community support officer or a C.E.O., or in accordance with the exemption provisions, cause or permit any vehicle to wait at any time on any day for the purpose of enabling goods to be loaded or unloaded from the vehicle on the sides of road specified in Schedule 3 Part 3 to this Order.
- 8.4 No person shall, except upon the direction or with the permission of a police officer in uniform, a community support officer or a C.E.O., or in accordance with the exemption provisions, cause or permit any vehicle to wait between the hours of 10.00 a.m. and 4.00 p.m. on any day, for the purpose of enabling goods to be loaded or unloaded from the vehicle on the sides of road specified in Schedule 3 Part 4 to this Order.
- 8.5 No person shall, except upon the direction or with the permission of a police officer in uniform, a community support officer or a C.E.O., cause or permit any vehicle to wait at any time on any day, other than for the purpose of enabling goods to be loaded or unloaded from the vehicle in the permitted parking place specified in Schedule 3 Part 5 to this Order.
- 8.6 No person shall, except upon the direction or with the permission of a police officer in uniform, a traffic warden, a community support officer or a C.E.O., cause or permit any vehicle to wait at between the hours of 6.00 a.m. and 6.00 p.m. on any day, other than for the purpose of enabling goods to be loaded or unloaded from the vehicle in the permitted parking place specified in Schedule 3 Part 6 to this Order.

- 8.7 No person shall, except upon the direction or with the permission of a police officer in uniform, a traffic warden, a community support officer or a C.E.O., cause or permit any vehicle to wait at between the hours of 4.00 p.m. and midnight and midnight and 10.00 a.m. on any day, other than for the purpose of enabling goods to be loaded or unloaded from the vehicle in the permitted parking place specified in Schedule 3 Part 7 to this Order.
- 8.8 No person shall, except upon the direction or with the permission of a police officer in uniform, a community support officer or a C.E.O., or in accordance with the exemption provisions, cause or permit any vehicle to wait at any time on any day, on the sides of road specified in Schedule 3 Part 8 to this Order.
- 8.9 No person shall, except upon the direction or with the permission of a police officer in uniform, a community support officer or a C.E.O., or in accordance with the exemption provisions, cause or permit any vehicle to wait between the hours of 8.00 a.m. and 6.00 p.m. on any day other than a Sunday, on the sides of road specified in Schedule 3 Part 9 to this Order.
- 8.10 No person shall, except upon the direction or with the permission of a police officer in uniform, a community support officer or a C.E.O., or in accordance with the exemption provisions, cause or permit any vehicle to wait between the hours of 6.00 a.m. and 6.00 pm on any day other than a Sunday, on the sides of road specified in Schedule 3 Part 10 to this Order.
- 8.11 No person shall, except upon the direction or with the permission of a police officer in uniform, a community support officer or a C.E.O., or in accordance with the exemption provisions, cause or permit any vehicle to wait, except for any taxi, between the hours of 6.00 p.m. and midnight and midnight and 6.00 a.m., on any day, on the sides of road specified in Schedule 3 Part 11 to this Order.
- 8.12 No person shall, except upon the direction or with the permission of a police officer in uniform, a community support officer or a C.E.O., or in accordance with the exemption provisions, cause or permit any vehicle to stop or wait, except for any taxi, between the

hours of midnight and 5.00 a.m. on any day, on the sides of road specified in Schedule 3 Part 12 to this Order.

- 8.13 No person shall, except upon the direction or with the permission of a police officer in uniform, a community support officer or a C.E.O., cause or permit any vehicle to wait between the hours of 10.00 a.m. and 4.00 p.m. on any day in the permitted parking place specified in Schedule 3 Part 13 to this Order, except for disabled badge holders:-
- a) For a period longer than 3 hours, or
  - b) If a period of less than 1 hour has elapsed since the last period of waiting by that vehicle on the same permitted parking place;
- 9 Except where otherwise stated, a reference in this Order to a numbered Article or Schedule is reference to the Article or Schedule bearing that number in this Order.
10. The plan annexed to this Order and marked drawing numbers TM4145/04, TM4145/05, TM4145/06, TM4145/07, TM4145/08, TM4145/09, TM4145/10 and TM4145/11 are for identification purposes only.



**SCHEDULE 1**

<b>TYPE OF EXEMPTION</b>	<b>CODE</b>
For vehicles to allow people to board or alight.	LCCA
For vehicles used in connection with:-  (i) building, industrial or demolition operations; (ii) the removal of any obstruction to traffic; (iii) the maintenance, improvement or reconstruction of the said sides of roads; or (iv) the laying, erection, alternative or repair on, or in land adjacent to the said sides of roads of any sewer or of any main, pipe or apparatus for the supply of gas, water or electricity or of any telegraphic line as defined in the Telecommunications Act 1984.	LCCB
For vehicles to be used in the service of a local authority, highways agency, an area health authority or a water undertaker in pursuance of statutory powers or duties and whilst being so used in such service it is necessary for the vehicle to be positioned in the place where it is waiting.	LCCC
For vehicles to be used for the purpose of delivering or collecting postal packets as defined in section 87 of the Postal Services Act 2000 by any universal service provider.	LCCD
Not Allocated	LCCE
For vehicles to wait at or near to any premises situated on or adjacent to the said sides of roads for so long as such waiting by that vehicle is reasonably necessary in connection with any wedding or funeral.	LCCF

For vehicles to be used for fire brigade, ambulance or police purposes.	LCCG
For goods to be loaded on or unloaded from the vehicle on the sides of roads specified in this Order.	LCCH
<p>For Vehicles:</p> <ul style="list-style-type: none"> <li>(a) to wait upon an authorised parking place,</li> <li>(b) being a hackney carriage, to wait upon an authorised cab rank, or</li> <li>(c) licensed taxi.</li> </ul>	LCCI
For a disabled person's vehicle which displays in the relevant position a disabled person's badge, and a parking disc (on which the driver, or other person in charge of the vehicle, has marked the time at which the period of waiting began) to wait on the sides of roads referred to in that Schedule for a period not exceeding three hours (not being a period separated by an interval of less than one hour from a previous period of waiting by the same vehicle on the same side of road on the same day) provided that no such vehicle shall wait in any length of road where there is for the time being a prohibition of loading and unloading.	LCCJ
For vehicles to wait on the sides of roads referred to therein for so long as may be necessary while any gate or other barrier at the entrance to premises to which the vehicle requires access or from which it has just emerged is being opened or closed, if it is not reasonably practicable for the vehicle to wait otherwise than in that road while such a gate or barrier is opened or closed.	LCCK
Any vehicle bona fide associated or used in connection with or for the purpose of licensed markets or special events.	LCCL

Where the person in control of the vehicle is directed or given permission to stop by a police officer, community support officer or a civil enforcement officer.	LCCM
To enable any motor vehicle that is constructed or adapted for the purpose of carrying monies or valuables under secure deposit and which is in use on a pre-arranged appointment for the delivery or collection of monies, financial instruments or valuables (for such a period of time as reasonably required to complete the delivery or collection) to any premises on the sides of road.	LCCN
Not Allocated	LCCO
Not Allocated	LCCP
Nothing shall render it unlawful to cause or permit any vehicle to wait in connection with the maintenance or repair of any premises adjoining the roads which can only be carried out from the road being such works as are required to be carried out to comply with any statutory obligation condition or stipulation subject to such waiting being limited to a maximum of two hours in any period of 24 hours.	LCCQ
Not Allocated	LCCR
Not Allocated	LCCS
Not Allocated	LCCT
Not Allocated	LCCU
Not Allocated	LCCV

Not Allocated	LCCW
Not Allocated	LCCX
For a disabled person's vehicle which displays in the relevant position a disabled person's badge and a parking disc (on which the driver, or other person in charge of the vehicle, has marked the time at which the period of waiting began) to wait in the designated parking place.	LCCY

## **SCHEDULE 2** **REVOCATIONS**

**Items to be revoked from:**

**THE LEICESTERSHIRE COUNTY COUNCIL (VARIOUS ROADS, LOUGHBOROUGH (AREA 5), DISTRICT OF CHARNWOOD) CONSOLIDATION AND AMENDMENT ORDER 2009**

**No loading at any time**

**Baxter Gate, Loughborough**

- (i) the north-west side from its junction with High Street (A6) in a north-easterly direction to the boundary between Nos. 1 and 2 for a distance of approximately 15 metres
- (ii) the south-east side from its junction with High Street (A6) in a north-easterly direction to the boundary between Nos. 60 and 61 for a distance of approximately 43 metres

**No loading Mon-Sat 8am-6pm**

**Baxter Gate, Loughborough**

- (i) the south-east side from its boundary between Nos. 60 and 61 in a north-easterly direction to its south-western boundary of No. 54 for a distance of approximately 67 metres

- (ii) the south-east side from a point 9.5 metres north-east of the south-western boundary of No. 54 north-eastwards to a point 1 metre south-west of the boundary between Nos. 51 and 52 for a distance of approximately 20 metres

**Loading Only at any time**

**Baxter Gate, Loughborough**

- (i) the north-west side from the boundary between Nos. 1 and 2 in a north-easterly direction for a distance of 13 metres
- (ii) the south-east side from the south-westerly boundary of No. 54 in a north-easterly direction for 10 metres

**No waiting at any time**

**Ashby Square, Loughborough**

- (i) the north side from its junction with Ashby Road to a point 24 metres in a westerly direction from its junction with Orchard Street
- (ii) the south side from its junction with Ashby Road in an easterly direction to its junction with Derby Square

**Baxter Gate, Loughborough**

- (i) the north-west side from its junction with High Street (A6) in a north-easterly direction to the boundary between Nos. 1 and 2 for a distance of approximately 15 metres
- (ii) the south-east side from its junction with High Street (A6) in a north-easterly direction to the boundary between Nos. 60 and 61 for a distance of approximately 43 metres

**Derby Square, Loughborough**

both sides from its junction with Swan Street in a westerly direction to its junction with Ashby Square

**Hume Street, Loughborough**

both sides from its junction Pinfold Gate in an easterly direction to a point 3 metres east of the east side of the entrance to garages at the rear of flats numbered 40-49

### **Orchard Street, Loughborough**

- (i) the north-east side from its junction with Greenclose Lane in a south-easterly direction for a distance of 6 metres
- (ii) the north-east side from its junction with Derby Square in a north-westerly direction for a distance of 14 metres
- (iii) the south-west side from its junction with Greenclose Lane for a distance of 5 metres

**No waiting 8am-6pm**

### **Ashby Square, Loughborough**

the north side from its junction with Orchard Street in a westerly direction for a distance of 24 metres

**No waiting Mon-Sat 8am-6pm**

### **Baxter Gate, Loughborough**

- (i) the south-east side from its boundary between Nos. 60 and 61 in a north-easterly direction to its south-western boundary of No. 54 for a distance of approximately 67 metres
- (ii) the south-east side from a point 9.5 metres north-east of the south-western boundary of No. 54 north-eastwards to a point 1 metre south-west of the boundary between Nos. 51 and 52 for a distance of approximately 20 metres

### **Moor Lane, Loughborough**

- (i) the south side from a point 26 metres east of its junction with Trinity Street in an easterly direction for a distance of 14 metres
- (ii) the south side from a point 12 metres west of its junction with New King Street to a point 40 metres west of its junction with New King Street

### **Orchard Street, Loughborough**

- (i) the north-east side from a point 6 metres south-east of its junction with Greenclose Lane in a south-easterly direction to a point 14 metres north-west of its junction with Derby Square
- (ii) the south-west side from a point 5 metres south-east of its junction with Greenclose Lane in a south-easterly direction to its junction with Ashby Square

### **Items to be revoked from:**

**THE LEICESTERSHIRE COUNTY COUNCIL (A6, LEICESTER ROAD,  
LOUGHBOROUGH (AREA 5), DISTRICT OF CHARNWOOD) ORDER 2011**

**No loading Mon-Sat 7.30am-9am and 4.30pm-6pm**

### **High Street, Loughborough**

the south-west side from its junction with Wood Gate in a north-westerly direction to its junction with Market Place

### **Market Place, Loughborough**

the south-west side from its junction with High Street in a north-westerly direction to its junction with Swan Street

### **Swan Street, Loughborough**

- (i) the south-west side from its junction with Market Place in a north-westerly direction to its junction with Derby Square
- (ii) the south-west side from its junction with Derby Square in a north-westerly direction to its junction with The Rushes

### **The Rushes, Loughborough**

the south-west side from its junction with Swan Street in a north-westerly direction to its junction with Greenclose Lane

**No waiting at any time**

### **High Street, Loughborough**

the south-west side from its junction with Wood Gate in a north-westerly direction to its junction with Market Place

### **Market Place, Loughborough**

the south-west side from its junction with High Street in a north-westerly direction to its junction with Swan Street

### **Swan Street, Loughborough**

- (i) the south-west side from its junction with Market Place in a north-westerly direction to its junction with Derby Square
- (ii) the south-west side from its junction with Derby Square in a north-westerly direction to its junction with The Rushes

### **The Rushes, Loughborough**

- (i) the south-west side from its junction with Swan Street in a north-westerly direction to its junction with Greenclose Lane
- (ii) the south-west side from its junction with Greenclose Lane in a north-westerly direction to its junction with Broad Street

### **Items to be revoked from:**

**THE LEICESTERSHIRE COUNTY COUNCIL (VARIOUS ROADS, LOUGHBOROUGH (AREA 5), DISTRICT OF CHARNWOOD) AMENDMENT ORDER NO.2 2011**

**No loading Mon-Sat 7.30am-9am and 4.30pm-6pm**

### **High Street, Loughborough**

the north-east side from its junction with Pinfold Gate in a north-westerly direction to its junction with Baxter Gate

### **Market Place, Loughborough**

the north-east side from its junction with Access Road To City Heights to its junction with Swan Street



**Swan Street, Loughborough**

the north-east side from its junction with Market Place in a north-westerly direction to its junction with The Rushes

**The Rushes, Loughborough**

the north-east side from its junction with Swan Street in a north-westerly direction to its junction with Shakespeare Street

**No waiting at any time**

**High Street, Loughborough**

the north-east side from its junction with Pinfold Gate in a north-westerly direction to its junction with Baxter Gate

**Market Place, Loughborough**

the north-east side from its junction with Baxter Gate in a north-westerly direction to its junction with Swan Street

**Swan Street, Loughborough**

the north-east side from its junction with Market Place in a north-westerly direction to its junction with The Rushes

**The Rushes, Loughborough**

the north-east side from its junction with Swan Street in a north-westerly direction to its junction with Shakespeare Street

**Items to be revoked from:**

**THE LEICESTERSHIRE COUNTY COUNCIL (INNER RELIEF ROAD, LOUGHBOROUGH (BOROUGH OF CHARNWOOD) (PROHIBITION AND RESTRICTION OF WAITING, LOADING AND PARKING PLACES) ORDER 2014**

**Limited waiting 1 hour no return for 1 hour Mon-Sat 8am-6pm**

**Church Gate, Loughborough**

- (i) the north-west side from a point 15 metres north-east of its junction with Steeple Row in a north-easterly direction for a distance of 16 metres
- (ii) the south-east side from a point 32.5 metres south-west of its junction with Sparrow Hill in a south-westerly direction for a distance of 41.5 metres

**Limited waiting 2 hours no return for 1 hour Mon-Sat 8am-6pm**

**Chapman Street, Loughborough**

the south-west side from a point 8 metres south-east of its junction with Cradock Street in a south-easterly direction for a distance of 6 metres

**Moor Lane, Loughborough**

the south side from a point 34 metres east of its junction with Barrow Street in an easterly direction for a distance of 34 metres

**Sparrow Hill (north-west Bound Only Carriageway), Loughborough**

the north-east side from a point 31 metres south-east of its junction with Baxter Gate in a south-easterly direction for a distance of 61 metres

**Sparrow Hill (south-east Bound Only Carriageway) Loughborough**

- (i) the north-east side from a point 99.5 metres south-east of its junction with The Coneries in a south-easterly direction for a distance of 22 metres
- (ii) the south-west side from a point 20 metres south-east of its junction with The Coneries in a south-easterly direction for a distance of 61 metres

**No loading at any time**

**Church Gate, Loughborough**

the east side from a point 86 metres south-west of its junction with Sparrow Hill in a southerly direction to its junction with Lemington Street

**Moor Lane, Loughborough**

the south side from its junction with Barrow Street in an easterly direction for a distance of 34 metres

**No loading Mon-Sat 7.30am-9am and 4.30pm-6pm**

**The Rushes, Loughborough**

(i) the north-east side from its junction with Shakespeare Street in a north-westerly direction to a point 23 metres north-west of its junction with the access road to The Rushes carpark

(ii) the south-west side from its junction with Greenclose Lane in a north-westerly direction to a point 83 metres south-east of its junction with Broad Street

**No waiting at any time**

**Baxter Gate, Loughborough**

the north-west side from a point 1 metres south-west of the north-eastern boundary of 19/20 Baxter Gate in a north-easterly direction to its junction with Lemington Street

**Church Gate, Loughborough**

the east side from a point 86 metres south-west of its junction with Sparrow Hill in a southerly direction to its junction with Lemington Street

**Moor Lane, Loughborough**

the south side from its junction with Barrow Street in an easterly direction for a distance of 34 metres

**Sparrow Hill (north-west Bound Only Carriageway), Loughborough**

(i) the north-east side from its junction with Baxter Gate in a south-easterly direction for a distance of 31 metres

(ii) the north-east side from a point 92 metres south-east of its junction with Baxter Gate in a south-easterly direction to its junction with Pinfold Gate

**Sparrow Hill (south-east Bound Only Carriageway), Loughborough**

(i) the north-east side from its junction with The Coneries in a south-easterly direction for a distance of 99.5 metres

(ii) the north-east side from a point 121.5 metres south-east of its junction with The Coneries in a south-easterly direction to its junction with Pinfold Gate

(iii) the south-west side from its junction with The Coneries in a south-easterly direction for a distance of 20 metres

(iv) the south-west side from a point 81 metres south-east of its junction with The Coneries in a south-easterly direction to its junction with Pinfold Gate

#### **The Rushes, Loughborough**

the north-east side from its junction with Shakespeare Street in a north-westerly direction to a point 156 metres south-east of its junction with Barnsdale Close

**No waiting Monday-Saturday 8.00am-6.00pm**

#### **Aumbery Gap, Loughborough**

the south-west side from a point opposite a point 20 metres north-west of the southern building corner of No 33 Pinfold Gate in a south-easterly direction for a distance of 40 metres

### **SCHEDULE 3, PART 1**

**Limited waiting 1 hour no return for 1 hour  
Monday-Saturday 8.00am-6.00pm**

#### **Church Gate, Loughborough**

the south-east side from a point 32.5 metres south-west of its junction with Sparrow Hill in a south-westerly direction for a distance of 31 metres

#### **Greenclose Lane, Loughborough**

the north-west side from a point 9.5 metres south-west of its junction with The Rushes in a south-westerly direction for a distance of 24 metres

### **Limehurst Avenue, Loughborough**

the south-west side from a point 15 metres north-west of its junction with Bridge Street in a north-westerly direction for a distance of 16 metres

#### **EXEMPTIONS**

The following exemptions apply to the above. Refer to Schedule 1 for the details of each exemption:-

LCCA, LCCB, LCCC, LCCD, LCCF, LCCG, LCCH, LCCM, LCCY.

### **SCHEDULE 3, PART 2**

**Limited waiting 2 hours no return for 1 hour  
Monday-Saturday 8.00am-6.00pm**

### **Aumbery Gap, Loughborough**

the south-west side from a point opposite a point 20 metres north-west of the southern building corner of No. 33 Pinfold Gate in a south-easterly direction for a distance of 40 metres

### **Moor Lane, Loughborough**

the south side from a point 40 metres east of its junction with Barrow Street in an easterly direction for a distance of 28 metres

### **Sparrow Hill (south-east Bound Only Carriageway), Loughborough**

the north-east side from a point 10 metres south-east of its junction with Cradock Street in a south-easterly direction for a distance of 32 metres

#### **EXEMPTIONS**

The following exemptions apply to the above. Refer to Schedule 1 for the details of each exemption:-

LCCA, LCCB, LCCC, LCCD, LCCF, LCCG, LCCH, LCCM, LCCY.

### SCHEDULE 3, PART 3

#### **No loading at any time**

##### **Ashby Road, Loughborough**

- (i) the north side from its junction with Greenclose Lane in an easterly direction for a distance of 33.5 metres
- (ii) the south side from its junction with Frederick Street in an easterly direction for a distance of 37.5 metres

##### **Ashby Square, Loughborough**

- (i) the north side from a point 33.5 metres east of its junction with Greenclose Lane in an easterly direction for a distance of 27 metres
- (ii) the south side from a point 37.5 metres east of its junction with Frederick Street in an easterly direction for a distance of 39 metres
- (iii) the south side from a point 95 metres east of its junction with Frederick Street in an easterly direction for a distance of 22.5 metres

##### **Baxter Gate, Loughborough**

- (i) the north-west side from a point 142 metres north-east of its junction with High Street in a north-easterly direction to its junction with Lemington Street
- (ii) the north-west side from its junction with High Street in a north-easterly direction for a distance of 13.5 metres
- (iii) the south-east side from its junction with High Street in a north-easterly direction for a distance of 133.5 metres
- (iv) the south-east side from a point 149 metres north-east of its junction with High Street in a north-easterly direction to its junction with Jubilee Way

### **Church Gate, Loughborough**

the south-east side from a point 77.5 metres south-west of its junction with Sparrow Hill in a southerly direction to its junction with Lemington Street

### **Derby Square, Loughborough**

- (i) the north side from its junction with Swan Street in a westerly direction to its junction with Orchard Street
- (ii) the south side from its junction with Swan Street in a westerly direction for a distance of 27.5 metres
- (iii) the south side from a point 50.5 metres west of its junction with Swan Street in a westerly direction for a distance of 20.5 metres

### **High Street, Loughborough**

- (i) the north-east side from its junction with Baxter Gate in a south-easterly direction for a distance of 73.5 metres
- (ii) the south-west side from a point 44.5 metres north-west of its junction with Woodgate in a north-westerly direction for a distance of 15.5 metres
- (iii) the south-west side from a point 139.5 metres north-west of its junction with Woodgate in a north-westerly direction to its junction with Market Place
- (iv) the south-west side from a point 93.5 metres north-west of its junction with Woodgate in a north-westerly direction for a distance of 11 metres

### **Moor Lane, Loughborough**

the south side from its junction with Barrow Street in an easterly direction for a distance of 40 metres

### **Swan Street, Loughborough**

- (i) the north-east side from a point 90.5 metres south-east of its junction with Shakespeare Street in a south-easterly direction for a distance of 48 metres

(ii) the south-west side from its junction with Derby Square in an south-easterly direction for a distance of 48 metres

(iii) the south-west side from its junction with Derby Square in a north-westerly direction for a distance of 43 metres

### **The Rushes, Loughborough**

the south-west side from its junction with Brookside in a north-westerly direction for a distance of 29 metres

### **EXEMPTIONS**

The following exemptions apply to the above. Refer to Schedule 1 for the details of each exemption:-

LCCA, LCCB, LCCC, LCCD, LCCG, LCCM.

### **SCHEDULE 3, PART 4**

**No loading 10.00am-4.00pm**

### **Market Place, Loughborough**

(i) the north-east side from a point 174 metres south-east of its junction with Shakespeare Street in a south-easterly direction to its junction with Baxter Gate

(ii) the south-west side from a point 84 metres south-east of its junction with Derby Square in a south-easterly direction to its junction with High Street

### **Swan Street, Loughborough**

(i) the north-east side from a point 138.5 metres south-east of its junction with Shakespeare Street in an south-easterly direction for a distance of 35.5 metres

(ii) the south-west side from a point 48 metres south-east of its junction with Derby Square in an south-easterly direction for a distance of 36 metres



### **EXEMPTIONS**

The following exemptions apply to the above. Refer to Schedule 1 for the details of each exemption:-

LCCA, LCCB, LCCC, LCCD, LCCG, LCCM.

### **SCHEDULE 3, PART 5**

#### **Loading Only at any time**

##### **Baxter Gate, Loughborough**

the north-west side from a point 13.5 metres north-east of its junction with High Street in a north-easterly direction for a distance of 12 metres

##### **The Rushes, Loughborough**

- (i) the south-west side from a point 29 metres north-west of its junction with Brookside in a north-westerly direction for a distance of 29.5 metres
- (ii) the south-west side from a point 34 metres north-west of its junction with Greenclose Lane in a north-westerly direction for a distance of 7 metres

### **EXEMPTIONS**

The following exemptions apply to the above. Refer to Schedule 1 for the details of each exemption:-

LCCA, LCCB, LCCC, LCCD, LCCG, LCCM.

### **SCHEDULE 3, PART 6**

#### **Loading Only 6.00am-6.00pm**

##### **Ashby Square, Loughborough**

- (i) the north side from a point 60.5 metres east of its junction with Greenclose Lane in an easterly direction for a distance of 12 metres

(ii) the north side from a point 88 metres east of its junction with Greenclose Lane in an easterly direction for a distance of 14 metres

(iii) the south side from a point 83 metres east of its junction with Frederick Street in an easterly direction for a distance of 12 metres

#### **Baxter Gate, Loughborough**

the north-west side from a point 112 metres north-east of its junction with High Street in a north-easterly direction for a distance of 30 metres

#### **Derby Square, Loughborough**

the south side from a point 27.5 metres west of its junction with Swan Street in a westerly direction for a distance of 23 metres

#### **High Street, Loughborough**

(i) the north-east side from a point 73.5 metres south-east of its junction with Baxter Gate in a south-easterly direction for a distance of 29.5 metres

(ii) the south-west side from a point 104.5 metres north-west of its junction with Woodgate in a north-westerly direction for a distance of 14 metres

#### **Swan Street, Loughborough**

the north-east side from a point 63.5 metres south-east of its junction with Shakespeare Street in a south-easterly direction for a distance of 27 metres

### **EXEMPTIONS**

The following exemptions apply to the above. Refer to Schedule 1 for the details of each exemption:-

LCCA, LCCB, LCCC, LCCD, LCCG, LCCM.

### SCHEDULE 3, PART 7

**Loading Only 4.00pm-midnight and midnight-10.00am**

#### **Baxter Gate, Loughborough**

the south-east side from a point 133.5 metres north-east of its junction with High Street in a north-easterly direction for a distance of 15.5 metres

#### **EXEMPTIONS**

The following exemptions apply to the above. Refer to Schedule 1 for the details of each exemption:-

LCCA, LCCB, LCCC, LCCD, LCCG, LCCM.

### SCHEDULE 3, PART 8

**No waiting at any time**

#### **Ashby Square, Loughborough**

the north side from a point 72.5 metres east of its junction with Greenclose Lane in an easterly direction for a distance of 15.5 metres

#### **Church Gate, Loughborough**

the south-east side from a point 63.5 metres south-west of its junction with Sparrow Hill in a south-westerly direction for a distance of 14 metres

#### **Greenclose Lane, Loughborough**

(i) the north-west side from a point 33.5 metres south-west of its junction with The Rushes in a south-westerly direction to its junction with Ashby Road

(ii) the north-west side from its junction with The Rushes in a south-westerly direction for a distance of 9.5 metres

- (iii) the south-east side from its junction with The Rushes in a south-westerly direction to its junction with Ashby Road

### **High Street, Loughborough**

- (i) the north-east side from its junction with Pinfold Gate in a north-westerly direction for a distance of 47 metres
- (ii) the south-west side from its junction with Woodgate in a north-westerly direction for a distance of 44.5 metres

### **Hume Street, Loughborough**

- (i) the east side from its northern kerbline at the western end of Hume Street in a northerly direction for the extent of the adopted highway
- (ii) the north side from a point 18 metres east of the eastern kerbline at the western end of Hume Street in an easterly direction for a distance of 5 metres
- (iii) the south side from its junction with Pinfold Gate in an easterly direction for a distance of 41 metres

### **Orchard Street, Loughborough**

both sides from its junction with Greenclose Lane in a south-easterly direction to its junction with Ashby Square / Derby Square

### **Sparrow Hill (south-east Bound Only Carriageway), Loughborough**

- (i) the north-east side from its junction with The Coneries in a south-easterly direction to a point 10 metres south-east of its junction with Cradock Street
- (ii) the north-east side from a point 42 metres south-east of its junction with Cradock Street in a south-easterly direction to its junction with Pinfold Gate

### **The Rushes, Loughborough**

- (i) the north-east side from a point 7 metres south-east of its junction with Shakespeare Street in a north-westerly direction to a point 23 metres north-west of its junction with the access to The Rushes carpark
- (ii) the south-west side from a point 58.5 metres north-west of its junction with Brookside in a north-westerly direction to a point 34 metres north-west of its junction with Greenclose Lane
- (iii) the south-west side from a point 41 metres north-west of its junction with Greenclose Lane in a north-westerly direction to a point 83 metres south-east of its junction with Broad Street

### **EXEMPTIONS**

The following exemptions apply to the above. Refer to Schedule 1 for the details of each exemption:-

LCCA, LCCB, LCCC, LCCD, LCCF, LCCG, LCCH, LCCI, LCCJ, LCCM, LCCN.

### **Ashby Road, Loughborough**

- (i) the north side from its junction with Greenclose Lane in an easterly direction for a distance of 33.5 metres
- (ii) the south side from its junction with Frederick Street in an easterly direction for a distance of 37.5 metres

### **Ashby Square, Loughborough**

- (i) the north side from a point 33.5 metres east of its junction with Greenclose Lane in an easterly direction for a distance of 27 metres
- (ii) the south side from a point 37.5 metres east of its junction with Frederick Street in an easterly direction for a distance of 39 metres
- (iii) the south side from a point 95 metres east of its junction with Frederick Street in an easterly direction for a distance of 22.5 metres

### **Baxter Gate, Loughborough**

- (i) the north-west side from a point 142 metres north-east of its junction with High Street in a north-easterly direction to its junction with Lemington Street
- (ii) the north-west side from its junction with High Street in a north-easterly direction for a distance of 13.5 metres
- (iii) the south-east side from its junction with High Street in a north-easterly direction for a distance of 133.5 metres
- (iv) the south-east side from a point 149 metres north-east of its junction with High Street in a north-easterly direction to its junction with Jubilee Way

### **Church Gate, Loughborough**

the south-east side from a point 77.5 metres south-west of its junction with Sparrow Hill in a southerly direction to its junction with Lemington Street

### **Derby Square, Loughborough**

- (i) the north side from its junction with Swan Street in a westerly direction to its junction with Orchard Street
- (ii) the south side from its junction with Swan Street in a westerly direction for a distance of 27.5 metres
- (iii) the south side from a point 50.5 metres west of its junction with Swan Street in a westerly direction for a distance of 20.5 metres

### **High Street, Loughborough**

- (i) the north-east side from its junction with Baxter Gate in a south-easterly direction for a distance of 73.5 metres
- (ii) the south-west side from a point 44.5 metres north-west of its junction with Woodgate in a north-westerly direction for a distance of 15.5 metres
- (iii) the south-west side from a point 93.5 metres north-west of its junction with Woodgate in a north-westerly direction for a distance of 11 metres

(iv) the south-west side from a point 139.5 metres north-west of its junction with Woodgate in a north-westerly direction to its junction with Market Place

#### **Market Place, Loughborough**

- (i) the north-east side from a point 174 metres south-east of its junction with Shakespeare Street in a south-easterly direction to its junction with Baxter Gate
- (ii) the south-west side from a point 84 metres south-east of its junction with Derby Square in a south-easterly direction to its junction with High Street

#### **Moor Lane, Loughborough**

the south side from its junction with Barrow Street in an easterly direction for a distance of 40 metres

#### **Swan Street, Loughborough**

- (i) the north-east side from a point 90.5 metres south-east of its junction with Shakespeare Street in a south-easterly direction for a distance of 83.5 metres
- (ii) the south-west side from its junction with Derby Square in a south-easterly direction for a distance of 84 metres
- (iii) the south-west side from its junction with Derby Square in a north-westerly direction for a distance of 43 metres

#### **The Rushes, Loughborough**

- ii) the north-east side from a point 23 metres north-west of its junction with access road to The Rushes carpark in a north-westerly direction to a point 156 metres south-east of its junction with Barnsdale Close
- (ii) the south-west side from its junction with Brookside in a north-westerly direction for a distance of 29 metres
- (iii) the south-west side from a point 83 metres south-east of its junction with Broad Street in a north-westerly direction to its junction with Broad Street

### **EXEMPTIONS**

The following exemptions apply to the above. Refer to Schedule 1 for the details of each exemption:-

LCCA, LCCB, LCCC, LCCD, LCCG, LCCM.

### **SCHEDULE 3, PART 9**

**No waiting Monday-Saturday 8.00am-6.00pm**

#### **Chapman Street, Loughborough**

the south-west side from a point 8 metres south-east of its junction with Cradock Street in a south-easterly direction for a distance of 6 metres

#### **Hume Street, Loughborough**

the north side from its eastern kerbline at the western end of Hume Street in an easterly direction for a distance of 18 metres

#### **Moor Lane, Loughborough**

the south side from a point 12 metres west of its junction with King Street in a westerly direction for a distance of 16 metres

### **EXEMPTIONS**

The following exemptions apply to the above. Refer to Schedule 1 for the details of each exemption:-

LCCA, LCCB, LCCC, LCCD, LCCE, LCCF, LCCG, LCCH, LCCI, LCCJ, LCCM, LCCN.

### **SCHEDULE 3, PART 10**

**No waiting  
Monday-Saturday 6.00am-6.00pm**

#### **Church Gate, Loughborough**



the north-west side from a point 15 metres north-east of its junction with Steeple Row in a north-easterly direction for a distance of 16 metres

#### **EXEMPTIONS**

The following exemptions apply to the above. Refer to Schedule 1 for the details of each exemption:-

LCCA, LCCB, LCCC, LCCD, LCCF, LCCG, LCCH, LCCI, LCCJ, LCCM, LCCN.

### **SCHEDULE 3, PART 11**

#### **No Waiting except taxis 6.00pm-midnight and midnight-6.00am**

##### **Baxter Gate, Loughborough**

the north-west side from a point 112 metres north-east of its junction with High Street in a north-easterly direction for a distance of 30 metres

##### **High Street, Loughborough**

(i) the north-east side from a point 73.5 metres south-east of its junction with Baxter Gate in a south-easterly direction for a distance of 29.5 metres

(ii) the south-west side from a point 104.5 metres north-west of its junction with Woodgate in a north-westerly direction for a distance of 14 metres

##### **Swan Street, Loughborough**

the north-east side from a point 63.5 metres south-east of its junction with Shakespeare Street in a south-easterly direction for a distance of 27 metres

#### **EXEMPTIONS**

The following exemptions apply to the above. Refer to Schedule 1 for the details of each exemption:-

LCCA, LCCG, LCCI, LCCM.

## **SCHEDULE 3, PART 12**

### **No stopping except taxis midnight-5.00am**

#### **Baxter Gate, Loughborough**

the north-west side from a point 25.5 metres north-east of its junction with High Street in a north-easterly direction for a distance of 86.5 metres

#### **High Street, Loughborough**

the south-west side from a point 60 metres north-west of its junction with Woodgate in a north-westerly direction for a distance of 12.5 metres

#### **Swan Street, Loughborough**

the north-east side from a point 50 metres south-east of its junction with Shakespeare Street in a south-easterly direction for a distance of 13.5 metres

#### **The Rushes, Loughborough**

the south-east side from a point 7 metres south-east of its junction with Shakespeare Street in a south-easterly direction for a distance of 15 metres

## **EXEMPTIONS**

The following exemptions apply to the above. Refer to Schedule 1 for the details of each exemption:-

LCCG, LCCI, LCCM.

## **SCHEDULE 3, PART 13**

### **Disabled Persons Parking**

**3 hours no return for 1 hour 10.00am-4.00pm**

#### **Ashby Square, Loughborough**

(i) the north side from a point 102 metres east of its junction with Greenclose Lane in an easterly direction for a distance of 6.6 metres

(iii) the south side from a point 76.5 metres east of its junction with Frederick Street in an easterly direction for a distance of 6.6 metres

**Baxter Gate, Loughborough**

the south-east side from a point 133.5 metres north-east of its junction with High Street in a north-easterly direction for a distance of 15.5 metres

**EXEMPTIONS**

The following exemptions apply to the above. Refer to Schedule 1 for the details of each exemption:-

LCCA.

THE COMMON SEAL of THE )  
LEICESTERSHIRE COUNTY COUNCIL )  
was hereunto affixed this twenty first day of )  
March 2016 in the presence of )

*J. L. Smith*





# **KEY**

PROPOSED NO LOADING AND NO  
WAITING AT ANYTIME  
EXISTING PARKING BAY TO BE  
REDUCED IN LENGTH

EXISTING WAITING RESTRICTIONS  
TO BE RETAINED



**Leicestershire  
County Council**

**ENVIRONMENT AND  
TRANSPORT DEPT**



**PHIL CROSS LAND  
DIRECTOR**

**TRAFFIC & SAFETY  
GROUP**

**TRAFFIC MANAGEMENT**

**TITLE:**

**MOOR LANE  
LOUGHBOROUGH  
TRO CHANGES**

**DRAWING NUMBER**

**TM4145/05**

**SCALE**

**NTS**

**PREPARED BY:**

**GN**

**DATE:** 3rd Oct 2014

**CHECKED BY:**

**NP**

**SIZE:** A4

**COUNTY HALL • GLENFIELD • LEICESTER • LE3 8BT**

**Tel: 0116 305 0001 • Fax: 0116 305 0008**

**E-Mail address:** [customerservices@leics.gov.uk](mailto:customerservices@leics.gov.uk) [www.leics.gov.uk](http://www.leics.gov.uk)

MAPINFO (C) Leicestershire County Council  
© Crown copyright. All rights reserved. Leicestershire County Council 100019271.  
Published 2014.



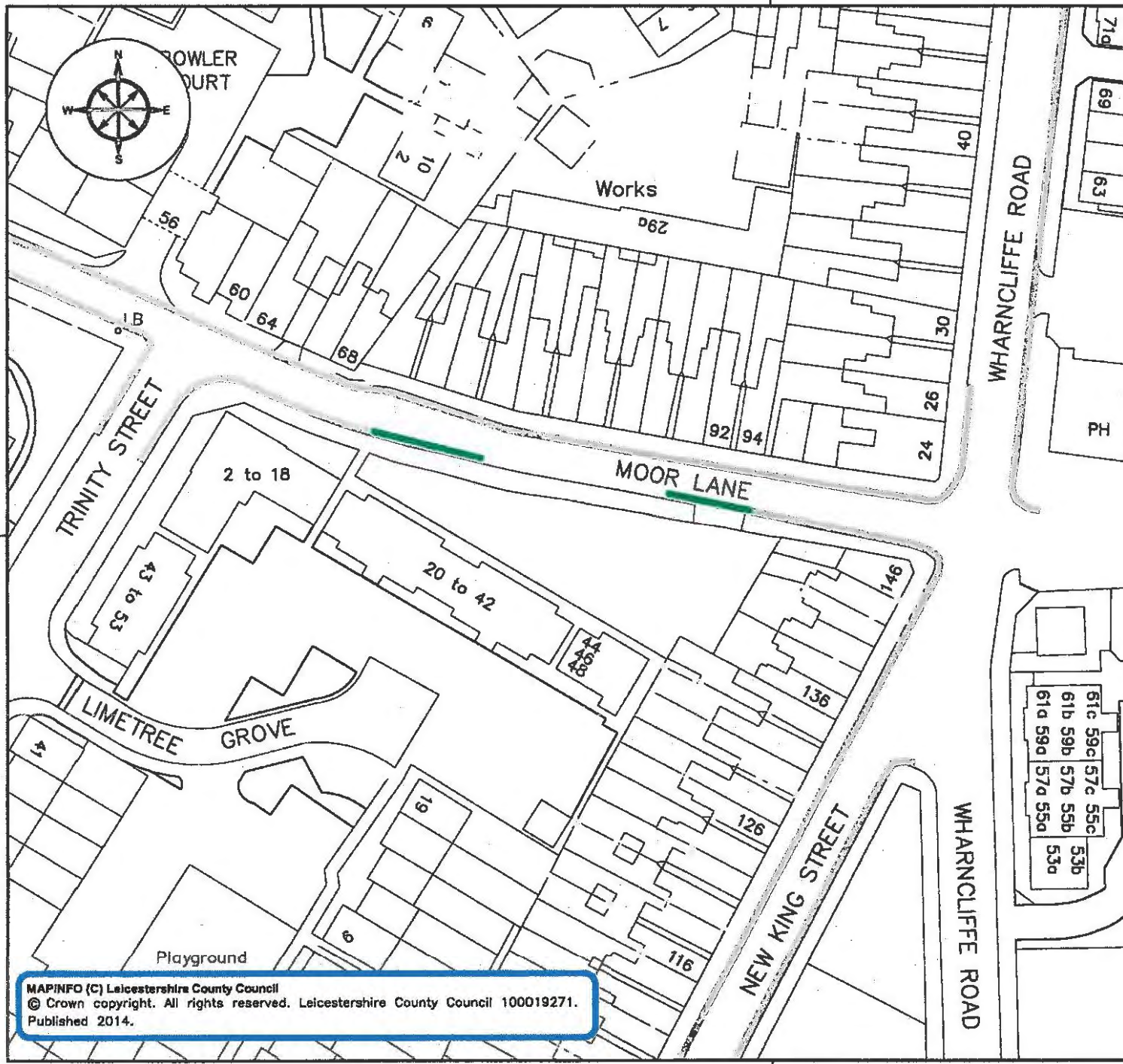

**KEY**

PROPOSED REMOVAL OF LIMITED WAITING PARKING RESTRICTION (Single Yellow Line)

EXISTING WAITING RESTRICTIONS TO BE RETAINED

**Leicestershire County Council**

**ENVIRONMENT AND TRANSPORT DEPT**

**PHIL CROSS LAND DIRECTOR**

**TRAFFIC & SAFETY GROUP**

**TRAFFIC MANAGEMENT**

**TITLE:** MOOR LANE LOUGHBOROUGH TRO CHANGES

<b>DRAWING NUMBER</b>	<b>SCALE</b>
TM4145/06	NTS
<b>PREPARED BY:</b> GN	<b>DATE:</b> 30th Sep 2014
<b>CHECKED BY:</b> MP	<b>SIZE:</b> A4

**COUNTY HALL \* GLENFIELD \* LEICESTER \* LE3 8ST**

**Tel: 0116 305 0001 \* Fax: 0116 305 0006**

**E-Mail address:** [customerservices@leics.gov.uk](mailto:customerservices@leics.gov.uk) [www.leics.gov.uk](http://www.leics.gov.uk)

MAPINFO (C) Leicestershire County Council  
 © Crown copyright. All rights reserved. Leicestershire County Council 100019271.  
 Published 2014.

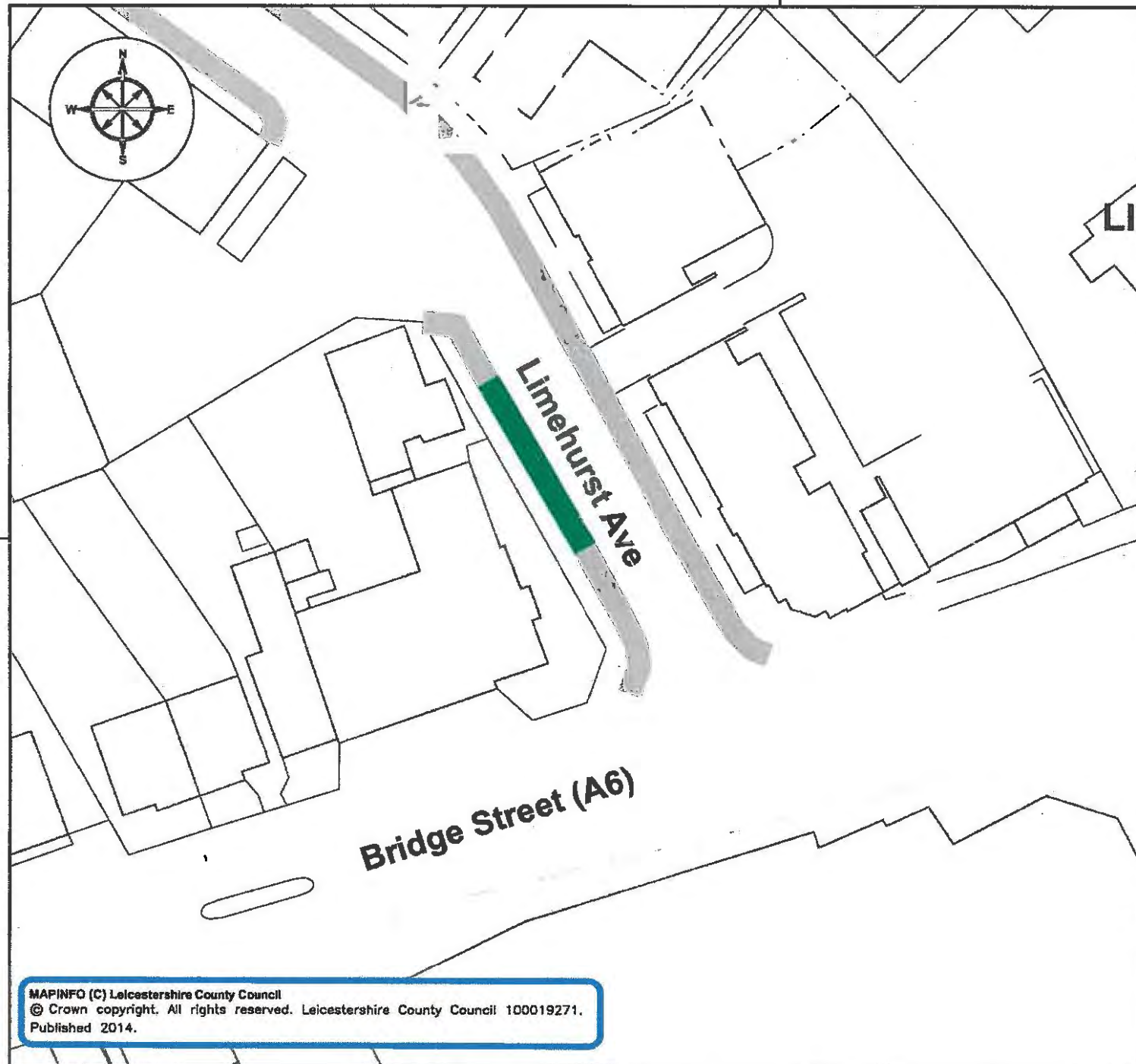

# **KEY**

**PROPOSED 1 HR LIMITED WAITING  
MON - SAT 8AM TO 6PM  
NO RETURN WITHIN 1 HOUR**

**EXISTING WAITING RESTRICTIONS  
TO BE RETAINED**



**ENVIRONMENT AND  
TRANSPORT DEPT**



**PHIL CROSS LAND  
DIRECTOR**

**TRAFFIC & SAFETY  
GROUP**

**TRAFFIC MANAGEMENT**

**TITLE:  
LIMEHURST AVENUE  
LOUGHBOROUGH  
TRO CHANGES**

DRAWING NUMBER	SCALE
TM4145/07	NTS
PREPARED BY: GN	DATE: 3rd Oct 2014
CHECKED BY: MP	SIZE: A4

**COUNTY HALL • GLENFIELD • LEICESTER • LE3 8ST**

**Tel: 0116 305 0001 • Fax: 0116 305 0006**

**E-Mail address: [customerservices@leics.gov.uk](mailto:customerservices@leics.gov.uk) [www.leics.gov.uk](http://www.leics.gov.uk)**

**MAPINFO (C) Leicestershire County Council  
© Crown copyright. All rights reserved. Leicestershire County Council 100019271.  
Published 2014.**



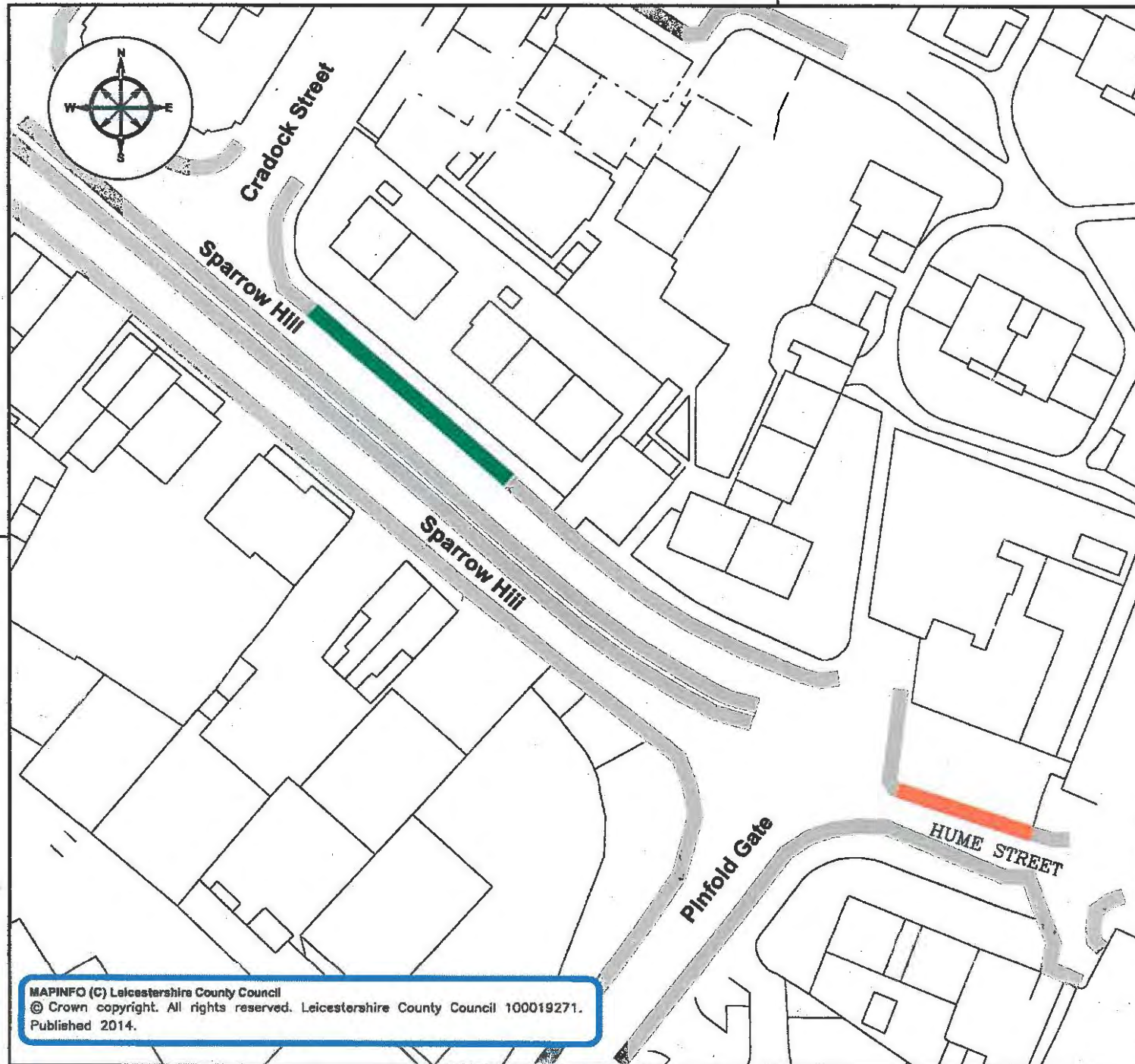

# **KEY**



**PROPOSED 2 HR LIMITED WAITING**  
**MON - SAT 8AM TO 6PM**  
**NO RETURN WITHIN 1 HOUR**



**PROPOSED NO WAITING**  
**MON - SAT 8AM TO 6PM**



**EXISTING WAITING RESTRICTIONS**  
**TO BE RETAINED**



**Leicestershire**  
**County Council**

**ENVIRONMENT AND**  
**TRANSPORT DEPT**



**PHIL CROSS LAND**  
**DIRECTOR**

**TRAFFIC & SAFETY**  
**GROUP**

**TRAFFIC MANAGEMENT**

**TITLE:**

**SPARROW HILL**  
**LOUGHBOROUGH**  
**TRO CHANGES**

**DRAWING NUMBER**

**SCALE**

**TM4145/08**

**NTS**

**PREPARED BY:**

**GN**

**DATE:** 3rd Oct 2014

**CHECKED BY:**

**MP**

**SIZE:** A4

**COUNTY HALL • GLENFIELD • LEICESTER • LE3 8ST**

**Tel: 0116 305 0001 • Fax: 0116 305 0006**

**E-Mail address:** [customerservices@leics.gov.uk](mailto:customerservices@leics.gov.uk) [www.leics.gov.uk](http://www.leics.gov.uk)

**MAPINFO (C) Leicestershire County Council**  
 © Crown copyright. All rights reserved. Leicestershire County Council 100019271.  
 Published 2014.

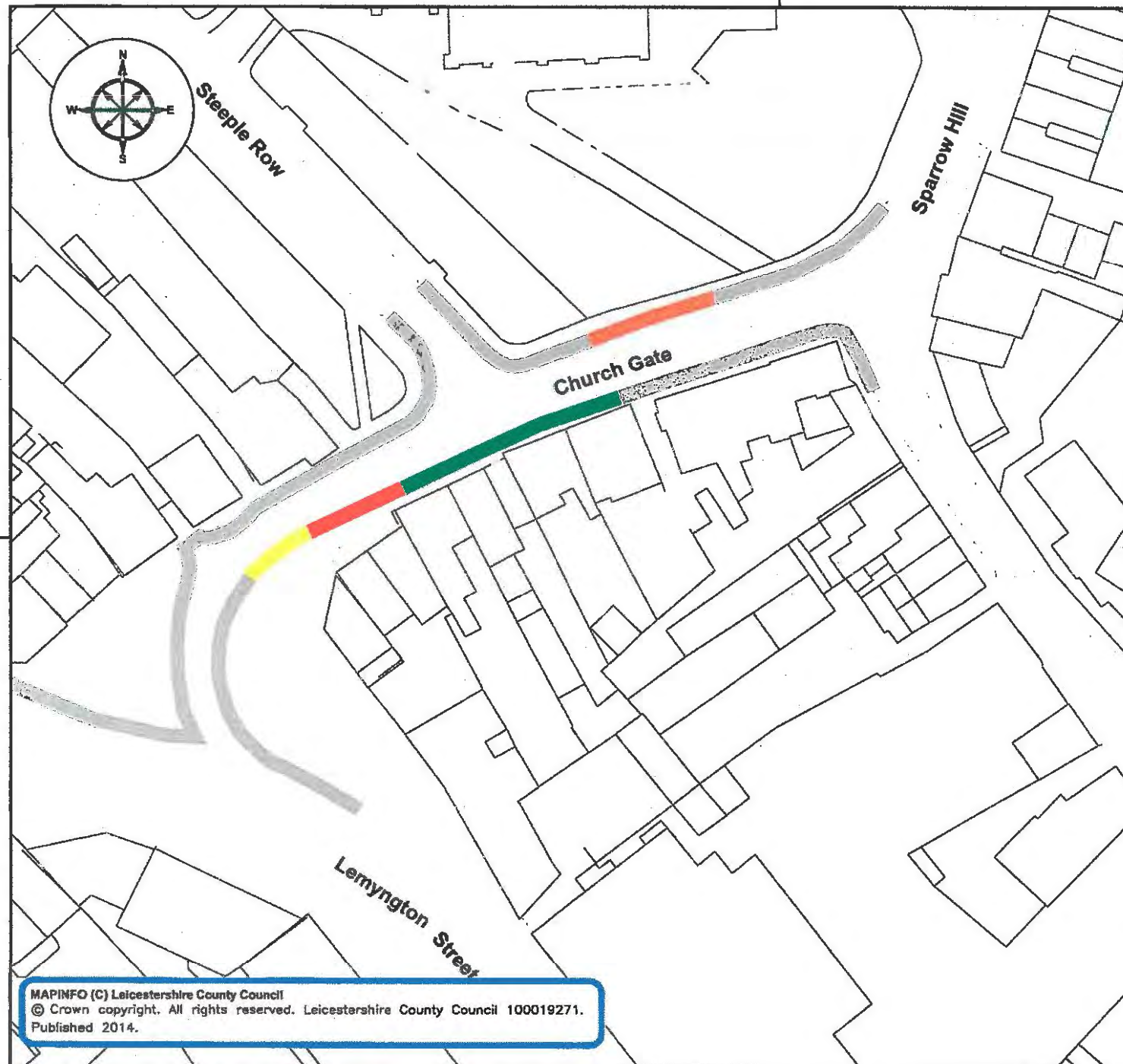

# **KEY**

- PROPOSED 1 HR LIMITED WAITING  
MON - SAT 8AM TO 6PM  
NO RETURN WITHIN 1 HOUR
- PROPOSED NO WAITING  
MON - SAT 8AM TO 6PM
- PROPOSED NO WAITING  
AT ANY TIME
- PROPOSED NO LOADING AND NO WAITING  
AT ANY TIME
- EXISTING WAITING RESTRICTIONS  
TO BE RETAINED



ENVIRONMENT AND  
TRANSPORT DEPT



PHIL CROSS LAND  
DIRECTOR

TRAFFIC & SAFETY  
GROUP

TRAFFIC MANAGEMENT

TITLE:  
**CHURCH GATE  
LOUGHBOROUGH  
TRO CHANGES**

DRAWING NUMBER	SCALE
TM4145/09	NTS
PREPARED BY: GN	DATE: 3rd Oct 2014
CHECKED BY: MP	SIZE: A4

COUNTY HALL • GLENFIELD • LEICESTER • LE3 0ST

Tel: 0116 305 0001 • Fax: 0116 305 0006

E-Mail address: [customerservices@leics.gov.uk](mailto:customerservices@leics.gov.uk) [www.leics.gov.uk](http://www.leics.gov.uk)

MAPINFO (C) Leicestershire County Council  
© Crown copyright. All rights reserved. Leicestershire County Council 100019271.  
Published 2014.



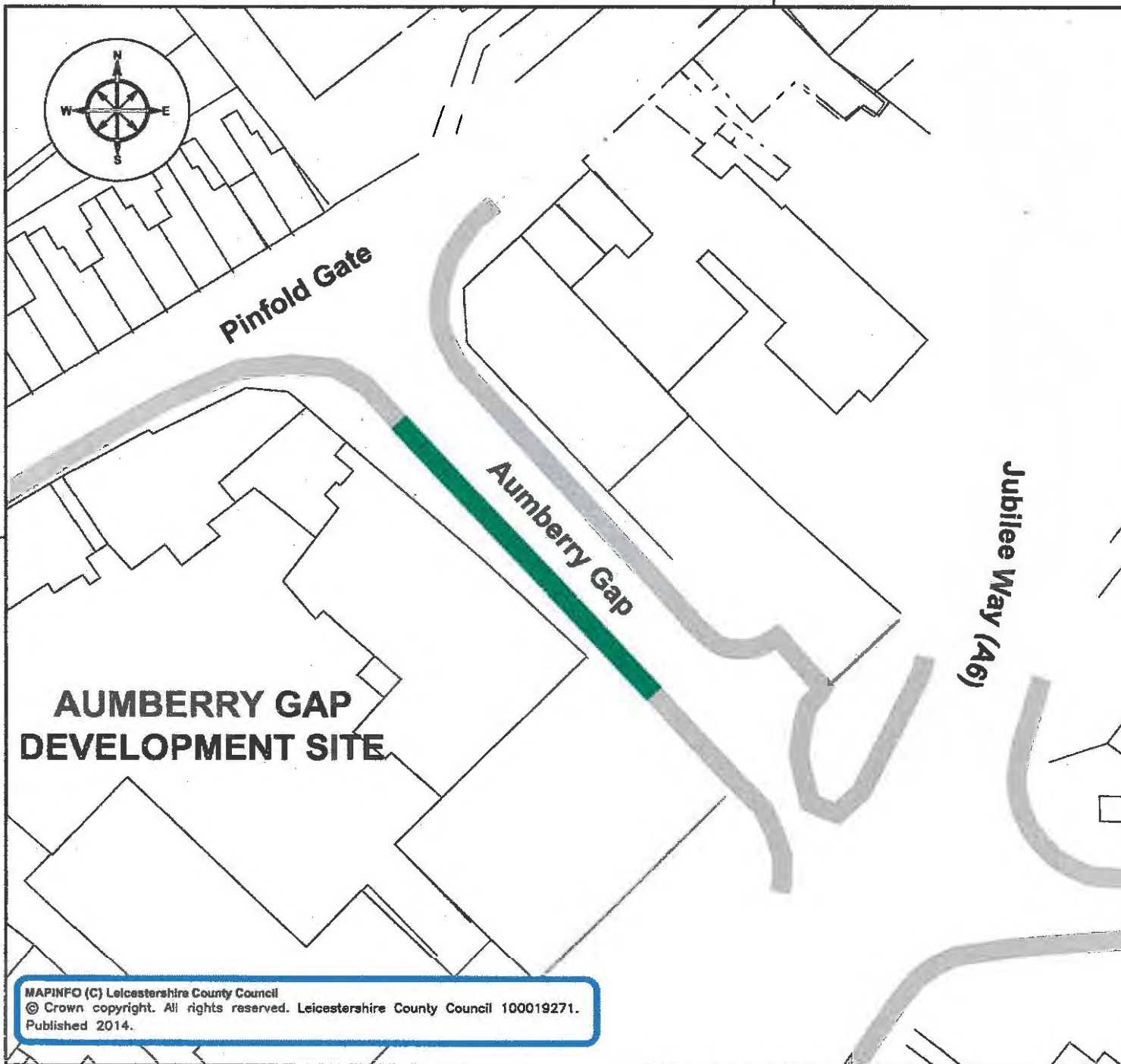

# **KEY**

 **PROPOSED 2 HR LIMITED WAITING**  
**MON - SAT 8AM TO 6PM**  
**NO RETURN WITHIN 1 HOUR**

 **EXISTING WAITING RESTRICTIONS**  
**TO BE RETAINED**



**Leicestershire**  
**County Council**

**ENVIRONMENT AND**  
**TRANSPORT DEPT**



**PHIL CROSS LAND**  
**DIRECTOR**

**TRAFFIC & SAFETY**  
**GROUP**

**TRAFFIC MANAGEMENT**

**TITLE:**  
**AUMBERRY GAP**  
**LOUGHBOROUGH**  
**TRO CHANGES**

**DRAWING NUMBER**

**SCALE**

**TM4145/10**

**NTS**

**PREPARED BY:**

**GN**

**DATE:**

**3rd Oct 2014**

**CHECKED BY:**

**MP**

**SIZE :**

**A4**

**COUNTY HALL \* GLENFIELD \* LEICESTER \* LE3 8ST**

**Tel: 0116 305 0001 \* Fax: 0116 305 0006**

**E-Mail address:**

**customerservices@leics.gov.uk**

**www.leics.gov.uk**

**MAPINFO (C) Leicestershire County Council**  
**© Crown copyright. All rights reserved. Leicestershire County Council 100019271.**  
**Published 2014.**

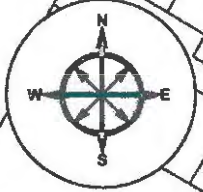



Cradock Street

CHAPMAN STREET

Chapman St

**KEY**

-  PROPOSED NO WAITING  
MON - SAT 6AM TO 6PM
-  EXISTING WAITING RESTRICTIONS  
TO BE RETAINED



**Leicestershire  
County Council**

**ENVIRONMENT AND  
TRANSPORT DEPT**



**PHIL CROSS LAND  
DIRECTOR**

**TRAFFIC & SAFETY  
GROUP**

**TRAFFIC MANAGEMENT**

TITLE:

**CHAPMAN STREET  
LOUGHBOROUGH  
TRO CHANGES**

DRAWING NUMBER

SCALE

**TM4145/11**

**NTS**

PREPARED BY:

GN

DATE:

3rd Oct 2014

CHECKED BY:

MP

SIZE :

A4

**COUNTY HALL • GLENFIELD • LEICESTER • LE1 8BT**

**Tel: 0116 305 0001 • Fax: 0116 305 0006**

E-Mail address:

[customerservices@leics.gov.uk](mailto:customerservices@leics.gov.uk)

[www.leics.gov.uk](http://www.leics.gov.uk)

MAPINFO (C) Leicestershire County Council  
© Crown copyright. All rights reserved. Leicestershire County Council 100019271.  
Published 2014.



