

THE LEICESTERSHIRE COUNTY COUNCIL
(LEICESTER ROAD, LOUGHBOROUGH, BOROUGH OF CHARNWOOD)
(IMPOSITION OF WAITING RESTRICTIONS AND PARKING PLACES) ORDER 2015

The Leicestershire County Council ("the Council") in exercise of its powers under Section 1(1), 2(1), 2(2), 4, 32, 35 and Part IV of Schedule 9 of the Road Traffic Regulation Act 1984 ("The Act") and of all other enabling powers, hereby makes the following Order:-

1. This Order shall come into force on the twenty fifth day of May 2015 and may be cited as "The Leicestershire County Council (Leicester Road, Loughborough, Borough of Charnwood) (Imposition of Waiting Restrictions and Parking Places) Order 2015".
2. The exemptions contained in this Order as set out in column 1 of Schedule 1 shall hereafter be referred to by reference to the code letters given in column 2 of Schedule 1.
3. (1) In this Order –

"authorised cab rank" means any area of carriageway which is comprised within and indicated by a road marking complying with diagram 1028.2 in Schedule 6 of The Traffic Signs Regulations and General Directions 2002;

"authorised parking place" means any parking place on a road authorised or designated by an Order made or having effect as if made under the Act;

"bus" has the same meaning as in Regulation 22 of the Traffic Signs Regulations and General Directions 2002;

"bus stop area" means any area of carriageway on the sides of roads specified in this Order which is comprised within and indicated by a road marking complying with either diagram 1025.2 or diagram 1025.3 to the Traffic Signs Regulations and General Directions 2002;

"C.E.O." means a duly authorised Civil Enforcement Officer;

"disabled person's badge" has the same meaning as in The Disabled Persons (Badges for Motor Vehicles)(England) Regulations 2000 and subsequent Amendment Regulations;

"disabled persons designated parking bay" means the part of the carriageway or side of road marked in accordance with Schedule 6 of the Traffic Signs Regulations and General Directions 2002 (as amended) by the marking shown in diagram 1028.3, 1032 or 1033 (or permitted variants thereof);

"doctors' permit holders" means a vehicle which displays a valid permit issued to a Doctor for use in a specified location;

"footway parking area" means an area of the footway specifically designated for the purpose of waiting;

"goods vehicle" has the same meaning as that ascribed to it in Section 192(1) of the Road Traffic Act 1988;

"heavy commercial vehicle" has the same meaning as in Section 138 of the Act;

"loading" and "unloading" means the collection or delivery of goods (parcels, stock and other items of that nature) to or from a vehicle where the goods cannot be reasonably collected or delivered except by the use of that vehicle in a particular length of road;

"market day" means any day of the week approved and authorised under a market charter for the holding of a market or such other bona fide licensed market;

"market trader" means any person duly authorised an appropriate body to trade from an authorised market stall or stand or location as from time to time may be specified by the appropriate body for the purposes of his or her trading;

"motor cycle" has the same meaning as in Section 136 of The Act;

"motor vehicle" means any vehicle as defined by the Construction and Use Regulations 1986 (as amended) which is mechanically propelled except where otherwise provided;

"parking disc" means a disc, issued by a local authority, complying with the requirements of the British Standard Specification for Parking Discs (BS No.4631:1970) but coloured blue, and capable of showing the quarter hour period during which a period of waiting begins, or a blue badge under the Disabled Persons (Badges for Motor Vehicles)(England) Regulations 2000;

"permitted parking place" means any part of a road hereby authorised by the Council for use as a parking place, bay or space where vehicles may wait;

"permit" means a written warrant issued by or on behalf of Leicestershire County Council allowing the holder to wait in a specified location;

"permit holder" means a vehicle which displays a valid permit;

"residents' parking permit holder / residents' permit holder" means a vehicle which displays a valid permit issued to a resident of the specified location;

"road / roads" means the carriageway the footway and any verges being the full width of the highway extent from one boundary to another;

"school entrance" means any area of carriageway on the side of the road where vehicles are not permitted to stop and indicated by a road marking complying with diagram 1027.1 of the 2002 Regulations;

"solo motor cycle" means a motor cycle without a sidecar and having two wheels;

"taxi" means a Hackney Carriage vehicle licensed under section 37 of the Town Police Clauses Act 1847;

"vehicle" means any Motor Vehicle as defined in this Order and any other vehicle (capable of the carriage of persons or goods) except cycles unless otherwise provided;

"4.00 p.m. to 10.00 a.m. the following morning" wherever referred to in this Order means that period of time commencing at 4.00 p.m. in the afternoon of any day and terminating at 10.00 a.m. on the morning of the next day;

"The Act" means The Road Traffic Regulation Act 1984.

- (2) For the purpose of this Order a vehicle shall be regarded as displaying a disabled person's badge in the relevant position, where in accordance with The Disabled Persons (Badges for Motor Vehicles) (England) Regulations 2000 (as amended):
- (i) the Badge is displayed on the vehicle's dashboard or fascia panel with the front of the Badge facing forward with the details thereon clearly visible from an external position, or
 - (ii) where the vehicle has no dashboard or fascia panel or windscreen where the Badge may be exhibited or displayed it shall be exhibited in a conspicuous position on the front or near side of the vehicle and

in either case a parking disc is exhibited in the relevant position prescribed in The Disabled Persons (Badges for Motor Vehicles) (England) Regulations 2000 (as amended).

4. For the purposes of this Order and where any article permits, it shall not be unlawful to cause or permit a disabled person's vehicle which displays in the relevant position a disabled person's badge and a parking disc (on which the driver, or other person in charge of the vehicle, has marked the time at which the period of waiting began) to wait on the sides of roads referred to in the specific article, for a period not exceeding 3 hours unless otherwise stated (not being a period separated by an interval of less than one hour, unless otherwise stated, from a previous period of waiting by the same vehicle on the same side of road on the same day) provided that no such vehicle shall wait in any length of road where there is for the time being a prohibition of loading and unloading.
5. "The Leicestershire County Council (Various Roads, Loughborough (Area 5), District of Charnwood) Consolidation and Amendment Order 2009", "The Leicestershire County Council

(A6, Leicester Road, Loughborough (Area 5), District of Charnwood) Order 2011", "The Leicestershire County Council (Various Roads, Loughborough (Area 5), District of Charnwood) Amendment Order No.2 2011" and "The Leicestershire County Council (Inner Relief Road, Loughborough (Borough of Charnwood) (Prohibition and Restriction of Waiting, Loading and Parking Places) Order 2014" is hereby revoked in respect of that length of road specified in Schedule 2 to this Order.

6.1 No person shall, except upon the direction or with the permission of a police officer in uniform, a community support officer or a C.E.O., cause or permit any vehicle to wait between the hours of 8.00 a.m. and 6.00 p.m. on any day other than a Sunday, in the permitted parking place specified in Schedule 3 Part 1 to this Order:-

- a) For a period longer than 2 hours, or
- b) If a period of less than 1 hour has elapsed since the last period of waiting by that vehicle on the same permitted parking place;

6.2 No person shall, except upon the direction or with the permission of a police officer in uniform, a community support officer or a C.E.O., cause or permit any vehicle to wait between the hours of 8.00 a.m. and 6.00 p.m. on any day other than a Sunday, in the permitted parking place specified in Schedule 3 Part 2 to this Order:-

- a) For a period longer than 30 hour, or
- b) If a period of less than 1 hour has elapsed since the last period of waiting by that vehicle on the same permitted parking place;

6.3 No person shall, except upon the direction or with the permission of a police officer in uniform, a community support officer or a C.E.O., or in accordance with the exemption provisions, cause or permit any vehicle to wait between the hours of 7.30 a.m. and 9.00 a.m. and 4.30 p.m. and 6.00 p.m. on any day other than a Sunday, for the purpose of enabling goods to be loaded or unloaded from the vehicle on the sides of road specified in Schedule 3 Part 3 to this Order.

6.4 No person shall, except upon the direction or with the permission of a police officer in uniform, a community support officer or a C.E.O., or in accordance with the exemption provisions, cause or permit any vehicle to wait at any time on any day, on the sides of road specified in Schedule 3 Part 4 to this Order.

- 6.5 No person shall, except upon the direction or with the permission of a police officer in uniform, a community support officer or a C.E.O., cause or permit any vehicle to wait on any day, in the permitted parking place specified in Schedule 3 Part 5 to this Order, except for disabled badge holders:-
- For a period longer than 3 hours, or
 - If a period of less than 1 hour has elapsed since the last period of waiting by that vehicle on the same permitted parking place;
6. Except where otherwise stated, a reference in this Order to a numbered Article or Schedule is reference to the Article or Schedule bearing that number in this order.
7. The plan annexed to this Order and marked drawing number TM3983/04 is for identification purposes only.

SCHEDULE 1

TYPE OF EXEMPTION	CODE
For vehicles to allow people to board or alight.	LCCA
For vehicles used in connection with:- <ol style="list-style-type: none"> building, industrial or demolition operations; the removal of any obstruction to traffic; the maintenance, improvement or reconstruction of the said sides of roads; or the laying, erection, alternative or repair on, or in land adjacent to the said sides of roads of any sewer or of any main, pipe or apparatus for the supply of gas, water or electricity or of any telegraphic line as defined in the Telecommunications Act 1984. 	LCCB
For vehicles to be used in the service of a local authority, highways agency, an area health authority or a water	LCCC

undertaker in pursuance of statutory powers or duties and whilst being so used in such service it is necessary for the vehicle to be positioned in the place where it is waiting.	
For vehicles to be used for the purpose of delivering or collecting postal packets as defined in section 87 of the Postal Services Act 2000 by any universal service provider.	LCCD
Not Allocated	LCCE
For vehicles to wait at or near to any premises situated on or adjacent to the said sides of roads for so long as such waiting by that vehicle is reasonably necessary in connection with any wedding or funeral.	LCCF
For vehicles to be used for fire brigade, ambulance or police purposes.	LCCG
For goods to be loaded on or unloaded from the vehicle on the sides of roads specified in this Order.	LCCH
For Vehicles: (a) to wait upon an authorised parking place, (b) being a hackney carriage, to wait upon an authorised cab rank, or (c) licensed taxi.	LCCI
For a disabled person's vehicle which displays in the relevant position a disabled person's badge, and a parking disc (on which the driver, or other person in charge of the vehicle, has marked the time at which the period of waiting began) to wait on the sides of roads referred to in that Schedule for a period not exceeding three hours (not being a period separated by an interval of less than one hour from a previous period of waiting by the same vehicle on the same side of road on the same	LCCJ

day) provided that no such vehicle shall wait in any length of road where there is for the time being a prohibition of loading and unloading.	
For vehicles to wait on the sides of roads referred to therein for so long as may be necessary while any gate or other barrier at the entrance to premises to which the vehicle requires access or from which it has just emerged is being opened or closed, if it is not reasonably practicable for the vehicle to wait otherwise than in that road while such a gate or barrier is opened or closed.	LCKK
Any vehicle bona fide associated or used in connection with or for the purpose of licensed markets or special events.	LCCL
Where the person in control of the vehicle is directed or given permission to stop by a police officer, community support officer or a civil enforcement officer.	LCCM
To enable any motor vehicle that is constructed or adapted for the purpose of carrying monies or valuables under secure deposit and which is in use on a pre-arranged appointment for the delivery or collection of monies, financial instruments or valuables (for such a period of time as reasonably required to complete the delivery or collection) to any premises on the sides of road.	LCCN
Not Allocated	LCCO
Not Allocated	LCCP
Nothing shall render it unlawful to cause or permit any vehicle to wait in connection with the maintenance or repair of any premises adjoining the roads which can only be carried out from the road being such works as are required to be carried out to comply with any statutory obligation condition or stipulation subject to such waiting being limited to a maximum	LCCQ

of two hours in any period of 24 hours.	
Not Allocated	LCCR
Not Allocated	LCCS
Not Allocated	LCCT
Not Allocated	LCCU
Not Allocated	LCCV
Not Allocated	LCCW
Not Allocated	LCCX
For a disabled person's vehicle which displays in the relevant position a disabled person's badge and a parking disc (on which the driver, or other person in charge of the vehicle, has marked the time at which the period of waiting began) to wait in the designated parking place.	LCCY

SCHEDULE 2 **REVOCATIONS**

Items to be revoked from:

THE LEICESTERSHIRE COUNTY COUNCIL (VARIOUS ROADS, LOUGHBOROUGH (AREA 5), DISTRICT OF CHARNWOOD) CONSOLIDATION AND AMENDMENT ORDER 2009

Limited waiting 2 hours no return for 1 hour Mon-Sat 8am-6pm

Unnamed Access Road to Fairfield Lower School, Loughborough

- (i) the north-east side from a point opposite the north-western kerblines of Factory Street in a north-westerly direction for a distance of 46 metres
- (ii) the north-east side from a point 11 metres south-east of a point opposite the south-eastern kerblines of King Street in a north-westerly direction for a distance of 31 metres

No waiting at any time

Unnamed Access Road to Fairfield Lower School, Loughborough

- (i) the north-east side from a point 46 metres north-west of a point opposite the north-western kerblines of Factory Street in a north-westerly direction for a distance of 47 metres
- (ii) the south-west side from a point 15 metres south-east of a point opposite the south-eastern kerblines of King Street in a north-westerly direction for a distance of 112 metres

Items to be revoked from:

THE LEICESTERSHIRE COUNTY COUNCIL (A6, LEICESTER ROAD, LOUGHBOROUGH (AREA 5), DISTRICT OF CHARNWOOD) ORDER 2011

No loading Mon-Sat 7.30am-9am and 4.30pm-6pm

Leicester Road, Loughborough

- (i) the north-east side from its junction with Factory Street in a north-westerly direction to its junction with Gregory Street
- (ii) the north-east side from its junction with King Street in a north-westerly direction to its junction with Factory Street

No waiting at any time

Leicester Road, Loughborough

- (i) the north-east side from its junction with Factory Street in a north-westerly direction for a distance of 10 metres
- (ii) the north-east side from its junction with King Street in a north-westerly direction to its junction with Factory Street

Items to be revoked from:

THE LEICESTERSHIRE COUNTY COUNCIL (VARIOUS ROADS, LOUGHBOROUGH (AREA 5), DISTRICT OF CHARNWOOD) AMENDMENT ORDER NO.2 2011

Limited waiting 30 mins no return for 30 mins Mon-Sat 9am-4.30pm

Leicester Road, Loughborough

- (i) the north-east side from a point 10 metres north-west of its junction with Factory Street in a north-westerly direction to a point 2 metres south-east of its junction with Gregory Street
- (ii) the north-east side from a point 2 metres north-west of its junction with Gregory Street in a north-westerly direction for a distance of 40 metres
- (iii) the north-east side from a point 55 metres north-west of its junction with Gregory Street in a north-westerly direction for a distance of 13 metres
- (iv) the north-east side from a point 78 metres north-west of its junction with Gregory Street in a north-westerly direction to the boundary of Nos. 24/26 Leicester Road

No waiting at any time

Leicester Road, Loughborough

- (i) the north-east side from a point 42 metres north of its junction with Gregory Street in a north-westerly direction for a distance of 13 metres

- (ii) the north-east side from a point 68 metres north of its junction with Gregory Street in a north-westerly direction for a distance of 10 metres
- (iii) the north-east side from the boundary of Nos. 24/26 Leicester Road in a north-westerly direction to its junction with Barrow Street
- (iv) the north-east side from its junction with Gregory Street in a north-westerly direction for a distance of 2 metres
- (v) the north-east side from its junction with Gregory Street in a south-easterly direction for a distance of 2 metres

No waiting Mon-Sat 7.30am-9am and 4.30pm-6pm

Leicester Road, Loughborough

- (i) the north-east side from a point 10 metres north-west of its junction with Factory Street in a north-westerly direction to a point 2 metres south-east of its junction with Gregory Street
- (ii) the north-east side from a point 2 metres north-west of its junction with Gregory Street in a north-westerly direction for a distance of 40 metres
- (iii) the north-east side from a point 55 metres north-west of its junction with Gregory Street in a north-westerly direction for a distance of 13 metres
- (iv) the north-east side from a point 78 metres north-west of its junction with Gregory Street in a north-westerly direction to the boundary of Nos. 24/26 Leicester Road

Items to be revoked from:

THE LEICESTERSHIRE COUNTY COUNCIL (INNER RELIEF ROAD, LOUGHBOROUGH (BOROUGH OF CHARNWOOD) (PROHIBITION AND RESTRICTION OF WAITING, LOADING AND PARKING PLACES) ORDER 2014

No loading at any time

Leicester Road, Loughborough

the north-east side from its junction with Barrow Street in a south-easterly direction to the boundary of Nos. 20/22 Leicester Road

No loading Mon-Sat 7.30am-9am and 4.30pm-6pm

Leicester Road, Loughborough

the north-east side from its junction with Gregory Street in a north-westerly direction to the boundary of Nos. 20/22 Leicester Road

SCHEDULE 3
IMPOSITIONS

Schedule 3, Part 1

Limited waiting 2 hours no return for 1 hour Mon-Sat 8am-6pm

Leicester Road (service Road), Loughborough

- (i) the north-east side from a point 13 metres north-west of its junction with Leicester Road in a north-westerly direction for a distance of 38 metres
- (ii) the north-east side from a point 103 metres north-west of its junction with Leicester Road in a north-westerly direction for a distance of 32 metres
- (iii) the north-east side from a point 139.5 metres north-west of its junction with Leicester Road in a north-westerly direction for a distance of 14 metres
- (iv) the north-east side from a point 155 metres north-west of its junction with Leicester Road in a north-westerly direction for a distance of 5 metres
- (v) the north-east side from a point 173 metres north-west of its junction with Leicester Road in a north-westerly direction for a distance of 6.5 metres
- (vi) the north-east side from a point 16.5 metres south-east of its junction with Leicester Road in a south-easterly direction for a distance of 28 metres

EXEMPTIONS

The following exemptions apply to the above. Refer to Schedule 1 for the details of each exemption:-

LCCA, LCCB, LCCC, LCCD, LCCF, LCCG, LCCH, LCCM, LCCY.

Schedule 3, Part 2

Limited waiting 30 mins no return for 1 hour Mon-Sat 8am-6pm

Leicester Road, Loughborough

- (i) the north-east side from a point 11 metres north-west of its junction with Factory Street in a north-westerly direction for a distance of 40 metres
- (ii) the north-east side from a point 2 metres north-west of its junction with Gregory Street in a north-westerly direction for a distance of 60 metres
- (iii) the north-east side from a point 84 metres north-west of its junction with Gregory Street in a north-westerly direction for a distance of 56 metres

EXEMPTIONS

The following exemptions apply to the above. Refer to Schedule 1 for the details of each exemption:-

LCCA, LCCB, LCCC, LCCD, LCCF, LCCG, LCCH, LCCM, LCCY.

Schedule 3, Part 3

**No loading
Monday-Saturday 7.30am-9.00am and 4.30pm-6.00pm**

Leicester Road, Loughborough

- (i) the north-east side from its junction with King Street in a north-westerly direction to a point 11 metres north-west of its junction with Factory Street

- (ii) the north-east side from a point 140 metres north-west of its junction with Gregory Street in a north-westerly direction to its junction with Barrow Street

EXEMPTIONS

The following exemptions apply to the above. Refer to Schedule 1 for the details of each exemption:-

LCCA, LCCB, LCCC, LCCD, LCCG, LCCM.

Schedule 3, Part 4

No waiting at any time

Leicester Road, Loughborough

- (i) the north-east side from its junction with King Street in a north-westerly direction to a point 11 metres north-west of its junction with Factory Street
- (ii) the north-east side from a point 140 metres north-west of its junction with Gregory Street in a north-westerly direction to its junction with Barrow Street

EXEMPTIONS

The following exemptions apply to the above. Refer to Schedule 1 for the details of each exemption:-

LCCA, LCCB, LCCC, LCCD, LCCG, LCCM.

No waiting at any time

Leicester Road, Loughborough

- (i) the north-east side from a point 2 metres south-east of its junction with Gregory Street in a north-westerly direction to a point 2 metres north-west of its junction with Gregory Street
- (ii) the north-east side from a point 62 metres north-west of its junction with Gregory Street in a north-westerly direction for a distance of 22 metres

Leicester Road (service Road), Loughborough

- (i) the north-east & south-east side from a point 44.5 metres south-east of its junction with Leicester Road in a south-easterly, then south-westerly direction to its south-western extent
- (ii) the north-east side from its junction with Leicester Road in a north-westerly direction for a distance of 13 metres
- (iii) the north-east side from a point 51 metres north-west of its junction with Leicester Road in a north-westerly direction for a distance of 52 metres
- (iv) the north-east side from a point 135 metres north-west of its junction with Leicester Road in a north-westerly direction for a distance of 4.5 metres
- (v) the north-east side from a point 153.5 metres north-west of its junction with Leicester Road in a north-westerly direction for a distance of 1.5 metres
- (vi) the north-east side from a point 160 metres north-west of its junction with Leicester Road in a north-westerly direction for a distance of 3.5 metres
- (vii) the north-east side from a point 167 metres north-west of its junction with Leicester Road in a north-westerly direction for a distance of 6 metres
- (viii) the north-east side from a point 179.5 metres north-west of its junction with Leicester Road in a north-westerly direction to its north-eastern extent
- (ix) the north-east side from its junction with Leicester Road in a south-easterly direction for a distance of 16.5 metres
- (x) the south-west & north-west side from its south-western extent in a north-westerly, then north-easterly direction to its north-eastern extent including the turning head

EXEMPTIONS

The following exemptions apply to the above. Refer to Schedule 1 for the details of each exemption:-

LCCA, LCCB, LCCC, LCCD, LCCF, LCCG, LCCH, LCCI, LCCJ, LCCM, LCCN.

Schedule 3, Part 5

Disabled Persons Parking 3 hours no return for 1 hour

Leicester Road (service Road), Loughborough

the north-east side from a point 163.5 metres north-west of its junction with Leicester Road
in a north-westerly direction for a distance of 3.6 metres

EXEMPTIONS

The following exemptions apply to the above. Refer to Schedule 1 for the details of each exemption:-

LCCA.

THE COMMON SEAL of THE)
LEICESTERSHIRE COUNTY COUNCIL)
was hereunto affixed this eleventh day of)
May 2015 in the presence of)

Steven Haslam



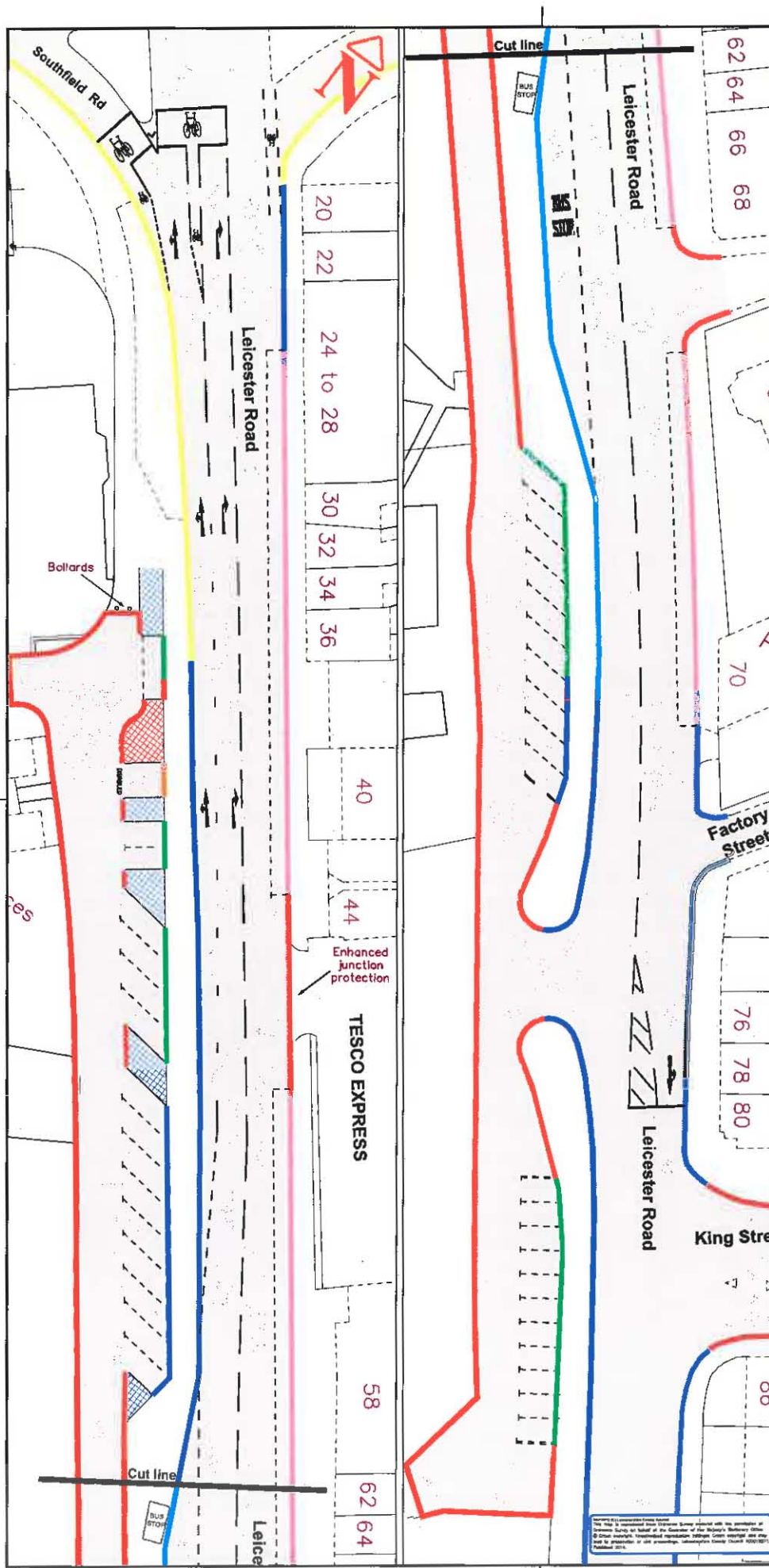

KEY

- Proposed kerb build out
- No waiting at any time, and no loading at any time
- No waiting at any time, and no loading Mon-Sat, 07:30-09:00hrs & 16:30-18:00hrs
- Double yellow lines (No waiting at any time)
- Limited waiting for 30 mins Mon - Sat, 8am - 6pm No return within 1 hour
- Limited waiting for 2 hours Mon - Sat, 8am - 6pm No return within 1 hour
- Disabled badge holders only Limited waiting for 3 hours No return within 1 hour
- No stopping except buses at any time

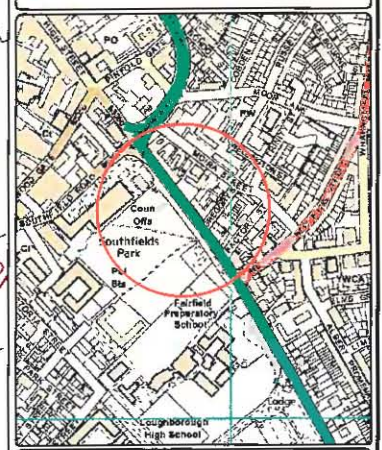

This drawing is indicative, and should be used for illustrative purposes only.

The precise number, or alignment or parking bays may be subject to change. This drawing is not intended to be an accurate portrayal of existing or proposed carriageway markings.

This drawing does not form a part of the final legal order. Other existing parking controls not shown on this drawing do not form a part of the proposals and shall remain unchanged.

No attempt should be made to scale from this drawing.

Leicestershire County Council

ENVIRONMENT AND TRANSPORT DEPARTMENT

PHIL CROSSLAND DIRECTOR

TRAFFIC & SAFETY GROUP

TRAFFIC MANAGEMENT

TITLE:
LEICESTER ROAD & SERVICE ROAD LOUGHBOROUGH
DISTRICT OF CHARNWOOD
NEW ROAD LAYOUT & PARKING CONTROLS

DRAWING NUMBER	SCALE
TM3983/04	NTS
PREPARED BY: M. ARCHER	DATE: October 2014
CHECKED BY: M. ARCHER	SIZE: A3
APPROVED BY: M. PALFREYMAN	CORR. FILE: 1

COUNTY HALL * GLENFIELD * LEICESTER * LE3 8RJ

E-Mail address: customer.services@leica.gov.uk www.leica.gov.uk