

THE LEICESTERSHIRE COUNTY COUNCIL  
(VARIOUS ROADS, LOUGHBOROUGH (AREA 5), BOROUGH OF CHARNWOOD)  
(NO WAITING AT ANY TIME) ORDER 2014

The Leicestershire County Council ("the Council") in exercise of its powers under Section 1(1) and 2(1) to (3) 4(2) 32 35 and Part IV of Schedule 9 of the Road Traffic Regulation Act 1984 ("The Act") and of all other enabling powers, hereby makes the following Order:-

1. This Order shall come into force on the tenth day of November 2014 and may be cited as "The Leicestershire County Council (Various Roads, Loughborough (Area 5), Borough of Charnwood) (No Waiting at Any Time) Order 2014 ".
2. The exemptions contained in this Order as set out in column 1 of Schedule 1 shall hereafter be referred to by reference to the code letters given in column 2 of Schedule 1.
3. (1) In this Order –

"authorised cab rank" means any area of carriageway which is comprised within and indicated by a road marking complying with diagram 1028.2 in Schedule 6 of The Traffic Signs Regulations and General Directions 2002;

"authorised parking place" means any parking place on a road authorised or designated by an Order made or having effect as if made under the Act;

"bus" has the same meaning as in Regulation 22 of the Traffic Signs Regulations and General Directions 2002;

"bus stop area" means any area of carriageway on the sides of roads specified in this Order which is comprised within and indicated by a road marking complying with either diagram 1025.2 or diagram 1025.3 to the Traffic Signs Regulations and General Directions 2002;

"C.E.O." means a duly authorised Civil Enforcement Officer;

"disabled person's badge" has the same meaning as in The Disabled Persons (Badges for Motor Vehicles)(England) Regulations 2000 and subsequent Amendment Regulations;

"disabled persons designated parking bay" means the part of the carriageway or side of road marked in accordance with Schedule 6 of the Traffic Signs Regulations and General Directions 2002 (as amended) by the marking shown in diagram 1028.3, 1032 or 1033 (or permitted variants thereof);

"doctors' permit holders" means a vehicle which displays a valid permit issued to a Doctor for use in a specified location;

"footway parking area" means an area of the footway specifically designated for the purpose of waiting;

"goods vehicle" has the same meaning as that ascribed to it in Section 192(1) of the Road Traffic Act 1988;

"heavy commercial vehicle" has the same meaning as in Section 138 of the Act;

"loading" and "unloading" means the collection or delivery of goods (parcels, stock and other items of that nature) to or from a vehicle where the goods cannot be reasonably collected or delivered except by the use of that vehicle in a particular length of road;

"market day" means any day of the week approved and authorised under a market charter for the holding of a market or such other bona fide licensed market;

"market trader" means any person duly authorised an appropriate body to trade from an authorised market stall or stand or location as from time to time may be specified by the appropriate body for the purposes of his or her trading;

"motor cycle" has the same meaning as in Section 136 of The Act;

"motor vehicle" means any vehicle as defined by the Construction and Use Regulations 1986 (as amended) which is mechanically propelled except where otherwise provided;

"parking disc" means a disc, issued by a local authority, complying with the requirements of the British Standard Specification for Parking Discs (BS No.4631:1970) but coloured blue, and capable of showing the quarter hour period during which a period of waiting begins, or a blue badge under the Disabled Persons (Badges for Motor Vehicles)(England) Regulations 2000;

"permitted parking place" means any part of a road hereby authorised by the Council for use as a parking place, bay or space where vehicles may wait;

"permit" means a written warrant issued by or on behalf of Leicestershire County Council allowing the holder to wait in a specified location;

"permit holder" means a vehicle which displays a valid permit;

"residents' parking permit holder / residents' permit holder" means a vehicle which displays a valid permit issued to a resident of the specified location;

"road / roads" means the carriageway the footway and any verges being the full width of the highway extent from one boundary to another;

"school entrance" means any area of carriageway on the side of the road where vehicles are not permitted to stop and indicated by a road marking complying with diagram 1027.1 of the 2002 Regulations;

"solo motor cycle" means a motor cycle without a sidecar and having two wheels;

"taxi" means a Hackney Carriage vehicle licensed under section 37 of the Town Police Clauses Act 1847;

"vehicle" means any Motor Vehicle as defined in this Order and any other vehicle (capable of the carriage of persons or goods) except cycles unless otherwise provided;

"4.00 p.m. to 10.00 a.m. the following morning" wherever referred to in this Order means that period of time commencing at 4.00 p.m. in the afternoon of any day and terminating at 10.00 a.m. on the morning of the next day;

"The Act" means The Road Traffic Regulation Act 1984.

- (2) For the purpose of this Order a vehicle shall be regarded as displaying a disabled person's badge in the relevant position, where in accordance with The Disabled Persons (Badges for Motor Vehicles) (England) Regulations 2000 (as amended):

- (i) the Badge is displayed on the vehicle's dashboard or fascia panel with the front of the Badge facing forward with the details thereon clearly visible from an external position, or
- (ii) where the vehicle has no dashboard or fascia panel or windscreen where the Badge may be exhibited or displayed it shall be exhibited in a conspicuous position on the front or near side of the vehicle and

in either case a parking disc is exhibited in the relevant position prescribed in The Disabled Persons (Badges for Motor Vehicles) (England) Regulations 2000 (as amended).

4. For the purposes of this Order and where any article permits, it shall not be unlawful to cause or permit a disabled person's vehicle which displays in the relevant position a disabled person's badge and a parking disc (on which the driver, or other person in charge of the vehicle, has marked the time at which the period of waiting began) to wait on the sides of roads referred to in the specific article, for a period not exceeding 3 hours unless otherwise stated (not being a period separated by an interval of less than one hour, unless otherwise stated, from a previous period of waiting by the same vehicle on the same side of road on the same day) provided that no such vehicle shall wait in any length of road where there is for the time being a prohibition of loading and unloading.

5. "THE LEICESTERSHIRE COUNTY COUNCIL (VARIOUS ROADS, LOUGHBOROUGH (AREA 5), DISTRICT OF CHARNWOOD) CONSOLIDATION AND AMENDMENT ORDER 2009" is hereby revoked in respect of those lengths of roads as specified in Schedule 2 to this Order.

"THE LEICESTERSHIRE COUNTY COUNCIL (VARIOUS ROADS, LOUGHBOROUGH (AREA 5), DISTRICT OF CHARNWOOD) ORDER 2011" is hereby revoked in respect of those lengths of roads as specified in Schedule 2 to this Order

"THE LEICESTERSHIRE COUNTY COUNCIL (LOUGHBOROUGH EASTERN GATEWAY (AREA 5), DISTRICT OF CHARNWOOD) ORDER 2011" is hereby revoked in respect of those lengths of roads as specified in Schedule 2 to this Order

"THE LEICESTERSHIRE COUNTY COUNCIL (LOUGHBOROUGH EASTERN GATEWAY (AREA 5), DISTRICT OF CHARNWOOD) ORDER NO.2 2012" is hereby revoked in respect of those lengths of roads as specified in Schedule 2 to this Order

"THE LEICESTERSHIRE COUNTY COUNCIL (WEST LOUGHBOROUGH PARKING STRATEGY (AREA 5), DISTRICT OF CHARNWOOD) ORDER 2012" is hereby revoked in respect of those lengths of roads as specified in Schedule 2 to this Order

"THE LEICESTERSHIRE COUNTY COUNCIL (DISABLED PERSONS PARKING PLACES, LOUGHBOROUGH (AREA 5), DISTRICT OF CHARNWOOD) ORDER 2013" is hereby revoked in respect of those lengths of roads as specified in Schedule 2 to this Order

6.1 No person shall, except upon the direction or with the permission of a police officer in uniform, a community support officer or a C.E.O., or in accordance with the exemption provisions, cause or permit any vehicle to wait at any time on any day, on the sides of road specified in Schedule 3 to this Order.

6.2 No person shall, except upon the direction or with the permission of a police officer in uniform, a community support officer or a C.E.O., cause or permit any vehicle to wait between the hours of 8.00 a.m. and 6.00 p.m. on any day other than a Sunday, in the permitted parking place specified in Schedule 4 Part 1 to this Order:-

- a) For a period longer than 1 hour, or
- b) If a period of less than 1 hour has elapsed since the last period of waiting by that vehicle on the same permitted parking place;

6.3 No person shall, except upon the direction or with the permission of a police officer in uniform, a community support officer or a C.E.O., cause or permit any vehicle to wait between the hours of 8.00 a.m. and 6.00 p.m. on any day other than a Sunday, in the permitted parking place specified in Schedule 4 Part 2 to this Order:-

- a) For a period longer than 2 hours, or

- b) If a period of less than 1 hour has elapsed since the last period of waiting by that vehicle on the same permitted parking place;

6.4 No person shall, except upon the direction or with the permission of a police officer in uniform, a community support officer or a C.E.O., cause or permit any vehicle to wait between the hours of 8.00 a.m. and 6.00 p.m. on any day other than a Sunday, in the permitted parking place specified in Schedule 4 Part 3 to this Order, except for residents' parking permit holders:-

- a) For a period longer than 1 hour, or
- b) If a period of less than 1 hour has elapsed since the last period of waiting by that vehicle on the same permitted parking place;

6.5 No person shall, except upon the direction or with the permission of a police officer in uniform, a community support officer or a C.E.O., cause or permit any vehicle to wait between the hours of 8.00 a.m. and 6.00 p.m. on any day other than a Sunday, between 1st October and 31st May, in the permitted parking place specified in Schedule 4 Part 4 to this Order, except for residents' parking permit holders:-

- a) For a period longer than 1 hour, or
- b) If a period of less than 1 hour has elapsed since the last period of waiting by that vehicle on the same permitted parking place;

6.6 No person shall, except upon the direction or with the permission of a police officer in uniform, a community support officer or a C.E.O., cause or permit any vehicle to wait between the hours of 8.00 a.m. and 6.00 p.m. on any day other than a Sunday, between 1st October and 31st May, in the permitted parking place specified in Schedule 4 Part 5 to this Order, except for residents' parking permit holders:-

- a) For a period longer than 2 hours, or
- b) If a period of less than 1 hour has elapsed since the last period of waiting by that vehicle on the same permitted parking place;



- 6.7 No person shall, except upon the direction or with the permission of a police officer in uniform, a community support officer or a C.E.O., or in accordance with the exemption provisions, cause or permit any vehicle to wait at any time on any day, on the sides of road specified in Schedule 4 Part 6 to this Order.
- 6.8 No person shall, except upon the direction or with the permission of a police officer in uniform, a community support officer or a C.E.O., or in accordance with the exemption provisions, cause or permit any vehicle to wait between the hours of 8.00 a.m. and 6.00 p.m. on any day other than a Sunday, on the sides of road specified in Schedule 4 Part 7 to this Order.
- 6.9 No person shall, except upon the direction or with the permission of a police officer in uniform, a community support officer or a C.E.O., or in accordance with the exemption provisions, cause or permit any vehicle to stop or wait between the hours of 8.00 a.m. and 5.00 p.m. on any day other than a Saturday or Sunday, on the side of road designated as a school entrance as specified in Schedule 4 Part 8 to this Order.
- 6.10 No person shall, except upon the direction or with the permission of a police officer in uniform, a community support officer or a C.E.O., cause or permit any vehicle to wait in any designated footway parking area, on the sides of road specified in Schedule 4 Part 9 to this Order, except for residents parking permit holders.

- 7 Except where otherwise stated, a reference in this Order to a numbered Article or Schedule is reference to the Article or Schedule bearing that number in this order.
- 8 The written restriction applicable to that length of road referred to in Schedule 2 is hereby revoked and re-enacted as amended in Schedule 4. Such amendments shall have no practical effect on the restriction as set out on those lengths of roads and shall not affect the use of such roads by members of the public.
9. The plans annexed to this Order and marked drawing numbers TM4002, TM4002/1, TM4002/2, TM4002/3 are for identification purposes only.

**SCHEDULE 1**

<b>TYPE OF EXEMPTION</b>	<b>CODE</b>
For vehicles to allow people to board or alight.	LCCA
For vehicles used in connection with:-  (i) building, industrial or demolition operations; (ii) the removal of any obstruction to traffic; (iii) the maintenance, improvement or reconstruction of the said sides of roads; or (iv) the laying, erection, alternative or repair on, or in land adjacent to the said sides of roads of any sewer or of any main, pipe or apparatus for the supply of gas, water or electricity or of any telegraphic line as defined in the Telecommunications Act 1984.	LCCB
For vehicles to be used in the service of a local authority, highways agency, an area health authority or a water undertaker in pursuance of statutory powers or duties and whilst being so used in such service it is necessary for the vehicle to be positioned in the place where it is waiting.	LCCC



For vehicles to be used for the purpose of delivering or collecting postal packets as defined in section 87 of the Postal Services Act 2000 by any universal service provider.	LCCD
Not Allocated	LCCE
For vehicles to wait at or near to any premises situated on or adjacent to the said sides of roads for so long as such waiting by that vehicle is reasonably necessary in connection with any wedding or funeral.	LCCF
For vehicles to be used for fire brigade, ambulance or police purposes.	LCCG
For goods to be loaded on or unloaded from the vehicle on the sides of roads specified in this Order.	LCCH
<p>For Vehicles:</p> <ul style="list-style-type: none"> <li>(a) to wait upon an authorised parking place,</li> <li>(b) being a hackney carriage, to wait upon an authorised cab rank, or</li> <li>(c) licensed taxi.</li> </ul>	LCCI
For a disabled person's vehicle which displays in the relevant position a disabled person's badge, and a parking disc (on which the driver, or other person in charge of the vehicle, has marked the time at which the period of waiting began) to wait on the sides of roads referred to in that Schedule for a period not exceeding three hours (not being a period separated by an interval of less than one hour from a previous period of waiting by the same vehicle on the same side of road on the same day) provided that no such vehicle shall wait in any length of road where there is for the time being a prohibition of loading and unloading.	LCCJ
For vehicles to wait on the sides of roads referred to therein for so long as may be necessary while any gate or other barrier at	LCKK

the entrance to premises to which the vehicle requires access or from which it has just emerged is being opened or closed, if it is not reasonably practicable for the vehicle to wait otherwise than in that road while such a gate or barrier is opened or closed.	
Any vehicle bona fide associated or used in connection with or for the purpose of licensed markets or special events.	LCCL
Where the person in control of the vehicle is directed or given permission to stop by a police officer, community support officer or a civil enforcement officer.	LCCM
To enable any motor vehicle that is constructed or adapted for the purpose of carrying monies or valuables under secure deposit and which is in use on a pre-arranged appointment for the delivery or collection of monies, financial instruments or valuables (for such a period of time as reasonably required to complete the delivery or collection) to any premises on the sides of road.	LCCN
Not Allocated	LCCO
Not Allocated	LCCP
Nothing shall render it unlawful to cause or permit any vehicle to wait in connection with the maintenance or repair of any premises adjoining the roads which can only be carried out from the road being such works as are required to be carried out to comply with any statutory obligation condition or stipulation subject to such waiting being limited to a maximum of two hours in any period of 24 hours.	LCCQ
Not Allocated	LCCR
Not Allocated	LCCS
Not Allocated	LCCT

Not Allocated	LCCU
Not Allocated	LCCV
Not Allocated	LCCW
Not Allocated	LCCX
For a disabled person's vehicle which displays in the relevant position a disabled person's badge and a parking disc (on which the driver, or other person in charge of the vehicle, has marked the time at which the period of waiting began) to wait in the designated parking place.	LCCY

**SCHEDULE 2**  
**ANOMALY REVOCATIONS**

**Items to be revoked from:**

**THE LEICESTERSHIRE COUNTY COUNCIL (VARIOUS ROADS, LOUGHBOROUGH (AREA 5),  
DISTRICT OF CHARNWOOD) CONSOLIDATION AND AMENDMENT ORDER 2009**

**Limited waiting 1 hour no return for 1 hour Mon-Sat 8am-6pm**

**Lansdowne Drive, Loughborough**

the north-east side Parking bay opposite Nos. 77 to 85 Lansdowne Drive

**Park Road, Loughborough**

the north-west side parking bay abutting shops opposite houses 234 to 240 (even nos.) inclusive

**No waiting at any time**

**Cumberland Road, Loughborough**

(i) the north-east side from its junction with Ashby Road in a north-westerly direction for a distance of 20 metres

(ii) the south-west side from its junction with Ashby Road in a north-westerly direction for a distance of 14 metres

**Jubilee Drive, Loughborough**

the north-east side from a point 65 metres south-east of its junction with Pavilion Way in a south-easterly direction for a distance of 9 metres

**King Street / New King Street, Loughborough**

(i) the north-west side from its junction with Leicester Road to its junction with Moira Street

(ii) the south-east side from its junction with Leicester Road in a north-easterly direction to its junction with Moor Lane

#### **Lansdowne Drive, Loughborough**

the north-east side from its junction with Park Road in a north-westerly direction for a distance of 119 metres

#### **New King Street, Loughborough**

(i) the north-west side from its junction with Moira Street in a north-easterly direction for a distance of 18 metres

(ii) the north-west side from its junction with Moor Lane in a south-westerly direction for a distance of 68 metres

#### **Rutland Street, Loughborough**

(i) the south-east side from a point 78 metres south-west of its junction with Moor Lane in a north-easterly direction for a distance of 18 metres

(ii) the south-east side from a point 78 metres south-west of its junction with Moor Lane in a south-westerly direction for a distance of 13.5 metres

#### **School Keep Clear (Mandatory)**

#### **Howard Street, Loughborough**

the north-east side from a point 26 metres south-east of the channel line of its junction with Charles Street in a south-easterly direction for a distance of 26 metres

#### **Items to be revoked from:**

**THE LEICESTERSHIRE COUNTY COUNCIL (VARIOUS ROADS, LOUGHBOROUGH (AREA 5), DISTRICT OF CHARNWOOD) ORDER 2011**

**No waiting at any time**

#### **Cattlemarket, Loughborough**

the east side from a point 1 metre south of its intersection with the southern kerbline of Mills Yard in a northerly direction to its intersection with the extended northern kerbline of Mills Yard

#### **Devonshire Lane (service Road), Loughborough**

the west side from a point 43 metres north of its junction with Devonshire Lane in a northerly direction to its junction with Devonshire Square

**Devonshire Square, Loughborough**

the west side from its junction with Devonshire Lane in a northerly direction for a distance of 2 metres

**Devonshire Square (service Road), Loughborough**

the east side from a point 27 metres north of its junction with Devonshire Lane in a northerly direction to its junction with Devonshire Square

**Items to be revoked from:**

**THE LEICESTERSHIRE COUNTY COUNCIL (LOUGHBOROUGH EASTERN GATEWAY (AREA 5), DISTRICT OF CHARNWOOD) ORDER 2011**

**No waiting at any time**

**Meadow Lane, Loughborough**

(i) the east side from its junction with Station Boulevard in a northerly direction to the northern side of the bridge crossing Summerpool Brook

(ii) the east side from its junction with Burder Street in a northerly direction to its junction with Station Boulevard

(iii) the east side from its junction with Ratcliffe Road in a northerly direction to its junction with Burder Street

(iv) the west side from its junction with North Road in a northerly direction to the northern side of the bridge crossing Summerpool Brook

(v) the west side from its junction with Belton Road in a northerly direction to its junction with Meadow Avenue

(vi) the west side from its junction with Meadow Avenue in a northerly direction to its junction with North Road



Items to be revoked from:

**THE LEICESTERSHIRE COUNTY COUNCIL (LOUGHBOROUGH EASTERN GATEWAY (AREA 5), DISTRICT OF CHARNWOOD) ORDER NO. 2 2012**

**No waiting at any time**

**Meadow Lane, Loughborough**

- (i) the east side from a point 70 metres south of its junction with Cartwright Street in a northerly direction to its junction with Ratcliffe Road
- (ii) the west side from a point opposite a point 77 metres south of its junction with Cartwright Street in a northerly direction to its junction with Belton Road

Items to be revoked from:

**THE LEICESTERSHIRE COUNTY COUNCIL (WEST LOUGHBOROUGH PARKING STRATEGY (AREA 5), DISTRICT OF CHARNWOOD) ORDER 2012**

**Disabled Persons Parking**

**Oxford Street, Loughborough**

the north-east side from a point 8 metres south-east of its junction with Havelock Street in a south-easterly direction for a distance of 6.6 metres

**Limited waiting 2 hours no return for 1 hour Mon-Sat 8am-6pm**

**Ashby Road, Loughborough**

the north side from a point 46 metres west of its junction with Storer Road in a westerly direction to a point 15 metres east of its junction with Cumberland Road

**Limited waiting 1 hour no return for 1 hour Mon-Sat 8am-6pm between 01 Oct and 31 May  
except resident's parking permit holders**

**Cumberland Road, Loughborough**

the north-east side from a point 7 metres south-east of its junction with Fearon Street in a south-easterly direction to a point 20 metres north-west of its junction with Ashby Road

**Hastings Street, Loughborough**

the north-west side from a point 7 metres south-west of its junction with Oxford Street in a south-westerly direction for a distance of 25.5 metres

**Oxford Street, Loughborough**

the north-east side from the boundary of Nos. 73/71 Oxford Street in a south-easterly direction to a point 6 metres north-west of its junction with Station Street

**Limited waiting 2 hours no return for 1 hour Mon-Sat 8am-6pm between 01 Oct and 31 May  
except resident's parking permit holders**

**Cumberland Road, Loughborough**

the south-west side from a point 14 metres north-west of its junction with Ashby Road in a north-westerly direction for a distance of 226 metres

**No waiting at any time**

**Ashby Road, Loughborough**

the north side from a point 20 metres west of its junction with Cumberland Road in an easterly direction to a point 15 metres east of its junction with Cumberland Road

**Oxford Street, Loughborough**

the north-east side from its junction with Havelock Street in a south-easterly direction for a distance of 8 metres

Items to be revoked from:

**THE LEICESTERSHIRE COUNTY COUNCIL (DISABLED PERSONS PARKING PLACES,  
LOUGHBOROUGH (AREA 5), DISTRICT OF CHARNWOOD) ORDER 2013**

**Disabled Persons Parking**

**Edward Street, Loughborough**

the south-east side from a point 1 metres south-west of the boundary of Nos. 23/25 Edward Street in a north-easterly direction for a distance of 6.6 metres

#### **Rendell Street, Loughborough**

the south-west side from the boundary of Nos. 14/16 Rendell Street in a north-westerly direction for a distance of 6.6 metres

**Limited waiting 1 hour no return for 1 hour Mon-Sat 8am-6pm except resident's parking permit holders**

#### **Burton Street, Loughborough**

the north-west side from a point 8 metres south-west of the boundary of Nos. 5/6 Burton Street in a south-westerly direction to a point 1 metre south-west of the boundary of Nos. 15/16 Burton Street

#### **Colgrove Road, Loughborough**

the south-west side from a point 17 metres north-east of its junction with Wallace Road in a north-easterly direction to a point 5 metres north-east of the boundary of Nos. 36/38 Colgrove Road

#### **Edward Street, Loughborough**

(i) the south-east side from a point 6 metres north-east of the boundary of Nos. 23/25 Edward Street in a north-easterly direction to a point 12 metres south-west of its junction with Lisle Street

(ii) the south-west side from a point 16 metres south-west of the boundary of No. 1 Edward Street / 133 Derby Road in a north-easterly direction to a point 1 metre south-west of the boundary of Nos. 23/25 Edward Street

#### **Rendell Street, Loughborough**

(i) the south-west side from a point 20 metres north-west of its junction with Meadow Lane in a north-westerly direction to the boundary of Nos. 14/16 Rendell Street

(ii) the south-west side from a point 6.6 metres north-west of the boundary of Nos. 14/16 Rendell Street in a north-westerly direction to a point 8 metres north-west of the north-western boundary of No. 58 Rendell Street

**No waiting at any time**

#### **Albert Street, Loughborough**

the south-west side from its junction with Bedford Street in a south-westerly direction to a point 16 metres north-west of the boundary of Nos. 3/Workshop building Bedford Street

#### **Beacon Road, Loughborough**

the north side from its junction with Epinal Way in a northerly direction to a point 15 metres south-west of the boundary of Nos. 109/111 Beacon Road

#### **Burton Street, Loughborough**

- (i) the north-west side from a point 7 metres south-west of the boundary of Nos. 4/3 Burton Street in a south-westerly direction to a point 8 metres south-west of the boundary of Nos. 5/6 Burton Street
- (ii) the north-west side from a point 1 metres south-west of the boundary of Nos 15/16 Burton Street in a south-westerly direction to a point 13 metres south-west of its junction with Gray Street

#### **Gray Street, Loughborough**

- (i) the north & west side from its junction with Burton Street in a northerly then easterly direction to its junction with Park Street
- (ii) the north-east & south-east side from its junction with Burton Street in a north-westerly direction for a distance of 10 metres
- (iii) the south-west side from its junction with Burton Street in a north-westerly direction for a distance of 32 metres

**No waiting Mon-Sat 8am-6pm**

#### **Beacon Road, Loughborough**

the north-west side from a point 15 metres south-west of the south-western boundary of No.111 Beacon Road in a north-easterly direction to a point opposite the boundary of Nos. 20/22 Beacon Road

### SCHEDULE 3

#### **No waiting at any time**

##### **Access From Ashby Road To Loughborough University, Loughborough**

both sides from its junction with Ashby Road in a south-easterly direction for the extent of the adopted highway

##### **Ashby Way (North-west bound carriageway), Loughborough**

both sides from its junction with Ashby Road in a south-easterly direction for the extent of the adopted highway.

##### **Ashby Way (slip Road From Ashby Road), Loughborough**

the south-east side from its junction with Ashby Road in a south-westerly direction to its junction with Ashby Way (South-east Bound Carriageway)

##### **Ashby Way (south-east Bound Carriageway), Loughborough**

both sides from its junction with Ashby Road in a south-easterly direction for the extent of the adopted highway.

##### **Beacon Road, Loughborough**

the north-west side from a point 19.5 metres south-west of its junction with Holt Drive in a north-easterly direction for a distance of 44.5 metres

##### **Holt Drive, Loughborough**

(i) the north-east side from its junction with Beacon Road in a north-easterly direction for a distance of 19 metres

(ii) the south-west side from its junction with Beacon Road in a north-easterly direction for a distance of 17 metres

##### **Old Ashby Road, Loughborough**

(i) the north side from its junction with Schofield Road in a westerly direction for a distance of 44 metres

(ii) the south side from its junction with Schofield Road in a westerly direction for a distance of 46 metres

### **Schofield Road, Loughborough**

the west side from a point 12 metres south of its junction with Old Ashby Road in a northerly direction to a point 12 metres north of its junction with Old Ashby Road

### **Spinney Hill Drive, Loughborough**

- (i) the north side from a point 104 metres north-west of its eastern junction with Holywell Drive in a westerly direction for a distance of 66 metres
- (ii) the south side from a point 103 metres north-west of its eastern junction with Holywell Drive in a westerly direction for a distance of 45 metres

### **EXEMPTIONS**

The following exemptions apply to the above. Refer to Schedule 1 for the details of each exemption:-

LCCA, LCCB, LCCC, LCCD, LCCE, LCCF, LCCG, LCCH, LCCI, LCCJ, LCCM, LCCN.

### **ANOMALLY IMPOSITIONS** **SCHEDULE 4 PART 1**

**Limited waiting**  
**1 hour no return for 1 hour Monday-Saturday 8.00am-6.00pm**

### **Lansdowne Drive, Loughborough**

the east side from a point 9 metres north of its junction with Park Road in a northerly direction for a distance of 26 metres

### **EXEMPTIONS**

The following exemptions apply to the above. Refer to Schedule 1 for the details of each exemption:-

LCCA, LCCB, LCCC, LCCD, LCCF, LCCG, LCCH, LCCM, LCCY.



## SCHEDULE 4 PART 2

**Limited waiting  
2 hours no return for 1 hour Monday-Saturday 8.00am-6.00pm**

### **Ashby Road, Loughborough**

the north side from a point 46 metres west of its junction with Storer Road in a westerly direction to a point 13.5 metres east of its junction with Cumberland Road

## EXEMPTIONS

The following exemptions apply to the above. Refer to Schedule 1 for the details of each exemption:-

LCCA, LCCB, LCCC, LCCD, LCCF, LCCG, LCCH, LCCM, LCCY.

## SCHEDULE 4 PART 3

**Limited waiting 1 hour no return for 1 hour  
Monday-Saturday 8.00am-6.00pm except resident's parking permit holders**

### **Burton Street, Loughborough**

the north-west side from a point 4 metres south-west of its junction with Park Street in a south-westerly direction to a point 14 metres north-east of its junction with Gray Street

### **Colgrove Road, Loughborough**

the south-east side from a point 17 metres north-east of its junction with Wallace Road in a north-easterly direction to a point 5 metres north-east of the boundary of Nos. 36/38 Colgrove Road

### **Edward Street, Loughborough**

the south-east side from a point 12 metres south-west of its junction with Lisle Street in a south-westerly direction to a point 14 metres north-east of its junction with Derby Road

### **Rendell Street, Loughborough**

the south-west side from a point 20 metres north-west of its junction with Meadow Lane in a north-westerly direction to a point 8 metres north-west of the north-western boundary of No. 58 Rendell Street

### **EXEMPTIONS**

The following exemptions apply to the above. Refer to Schedule 1 for the details of each exemption:-

LCCA, LCCB, LCCC, LCCD, LCCF, LCCG, LCCH, LCCM, LCCY.

### **SCHEDULE 4 PART 4**

**Limited waiting 1 hour no return for 1 hour  
Monday-Saturday 8.00am-6.00pm between 01 October  
and 31 May except resident's parking permit holders**

#### **Cumberland Road, Loughborough**

the north-east side from a point 7 metres east of its junction with Fearon Street in a south-easterly direction to a point 22 metres north-west of its junction with Ashby Road

#### **Oxford Street, Loughborough**

the north-east side from a point 7 metres south-east of its junction with Havelock Street in a south-easterly direction to a point 6 metres north-west of its junction with Station Street

### **EXEMPTIONS**

The following exemptions apply to the above. Refer to Schedule 1 for the details of each exemption:-

LCCA, LCCB, LCCC, LCCD, LCCF, LCCG, LCCH, LCCM, LCCY.

### **SCHEDULE 4 PART 5**

**Limited waiting 2 hours no return for 1 hour  
Monday-Saturday 8.00am-6.00pm between 01 October  
and 31 May except resident's parking permit holders**

### **Cumberland Road, Loughborough**

the south-west side from a point 18 metres north-west of its junction with Ashby Road in a north-westerly direction for a distance of 226 metres

#### **EXEMPTIONS**

The following exemptions apply to the above. Refer to Schedule 1 for the details of each exemption:-

LCCA, LCCB, LCCC, LCCD, LCCF, LCCG, LCCH, LCCM, LCCY.

#### **SCHEDULE 4 PART 6**

**No waiting at any time**

### **Meadow Lane, Loughborough**

- (i) the east side from a point 70 metres south of its junction with Cartwright Street in a northerly direction to a point 74 metres north of its junction with Station Boulevard
- (ii) the west side from opposite a point 77 metres south of its junction with Cartwright Street in a northerly direction to opposite a point 74 metres north of its junction with Station Boulevard

#### **EXEMPTIONS**

The following exemptions apply to the above. Refer to Schedule 1 for the details of each exemption:-

LCCA, LCCB, LCCC, LCCD, LCCG, LCCM.

**No waiting at any time**

### **Albert Street, Loughborough**

the south-west side from its junction with Bedford Street in a south-easterly direction to a point 16 metres north-west of the boundary of Nos. 3/ workshop building Bedford Street

#### **Ashby Road, Loughborough**

the north side from a point 20 metres west of its junction with Cumberland Road in an easterly direction to a point 13.5 metres east of its junction with Cumberland Road

#### **Beacon Road, Loughborough**

the north-west side from its junction with Epinal Way in a north-easterly direction to a point 28 metres south of the boundary of Nos. 109/111 Beacon Road

#### **Burton Street, Loughborough**

- (i) the north-west side from a point 6.5 metres north-east of its junction with Park Street in a south-westerly direction to a point 4 metres south-west of its junction with Park Street
- (ii) the north-west side from a point 14 metres north-east of its junction with Gray Street in a south-westerly direction to a point 13 metres south-west of its junction with Gray Street

#### **Cattlemarket, Loughborough**

the east side from the northern side of its junction with Mills Yard in a southerly direction for a distance of 7.5 metres

#### **Cumberland Road, Loughborough**

- (i) the north-east side from its junction with Ashby Road in a north-westerly direction for a distance of 22 metres
- (ii) the south-west side from its junction with Ashby Road in a north-westerly direction for a distance of 18 metres

#### **Devonshire Square, Loughborough**

the west side from its junction with Devonshire Lane in a northerly direction for a distance of 2 metres

#### **Devonshire Square (service Road), Loughborough**

- (i) the east side from a point 27 metres north of its junction with Devonshire Lane in a northerly direction to its junction with Devonshire Square

- (ii) the west side from a point 43 metres north of its junction with Devonshire Lane in a northerly direction to its junction with Cattlemarket

#### **Edward Street, Loughborough**

The south-east side from its junction with Derby Road in a north-easterly direction for a distance of 14 metres.

#### **Gray Street, Loughborough**

- (i) the north-east side from its junction with Burton Street in a north-westerly direction for a distance of 10 metres
- (ii) the south-west & north-west side from its junction with Burton Street in a north-westerly, then north-easterly direction to its junction with Park Street

#### **Jubilee Drive, Loughborough**

the north-east side from a point 65 metres south-east of its junction with Pavilion Way in a south-easterly direction for a distance of 25 metres

#### **King Street, Loughborough**

- (i) the north-west side from its junction with Moor Lane in a south-westerly direction for a distance of 68 metres
- (ii) the north-west side from its junction with Leicester Road in a north-easterly direction to a point 18 metres north-east of its junction with Moira Street
- (iii) the south-east side from its junction with Leicester Road in a north-easterly direction to its junction with Wharncliffe Road

#### **Lansdowne Drive, Loughborough**

- (i) the east side from its junction with Park Road in a northerly direction for a distance of 9 metres
- (ii) the north-east side from a point 35 metres north of its junction with Park Road in a north-westerly then northerly direction to its junction with Epinal Way

#### **Meadow Lane, Loughborough**

both sides from a point 74 metres north of its junction with Station Boulevard in a northerly direction to its northern side of the bridge crossing Summerpool Brook

**Oxford Street, Loughborough**

the north-east side from its junction with Havelock Street in a south-easterly direction for a distance of 7 metres

**Rutland Street, Loughborough**

the south-east side from its junction with Wellington Street in a north-easterly direction to its junction with Holland Close

**EXEMPTIONS**

The following exemptions apply to the above. Refer to Schedule 1 for the details of each exemption:-

LCCA, LCCB, LCCC, LCCD, LCCE, LCCF, LCCG, LCCH, LCCI, LCCJ, LCCM, LCCN.

**SCHEDULE 4 PART 7**

**No waiting  
Monday-Saturday 8.00am-6.00pm**

**Beacon Road, Loughborough**

the north-west side from a point 28 metres south of the boundary of Nos. 109/111 Beacon Road in a north-easterly direction to a point opposite the boundary of Nos. 20/22 Beacon Road

**EXEMPTIONS**

The following exemptions apply to the above. Refer to Schedule 1 for the details of each exemption:-

LCCA, LCCB, LCCC, LCCD, LCCE, LCCF, LCCG, LCCH, LCCI, LCCJ, LCCM, LCCN.

**SCHEDULE 4 PART 8**



**School Keep Clear (Mandatory)**  
**Monday-Friday 8.00am-5.00pm**

**Howard Street, Loughborough**

the north-east side from a point 26 metres south-east of its junction with Charles Street in a south-easterly direction for a distance of 26 metres

**EXEMPTIONS**

The following exemptions apply to the above. Refer to Schedule 1 for the details of each exemption:-

LCCB, LCCC, LCCG, LCCM.

**SCHEDULE 4 PART 9**

**Partial Footway Parking**  
**Resident Parking Permit Holders Only**

**Linden Road, Loughborough**

the south-west side from a point 6 metres south-east of the boundary of Nos. 30/32 Linden Road in a north-westerly direction for a distance of 24 metres

**EXEMPTIONS**

The following exemptions apply to the above. Refer to Schedule 1 for the details of each exemption:-

LCCA, LCCB, LCCC, LCCD, LCCF, LCCG, LCCH, LCCM, LCCY

THE COMMON SEAL of THE )  
LEICESTERSHIRE COUNTY COUNCIL )  
was hereunto affixed this thirty first day of )  
October 2014 in the presence of )

*AW Tamer*

Head of Legal Services





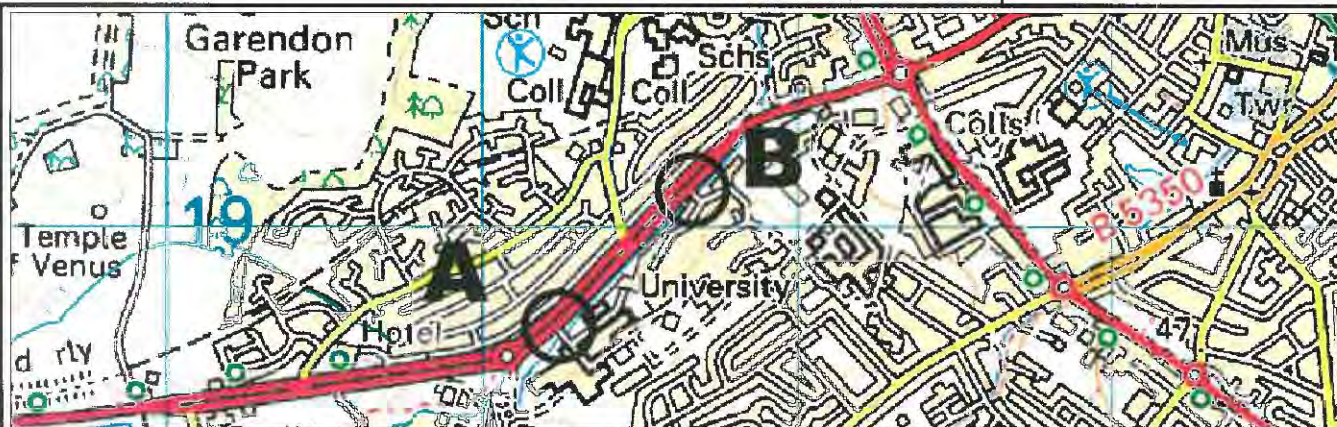

# **DISCLAIMER:**

OTHER RESTRICTIONS NOT SHOWN ON THIS PLAN ARE NOT PART OF THE PROPOSED SCHEME AND THEREFORE WILL NOT CHANGE

THIS PLAN IS FOR GRAPHICAL REPRESENTATION ONLY AND DOES NOT FORM PART OF THE FINAL LEGAL ORDER

Any highway boundaries shown on this plan are not definitive or legally binding. Highway boundaries shown only represent the Council's opinion of the highway extent against indicative Ordnance Survey features, based on any supporting information available at the time of verification.

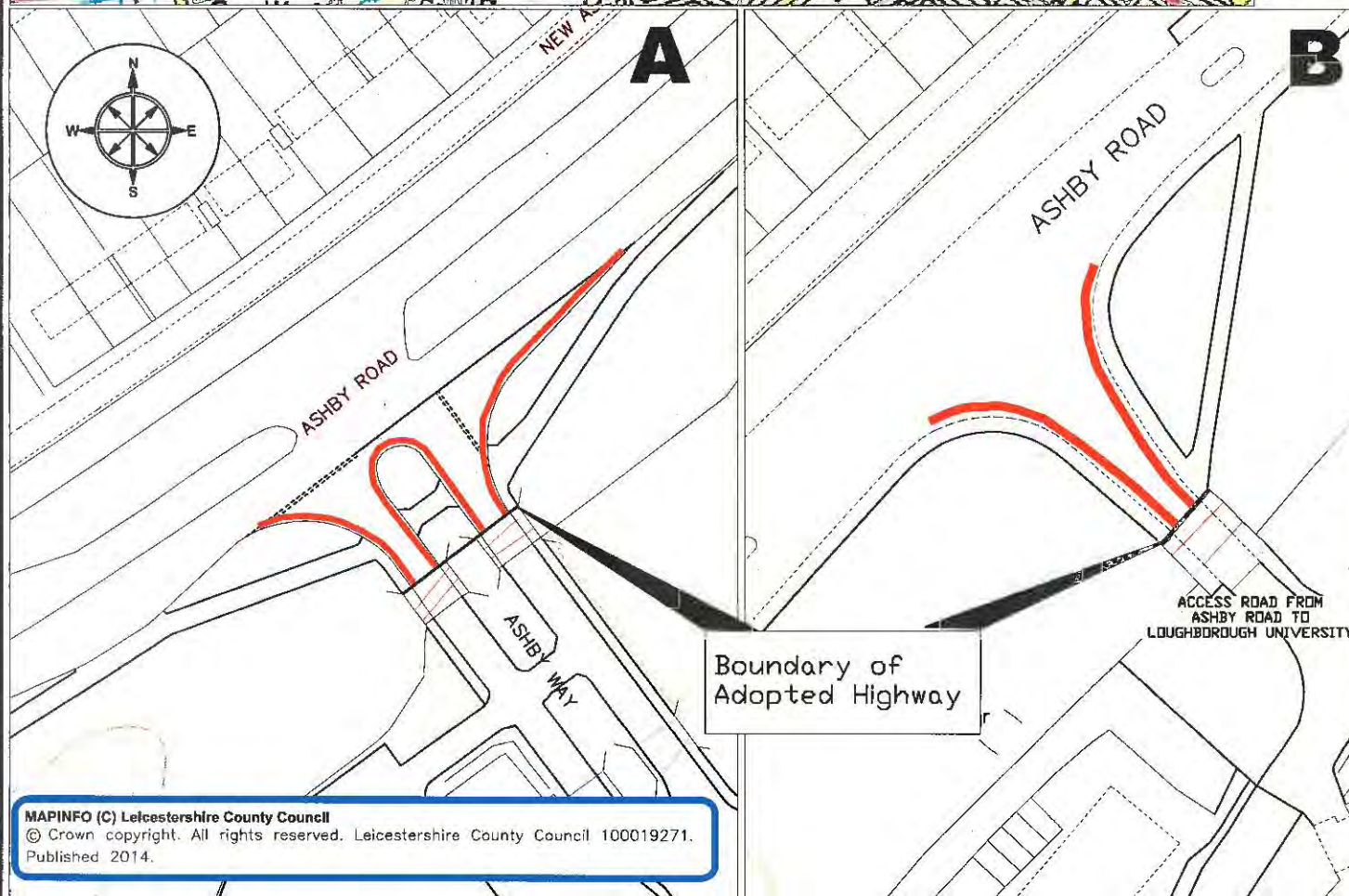

**ENVIRONMENT AND  
TRANSPORT DEPT**



DIRECTOR, PHIL CROSSLAND

**NO WAITING AT ANY TIME  
ASHBY ROAD,  
LOUGHBOROUGH**

**PROPOSED NO WAITING AT  
ANY TIME RESTRICTIONS**

MAPINFO (C) Leicestershire County Council  
© Crown copyright. All rights reserved. Leicestershire County Council 100019271.  
Published 2014.

DRAWING NUMBER	SCALE
TM4002	NTS
PREPARED BY: R.H.	DATE: April 2014
CHECKED BY: A.D.	SIZE: A4
COUNTY HALL * GLENFIELD * LEICESTER * LE3 8ST	
Tel: 0116 3050001 * Fax: 0116 3050006	
E-Mail address:	customerservices@lelcs.gov.uk www.lelcs.gov.uk



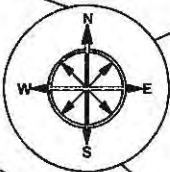

OLD ASHBY ROAD

SCHOFIELD ROAD

2

40

**DISCLAIMER:**  
OTHER RESTRICTIONS NOT SHOWN ON THIS PLAN ARE NOT PART OF THE PROPOSED SCHEME AND THEREFORE WILL NOT CHANGE  
  
THIS PLAN IS FOR GRAPHICAL REPRESENTATION ONLY AND DOES NOT FORM PART OF THE FINAL LEGAL ORDER

MAPINFO (C) Leicestershire County Council  
© Crown copyright. All rights reserved. Leicestershire County Council 100019271.  
Published 2014.



ENVIRONMENT AND  
TRANSPORT DEPARTMENT



TRAFFIC AND SAFETY

Existing No Waiting  
at any time to be  
formalised

NO WAITING AT ANY TIME

Old Ashby Road/Schofield Road  
Loughborough



DRAWING NUMBER		SCALE
TM4002/1		NTS
PREPARED BY:	RH	DATE: July 2012
CHECKED BY:	AD	SIZE: A4
COUNTY HALL * GLENFIELD * LEICESTER * LE3 8RJ		
Tel: 0116 2323232 * 0116 3050001 * Fax * 0116 3050006		
Email address: customerservices@leicsgov.uk		Website: www.leics.gov.uk



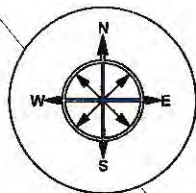

SPINNEY HILL DRIVE

23

Post

15

28

21

**DISCLAIMER:**

OTHER RESTRICTIONS NOT SHOWN ON THIS PLAN ARE NOT PART OF THE PROPOSED SCHEME AND THEREFORE WILL NOT CHANGE

THIS PLAN IS FOR GRAPHICAL REPRESENTATION ONLY AND DOES NOT FORM PART OF THE FINAL LEGAL ORDER

MAPINFO (C) Leicestershire County Council  
© Crown copyright. All rights reserved. Leicestershire County Council 100019271.  
Published 2014.

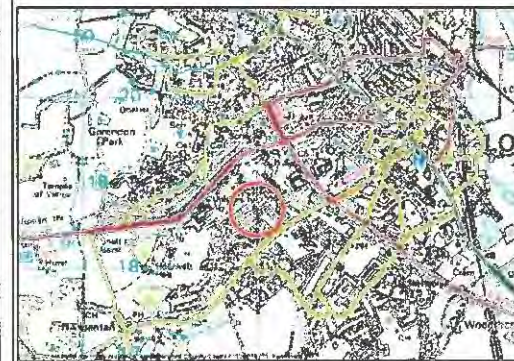

**Leicestershire  
County Council**

**ENVIRONMENT AND  
TRANSPORT DEPT**



INVESTOR IN PEOPLE

**TRAFFIC AND SAFETY**

Existing No Waiting  
at any time to be  
formalised

**NO WAITING AT ANY TIME**

TITLE:

**Spinney Hill Drive  
Loughborough**

DRAWING NUMBER

SCALE

**TM4002/2**

**NTS**

PREPARED BY: R H

DATE: July 2014

CHECKED BY: A D

SIZE: A4

COUNTY HALL \* GLENFIELD \* LEICESTER \* LE3 8ST

Tel: 0116 3050001 \* Fax: 0116 3050006

E-Mail address: [customerservices@lelcs.gov.uk](mailto:customerservices@lelcs.gov.uk) [www.lelcs.gov.uk](http://www.lelcs.gov.uk)





HOLT DRIVE

BEACON ROAD

7

219

213

2

221

**DISCLAIMER:**

OTHER RESTRICTIONS NOT SHOWN ON THIS PLAN ARE NOT PART OF THE PROPOSED SCHEME AND THEREFORE WILL NOT CHANGE

THIS PLAN IS FOR GRAPHICAL REPRESENTATION ONLY AND DOES NOT FORM PART OF THE FINAL LEGAL ORDER

MAPINFO (C) Leicestershire County Council

© Crown copyright. All rights reserved. Leicestershire County Council 100019271.  
Published 2014.

The Beacon



**Leicestershire  
County Council**

**ENVIRONMENT AND  
TRANSPORT DEPT**



INVESTOR IN PEOPLE

Existing No  
Waiting at any  
time to be  
formalised

TITLE:

**HOLT DRIVE / BEACON ROAD  
LOUGHBOROUGH**

DRAWING NUMBER

SCALE

**TM4002/3**

**NTS**

PREPARED BY: R.H.

DATE: July 2014

CHECKED BY: A.D.

SIZE: A4

COUNTY HALL \* GLENFIELD \* LEICESTER \* LE3 8ST

Tel: 0116 3050001 \* Fax: 0116 3050006

E-Mail address:

[customerservices@lelcs.gov.uk](mailto:customerservices@lelcs.gov.uk)

[www.lelcs.gov.uk](http://www.lelcs.gov.uk)