

THE LEICESTERSHIRE COUNTY COUNCIL
(A426 LEICESTER ROAD AND BLABY BYPASS, BLABY AND GLEN PARVA (AREA 2),
DISTRICT OF BLABY) ORDER NO. 1 2013

The Leicestershire County Council ("the Council") in exercise of its powers under Section 1(1) and 2(1) to (3) 4 (1) to (2) and Part IV of Schedule 9 of the Road Traffic Regulation Act 1984 ("the Act") and of all other enabling powers, hereby makes the following Order:-

1. This Order shall come into force on the Ninth day of December 2013 and be cited as "The Leicestershire County Council (A426 Leicester Road and Blaby Bypass, Blaby and Glen Parva (Area 2), District of Blaby) Order No. 1 2013".
2. The exemptions contained in this Order as set out in column 1 of Schedule 1 shall hereafter be referred to by reference to the code letters given in column 2 of Schedule 1.
3. (1) In this Order –

"authorised cab rank" means any area of carriageway which is comprised within and indicated by a road marking complying with diagram 1028.2 in Schedule 6 of The Traffic Signs Regulations and General Directions 2002;

"authorised parking place" means any parking place on a road authorised or designated by an Order made or having effect as if made under the Act;

"bus" means any Public Service Vehicle or bus operating a local stage carriage service as defined in the Transport Act 1985;

"bus stop area" means any area of carriageway on the sides of roads specified in this Order which is comprised within and indicated by a road marking complying with either diagram 1025.2 or diagram 1025.3 to the Traffic Signs Regulations and General Directions 2002;

"C.E.O." means a duly authorised Civil Enforcement Officer;

"disabled person's badge" has the same meaning as in The Disabled Persons (Badges for Motor Vehicles)(Amendment) Regulations 1991; or the Disabled Persons (Badges for Motor Vehicles)(England) Regulations 2000 and the Local Authorities' Traffic Orders (Exemptions for Disabled Persons)(England) Regulations 2000;

"disabled person's vehicle" has the same meaning as in The Local Authorities' Traffic Orders (Exemption for Disabled Persons)(England and Wales)(Amendment) Regulations 1991;

"disabled persons designated parking bay" means the part of the carriageway or side of road marked in accordance with Schedule 6 of the Traffic Signs Regulations and General Directions 2002 by the marking shown in diagram 1028.3 (or permitted variant thereof) and with a white broken line bounding the words "DISABLED" marked outside the bay;

"doctors' permit holders" means a vehicle which displays a valid permit issued to a Doctor for use in a specified location;

"footway parking area" means an area of the footway specifically designated for the purpose of waiting;

"hackney carriage" has the same meaning as in section 38(1) of the Vehicles (Excise) Act 1971;

"Loading" and "Unloading" means the collection or delivery of goods (parcels, stock and other items of that nature) to or from a vehicle where the goods cannot be reasonably collected or delivered except by the use of that vehicle in a particular length of road.

"market day" means any day of the week approved and authorised under a market charter for the holding of a market or such other bona fide licensed market;

"Market trader" means any person duly authorised an appropriate body to trade from an authorised market stall or stand or location as from time to time may be specified by the appropriate body for the purposes of his or her trading;

"motor vehicle" means any vehicle as defined by the Construction and Use Regulations 1986 (as amended) which is mechanically propelled except where otherwise provided;

"parking disc" means a disc, issued by a local authority, complying with the requirements of the British Standard Specification for Parking Discs (BS No.4631:1970) but coloured orange, and capable of showing the quarter hour period during which a period of waiting begins, or a blue badge under the Disabled Persons (Badges for Motor Vehicles)(England) Regulations 2000;

"permitted parking place" means any part of a road hereby authorised by the Council for use as a parking place, bay or space where vehicles may wait;

"permit" means a written warrant issued by or on behalf of Leicestershire County Council allowing the holder to wait in a specified location;

"permit holder" means a vehicle which displays a valid permit;

"residents' parking permit holder / residents' permit holder" means a vehicle which displays a valid permit issued to a resident of the specified location;

"road / roads" means the carriageway the footway and any verges being the full width of the highway extent from one boundary to another;

"school entrance" means any area of carriageway on the side of the road specified in Schedule 12 of this Order where vehicles are not permitted to stop and indicated by a road marking complying with diagram 1027.1 of the 2002 Regulations;

"vehicle" means any Motor Vehicle as defined in this Order and any other vehicle (capable of the carriage of persons or goods) except cycles unless otherwise provided;

"4.00 p.m. to 10.00 a.m. the following morning" wherever referred to in this Order means that period of time commencing at 4.00 p.m. in the afternoon of any day and terminating at 10.00 a.m. on the morning of the next day;

"The Act" means The Road Traffic Regulation Act 1984.

(2) For the purpose of this Order a vehicle shall be regarded as displaying a disabled person's badge in the relevant position, where in accordance with the Disabled Persons (Badges for Motor Vehicles) (Amendment) Regulations 1991 and the Disabled Persons (Badges for Motor Vehicles) (England) Regulations 2000

(i) the Badge is displayed on the vehicle's dashboard or fascia panel with the front of the Badge facing forward with the details thereon clearly visible from an external position, or

(ii) where the vehicle has no dashboard or fascia panel or windscreen where the Badge may be exhibited or displayed it shall be exhibited in a conspicuous position on the front or near side of the vehicle and

in either case a parking disc is exhibited in the relevant position prescribed in the Disabled Persons (Badges for Motor Vehicles) (Amendment) Regulations 1991 or the Disabled Persons (Badges for Motor Vehicles) (England) Regulations 2000.

(3) For the purposes of this Order and where any article permits, it shall not be unlawful to cause or permit a disabled person's vehicle which displays in the relevant position a disabled person's badge and a parking disc (on which the driver, or other person in charge of the vehicle, has marked the time at which the period of waiting began) to wait on the sides of roads referred to in the specific article, for a period not exceeding 3 hours unless otherwise stated (not being a period separated by an interval of less than one hour, unless otherwise stated, from a previous period of waiting by the same vehicle on the same side of road on the same day) provided that no such vehicle shall wait in any length of road where there is for the time being a prohibition of loading and unloading.

4 "The A426 Leicester Road and Blaby Bypass, Blaby and Glen Parva (Area 2), District of Blaby) Order 2013" and "The Leicestershire County Council (Various Roads, Blaby, Countesthorpe, Glen Parva and Whetstone (Area 2), District of Blaby), Consolidation and Amendment Order 2009" are hereby revoked in respect of those lengths of road as specified in Schedule 2 to this Order.

- 5.1 No person shall, except upon the direction or with the permission of a police officer in uniform, a community support officer, a parking attendant or a C.E.O., or in accordance with the exemption provisions, cause or permit any vehicle to wait at any time on any day for the purpose of enabling goods to be loaded or unloaded from the vehicle on the sides of road specified in Schedule 3 to this Order.
- 5.2 No person shall, except upon the direction or with the permission of a police officer in uniform, a community support officer, a parking attendant or a C.E.O., or in accordance with the exemption provisions, cause or permit any vehicle to wait between the hours of 7.30 a.m. and 9.30 a.m. and 4.30 p.m. and 6.30 p.m. on any day other than a Sunday, for the purpose of enabling goods to be loaded or unloaded from the vehicle on the sides of road specified in Schedule 4 to this Order.
- 5.3 No person shall, except upon the direction or with the permission of a police officer in uniform, a community support officer, a parking attendant or a C.E.O., or in accordance with the exemption provisions, cause or permit any vehicle to wait at any time on any day, on the sides of road specified in Schedule 5 to this Order.
6. Except where otherwise stated, a reference in this Order to a numbered Article or Schedule is reference to the Article or Schedule bearing that number in this Order.
7. The plan annexed to this Order and marked drawing number TM3991(1)/1A/2012 is for identification purposes only.

SCHEDULE 1

TYPE OF EXEMPTION	CODE
For vehicles to allow people to board or alight.	LCCA
For vehicles used in connection with:- (i) building, industrial or demolition operations; (ii) the removal of any obstruction to traffic; (iii) the maintenance, improvement or reconstruction of the said sides of roads; or (iv) the laying, erection, alternative or repair on, or in land adjacent to the said sides of roads of any sewer or of any main, pipe or apparatus for the supply of gas, water or electricity or of any telegraphic line as defined in the Telecommunications Act 1984.	LCCB
For vehicles to be used in the service of a local authority, highways agency, an area health authority or a water undertaker in pursuance of statutory powers or duties and whilst being so used in such service it is necessary for the vehicle to be positioned in the place where it is waiting.	LCCC
For vehicles to be used for the purpose of delivering or collecting postal packets as defined in section 87 of the Postal Services Act 2000 by any universal service provider.	LCCD
For vehicle to take in petrol, oil water or air from any garages situated on or adjacent to the said sides of roads	LCCE
For vehicles to wait at or near to any premises situated on or adjacent to the said sides of roads for so long as such waiting by that vehicle is reasonably necessary in connection with any wedding or funeral.	LCCF
For vehicles to be used for fire brigade, ambulance or police purposes.	LCCG
For goods to be loaded on or unloaded from the vehicle on the sides of roads specified in this Order.	LCCH
For Vehicles: (a) to wait upon an authorised parking place, (b) being a hackney carriage, to wait upon an authorised cab rank, or (c) licensed taxi.	LCCI
For a disabled person's vehicle which displays in the relevant position a disabled person's badge, and a parking disc (on which the driver, or other person in charge of the vehicle, has marked the time at which the period of waiting began) to wait on the sides of roads referred to in that Schedule for a period not exceeding three hours (not being a period separated by an	LCCJ

interval of less than one hour from a previous period of waiting by the same vehicle on the same side of road on the same day) provided that no such vehicle shall wait in any length of road where there is for the time being a prohibition of loading and unloading.	
For vehicles to wait on the sides of roads referred to therein for so long as may be necessary while any gate or other barrier at the entrance to premises to which the vehicle requires access or from which it has just emerged is being opened or closed, if it is not reasonably practicable for the vehicle to wait otherwise than in that road while such a gate or barrier is opened or closed.	LCKK
Any vehicle bona fide associated or used in connection with or for the purpose of licensed markets or special events.	LCCL
Where the person in control of the vehicle is directed or given permission to stop by a police officer, community support officer or a civil enforcement officer.	LCCM
To enable any motor vehicle that is constructed or adapted for the purpose of carrying monies or valuables under secure deposit and which is in use on a pre-arranged appointment for the delivery or collection of monies, financial instruments or valuables (for such a period of time as reasonably required to complete the delivery or collection) to any premises on the sides of road.	LCCN
The Article shall not prevent waiting by vehicles carrying children from and to school on normal school days	LCCO
Nothing shall render it unlawful for the owners or occupiers for the time being of the three properties No's 2, 4 and 6 Baines Lane, Hinckley to cause or permit any vehicle to wait in the length of road or side road specified in the Third Schedule to this Order for a period not exceeding 1 hour between the hours of 8.30am and 6.00pm (Monday to Saturday inclusive) and without limitation on Sundays.	LCCP
Nothing shall render it unlawful to cause or permit any vehicle to wait in connection with the maintenance or repair of any premises adjoining the roads which can only be carried out from the road being such works as are required to be carried out to comply with any statutory obligation condition or stipulation subject to such waiting being limited to a maximum of two hours in any period of 24 hours.	LCCQ
Nothing shall render it unlawful to cause or permit a public service vehicle to stop for a longer time than is necessary for taking up and setting down passengers at any time on any day on the east side of Melbourne Road fronting the coach depot occupying 211/213 Melbourne Road	LCCR

For any disabled person's vehicle which displays in the relevant position a disabled person's badge and a parking badge (on which the driver or other person in charge of the vehicle has marked the time at which waiting began) to wait, load or unload in those parts of the road specified in the schedule to this order for a period not exceeding 3 hours, with no return within 3 hours.	LCCS
If the vehicle is being used to attend any of the properties numbered 2-30 Mantle Lane, but for the purposes of loading/unloading of goods or equipment at such property only	LCCT
If the vehicle is an official wedding or funeral car attending any of the properties numbered 2 -30 Mantle Lane for the purpose of allowing passengers to board or alight.	LCCU
For any vehicle in excess of 7.5 tonnes loading or unloading on that part of Biggin Street between its junction with Fennel Street and a pint 35 metres north of its junction with Swan Street, such vehicle shall have entered Biggin Street from its junction with Fennel Street between the hours of 4.00p.m. to midnight and midnight to 10.00 a.m.	LCCV
Nothing shall render it unlawful to cause or permit any vehicle to wait on the triangular area or highway not comprising part of the main carriageway fronting Nos 9 and 19 Station Road, Hugglescote	LCCW
Nothing shall render it unlawful to cause any vehicle to enter Market Place if the vehicle is a vehicle- (a) in the service of a Police or Fire or Health or Local Authority and is being used for Police, Fire, Ambulance or Local Authority purposes as the case may be; being used by a resident of Market Place for the purpose of gaining access to his place of residence there.	LCCX
For a disabled person's vehicle which displays in the relevant position a disabled person's badge and a parking disc (on which the driver, or other person in charge of the vehicle, has marked the time at which the period of waiting began) to wait in the designated parking place.	LCCY

SCHEDULE 2
REVOCATIONS

THE LEICESTERSHIRE COUNTY COUNCIL
(VARIOUS ROADS, BLABY, COUNTSTHORPE, GLEN PARVA AND WHETSTONE (AREA2),
DISTRICT OF BLABY), CONSOLIDATION AND AMENDMENT ORDER 2009

NO WAITING AT ANY TIME

LEICESTER ROAD, GLEN PARVA

- (i) Both sides from its junction with New Bridge Road for a distance of 132 metres in a northerly direction.
- (ii) The east side from its junction with Grange Drive in a southerly direction from the centreline of Grange Drive for a distance of 52 metres.
- (iii) The east side from its junction with Grange Drive in a northerly direction from the centreline of Grange Drive for a distance of 11 metres.
- (iv) The west side from its junction with Grange Drive in a southerly direction from the centreline of Grange Drive for a distance of 43 metres.

THE LEICESTERSHIRE COUNTY COUNCIL
(A426 LEICESTER ROAD AND BLABY BYPASS, BLABY AND GLEN PARVA
(AREA 2), DISTRICT OF BLABY) ORDER 2013

In its entirety.

SCHEDULE 3

NO LOADING AT ANY TIME

LEICESTER ROAD, GLEN PARVA

- (i) The east side from a point 20 metres south of its junction with Woodbank in a northerly direction to a point 15 metres north of its junction with Woodbank.
- (ii) The west side from a point opposite a point 20 metres south of its junction with Woodbank in a northerly direction to the boundary of Nos. 72/74 Leicester Road.

WOODBANK, GLEN PARVA

- (i) The north side from a point opposite a point 3 metres west of the boundary of Nos. 1/3 Woodbank in a westerly direction to its junction with Leicester Road.
- (ii) The south side from a point 8 metres west of the boundary of Nos. 1/3 Woodbank in a westerly direction to its junction with Leicester Road.

EXEMPTIONS

The following exemptions apply to the above. Refer to Schedule 1 for the details of each exemption:-

LCCA, LCCB, LCCC, LCCD, LCCG, LCCM, LCCN.

SCHEDULE 4

**NO LOADING
MONDAY-SATURDAY 7.30 AM - 9.30 AM AND 4.30 PM - 6.30 PM**

LEICESTER ROAD, GLEN PARVA

- (iii) The east side from the boundary of Nos. 105/107 Leicester Road in a northerly direction to the Leicester City/County boundary.
- (iv) The east side from a point 15 metres north of its junction with Woodbank in a northerly direction to the boundary of Nos. 79/81 Leicester Road.
- (iii) The west side from the boundary of Nos. 72/74 Leicester Road in a northerly direction to a point opposite the boundary of Nos. 79/81 Leicester Road.
- (iv) The west side from the boundary of Nos. 138/140 Leicester Road in a northerly direction to the Leicester City/County boundary.

EXEMPTIONS

The following exemptions apply to the above. Refer to Schedule 1 for the details of each exemption:-

LCCA, LCCB, LCCC, LCCD, LCCG, LCCM, LCCN.

SCHEDULE 5

NO WAITING AT ANY TIME

LEICESTER ROAD, GLEN PARVA

- (i) The east side from a point 20 metres south of its junction with Woodbank in a northerly direction to the boundary of Nos. 79/81 Leicester Road.
- (ii) The east side from the boundary of Nos. 105/107 Leicester Road in a northerly direction to the Leicester City/County boundary.
- (iii) The west side from a point 51 metres south of the boundary of Nos. 72/74 Leicester Road in a northerly direction to a point opposite the boundary of Nos. 79/81 Leicester Road.
- (iv) The west side from the boundary of Nos. 138/140 Leicester Road in a northerly direction to the Leicester City/County boundary.

WOODBANK, GLEN PARVA

- (i) The north side from a point opposite a point 3 metres west of the property boundary of Nos. 1/3 Woodbank in a westerly direction to its junction with Leicester Road.
- (ii) The south side from a point 8 metres west of the property boundary of Nos. 1/3 Woodbank in a westerly direction to its junction with Leicester Road.

EXEMPTIONS

The following exemptions apply to the above. Refer to Schedule 1 for the details of each exemption:-

LCCA, LCCB, LCCC, LCCD, LCCG, LCCM, LCCN.

NO WAITING AT ANY TIME

DOROTHY AVENUE, GLEN PARVA

Both sides from a point 56 metres east of the boundary of Nos. 4/6 Dorothy Avenue in an easterly direction to its junction with Leicester Road.

GLENVILLE AVENUE, GLEN PARVA

Both sides from its junction with Leicester Road in a westerly direction for a distance of 22 metres.

HALL CLOSE, GLEN PARVA

Both sides from a point 23 metres east of the boundary of Nos. 1/3 Hall Close in an easterly direction to its junction with Leicester Road.

HILLSBOROUGH ROAD, GLEN PARVA

Both sides from a point 68 metres west of the boundary of Nos. 1/1a Hillsborough Road in a westerly direction to its junction with Leicester Road.

LEICESTER ROAD, GLEN PARVA

- (i) Both sides from its junction with New Bridge Road in a northerly direction to a point 20 metres south of its junction with Woodbank.
- (ii) The east side from the boundary of Nos. 79/81 Leicester Road in a northerly direction to the boundary of Nos. 105/107 Leicester Road.
- (iii) The west side from a point opposite the property boundary of 79/81 Leicester Road in a northerly direction to the boundary of Nos. 138/140 Leicester Road.

WEST VIEW AVENUE, GLEN PARVA

Both sides from a point 49 metres east of the boundary of Nos. 1/3 West View Avenue in an easterly direction to its junction with Leicester Road.

EXEMPTIONS

The following exemptions apply to the above. Refer to Schedule 1 for the details of each exemption:-

LCCA, LCCB, LCCC, LCCD, LCCF, LCCG, LCCH, LCCI, LCCJ, LCCM, LCCN.

THE COMMON SEAL of THE)
LEICESTERSHIRE COUNTY COUNCIL)
was hereunto affixed this 6th day of)
December 2013 in the presence of)

AW James

Head of Legal Services



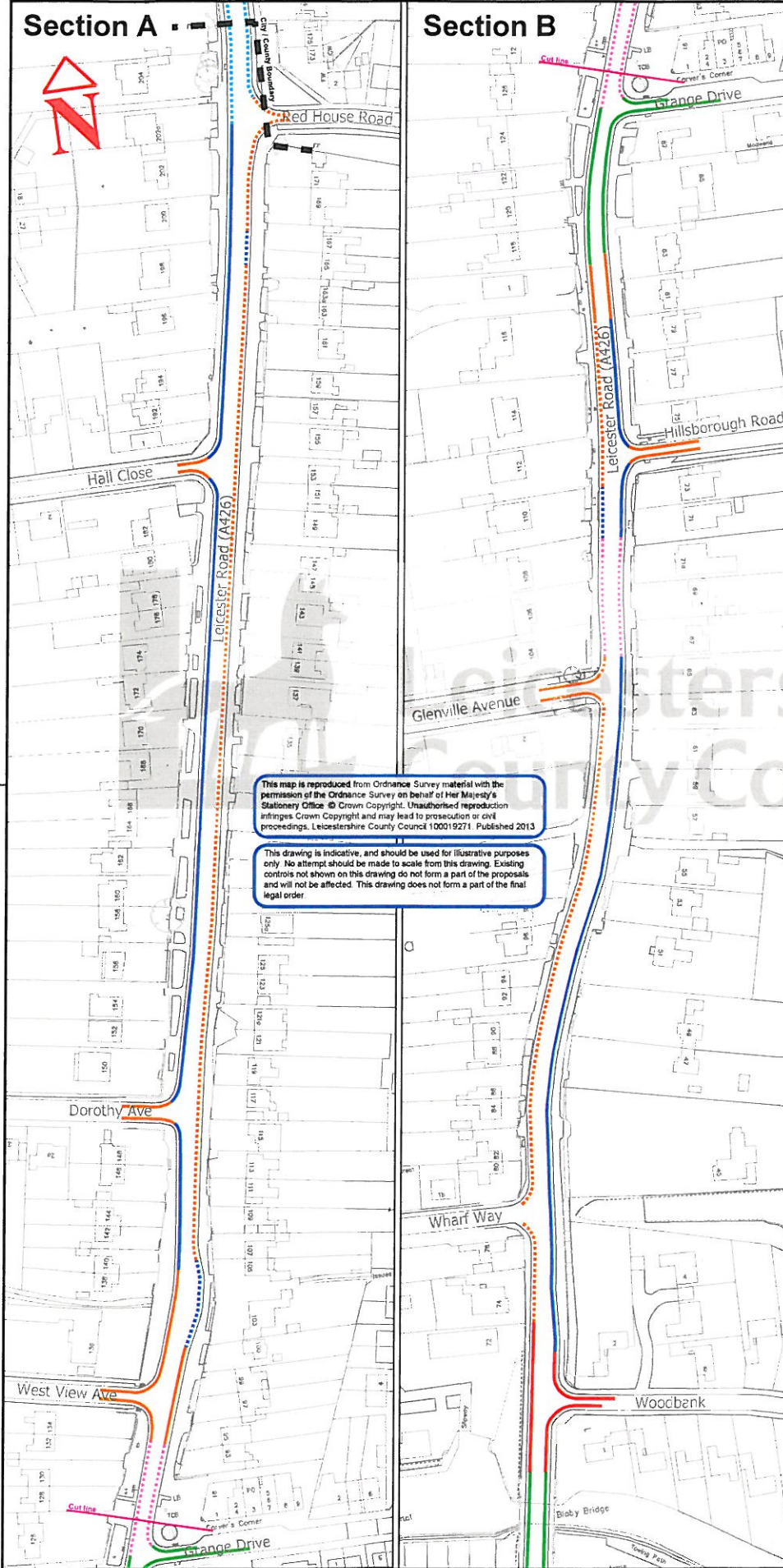

This map is reproduced from Ordnance Survey material with the permission of the Ordnance Survey on behalf of Her Majesty's Stationary Office © Crown Copyright. Unauthorised reproduction infringes Crown Copyright and may lead to prosecution or civil proceedings. Leicestershire County Council 100019271. Published 2013

This drawing is indicative, and should be used for illustrative purposes only. No attempt should be made to scale from this drawing. Existing controls not shown on this drawing do not form a part of the proposals and will not be affected. This drawing does not form a part of the final legal order.

KEY

- Proposed Bus Lane, 24 hrs
No waiting at any time and no loading Mon-Sat, 7.30am-9.30am & 4.30pm-6.30pm
- Proposed bus stop clearway, no stopping at any time except for buses
- Proposed double yellow lines (no waiting at any time) and no loading at any time
- Proposed double yellow lines (no waiting at any time) and no loading Mon-Sat, 7.30am-9.30am & 4.30pm - 6.30pm
- Proposed double yellow lines (no waiting at any time)
- Proposed toucan crossing. Area to be covered by zig zags (no stopping at any time)
- Existing double yellow lines to remain (no waiting at any time)
- Existing no stopping at any time (area controlled by signal crossing zig zags)

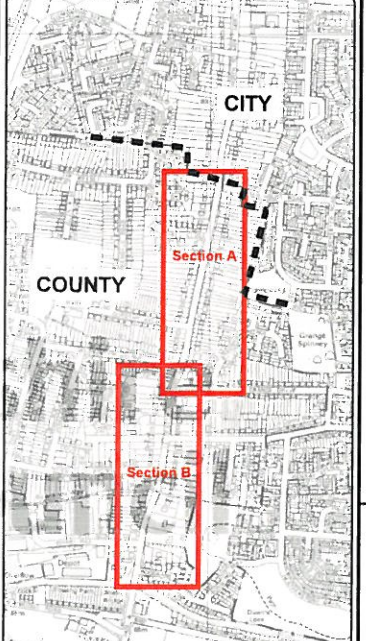

Drawing Control

MP	No loading throughout bus lane amended from at any time to peak hour (7.30am-9.30am & 4.30pm-6.30pm)	MP	HL 03.13	A
Author	Authorised	Signer	Doc	Per

Leicestershire County Council

ENVIRONMENT AND TRANSPORT DEPARTMENT

MATTHEW LUGG
DIRECTOR
B Eng., C. Eng., MICE, MCIHT, DMS

TRAFFIC & SAFETY GROUP

TRAFFIC MANAGEMENT

TITLE

**VARIOUS ROADS
GLEN PARVA
DISTRICT OF BLABY**

**A426 BUS LANE CORRIDOR
PROPOSED BUS LANE & PARKING CONTROLS**

DRAWING NUMBER	SCALE
TM3991(1)/1A/2012	NTS
PREPARED BY	DATE
M ARCHER	08 MARCH 2013
CHECKED BY	SIZE
M PALFREYMAN	A3
APPROVED BY	SECTION
M PALFREYMAN	TM
COUNTY HALL * GLENFIELD * LEICESTER * LE3 8RJ	
E Mail: tm3991@leics.gov.uk www.leics.gov.uk	