

**BLABY DISTRICT COUNCIL  
ROAD TRAFFIC REGULATION ACT 1984**

**Blaby District Council (Enderby Road & Johns Court, Weavers Court and Leicester Road Car Parks) (Electric Vehicle Charging Bays) Experimental Order 2021**

NOTICE is hereby given that Blaby District Council (“the Council”) made the above named Experimental Order on the 27th September 2021 under the relevant provisions of the Road Traffic Regulation Act 1984 as amended which comes into force on 4th October 2021 for a period not exceeding 18 months. The effect of the Order will be to change a provision of The District of Blaby (Off-Street Parking Places) Order 2019 by:

- Introducing a maximum three hour stay and associated restrictions within designated electric vehicle charging bays in the above named car parks.

A copy of the Experimental Order as made, a plan showing the car parks affected and a statement of the Council's reasons for making the Order may be seen online at [www.blaby.gov.uk](http://www.blaby.gov.uk) or by contacting [parking@blaby.gov.uk](mailto:parking@blaby.gov.uk)

The documents can also be viewed (by appointment only) at the Council Offices, Desford Road, Narborough, Leicestershire, LE19 2EP (Monday, Tuesday and Thursday 8:45-5:15, Wednesday 9:30-5:15 and Friday 8:45-4:45).

The Council will be considering in due course whether the provisions of the Experimental Order should be continued in force indefinitely. Any person wishing to object to such indefinite continuation of the provisions may within a period of six months from 27th September 2021, (or if this Order is varied by another Order or modified pursuant to section 10(2) of the Act, six months from the day on which the variation or modification or the latest variation or modification came into force) object in writing stating the grounds on which that objection is being made. Objections should be sent to the Environmental Health, Housing & Community Services Group Manager, Blaby District Council, Council Offices, Desford Road, Narborough, Leicestershire, LE19 2EP, or by e-mail to [parking@blaby.gov.uk](mailto:parking@blaby.gov.uk) no later than 27th March 2022.

Any person who wishes to question the validity of the Experimental Order or of any of its provisions on the grounds that it or they are not within the powers conferred by the Act, or that any requirements of the Act or of any instrument made under it have not been complied with may, within six weeks from the date on which the Order was made, apply to the High Court for that purpose.

Dated: 27th September 2021

Caroline Harbour, Environmental Health, Housing & Community Services Group Manager. Blaby District Council, Council Offices, Desford Road, Narborough, Leicestershire, LE19 2EP.

**BLABY DISTRICT COUNCIL  
ROAD TRAFFIC REGULATION ACT 1984**

**Blaby District Council (Enderby Road & Johns Court, Weavers Court and Leicester Road Car Parks) (Electric Vehicle Charging Bays) Experimental Order 2021**

**STATEMENT OF REASONS**

The proposed changes are being implemented to support the introduction of electric vehicle charging bays within our car parks, allowing residents and visitors to charge their vehicles where they may not have opportunity to elsewhere. The restrictions will prevent bay blocking and encourage turnover so that electric vehicle charging bays are available for all in Blaby District. The Council has recently made the commitment to carbon neutrality by 2030 and these changes will help achieve this. The temporary changes will be undertaken on an experimental basis for a maximum of 18 months. Impact of these changes will be monitored and assessed during this period and findings shared with key partners.

Dated: 27th September 2021

Caroline Harbour, Environmental Health, Housing & Community Services Group Manager. Blaby District Council, Council Offices, Desford Road, Narborough, Leicestershire, LE19 2EP.

**BLABY DISTRICT COUNCIL  
ROAD TRAFFIC REGULATION ACT 1984**

**Blaby District Council (Enderby Road & Johns Court, Weavers Court and Leicester Road Car Parks) (Electric Vehicle Charging Bays) Experimental Order 2021**

Blaby District Council in exercise of its powers under the Road Traffic Regulation Act 1984 ("the Act") as amended and of all other enabling powers and in accordance with Regulation 22 of the Local Authorities Traffic Orders (Procedure) (England and Wales) Regulations 1996 hereby makes the following Order:

1. Blaby District Council (Enderby Road & Johns Court, Weavers Court and Leicester Road Car Parks) (Electric Vehicle Charging Bays) Experimental Order 2021 and shall come into force on 4th October 2021.
2. The Council's Environmental Health, Housing & Community Services Group Manager is authorised to modify or suspend the operation of this Order or any provision of it in accordance with the provisions of section 10(2) of the Act.
3. The District of Blaby (Off-Street Parking Places) Order 2019 is amended as follows:

**SCHEDULE OF CHARGES SCHEDULE 1 AMENDMENTS:**

Name of car park	Controlled Hours	Charged Hours	Scale of Charges during Charged Hours
1	2	3	4
Enderby Road & Johns Court Car Park, Blaby	All days	8 am to 6 pm Monday – Saturday (inclusive) Including Bank Holidays	Up to 2 hours – 30p Up to 3 hours – 50p Up to 4 hours – £1.50 Over 4 hours – £5.00 Season Tickets – not available Residents Permits – £75 per annum subject to residence qualifications Maximum 3 hours stay within designated green electric vehicle charging bays Charges apply for electricity Return prohibited within 3 hours A ticket must be displayed for chargeable tariffs Electric vehicle charging point user must be plugged in at all times

Name of car park	Controlled Hours	Charged Hours	Scale of Charges during Charged Hours
1	2	3	4
Weavers Court Car Park, Narborough	All days	8 am to 6 pm Monday – Saturday (inclusive) Including Bank Holidays	Up to 2 hours – 30p Up to 3 hours – 50p Up to 4 hours – £1.50 Over 4 hours – £5.00 Season Tickets – not available Residents Permits – £75 per annum subject to residence qualifications Maximum 3 hours stay within designated green electric vehicle charging bays Charges apply for electricity Return prohibited within 3 hours A ticket must be displayed for chargeable tariffs Electric vehicle charging point user must be plugged in at all times
Leicester Road Car Park, Narborough	All days	8 am to 6 pm Monday – Saturday (inclusive) Including Bank Holidays	Up to 2 hours – 30p Up to 3 hours – 50p Up to 20 minutes – FREE in designated short stay parking bays Season Tickets – not available Residents Permits – £75 per annum subject to residence qualifications Maximum 3 hours stay within designated green electric vehicle charging bays Charges apply for electricity Return prohibited within 3 hours A ticket must be displayed for chargeable tariffs Electric vehicle charging point user must be plugged in at all times

**WEAVERS COURT CAR PARK, NARBOROUGH**

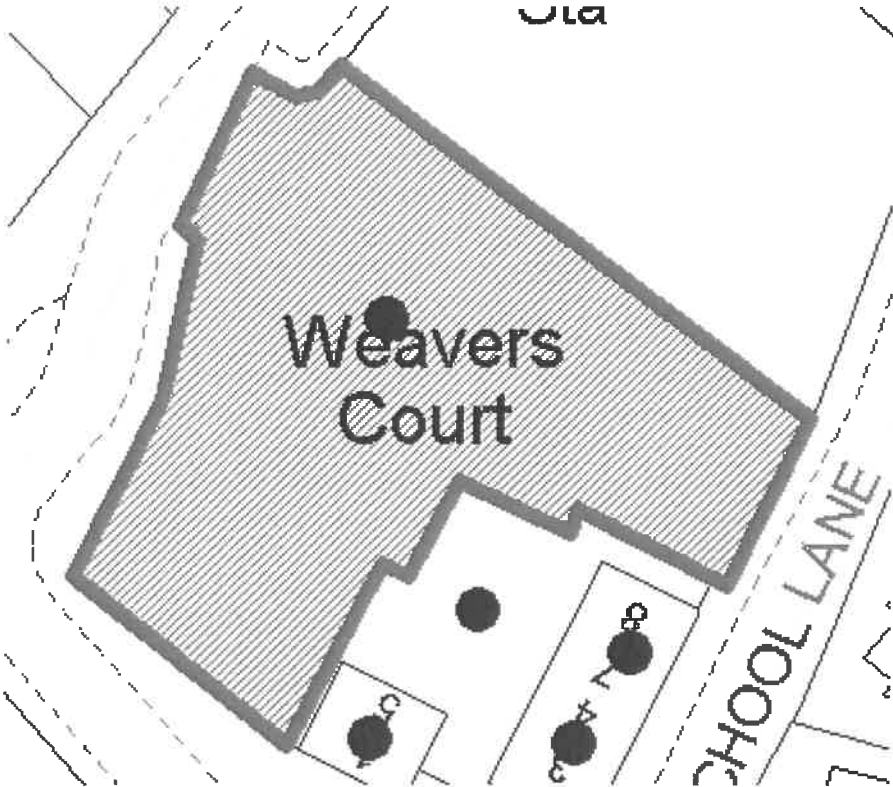

**LEICESTER ROAD CAR PARK, NARBOROUGH**

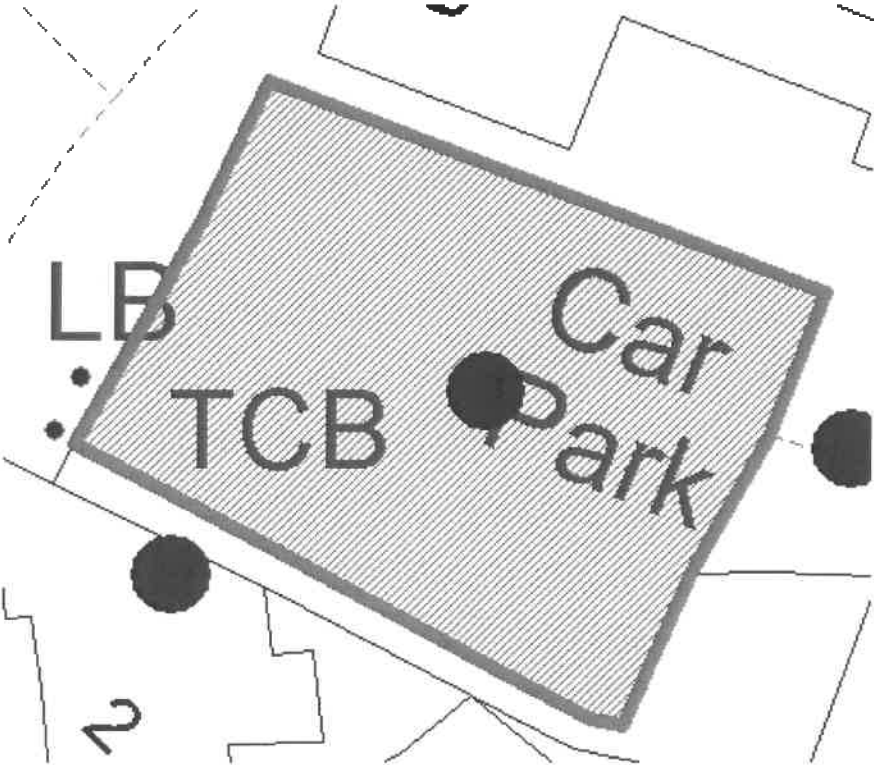



# ENDERBY ROAD & JOHNS COURT CAR PARK, BLABY

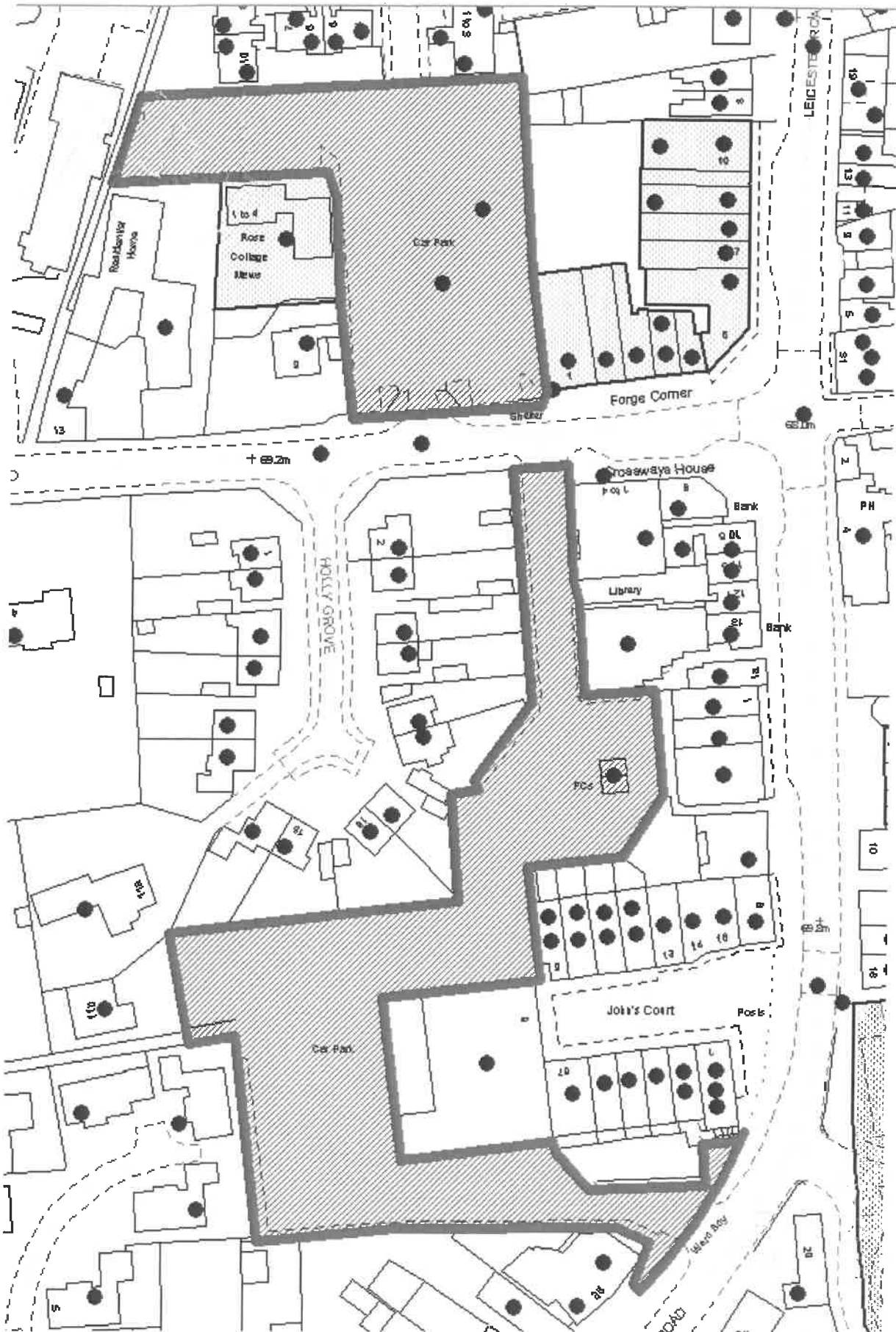

IN WITNESS whereof the Blaby District Council have caused the Common Seal to be hereunto affixed the 27th day of September 2021.

THE COMMON SEAL of the BLABY )  
DISTRICT COUNCIL was hereunto )  
affixed the day and year first before )  
written )

10036

