

THE NORFOLK COUNTY COUNCIL (BURNHAM MARKET, VARIOUS ROADS)
(20 M.P.H. SPEED LIMIT) ORDER 2015

The Norfolk County Council in exercise of its powers under Section 84 and 122 and parts III and IV of Schedule 9 of the Road Traffic Regulation Act 1984 (hereinafter referred to as "the Act"), having given public notice in accordance with sub-section (2) of that section and having consulted the Chief Officer of Police in accordance with paragraph 20 of Part III of Schedule 9 to the Act, hereby makes the following Order:

1. No person shall cause or permit any vehicle to proceed at a speed exceeding 20 miles per hour along the lengths of road specified in the Schedule to this Order.
2. No speed limit imposed by this order applies to vehicles falling within regulation 3(4) of the Road Traffic Exemptions (Special Forces)(Variation and Amendment) Regulations 2011 when used in accordance with Regulation 3(5) of those Regulations.
3. This Order shall come into force on the 30th day of October 2015 and may be cited as the Norfolk County Council (Burnham Market, Various Roads)(20 m.p.h. Speed Limit) Order 2015.
4. Insofar as any provision of this Order conflicts with any provision of any previous Order relating to the lengths of road specified in the Schedule to this Order, that provision of this Order shall prevail.

SCHEDULE

In the Parish of Burnham Market

20 m.p.h. Speed Limit

- | | |
|----------------------|-----------------------------------------------------------------------------------------------------------------------------------|
| B1355 Bellamy's Lane | - From its junction with the B1155 North Street northwards for a distance of 70 metres |
| B1155 Church Walk | - From its junction with the U22349 Market Place south-westwards for a distance of 85 metres |
| B1355 Creake Road | - From its junction with the B1155 Ulph Place southwards to a point 60 metres south of its junction with the C97 Joan Shorts Lane |
| B1155 Front Street | - For its entire length |
| U22165 Herrings Lane | - From its junction with the U22349 Market Place northwards for a distance of 54 metres |
| B1155 Market Place | - For its entire length |

- U22349 Market Place - For its entire length
- U22186 Market Place - For its entire length
- B1155 North Street - For its entire length
- B1155 Overy Road - From its junction with the B1155 North Street north-eastwards to a point 101 metres south-west of its junction with the U22169 Joan Shorts Lane
- U22165 Station Road - From its junction with the B1155 Church Walk to its junction with the B1355 Creake Road
- B1155 Ulph Place - For its entire length

Dated this 19th day of October 2015

The COMMON SEAL of the)
 NORFOLK COUNTY COUNCIL)
 was hereunto affixed in the)
 presence of:-)



Head of Law

FK/SMC/BurnhamMarket20mph

authorised to sign
 on behalf of: HEAD OF LAW

89990

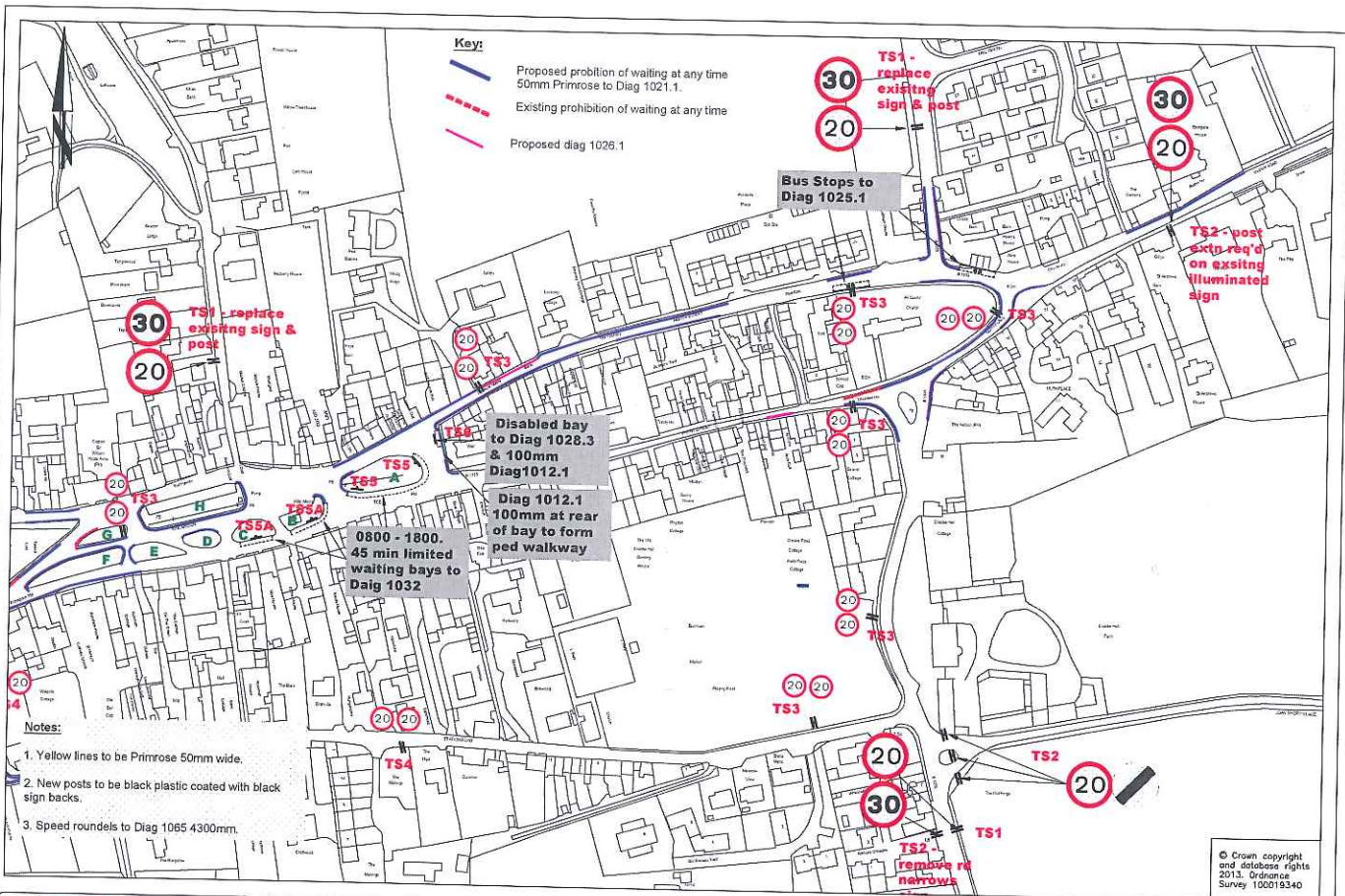

- Notes:**
1. Yellow lines to be Primrose 50mm wide.
 2. New posts to be black plastic coated with black sign backs.
 3. Speed roundels to Diag 1065 4300mm.

© Crown copyright and database rights 2013. Ordnance Survey 100019340

Norfolk County Council
working with
MAY CURRY

Mike Jackson
Director of Environment, Transport and Development
Norfolk County Council
County Hall
Marshwood Lane
Norwich NR1 2SG

DRAWING TITLE
BURNHAM MARKET
WAITING RESTRICTIONS & 20MPH SPEED LIMIT
IMPLEMENTATION EAST END

REV.	DESCRIPTION	CHECKED	DATE
	BURNHAM MARKET IMPLEMENTATION PLAN		

INITIALS	DATE	DRAWING No.
SURVEYED BY: GC	03/13	
DESIGNED BY: PR	03/13	
DRAWN BY: PR	03/13	
CHECKED BY: PR	03/13	



Handwritten signature in blue ink

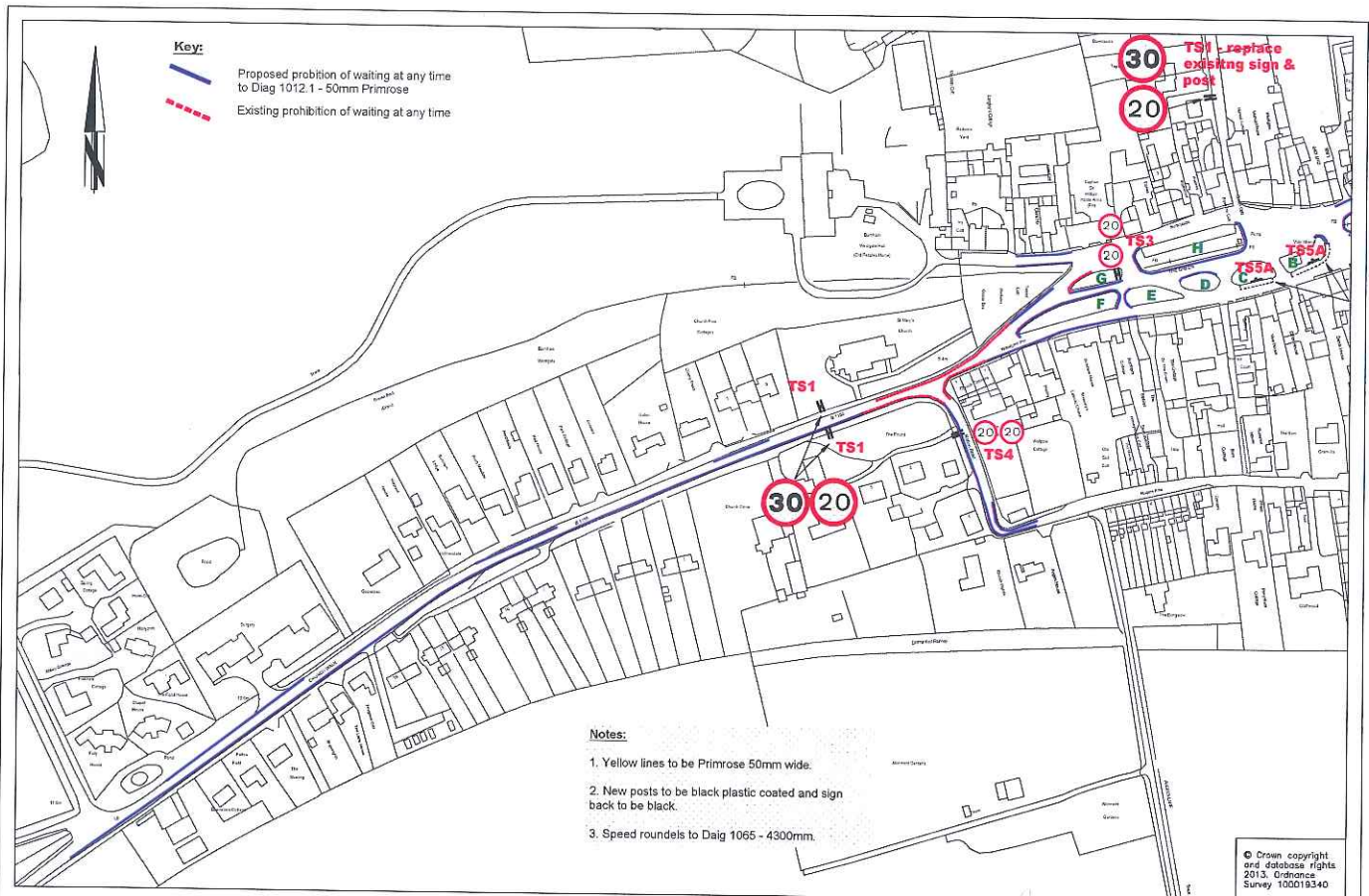

authorised to sign
on behalf of: HEAD OF LAW

39990



Key:
 Proposed prohibition of waiting at any time to Diag 1012.1 - 50mm Primrose
 Existing prohibition of waiting at any time

- Notes:**
1. Yellow lines to be Primrose 50mm wide.
 2. New posts to be black plastic coated and sign back to be black.
 3. Speed roundels to Diag 1065 - 4300mm.

© Crown copyright and database rights 2013. Ordnance Survey 100019340

Norfolk County Council
 working with
 

Mike Jackson
 Director of Environment, Transport and Development
 Norfolk County Council
 County Hall
 Martineau Lane
 Norwich NR1 2BG

DRAWING TITLE
 BURNHAM MARKET IMPLEMENTATION
 WAITING RESTRICTIONS & 20 MPH SPEED LIMIT
 WESTERN END

REV.	DESCRIPTION	CHECKED	DATE

SURVEYED BY	INITIALS	DATE	DRAWING NO.
CS	CS	02/13	3945-HP-000W
DESIGNED BY	INITIALS	DATE	PROJECT TITLE
PR	PR	02/13	BURNHAM MARKET
DRAWN BY	INITIALS	DATE	WAITING RESTRICTIONS
PR	PR	02/13	
CHECKED BY	INITIALS	DATE	SCALE
			1:1
			FILE NO.



authorised to sign
 on behalf of: HEAD OF LAW



39990