

HERTFORDSHIRE COUNTY COUNCIL
ROAD TRAFFIC REGULATION ACT 1984

Date of Order: 18 February 2009
Order No: 7327

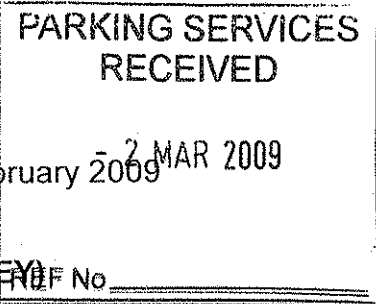

THE HERTFORDSHIRE (VARIOUS ROADS, BUSHEY)
(RESTRICTION OF WAITING) ORDER 2008

The Hertfordshire County Council in exercise of their powers under Sections 1, 2 and 3 of the Road Traffic Regulation Act 1984 (which said Act of 1984 is hereinafter referred to as "the Act of 1984"), and Part IV of Schedule 9 of the Act of 1984 and of all other enabling powers and after consultation with the Chief Officer of Police in accordance with Part III of Schedule 9 of the Act of 1984, hereby make the following Order:-

1. This Order may be cited as "The Hertfordshire (Various Roads, Bushey) (Restriction of Waiting) Order 2008" and shall come into operation on Monday 2 March 2009.
2. Save as provided in Article 3, 4 and 5 of this Order no person shall cause or permit any vehicle to wait at any time in those lengths of road in Bushey as specified in the Schedule to this Order.
3. (1) Nothing in Article 2 of this Order applies to the lengths of road restricted by that Article (which said lengths of road are referred to in this Article as "the restricted area") in relation to –
 - (a) a vehicle being used for Fire and Rescue, Ambulance or Police purposes.
 - (b) anything done with the permission of or at the direction of –
 - (i) a police officer in uniform;
 - (ii) a Civil Enforcement Officer as defined by the Traffic Management Act 2004 and appointed by Hertsmere Borough Council.
 - (c) a vehicle which is prevented from proceeding by circumstances beyond the drivers control or which has stopped in order to avoid injury or damage to persons or property or when required to do so by law;
 - (d) a vehicle which is stationary in order that it may be used for one or more of the purposes specified in sub-Article (2) of this Article and which cannot reasonably be used for such a purpose without stopping in the restricted area;
 - (e) a marked vehicle which, whilst used by a universal service provider in the course of the provision of a universal postal service, is stationary only for so long as may be reasonably necessary for postal packets to be delivered or collected;

In this Article -

The expressions "universal service provider", "provision of a universal postal Service" and "postal packet" shall bear the same meanings as in the Postal Services Act 2000.

- (2) The "purposes" referred to in sub-Article (1)(d) of this Article are –
 - (a) any operation involving building, demolition or excavation;
 - (b) the removal of any obstruction to traffic;
 - (c) the maintenance, improvement or reconstruction of a road;
 - (d) constructing, improving, maintaining, or cleaning of any street furniture; or
 - (e) the laying, erection, alteration, repair or cleaning of any sewer or of any main pipe or apparatus for the supply of gas, water or electricity, or of any telecommunications apparatus kept or installed for the purposes of a

telecommunications code system or of any other telecommunications apparatus lawfully kept installed in any position.

4. Nothing in Article 2 of this Order applies to the lengths of road restricted by that Article (which said lengths of road are referred to in this Article as "the restricted area") so as to render it unlawful to cause or permit any vehicle to wait only for so long as may be reasonably necessary –
 - (a) to enable goods to be loaded on or unloaded from the vehicle from or to premises adjacent to the restricted area; or
 - (b) to enable a passenger to board or alight and to load and unload any luggage.
5. (1) Nothing in Article 2 of this Order shall render it unlawful to cause or permit a disabled person's vehicle which displays in the relevant position a disabled person's badge and a parking disc, to wait at any time in the lengths of road specified in the Schedule of this Order for a period not exceeding 3 hours (not being a period separated by an interval of less than 1 hour from a previous period of waiting by the same vehicle in the same length of road).
 - (2) In this Article –

"disabled person's vehicle" has the same meaning as in Section 142(1) of the Act of 1984;

"disabled person's badge" has the same meaning as given in Regulation 3(1) of The Local Authorities' Traffic Orders (Exemptions for Disabled Persons) (England) Regulations 2000

"parking disc" has the same meaning as given in Regulation 8(5) of The Local Authorities' Traffic Orders (Exemptions for Disabled Persons) (England) Regulations 2000; and

"relevant position" has the same meaning as given in Regulation 4 of The Local Authorities' Traffic Orders (Exemptions for Disabled Persons) (England) Regulations 2000
6. The Interpretation Act 1978 shall apply for the interpretation of this Order as it applies for the interpretation of an Act of Parliament.
7. The provisions of the following Order are hereby revoked only in so far as they are affected by the restrictions imposed by this Order:

The Borough of Hertsmere (Control of Parking) (Consolidation) Order 2007.
8. The restrictions imposed by this Order shall be in addition to and not in derogation from any restriction or requirement imposed by any other regulations made or having effect as if made under the Act of 1984 or by or under any other enactment.

SCHEDULE

lengths of roads in Bushey – no waiting at any time

- | | |
|---|--|
| A411 High Street
(north east side) | (a) from its junction with the north west kerbline of Steeplands north westwards for 6 metres. |
| | (b) from its junction with the south east kerbline of Steeplands south eastwards for 3.5 metres. |
| Steeplands
(north & south west
sides) | from its junction with the north east kerbline of A411 High Street south east and north westwards for 14.5 metres. |

(south east & south west sides)	from its junction with the north east kerbline of A411 High Street north east and south eastwards for 15 metres.
A411 Sparrows Herne (north east side)	(a) from its junction with the north west kerbline of Claybury north westwards for 3 metres. (b) from its junction with the south east kerbline of Claybury south eastwards for 4.5 metres.
Claybury/Steeplands (north west & south west sides)	from its junction with the north east kerbline of A411 Sparrows Herne north east and north westwards into Steeplands for approximately 29 metres to a point 11 metres east of the south east boundary of 1 Claybury.
Claybury (south east & south west sides)	from its junction with the north east kerbline of A411 Sparrows Herne north east and south eastwards for 25 metres.
Brooke Close (north east & south west sides)	(a) from its junction with the north east kerbline of A411 Sparrows Herne north west, north east and south eastwards for 19 metres. (b) from its junction with the north east kerbline of A411 Sparrows Herne north east and north westwards for 16 metres.
A411 Elstree Road (north west side)	(a) from its junction with the north east kerbline of Richfield Road north eastwards for 3 metres. (b) from its junction with the south west kerbline of Richfield Road south westwards for 5 metres.
A411 Elstree Road (south side)	from a point 46 metres east of a point in line with the east boundary of 174 Sparrows Herne eastwards for approximately 56 metres to a point 51 metres south west of a point in line with the south west kerbline of Richfield Road.
Richfield Road (north east & south east sides)	from its junction with the north west kerbline of A411 Elstree Road north west and north eastwards for 17 metres.
(south west & south east sides)	from its junction with the north west kerbline of A411 Elstree Road north west, south west and westwards for approximately 94.5 metres to a point 13 metres north west of a point in line with the south west boundary of 12 Richfield Road.
Coldharbour Lane (north west side)	from a point 15 metres north east of a point in line with the north east boundary of 28 Coldharbour Lane south westwards for approximately 144 metres to a point 4 metres west of a point in line with the north west kerbline of Bridgewater Way.
(south east side)	(a) from its junction with the north east kerbline of King George Avenue north eastwards for approximately 87 metres to a point 5 metres north east of a point in line with the boundary between 3c and 5 Coldharbour Lane. (b) from its junction with the south west kerbline of King George Avenue south westwards for approximately 50 metres to its junction with the north east kerbline of Bridgewater Way.
Bridgewater Way (east side)	from its junction with the south west kerbline of Coldharbour Lane south westwards for 8 metres.

Moatfield Road
(south west side)

from a point in line with the south east boundary of 66-70
Moatfield Road south eastwards for 23 metres.

IN WITNESS whereof the Common Seal of the Hertfordshire County Council was
hereunto affixed this 18th day of February 2009.

The Common Seal of)
Hertfordshire County Council)
was hereunto affixed)
in the presence of)

ANDREW L LAYCOCK

County Secretary

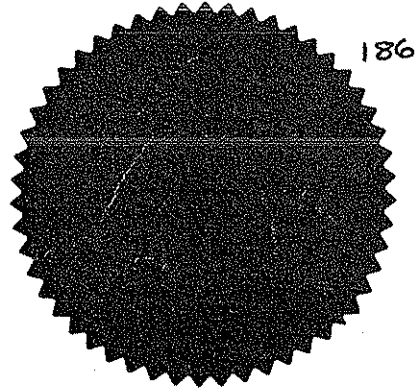



At Original Drawing Size This Line Measures 100mm
 Original Drawing Size A4

Based upon the Ordnance Survey National Grid Reference Scheme (OSGRS) the coordinates of the corners of the site are as follows:
 Down copyright.
 Authorised reproduction requires the written permission of Hertfordshire County Council. 00019805 2008

 <p>Hertfordshire Highways Highways Branch 41-45 Broadwater Road Stevenage City SG1 3EP Tel: 01707 356200 Fax: 01707 356300</p>		Rev. C
<p>Project No. M1749734/003/007</p>		<p>Project Title Hertsmere Double Yellow Lines</p>
<p>Project No. 749734/003</p>		<p>Drawing Title King George Avenue & Coldharbour Lane, Bushey</p>
<p>CD AW</p>	<p>Down AW</p>	<p>Checked/Approved LL</p>
<p>Initials Date</p>	<p>AW 6/2/08</p>	<p>LL 6/2/08</p>
<p>Scale 1 of 1</p>		<p>Scale 1:1000</p>
<p>Key Proposed double yellow lines</p>		<p>Notes</p>

This Drawing is the copyright of Hertfordshire County Council and Must Not be Reproduced Without Written Permission

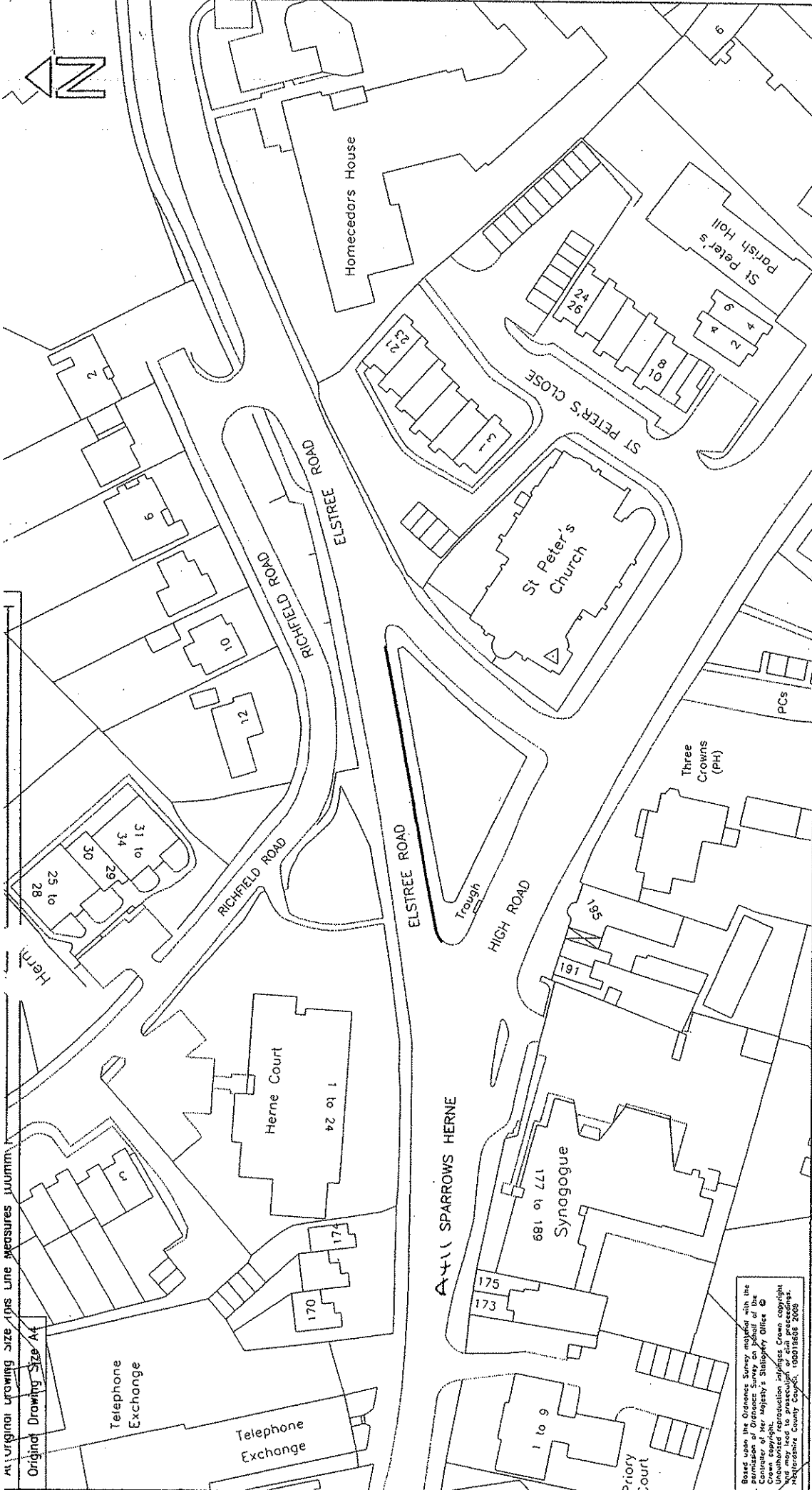

At original drawing size this line measures 100mm.
Original Drawing Size A4

Based upon Ordnance Survey maps, with the permission of the Controller of Her Majesty's Stationery Office. Crown copyright. All rights reserved. No part of this publication may be reproduced without the prior written permission of Hertfordshire County Council, 100018666 2009

Notes	Joins with existing double yellow lines at both ends.		
	Key Proposed double yellow lines		
Project No.	749734/003	Org. No.	M1749734/003/006
Rev.	C	Project Title	Hertsmere Double Yellow Lines
Scale	1:1000	Drawing Title	Elstree Road, Bushey
Drawn	AW	Checked	AW
Approved	AW	Approved	AW
Initials	AW	Date	25/10/07
Sht. No.	1 of 1	Scale	1:1000

Hertfordshire Highways
 Highway House
 11-15 Broadwater Road
 Watlington, Watlington City
 MK7 3SP
 Tel: 01707 356200
 Fax: 01707 356390

This Drawing is the copyright of Hertfordshire County Council and must not be reproduced without written permission

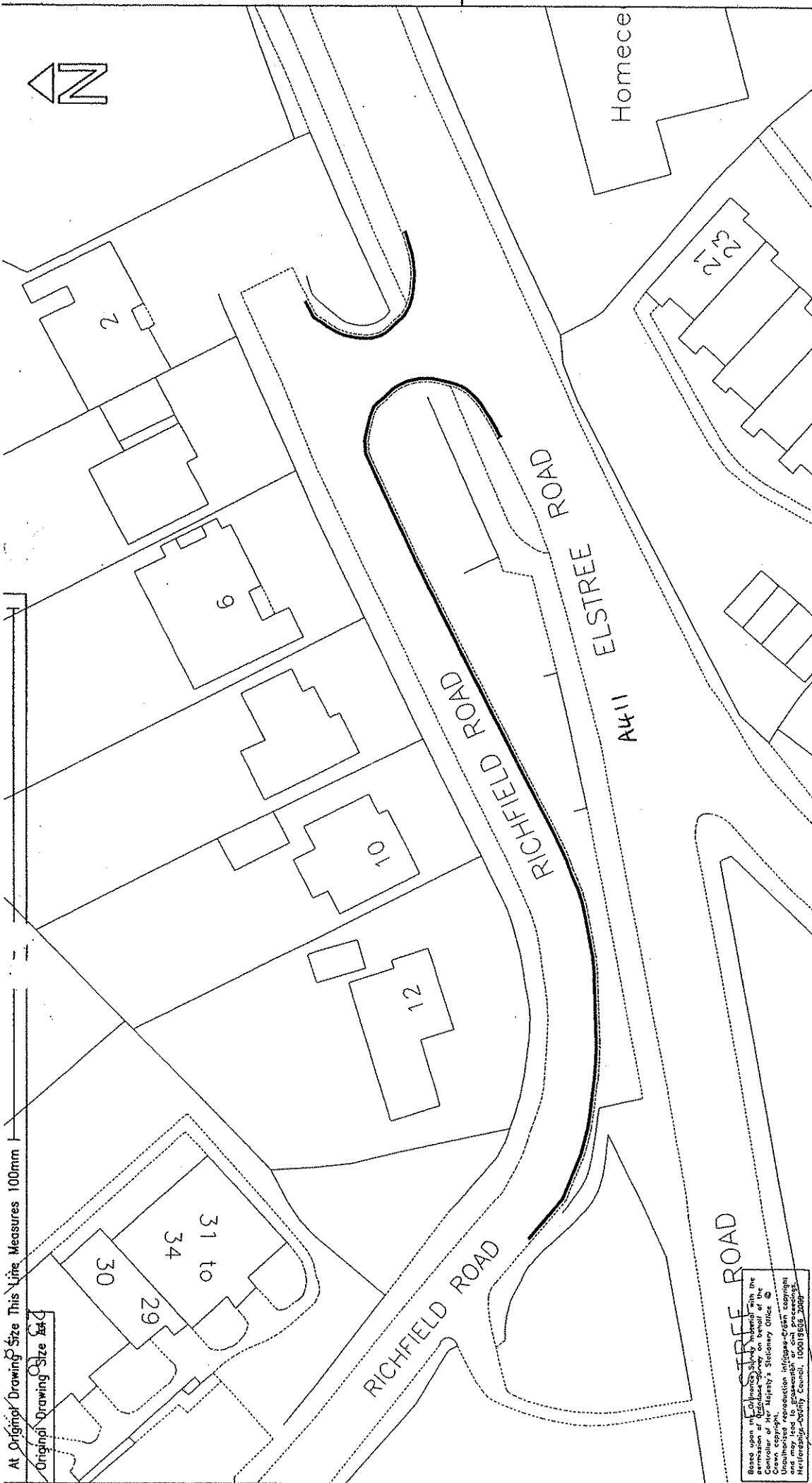

At Original Drawing Size This Line Measures 100mm
 Original Drawing Size 5x4

Based upon the information submitted with the permission of Hertfordshire County Council on behalf of the Council of Hertfordshire Highways.
 Copyright © Hertfordshire Highways
 Unauthorised reproduction in any form or by any means and may lead to prosecution or civil proceedings.
 Hertfordshire County Council, Royston, Herts. SG8 5BQ

Hertfordshire Highways
 Highways Manager
 41-45 Breachwater Road
 Welwyn Garden City
 AL7 3SP
 Tel: 01707 356200
 Fax: 01707 356380

Project No. 749734/003		Drg. No. M1749734/003/005		Rev. B
Initiate	AW	Drawn	AW	Project Title Hertsmere Double Yellow Lines
Date	03/10/07	Checked	LL	
	02/08/2008	Approved	LL	
Sht No. 1 of 1		Drawing Title		Richfield Road/Elstree Road, Bushey
Scales		1:500		

Key	Proposed double yellow lines
-----	------------------------------

Notes

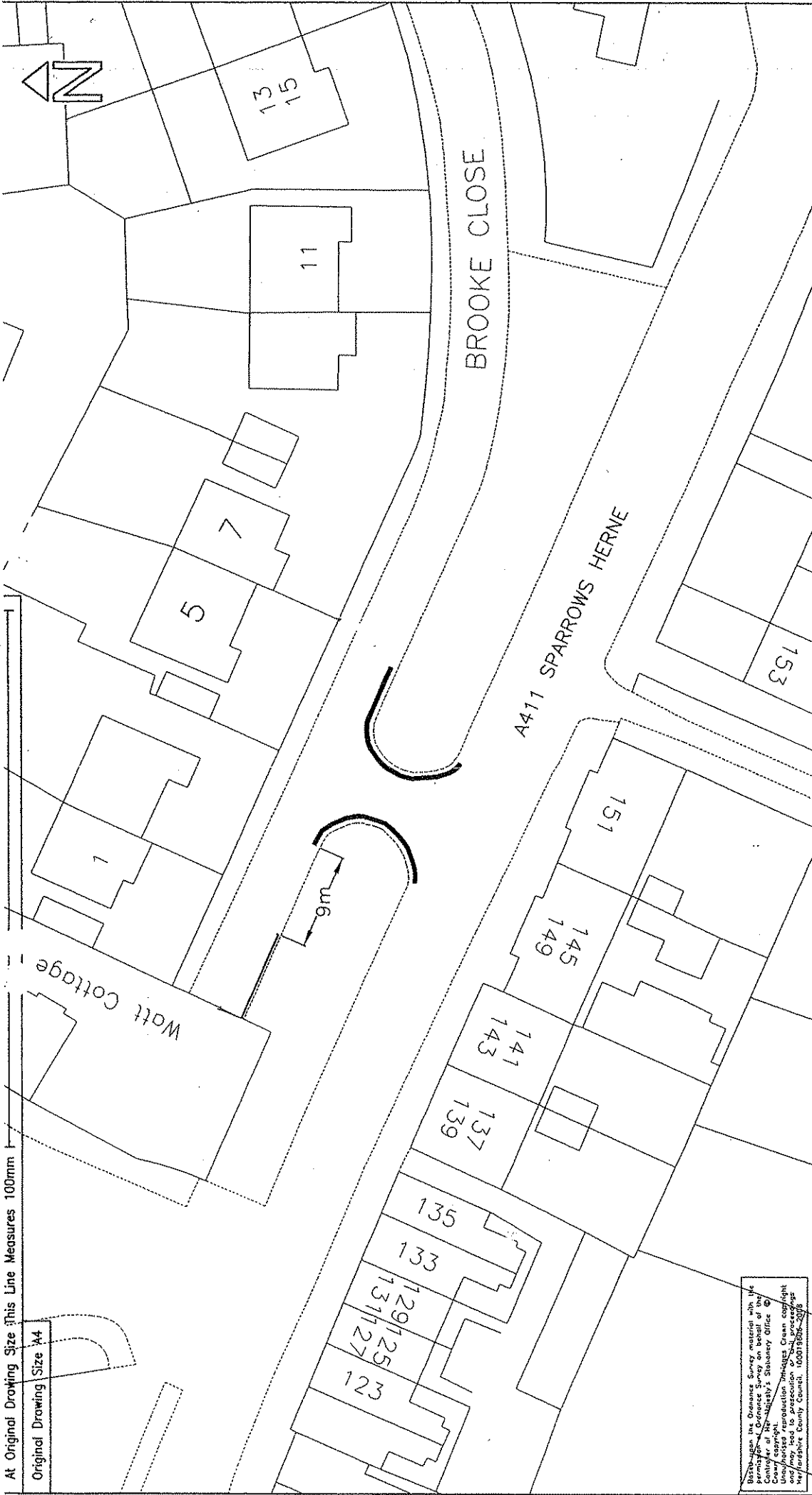

At Original Drawing Size This Line Measures 100mm

Original Drawing Size A4

Not to be used in any way without the permission of the Planning Department, Hertfordshire County Council. This drawing is the copyright of Hertfordshire County Council and must not be reproduced without written permission.

Notes	Project No. 749734/019		Org. No. M/749734/003/019	Rev. C							
	<table border="1"> <tr> <th>CAD</th> <th>Drawn</th> <th>Checked</th> <th>Approved</th> </tr> <tr> <td>AW</td> <td>AW</td> <td>AW</td> <td>AW</td> </tr> </table>		CAD	Drawn	Checked	Approved	AW	AW	AW	AW	Project Title
CAD	Drawn	Checked	Approved								
AW	AW	AW	AW								
Key	<p>Proposed double yellow lines</p>		Hertsmere Double Yellow Lines								
	<p>9m long gap left for car parking opposite 1 & 3 Brooke Close.</p>		Drawing Title								
<p>1. 9m long gap left for car parking opposite 1 & 3 Brooke Close.</p>		<p>1 of 1</p>		<p>Brooke Close, Bushey</p>							
<p>Scale 1:500</p>		<p>Hertfordshire Highways</p> <p>Hertsmere House 41-45 Brookwater Road Waltham Cross, Hertfordshire SG12 8JG Tel: 01707 356200 Fax: 01707 356380</p>									

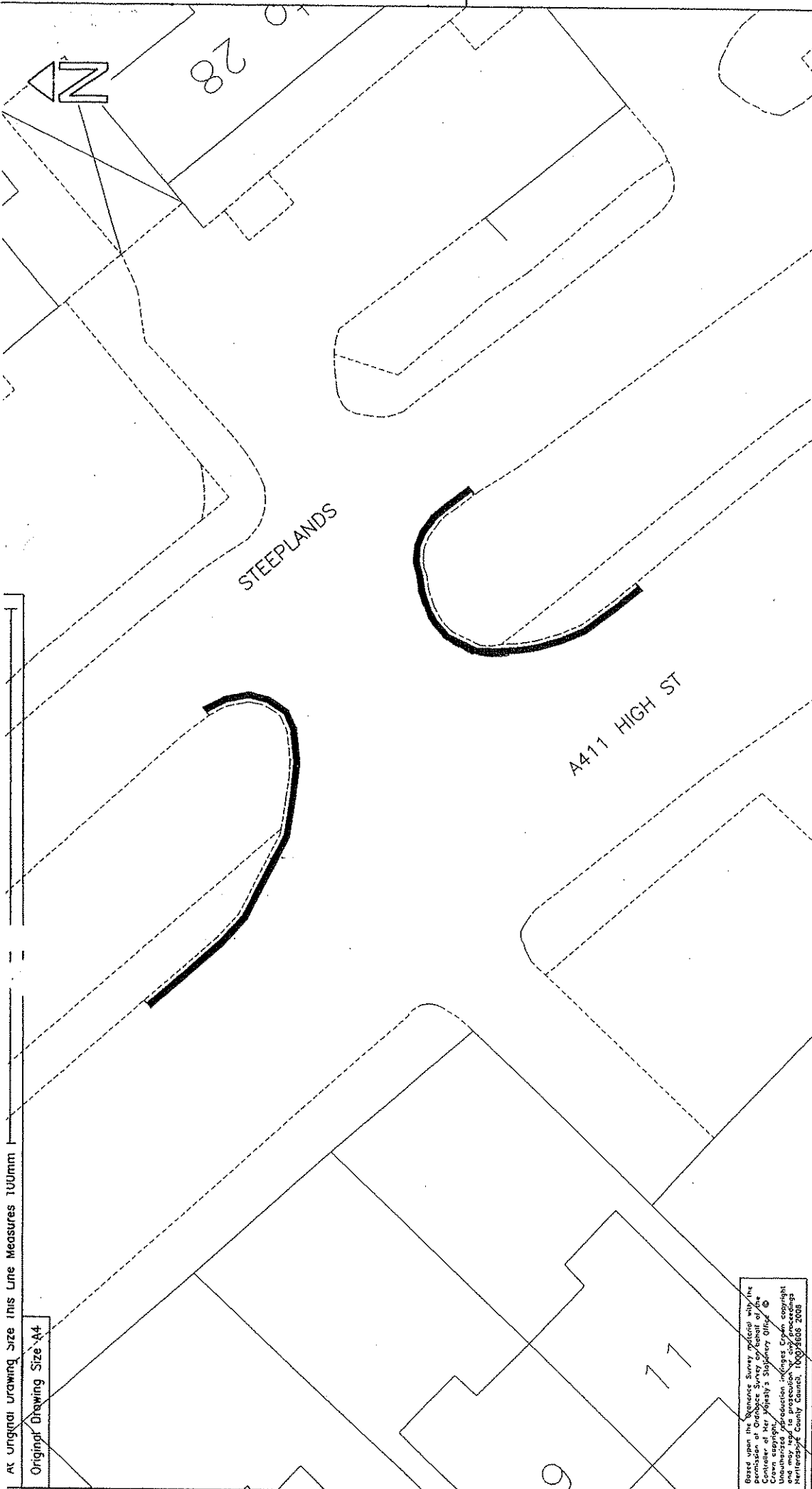

At original drawing size this line measures 100mm

Original Drawing Size - A4

Based upon the Ordnance Survey national grid, the permission of Ordnance Survey is hereby granted for the Crown copyright. This is a statutory right. Unauthorised reproduction in any form is prohibited. Ordnance Survey, 2008. Hertfordshire County Council, 2008.

Notes	Key	Project No. 749734/003		Drg. No. M/749734/003/002		Rev. A	
		CAD AW		Drawn AW		Checked LL	
		Initials		Date 25/10/07		Project Title Hertsmere Double Yellow Lines	
		Sht. No. 1 of 1		Drawing Title Steeplands/A411 High Street, Bushey		Hertfordshire Highways Highway House 4145 Bonchase Road Waltham Cross, City AL7 3EP Tel: 01797 356200 Fax: 01797 356300	
		Scales 1:250					

This Drawing is the copyright of Hertfordshire County Council and must not be reproduced without written permission

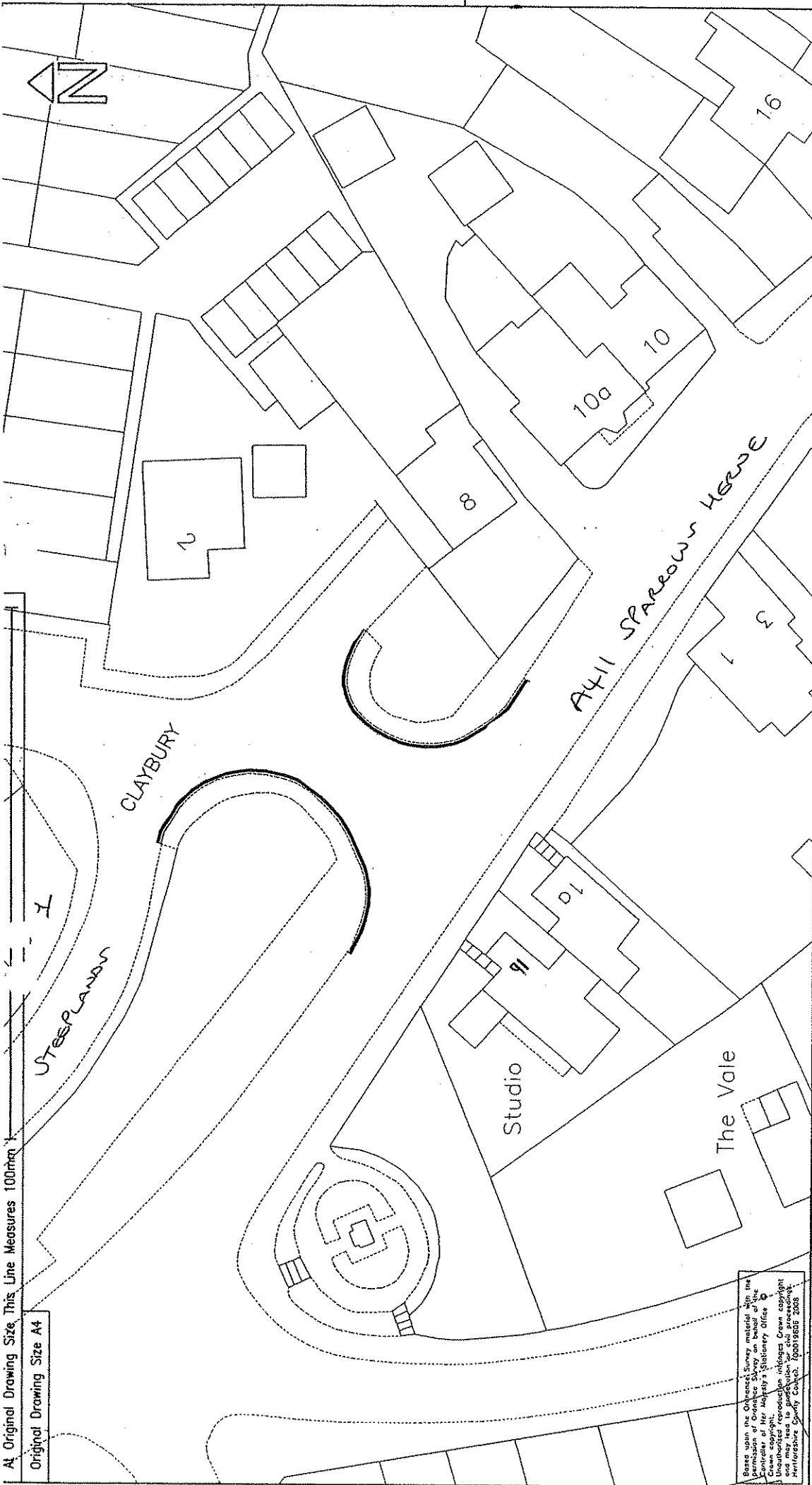

At Original Drawing Size This Line Measures 100mm
 Original Drawing Size A4

Based upon the Ordnance Survey material with the permission of the Controller of Her Majesty's Stationery Office. Crown copyright. All rights reserved. No part of this publication may be reproduced in any form or by any means without the prior written permission of the Controller of Her Majesty's Stationery Office. 100019555 2008

Notes Key Proposed double yellow lines	Project No. 749734/003		Drg. No. M/749734/003/003		Rev. A	
	CAD AW Initials AW Date 25/10/07 25/10/07	Drawn AW Checked AA Approved LJC	Project Title Hertsmere Double Yellow Lines			
	Site No. 1 of 1		Drawing Title Claybury/A411 Sparrows Heme, Bushey			
	Scales 1:500		Hertfordshire Highways Highways Team 41-45 Brewhouse Road Welwyn Garden City AL7 3SP Tel: 01707 356200 Fax: 01707 356380			

This Drawing is the copyright of Hertfordshire County Council and Must Not be Reproduced Without Written Permission

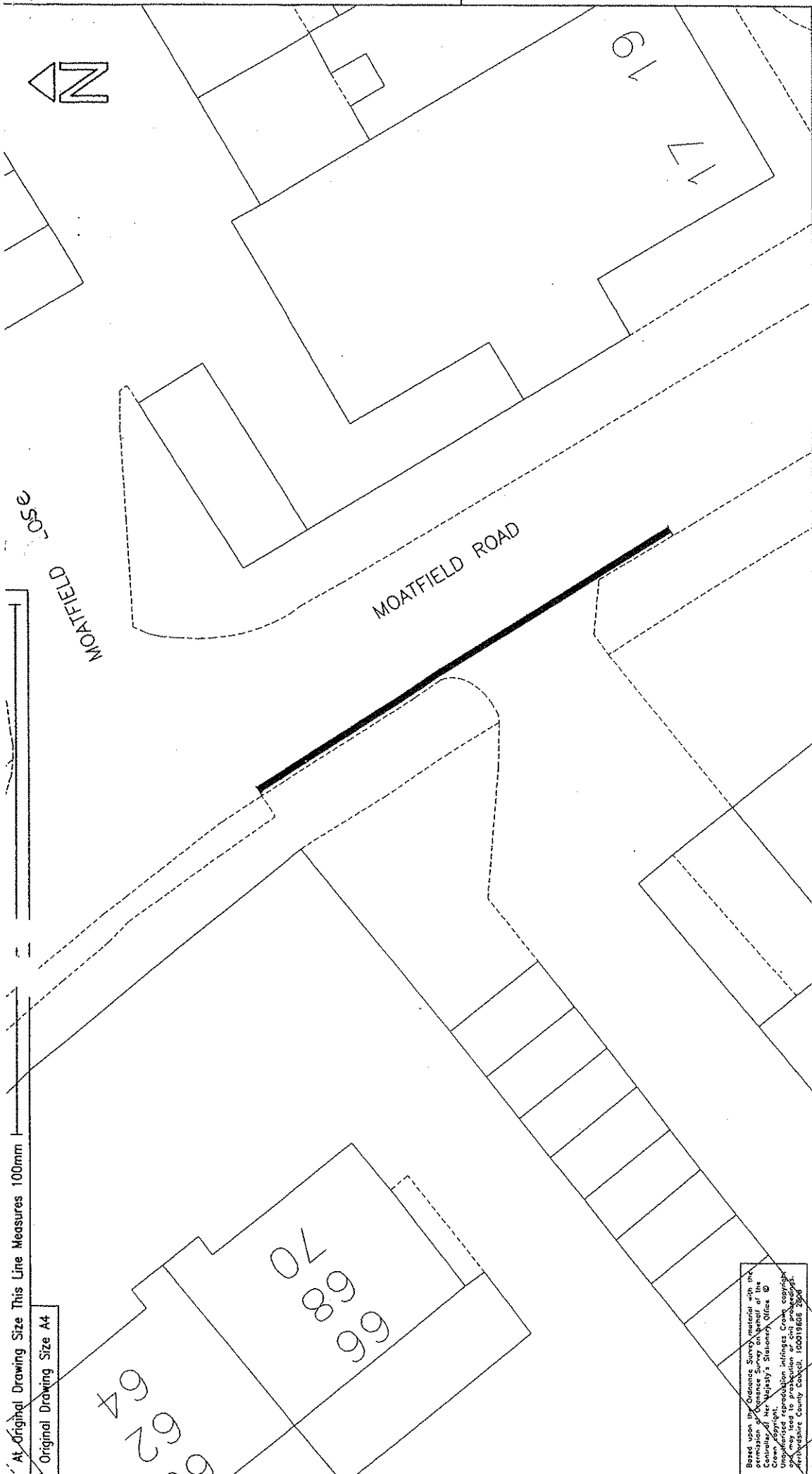

At Original Drawing Size This Line Measures 100mm
Original Drawing Size A4

Based upon the Ordnance Survey National Grid, with the permission of Ordnance Survey on behalf of the Controller of Her Majesty's Stationery Office. © Crown Copyright. All rights reserved. No copyright infringement may lead to prosecution or civil proceedings. Hertfordshire County Council, 100018668 25/07

Notes	Key	Proposed double yellow lines		Project No. 749734/003		Drg. No. M/749734/003/008	Rev. A
		Hertsmere Double Yellow Lines		Project Title			
1 of 1		Sht No.		Date 25/10/07		Hertsmere Double Yellow Lines	
1:250		Scales		Checked Approved		Hertfordshire Highways	
				Drawn AW		Hertfordshire Highways	
				CAD AW		Hertfordshire Highways	
				Date 25/10/07		Hertfordshire Highways	
				Sht No.		Hertfordshire Highways	
				Scales		Hertfordshire Highways	

This Drawing is the copyright of Hertfordshire County Council and must not be reproduced without written permission.



Hertfordshire Highways
Highways House
41-43 Disarbaner Road
Watling Gate City
AL7 3EP
Tel: 01707 356200
Fax: 01707 356380

