

HERTFORDSHIRE COUNTY COUNCIL

ROAD TRAFFIC REGULATION ACT 1984

Date of Order: 27 March 2009

Order No: 7341

**THE HERTFORDSHIRE (STUART COURT, ELSTREE)
(RESTRICTION OF WAITING) ORDER 2008**

**PARKING SERVICES
RECEIVED**

- 2 APR 2009

REF No _____

The Hertfordshire County Council in exercise of their powers under Sections 1, 2 and 3 of the Road Traffic Regulation Act 1984 (which said Act of 1984 is hereinafter referred to as "the Act of 1984"), and of all other enabling powers and after consultation with the Chief Officer of Police in accordance with Part III of Schedule 9 of the Act of 1984, hereby make the following Order:-

1. This Order may be cited as "The Hertfordshire (Stuart Court, Elstree) (Restriction of Waiting) Order 2008" and shall come into operation on Monday 6 April 2009
2. Save as provided in Articles 3, 4 and 5 of this Order no person shall cause or permit any vehicle to wait at any time in those lengths of Stuart Court, Elstree specified in the Schedule to this Order.
3. (1) Nothing in Article 2 of this Order applies to the lengths of road restricted by that Article (which said lengths of road are referred to in this Article as "the restricted area") in relation to –
 - (a) a vehicle being used for Fire and Rescue, Ambulance or Police purposes.
 - (b) anything done with the permission of or at the direction of –
 - (i) a police officer in uniform;
 - (ii) a Civil Enforcement Officer as defined by the Traffic Management Act 2004 and appointed by Hertsmere Borough Council.
 - (c) a vehicle which is prevented from proceeding by circumstances beyond the drivers control or which has stopped in order to avoid injury or damage to persons or property or when required to do so by law;
 - (d) a vehicle which is stationary in order that it may be used for one or more of the purposes specified in sub-Article (2) of this Article and which cannot reasonably be used for such a purpose without stopping in the restricted area;
 - (e) a marked vehicle which, whilst used by a universal service provider in the course of the provision of a universal postal service, is stationary only for so long as may be reasonably necessary for postal packets to be delivered or collected;

In this Article -

The expressions "universal service provider", "provision of a universal postal Service" and "postal packet" shall bear the same meanings as in the Postal Services Act 2000.

- (2) The "purposes" referred to in sub-Article (1)(d) of this Article are –

- (a) any operation involving building, demolition or excavation;
- (b) the removal of any obstruction to traffic;
- (c) the maintenance, improvement or reconstruction of a road;
- (d) constructing, improving, maintaining, or cleaning of any street furniture; or
- (e) the laying, erection, alteration, repair or cleaning of any sewer or of any main pipe or apparatus for the supply of gas, water or electricity, or of any telecommunications apparatus kept or installed for the purposes of a telecommunications code system or of any other telecommunications apparatus lawfully kept installed in any position.

4. Nothing in Article 2 of this Order applies to the lengths of road restricted by that Article (which said lengths of road are referred to in this Article as "the restricted area") so as to render it unlawful to cause or permit any vehicle to wait only for so long as may be reasonably necessary –

(a) to enable goods to be loaded on or unloaded from the vehicle from or to premises adjacent to the restricted area; or

(b) to enable a passenger to board or alight and to load and unload any luggage.

5. (1) Nothing in Article 2 of this Order shall render it unlawful to cause or permit a disabled person's vehicle which displays in the relevant position a disabled person's badge and a parking disc, to wait at any time in the lengths of road specified in the Schedule of this Order for a period not exceeding 3 hours (not being a period separated by an interval of less than 1 hour from a previous period of waiting by the same vehicle in the same length of road).

(2) In this Article -

"disabled person's vehicle" has the same meaning as in Section 142(1) of the Act of 1984;

"disabled person's badge" has the same meaning as given in Regulation 3(1) of The Local Authorities' Traffic Orders (Exemptions for Disabled Persons) (England) Regulations 2000

"parking disc" has the same meaning as given in Regulation 8(5) of The Local Authorities' Traffic Orders (Exemptions for Disabled Persons) (England) Regulations 2000; and

"relevant position" has the same meaning as given in Regulation 4 of The Local Authorities' Traffic Orders (Exemptions for Disabled Persons) (England) Regulations 2000

6. The Interpretation Act 1978 shall apply for the interpretation of this Order as it applies for the interpretation of an Act of Parliament.

7. The restrictions imposed by this Order shall be in addition to and not in derogation from any restriction or requirement imposed by any other regulations made or having effect as if made under the Act of 1984 or by or under any other enactment.

SCHEDULE

lengths of Stuart Court, Elstree – no waiting at any time

Stuart Court
(north east & south
east sides)

from a point 2.5 metres north west of the north west kerbline of
High Street north west and north eastwards for 23 metres.

(south west & north
west sides)

from a point 2.5 metres north west of the north west kerbline of
Elstree Hill South north west and north eastwards for 29.5 metres.

IN WITNESS whereof the Common Seal of the Hertfordshire County Council was
here unto affixed this 27th day of March 2009.

The Common Seal of)
Hertfordshire County Council)
was hereunto affixed)
in the presence of:-)



313

~~314~~

KATHRYN PETTITT
Assistant County Secretary

County Secretary

THE UNIVERSITY OF CHICAGO

CHICAGO, ILL.

(

(



Hertfordshire Highways
 Technical Team
 41-45 Broadwater Road
 Welwyn Garden City
 AL7 2SF
 Tel: 01707 550208
 Fax: 01707 550209

This drawing is the copyright of Hertfordshire County Council and may not be reproduced without written permission.

Site:		Stuart Court Elstree
Title:	Proposed Waiting Restrictions "At Any Time"	
Planning no.:	H273/416	Banner Ref. 581
Scale:	1:500 (A3)	Drawn: []
Rev. 01:	Issue July 08	Checked: []
A		Approved: []

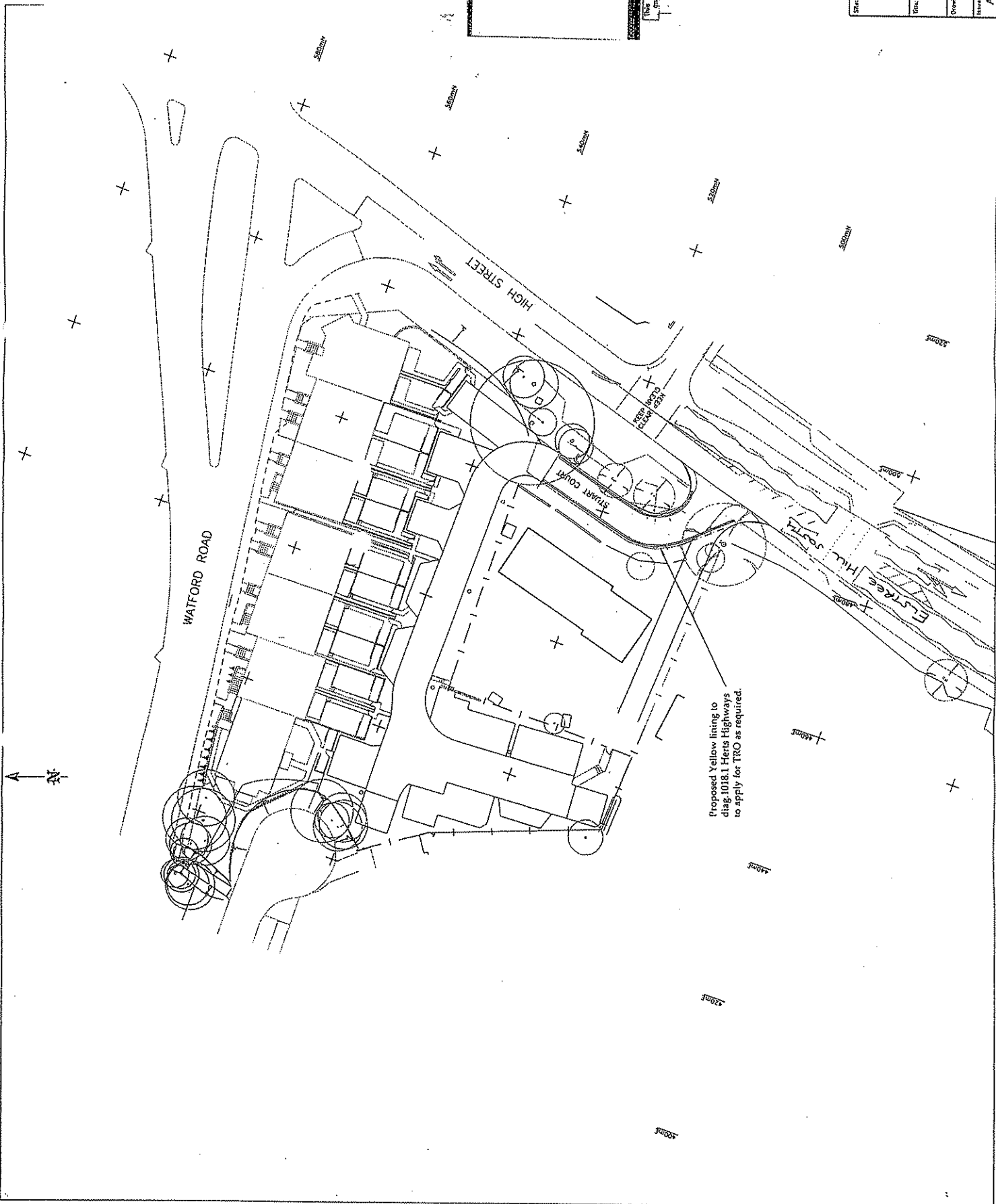

Proposed Yellow lining to
diag. 1018.1 Herts Highways
to apply for TRO as required.

100

[Faint, illegible text covering the majority of the page]

(

(