

HERTSMERE BOROUGH COUNCIL

ROAD TRAFFIC REGULATION ACT 1984

Date of Order 1 March 2007

Order No. 223

**The Borough of Hertsmere
(Manor Way Service Road, Borehamwood)
(Restriction of Waiting) Order 2007**

Hertsmere Borough Council (hereinafter referred to as "the Council") pursuant to arrangements made under Section 19 of The Local Government Act of 2000 and the Local Government (Arrangements for Discharge of Functions) (England) Regulations 2000 with Hertfordshire County Council ("the County Council") and in exercise of the powers conferred by Sections 1-4, 32 and 35, 45, 46, 49, 51 and 53 and Part IV of Schedule 9 to the Road Traffic Regulation Act 1984 ("the 1984 Act") (as amended by the Road Traffic Regulation (Parking) Act 1986) and Section 43 and Schedule 3 of the Road Traffic Act 1991 ("the 1991 Act") and of all other powers enabling them in that behalf and after consultation with the Chief Officer of Police in accordance with Part III of Schedule 9 to the 1984 Act hereby make the following Order:-

1. This Order may be cited as "The Borough of Hertsmere (Manor Way Service Road, Borehamwood) (Restriction of Waiting) Order 2007" and shall come into operation on 23 March 2007.
2. The provisions of the following Order are hereby revoked only in so far as they are affected by the restrictions imposed by this Order:

The Borough of Hertsmere (Control of Parking) (Consolidation) Order 2006.

3. Save as provided in Articles 4, 5 and 6 of this Order no person shall cause or permit any vehicle to wait between the hours of 8am and 6.30pm on Monday to Saturday for a period exceeding 2 hours (not being a period separated by an interval of less than 2 hours from any previous period of waiting by the same vehicle in the same length of road) in those lengths of the Manor Way Service Road specified in the schedules to this Order.
4. (1) Nothing in Article 3 of this Order applies to the lengths of road restricted by that Article (which said lengths of road are referred to in this Article as "the restricted area") in relation to:
 - (a) A vehicle being used for Fire and Rescue, ambulance or Police purposes.
 - (b) Anything done with the permission of or at the direction of:
 - (i) A police officer in uniform;

- (ii) In respect of any lengths of road in the restricted area which are in a special parking area designated under Part II of the Road Traffic Act 1991 or Schedule 3 to that Act, a parking attendant appointed under Section 63A of the Act of 1984;
- (c) A vehicle which is prevented from proceeding by circumstances beyond the drivers control or which has stopped in order to avoid injury or damage to persons or property or when required to do so by law;
- (d) A vehicle which is stationary in order that it may be used for one or more of the purposes specified in sub-Article (2) of this Article and which cannot reasonably be used for such a purpose without stopping in the restricted area;
- (e) A marked vehicle which, whilst used by a universal service provider in the course of the provision of a universal postal service, is stationary only for so long as may reasonably necessary for postal packets to be delivered and collected;

In this Article;

The expression “universal service provider”, “provision of a universal postal service” and “postal packet” shall bear the same meanings as in the Postal Services Act 2000.

(2) The “purposes” referred to in sub-Article (1)(d) of this Article are:

- (a) Any operation involving building, demolition or excavation;
 - (b) The removal of any obstruction to traffic;
 - (c) The maintenance, improvement or reconstruction of a road;
 - (d) Constructing, improving, maintaining or cleaning of any street furniture; or
 - (e) The laying, erection, alteration, repair or cleaning of any sewer or of any main pipe or apparatus for the supply of gas, water or electricity, or of any telecommunications apparatus kept or installed for the purposes of a telecommunications code system or of any other telecommunications apparatus lawfully kept installed in any position.
5. Nothing in Article 3 of this Order applies to the lengths of road restricted by that Article (which said lengths of road are referred to in this Article as “the restricted area”) so as to render it unlawful to cause or permit any vehicle to wait only for so long as may be reasonably necessary –
- (a) To enable goods to be loaded on or unloaded from the vehicle from or to premises adjacent to the restricted area; or

(b) To enable a passenger to board or alight and to load and unload any luggage.

6. (1) Nothing in Article 3 of this Order shall render it unlawful to cause or permit a disabled person's vehicle that displays in the relevant position a disabled person's badge, to wait at any time in the lengths of road specified in the schedule to this Order.

(2) In this Article –

“disabled person's vehicle” has the same meaning as in Section 142(1) of the Act of 1984;

“disabled person's badge” has the same meaning as in Section 142(1) of the Act of 1984;

“relevant position” means

A vehicle displays a disabled person's badge in the relevant position if:-

- a) in the case of a vehicle fitted with a dashboard or fascia panel, the badge is exhibited thereon so that Part 1 of the badge is legible from outside the vehicle; or
- b) in the case of a vehicle not fitted with a dashboard or fascia panel, the badge is exhibited in a conspicuous position on the vehicle so that Part 1 of the badge is legible from outside the vehicle.

7. The Interpretation Act 1978 shall apply for the interpretation of this Order as it applies for the interpretation of an Act of Parliament.

8. The restrictions imposed by this Order shall be in addition to and not in derogation from any restriction or requirement imposed by any regulations made or having effect as if made under the Act of 1984 or by any other enactment.

IN WITNESS whereof the Common Seal of the Hertsmere Borough Council was hereunto affixed this 1st day of March 2007.

The Common Seal of the)
Hertsmere Borough Council)
was hereunto affixed in the)
presence of :-)

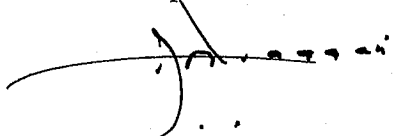

Head of Legal Services

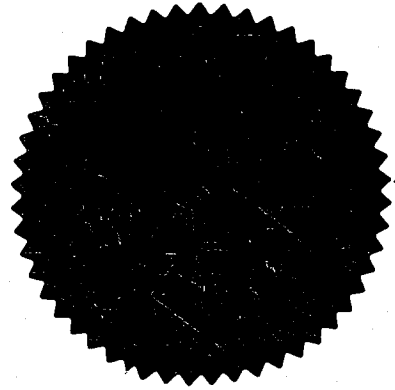

SCHEDULE

Lengths of Manor Way Service Road, Borehamwood
8 am to 6.30pm Monday to Saturday,
waiting limited to 2 hours no return within the next 2 hours.

West side from a point opposite the common boundary of Nos.148/150 Manor Way northwards for a distance of 17.5 metres.

West side from a point opposite the common boundary of Nos. 112/114 Manor Way southwards for a distance of 81.5 metres.

STATEMENT OF REASONS FOR PROPOSING

**The Borough of Hertsmere
(Manor Way Service Road, Borehamwood)
(Restriction of Waiting) Order 2007**

Hertsmere Borough Council in order to prevent all-day parking outside the Manor Way shopping parade propose to implement two-hour maximum stay parking, with no return within 2 hours, between the hours of 8am to 6.30pm, Monday to Saturday. The restrictions are aimed at providing a turnover of parking spaces for shoppers and short-stay visitors and to assist the viability and vitality of local shops and businesses.

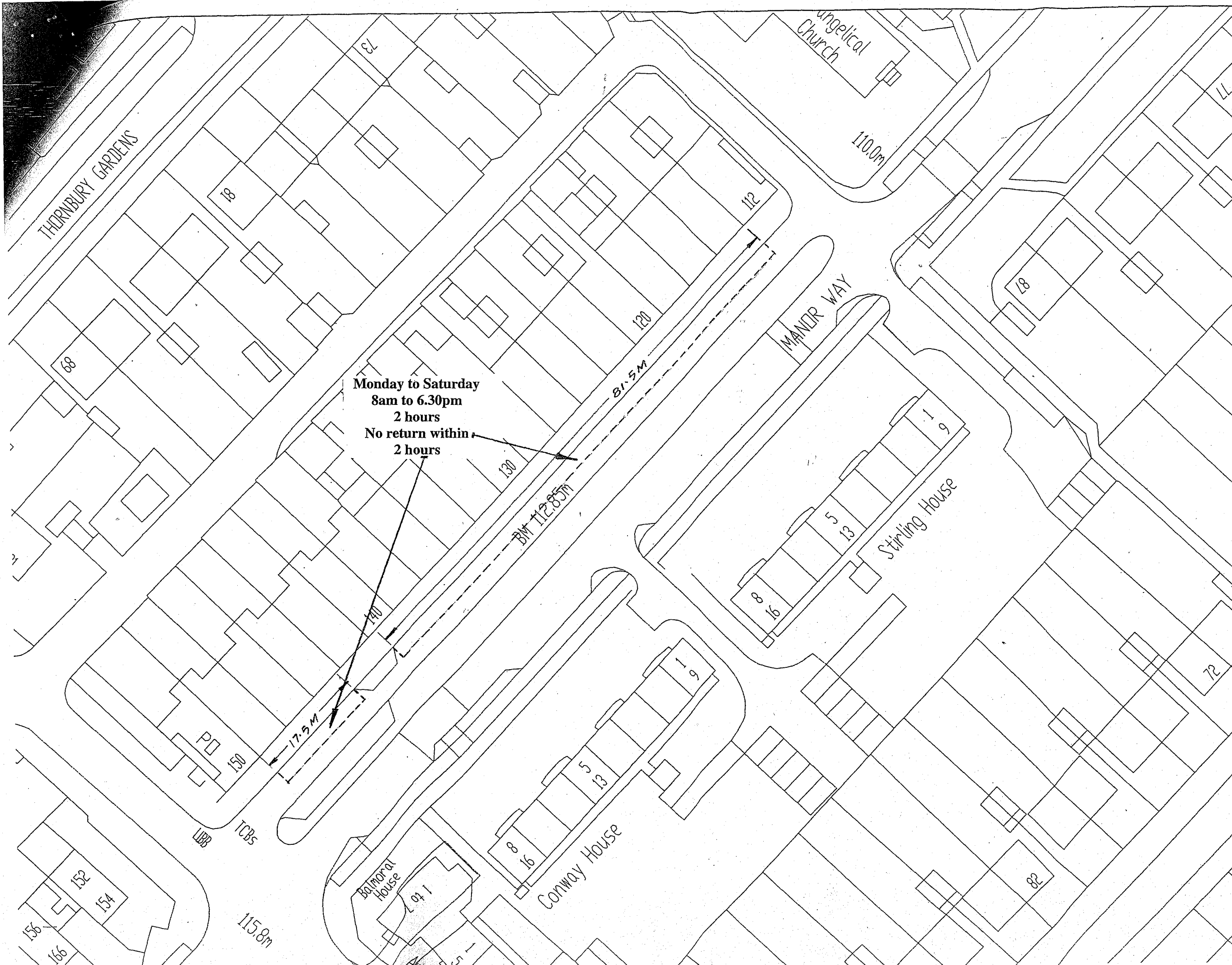

Monday to Saturday
8am to 6.30pm
2 hours
No return within
2 hours

Reproduced from the Ordnance Survey map with the permission of the Ordnance Survey on behalf of the Controller of Her Majesty's Stationery Office. (Crown Copyright). Unauthorised reproduction is prohibited. Ordnance Survey maps are available from Ordnance Survey, High Holborn, London WC1A 1DU.

- Key**
- Residents and visitors only permit parking places 8.00 a.m. - 6.30 p.m. Monday to Saturday
 - Residents and visitors only permit parking places 1 hour restriction during working day. Between 2.00 p.m. - 3.00 p.m. Monday to Friday
 - Shoppers parking places Waiting limited to 1 hour - No return within 2 hours
 - Disabled persons parking places
 - General parking
- Waiting Restrictions**
- 8.00 a.m. - 6.30 p.m. Monday to Saturday
 - At any time
 - 1 hour restriction during working day. Between 2.00 p.m. - 3.00 p.m. Monday to Friday
- Public Car Park

- Street Furniture**
- Vehicle Crossing
 - Cable Box
 - Beacon post
 - Signpost
 - Lighting column
 - Tree
 - Traffic signal
 - Telephone call box
 - Dropke
 - Ballard
 - Pub sign
 - Telegraph post
 - Bus stop
 - Post Box
 - Zebra crossing
- Existing advisory white line to indicate that dropped kerb should be kept clear of parked vehicles

- Signs**
- A
 - B
 - C
 - D
 - E
 - F
 - G
 - H
- Zone Boundary



Date	Rev.	Comments

HERTSMERE BOROUGH COUNCIL
R. HIGGINS, B.SC.(HONS), C.ENG., M.I.C.E., F.I.H.
SERVICES DIRECTOR

Project Title
BOREHAMWOOD CONTROLLED PARKING SCHEME

**MANOR WAY
2 HOUR LIMITED
WAITING**

Scale 1:500	Date DEC 06
Checked 	Drawn C.H.C.
	Eng. B.B.
	Appr.